



# AudioSource®



A Phoenix Gold International Company

# AMP200

## OWNER'S MANUAL



# WARNING

- TO PREVENT FIRE OR SHOCK HAZARD, DO NOT USE THIS PLUG WITH AN EXTENSION CORD, RECEPTACLE OR OTHER OUTLET UNLESS THE BLADES CAN BE FULLY INSERTED TO PREVENT BLADE EXPOSURE.
- TO PREVENT FIRE OR SHOCK HAZARD, DO NOT EXPOSE THIS APPLIANCE TO RAIN OR MOISTURE.
- TO PREVENT ELECTRICAL SHOCK, MATCH WIDE BLADE PLUG TO WIDE SLOT, FULLY INSERT.



This lightning flash with arrowhead symbol, within an equilateral triangle, is intended to alert the user to the presence of uninsulated "dangerous voltage" within the product's enclosure that may be of sufficient magnitude to constitute a risk of electric shock to persons.

## CAUTION

### RISK OF ELECTRIC SHOCK DO NOT OPEN

Warning: To reduce the risk of electric shock, do not remove cover (or back) no user serviceable parts inside. refer servicing to qualified service personnel.



The exclamation point within the equilateral triangle is intended to alert the user to the presence of important operating and maintenance (servicing) instructions in the literature accompanying the appliance.

## IMPORTANT SAFETY INSTRUCTIONS

1. Read these instructions.
2. Keep these instructions.
3. Heed all warnings.
4. Follow all instructions.
5. Do not use this apparatus near water.
6. Clean only with dry cloth.
7. Do not block any ventilation openings. Install in accordance with the manufacturer's instructions.
8. Do not install near heat sources such as radiators, heat registers, stoves, or other apparatus (including amplifiers) that produce heat.
9. Do not defeat the safety purpose of the polarized or grounding type plug. A polarized plug has two blades with one wider than the other. A grounding type plug has two blades and a third grounding prong. The wide blade or third prong are provided for your safety. If the provided plug does not fit into your outlet, consult an electrician for replacement of the obsolete outlet.
10. Protect the power cord from being walked on or pinched particularly at the plugs, convenience receptacles, and at the point where they exit from the appliance.
11. Only use attachments or accessories specified by the manufacturer.
12. Unplug the apparatus during lightning storms or when unused for long periods of time.
13. Refer all servicing to qualified personnel. Servicing is required when the apparatus has been damaged in any way, such as power supply cord or plug is damaged, liquid has been spilled or objects have fallen into the apparatus, the apparatus has been exposed to rain or moisture, does not operate normally, or has been dropped.

This appliance shall not be exposed to dripping or splashing water and no object filled with liquids such as vases shall be placed on apparatus.

# AMP200 Source Switching Amplifier



Congratulations on your purchase of the AudioSource AMP200. Please take a few moments to read this entire manual, and be sure to retain this document for future reference. Please read and observe all safety instructions detailed on page two (2).

**!** Note: If any part of this product is damaged or missing, please call your dealer or Phoenix Gold Home Products directly at 800-435-7115 or 503-286-9300.

## Using the Controls / Front Panel

### Power

The front panel switch will manually switch the AMP200 on or off. A blue LED behind the faceplate lens indicates its power status. Whenever the amplifier's power switch is in the "ON" position and the amplifier is in "Active" status the lens is illuminate Blue. If the amplifier is "ON" but in the "Standby" status the lens is illuminated RED.

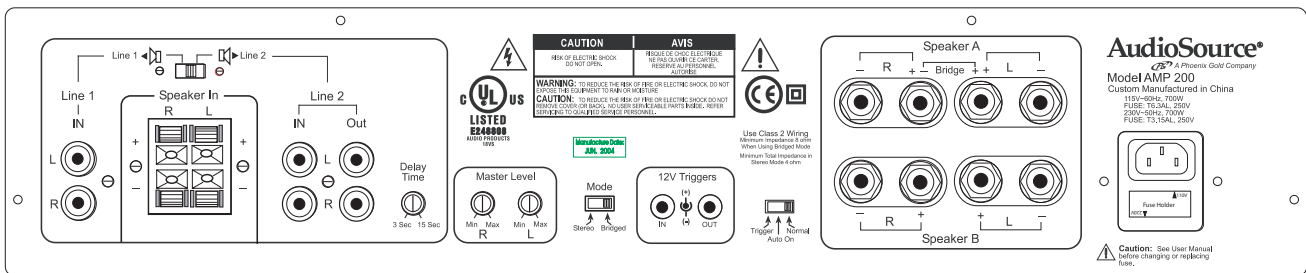

## Using the Controls / Back Panel

### Power

The AMP200 can be turned on and off independently via a switch on the front panel, by signal sensing, or remotely by a triggered DC input. There is a switch located on the lower edge of the rear panel of the amplifier to select how you would like to turn on the AMP200. If you would like to control the unit's power on / power off status manually from the front, place the switch in the "Normal" position. If you would like to control the unit's power on / power off status by means of signal sensing, place the switch in the "AUTO ON" position. If you would like to control the unit's power on / power off status by a DC remote trigger, place the switch in the "TRIGGER" position, and connect the remote triggering wire and ground from your triggering device to the terminal labeled "TRIGGER IN" next to the switch.

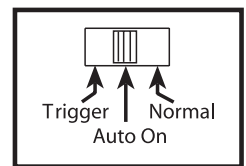
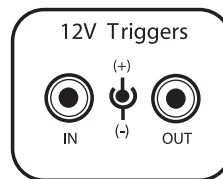

You should use a 3.5mm phone plug in the "IN" connector to make this connection. The tip of the connector is (+) positive, and the sleeve of the connector is (-) negative. A second terminal in the same block is labeled "OUT". This allows for remote turn-on of other devices when the AMP300 is powered on. Use the same polarity for the terminals of this plug. Please read the owner's manual for any devices you are attempting to connect in this manner to ensure compatibility.

**!** Note: The front panel power switch must be in the "ON" position for the 12V triggers or "Auto ON" features to operate.

## Master Level Controls

Each channel is able to control its volume independently relative to the other channel. At the bottom left of the rear panel, there are 2 screwdriver adjustment knobs which correspond to the volume level of the channel identified by a channel designator below it.

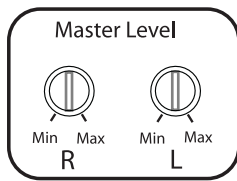

The volume range is labeled Minimum to Maximum and has 1 steps (clicks) at a center detent position as a reference. Rotate the knob clockwise to increase output, and counter-clockwise to decrease output.

These adjustments set the master level and if not set up at initial setup of the AMP200 will or may adversely affect the performance of the amplifier.

To set the Master Level controls begin by adjusting the front panel "Volume Trim" to its fully clockwise position. Also set the front panel "Balance Trim" to its center detent position. Now adjust both the Left and Right Channel Master Level controls to set a "Maximum" desired volume for the AMP200 in its application, as well as setting an appropriate "Balance" from left to right.

Now the front panel Volume and Balance Trim controls can make fine adjustments to your set up in this application.

## RCA Input

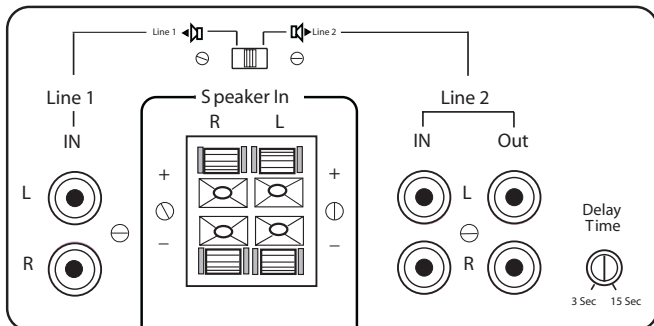

There are a total of 4 RCA inputs on the back panel of the AMP200. These RCA inputs are labelled as "Line 1 Input" and "Line 2 Input". They are also designated with an "R" or an "L" as Right channel or Left Channel inputs respectively.

"Line 2 Input" should be used as the "primary" or normal input for various line level sources that may be available locally to the amplifier. "Line 1 Input" is a priority switching input that can be used for a second input, such as, the output of a second source, and will take over as the primary input whenever a signal with a minimum of 5mV of level is present. Whenever, there is an absence of signal at the "Line 1 Input" RCAs the input will revert back to the normal "Line 2 Input" RCAs input signal. An adjustable delay of from 3 Seconds to 15 Seconds is available and can be set to accommodate the nature of the source connected to the "Line 1 Input" RCAs.

As an example, if the "Line 1 Input" source was a CD Changer, the delay could be adjusted to prevent switching back to the "Line 2 Input" source while the changer moves from one disc to another.

## Speaker Level Input

The AMP200 also provides a pair of speaker level inputs for those applications where either of the sources has only speaker level output signal available. This input may be switched to be used in place of the Line 1 or Line 2 input.

## Mode Switch

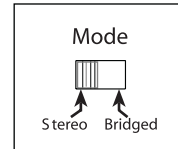

To the right of the Master Level controls is a switch labeled "MODE" with "STEREO" and "BRIDGED" as options. If you will be connecting one or two pair of speakers to the amplifier, place the switch in the "STEREO" position.

If you will be using a pair of channels to power a single mono speaker, place the switch in the "BRIDGED" position, and be sure to read the section titled "Speaker Terminals" below.

When you are using the amplifier in "Bridged Mode," the amplifier is now a single channel Mono amplifier. The two channels have been internally connected in series by the "Bridge" switch. The AMP200 is now capable of 250W, bridged into 8 ohms with less than 0.2% THD+N.

For the amplifier to operate properly in the bridged mode you should have both the "Right and Left" inputs connected to the amplifier. The amplifier will sum these signals and create your Mono source.

**NOTE:** Both of the "Master Level" adjustments should be set to the same position, and the "Balance Trim" should be set to the center or 12 o'clock position for the amplifier to operate normally in the "Bridged" mode.

**NOTE:** This amplifier will produce in excess of 300 watts with a bridged pair of channels. Please verify that your speakers are capable of handling such power to avoid possible damage!

## Speaker Terminals

Each channel has two pair of multi-way binding post. These are the red and black screw posts on the rear of the amplifier. Terminals are provided for "A" and "B" pairs of speakers for each channel. If you will be using the amplifier as a stereo amplifier (i.e.- not a bridged amplifier) you will connect the speakers positive (red) terminal to the amplifiers positive (red) terminal using the appropriate gauge speaker wire, and the speakers negative (black) terminal to the amplifiers negative (black) terminal (immediately below the positive terminal) using the appropriate gauge speaker wire. If you would like to use one pair of channels bridged, place the "MODE" switch in the "BRIDGED" position and use both RED terminals to connect to the speaker. (See illustration on page 5)

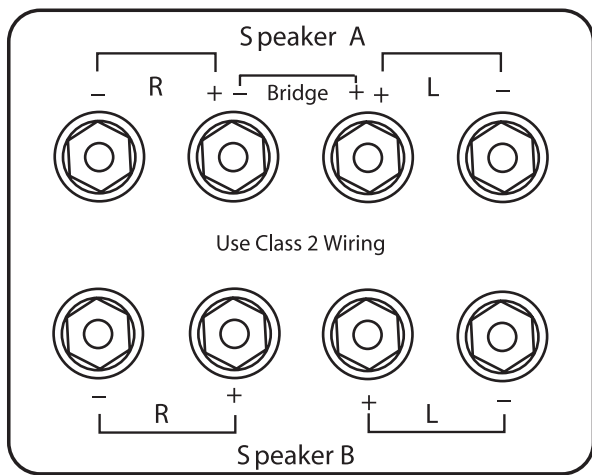

**NOTE:** Only one pair of channels can be bridged together. Do not attempt to bridge both A & B speaker terminals, as this may result in a lower impedance than the amplifier is designed to accommodate, and may damage your amplifier. **The minimum impedance for the total load connected to a pair of channels in the bridged mode is 8-ohm.**

**NOTE:** This amplifier is capable of use with standard US voltage (115VAC) as well as European voltage (230VAC). The amplifier will be preset for the voltage of the country it is sold in. Use with other voltages requires some changes to be made to the amplifier. Should you wish to use the amplifier in a country other than the one for which it was purchased, please contact Phoenix Gold Home Products support at 1-800-435-7115.

## AMP 200 Specifications

### Power Bandwidth 20Hz-20kHz:

80W per CH into 8 ohm loads with less than 0.2% THD+N  
 125W per CH into 4 ohm loads with less than 0.2% THD+N  
 250W Bridged Mono into 8 ohms with less than 0.2% THD+N

Crosstalk: >65dB @ 1kHz, ref. to rated power into 8 ohms  
 Frequency Response: (20Hz to 20kHz)+0.0dB, -0.5dB  
 Signal to Noise ratio: -103dB ref. to rated power into 4 ohms  
 AC Power Consumption: 700W (all channels driven)  
 Net Weight: 24.3 lbs (11.0 kgs)  
 Gross Weight: 32.2 lbs (14.6.0 kgs)

### AC Mains Fuse:

115V ~ 60Hz T6.3AL, 250V  
 230V ~ 50Hz T3.15AL, 250V

## Limited Warranty

Phoenix Gold International, Inc. (or "AudioSource") warrants its amplifier products against defects in materials and workmanship for a limited period of time. For a period of two years from date of original purchase, we will repair or replace the product, at our option, without charge for parts and labor. Customer must pay all parts and labor charges after the limited warranty period expires. The limited warranty period for factory refurbished products expires after ninety (90) days from date of original purchase.

This limited warranty applies only to purchases from authorized AudioSource Electronics retailers. This limited warranty is extended only to the original purchaser and is valid only to consumers in the United States.

Consumers are required to provide a copy of the original sales invoice from an authorized AudioSource dealer when making a claim against this limited warranty. This limited warranty only covers failures due to defects in materials or workmanship that occur during normal use. It does not cover failures resulting from accident, misuse, abuse, neglect, mishandling, misapplication, alteration, faulty installation, modification, service by anyone other than Phoenix Gold, or damage that is attributable to Acts of God. It does not cover costs of transportation to Phoenix Gold or damage in transit. The customer should return their defective product, freight prepaid and insured, to Phoenix Gold International, Inc. only after receiving a Return Authorization.

This warranty will become void if the serial number identification has been wholly or partially removed, altered or erased. Repair or replacement under the terms of this warranty does not extend the terms of this warranty. Should a product prove to be defective in workmanship or material, the consumer's sole remedies will be repair or replacement as provided under the terms of this warranty. Under no circumstances shall Phoenix Gold be liable for loss or damage, direct, consequential or incidental, arising out of the use of or inability to use the product. There are no express warranties other than described above.

## Applications

### Powering Speakers Outdoors

Whenever you are using loudspeakers outdoors, you should be aware that sound does not travel like it would in your home. Without the reflective surfaces of walls and ceilings, sound outdoors will dissipate quickly. Therefore, in an outdoor situation the AMP200 provides the opportunity to bridge adjacent channels, effectively doubling the available power for your speakers. This can help to overcome the problem of using speakers outdoors assuming the speakers chosen are capable of handling the additional power.

It should be noted that the AMP200 is rated to operate into a minimum 8-ohm bridged load. Therefore, if you are using more than a single 8-ohm loudspeaker in bridged mode you should consider using an impedance matching speaker selector, such as the Innovative Home ASM4, ASM6 or ASM8 or possibly using an impedance matching volume control, such as the Innovative Home VMT1 in a weatherproof housing available at your favorite DIY store or electrical supply. The choice of a volume control would allow you the additional flexibility of being able to attenuate the volume whenever necessary.

## Stereo Setup

In this configuration, the mono switch is set to stereo for stereo operation. Connect the line out jacks from a stereo preamplifier or source to the Line 2 input jacks of your AMP200. Next connect your speakers to the terminals marked "SPEAKER A" observing proper polarity (see "Speaker Terminals" Page 5). Connect a second (optional) pair of speakers to the terminals marked "SPEAKER B". Select between the "A" and/or "B" speakers using the front panel speaker selection buttons.

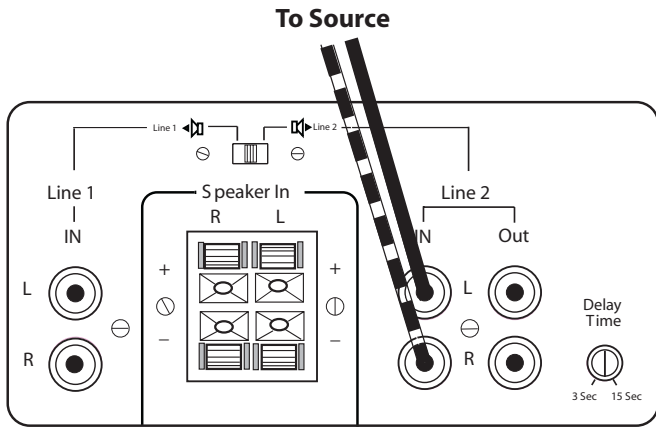

## Mono Setup

In this configuration, the mono switch is set to bridged. Connect the line out from a preamplifier to the right and left Line 2 input of your Amp200. Connect your mono speaker to the terminals of your Amp200, following the instructions in "Speaker Terminals" on Page 4. Use the "Master Level" controls on the rear panel to adjust the volume. Leave the balance set to the center detent position.

## Setup For Multiple Sources

In the application shown below, a distributed audio system is connected to the AMP200 as a local zone amplifier via the Line 2 inputs. Normally the distributed audio system will be the audio source for the AMP200.

The distributed audio is then passed on to be used by additional zones or sub zones in the distributed system via the Line 2 outputs.

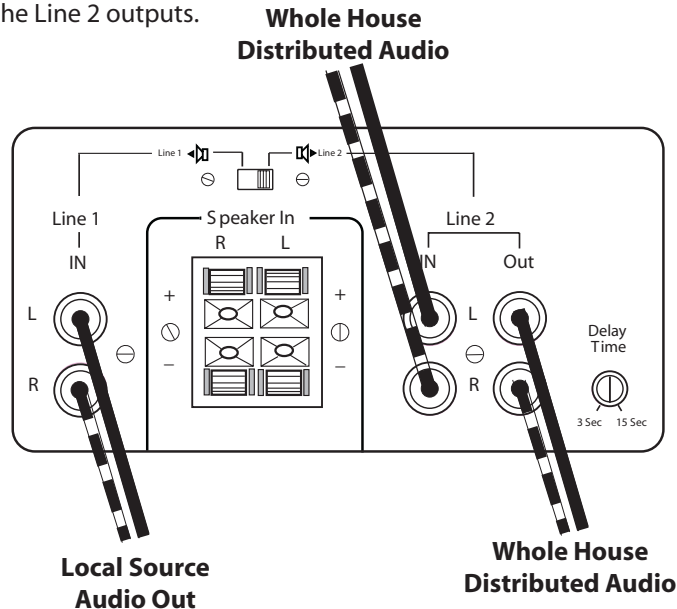

The Audio output of a local source, such as MP3 Player, CD, television, computer, etc. is connected to the AMP200 via the Line 1 inputs, and whenever the local source is active its signal will take priority over the distributed audio signal present at Line 2. However, the distributed audio signal will still be present at the Line 2 input. In this circumstance the audio output of the local source will be heard via the AMP200. Once the local source is turned off or muted, the AMP200 will automatically switch back the distributed audio system as an audio source, assuming the television is remains inactive. The delay time adjustment determines when switch back to the normal source will occur.

This set up assumes all incoming signals are at line level and not at speaker level. If the Whole House Distributed Audio was only available as a Speaker Level signal you could connect it the "Speaker In" connections and set the switch above to the "Line 2" position, or toward the right hand position of the switch.

## Whole House Distributed Audio

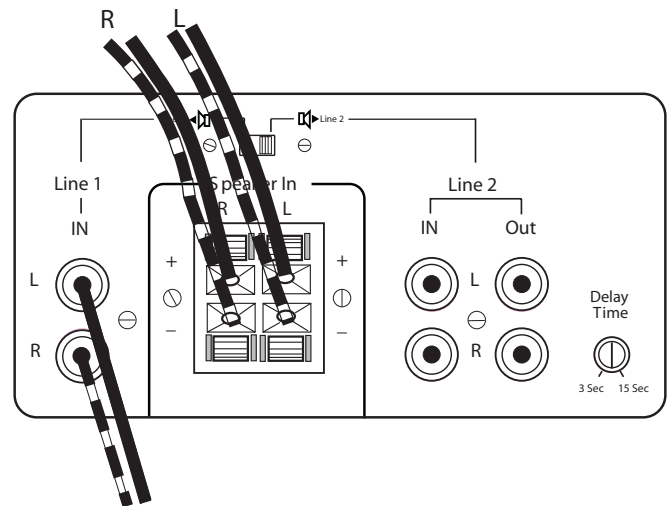

## Local Source Audio Out

The AMP 200 will no longer be able to pass the Whole House Distributed Audio to another zone via the Line 2 Output.

If you have any questions regarding how to set this up, please call Phoenix Gold Tech support at **800.950.1449**.

## Free Manuals Download Website

<http://myh66.com>

<http://usermanuals.us>

<http://www.somanuals.com>

<http://www.4manuals.cc>

<http://www.manual-lib.com>

<http://www.404manual.com>

<http://www.luxmanual.com>

<http://aubethermostatmanual.com>

Golf course search by state

<http://golfingnear.com>

Email search by domain

<http://emailbydomain.com>

Auto manuals search

<http://auto.somanuals.com>

TV manuals search

<http://tv.somanuals.com>