

# Instruction Manual for CMOS2 5-in-1 Rear-view Camera

Dear Customer,  
CONGRATULATIONS! This 5-in-1 high resolution rear-view camera kit when used as described can be installed in 5 different ways and will improve your ability to see what behind you car, CRV or mini-van. We have taken numerous measures in quality control to ensure that your products arrive in top condition and will perform to your satisfaction.

## Before You Install

Automotive video equipment installations can be difficult at times, even to the most experienced installation technicians. If you are not confident working with 12 volt DC vehicle wiring, removing and reinstalling interior panels, carpeting or other components of your vehicle, contact the vehicle's manufacturer or consider having the system installed professionally.

## Parts

1. Camera main body with 70" power and signal cable.

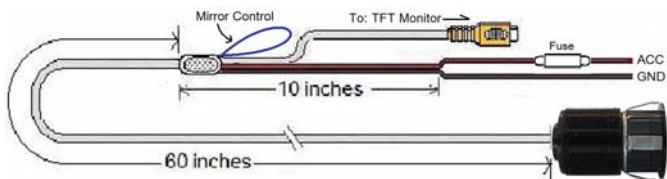

2. Parts package listed below:

### Parts name list:

1. Camera main unit.
2. Trim Ring.
3. Main ring.
4. Slim angle ring.
5. Angle ring.
6. Locking ring.
7. Long butterfly bracket.
8. Short butterfly bracket.
9. Surface Mount bracket.

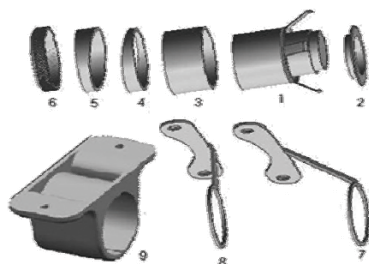

This camera kit can be in the following installations:

- a. Bumper Mounted
- b. Traditional Drilled/Angled Mount
- c. With Long butterfly Style bracket
- d. With Short butterfly Style bracket
- e. Surface Mounted style

Note: The Trim Ring (Part no #2) can be painted in any color and then replaced to match the Vehicle Color. DO NOT PAINT ON THE CAMERA.

## Installation Instructions:

### A. Bumper Mounted

Before you drill a hole on the rear bumper, you must check what is behind where you are drilling. If there are any vehicle components, such as electrical parts or fuel system components behind where you are drilling, you must take whatever precaution necessary not to damage them. Insure you have enough depth for the camera housing.

1. You will only need #2 attached to The camera.
2. Use a 15/16" diameter hole saw to drill a hole on the rear bumper.
3. Insert the camera cable into the hole and carefully feed through the hole. Route the cable into the trunk or Tail Light Housing area.
4. Connect the camera power cable: Red to reverse lamp power +12V and black to ground
5. Connect the monitor and camera using a video coax cable. Note: DO NOT USE AN AUDIO RCA CABLE.



### B. Traditional Drilled/Angled Mount

1. Parts # 3, 4, 5, &6 may be used depending on the mounting location selected. Use any combination to adjust to your required mounting angle.
2. Use a 15/16" diameter hole saw to drill a hole where you are mounting the camera.
3. Insert the camera cable into the hole and carefully feed through the hole. Route the cable into the trunk or Tail Light Housing area.
4. Connect the camera power cable: Red to reverse lamp power +12V and black to ground
5. Connect the monitor and camera using a video coax cable. Note: DO NOT USE AN AUDIO RCA CABLE.



### c. Long butterfly style bracket

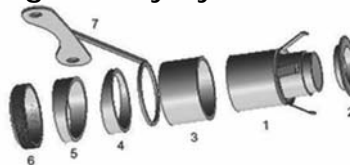

1. Parts #2, #1 #3, #7, #4, #5 and #6 May be used, The Butterfly mount can be at any position on the camera.
2. Mount the camera using two screws; always look before you screw into the vehicle to insure there is nothing located behind your mounting location.
3. Route the cable into the trunk or Tail Light Housing area.
4. Connect the camera power cable: Red to reverse lamp power +12V and black to ground
5. Connect the monitor and camera using a video

coax cable. Note: DO NOT USE AN AUDIO RCA CABLE.



#### D. Short butterfly style bracket

1. Parts #2, #1, #3, #4, #5, #8 and #6 May be used.  
The Butterfly mount can be at any position on the camera.
2. Mount the camera using two screws; always look before you screw into the vehicle to insure there is nothing located behind your mounting location.
3. Route the cable into the trunk or Tail Light Housing area.
4. Connect the camera power cable: Red to reverse lamp power +12V and black to ground
5. Connect the monitor and camera using a video coax cable. Note: DO NOT USE AN AUDIO RCA CABLE.

#### E. Surface Mounted Plastic bracket

1. Combine Parts #2, #1, #9, #2 and #6.
2. Mount the camera using two screws; always look before you screw into the vehicle to insure there is nothing located behind your mounting location.
3. Route the cable into the trunk or Tail Light Housing area.
4. Connect the camera power cable: Red to reverse lamp power +12V and black to ground
5. Connect the monitor and camera using a video coax cable. Note: DO NOT USE AN AUDIO RCA CABLE.



## Free Manuals Download Website

<http://myh66.com>

<http://usermanuals.us>

<http://www.somanuals.com>

<http://www.4manuals.cc>

<http://www.manual-lib.com>

<http://www.404manual.com>

<http://www.luxmanual.com>

<http://aubethermostatmanual.com>

Golf course search by state

<http://golfingnear.com>

Email search by domain

<http://emailbydomain.com>

Auto manuals search

<http://auto.somanuals.com>

TV manuals search

<http://tv.somanuals.com>