



Xpress^{EZ}



user guide
XMCK-5P

Quick Start

1. Install your Xpress^{EZ} in your vehicle
2. Activate your XM subscription online at <http://activate.xmradio.com> or by phone 1 800 XM RADIO (1-800-967-2346)
3. Listen to XM*
4. Identify and easily access your favorite channels by using the **favorites** button

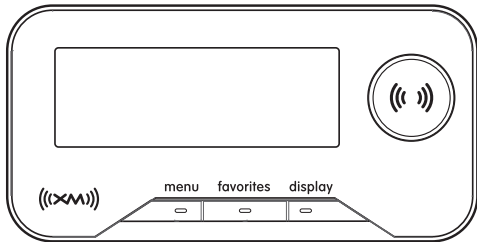

*Hardware and required monthly subscription sold separately. Installation cost and other fees and taxes, including a one-time activation fee, may apply. Subscription fee is consumer only. XM products, programming, services, and fees are subject to change, at any time, without notice. Channels with frequent explicit language are indicated with an XL. Channel blocking is available for XM radio receivers by calling 1-800-XM-RADIO. Subscriptions subject to Customer Agreement available at xmradio.com. XM service only available in the 48 contiguous United States. ©2007 XM Satellite Radio Inc. All rights reserved.

Introduction	4	Auto Tune Mode	27
Features.....	4	Auto Off	28
Safety Instructions.....	5	Factory Defaults.....	28
What's in the Box	7	Customer Support	29
Xpress ^{EZ} Controls	8	Troubleshooting	30
Using this Guide	9	Specifications	32
Vehicle Installation	10	Product Registration	33
Mounting the XM Antenna	12	Patent Information	34
Installing the Vent Mount.....	13	FCC Statement	35
How to Receive XM Through your Car's Stereo	14	Warranty	36
Making Your FM Radio an XM Radio ..	15		
Activation	18		
Using your Xpress^{EZ}	20		
Listening to Live XM.....	21		
Search by Category	21		
Favorites	22		
Display.....	23		
Menu Options	24		
FM Frequency	24		
Brightness	25		
Contrast	25		
Backlight Timer	25		
Audio Level	26		
Bass and Treble.....	26		
Antenna Aiming	26		

Features

Congratulations on your purchase of the Audiovox Xpress^{EZ}. Your new Xpress^{EZ} includes:

Built-in FM modulator

Favorites button allows you to program 10 of your favorite channels

Easily view channel, artist, and song title via a bright 3 line display

Move quickly through XM channels with the tune and press knob

Enjoy XM's 170 channels from coast to coast, with over 80,000 hours of entertainment each month. XM offers musical choice, variety, and discovery – worlds beyond your own collection – plus a wide range of news, sports, talk, comedy, kids, and entertainment channels.

We recommend that you read the entire manual before using your Xpress^{EZ}.

Safety Instructions

Please read and understand all the instructions to avoid injury to yourself and/or damage to your Xpress^{EZ}. Please be aware that XM claims no responsibility for damage from data loss due to breakdown, repair, or other causes.

Xpress^{EZ} Digital Audio Player

- Do not expose to extreme temperatures (above 140°F or below -4°F, or above 60°C or below -20°C).
- Do not expose to moisture. Do not use Xpress^{EZ} near or in water.
- Do not let any foreign matter spill into Xpress^{EZ}.
- Do not expose to chemicals such as benzene and thinners. Do not use liquid or aerosol cleaners. Clean with a soft damp cloth only.
- Do not expose to direct sunlight, fire, flame or other heat sources for a prolonged period.
- Do not try to disassemble and/or repair Xpress^{EZ} yourself.
- Do not drop your Xpress^{EZ} or subject it to severe impact.
- Do not place heavy objects on Xpress^{EZ}.
- Do not subject Xpress^{EZ} to excessive pressure.
- Do not touch the Xpress^{EZ} with wet hands.
- Do not store in dusty areas.

Caution: Opening the case may result in electric shock.

Caution: The uninsulated parts inside the power adapter and cradle may cause electric shock or fire. For your safety, please do not open these components. Do not let metallic objects, such as necklaces or coins, come into contact with the power adapter plugs.

Caution: To avoid electric shock, use the power adapter only with an outlet that matches the shape of the adapter's plug.

Caution: Make sure that you insert the adapter's plug all the way into the outlet.

Caution: Do not plug several devices into the same electrical outlet.

Important: Always read and understand the user guide to prevent problems.

Warning: Use the power adapter and cradle away from water sources to avoid fire or electric shock.

Environmental Information

- Follow local guidelines for waste disposal when discarding packaging and electronic appliances.
- Your Satellite Radio receiver is packaged with cardboard, polyethylene, etc., and does not contain any unnecessary materials.

⚠ Warnings

- When using this product it is always important to keep your eyes on the road and hands on the wheel. Not doing so could result in personal injury, death, and/or damage to your Xpress^{EZ} Receiver, accessories, and/or to your vehicle or other property.
- Xpress^{EZ} should be placed in your vehicle where it will not interfere with the function of safety features, e.g. deployment of airbags. Failure to correctly place Xpress^{EZ} may result in injury to you or others if the unit becomes detached during an accident and/or obstructs the deployment of an airbag.

What's in the Box?

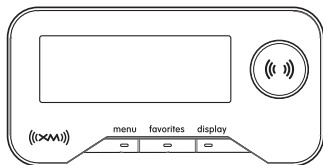

Xpress^{EZ}

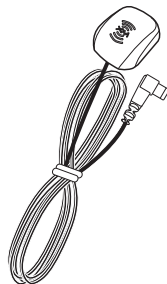

XM Antenna

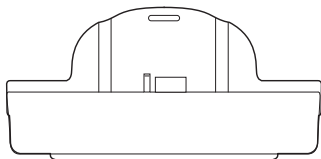

Car Cradle

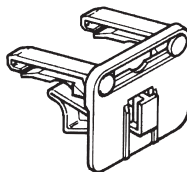

Vent Mount

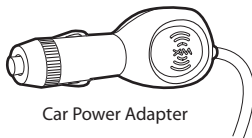

Car Power Adapter

XpressEZ Functions

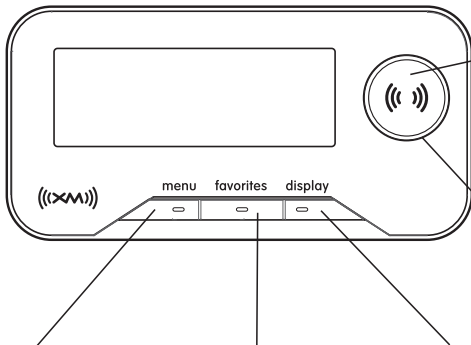

Power/Select XM Button

Power button; also confirms selection for channels, categories, and menu items. Press and hold to power down.

Knob

Previews channels and navigates categories and menu options.

Menu

Access advanced features and configuration options.

Favorites

Store and access up to 10 of your favorite channels.

Display

Changes the way content is shown on the display.

Using This Guide

Throughout this guide, you will see instructions such as: Select **menu** → **Antenna Aiming**. This tells you to perform the following actions:

1. Press the **menu** button.
2. Rotate knob to highlight **Antenna Aiming**, then press the **XM** button to select it.

Not all of the menu items described in this guide may appear on your Xpress^{EZ} display. Some menu items will only be seen when Xpress^{EZ} is used in an accessory home kit or boombox (both sold separately).



vehicle installation

Vehicle installation

Every vehicle is different; for your safety, follow all instructions carefully. Consult a professional installer if you have questions.

1. To begin, first decide which method of installation is best for your vehicle:

XM SureConnect (Sold Separately): You can listen to your Xpress^{EZ} through your car stereo by using Xpress^{EZ}'s built-in FM modulator and the XM SureConnect. Simply find an unused FM frequency on the stereo and set your Xpress^{EZ} to transmit on that same frequency.

FM Direct Adapter (Sold Separately): If you choose to use the FM Direct Adapter to transmit XM audio through your car stereo, we recommend professional installation.

Cassette Adapter (Sold Separately): Use the cassette adapter if your vehicle's audio system has a built in cassette player. The cassette adapter will provide the best audio quality.

Audio input: Some vehicles come with an audio input jack. If your vehicle has this type of input you can simply use a mini audio cable (**sold separately**).

Note: Separate purchase of one of the above accessories is required in order to install your Xpress^{EZ}.

2. Once you have chosen your method of installation, next you can mount your Xpress^{EZ}.
3. Next decide the best location for your XM antenna. Mount this antenna to the roof or trunk of the vehicle. During installation, make sure you are outdoors and the antenna is not obstructed by tall buildings.
4. Finally you will connect all of the plugs to the car cradle and dock your Xpress^{EZ} into the cradle. Once in place you can activate your Xpress^{EZ}.

Now that you have all of the parts you need, you are ready to begin installing your Xpress^{EZ}.
Download from www.Somanuals.com. All Manuals Search And Download.

Step 1: Mounting the XM Antenna

Mount the XM antenna to the roof or trunk of the vehicle. During installation, make sure you are outdoors and the antenna is not obstructed by tall buildings. For best results mount the XM antenna to the outside of your vehicle. Below are the recommended options.

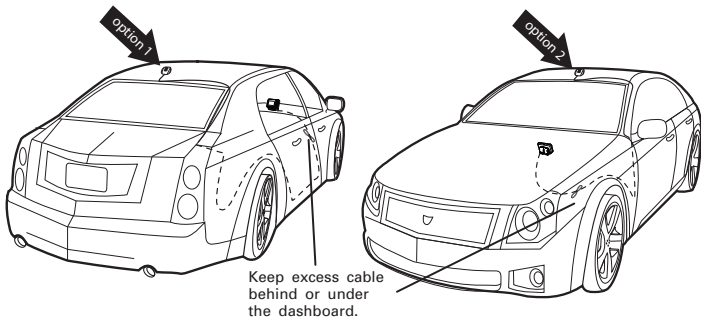
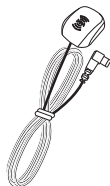

The XM antenna contains a strong magnet, allowing it to stick to any metal parts of your vehicle.



Step 2: Installing the Vent Mount

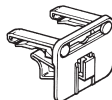

To install the vent mount, find a horizontal vent that is strong enough to hold your Xpress^{EZ} and car cradle. To remove the vent mount, push it into the vent and lift upwards slightly to release the mount's hooks from the vent vane.

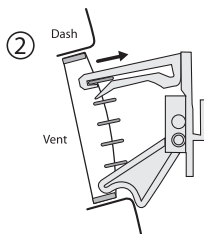
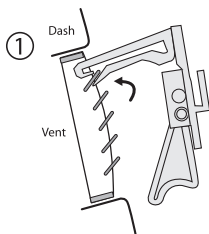

Some parts of the vent mount can be adjusted to better suit your vent.

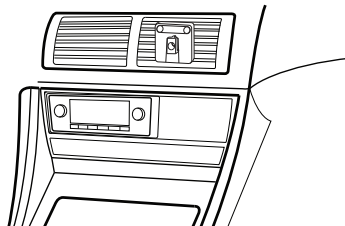

Step 3: How to receive XM through your car stereo

There are several methods of receiving XM through your car stereo

Option 1

XM SureConnect (Sold Separately): You can listen to your Xpress^{EZ} through your car stereo by using Xpress^{EZ}'s built-in FM modulator and the XM SureConnect. Simply find an unused FM frequency on the stereo and set your Xpress^{EZ} to transmit on that same frequency.

Option 2

Professional Wired (Sold Separately): If you choose to use the FM Direct Adapter to transmit XM audio through your car stereo, we recommend professional installation.

Option 3

Cassette Adapter (Sold Separately): Use the cassette adapter if your vehicle's audio system has a built in cassette player. The cassette adapter will provide the best audio quality.

Audio input: Some vehicles come with an audio input jack. If your vehicle has this type of input you can simply use a mini audio cable (**sold separately**).

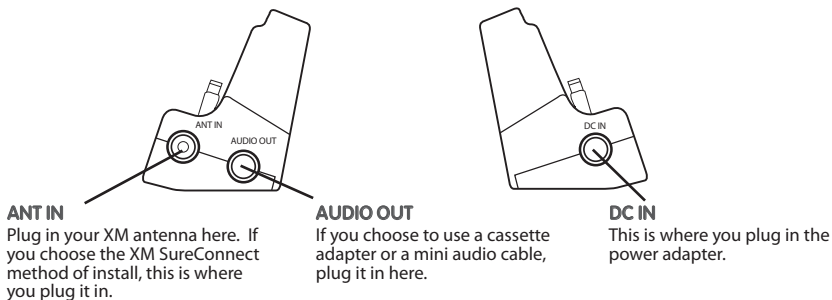

Step 4: Making Your Vehicle's FM Radio an XM Radio

Your Xpress^{EZ} contains a built-in FM modulator that requires the use of either the XM SureConnect (sold separately) or the FM Direct Adapter (sold separately) to transmit the XM audio signal to your vehicle's FM radio.

First, turn on your car stereo. You will need to find a suitable FM frequency in order to get the best sound. A suitable FM frequency is an unused frequency or weak station that is not located near a strong FM station in your area. Follow the steps below for more help:

1. Go to **www.xmradio.com/fmlocator** for recommended FM frequencies in your area.
2. Enter your local USPS Zip Code.
3. You will see the recommended FM frequencies in your area. Try the "vacant" channels first.
4. Set your vehicle's FM radio to one of the recommended frequencies. Now set your XM receiver to the same frequency using the menu settings. For more information, see FM Frequency on page 24.
5. If the audio quality is not satisfactory, you can repeat these steps by choosing another frequency.

You will see a chart that looks like this:

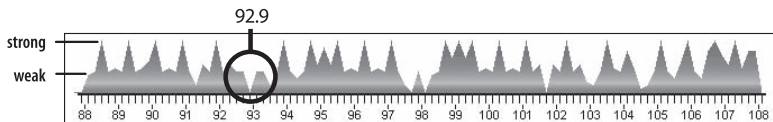

This chart represents the FM channels in the Washington, DC area. The spikes represent the strength of the FM channel. Someone in DC would choose a “vacant” channel like 92.9 that is unused and located between two weaker channels.

Sample Search Results for Major US Markets:

City:	Zip Code:	FM Channels:
New York City	10199	88.5, 91.9, 95.1
Los Angeles	90052	99.1, 101.5, 107.9
Chicago	60607	89.1, 90.7, 91.1
Houston	77201	88.1, 95.1, 97.3
Washington, DC	20090	92.9, 97.7, 98.1

Next, power on your Xpress^{EZ}. Be sure all of your cables are properly connected. Go to channel 1, this is the preview channel. You will not hear any sound through your vehicle’s audio system until you have chosen an FM Frequency.

Note: Your XM radio may not modulate on each of the frequencies shown on the Radio-Locator site. Check your Xpress^{EZ} for the frequencies that are usable for you.

Press **Menu**, look for this screen:



Press the **XM** button, then turn the knob to scroll through the frequencies. Match the frequency to the frequency you see on your car’s FM radio. Choose from frequencies between 88.1 - 107.9.



If you choose to use a cassette adapter or a mini audio cable (both sold separately) be sure to turn the FM Modulator off instead of setting it to one of the FM frequencies:



Now you should be able to hear your Xpress^{EZ} through your FM stereo. If you can't hear any sound please check all of your connections and be sure your XM antenna is not obstructed. Visit Troubleshooting (page 30) for more information.

Now you will learn how to activate and use your Xpress^{EZ}.

2

activation

Before you can listen to XM content, you must activate your Xpress^{EZ}.

1. Set up your Xpress^{EZ}, car cradle, power adapter, and antenna (pages 10 -17). Make sure Xpress^{EZ} can receive the XM signal.
2. Find the 8-character XM Radio ID, which is printed on the package or on the back of your Xpress^{EZ}. Or select XM channel 0 to view the Radio ID. Record the Radio ID here for reference:

--	--	--	--	--	--	--	--

The XM Radio ID does not use the letters I, O, S, or F.

3. Activate your XM Satellite Radio service online at <http://activate.xmradio.com> or by calling 1 800 XM RADIO (1-800-967-2346). You will need a major credit card. The website will walk you through activation, selecting a service plan, and creating an XM account.

XM will send a signal from the satellites to activate the full channel lineup. Activation normally takes 10 to 15 minutes, but during peak busy periods you may need to keep your Xpress^{EZ} on for up to an hour. When you can access the full channel lineup on your Xpress^{EZ}, you're finished!

3

using your Xpress^{EZ}

Listening to Live XM

Turn on your XpressEZ. Subscribe to XM (page 19) if you haven't done so already.

Selecting Channels

Rotate the knob to scroll through the list of channels. Press the **XM** button to select a channel. You can also set up XpressEZ so that you do not have to press the **XM** button to select a channel. See "Auto Tune Mode" on page 27.

- OR -

If you have channels assigned to favorites, press the **favorites** button several times until you find the channel you would like to listen to.

- OR -

Press the number keys on the remote (sold separately) that correspond to the channel number.

Search by Category

XM channels are organized into categories, or genres, such as "Rock," "Jazz," or "News."

To find a channel by category:

1. At any live XM screen, press the **XM** button and a category name will appear.
2. Rotate the knob to navigate through categories.
3. Press the **XM** button to select a category.
4. Rotate the knob to navigate through channels within the category.
5. Press **XM** button to select a channel.

To choose another category, scroll back up to the category name and press the **XM** button, scroll to choose another category. Press **display** to get back to the live **XM** screen.

Favorites

There are 10 user presets that can be stored using the **favorites** button. To set a channel to your favorites:

1. Tune to desired channel.
2. Press and hold the **favorites** button for 2 seconds.

The stored location for the channel will appear across the top of the display.

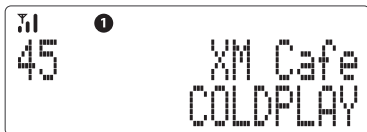

You can access your favorite channels by pressing the **favorites** button.

When you attempt to add more than 10 favorite channels, your XpressEZ will give you the option to replace one of your previously saved favorite channels. To replace a favorite channel:

1. Tune to desired channel.
2. Press and hold **favorites** button for 2 seconds. You will receive a message stating "Favorites Full" then you will be prompted to "Replace?".
3. Rotate knob to navigate through your favorite channels.
4. Press **XM** to replace. You will receive a message confirming the replacement.



Display

Press the **display** button to change the way you view the content on the display. There are 3 different display modes. Each time you press **display**, the display will change.

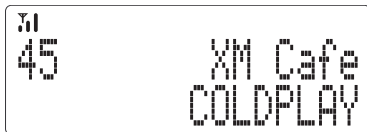

View by channel number, channel name, and artist name.



View by channel number, channel name, and song title.

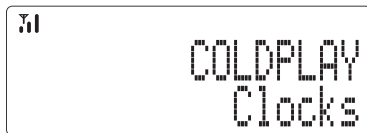

View by artist name and song title.

Menu Options

FM Frequency

You will need to find a suitable FM frequency in order to get the best sound. A suitable FM frequency is an unused frequency or weak station that is not located near a strong FM station in your area. To access your FM Frequency menu press **menu** → **FM Frequency**. Here you can choose which FM frequency to select for FM modulation. See page 15 for more information.

Favorite FM Frequencies

To set a Favorite FM frequency:

1. Press **menu** → **FM Frequency**.
2. Navigate through the list of frequencies and press the **XM** button to make your selection.



The selected FM Frequency is automatically added to your favorites and a number (1 thru 5) to which that frequency is assigned will be displayed. When you attempt to add more than five FM frequencies to your Favorites, your first FM frequency will be overwritten.

To access a Favorite FM Frequency:

1. Press **menu** → **FM Frequency**.
2. Press the **favorites** button until the desired FM Frequency is displayed

Note: pressing **menu** allows you to back out of any menu.

Brightness

To change the display's brightness:

1. Press **menu** → **Brightness**.
2. Rotate the knob to adjust the display's brightness.
3. Press **XM** to confirm your selection.
4. Press the **menu** button to back out.

Contrast

To change the display's contrast:

1. Press **menu** → **Contrast**.
2. Rotate the knob to adjust the display's contrast.
3. Press **XM** to confirm your selection.
4. Press the **menu** button to back out.

Backlight Timer

The Backlight Timer feature allows you to set the amount of time the display backlight remains on. To adjust your backlight timer:

1. Press **menu** → **Backlight Timer**.
2. Rotate the knob to adjust the Backlight Timer setting.
3. Press **XM** to confirm your selection.
4. Press the **menu** button to back out.

Audio Level

When listening to your XpressEZ, you can adjust its audio level to match other audio sources (your CD player, other FM stations, or MP3 player).

1. Press **menu** → **Audio Level**.
2. Rotate the knob to adjust the Audio Level setting.
3. Press **XM** to confirm your selection.
4. Press the **menu** button to back out.

Bass and Treble (Audio System Option)*

You can adjust the bass and treble to suit the kind of music you're listening to.

1. Press **menu** → **Bass** or **Treble**
2. Rotate the knob to adjust the Bass or Treble setting.
3. Press the **XM** button to confirm your selection.
4. Press **menu** button to back out.

*Audio Systems are sold separately

Aiming the Antenna

For optimal reception of XM's live satellite signal, your XpressEZ antenna should have an unobstructed view of the XM satellites in the southern sky. In large cities, XM also has a network of ground repeaters to help increase the signal coverage.

Your Xpress^{EZ} can help you aim the antenna to pull in the strongest possible signal.

1. Press **menu** → **Antenna Aiming**.
2. As you adjust the antenna the “Satellite” and “Terrestrial” signal bars will change. Find the position that gives the strongest signal strength on either “Satellite” or “Terrestrial.”
3. The antenna aiming display remains as long as it’s needed to help you position the antenna. When you’ve found the best position, press **menu** to back out.



Auto Tune Mode

By default, Auto Tune is set to “Off” meaning, as you scroll through live XM channels you can preview the channel list before selecting a channel. Xpress^{EZ} does not switch to that channel until you press the **XM** button. By setting Auto Tune to “On” you can change this behavior so that Xpress^{EZ} automatically tunes to the channel that you’re previewing.

1. Press **menu** → **Auto Tune Mode**.
2. Rotate the knob to the “On” option.
3. Press **XM** to confirm your selection.
4. Press the **menu** button to back out.

Xpress^{EZ} will automatically tune to the channel that you preview.

Auto Off

Options: OFF, 15 minutes, 30 minutes, 45 minutes, 1 hour, 2 hours, and 3 hours.

If the cigarette lighter is always powered, you can set the XpressEZ to automatically turn off after a period from 15 minutes to 3 hours.

1. Press **menu** → **Auto Off**.
2. Rotate the knob to select your desired time period.
3. Press **XM** to confirm your selection.
4. Press the **menu** button to back out.

Factory Defaults

This feature erases all of your “favorites,” and resets all other settings to the original factory configuration.

1. Press **menu** → **Factory Default**.
2. Rotate knob to display “Yes”.
3. Press the **XM** button to confirm your selection.
4. Press the **XM** button one more time at the “Are you sure?” to confirm “Yes” again.

4

Customer Support

Troubleshooting

Xpress^{EZ} is designed and built to provide you with trouble-free performance without the need for servicing. If it does not appear to be functioning properly, follow these troubleshooting steps first to try to remedy the situation yourself:

1. Attach all connections firmly and securely.
2. Make sure the cigarette lighter/auxiliary power socket is clean and free of corrosion.
3. If you have installed Xpress^{EZ} in a vehicle and the Xpress^{EZ} does not power on, check the 12V adapter fuse by unscrewing the ribbed end of the cigarette lighter adapter. If required, replace with a 1-amp fuse only. If the 12V adapter does not have a removable end-cap, it has an internal fuse that resets itself after it is left unplugged for a period of time.

If you see this on the display:	You should:
No Signal	Something is blocking the XM signal. Move your XM antenna away from the obstructed area (e.g., an underground garage). Make sure the XM antenna is mounted outside of the vehicle.
Antenna	Be sure that the antenna cable is fully inserted on the connector. Make sure the cable is not bent or broken. Turn Xpress ^{EZ} off, then on, to reset this message.
Off Air	The channel you've selected is not currently broadcasting. Tune to another channel.
Loading	Your Xpress ^{EZ} is acquiring audio or program information from the XM signal. This message should disappear in a few seconds in good signal conditions.
Updating	XM is updating your Xpress ^{EZ} with the latest encryption code. Simply wait a few seconds until the update is done. – OR – You may be attempting to tune to a channel that is blocked or unavailable.
--- (no artist or title)	No program information, such as artist name, song title, or channel exists.

If this happens:	You should:
Xpress ^{EZ} shuts off unexpectedly.	Check whether you have your "Auto Off" function turned on. Check to be sure all of the cables are connected properly.
You do not receive all the XM channels you have subscribed to.	Your Xpress ^{EZ} may not be activated. Contact XM Satellite Radio. See Page 19.
No audio.	Check all connections between your Xpress ^{EZ} and your stereo system.
No song title or artist name is displayed.	Nothing is wrong with your Xpress ^{EZ} . That information may be in the process of being updated. Some channels, such as news and sports, may not have such information.
No audio when listening to Xpress ^{EZ} through an FM radio.	Check that your Xpress ^{EZ} and your radio are tuned to the same FM frequency.
Audio fades or has static when listening.	You might be hearing interference from another FM station. First check all cables for a proper connection on your Xpress ^{EZ} car cradle. If the problem persists, set your Xpress ^{EZ} and your radio to a different FM frequency.
Audio sounds too soft.	Raise the FM audio level until the sound quality improves.
XM Instant Traffic and Weather channels sound different than other channels.	Nothing is wrong with your Xpress ^{EZ} . These channels use a different audio technology than the other XM channels.

Specifications

Xpress ^{EZ}	
Dimensions	101 mm (W) x 51 mm (H) x 16 mm (D) 4 in (W) x 2 in (H) x 0.6 in (D)
Weight	77 g 2.7 oz
Audio output	3.5 mm mini-stereo jack
Antenna connector (home and car cradle)	RF SMB
External power	Voltage: 5 V DC Current: 2000 mA Polarity: -  +
Model Numbers	
Xpress ^{EZ}	XMCK-5P
Xpress home kit	XMH-10A
Xpress car kit	XMC-10A

Product Registration

1. Register your product. We will keep the details of your purchase on file to help you refer to this information in the event of an insurance claim such as loss or theft.
2. Receive updates on the latest products and technologies.
3. Download owner's manuals, order product catalogues, research new products, and much more.



For Customer Service
Visit Our Website At
www.audiovox.com
Product Information, Photos,
FAQ's Owner's Manuals

IMPORTANT (Serial Number) The serial number of this device is located on the back of this unit. For your own security and convenience, be sure to record this number for future warranty claims.

Serial Number: _____

Patent Information

Technology. It is prohibited to, and you agree that you will not, copy, decompile, disassemble, reverse engineer, hack, manipulate, or otherwise access and/or make available any technology incorporated in receivers compatible with the XM Satellite Radio system. Furthermore, the AMBE (r) voice compression software included in this product is protected by intellectual property rights including patent rights, copyrights, and trade secrets of Digital Voice Systems, Inc. The software is licensed solely for use within this product. The music, talk, news, entertainment, data, and other content on the Services are protected by copyright and other intellectual property laws and all ownership rights remain with the respective content and data service providers. You are prohibited from any export of the content and/or data (or derivative thereof) except in compliance with applicable export laws, rules and regulations. The user of this or any other software contained in an XM Radio is explicitly prohibited from attempting to copy, decompile, reverse engineer, hack, manipulate or disassemble the object code, or in any other way convert the object code into human-readable form.

FCC Statement

Please note that the power cable that has been supplied with your device is supplied with permanently attached ferrite beads. It is the responsibility of the user to use the power cable with the ferrite beads.

The user is cautioned that changes or modifications not expressly approved by XM Satellite Radio Inc. can void the user's authority to operate this device.

This device complies with Part 15 of the FCC Rules. Operation is subject to the following two conditions:

- (1) This device may not cause harmful interference.
- (2) This device must accept any interference received, including interference that may cause undesired operation.

This equipment has been tested and found to comply with the limits for a Class B digital device, pursuant to Part 15 of the FCC Rules. These limits are designed to provide reasonable protection against harmful interference in a residential installation.

This equipment generates, uses, and can radiate radio frequency energy and, if not installed and used in accordance with the installation instructions, may cause harmful interference to radio communications. However, there is no guarantee that interference will not occur in a particular installation. If this equipment does cause harmful interference to radio or television reception, which can be determined by turning the equipment off and on, the user is encouraged to try to correct the interference by one or more of the following measures:

- Reorient or relocate the receiving antenna of the affected receiver.
- Increase the separation between the XM equipment and the affected receiver.
- Connect the XM equipment into an outlet on a circuit different from that to which the affected receiver is connected.
- Consult the dealer or an experienced radio/TV technician for help.



Warning: The FCC and FAA have not certified this Satellite Radio Receiver for use in any aircraft (neither portable nor permanent installation). Therefore, XM Satellite Radio cannot support this type of application or installation

5

Warranty



12 Month Limited Warranty

AUDIOVOX ELECTRONICS CORPORATION (the Company) warrants to the original retail purchaser of this product that should this product or any part thereof, under normal use and conditions, be proven defective in material or workmanship within 12 months from the date of original purchase, such defect(s) will be repaired or replaced with new or reconditioned product (at the Company's option) without charge for parts and repair labor.

To obtain repair or replacement within the terms of this Warranty, the product is to be delivered with proof of warranty coverage (e.g. dated bill of sale), specification of defect(s), transportation prepaid, to an approved warranty station or the Company at the address shown on the next page.

This Warranty does not extend to the elimination of externally generated static or noise, to costs incurred for installation, removal or reinstallation of the product, damage to speakers, accessories, or vehicle and home electrical systems, malfunction of satellite transmissions, repeater signal or receiver unit.

This Warranty does not apply to any product or part thereof which, in the opinion of the Company, has suffered or been damaged through alteration, improper installation, mishandling, misuse, neglect, accident, or by removal or defacement of the factory serial number/bar code label(s).

THE EXTENT OF THE COMPANY'S LIABILITY UNDER THIS WARRANTY IS LIMITED TO THE REPAIR OR REPLACEMENT PROVIDED ABOVE AND, IN NO EVENT, SHALL THE COMPANY'S LIABILITY EXCEED THE PURCHASE PRICE PAID BY PURCHASER FOR THE PRODUCT.

This Warranty is in lieu of all other express warranties or liabilities. ANY IMPLIED WARRANTIES, INCLUDING ANY IMPLIED WARRANTY OF MERCHANTABILITY, SHALL BE LIMITED TO THE DURATION OF THIS WRITTEN WARRANTY. ANY ACTION FOR BREACH OF ANY WARRANTY HEREUNDER INCLUDING ANY IMPLIED WARRANTY OF MERCHANTABILITY MUST BE BROUGHT WITHIN A PERIOD OF 48 MONTHS FROM DATE OF ORIGINAL PURCHASE. IN NO CASE SHALL THE COMPANY BE LIABLE FOR ANY CONSEQUENTIAL OR INCIDENTAL DAMAGES FOR BREACH OF THIS OR ANY OTHER WARRANTY, EXPRESS OR IMPLIED, WHATSOEVER. No person or representative is authorized to assume for the Company any liability other than expressed herein in connection with the sale of this product.

Some states do not allow limitations on how long an implied warranty lasts or the exclusion or limitation of incidental or consequential damage so the above limitations or exclusions may not apply to you. This Warranty gives you specific legal rights and you may also have other rights which vary from state to state.

U.S.A. : AUDIOVOX ELECTRONICS CORPORATION, 150 MARCUS BLVD., HAUPPAUGE, NEW YORK 11788 1-800-645-4994

CANADA : CALL 1-800-645-4994 FOR LOCATION OF WARRANTY STATION SERVING YOUR AREA

Notes:



Audiovox Electronics Corporation
150 Marcus Blvd.
Hauppauge, New York 11788
U.S.A.
1 800 645 4994

www.audiovox.com

XM name and related logos are registered trademarks of XM Satellite Radio Inc.
All other trademarks are property of their respective owners.

♻️ Printed on Recycled Paper
©2007 Audiovox Electronics Corporation. All rights reserved.

XMCK-5P

Download from Www.Somanuals.com. All Manuals Search And Download.

Free Manuals Download Website

<http://myh66.com>

<http://usermanuals.us>

<http://www.somanuals.com>

<http://www.4manuals.cc>

<http://www.manual-lib.com>

<http://www.404manual.com>

<http://www.luxmanual.com>

<http://aubethermostatmanual.com>

Golf course search by state

<http://golfingnear.com>

Email search by domain

<http://emailbydomain.com>

Auto manuals search

<http://auto.somanuals.com>

TV manuals search

<http://tv.somanuals.com>