

### What's in the Box?

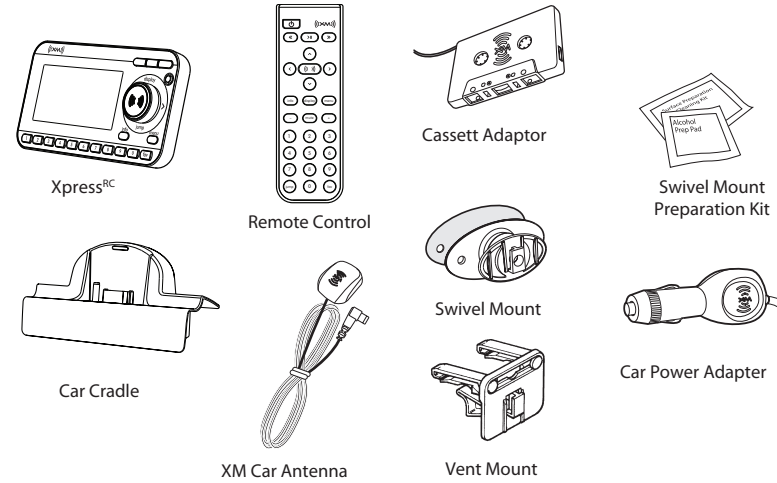

**WARNINGS:**

- When using this product it is always important to keep your eyes on the road and hands on the wheel. Not doing so could result in personal injury, death, and/or damage to your Xpress<sup>RC</sup> Receiver, accessories, and/or to your vehicle or other property.
- Xpress<sup>RC</sup> should be placed in your vehicle where it will not interfere with the function of safety features, e.g., deployment of airbags. Failure to correctly place Xpress may result in injury to you or others if the unit becomes detached during an accident and/or obstructs the deployment of an airbag.

### Xpress<sup>RC</sup> functions

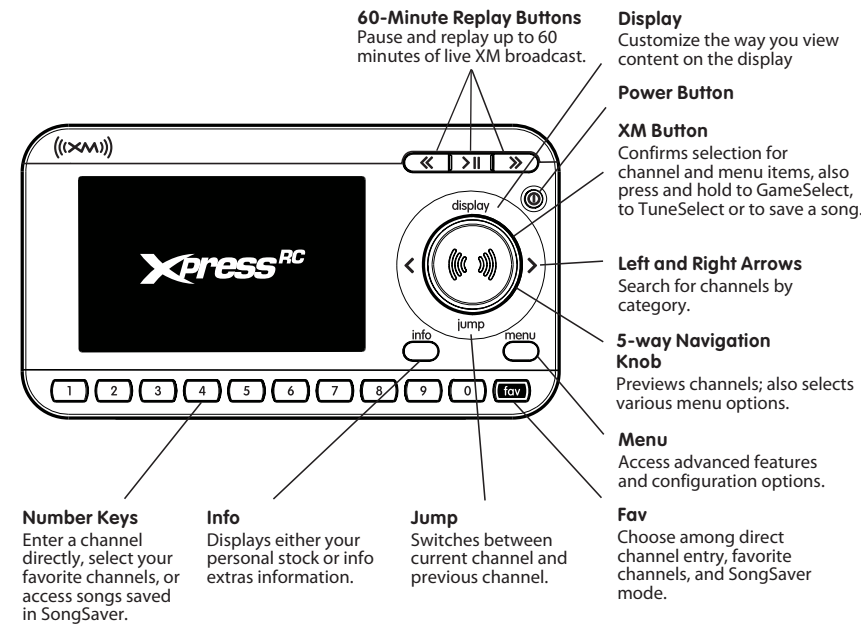

### 5-way navigation knob

- Turn the knob to scroll through a list.
- Press the center of the **XM button** to make a selection.
- Press the edge of the **XM button** to select **display, jump, < or >**.

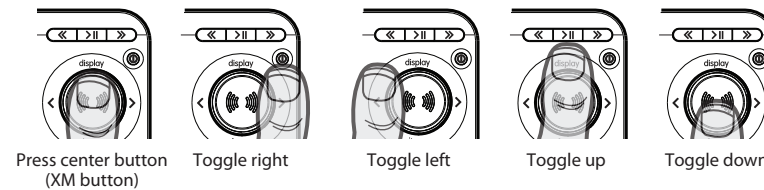

### Vehicle Installation

#### Step 1: Mount the XM Antenna

- Choose the best location for your XM antenna considering your own personal situation. Pay particular attention to any accessories that you may have like luggage racks and how frequently you may use them.

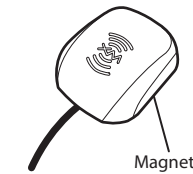

The XM antenna contains a strong magnet which will stick to any metal parts of your vehicle.

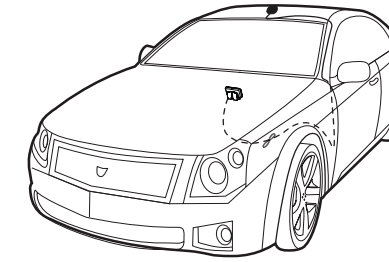

If you placed the XM antenna on the front of the vehicle, route the cable across the top of the windshield. Gently pry up the rubber weather seal and tuck the cable underneath. Follow the weather seal down to the door jam. Tuck the cable into the door jam and up to the dash or under the carpet to the car cradle as shown.

If you placed the XM antenna on the rear of the vehicle, route the cable under the weather seal of the rear window. Route it into the trunk and through any existing wire passages or cargo passages to the rear passenger compartment. Tuck the cable under the door jam trim or under the carpet to the radio as shown.

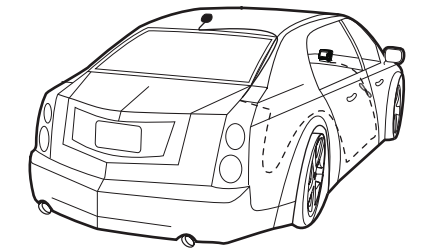

**TIP!** Always be careful to include enough slack in your cable to accommodate open doors or trunk lids. Use things typically found around the home, like electrical tape, to secure cables in areas so that hinges do not pinch the cable with the door. Hide any excess cable in the trim.

### Step 2: Install the vent or swivel mount

You can use either the vent mount or the swivel mount for your Xpress<sup>RC</sup> depending on your particular situation.

#### Installing the vent mount

- Locate a vent with horizontal slats sturdy enough to hold your XM cradle and radio.
- Adjust the clamps to fit your vent.
- Snap the mount onto the vent.

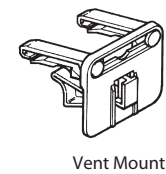

To remove, push the mount into the vent, then lift up.

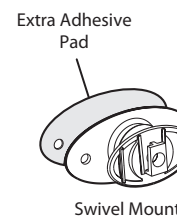
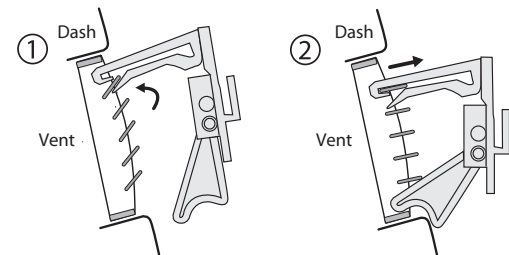

### Installing the swivel mount

**CAUTION:** The adhesive used with the swivel mount may make it difficult to remove. Do not install this mount on leather surfaces and make sure the air temperature is at least 60°F (15°C).

- Locate a flat surface for the mount. Make sure there is ample room for the XM cradle and radio when installed.
- Clean the surface with the preparation kit and let it dry thoroughly.
- Peel off the adhesive liner. Position, press, and hold the swivel mount in place for 30 seconds.
- IMPORTANT:** Let the adhesive cure for 24 hours before attaching the XM cradle and radio to the mount.
- Turn the swivel to accommodate the XM cradle and radio. Adjust the tension via the center screw.

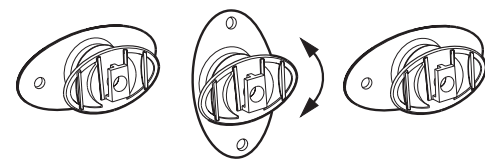

You can adjust this screw to adjust the tension of the mount with a screwdriver.

To remove, carefully lift the adhesive pad with your fingers or a spoon. Warming the pad with a hair dryer for several minutes will help soften the adhesive.

You can reinstall the swivel mount using the extra adhesive pad.

### Step 3: Connect your Xpress<sup>RC</sup>

- Plug the antenna into ANT IN on the cradle.
- Plug the power adapter into DC IN on the cradle.
- Plug the audio adapter into AUDIO OUT on the cradle.
  - Use the Cassette Adapter if your vehicle has a built-in cassette player.
  - Use a mini audio cable (sold separately) if your vehicle has an audio input jack.
- Insert the cradle into the mount.
- Insert your Xpress<sup>RC</sup> into the cradle.

**NOTE:** If your car does not contain a cassette player or an audio input, you will need to use either the XM SureConnect (sold separately) or the FM Direct adapter (sold separately).

**XM SureConnect** (sold separately): You can listen to your Xpress<sup>RC</sup> through your car stereo by using Xpress<sup>RC</sup>'s built-in FM modulator and the XM SureConnect. Simply find an unused FM frequency on the stereo and set your Xpress<sup>RC</sup> to transmit on that same frequency. Refer to Set the FM frequency page in your user guide for more information.

**FM Direct Adapter** (sold separately): This option directly connects the Xpress<sup>RC</sup> to your car's audio system and antenna. A professional installation is recommended if you choose to use this method.

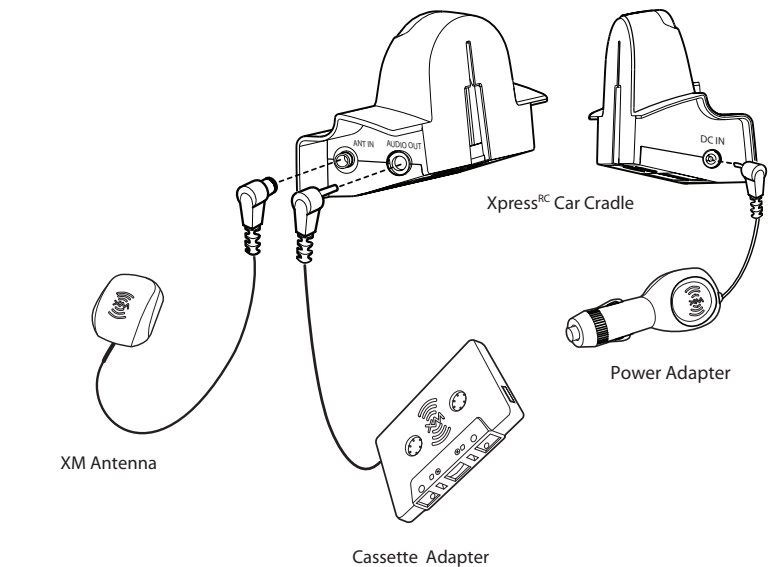

### Step 4: Turning on your Xpress<sup>RC</sup>.

- 1 Turn on your car radio.
- 2 Insert the cassette adapter.

**NOTE:** If you are using the XM SureConnect or the FM Direct adapter, refer to **Turn the FM modulator on/off** on page 50 for more information.

- 3 Turn on your Xpress<sup>RC</sup>.

**NOTE:** You may experience a brief delay while your Xpress<sup>RC</sup> powers up. If you press the power button during this time, you will see a "Please Wait" message.

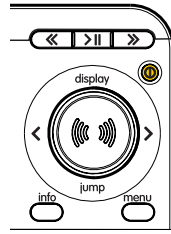

### Activation

Before you can listen to any of XM's great channels, you must first activate your Xpress<sup>RC</sup>.

- 1 Make sure your Xpress<sup>RC</sup> is properly installed and receiving the XM signal so that you can hear the audio on channel 1.
- 2 Make a note of your XM Radio ID. You can find it:
  - On XM channel 0
  - On the rear package label
  - On the label on the back of your Xpress<sup>RC</sup>

**NOTE:** The XM Radio ID does not use the letters I, O, S, or F.

- 3 Activate your service:
  - Browse to <http://activate.xmradio.com> and follow the instructions.
  - OR**
  - Call 1 800 XM RADIO (1-800-967-2346).
- 4 When your service is activated, your Xpress<sup>RC</sup> will receive all channels. This usually takes 10 to 15 minutes, but may take up to an hour. Your radio must remain on until activated.

### Using your Xpress<sup>RC</sup>

#### Listening to XM

##### Enter a channel

- 1 Turn the knob to scroll through the list of channels.
- 2 You'll see the channel logo and current artist. In a few seconds, the current song title appears.

**TIP!** You can change the display mode to show both the current channel and all channels. Refer to Changing the display in your user guide.



- 3 Press the **XM button** to select a channel.

**TIP!** You can configure Xpress<sup>RC</sup> to automatically tune to the channel you scroll to. Refer to page 32 for instructions on how to eliminate the need to enter your selection.

#### View a category

With so many channels to choose from, XM Satellite Radio has organized them into categories to make it easier for you to find the ones that suit your taste.

- 1 To view a category, press **<** or **>**.
- 2 Scroll through the category to find the channel you want.
- 3 Press the **XM button**.

**TIP!** To briefly listen to each channel in the category, select Scan, then press the **XM button**.



### Set your favorite channel

You can assign up to 10 of your favorite channels to the number buttons so you can quickly access them.

#### To assign a favorite channel to a button:

- 1 Tune to the desired channel.
- 2 Be sure you are in Favorite Channels mode. Press **fav** until Favorite Channels appears in the title bar.
- 3 Press and hold the number button you want to use for that channel.



#### To listen to a favorite channel:

- 1 Be sure you are in Favorite Channels mode. Press **fav** until Favorite Channels appears in the title bar.
- 2 Press the number button where the desired channel is programmed.

**TIP!** To see your list of Favorite Channels, press **<** or **>**. Select a favorite and press the **XM button** to listen to that channel.



### Change the display mode

You can view multiple channels on the display to see what else is playing.

Choose from:

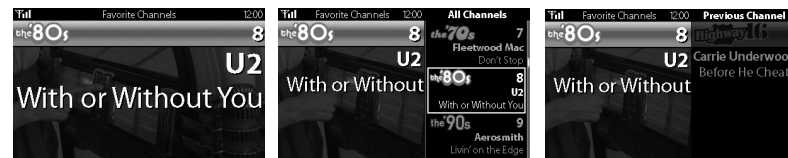

single current channel      split screen with channel list      split screen with previous

To change the mode, press **display**.

**TIP!** When in split screen with the channel list, you can scroll through the list of channels, just like when it appears on the full screen. Press **<** or **>** to change categories. Press the **XM button** to select a channel.

**TIP!** Press jump to change to the previous channel.

### FCC Statement

Please note that the power cable that has been supplied with your device is supplied with permanently attached ferrite beads. It is the responsibility of the user to use the power cable with the ferrite beads.

The user is cautioned that changes or modifications not expressly approved by XM Satellite Radio Inc. can void the user's authority to operate this device. This device complies with Part 15 of the FCC Rules. Operation is subject to the following two conditions:

- This device may not cause harmful interference.
- This device must accept any interference received, including interference that may cause undesired operation.

This equipment has been tested and found to comply with the limits for a Class B digital device, pursuant to Part 15 of the FCC Rules. These limits are designed to provide reasonable protection against harmful interference in a residential installation.

This equipment generates, uses, and can radiate radio frequency energy and, if not installed and used in accordance with the installation instructions, may cause harmful interference to radio communications. However, there is no guarantee that interference will not occur in a particular installation. If this equipment does cause harmful interference to radio or television reception, which can be determined by turning the equipment off and on, the user is encouraged to try to correct the interference by one or more of the following measures:

- Reorient or relocate the receiving antenna of the affected receiver.
- Increase the separation between the XM equipment and the affected receiver.
- Connect the XM equipment into an outlet on a circuit different from that to which the affected receiver is connected.
- Consult the dealer or an experienced radio/TV technician for help.

**WARNING!** The FCC and FAA have not certified this Satellite Radio Receiver for use in any aircraft (neither portable nor permanent installation). Therefore, XM Satellite Radio cannot support this type of application or installation.



DP55-07-E-074  
© 2007 Delphi Corporation. All rights reserved.

Printed on Recycled Paper  
XM name and related logos are registered trademarks of XM Satellite Radio Inc. All other trademarks are the property of their respective owners.

www.delphi.com  
1.877.GO.DELPHI  
Troy, Michigan 48098-5090 U.S.A.  
Delphi Corporation

SA10316  
DELPHI

## Free Manuals Download Website

<http://myh66.com>

<http://usermanuals.us>

<http://www.somanuals.com>

<http://www.4manuals.cc>

<http://www.manual-lib.com>

<http://www.404manual.com>

<http://www.luxmanual.com>

<http://aubethermostatmanual.com>

Golf course search by state

<http://golfingnear.com>

Email search by domain

<http://emailbydomain.com>

Auto manuals search

<http://auto.somanuals.com>

TV manuals search

<http://tv.somanuals.com>