

WARNING

- When replacing the battery, be careful of any sharp edges that could cut you or the wire
- Only use the supplied AC Adaptor to charge the light. Charging the light with a substitute AC Adaptor may cause damage to the light
- Do not pull or cut any wire
- Do not disassemble the unit
- Do not immerse components in liquid



Ni-MH battery must be recycled or disposed of properly.

CARE AND MAINTENANCE :

1. Store the light indoors when not in use.
2. Clean the unit regularly with a soft damp cloth. Do not use abrasives or solvents.
3. Do not over charge the batteries.
4. Do not immerse the light in water.

Please contact one of our Product Specialists for assembly assistance or questions at **1-800-537-8484** or email **ps@frontgate.com**. Specialists are available weekdays 8:00 a.m. to 8:00 p.m. EST or Saturday 9:30 a.m. to 6:00 p.m.

FRONTGATE®

OUTFITTING AMERICA'S FINEST HOMES®

20335 – Avalon Rechargeable Umbrella Light

Part List	Quantity
Umbrella Light	1
Clamp Collar	1
AC Adaptor	1

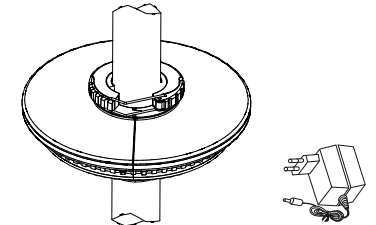

IMPORTANT

The umbrella light is weather resistant but do not immerse the unit in water.

The Umbrella Light contains a rechargeable Ni-MH battery. This rechargeable battery is shipped without charge. **Please pre-charge them for 12 hours prior to first use, to ensure full charge!**

When the Ni-MH battery life is exhausted, the battery must be recycled or disposed of properly. For additional information regarding disposal, contact your local solid waste authority.
DO NOT DISPOSE OF BATTERY IN FIRE.

Using the umbrella light without sufficient charge will damage the internal battery.

OPERATION:

1) INSTALL THE LIGHT

1. Attach the collar clamp onto the umbrella pole or any pole desired for the umbrella light at eye level.

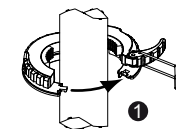

2. Clip the latch in the appropriate notch.

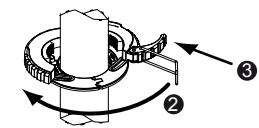

3. Close the clamp locking the clamp collar onto the pole.

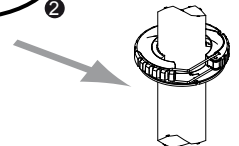

4. Press the "Open" button on the side of the umbrella light to open the umbrella light.

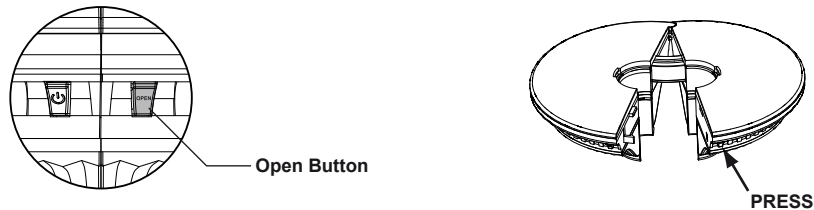

5. Close the umbrella light beneath the collar clamp.

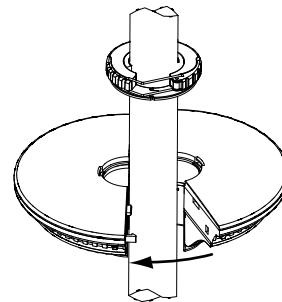

6. Move the umbrella light up to the collar clamp. Snap in the umbrella light by aligning the two tabs of the collar clamp with the notches of light, then push up. Unlatch the collar and slide light to desired height and close latch.

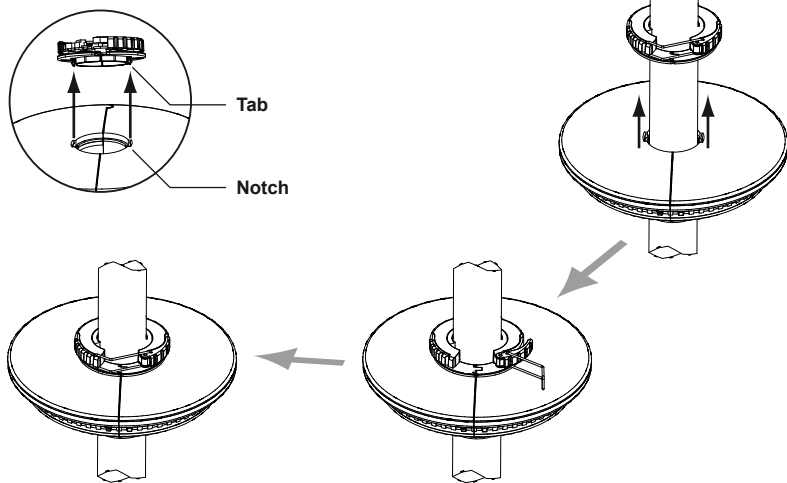

2

2) RELEASE THE LIGHT

- press the "Open" button on the side of the umbrella light to open the umbrella light
- remove the umbrella light from the pole
- pull the plastic clip to open and release the collar clamp

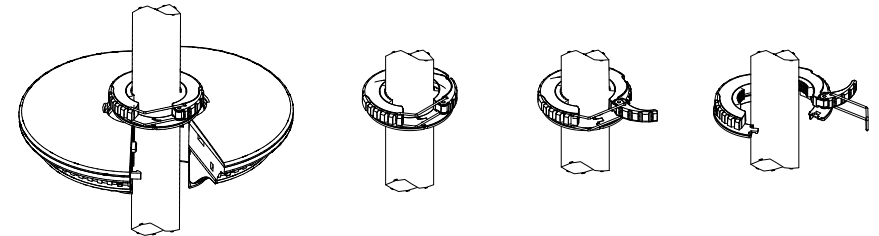

3) INITIAL CHARGE

- plug in the adaptor to charge the battery 12 hours before first use
- repeat this procedure every three (3) months to fully recharge the battery
- the umbrella light can be charged if the light is ON or OFF

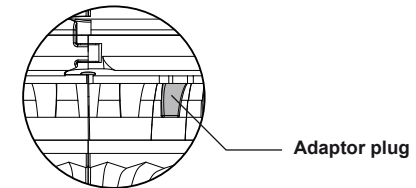

4) DAILY CHARGE

- plug in the adaptor to charge the battery
- red light illuminates during charging and the light turns to green when the battery is fully charged

5) To turn ON:

- press ON/OFF button on the side of the umbrella light

6) To turn OFF:

- press ON/OFF button on the side of the umbrella light
- for extended periods of non-use (storage), turn the power switch to OFF position
- never store unit with power switch in the ON position. This will damage the battery and it will not recharge

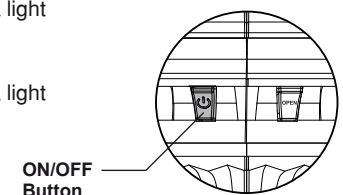

** Only use the supplied AC Adaptor to charge the light. Charging the light with a substitute AC Adaptor may cause damage to the light

3

Free Manuals Download Website

<http://myh66.com>

<http://usermanuals.us>

<http://www.somanuals.com>

<http://www.4manuals.cc>

<http://www.manual-lib.com>

<http://www.404manual.com>

<http://www.luxmanual.com>

<http://aubethermostatmanual.com>

Golf course search by state

<http://golfingnear.com>

Email search by domain

<http://emailbydomain.com>

Auto manuals search

<http://auto.somanuals.com>

TV manuals search

<http://tv.somanuals.com>