

MM323 | Cup Holder Mount for Magellan®, Mio®, and Navman® GPS Devices



Package Contents:

- (1) CM033-2 - Cup holder pedestal mount
- (1) APMM300 - Dual-T to Mio Moov 300 pattern adapter plate

Compatible with:

- Magellan Maestro: 3100, 3140, 3200, 3210, 3220, 3225, 3250, 4000, 4010, 4040, 4050, 4210, 4215, 4200, 4220, 4245, 4250, 4350, 4370, 4700, 5310, and 5340
- Magellan RoadMate: 1200, 1210, 1212, 1215, 1220, 1230, 1340, 1400, 1412, 1430, 1440, 1470, 1475T, 2000, 2200T, 2250T, 300, 3000T, 3050T, 360, 500, 500 Plus, 6000T, 700, 760, 800, and 860T
- Magellan Triton: 1500, 200, 2000, 300, 400, and 500
- Magellan Crossover: GPS 2500T
- Mio Moov: 300, 301, 310, 330, 330 Europe, 360, 370 Europe, 380, 500, and Knight Rider Ed.
- Navman: S50, S50 3D, S70, S90i



Do not place mount in or near an air bag deployment zone or where it will obstruct view of the road.

Cup Holder Mount Installation

- Step 1. Connect the post (A) to the cup holder base (B) by aligning the groove on the base to the ridge inside the bottom of the post.

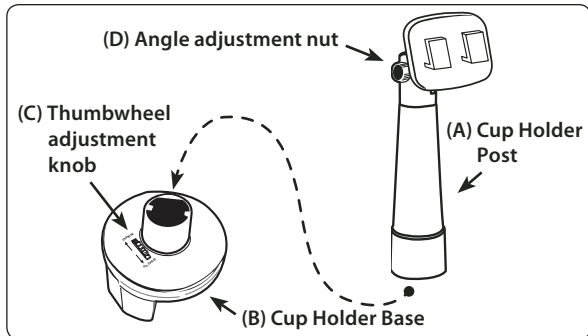

- Step 2. Place the universal cup holder mount into the designated cup holder in the vehicle. Adjust the thumbwheel adjuster (C) to expand or close the cup holder prongs to fit in the cup holder.

- Step 3. For oversize cup holder openings or the adjustable "pop out" cup holders use the optional self-adhesive side support pads (E). Install the pads by removing the adhesive backing and placing it on the flat surface side of the cup holder support leg.

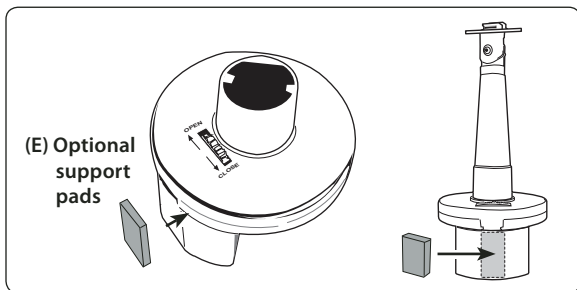

Connect Power Cord to Adapter Plate and Device Attachment

- Step 1. Insert the power cord (not included, sold separately) into the grooved slot in the bottom of the adapter plate.

All brand names and product names are trademarks or registered trademarks of their respective owners.



Safety Precautions

Do not install Arkon products over an air bag cover or within the air bag deployment zone. Arkon Resources, Inc. assumes no responsibility of liability for injury or death as a result of car crashes and/or air bag deployment.

Arkon is not responsible for any damages caused to your car, your device, or yourself due to the installation or use of this pedestal mount.

...continued from previous column

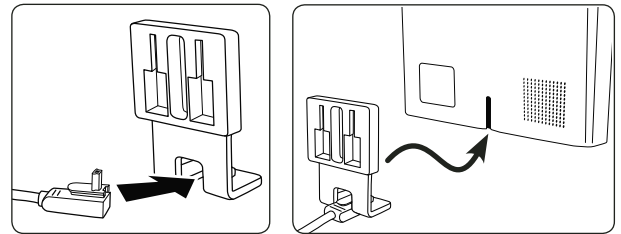

- Step 2. Insert the adapter plate with power cord into the vertical groove pattern on the back of the GPS device (not included, sold separately.)

Connect GPS Device to Cup Holder Mount

- Step 1. Attach the device to the cup holder mount by inserting the dual T-Tabs on the pedestal head (F) into the T-slots on the back of the adapter plate (G).

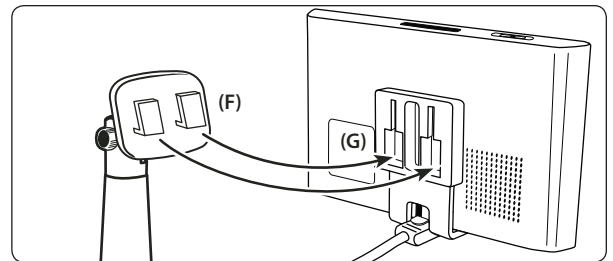

Dual-T Device Attachment

- Step 1. If your Magellan device has dual-T slots on the back, attach the GPS unit to the cup holder mount by connecting the dual T-slots (H) to the dual T-tabs of the mount head (I).

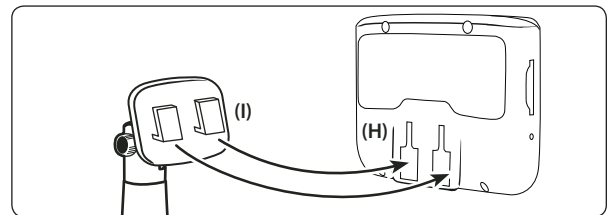

ARKON
RESOURCES INC.

The Mobile Mounting Specialists™

Consumer Hotline:

USA (800) 841-0884

INT'L (626) 254-9005

Monday - Friday 9 am - 5 pm, PST

www.arkon.com

Arcadia, CA 91006 USA

Designed in USA | Made in Taiwan

© Copyright 2008 Arkon Resources, Inc.

Free Manuals Download Website

<http://myh66.com>

<http://usermanuals.us>

<http://www.somanuals.com>

<http://www.4manuals.cc>

<http://www.manual-lib.com>

<http://www.404manual.com>

<http://www.luxmanual.com>

<http://aubethermostatmanual.com>

Golf course search by state

<http://golfingnear.com>

Email search by domain

<http://emailbydomain.com>

Auto manuals search

<http://auto.somanuals.com>

TV manuals search

<http://tv.somanuals.com>