

HDMI-VS-4X1 Switch

User's Guide

© 2008 **Avenview™** Inc. All rights reserved.

The contents of this document are provided in connection with Avenview Inc. ("Avenview") products. Avenview makes no representations or warranties with respect to the accuracy or completeness of the contents of this publication and reserves the right to make changes to specifications and product descriptions at any time without notice. No license, whether express, implied, or otherwise, to any intellectual property rights is granted by this publication. Except as set forth in Avenview Standard Terms and Conditions of Sale, Avenview assumes no liability whatsoever, and disclaims any express or implied warranty, relating to its products including, but not limited to, the implied warranty of merchantability, fitness for a particular purpose, or infringement of any intellectual property right.

Reproduction of this manual, or parts thereof, in any form, without the express written permission of Avenview Inc. is strictly prohibited.

Disclaimer

While every precaution has been taken in the preparation of this document, Avenview Inc. assumes no liability with respect to the operation or use of Avenview hardware, software or other products and documentation described herein, for any act or omission of Avenview concerning such products or this documentation, for any interruption of service, loss or interruption of business, loss of anticipatory profits, or for punitive, incidental or consequential damages in connection with the furnishing, performance, or use of the Avenview hardware, software, or other products and documentation provided herein.

Avenview Inc. reserves the right to make changes without further notice to a product or system described herein to improve reliability, function or design. With respect to Avenview products which this document relates, Avenview disclaims all express or implied warranties regarding such products, including but not limited to, the implied warranties of merchantability, fitness for a particular purpose, and non-infringement.

Table of Contents

Getting Started.....	3
Key Features.....	3
Panel Description	4
HDMI-VS-4X1 Switch	4
Installation.....	5
Operation	5
Specifications	7

Getting Started

Avenview HDMI-VS-4X1 switch displays HDMI signal from 4 different sources and displays to 1 HDMI output with just a click of a button on a IR remote control. This device is especially designed for home theatres, conference rooms and digital signage. It is an ideal solution to connect DVD player, game consoles, satellite receivers, digital boxes, PCs to TV or digital receivers that have only one HDMI input.

Key Features

- Auto cycle scanning function with interval adjustment
- Three switch modes:
 - Automatic Switching
 - Manual Switching
 - Remote Control
- HDMI 1.3 and HDCP Compliant
- Supports full 1080p Resolution
- IR Remote Control
- Optional IR Receiver extension can be added to the system for extended remote control
- Built-in equalizer to fine tune picture quality

Panel Description

HDMI-VS-4X1 Switch

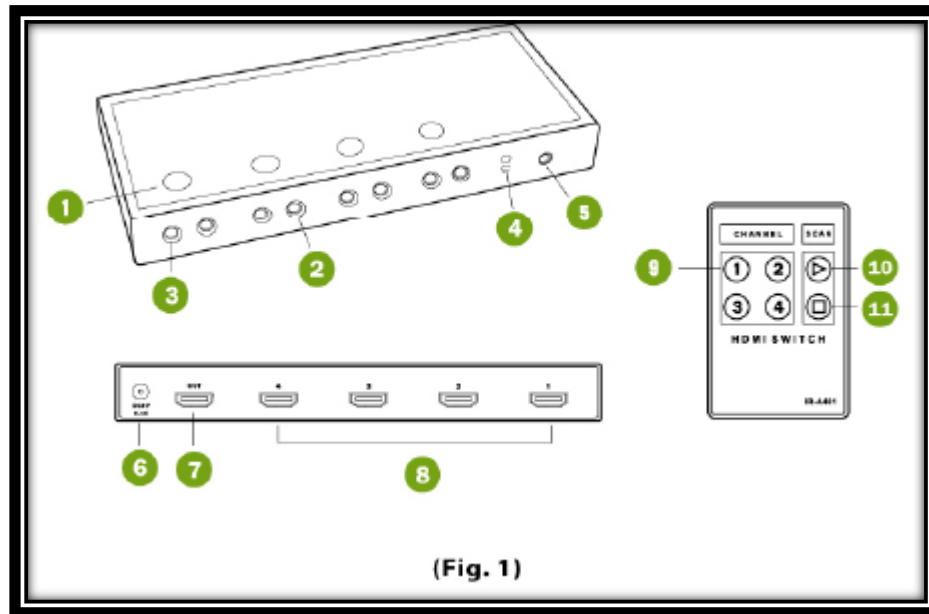

(Fig. 1)

1. Manual Switch Buton
2. Switching Indicator – Yellow LED indicates displaying channel
3. Input Indicator – Blue LED indicates
4. IR Remote Control Receiver
5. IR Remote Control Receiver extension cable port
6. Power Adapter
7. Output to Display TV
8. 4 Input Ports from HDMI Devices
9. Channel Select Button
10. Automatic Scan Button (scan interval setting button)
11. Stop Scan Button



Installation

- **First Time Setup:** Turn off all the devices.
- **Device Connections:**
 - Connect HDMI cable from display TV or digital receiver to HDMI-VS-4X1 Switch.
 - Connect power adapter to HDMI-VS-4X1 Switch and plug it into power socket.
Power on the Switch
 - Connect HDMI-VS-4X1 Switch and HDMI sources by HDMI cable.
 - Power on display TV or digital receiver and source devices

Operation

- **Automatic Switch:** Device automatically switches to the last active source connected to HDMI-VS-4X1 Switch. When display source is unplugged from switch, device automatically switches to next available channel.
- **Manual Switch:** Simply press the manual switch button on HDMI-VS-4X1 Switch to select the source.
- **Remote Control:** Press number button on remote control to select corresponding channel.
- **Auto Scan Function:** Activate via remote control "SCAN" button. Can be set at 20, 40, 60, 80 seconds interval. Press "STOP" or manual switch button to stop scanning.

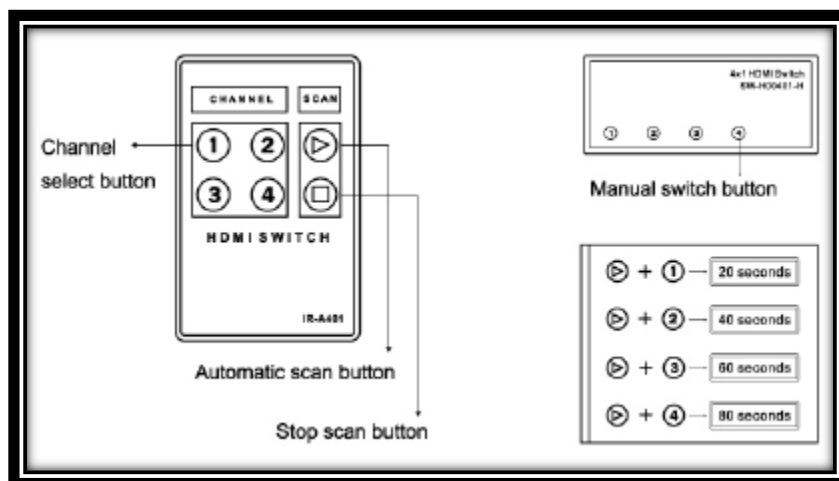

General Troubleshooting

Problem	Possible Solution
Remote Control not working	<ul style="list-style-type: none">• Check to ensure that batteries are full• Operate the device without any obstruction between HDMI-VS-4X1 Switch and the Remote Control.
Bright Dots in the Picture	<ul style="list-style-type: none">• Adjust the picture quality via built-in equalizer. Hold down the manual switch button for 2 seconds until yellow LED blinks.• Repeat the procedure until problem is solved• Check your cable
No Image	<ul style="list-style-type: none">• Ensure that the monitor cable is securely fastened to the HDMI and Monitor port.• User higher quality HDMI cable (24 gauge HDMI cable)

Specifications

Model	HDMI-VS-4X1 Switch
Description	4 to 1 HDMI Switch
Input	HDMI Female x 4
Output	HDMI Female x 1
Supported Resolution	480i, 480p, 720p, 1080i, 1080p
Cable Extension	20m
Switching Methods	Automatic, Manual Button, Remote Control
Remote Control Distance	10m
Supported Signal	HDMI 1.3, HDCP, DVI
Power Supply	DC 9V, 500mA
Dimension (LxWxH)	82 x 193 x 22 mm



Free Manuals Download Website

<http://myh66.com>

<http://usermanuals.us>

<http://www.somanuals.com>

<http://www.4manuals.cc>

<http://www.manual-lib.com>

<http://www.404manual.com>

<http://www.luxmanual.com>

<http://aubethermostatmanual.com>

Golf course search by state

<http://golfingnear.com>

Email search by domain

<http://emailbydomain.com>

Auto manuals search

<http://auto.somanuals.com>

TV manuals search

<http://tv.somanuals.com>