

Stompbox Accessories

PEDAL BOARD PB600

Pedal Board with 9 V DC Power Supply and Patch Cables

- Ultra-compact and lightweight pedal board for transporting up to 6 effects pedals, including patch cables
- Generous 1.7 A power adapter included for powering more than 12 devices*—includes 1 x 6 daisy-chain cabling
- Ultra-rigid plastic design withstands even heavy impact
- High-quality components and exceptionally rugged construction ensure long life
- Conceived and designed by BEHRINGER Germany

* Depends on the power consumption of the effects pedals, etc.



When effects are an integral part of your rig, their power adapters and patch cables can often be the most vulnerable part, and the most likely to sabotage your set if they're not pampered. Rather than tossing your pedals, power adapters and all other cabling into a duffel bag after a gig, keep them safe—and ready to rock at a moment's notice—with the PB600.

It's all about connections

This awesome pedal board makes hooking up six 2.5" x 4.5" pedals as easy as hooking up just one (of course, if you're using pedals that aren't 2.5" x 4.5", the snug foam padding can be cut to accommodate pedals of varying shapes). The PB600 includes ¼" patch cables, so you can leave your pedals connected to one another, ready to pass signal even when you're transporting them. It also comes with 1 x 6 daisy chain cabling so that when you plug in the 1.7 A power adapter, all your pedals receive power. Meanwhile, all cabling remains safe and free of strain. Failure is almost guaranteed when you're dealing with a rat's nest of loose cabling, but with the PB600, your effects chain is always safe and organized.

Connect your guitar, bass or keyboard to the single ¼" input in the upper right corner of the board. A pair of ¼" FROM EFFECTS jacks in the upper left corner allow you to connect stereo effects, and two ¼" OUTPUT TO AMP jacks send a left and right stereo signal to up to two amps.

When it's time to load out, just unplug the power supply, disconnect your guitar and amp, put the lid back on the PB600 and slide the locking latches back into place. The heavy-impact plastic casing will protect your pedals from the very worst dings, scrapes and scratches the road throws your way.



behringer.com



PEDAL BOARD PB600

Hookup Diagram

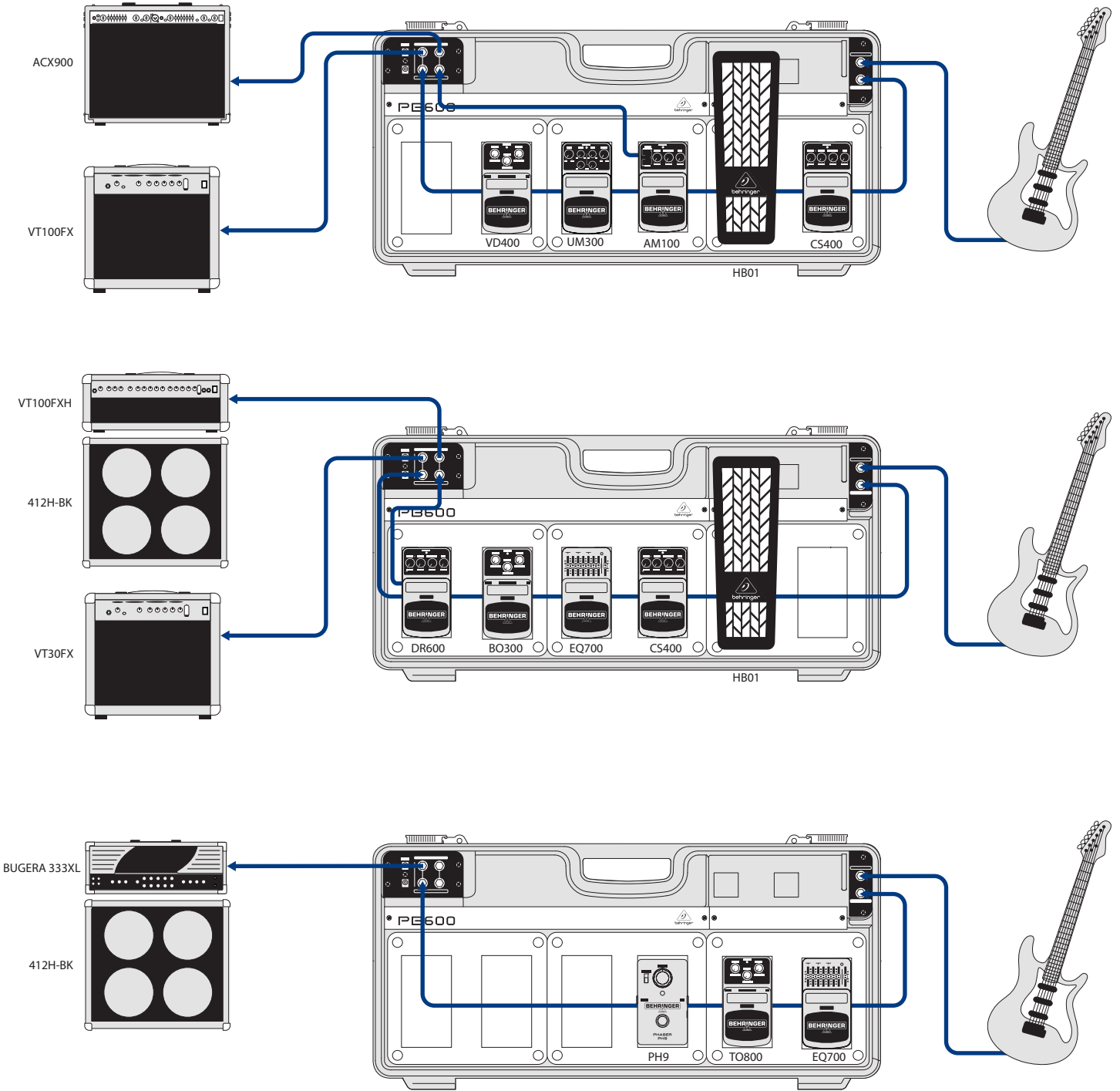

PEDAL BOARD PB600

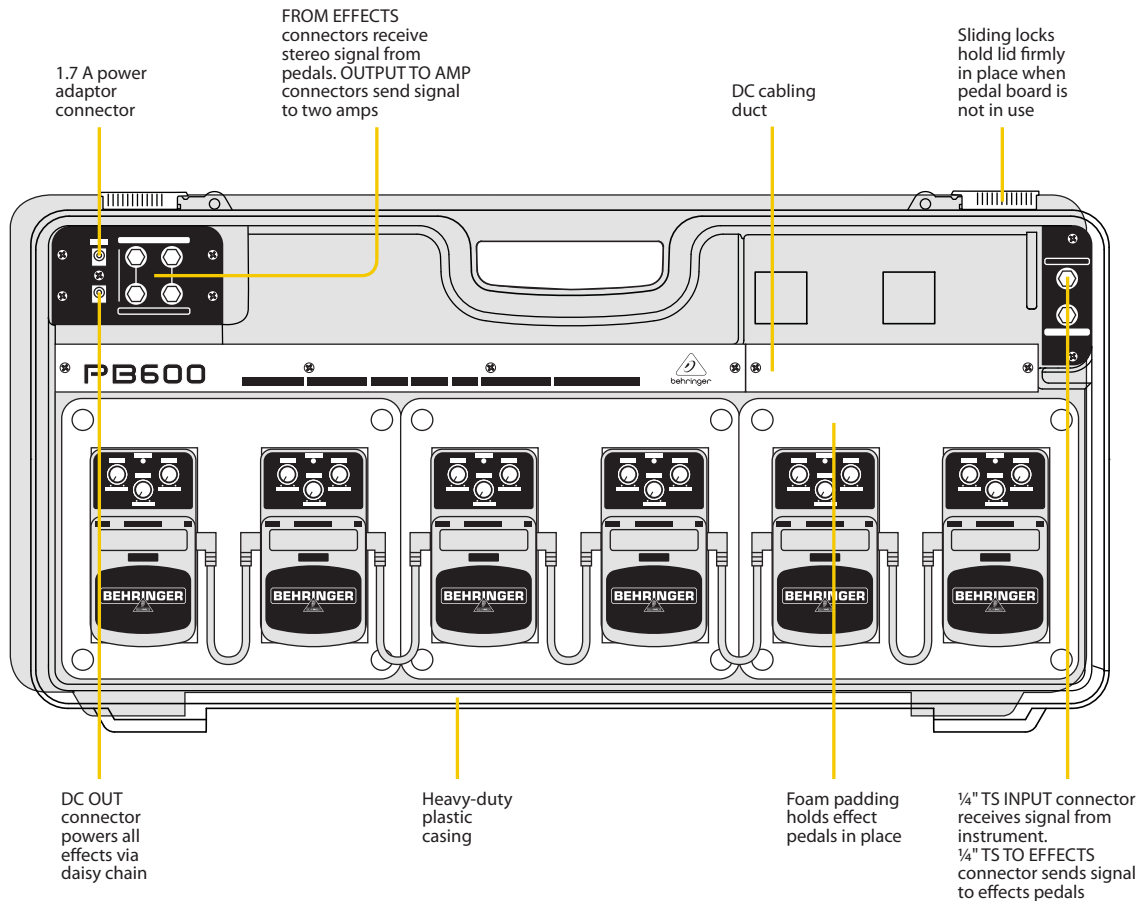

SPECIFICATIONS

Power Supply	9 V, 1.7 A switching adaptor (included)
Connectors	¼" TS, unbalanced
USA/Canada	120 V~, 60 Hz GPE182-090170-1 (HSB-UL)
Europe/Australia	230 V~, 50 Hz GPE182-090170-2 (HSB-EU)
U.K.	GPE182-090170-3 (HSB-UK)
Korea	220 V~, 60 Hz GPE182-090170-4 (HSB-SAA)

China	220 V~, 50 Hz GPE182-090170-5 (HSB-CCC)
Japan	100 V~, 50/60 Hz GPE182-090170-6 (HSB-JP)
Power connector	2 mm DC jack, center negative (with daisy-chain cable included)
Power consumption	2 mA

PHYSICAL

PB1000	
Dimensions (HxWxD)	504.3 x 663.6 x 115 mm 19 7/8 x 26 1/8 x 4 1/2"

PB600

Dimensions (HxWxD)	13 x 26 1/8 x 4 1/2" 329 x 663.6 x 115 mm
---------------------------	--

PB1000

Weight	approx. 11.8 lbs / 5.3 kg including PSU & daisy chain
PB600	approx. 8.4 lbs / 3.8 kg including PSU & daisy chain

Please note these specifications are preliminary and conceptual in nature, and as such are subject to change as product development progresses. This information is supplied for market research purposes only and is not to be made public in any manner. This document is solely the property of THE MUSIC Group, or one of its subsidiaries, and must be surrendered upon request of the owner.

For service, support or more information contact the BEHRINGER location nearest you:

Europe Tel.: +49 2154 9206 4149
Fax: +49 2154 9206 4199

USA/Canada Tel.: +1 425 672 0816
Fax: +1 425 673 7647

Singapore Tel.: +65 6845 1800
Fax: +65 6214 0275

Australia Tel.: +61 03 9877 7170
Fax: +61 03 9877 7870

Japan Tel.: +81 3 5281 1180
Fax: +81 3 5281 1181

©2011 Red Chip Company Ltd. Technical specifications and appearance subject to change without notice. The information contained herein is correct at the time of printing. All trademarks are the property of their respective owners. BEHRINGER accepts no liability for any loss which may be suffered by any person who relies either wholly or in part upon any description, photograph or statement contained herein. 985-10000-00382

behringer.com



Free Manuals Download Website

<http://myh66.com>

<http://usermanuals.us>

<http://www.somanuals.com>

<http://www.4manuals.cc>

<http://www.manual-lib.com>

<http://www.404manual.com>

<http://www.luxmanual.com>

<http://aubethermostatmanual.com>

Golf course search by state

<http://golfingnear.com>

Email search by domain

<http://emailbydomain.com>

Auto manuals search

<http://auto.somanuals.com>

TV manuals search

<http://tv.somanuals.com>