

Vacuum Cleaner
User's Manual

BKS 2420

BEKO

Dear Customer,

We would like our product, which is manufactured in modern facilities and which has been subject to detailed quality control process, to provide you with the highest productivity.

Therefore, we would like you to read this manual thoroughly before you start using the product and we would like you to keep it as a reference.

BEKO



This product has been produced in environmentally friendly, modern facilities



Contents

1 Safety Warnings	> 2	4 Parking the Appliance	> 6
2 Technical Aspects of your machine	> 3	5 Maintenance and Cleaning	> 7-8
3 Using your machine	> 4-5	1- Removing the filthy and filled paper filter	> 7
1- Preparing the vacuum cleaner for use	> 4	2- Cleaning the exhaust filter	> 8
2- Using the telescopic pipe	> 4	3- Cleaning the engine protection filter	> 8
3- Using the accessories	> 4		
4- Operating and arranging the power	> 5		

1 Safety Warnings

- The appliance has been manufactured for domestic use and it is not suitable for commercial use or use under severe conditions.
- The appliance has been adjusted for 220-240 volts. Please check the appropriateness of the voltage value before plugging in the socket.
- Make sure that the appliance is plugged off after using it, before changing the accessories, and before cleaning and maintaining.
- Do not unplug the appliance with wet hands.
- Do not unplug the appliance by pulling from the cord.
- Do not move your appliance over its cord, you can harm its isolation.
- Be careful not to hit the cord to the appliance while winding it.
- Do not use the appliance on wet floor. Do not vacuum water or other liquids alike.
- Do not use your appliance in an upright position.
- Do not use your appliance without supplying the filters described in this manual; otherwise, you may harm the engine.
- Do not drop any objects into the open parts of your appliance.
- Do not block the air passages; check it frequently.
- While using the appliance, never hold the vacuum hose close to your eyes or ears.
- Do not attempt to clean glass or other incisory objects by using this appliance.
- Do not vacuum a burning cigarette, cigarette ash or matches using the appliance.
- Do not use your appliance to vacuum liquids such as gasoline, thinner, alcohol, kerosene etc or any corrosive liquids (acids, etc.).
- Keep your appliance away from stoves, ovens and other similar sources of heat.
- Before cleaning your appliance and its accessories, read the safety warning section of this manual.
- Do not use harmful chemicals or corrosive cleaners to clean your appliance.
- Never immerse the housing of your appliance (the part where the engine is in) in water, and prevent water from being poured on your appliance.
- The appliance should not be used by people who are physically (visual, audial) or mentally impaired, children, and those who do not have the required experience or knowledge, in the absence of the observation of a responsible person for their safety.
- Please keep an eye on children when the appliance is in use, and make sure that they do not play with it.

Attention!
Before operating your vacuum cleaner, read all the information provided in the guarantee section of your manual carefully. Once the vacuum cleaner has been operated, we accept that the user's manual was read and the guarantee conditions have been understood by the consumer.
Keep the original, or a copy of the, invoice in case it may be necessary in future for guarantee procedures. Your vacuum cleaner has been manufactured for domestic use. It has not been manufactured for professional use.

2 Technical Aspects of your machine

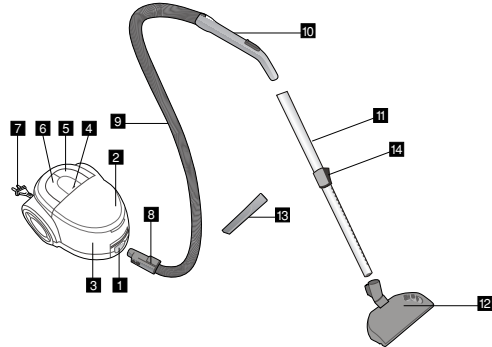

- 1 Vacuuming mouth
- 2 Spare paper filter lid
- 3 Dust lid
- 4 Light indicator
- 5 On-off button
- 6 Cord winder button
- 7 Electrical cord
- 8 Vacuuming adaptor
- 9 Hose
- 10 Pipe adaptor
- 11 Telescopic tube
- 12 Brush for carpets and hard surfaces
- 13 Narrow tool
- 14 Adjustment bolt

Net weight : 6.15 kg.
 Adapter Voltage / Frequency : 220-240V~ 50/60 Hz
 Adapter Isolation Class :
 Dimensions : \varnothing 405 x 325 x 245 mm.
 Maximum power : 2200 W max.
 Nominal power : 1700 W nominal

• All declared values on the product and on the printed leaflets are picked up after laboratory measurements performed according to related standards. These values may differ upon usage and ambient conditions.

• The power values were tested at 240 V.

3 Using your machine

1) Preparing the vacuum cleaner for use:

Press the key on the vacuuming adaptor (Picture 1), and fit the hose holding piece into the vacuuming mouth. Pull the cord out and plug it in the electric socket (Picture 2).

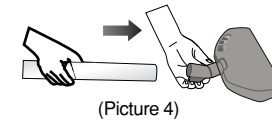
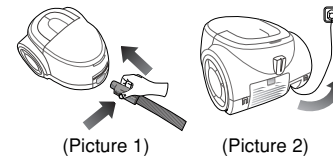

(Picture 4)

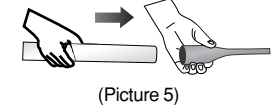

(Picture 5)

3) Using the accessories:

The narrow-mouthed end piece is used to clean places which are narrow and difficult to reach.

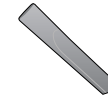

Attention!

Do not pull out longer than the red indicator on the cord.

2) Using the telescopic pipe:

The pipes are telescoped and the length can be adjustable. By pressing the adjustment bolt forward, adjust the length of the pipe for your convenience (Picture 3). When you release the adjustment bolt, the pipe will remain fixed at its place. Fix the accessory that you want to use at the end of the telescopic pipe.

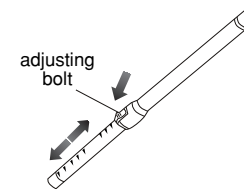

(Picture 3)

The use of the brush for carpets and hard surfaces: There is an adjusting mechanism on the left side of the brush, which indicates a positioning for carpets and for hard surfaces. This mechanism is adjusted according to the surface to be cleaned. To clean your carpets and kilims, use the brush in the normal position (the bristle-brushes in a hidden position). To clean hard surfaces such as the walls, change the adjustment positioning and do the cleaning on the bristle brushes.



Fix the accessory that you will select according to the surface you will clean at the end of the telescopic pipe (Pictures 4,5).

3 Using your machine

4) Operating:

When you press the on/off button, the engine will start operating.

Attention!

Do not press the buttons of the appliance with your foot. The defects caused by doing so are not covered within the guarantee.

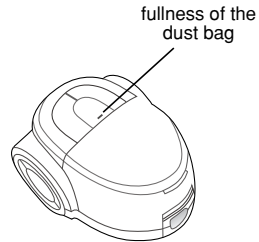

(Picture 6)

FUNCTION	HOW IT WORKS
LIGHT INDICATOR SHOWING THE FULLNESS OF THE DUST BAG	In the cases when paper filter is full while the appliance is operating at the max. power level, and/or when the engine protection filter and the sponge become dirty, the light indicator warns by lighting itself continuously (Picture 6). In this case, stop the vacuum cleaner by pressing the on/off button. Do the maintenance and cleaning. (See: Maintenance and cleaning)
	Attention! Although the paper filter may seem to be empty, as the particles from the cleaned surfaces will have clogged the pores of the paper filter, the light indicator will be on. In this case, a new paper filter should be fitted in. (See: Maintenance and cleaning)

4 Parking the Appliance

Switch off the vacuum cleaner by pressing the on/off button on the housing (Picture 7).

You can keep your vacuum cleaner by fitting the snap on the brush into its socket on the appliance (Pictures 9-10).

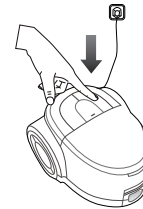

(Picture 7)

Plug off the cord, and press the cord winder key on your appliance in order to wind back the cord into its socket (Picture 8).

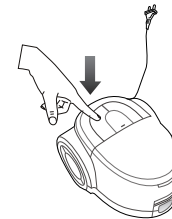

(Picture 8)



(Picture 9)

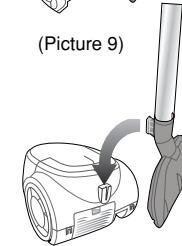

(Picture 10)

Attention!
Do not carry your appliance when it is in the parking position.

5 Maintenance and Cleaning

When the dust indicator is red, stop your vacuum cleaner and plug it off. Open the spare paper filter lid (Picture 11-12). Take out a paper filter and close the lid. Open the dust lid (Picture 13).

Attention!

While fitting in the new paper filter, make sure that the filter mouth is open (the sliding filter lock is not pulled). For maximum efficiency, use paper filters tested and approved by Arçelik only. Otherwise, as the dust holding capacity of other paper filters that you will get from the market is inadequate, failures may occur in your appliance; in this case, the defect will not be covered under the guarantee conditions.

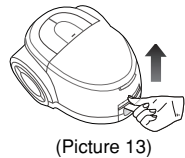
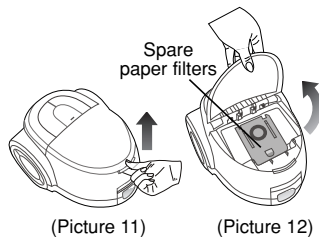

1) Removing the filthy and filled paper filter:

Close the filter mouth by pulling the sliding filter lock upwards. Remove the paper filter by pulling it out from the filter lock (Picture 14).

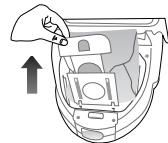

(Picture 14)

Fit the new paper filter into its place by holding it from its end (Picture 15). Place the back of the filter in its space (Picture 16).

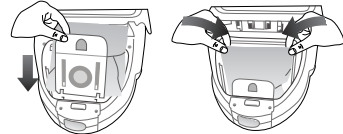

(Picture 15)

(Picture 16)

Textile Dust Bag:

If you are using a cloth dust bag, you can empty and use the bag repeatedly. If the dust bag in your appliance is made of cloth, take out the cloth bag as explained in the section titled "taking out the paper bag".

5 Maintenance and Cleaning

2) Cleaning the exhaust filter:

In every five changes of the paper filter, take the exhaust filter cassette by pressing down the opening button, and take the cassette out. Wash the sponge in it to clean (Pictures 17-18).

Attention!

Do not use the exhaust filter before ensuring that it is completely dry. Otherwise, the engine of the vacuum cleaner may be harmed. After cleaning the filter and drying it, place it in its space, applying the reverse procedure of taking it out (Pictures 19-20).

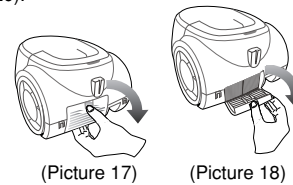

(Picture 17)

(Picture 18)

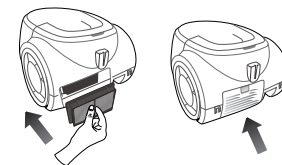

(Picture 19)

(Picture 20)

3) Cleaning the engine protection filter:

After every five uses of the paper filter, take the engine protection filter cassette out from its socket (Picture 21); then remove the engine protection filter, and wash it to clean. When it is completely dry, put it back to its place. Otherwise, your engine may be harmed. Fit the cassette back to its place after placing the filter in it (Pictures 22-23).

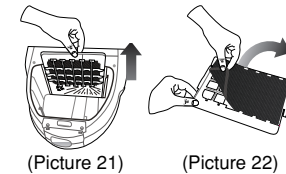

(Picture 21)

(Picture 22)



(Picture 23)

Free Manuals Download Website

<http://myh66.com>

<http://usermanuals.us>

<http://www.somanuals.com>

<http://www.4manuals.cc>

<http://www.manual-lib.com>

<http://www.404manual.com>

<http://www.luxmanual.com>

<http://aubethermostatmanual.com>

Golf course search by state

<http://golfingnear.com>

Email search by domain

<http://emailbydomain.com>

Auto manuals search

<http://auto.somanuals.com>

TV manuals search

<http://tv.somanuals.com>