

# TT125 | Flexible Gooseneck Seat Bolt or Floor Mount for TomTom® GPS



## Package Contents:

- (1) CM088-TS-2 - 15" Flexible steel gooseneck floor or console mount  
Includes: (1) Seat Bolt Bracket, (1) Floor / Console Bracket, (4) Screws, (4) Plastic Caps, and (1) Flexible Steel Shaft with Plastic Tubing
- (1) APTTO - Adapter plate for TomTom ONE™ Series
- (1) APTTOXL - Adapter plate for TomTom ONE XL™ and XL•S™ Series
- (1) APTTGO520 - Adapter plate for TomTom GO™ Series
- (1) APTTTP - Adapter plate for TomTom EasyPort™ pattern
- (1) APTTSE - Adapter plate for TomTom Start™ and Ease™

## Required Tools for Installation:

1. Socket wrench
2. Drill and screwdriver for optional floor or console mounting

## TomTom Device Compatibility:

TomTom ONE 125 125-SE (TomTom EasyPort Mount)  
 TomTom ONE 130, ONE 130-S (TomTom EasyPort Mount)  
 TomTom ONE 140, ONE 140-S (TomTom EasyPort Mount)  
 TomTom XL 325, XL 325-S, XL 325-SE (TomTom EasyPort Mount)  
 TomTom XL 330, XL 330-S (TomTom EasyPort Mount)  
 TomTom XL 335 Series (TomTom EasyPort Mount)  
 TomTom XL 340, XL 340-S, XL 340 LIVE Series (TomTom EasyPort Mount)  
 TomTom XL 350 Series (TomTom EasyPort Mount)  
 TomTom XXL 530-S, XXL 535-T, XXL 540-S/WTE, XXL 550 Series (TomTom EasyPort Mount)  
 TomTom ONE (US Edition, US 3rd Edition)  
 TomTom ONE XL (1st Edition) - TomTom ONE XL-S (1st Edition)  
 TomTom ONE 22, ONE 22 Regional, ONE 22 Regional Traffic  
 TomTom XL 22, XL 22 Regional (TomTom EasyPort Mount)  
 TomTom ONE UK / EUROPE (NEW Edition aka 2nd Edition, 3rd Edition)  
 TomTom GO 520 / 530 / 630 / 720 / 730 / 920 / 920T / 930  
 TomTom Start and Ease

TomTom, ONE, GO, and EasyPort, Start and Ease are product names, trademarks, or registered trademarks of TomTom International NV. Arkon Resources, Inc. is not affiliated with TomTom International NV.

## 1 Passenger Seat Bolt Mounting

For a simple mount that can be easily moved to another vehicle, install using the passenger seat track bolt.

**!** Do not place mount in or near an air bag deployment zone or where it will obstruct view of the road.

- Step 1. Screw the flexible steel shaft into the seat track bolt bracket.
- Step 2. With a socket wrench, loosen the passenger seat track bolt, insert the seat track bolt bracket, and retighten the seat track bolt.

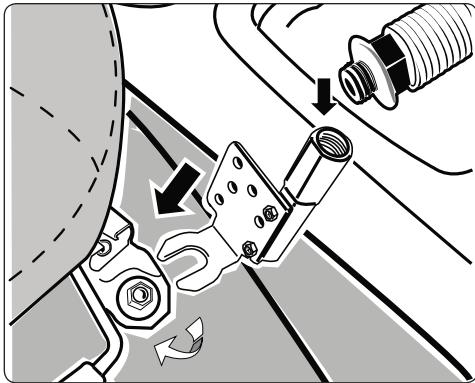

## 2 Floor or Console Mounting

For a more permanent mount, connect the Floor / Console Mount Bracket to the floor or console. This will require drilling into your vehicle's interior surface.

**!** Drilling into the dash, floor, or console will permanently damage the vehicle. Use caution and consult a mobile install professional to avoid drilling into the gas tank, electrical system or other highly sensitive vehicle components.

*Continued on next column...*

- Step 1. Position the Floor/Console Bracket and drill into the floor or console.
- Step 2. Attach the Floor / Console Bracket with screws and cover with plastic caps.
- Step 3. Screw the steel shaft into the Floor / Console Bracket.

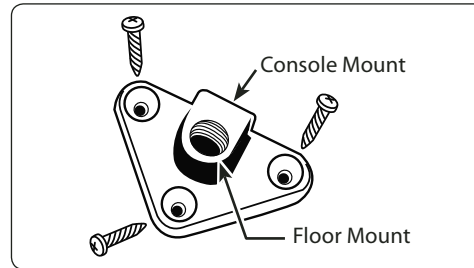

## 3 Pedestal Head Adjustments

- Step 1. Adjust the steel shaft by bending with both hands to the desired location of the male dual T head.
- Step 2. Use the adjustment knob and wing nut on the pedestal head to swivel or rotate the head position if necessary.

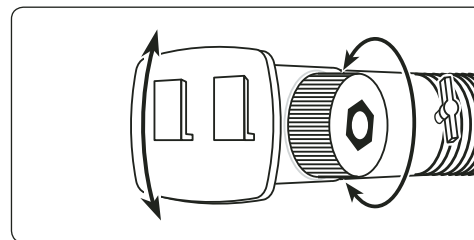

*Continued on other side...*

## ! Safety Precautions

Do not install Arkon products over an air bag cover or within the air bag deployment zone. Arkon Resources, Inc. assumes no responsibility of liability for injury or death as a result of car crashes and / or air bag deployment.

Arkon is not responsible for any damages caused to your car, your device, or yourself due to the installation or use of this pedestal mount.

**ARKON**  
RESOURCES INC.

*The Mobile Mounting Specialists™*

Consumer Hotline:

USA (800) 841-0884

INT'L (626) 254-9005

Monday - Friday 9am - 5pm, PST

[www.arkon.com](http://www.arkon.com)

Arcadia, CA 91006 USA

Designed in USA | Made in China and Taiwan

© Copyright 2010 Arkon Resources, Inc.

## TT125 | Flexible Gooseneck Seat Bolt or Floor Mount for TomTom® GPS

### 4 TomTom ONE, ONE XL, or XL•S Adapter Plate and Device Attachment

Step 1. Slide the adapter plate (D) up into the grooves on the back of the TomTom ONE, ONE XL, or ONE XL•S device (E).

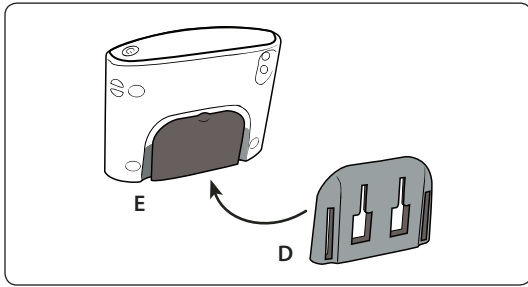

### 4 TomTom GO Adapter Plate and Device Attachment

Step 1. Slide the adapter plate (D) up into the grooves on the back of the TomTom GO 520, 530, 630, 720, 730, 920, 920T, and 930 models device (E).

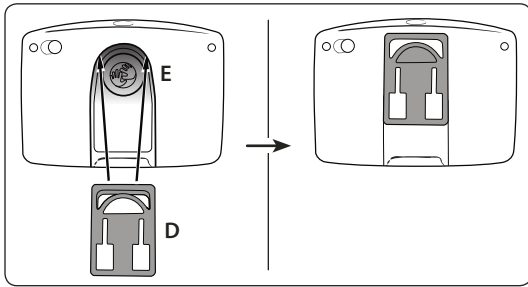

Step 2. Attach the device to the pedestal by inserting the dual T-slots on the adapter plate (F) to the dual-T tabs on the mount head (G).

### 4 TomTom EasyPort Adapter Plate and Device Attachment

Step 1. Connect the dual T-slots (A) on the back of the adapter plate to the dual T-tabs (B) on the mount pedestal head.

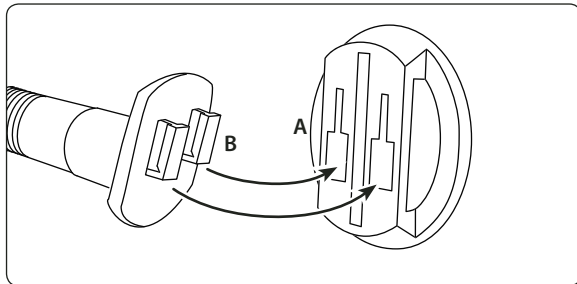

Step 2. While holding the mounted adapter plate, gently insert the device (not included, sold separately) into the adapter plate until an audible click is heard. The device can then be rotated into the desired viewing angle.

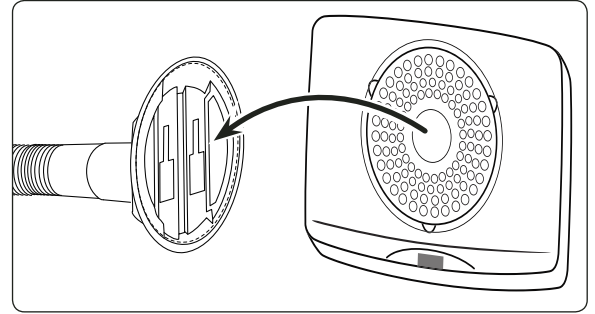

### TomTom Start & Ease Device Installation - Pedestal Attachment

Step 1. Attach the TomTom dual-T adapter plate to the mount by inserting the dual-T tabs of the pedestal (A) into the dual T-slots on the adapter plate (B).

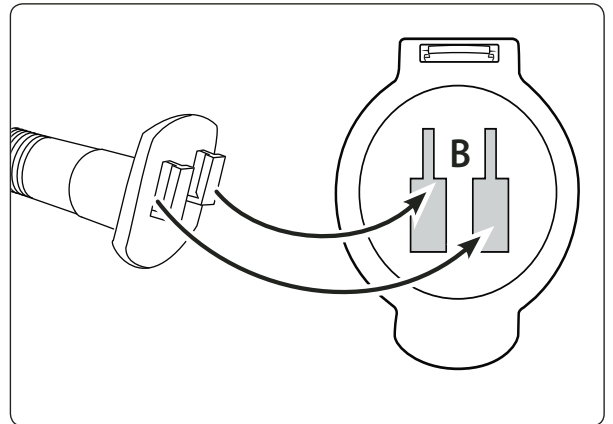

Step 2. While holding the mounted TomTom adapter plate, gently insert the TomTom device (not included, sold separately) into the adapter plate until an audible click is heard.

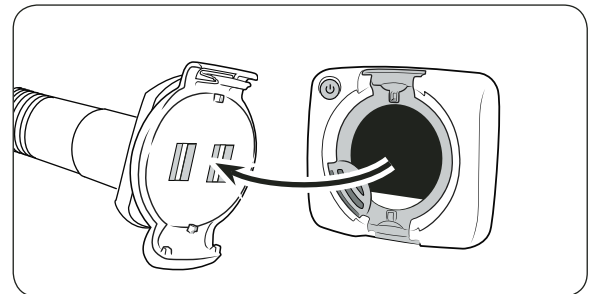

Continued on next column...

### ! Safety Precautions

Do not install Arkon products over an air bag cover or within the air bag deployment zone. Arkon Resources, Inc. assumes no responsibility of liability for injury or death as a result of car crashes and / or air bag deployment.

Arkon is not responsible for any damages caused to your car, your device, or yourself due to the installation or use of this pedestal mount.

**ARKON**  
RESOURCES INC. The Mobile Mounting Specialists™

Consumer Hotline:

USA (800) 841-0884

INT'L (626) 254-9005

Monday - Friday 9 am - 5 pm, PST

[www.arkon.com](http://www.arkon.com)

Arcadia, CA 91006 USA

Designed in USA | Made in China and Taiwan

© Copyright 2010 Arkon Resources, Inc.

## Free Manuals Download Website

<http://myh66.com>

<http://usermanuals.us>

<http://www.somanuals.com>

<http://www.4manuals.cc>

<http://www.manual-lib.com>

<http://www.404manual.com>

<http://www.luxmanual.com>

<http://aubethermostatmanual.com>

Golf course search by state

<http://golfingnear.com>

Email search by domain

<http://emailbydomain.com>

Auto manuals search

<http://auto.somanuals.com>

TV manuals search

<http://tv.somanuals.com>