

# INSTALLATION INSTRUCTIONS

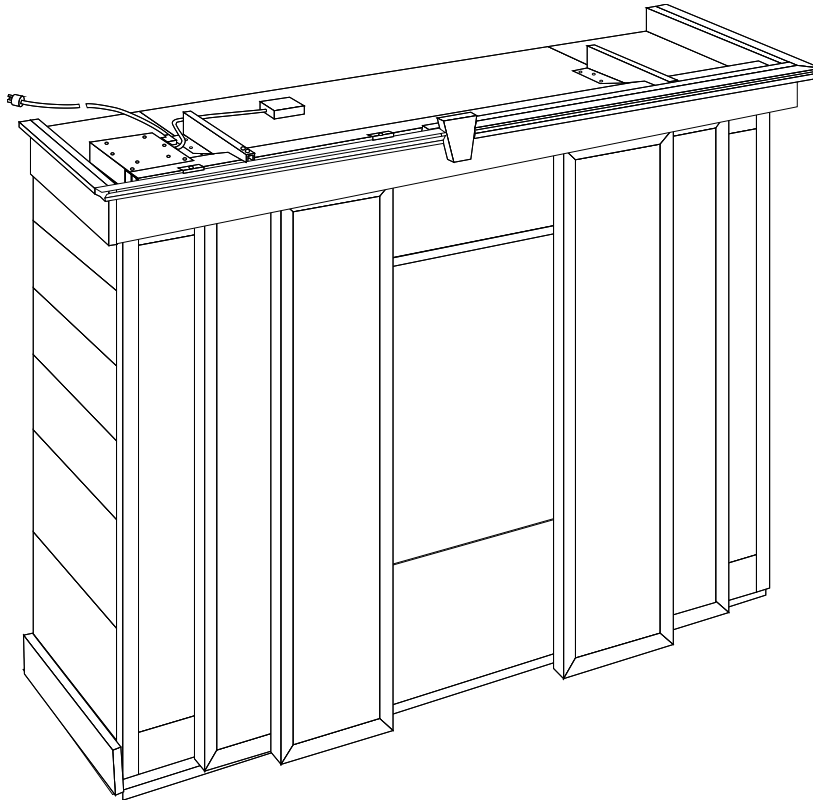

## Automated Quad Horizontal Door System

This device complies with part 15 of the FCC rules. Operation is subject to the following 2 conditions: (1) This device may not cause harmful interference, and (2) this device must accept any interference received, including interference that may cause undesired operation.

This equipment has been tested and found to comply with the limits of a Class B digital device, pursuant to Part 15 of the FCC rules. These limits are designed to provide reasonable protection against harmful interference in a residential installation. This equipment generates, uses and can radiate radio frequency energy, and if not installed and used in accordance with the instructions, may cause harmful interference to radio or television communications. However, there is no guarantee that the interference will not occur in a particular installation. If this equipment does cause harmful interference to radio or television reception, which can be determined by turning the equipment off and on, the user is encouraged to try to correct the interference by one of the following measures:

- Reorient or relocate the receiving antenna
- Increase the separation between the equipment and receiver
- Connect the equipment to an outlet on a circuit other than that to which the receiver is connected

Consult the dealer or an experienced radio/TV technician for help

 **CHIEF**<sup>®</sup>

**CM6QH SERIES**

CSAV, Inc., and its affiliated corporations and subsidiaries (collectively, "CSAV"), intend to make this manual accurate and complete. However, CSAV makes no claim that the information contained herein covers all details, conditions or variations, nor does it provide for every possible contingency in connection with the installation or use of this product. The information contained in this document is subject to change without notice or obligation of any kind. CSAV makes no representation of warranty, expressed or implied, regarding the information contained herein. CSAV assumes no responsibility for accuracy, completeness or sufficiency of the information contained in this document.



## IMPORTANT WARNINGS AND CAUTIONS!

The Alert messages **DANGER**, **WARNING**, **CAUTION**, **IMPORTANT**, and **NOTE** are used throughout these instructions and on the product to alert the reader and/or operator of the existence of dangerous situations, conditions and/or important operational and maintenance information.

### "SAVE THESE INSTRUCTIONS"



**WARNING:** WARNING alerts you to the possibility of serious injury or death if you do not follow the instructions.



**CAUTION:** A CAUTION alerts you to the possibility of damage or destruction of equipment if you do not follow the corresponding instructions.



**WARNING:** FAILURE TO READ AND FOLLOW THE FOLLOWING INSTRUCTIONS CAN RESULT IN SERIOUS PERSONAL INJURY, DAMAGE TO EQUIPMENT OR VOIDING OF FACTORY WARRANTY. It is the installer's responsibility to make sure all components are properly assembled and installed using the instructions provided. Read all instructions before using this furnishing.



**DANGER: TO REDUCE THE RISK OF ELECTRIC SHOCK:**

- ALWAYS unplug this furnishing from the electrical outlet before cleaning.



**WARNING: TO REDUCE THE RISK OF BURNS, FIRE, ELECTRIC SHOCK, OR INJURY TO PERSONS:**

- Unplug from outlet before putting on or taking off parts.
- Close supervision is necessary when this furnishing is being used by, or near, children, invalids, or disabled persons.
- Use this furnishing only for its intended use as directed in these instructions. DO NOT use attachments not recommended by the manufacturer.
- NEVER operate this furnishing if it has a damaged cord or plug, if it is not working properly, if it has been dropped or damaged, or dropped into water. Return the furnishing to a service center for examination and repair.
- Keep the cord away from heated surfaces.
- NEVER operate the furnishing with the air openings blocked. Keep the air openings free of lint, and the like.
- NEVER drop or insert anything into any opening.
- DO NOT use outdoors.
- DO NOT operate where aerosol (spray) products are being used, or where oxygen is being administered.
- To disconnect, turn all controls to the off position, then remove plug from outlet.



**WARNING: RISK OF ELECTRICAL SHOCK!** Connect this device to a properly grounded outlet only.



**CAUTION:** ONE END OF POWER CORD MUST REMAIN ACCESSIBLE AT ALL TIMES! DO NOT block or impede access to plug at any time!



**CAUTION:** Changes or modifications to this unit not expressly approved by the manufacturer can void the units FCC compliance rating and make the unit illegal to operate.

## System Features and Installation Requirements

### Features

#### Remote Control Activated Lutron Light Dimmer Module

With this dimmer cabinet lighting can be switched on or off and dimmed using the left buttons on the hand held remote control transmitter.

#### Obstruction Sensor

The system is equipped with an obstruction sensor. In the event that something would interfere the motion of the doors; the doors stop, reverse, run a few seconds, and then stop again.

#### Auxiliary Controls

There is an activator button located on the front of the motor box which will activate the doors.

#### Status Light

The Status Light on the front of the Motor Box indicates the operating condition of the mechanism. In normal operating conditions, the status light will be solid green with the doors at rest and will blink a series of green twice, pause, green twice, pause ..., when the doors are in motion.

### Installation Requirements

- 115VAC power at installation site
- Doors must be made of a non warping material.

### TOOLS REQUIRED FOR INSTALLATION

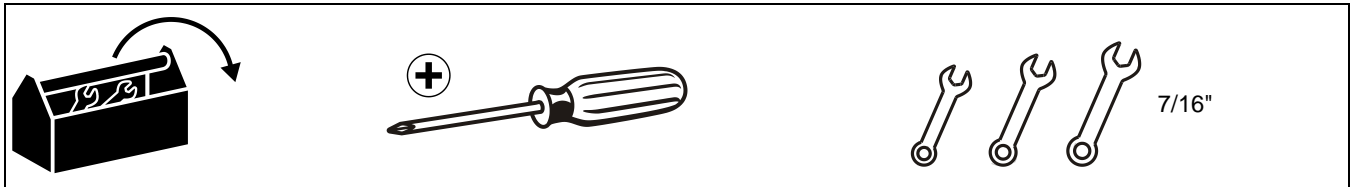

### PARTS

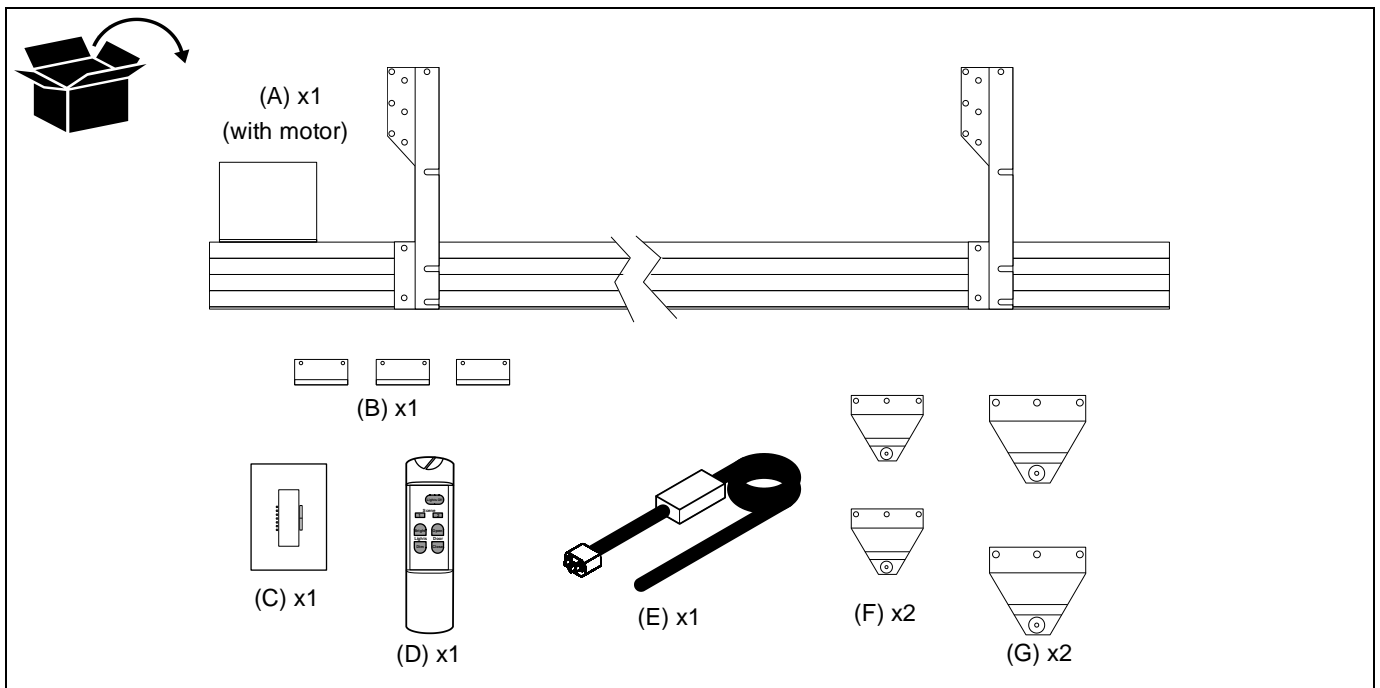

## INSTALLATION

### Installation

1. Secure track to top of cabinet.
2. Align centerline on track with center of cabinet opening, and keep the front of the track mounting flange flush with front of the cabinet. (See Figure 2)
3. Secure Support Arms to the top of the cabinet.

### Door Hanging Procedure

**IMPORTANT !** : Doors should be made of a non-warping material, not to exceed 1 3/8" in thickness and 50 pounds each.

1. Pre-drill the tops of the doors as shown with 1/2" clearance holes for the door hanger pendant bolts.
2. Mount the door hangers to the top of the 4 doors. After mounting, check to make sure that the pendant bolts can be freely adjusted in and out of the door hangers. (See figure 3)
3. Mount the guidewheel plates to the bottom of the doors. (See figure 4)
4. Hang the 2 Rear doors onto the mechanism carriages located on the underside of the track. Use the carriages closest to the ends of the track. First engage the guidewheel

plate wheel into the track area built into the base. Then tip the top of the door into the mechanism and engage the pendant bolts into the slots in the carriages. After hanging the doors spin the locking nut on the pendant bolts up so that the nut is finger tight against the bottom of the carriage. (See figure 3)

5. Repeat this procedure for the 2 Front doors using the center carriages.
6. Adjust the doors for plumb by using a 7/16" wrench and turning the adjustment nut on the pendant bolt. Tightening the bolt into the door hanger will raise that corner of the door, loosening the bolt will lower the corner. After all doors have been adjusted, use one wrench to hold the adjustment nut and another to tighten the locking nut on the pendant bolts against the carriage.

**IMPORTANT !** : Doors should be adjusted so that they are even across the top. Do not adjust the doors too high as this will cause the guidewheel plates to rub and possibly restrict the movement of the doors. Check to make sure that the front door guidewheel plates clear the bottom of the rear doors as they move.

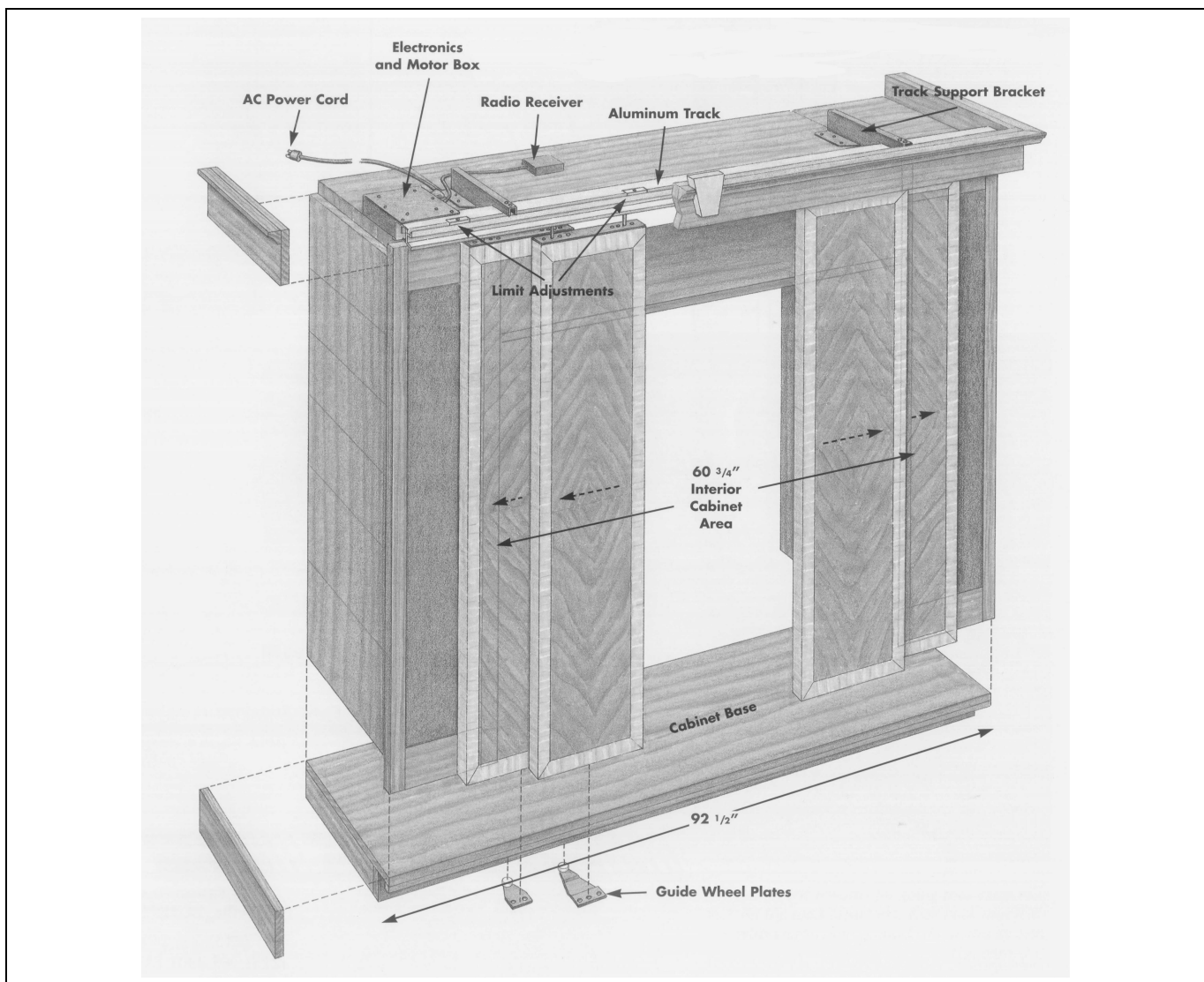

Figure 1

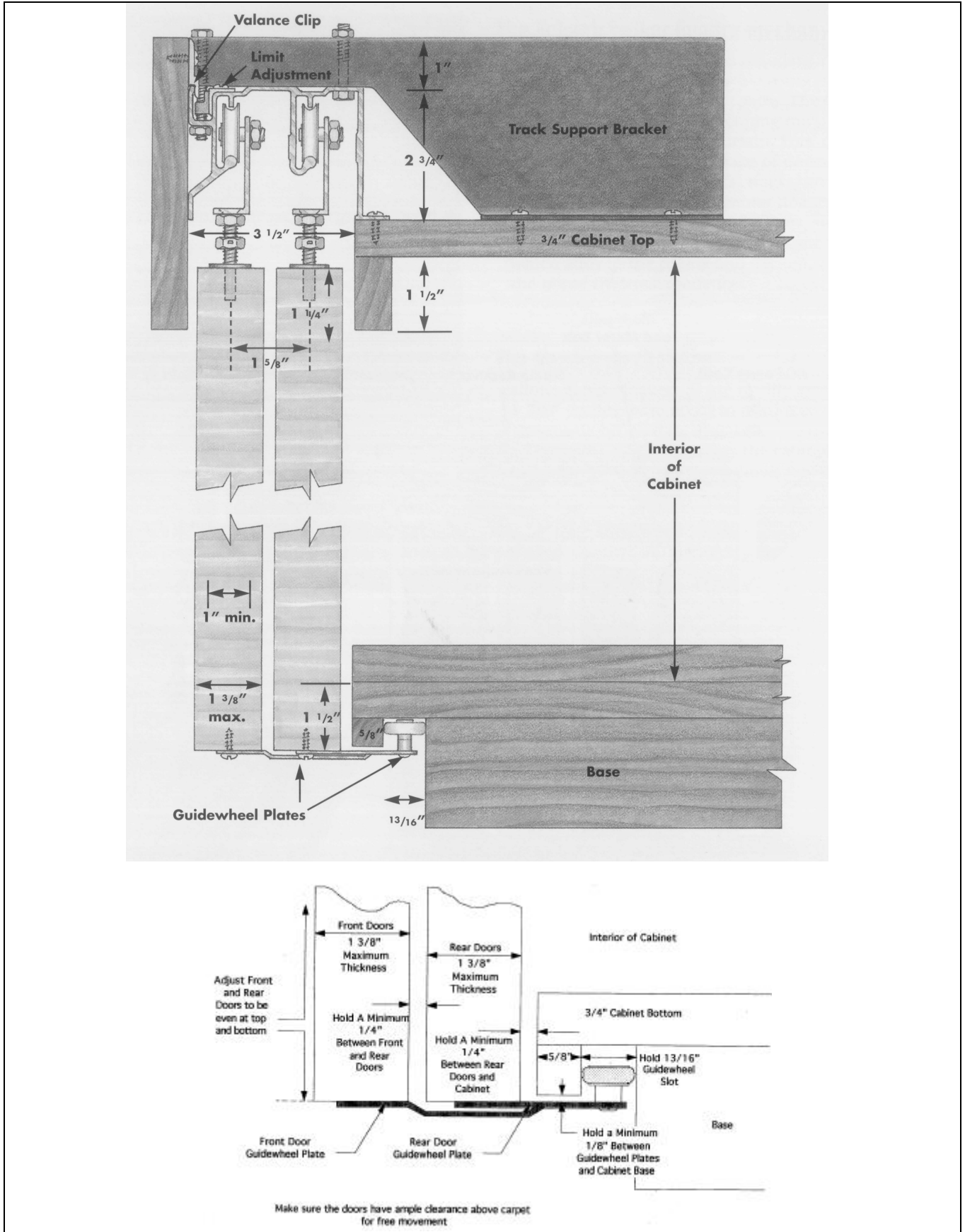

Figure 2

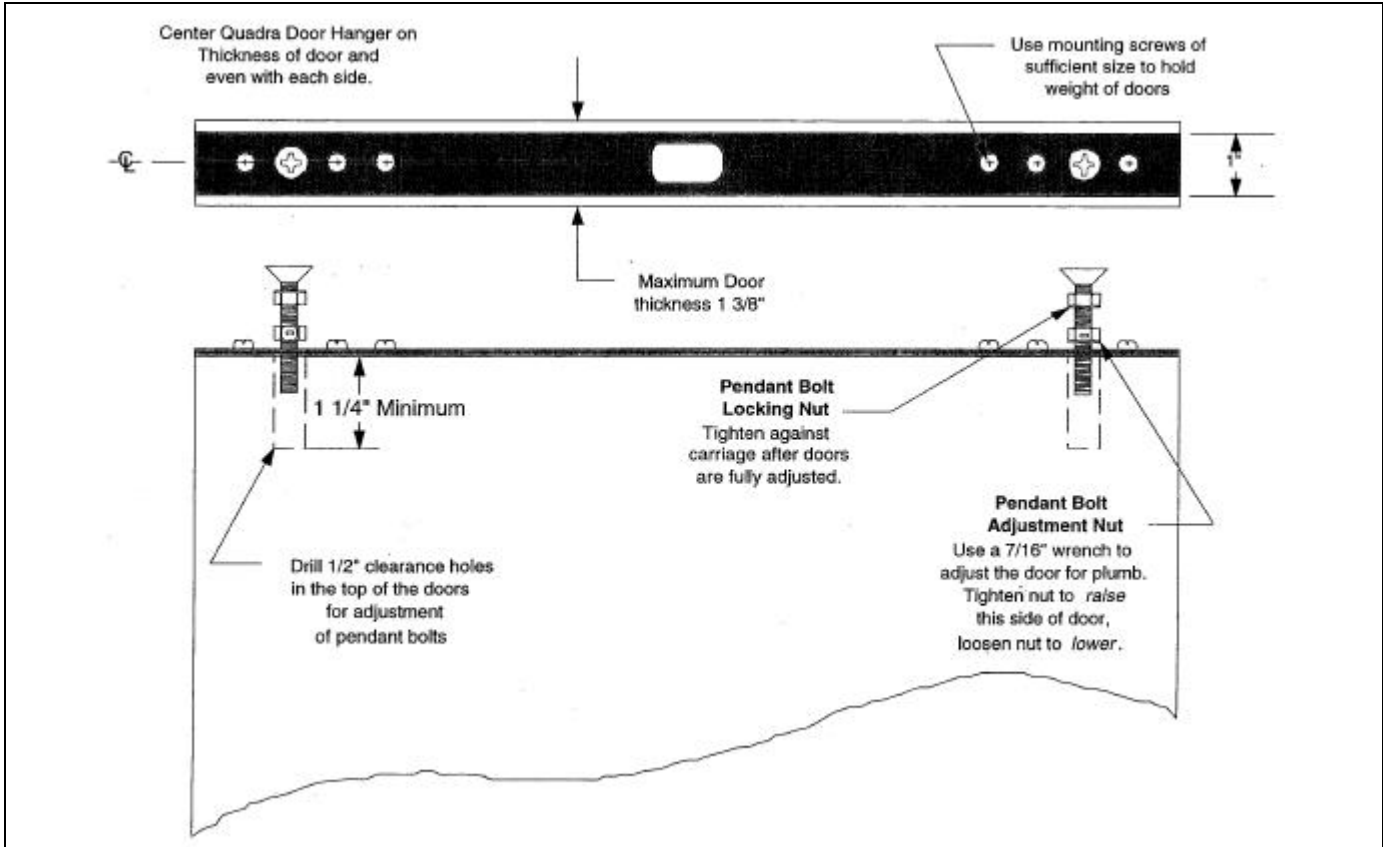

Figure 3

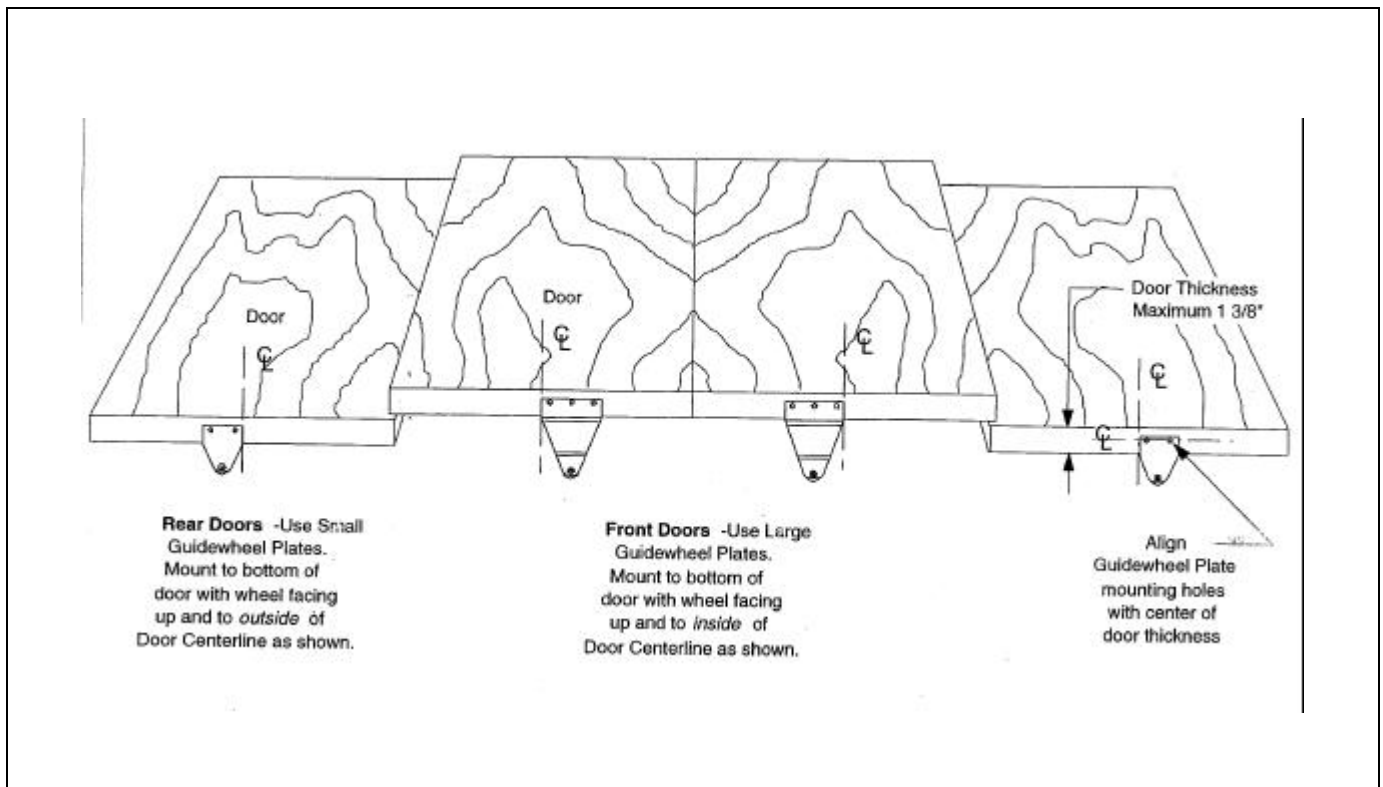
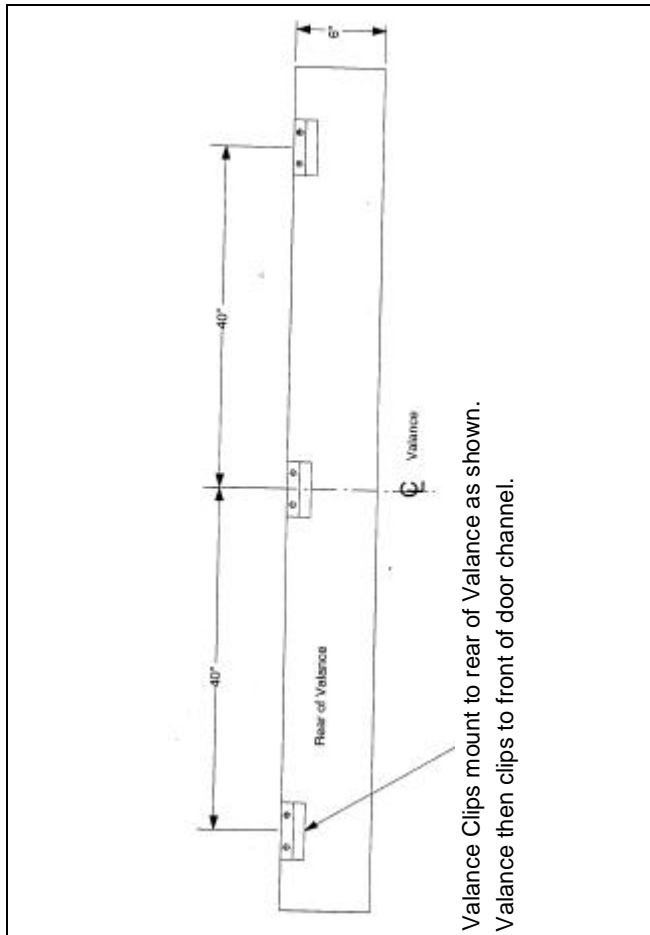

Figure 4

**Install Valance Clips**

Three Valance clips are supplied to assist in hanging a valance in front of the track. (See Figure 5).



**Figure 5**

**IR Sensor Placement**

The placement of the IR sensor can be crucial to proper operation of the system. A flexible IR sensor is provided to make it easier to achieve reliable operation.

In most applications, the IR sensor may be installed on top of the cabinet. However, tall ceilings and/or dark colored ceilings can absorb the IR signal. If inconsistent operation is encountered there are two alternatives.

- One, the flexible IR sensor eye can be placed so that it gives the sensor "line of sight" to the signal from the remote controller. Often this merely involves placing the IR sensor so that it peeks up over the top of the cabinet. It doesn't have to be much, just enough to give "line of sight".
- Two, an IR sensor extension cord can be used to position the IR sensor in the cabinet near to the other remote controlled units. (For example, near to the VCR or DVD player)

**Install Light Dimmer Module (Optional)**

With the dimmer option installed cabinet lighting can be switched on or off or dimmed using the left buttons on the systems remote control.

To install the optional dimmer:

1. Plug 115VAC lighting into the back of the Light Dimmer Module.
2. Plug the other end of Dimmer Module cord into a 115VAC grounded receptacle on motor assembly.



**CAUTION:** The Dimmer is for 120 volt incandescent or Halogen lamps of at least 25 watts and should not to exceed 300 watts total.

The system also provides the option of creating and saving two different lighting "scenes". Please refer to the Remote Control instructions for information on how to configure "scenes".

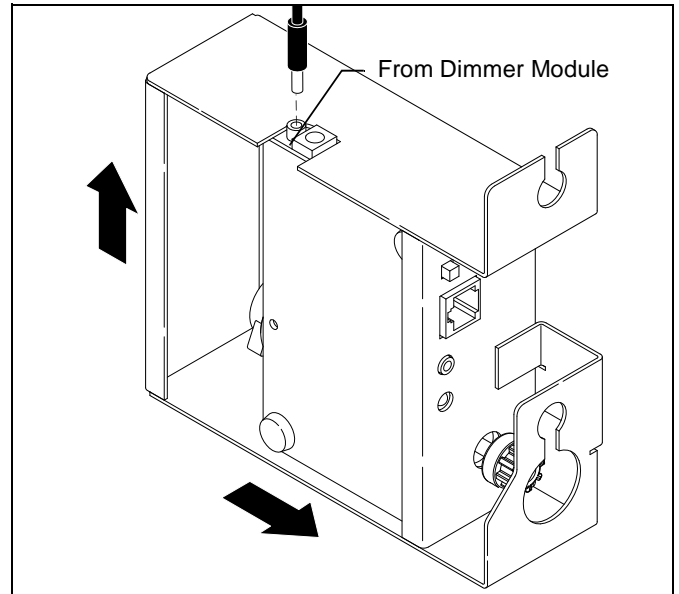

**Figure 6**

**System Activation**

1. Insert plug from the power supply into the jack on the top of the motor box.

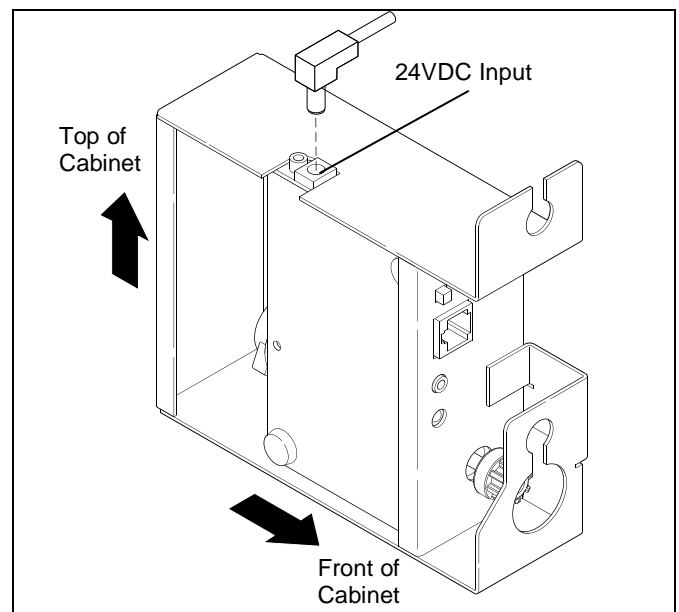

**Figure 7**

2. Plug Powercord into 115VAC outlet.  
**IMPORTANT !** : A quality surge protection device is recommended.
3. Make sure nothing is obstructing movement of doors,
4. Press and release the Activator Button on the front of the Motor Box or the "Close Door button on the Remote Control. (The doors should travel to the fully closed position)

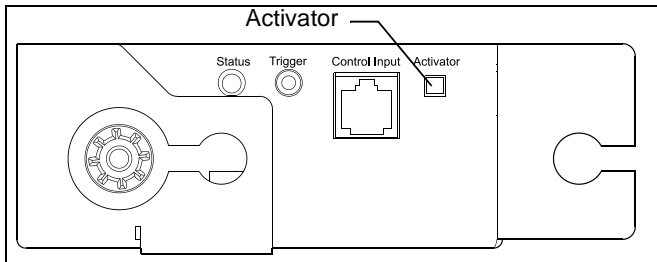

Figure 8

5. Press the "Open Door" button on the Remote Control.  
**NOTE:** If a different travel distance is required see "Door Travel Adjustment below.

## ADJUSTMENTS

### Adjust Door Travel Distance

To adjust door travel distance:

1. Press and hold the activator button on the front of the motor box for 13 seconds.

The Status Light on the front of the motor box will begin to blink alternately red and green. When this starts to happen release the Activator Button. When put into "Learn Moden the system runs back and forth several times and measures it's environment, such as open and closed locations etc. The system will then stop and remember these learned measurements.

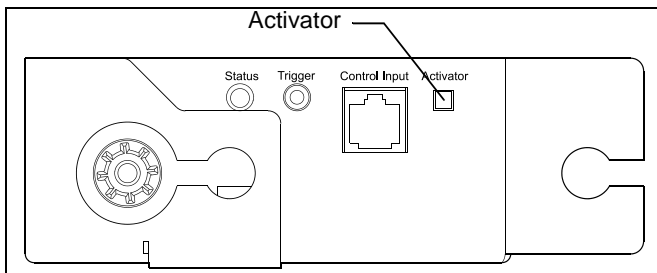

Figure 9

## System Controls and Indicators

### Learn Mode

The CM6SV system has no limit switches. The system uses an encoder on the motor to collect data and send it to the micro processor's memory. The software "learns" about its environment (speed, time duration, stop points, etc.) during the initial setup of the unit and retains that information until requested to "relearn" its environment.

The unit is shipped pre-set from the factory and will then continually adjusts to it's enviornment on each activation.

If for some reason you want to place the system into "Learn Mode" (such as to stop at other than its normal stop points), Press and hold the red activator button on the front of the motor

box for approxamatly 13 seconds and then release it when the Status Light flashes quickly red, green, red, green, red, green.

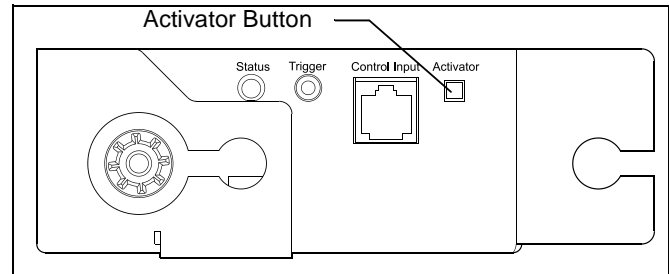

Figure 10

The controller will then be in "Learn Mode" (The door will move for 3 seconds, stop for 10 seconds, and when it starts moving again it will be in it's "Learn Mode").

When put into "Learn Mode" the mechanism runs back and forth several times and measures it's environment, such as open and closed locations etc., and then stops and remembers these learned measurements, so that next time the system runs it knows where to start and stop.

### Status Light Codes

There is a light on the front of the mechanism motor box that will tell through its pattern of flashes and colors what the mechanism is doing.

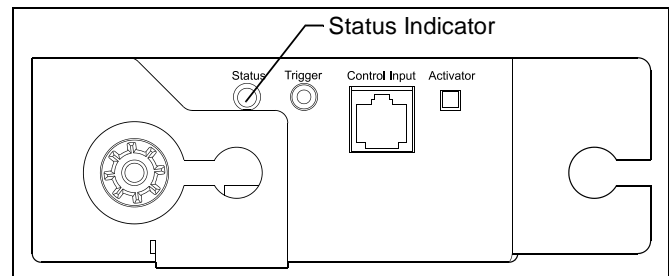

Figure 11

**Normal Doors At Rest** - The Status Light will be on steady green.

**Normal Run Motion of Doors** - The Status Light will flash in groups of 2 green followed by a pause. In normal run motion the doors on the system have a variable speed. The doors will start slowly, accelerate to a fast speed, and then slow down before coming to a stop.

**Doors Obstructed** - The Status Light will flash in groups of 3 red followed by a pause. If the doors meet an obstruction they will sense the obstruction, stop momentarily, and move in the opposite direction for a few seconds. ---- Remove the obstruction and then activate the doors. They should return to normal run motion.

**Doors Obstructed Both Ways** - The Status Light will flash in groups of 4 red followed by a pause. Similar to Doors Obstructed but doors are prevented from moving in either direction. ---- Remove the obstruction and then activate the doors. They should return to normal run motion.

**Travel Too Far** - The Status Light will flash in groups of 5 red followed by a pause. The motor is running but the doors are not moving. ---- Has the motor box been uncoupled from the



track, or is the motor box bent, causing it to become uncoupled from the track?

**Power Loss** - The Status Light will be on solid red. ---- There has been a power loss (due to an electrical storm, etc.). When next activated the doors will move at a slow speed to their full closed position. If the doors are already closed they will not move. The Status Light will return to solid green and the doors are ready for normal activation.

**Optional Control Input Connections**

**Control Input- 8 position RJ 45 modular phone jack**

Discrete control for use with 3rd party control.

- Position 8- Open
- Position 7- Stop

IR Receiver "Eye" input for Eubank, Inc. supplied external IR receiver only.

- Position 6 - V out
- Position 5 - Vcc, 5v

Radio Power for external RF receiver only.

- Position 4 - 24 VDC

Sequence control for use with 3rd party control.

- Position 3 - Sequence- Open, Stop, Close, Stop
- Position 2 - Common

Discrete control for use with 3rd party control.

- Position 1 - Close

**Control Input on Front of Motor Box**

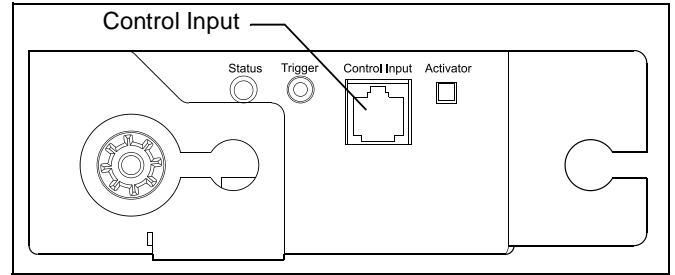

**Figure 12**

**NOTE:** Making a momentary dry contact closure between the common and the open, closed, stop, or sequence will activate the system in that mode.

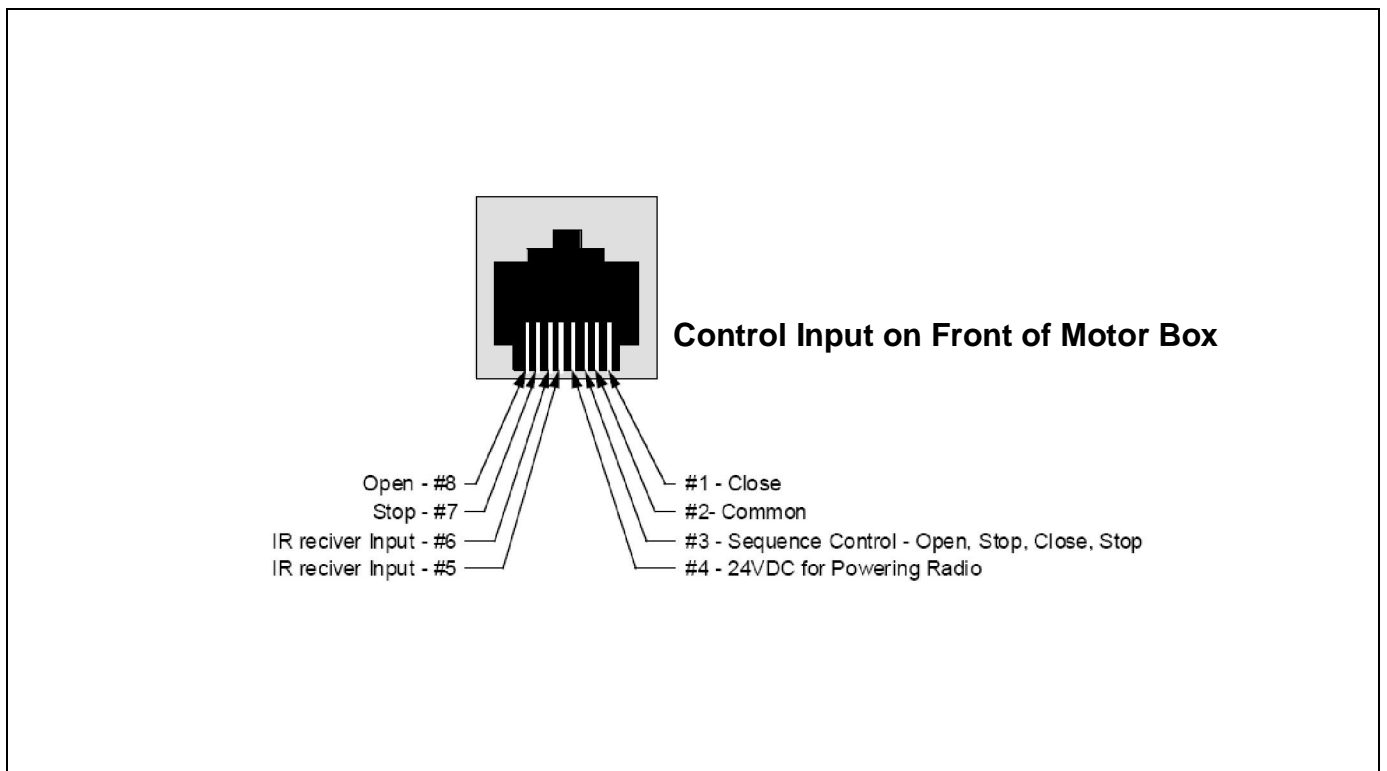

**Figure 13**



8820-000021  
©2007 Chief Manufacturing  
[www.chiefmfg.com](http://www.chiefmfg.com)  
03/07

<b>USA/International</b>	<b>A</b> 8401 Eagle Creek Parkway, Savage, MN 55378 <b>P</b> 800.582.6480 / 952.894.6280 <b>F</b> 877.894.6918 / 952.894.6918
<b>Europe</b>	<b>A</b> Fellenoord 130 5611 ZB EINDHOVEN, The Netherlands <b>P</b> +31 (0)40 2668620 <b>F</b> +31 (0)40 2668615
<b>Asia Pacific</b>	<b>A</b> Room 30I, Block D, Lily YinDu International Building LuoGang, BuJi Town, Shenzhen, CHINA. Post Code: 518112 深圳市布吉罗岗百合银都国际大厦D栋30I <b>P</b> +86-755-8996 9226 ; 8996 9236 ; 8996 9220 <b>F</b> +86-755-8996 9217

## Free Manuals Download Website

<http://myh66.com>

<http://usermanuals.us>

<http://www.somanuals.com>

<http://www.4manuals.cc>

<http://www.manual-lib.com>

<http://www.404manual.com>

<http://www.luxmanual.com>

<http://aubethermostatmanual.com>

Golf course search by state

<http://golfingnear.com>

Email search by domain

<http://emailbydomain.com>

Auto manuals search

<http://auto.somanuals.com>

TV manuals search

<http://tv.somanuals.com>