



INSTALLATION INSTRUCTIONS

# FSA-1003 and KSA-1003

## FLAT PANEL DISPLAY ACCESSORY ARM

Prior to assembly, unpack carton completely and verify contents.  
If you are missing any of the following components, please contact Customer Service at 1-800/582-6480

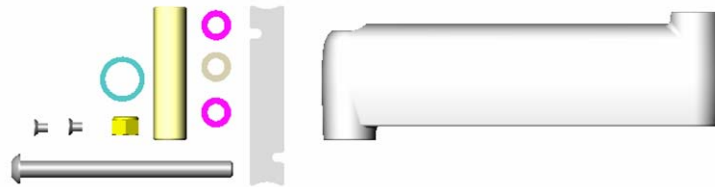

Figure 1

- (1) Flat Panel Arm
- (1) Cable Management Cover
- (1) Pivot Pin
- (1) Small Plastic Washer
- (1) Large Plastic Washer

- (1) Button Head Cap Screw, 4.0" Long
- (2) Flat Head Screw
- (1) Lock Nut
- (2) Steel Washer

**BEFORE PROCEEDING, READ INSTALLATION INSTRUCTIONS COMPLETELY**

### WARNING!

**When using an OFB and adding additional arms to an existing mount, the total number of arms on the mount cannot exceed two arms.**

1. Using a 3/16" hex key, remove the button head cap screw securing the monitor interface to the arm or other modular flat panel arm component (i.e. wall plate, desk clamp, etc.).
2. Install the components at each pivot in the order shown in Figure 2.
3. Using the 3/16" hex key, tighten the button head cap screws until the desired amount of pivoting friction is achieved.

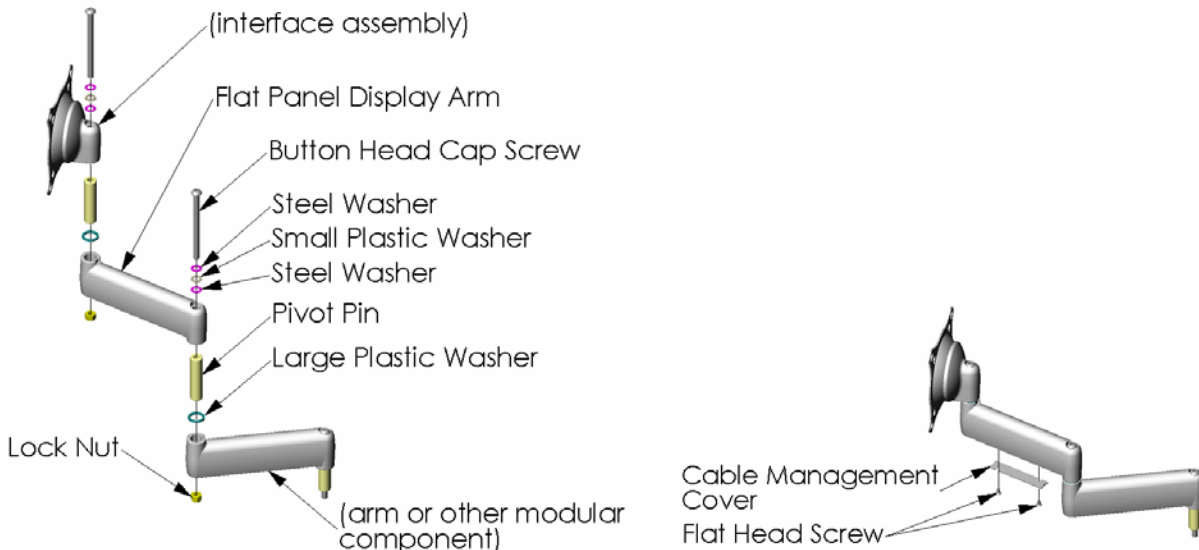

Figure 2

## Free Manuals Download Website

<http://myh66.com>

<http://usermanuals.us>

<http://www.somanuals.com>

<http://www.4manuals.cc>

<http://www.manual-lib.com>

<http://www.404manual.com>

<http://www.luxmanual.com>

<http://aubethermostatmanual.com>

Golf course search by state

<http://golfingnear.com>

Email search by domain

<http://emailbydomain.com>

Auto manuals search

<http://auto.somanuals.com>

TV manuals search

<http://tv.somanuals.com>