



Hedge Trimmers

INSTRUCTION MANUAL

Catalog Nos. HT200, HT300, HT400, HT500, HS1000, HS1022

BEFORE RETURNING THIS PRODUCT
FOR ANY REASON PLEASE CALL

1-800-54-HOW-TO (544-6986)

IF YOU SHOULD EXPERIENCE A PROBLEM
WITH YOUR **BLACK & DECKER** PURCHASE,
CALL 1-800-54-HOW-TO (1-800-544-6986).
IN MOST CASES, A **BLACK & DECKER** REPRESENTATIVE
CAN RESOLVE YOUR PROBLEM OVER THE PHONE.
IF YOU HAVE A SUGGESTION OR COMMENT,
GIVE US A CALL. YOUR FEEDBACK IS VITAL
TO THE SUCCESS OF **BLACK & DECKER'S** QUALITY
IMPROVEMENT PROGRAM.

KEY INFORMATION YOU SHOULD KNOW:

- To operate the trimmer, the actuator must be released (see Figure 2).
- Attach the extension cord properly for best results (see Figure 4).

SAVE THIS MANUAL FOR FUTURE REFERENCE.

VEA EL ESPAÑOL EN LA CONTRAPORTADA.

INSTRUCTIVO DE OPERACIÓN, CENTROS DE SERVICIO Y PÓLIZA DE
GARANTÍA. ADVERTENCIA: LÉASE ESTE INSTRUCTIVO ANTES DE USAR EL
PRODUCTO.

Cat. #'s. HT200, HT300, HT400, HT500, HS1000, HS1022 Form No. 384244-01 Printed in U.S.A. (APR99 CD-1)

Copyright © 1999 Black & Decker

TO REDUCE RISK OF INJURY:

- Before any use, be sure everyone using this tool reads and understands all safety instructions and other information contained in this manual.
- Save these instructions and review frequently prior to use and in instructing others.

⚠ WARNING: When using electric gardening appliances, basic safety precautions should always be followed to reduce risk of fire, electric shock, and personal injury, including the following:

READ ALL INSTRUCTIONS

GENERAL SAFETY WARNINGS AND INSTRUCTIONS FOR ALL TOOLS

- **AVOID DANGEROUS ENVIRONMENT** - Don't use hedge trimmers in damp or wet locations.
- **DON'T USE IN RAIN.**
- **KEEP CHILDREN AWAY** -All visitors should be kept at a safe distance from the work area.
- **DRESS PROPERLY** - Don't wear loose clothing or jewelry. They can be caught in moving parts. Use of rubber gloves and substantial footwear is recommended when working outdoors. Wear protective hair covering to contain long hair.
- **USE SAFETY GLASSES** -Also use face or dustmask if operation is dusty.
- **GROUND FAULT CIRCUIT INTERRUPTER (GFCI)** protection should be provided on the circuit(s) or outlet(s) to be used for the hedge trimmer. Receptacles are available having built-in GFCI protection and may be used for this measure of safety.
- **USE RIGHT APPLIANCE** - Do not use appliance for any job except that for which it is intended.

⚠ WARNING: To reduce the risk of electric shock use only with an extension cord intended for outdoor use, such as SW-A, SOW-A, STW-A, STOW-A, SJW-A, SJOW-A, SJTW-A or SJTOW-A.

- **EXTENSION CORD.** Make sure your extension cord is in good condition. When using an extension cord be sure it is heavy enough to carry the current your product will draw. An undersized extension cord will cause a drop in line voltage resulting in loss of power and overheating. The following table shows the correct size to use depending on cord length and nameplate ampere rating. If in doubt, use the next heavier gage. The smaller the gage number, the heavier the cord. Black & Decker has extension cords available for use with outdoor appliances.

Volts	Minimum Gage for Cord Sets				
	Total Length of Cord in Feet				
120V	25	26-50	51-100	101-150	
240V	50	51-100	101-200	201-300	
Ampere Rating		American Wire Gage			
More Than	Not more Than				
0	- 6	18	16	16	14
6	- 10	18	16	14	12
10	- 12	16	16	14	12
12	- 16	14	12	Not Recommended	

- **AVOID UNINTENTIONAL STARTING** - Don't carry plugged in hedge trimmer with finger on switch. Be sure switch is off when plugging in.
- **DON'T ABUSE CORD** - Never carry hedge trimmer by cord or yank it to disconnect from receptacle. Keep cord from heat, oil, and sharp edges.
- **⚠ DANGER:** Risk of cut. Keep hands away from blades. Keep both hands on handles when power is on.
- **DO NOT ATTEMPT** to remove cut material or hold material to be cut when blades are moving. Make sure trimmer switch is off when clearing jammed material from blades. Do not grasp the exposed cutting blades or cutting edges when picking up or holding the hedge trimmer. **⚠ CAUTION:** Blades coast after turn off.
- **DON'T FORCE HEDGE TRIMMER** - It will do the job better and with less likelihood of a risk of injury at the rate for which it was designed.
- **DON'T OVERREACH** - Keep proper footing and balance at all times.
- **STAY ALERT** - Watch what you are doing. Use common sense. Do not operate hedge trimmer when you are tired.
- **DISCONNECT HEDGE TRIMMER** from the power supply when not in use or when servicing or cleaning.
- **STORE IDLE HEDGE TRIMMER INDOORS** - When not in use, hedge trimmer should be stored indoors in a dry and high or locked-up place- out of reach of children.

- **MAINTAIN HEDGE TRIMMER WITH CARE** - Keep cutting blades sharp and clean for best performance and to reduce the risk of injury. Inspect extension cord periodically and replace if damaged. Keep handles dry, clean and free from oil and grease.
- **CHECK DAMAGED PARTS** - before further use of the hedge trimmer, a guard or other part that is damaged should be carefully checked to determine that it will operate properly and perform its intended function. Check for alignment of moving parts, binding of moving parts, breakage of parts, mounting and any other condition that may affect its operation. A guard or other part that is damaged should be properly repaired or replaced by an authorized service center unless otherwise indicated elsewhere in this manual.

SAFETY WARNINGS: DOUBLE INSULATION

Double insulated tools are constructed throughout with two separate layers of electrical insulation or one double thickness of insulation between you and the tool's electrical system. Tools built with this insulation system are not intended to be grounded. As a result, your tool is equipped with a two prong plug which permits you to use extension cords without concern for maintaining a ground connection.

NOTE: Double insulation does not take the place of normal safety precautions when operating this tool. The insulation system is for added protection against injury resulting from a possible electrical insulation failure within the tool.

REPLACEMENT PARTS: When servicing all tools, USE IDENTICAL REPLACEMENT PARTS. Repair or replace damaged cords.

SAFETY WARNINGS AND INSTRUCTIONS: POLARIZED PLUGS

To reduce the risk of electric shock, this equipment has a polarized plug (one blade is wider than the other). This equipment must be used with a suitable polarized 2 wire or 3 wire extension cord. Polarized connections will fit together only one way. Make sure that the receptacle end of the extension cord has large and small blade slot widths. If the plug does not fit fully into the extension cord, reverse the plug. If it still does not fit, obtain a suitable extension cord. If the extension cord does not fit fully into the outlet, contact a qualified electrician to install the proper outlet. Do not change the tool plug or extension cord in any way.

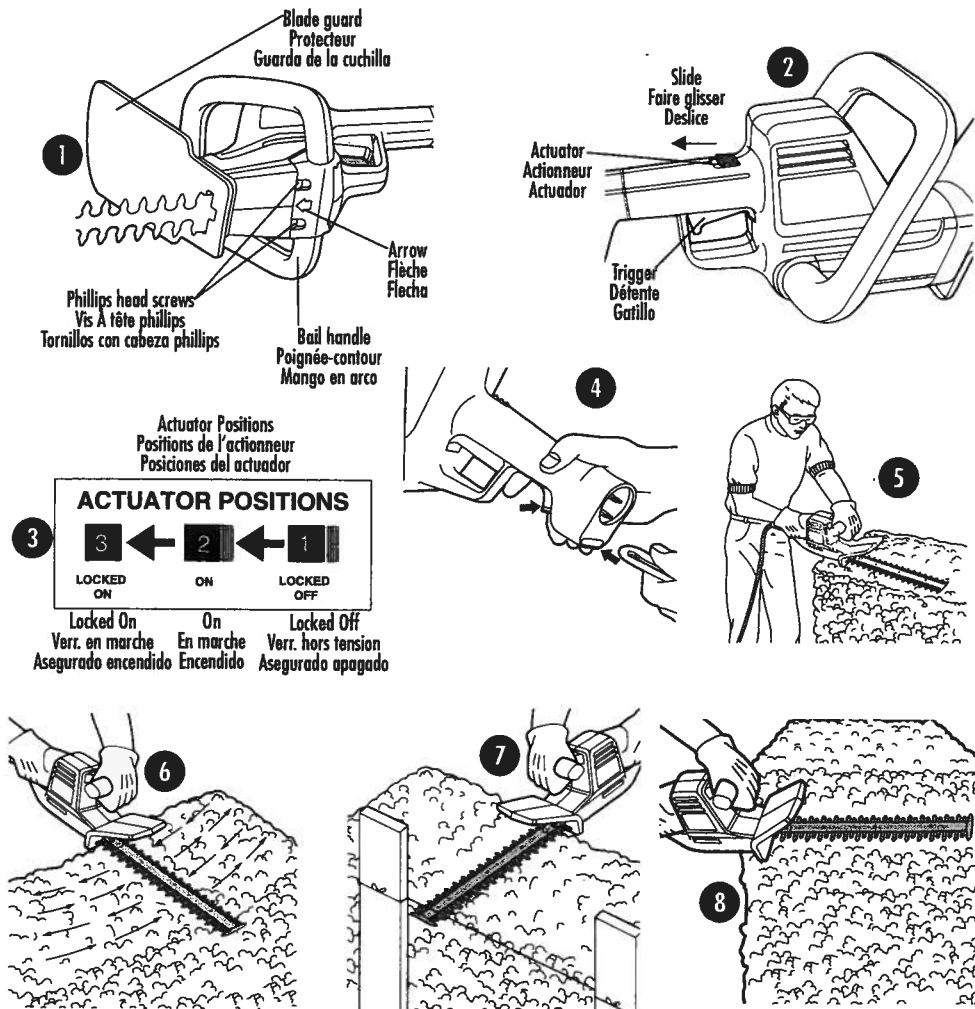

ASSEMBLY / ADJUSTMENT SET-UP

INSTALLING THE BAIL HANDLE (HT400 AND HT500 ONLY)

⚠ **WARNING:** Do not use hedge trimmer without bail handle.

NOTE: The HT200 and HT300 trimmers have built-in auxiliary handles and the HS1000 has a pre-installed bail handle.

Before using your trimmer, you must install the bail handle as follows:

1. **TURN OFF POWER AND UNPLUG TRIMMER.**
2. Install the bail handle to the trimmer housing from the bottom, as shown in Figure 1.
3. With the arrow pointing forward, as shown in Figure 1, install the two phillips head screws from the plastic bag through the bail handle and into the trimmer housing. Tighten securely.

⚠ **WARNING:** Always hold the bail or auxiliary handle with one hand when trimming.

ATTACHING EXTENSION CORD TO TRIMMER

An extension cord retainer is built into the switch handle that prevents the extension cord from pulling out of the handle. To use the retainer, simply double the extension cord as shown in Figure 4, about a foot from the female end, and insert the cord as far as it will go. The automatic mechanism inside the handle ensures that the cord will be securely held. Plug the female end of the extension cord onto the plug in the end of the switch handle. To remove the cord, simply depress the retainer latch and pull the cord out.

OPERATING INSTRUCTIONS

SWITCH

To turn the tool "ON", squeeze the trigger while sliding the actuator, shown in Figures 2 & 3, to the rear. When the actuator reaches position 2, shown in Figure 3, the trigger will depress fully and the tool will start to run. The actuator can be released at this time, but in order to keep the tool running, you must continue to squeeze the trigger. To turn the tool "OFF", simply release the trigger. The actuator will lock the tool "OFF" automatically.

The tool can be locked in the "ON" position by squeezing the trigger and sliding the actuator back as described above, but when the tool starts, continue squeezing the trigger and sliding the actuator back until it reaches position 3 shown in Figure 3. At this point the tool is locked "ON" and both the actuator and trigger may be released while the tool continues to run. To turn the tool off from a locked "ON" position, squeeze and release the trigger. The actuator locks the tool "OFF" automatically.

TRIMMING INSTRUCTIONS

1. **EXTENSION CORD.** (Figure 5) Always keep extension cord behind trimmer and away from the trimming operation. Never drape it over a hedge being trimmed. If you cut or damage the cord, unplug it at the electrical outlet immediately, before inspecting or repairing cord.
2. **WORKING POSITION.** Maintain proper footing and balance and do not overreach. Wear safety goggles, non-skid footwear and rubber gloves when trimming. Hold the tool firmly in both hands and turn the tool ON. Always hold the trimmer, as shown in the illustrations above, with one hand on the switch handle and one hand on the auxiliary or bail handle. Never hold the tool by the blade guard.
3. **TRIMMING NEW GROWTH.** (Figure 6) A wide, sweeping motion, feeding the blade teeth through the twigs is most effective. A slight downward tilt of the blade, in the direction of motion gives the best cutting.
⚠ **CAUTION: (HT200, HT300, HT400, HT500 TRIMMERS).** Do not cut stems greater than 3/8" (10mm). Use these trimmers only for cutting normal shrubbery around houses and buildings.
⚠ **CAUTION: (HS1000 & HS1022 TRIMMERS).** Do not use trimmer for cutting stems 3/4" (19mm) or greater. Use this trimmer only for cutting normal shrubbery around houses and buildings.
4. **LEVEL HEDGES.** (Figure 7) To obtain exceptionally level hedges a piece of string can be stretched along the length of the hedge as a guide.
5. **SIDE-TRIMMING HEDGES.** (Figure 8) Hold the trimmer as shown and begin at the bottom and sweep up.

⚠ WARNING: TO GUARD AGAINST INJURY, OBSERVE THE FOLLOWING:

- READ INSTRUCTION MANUAL BEFORE USING.
- SAVE INSTRUCTION MANUAL.
- KEEP HANDS AWAY FROM BLADES.
- KEEP HANDS ON HANDLES. DON'T OVERREACH.
- CAUTION – BLADE COASTS AFTER TURN OFF.
- DO NOT USE UNDER WET CONDITIONS.
- DO NOT USE WITH DAMAGED EXTENSION CORD.
- DO NOT UNPLUG OR STORE WITH SWITCH LOCKED ON.

IMPORTANT: To assure product SAFETY and RELIABILITY, repairs, maintenance and adjustment should be performed by authorized service centers or other qualified service organizations, always using identical replacement parts.

Accessories

⚠ WARNING: DO NOT use the hedge trimmer with any type of accessory or attachment. Such usage might be hazardous.

MAINTENANCE

The cutting blades are made from high quality, hardened steel and with normal usage, they will not require resharpening. However, if you accidentally hit a wire fence, stones, glass or other hard objects, you may put a nick in the blade. There is no need to remove this nick as long as it does not interfere with the movement of the blade. If it does interfere, unplug unit and use a fine toothed file or sharpening stone to remove the nick. If you drop the trimmer, carefully inspect it for damage. If the blade is bent, housing cracked, or handles broken or if you see any other condition that may affect the trimmer's operation contact your local Black & Decker Service Center for repairs before putting it back into use.

Fertilizers and other garden chemicals contain agents which greatly accelerate the corrosion of metals. Do not store the tool on or adjacent to fertilizers or chemicals.

With the unit unplugged, use only mild soap and a damp cloth to clean the tool. Never let any liquid get inside the tool; never immerse any part of the tool into a liquid.

Service Information

Black & Decker offers a full network of company-owned and authorized service locations throughout North America. All Black & Decker Service Centers are staffed with trained personnel to provide customers with efficient and reliable power tool service. Whether you need technical advice, repair, or genuine factory replacement parts, contact the Black & Decker location nearest you.

To find your local service location, refer to the yellow page directory under "Tools-Electric" or call: **1-800-54-HOW TO**.

Full Two-Year Home Use Warranty

Black & Decker (U.S.) Inc. warrants this product for two years against any defects in material or workmanship. The defective product will be replaced or repaired at no charge in either of two ways: The first, which will result in exchanges only, is to return the product to the retailer from whom it was purchased (provided that the store is a participating retailer). Returns should be made within the time period of the retailer's policy for exchanges (usually 30 to 90 days after the sale). Proof of purchase may be required. Please check with the retailer for their specific return policy regarding returns that are beyond the time set for exchanges.

The second option is to take or send the product (prepaid) to a Black & Decker owned or authorized Service Center for repair or replacement at our option. Proof of purchase may be required. Black & Decker owned and authorized service centers are listed under "Tools-Electric" in the yellow pages of the phone directory. This warranty does not apply to accessories. This warranty gives you specific legal rights and you may have other rights which vary from state to state. Should you have any questions, contact the manager of your nearest Black & Decker Service Center.

Black & Decker (U.S.) Inc.,
701 E. Joppa Rd.
Towson, MD 21286 U.S.A.



See 'Tools-Electric'
– Yellow Pages –
for Service & Sales



Free Manuals Download Website

<http://myh66.com>

<http://usermanuals.us>

<http://www.somanuals.com>

<http://www.4manuals.cc>

<http://www.manual-lib.com>

<http://www.404manual.com>

<http://www.luxmanual.com>

<http://aubethermostatmanual.com>

Golf course search by state

<http://golfingnear.com>

Email search by domain

<http://emailbydomain.com>

Auto manuals search

<http://auto.somanuals.com>

TV manuals search

<http://tv.somanuals.com>