

# OWNER'S MANUAL MANUEL D'UTILISATION MANUAL DEL USUARIO

## Outdoor LP Gas Lantern Lanterne d'extérieur au propane Linterna a gas propano líquido para exteriores Model No. / Modèle n° / Modelo no. GLL905W

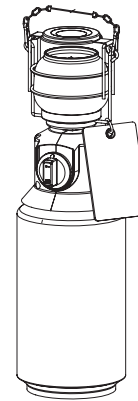

Optional Base / Socle en option / Base opcional  
Part number / numéro de pièce / número de pieza: 55-09-287

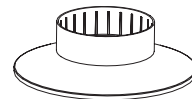

Save these instructions for future reference.

If you are assembling this unit for someone else, give this manual to him or her to read and save for future reference.

The use and installation of this product must conform to local codes. In absence of local codes, use the *National Fuel Gas Code, ANSI Z223.1/NFPA 54, CAN/CGA-B149.1, Natural Gas and Propane Installation Code.*

California Proposition 65: Chemicals known to the State of California to cause cancer, birth defects, or other reproductive harm are created by the combustion of propane.

Conservez ces instructions afin de pouvoir les consulter ultérieurement.

Si vous êtes en train d'assembler cet appareil pour une autre personne, veuillez lui fournir le manuel afin qu'elle puisse le lire et le consulter plus tard.

L'utilisation et l'installation de cet appareil doivent être conformes aux codes locaux. En l'absence de codes locaux, suivez le *Code national du gaz et des combustibles, les normes ANSI Z223.1/NFPA 54, CAN/CGA-B149.1 et le Code d'installation du gaz naturel et du propane.*

Proposition 65 de Californie: La combustion du propane produit des émanations et des résidus chimiques ayant été reconnus par l'État de la Californie comme étant source de cancer, malformations congénitales et autres dommages reproductifs.

Conserve estas instrucciones para futuras consultas.

Si está montando esta unidad para otra persona, entréguele este manual para futuras consultas.

El uso e instalación de este producto ha de realizarse de acuerdo con los códigos locales. Si no existen códigos locales, use las normas siguientes: *Código Nacional para Gas y Combustibles, ANSI Z223.1/NFPA 54, CAN/CGA-B149.1, Código de Instalación de Propano y Gas Natural.*

Propuesta 65 de California: La combustión del propano crea productos químicos considerados por el Estado de California como causantes de cáncer, malformaciones congénitas u otros daños reproductivos.

Manufactured in China for / Fabriqué en Chine pour / Fabricado en China para:

Blue Rhino Global Sourcing, Inc  
Winston-Salem, NC USA

1.800.762.1142, www.bluerhino.com

© Blue Rhino Global Sourcing, Inc. All Rights Reserved / Tous droits réservés / Todos los derechos reservados



Certified Under / Homologué par / Certificado por:  
ANS Z21.73b • CSA11.1b-2002 Camp Lights /  
Lampes de camping / Lámparas para campamento

## **WARNING**

### **FOR YOUR SAFETY:**

**For Outdoor Use Only**  
(outside any enclosure)

## **DANGER**

**If you smell gas -**

- 1. Do not attempt to light appliance.**
- 2. Extinguish any open flame.**
- 3. Disconnect from fuel supply.**

## **DANGER**



### **CARBON MONOXIDE HAZARD**

- This appliance can produce carbon monoxide which has no odor.**
- Using it in an enclosed space can kill you.**
- Never use this appliance in an enclosed space such as a camper, tent, car or home.**

## **WARNING**

### **FOR YOUR SAFETY:**

**Do not store or use gasoline or other liquids with flammable vapors in the vicinity of this or any other appliance.**

**▲ DANGER:** Failure to follow these instructions, dangers, warning and cautions in this manual may result in serious bodily injury or death, or in a fire or an explosion causing damage to property.

**▲ WARNING:**

- ▲ This lantern is for outdoor use only, and shall not be used in a building, garage or any other enclosed area.**
- ▲ Do NOT operate, light or use this appliance within 8 feet of walls, structures or buildings.**
- ▲ This lantern is NOT for commercial use.**
- ▲ This lantern is for use with liquid propane (LP) gas only. The conversion to or attempted use of natural gas in this LP gas lantern is dangerous and will void your warranty.**
- ▲ LP gas Characteristics:**
  - a. LP gas is flammable and hazardous if handled improperly. Become aware of the characteristics before using any LP gas product.**
  - b. LP gas is explosive under pressure, heavier than air, and settles and pools in low areas.**
  - c. LP gas in its natural state has no odor. For your safety, an odorant is added that smells like rotten cabbage.**
  - d. Contact with LP gas can cause freeze burns to skin.**
- ▲ Do not store spare LP cylinder within 10 feet (3.05 m) of this appliance.**
- ▲ An LP cylinder not connected for use shall not be stored in the vicinity of this or any other appliance.**
- ▲ LP gas tank needed to operate. Only tanks marked "propane" may be used.**
- ▲ The LP gas tank used with the lantern must be constructed and marked in accordance with the Specifications for LP-gas cylinders of the U.S. Department of Transportation (DOT) or *Transport Canada, CAN/CSA B339.***
- ▲ LP gas tank must be arranged for vapor withdrawal.**

**▲ Dented or rusted LP gas tanks may be hazardous and should be checked by your LP gas supplier prior to use.**

- ▲ The LP gas tank should not be dropped or handled roughly.**
- ▲ LP gas tanks must be stored outdoors out of the reach of children and must not be stored in a building, garage, or any other enclosed area. Your tank must never be stored where temperatures can reach over 125°F.**
- ▲ Never attempt to attach this lantern to the self-contained LP gas system of a camper trailer, motor home or house.**
- ▲ The use of alcohol, or prescription or non-prescription drugs may impair the consumer's ability to properly assemble or safely operate the appliance.**
- ▲ Never use lighter fluid, gasoline, kerosene or alcohol with this product.**
- ▲ Your lantern has been checked at all factory connections for leaks. Recheck all connections, as movement in shipping can loosen connections.**
- ▲ Check for leaks even if your unit was assembled for you by someone else.**
- ▲ Do not operate if gas leak is present. Gas leaks may cause a fire or explosion.**
- ▲ You must follow all leak-checking procedures before operating. To prevent fire or explosion hazard when testing for a leak:**
  - a. Always perform leak test before lighting the lantern and each time the tank is connected for use.**
  - b. No smoking. Do not use or permit sources of ignition in the area while conducting a leak test.**
  - c. Conduct the leak test outdoors in a well-ventilated area.**
  - d. Do not use matches, lighters, or a flame to check for leaks.**
  - e. Do not use lantern until any and all leaks are corrected.**

If you are unable to stop a leak, disconnect the LP gas supply. Call a gas appliance serviceman or your local LP gas supplier.

- ▲ Do not use in an explosive atmosphere. Keep lantern area clear and free from combustible materials, gasoline and other flammable vapors and liquids.**
- ▲ Keep all combustible items and surfaces at least 21 inches (53 cm) away from the lantern at all times. DO NOT use this lantern or any gas product under any overhead or near any unprotected combustible constructions.**
- ▲ It is essential to keep the lantern's valve compartment, burners, and circulating air passages clean. Inspect lantern before each use.**
- ▲ Do not alter lantern in any manner.**
- ▲ Do not use the lantern unless it is**

**COMPLETELY assembled and all parts are securely fastened and tightened.**

- ▲ This lantern should be thoroughly cleaned and inspected on a regular basis.**
- ▲ Use only the valve provided. The replacement valve shall be that specified by the manufacturer.**
- ▲ Use only Blue Rhino Global Sourcing, Inc. factory authorized parts. The use of any part that is not factory authorized can be dangerous. This will also void your warranty.**
- ▲ Do not use this appliance without reading "Operating Instructions" in this manual.**
- ▲ Do not touch metal parts of lantern until it has completely cooled (about 45 min.) to avoid burns, unless you are wearing protective gear (pot holders, gloves, BBQ mittens, etc.).**
- ▲ Do not install or use in or on boats or recreational vehicles.**
- ▲ When using, fire extinguishing materials shall be readily accessible.**
- ▲ Do not use lantern in high winds.**
- ▲ Never lean over the lantern when lighting.**
- ▲ Do NOT use this lantern if any part has been under water. Immediately call a qualified service technician to inspect the appliance and to replace any part or control system and any gas control which has been under water.**
- ▲ Do not leave a lit lantern unattended, especially keep children and pets away from lantern at all times.**
- ▲ Allow the lantern to cool before storing.**
- ▲ Storage of lantern indoors is permissible only if the tank is disconnected, removed from the lantern and properly stored outdoors.**
- ▲ Do not attempt to disconnect the gas regulator from the tank or any gas fitting while the lantern is in use.**
- ▲ Disconnect cylinder when not in use.**
- ▲ Use of chain: Always hang lantern from a sturdy, non-combustible support or use with optional base (part number 55-09-287, not included).**

**Use of base: Always use your lantern on a hard, non-combustible, level surface. An asphalt or blacktop surface may not be acceptable for this purpose.**
- ▲ Do not use directly on wooden decks and wooden picnic tables.**
- ▲ Keep all electrical cords away from a hot lantern.**
- ▲ Do not use lantern for indoor heating. TOXIC fumes can accumulate and cause asphyxiation.**
- ▲ After a period of storage and/or nonuse, check for leaks, and burner obstructions.**
- ▲ If lantern is not in use, the tank must be disconnected and stored in a proper**

location.

- ▲ Do not store a spare LP gas tank under or near this appliance.
- ▲ Use protective gloves when assembling this product.
- ▲ Do not force parts together as this can result in personal injury or damage to the product.
- ▲ Do not operate lantern with a hole or crack in the mantle.
- ▲ Do not attempt to operate the lantern without a mantle installed.
- ▲ Deaths, serious injury or damage to property may occur if the above is not followed exactly.

## Operating Instructions

Lantern is intended to hang from the chain on a non-combustible, sturdy support, unless lantern is used with optional base (part number 55-09-287, not included).

This lantern is designed to operate with a one pound 7-3/8" high disposable / 16.4 oz. propane gas tank (DOT 39 Cylinder).

### DO NOT ATTEMPT TO REFILL ANY ONE POUND (16.4 oz.) PROPANE GAS TANKS!

#### Connecting Gas Tank

1. Make sure the control knob is in the "OFF" position. (Figure 1)
2. Lubricate the threads of the regulator valve with petroleum jelly, insert the gas tank into the regulator valve and hand-tighten firmly. (Figure 2)
3. Insert LP gas tank into the base.
4. Test for leaks

#### Checking for Leaks

- ▲ **WARNING: Failure to inspect this connection or follow these instructions could cause a fire or an explosion which can cause death, serious bodily injury, or damage to property.**
1. Make 2-3 oz. of leak solution by mixing one part liquid dishwashing soap with three parts water.
  2. Make sure control knob is "OFF".
  3. Attach LP gas tank, per "Connecting Gas Tank" instructions.
  4. Spoon several drops of solution, or use squirt bottle, at the LP gas tank to regulator connection.
  5. Inspect the solution at the connections, looking for bubbles or the smell of rotten cabbage.
    - a. If NO bubbles appear or smells of rotten cabbage, the connections are secure.
    - b. If bubbles appear, you have a leak.
      1. Loosen and retighten this connection, making sure the connection is secure.
      2. Retest with solution.
- If you continue to see bubbles after several attempts, disconnect propane source and contact 1.800.762.1142 for assistance.

#### Lighting

- ▲ **DO NOT expose the lantern to flammable vapors or liquids during lighting.**
1. Make sure all labels, packaging and protective films have been removed from the lantern.
  2. Make sure there are no obstructions of airflow to the gas unit. Spiders and insects can nest within and clog the burner / venturi tube at the orifice.

Figure 1

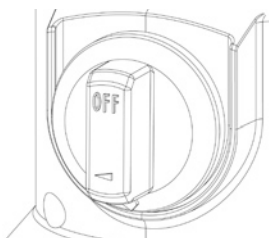

Figure 2

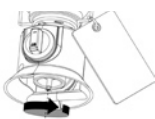
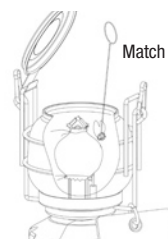

Figure 3



**A clogged burner tube can lead to a fire.**

3. Control knobs must be in the "OFF" position. (Figure 1)
  4. Attach the LP gas tank per the "Connecting Gas Tank" instructions.
  5. Igniter: Turn the control knob counterclockwise to "ON" and repeatedly push the igniter button to ignite the mantle.
    - a. Match: Wearing heat resistant gloves, position the lit long match or lit long butane lighter evenly next to the mantle. (Figure 3)
    - a. Turn control knob counterclockwise to "ON".
    - b. Hold lit long match or lit long butane lighter next to mantle for up to 5 seconds.
    - c. Remove long match/long butane lighter.
    - d. Replace cap.
- Note: Once the mantle has been burned, it is very fragile. Be careful not to touch it with finger or match.
6. If ignition does not occur in 5 seconds, turn burner control knob "OFF", wait 5 minutes and repeat lighting procedure.
- ▲ **Caution: If burner flame goes out during operation, immediately turn the gas "OFF" and let the gas clear for about 5 minutes before re-lighting.**

#### Turning Off

1. Turn control knobs to the "OFF" position.
2. Allow lantern to completely cool.
3. Remove LP gas tank and properly store tank.

#### Transporting

##### While Lantern is ON

1. Carefully carry the lantern by the chain.
2. Do not touch any of the lantern surfaces as they may be hot
3. Before setting the lantern down, make sure the lantern is hanging from a sturdy, non-combustible support or the tank is properly in the base.

##### While Lantern is OFF

1. The LP gas tank must be removed and stored properly.
2. Once the lantern is cooled, place the lantern (and optional base) in a plastic bag and secure the bag with a string.

▲ **DO NOT COMPLETELY SEAL THE PLASTIC BAG.**

Note: The plastic bag will help protect from insects.

#### Replacing Mantle

1. Turn control knob to "OFF" and remove LP gas tank.
2. Allow lantern to cool completely.
3. Open cap and remove globe

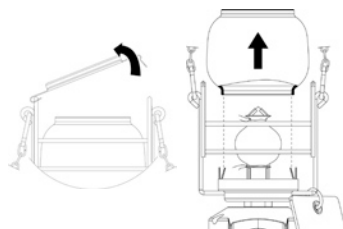

#### 4. Attach mantle

Note: Tie the mantles around grooves in burner.

Note: Evenly distribute folds on mantle. Cut off the extra string.

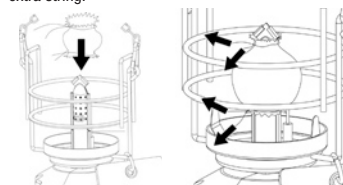

#### 5. Insert globe and close cap

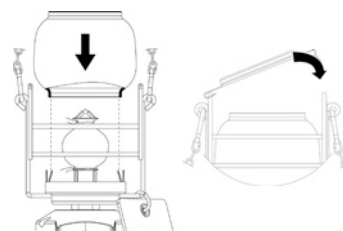

#### 6. Perform leak check

## Cleaning and Care

- ▲ **CAUTION: All cleaning and maintenance should be done when lantern is cool and with the fuel supply disconnected.**
- ▲ **CAUTION: DO NOT clean any lantern part in a self cleaning oven. The extreme heat will damage the finish.**

▲ **CAUTION: Keep lantern clear and free from combustible materials, gasoline and other flammable vapors and liquids.**

▲ **CAUTION: Do NOT obstruct the flow of combustion and ventilation air.**

#### Notices

1. Abrasive cleaners will damage this product.
2. Never use oven cleaner to clean any part of lantern.

#### Inspecting

This lantern should be inspected on a regular basis to ensure product safety and longer product life.

▲ **WARNING: Do NOT attempt to clean this lantern unless the flames are COMPLETELY out and unit is cool to the touch, about 45 minutes.**

1. Check burner to make sure it is secure.
2. Check valve to make sure it is clear and free of spider nests.
3. Check all gas connections for leaks.
4. Check components for any signs of damage or rust.
5. If damage to any component is detected, do NOT operate until repairs are executed.

#### Cleaning Surfaces

▲ **WARNING: Do NOT attempt to clean this lantern unless the flames are COMPLETELY out and unit is cool to the touch. (About 45 minutes).**

▲ **WARNING: Do NOT use oven cleaner or abrasive cleaners as they will damage this product.**

1. Wipe surfaces clean with mild dishwashing detergent or baking soda.
2. For stubborn surfaces use a citrus based degreaser and a nylon scrubbing brush.
3. Rinse clean with water.

## Product Registration

For faster warranty service, register your product immediately at [www.bluerhino.com](http://www.bluerhino.com) or call 1.800.762.1142.

## Limited Warranty

Blue Rhino Global Sourcing, Inc ("Vendor") warrants to the original retail purchaser of this product, and to no other person, that if this product is assembled and operated in accordance with the printed instructions accompanying it, then for a period of one (1) year from the date of purchase, all parts in such product shall be free from defects in material and workmanship. Vendor may require reasonable proof of your date of purchase. Therefore, you should retain your sales slip or invoice. This Limited Warranty shall be limited to the repair or replacement of parts, which prove defective under normal use and service and which Vendor shall determine in its reasonable discretion upon examination to be defective. Before returning any parts, you should contact Vendor's Customer Service Department using the contact information listed below. If Vendor confirms, after examination, a defect covered by this Limited Warranty in any returned part, and if Vendor approves the claim, Vendor will replace such defective part without charge. If you return defective parts, transportation charges must be prepaid by you. Vendor will return replacement parts to the original retail purchaser, freight or postage prepaid.

This Limited Warranty does not cover any failures or operating difficulties due to accident, abuse, misuse, alteration, misapplication, improper installation or improper maintenance or service by you or any third party, or failure to perform normal and routine maintenance on the product as set out in this owner's

manual. In addition, the Limited Warranty does not cover damage to the finish, such as scratches, dents, discoloration, rust or other weather damage, after purchase.

This Limited Warranty is in lieu of all other express warranties. Vendor disclaims all warranties for products that are purchased from sellers other than authorized retailers or distributors, including the warranty of merchantability or the warranty of fitness for a particular purpose. **VENDOR ALSO DISCLAIMS ANY AND ALL IMPLIED WARRANTIES, INCLUDING WITHOUT LIMITATION THE IMPLIED WARRANTIES OF MERCHANTABILITY AND FITNESS FOR A PARTICULAR PURPOSE. VENDOR SHALL HAVE NO LIABILITY TO PURCHASER OR ANY THIRD PARTY FOR ANY SPECIAL, INDIRECT, PUNITIVE, INCIDENTAL, OR CONSEQUENTIAL DAMAGES.** Vendor further disclaims any implied or express warranty of, and assumes no responsibility for, defects in workmanship caused by third parties.

This Limited Warranty gives the purchaser specific legal rights; a purchaser may have other rights depending upon where he or she lives. Some jurisdictions do not allow the exclusion or limitation of special, incidental or consequential damages, or limitations on how long a warranty lasts, so the above exclusion and limitations may not apply to everyone.

Vendor does not authorize any person or company to assume for it any other obligation or liability in connection with the sale, installation, use, removal, return, or replacement of its equipment, and no such representations are binding on Vendor.

Blue Rhino Global Sourcing, Inc  
Winston-Salem, North Carolina USA  
(800) 762-1142

## Troubleshooting

Please visit [www.bluerhino.com](http://www.bluerhino.com) or call 1.800.762.1142.

Notes / Remarques / Notas:

**Parts List / Liste des pièces / Lista de piezas**

<b>1</b>	Cap* / Couverture* / Tapa*	55-10-013
<b>2</b>	Globe* / Globe* / Globo*	55-10-014
<b>3</b>	Chain* / Chaîne* / Cadena*	55-10-015
<b>4</b>	Wire Guard* / Protecteur métallique* / Resguardo de alambre*	55-10-016
<b>5</b>	Mantle* / Manchon* / Camisa*	55-10-017
<b>6</b>	Igniter* / Allumeur* / Encendedor*	55-10-018
<b>7</b>	Base / Socle / Base (Not Included / Non inclus / No incluido)	55-09-287
<b>8</b>	Body* / Cuve du* / Carcass de la*	55-10-020
<b>9</b>	Control Knob* / Bouton de commande* / Perilla de control*	55-10-019

\* Pre-assembled / Pré-assemblé / \* Viene ensamblado

**Exploded View / Vue éclatée / Diagrama de explosión**

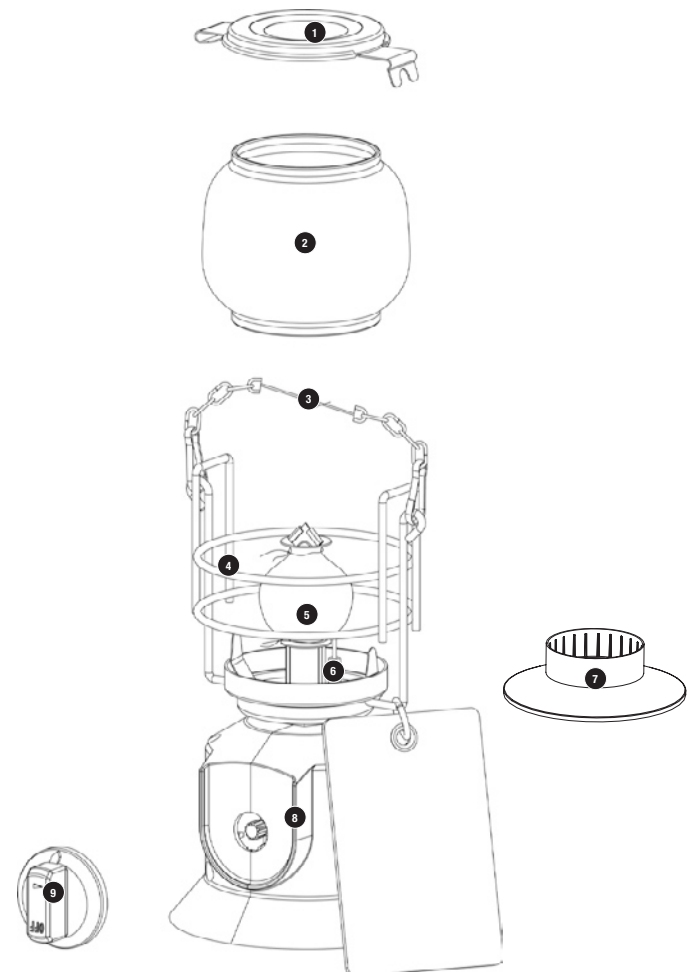

## Free Manuals Download Website

<http://myh66.com>

<http://usermanuals.us>

<http://www.somanuals.com>

<http://www.4manuals.cc>

<http://www.manual-lib.com>

<http://www.404manual.com>

<http://www.luxmanual.com>

<http://aubethermostatmanual.com>

Golf course search by state

<http://golfingnear.com>

Email search by domain

<http://emailbydomain.com>

Auto manuals search

<http://auto.somanuals.com>

TV manuals search

<http://tv.somanuals.com>