

BOSE[®]

Bose[®] in-ear headphones



Owner's Guide
Brugervejledning
Bedienungsanleitung
Guía de usuario
Notice d'utilisation
Manuale di istruzioni
Gebruiksaanwijzing
Bruksanvisningen
คู่มือผู้ใช้
사용자 안내서
用戶指南
دليل المالك

Welcome

Thank you for purchasing the Bose® in-ear headphones. Bose® in-ear headphones offer a combination of lifelike audio performance and comfortable fit not available from most conventional earbuds. Proprietary Bose technologies provide a new level of listening pleasure with performance that's faithful and realistic. Three sizes of ear tips allow them to rest gently and softly in the outer bowl of the ear (not your ear canal). A carrying case is included, small enough to fit in your pocket.

Your headphones include:

- Small, medium, and large ear tips. Medium tips already attached.
- Compact carrying case

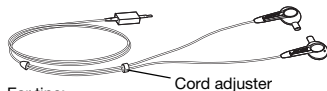

Ear tips:

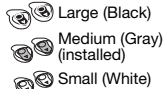

Using your headphones

Bose® in-ear headphones are packaged with medium-sized silicone ear tips installed; small- and large-sized ear tips are also included in the package. Locate the left (L) and right (R) markings on the headphones. With your selected ear tips on the headphones, gently insert the headphones into your ears so that the tips rest comfortably in the concha, the bowl of the ear just outside the ear canal. The headphones should be pushed into the ear far enough to establish a secure fit but not so far that they become uncomfortable. Do not attempt to wear the headphones without the ear tips.



Correct



Incorrect

Unlike some products that need to be pushed into the ear canal to perform as intended, Bose in-ear headphones are designed to rest comfortably in the bowl of the ear. Because of this, they may feel different at first from what listeners are accustomed to. The soft silicone ear tip barely contacts the opening to the ear canal; it provides just enough contact to secure the headphones in place comfortably without forming a tight, isolating seal.

Choosing the correct size ear tip to ensure proper fit

Some users may find that the small or large sized tips provide a more appropriate fit. It is also possible that some users may prefer different sizes of ear tips for each ear.

Larger sizes may be preferable if users plan to use them during certain activities such as exercise. One size larger ear tip may offer a little more contact with the ear, enhancing stability.

We encourage each user to experiment with the different ear-tip sizes until finding the combination that works best for them.

Changing ear tips

1. Gently remove the existing ear tip by peeling up from its large rounded side.
2. Align the triangle on the replacement ear tip with the triangle on the headphone.
3. Press the ear tip securely into place until you feel it latch. The large rounded side of the ear tip should completely cover the triangle on the headphone.

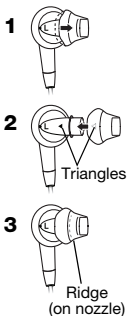

Connecting to an audio device

You can connect the headphones to any device that has a 3.5 mm stereo plug.

1. Turn down the volume of the audio device.
2. Plug the headphones into the audio output jack on the device.
3. Put on the headphones.
4. Slowly turn up the volume on the device.

Using the “enhancement” features of audio devices

Many portable audio devices include features or settings which electronically alter the audio signal sent to the headphones. These may include “bass boost” or other EQ settings. Other features may serve to limit volume out such as “sound check” or “volume limit.” Finally, other features add spatialization effects such as “Surround”, “SMS”, “WOW”, or “3D.”

The Bose® in-ear headphones were designed to deliver high quality, balanced sound and deep, low notes without the need for any artificial enhancement. Therefore, when using the headphones we recommend that you first turn off all the enhancement features before making any personal adjustments to the audio settings.

Using the case

A high quality case is provided to protect the headphones as well as to help keep the cable from tangling.

1. For easiest use, open the case fully and hold the case as shown (A).
2. Place the headphones in the case as shown (B).
3. Wrap the cord around the holder, in either direction.
4. Press the plug in place as shown (C).

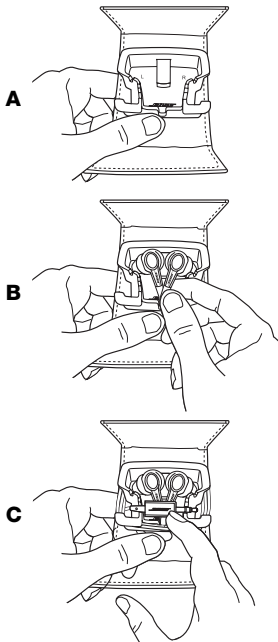

Cleaning

Your headphones may require periodic cleaning:

- **Ear tips:** First, remove them from the headphones and wash the tips with a mild detergent and water. Make sure you thoroughly rinse and dry them before putting them back on the headphones.
- **Headphone nozzles:** Clean the nozzles only with a dry, soft cotton swab or equivalent. Never insert any cleaning tool into the nozzle opening.

WARNINGS:

- *Long-term exposure to loud music may cause hearing damage. It is best to avoid extreme volume when using headphones, especially for extended periods.*
- *Do not use these headphones when operating a motor vehicle on a public road, or where the inability to hear outside sounds may present a danger to you or others.*

CAUTIONS:

- *Sounds that you rely on as reminders or warnings may have an unfamiliar character when using headphones. Be aware of how these sounds may vary in character so you can recognize them as needed.*
- *Do not drop, sit on, or allow the headphones to be immersed in water.*



This product conforms to the EMC Directive 89/336/EEC.

The complete Declaration of Conformity can be found at

www.Bose.com/compliance.

Troubleshooting

If you experience any trouble using your headphones, try the following troubleshooting instructions. If you still need help, see the contact information on the inside back cover for assistance in your area.

Problem	What to do
No audio/ Intermittent	Make sure that the headphone plug is securely connected to the headphone jack (not the line out jack) of the audio device.
Excessive bass	Turn off any bass boost or other audio enhancement features on the audio source.
Low volume/ poor audio	Turn off any "sound checker" or other audio signal altering features on the audio source.
Eartips falling off	Make sure to securely attach the eartips by aligning the triangles on the tip and housing and pressing the tip into place.
Lost eartip	Contact the service representatives appropriate for your region (on back page) to order replacements.

Replacement parts and accessories

Accessories or replacement parts can be ordered through Bose Customer Service. See the contact information for your area included in this guide. For replacement ear tips, call 1-800-611-1715 (US only).

- Carrying case
- Ear tips (S/M/L)

BOSE CORPORATION

Australia

Phone: 1 800 023 367
www.bose.com.au

Belgique/België

Phone: 012 390800
Fax: 012 390840

Canada

Phone: 1-800-465-2673
Fax: 1-800-862-2673
www.bose.ca

China

Phone: 86-21-62713000,
x162
Fax: 86-21-62713008

Danmark

Phone: 04343-7777
Fax: 04343-7818

Deutschland

Phone: +49-5921-724142
Fax: +49-5921-724251
www.bose.de

France

Phone: 01-30616363
Fax: 01-30616382
www.bosefrance.fr

India

Phone: 1 600 11 2673
Fax: 91 11 2307 3823
www.boseindia.com

Ireland

Phone: (042) 9671500
Fax: (042) 9671501
www.bose.ie

Italia

Phone: 06 60 292 292
Fax: 06 60 292 119
www.bose.it

Japan

Phone: 0120-130-168
Fax: 03-5489-1069
www.bose.co.jp

Mexico

Phone: +52 (55) 52 02 35 45

Fax: +52 (55) 52 02 41 95

Nederland

Phone: 0299-390111

Fax: 0299-390109

www.bose.nl

New Zealand

Phone: 0800 501 511

Norge

Phone: 62 82 15 60

Fax: 62 82 15 69

Österreich

Phone: 01-60404340

Fax: 01-604043423

Schweiz

Phone: 061-9757733

Fax: 061-9757744

Sverige

Phone: 031-878850

Fax: 031-274891

United Kingdom

Phone: 0870 7414500

Fax: 0870 7414545

www.bose.co.uk

United States

Phone: 1-888-757-9943

1-800-611-1715

(for replacement tips)

Fax: 1-877-289-4366

www.bose.com

World Wide Web

www.bose.com

www.boseeurope.com



299347

BOSE[®]
Better sound through research[®]

©2007 Bose Corporation, The Mountain,
Framingham, MA 01701-9168 USA
AM299347 Rev.02

Free Manuals Download Website

<http://myh66.com>

<http://usermanuals.us>

<http://www.somanuals.com>

<http://www.4manuals.cc>

<http://www.manual-lib.com>

<http://www.404manual.com>

<http://www.luxmanual.com>

<http://aubethermostatmanual.com>

Golf course search by state

<http://golfingnear.com>

Email search by domain

<http://emailbydomain.com>

Auto manuals search

<http://auto.somanuals.com>

TV manuals search

<http://tv.somanuals.com>