

Bravetti™

PLATINUM PRO

Swivel Head Food Processor

OWNER'S MANUAL

Model FP110H

120V., 60Hz., 550 Watts

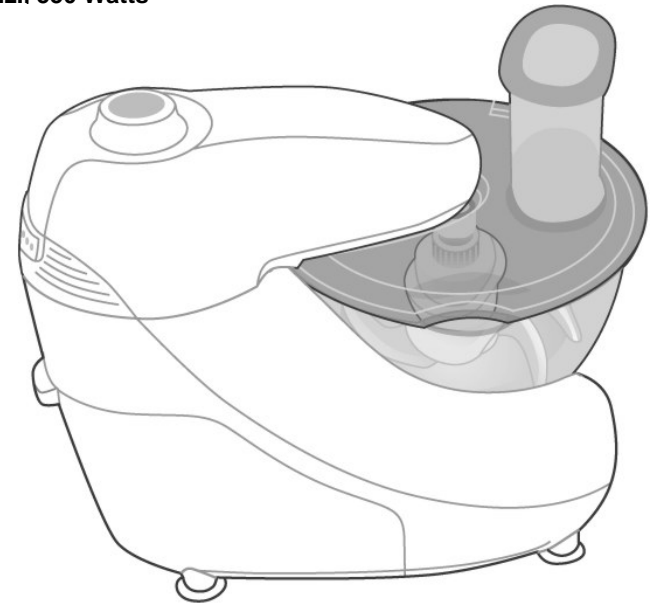

USA: EURO-PRO OPERATING LLC
94 Main Mill Street, Door 16
Plattsburg, NY 12901

Canada: EURO-PRO OPERATING LLC
4400 Bois Franc
St. Laurent, QC H4S 1A7

Tel.: 1 (800) 798-7398



ONE (1) YEAR LIMITED WARRANTY

EURO-PRO Operating LLC warrants this product to be free from defects in material and workmanship for a period of one (1) year from the date of purchase when utilized for normal household use.

If your appliance fails to operate properly while in use under normal household conditions within the warranty period, return the complete appliance and accessories, freight prepaid to:

US: **EURO-PRO Operating LLC**, 94 Main Mill Street, Door 16, Plattsburgh, NY 12901

Canada: **EURO-PRO Operating LLC**, 4400 Bois Franc, St Laurent, Qc, H4S 1A7

If the appliance is found to be defective in material or workmanship, **EURO-PRO Operating LLC** will repair or replace it free of charge. Proof of purchase date must be included.*

The liability of **EURO-PRO Operating LLC** is limited solely to the cost of the repair or replacement of the unit at our option. This warranty does not cover normal wear of parts and does not apply to any unit that has been tampered with or used for commercial purposes. This limited warranty does not cover damage caused by misuse, abuse, negligent handling or damage due to faulty packaging or mishandling in transit.

This warranty is extended to the original purchaser of the unit and excludes all other legal and/or conventional warranties. The responsibility of **EURO-PRO Operating LLC** if any, is limited to the specific obligations expressly assumed by it under the terms of the limited warranty. **In no event is EURO-PRO Operating LLC** liable for incidental or consequential damages of any nature whatsoever. Some states do not permit the exclusion or limitation of incidental or consequential damages, so the above may not apply to you.

This warranty gives you specific legal rights, and you may also have other rights which vary from state to state.

***Important: Carefully pack item to avoid damage in shipping. Be sure to include proof of purchase date and to attach tag to item before packing with your name, complete address and phone number with a note giving purchase information, model number and what you believe is the problem with item. We recommend you insure the package (as damage in shipping is not covered by your warranty). Mark the outside of your package "ATTENTION CUSTOMER SERVICE". We are constantly striving to improve our products, therefore the specifications contained herein are subject to change without notice.**



OWNERSHIP REGISTRATION CARD

Please fill out and mail the product registration card within ten (10) days of purchase. The registration will enable us to contact you in the unlikely event of a product safety notification. By returning this card you acknowledge to have read and understood the instructions for use, and warnings set forth in the accompanying instructions. **RETURN TO:**

EURO-PRO OPERATING LLC, 94 Main Mill Street, Door 16, Plattsburgh, NY 12901

FP110H
Appliance model

Date purchased Name of store

Owner's name

Address City State Zip Code

IMPORTANT SAFETY INSTRUCTIONS

When using electrical appliances, basic safety precautions should always be followed, including the following:

1. Read all instructions before using the appliance. It is suggested that you keep these instructions in a safe place for future reference.
2. Your voltage must correspond to the voltage printed on the bottom of the appliance.
3. To protect against electrical shock, do not immerse the motor housing (base), cord, or plug in water or other liquid.
4. Close supervision is necessary when the appliance is used by or near children.
5. Unplug appliance from outlet when not in use, before putting on or taking off parts and before cleaning.
6. Avoid touching moving parts at all times.
7. **Do not** operate the appliance with a damaged cord or plug, or after the appliance malfunctions, has been dropped or damaged in any manner. Return the appliance to **EURO-PRO Operating LLC** for examination, repair, electrical or mechanical adjustment.
8. The use of attachments including canning jars not recommended by the manufacturer may cause fire, electric shock or injury to persons.
9. **Do not** use outdoors.
10. **Do not** let cord hang over edge of table or counter or touch hot surfaces.
11. Keep hands and utensils away from moving blades or discs while processing food to reduce the risk of severe injury to persons or damage to the food processor. A scraper may be used but must be used only when the food processor is not running.
12. **Blades are sharp. Handle carefully.** When handling the chopper blade always hold it by the plastic hub.
13. To reduce the risk of injury, **never** place cutting blades or discs on the base without first putting bowl properly in place.
14. Be certain cover is securely locked in place before operating appliance.
15. **Never** feed food by hand. Always use food pusher.
16. **Do not** attempt to by-pass the cover interlock mechanism.
17. Always operate food processor with the cover in place.

SAVE THESE INSTRUCTIONS FOR HOUSEHOLD USE ONLY

Operating Instructions

Congratulations! As the owner of a new **Swivel Head Food Processor**, you are about to use a very versatile and powerful kitchen appliance that will quickly become an indispensable item in your kitchen. Bravetti Platinum Pro products are engineered to meet the highest quality standards and are designed to offer the ultimate in ease of operation and convenience.

IMPORTANT INFORMATION

Please read all the following instructions carefully:

IMPORTANT

For your protection, the **Swivel Head Food Processor** has a double safety switch so that it cannot run unless the bowl with lid is locked in place. **Do not** attempt to by-pass the safety interlock mechanism.

IMPORTANT

The swivel head will not rotate to the unlock position unless the control dial is in the "Off" position.

IMPORTANT NOTICE

This appliance has a polarized plug (one blade is wider than the other). To reduce the risk of electrical shock, this plug will fit in a polarized outlet only one way. If the plug does not fit fully in the outlet, reverse the plug. If it still does not fit, contact a qualified electrician. **Do not** modify the plug in any way.

Caution: Remove the protective blade guards from blades before using in the food processor.

SAVE THESE INSTRUCTIONS FOR HOUSEHOLD USE ONLY

Cleaning & Maintenance Instructions

Cleaning and Maintenance

Caution: Make sure that the unit is unplugged from the power source and the speed control dial is in the "OFF" position and press the swivel head release button before inserting or removing attachments.

- **Never** immerse the unit, cord or plug in water or any other liquid.
- Clean the main unit with a damp cloth only.
- **Use extreme caution when cleaning the chopping blade as the blades are very sharp.**
- All other parts can be cleaned in warm sudsy water using regular dishwashing liquid.
- If food has spilled over on to the main unit, use the pointy end of the spatula to clean the cracks and crevices of the base under the food processor bowl.
- The processor lid, protective blade guards, anti-slip pad and the sealing ring may be washed in lukewarm water and a mild dishwashing liquid. **DO NOT place these in the dishwasher.**

Using the Storage Compartment

The food processor comes with a blade storage compartment.

1. Pull the storage compartment out from the back of the unit. (Fig. 17)



Fig. 17

2. Place blades into the assigned slots inside as shown below. (Fig. 18)

Note: The blades only fit in each slot one way, with face of blade facing towards the center of the blade storage compartment. The **G** (large fry blade, faces the rear of the storage compartment).

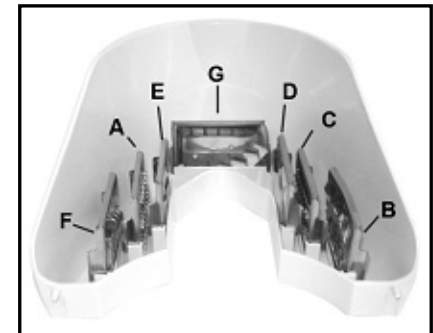

Fig. 18

Operating Instructions

Re-settable Thermal Safety Device

Your **Swivel Head Food Processor** has been designed with a unique safety system which prevents damage to the unit's motor and drive system, should you inadvertently overload your appliance. The safety system will automatically cut the electric power to the appliance when the device senses an overload or excessive temperature in the motor or drive system. Should this occur during use and the appliance stops functioning, following is the re-setting procedure:

1. Turn the On/Off speed control dial to the "Off" position
2. Unplug the unit from the wall receptacle and press the swivel head release button before inserting or removing attachments.

3. Remove and empty the processor bowl. Ensure that no food is jamming the cutting blades or attachments.
4. Allow the appliance to cool down for a minimum of **30 minutes**.
5. Re-install the processor bowl, turn the swivel head to the locked position and re-plug appliance in the wall outlet.
6. Proceed to use the appliance as before. Should the appliance still fail to operate, turn the On/Off speed control to the "Off" position and unplug from the wall outlet. Allow the appliance to cool down for an additional **1 to 2 hours**. After this time has passed, repeat the restart procedure, steps 5 and 6 above.

GETTING TO KNOW YOUR SWIVEL HEAD FOOD PROCESSOR

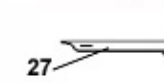
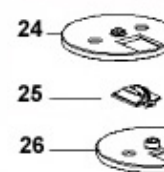
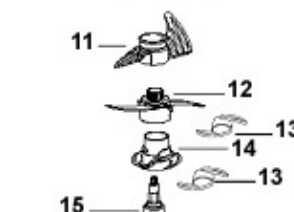
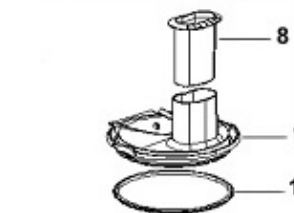

1. Swivel Head
2. Turbo Pulse Button
3. Speed Control Dial
4. Swivel Head Release Button
5. Food Processor Body
6. Blade Storage Compartment
7. Suction Cups
8. Food Processor Food Pusher
9. Processor Lid
10. Processor Lid Seal
11. Whipping Blade
12. Processor Double Blade
13. Protective Blade Guards (x2) (For storage purposes only)
14. Processor Main Chopping Blade
15. Processor Spindle
16. Food Processor Bowl
17. Processor Bowl Shaft
18. Julienne Blade
19. Grater
20. Thick Shredding Blade
21. Thin Shredding Blade
22. Thick Slicing Blade
23. Thin Slicing Blade
24. Main Blade Holder
25. French Fry Blade
26. French Fry Blade Holder
27. Spatula

Technical Specifications

Voltage: 120V., 60Hz.
 Power: 550 Watts
 Food Processor Capacity: 6 Cups (1.5 Liters)
 * Note: Illustrations may differ from actual product

Operating Instructions

Speed Control Dial

The speed control dial has speed settings as follows:

- Off
- 1 to 9
- Max
- Pulse/Turbo

The speed can be adjusted while the food processor is in use. (Fig. 1)

Use of the **Pulse/Turbo** button allows greater control over the texture of the food being processed. Use "Pulse" when the unit is in the "Off" position. Use "Turbo" when the unit is in the "On" position and you need a burst of power.

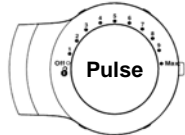

Fig. 1

Caution: The "Pulse" and "Turbo" function is only intended to be used for short "bursts" of processing. Damage to the unit may occur if this function is used for prolonged periods of time.

Operating The Food Processor

Setting Up:

Caution: Make sure that the unit is un-plugged from the power source and the swivel head is in the off position before inserting or removing any attachments and before cleaning.

Caution: Do not operate the unit for intervals longer than **20 seconds**. If longer chopping or mixing is required, run for **20 seconds**, allow motor to stop and run again for another **20 seconds**.

1. Place the food processor bowl onto the processor body. (Fig. 2)



Fig. 2

Caution: BLADES ARE SHARP! Always hold the blade assembly from the top. ALWAYS remove the chopping blade protective guards before using.

2. Assemble the main chopping blade onto the spindle. Ensure that the tabs on the underside of the spindle are aligned with the main chopping blade. (Fig. 3)

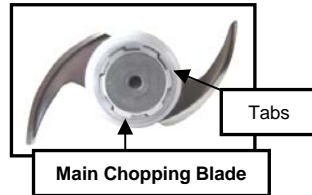

Fig. 3

3. Fit the spindle with chopping blade onto the motor shaft located on the bottom of the bowl. (Fig. 4)

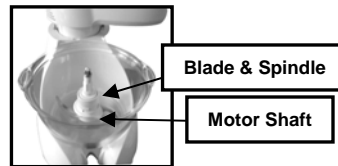

Fig. 4

4. Fit the processor lid onto the food processor bowl firmly.

Important: The unit will NOT operate without the processor lid in place and the swivel head in the locked position.

5. When fitted correctly, the lip on the processor lid will fit into the notch on the food processor body. (Fig. 5)

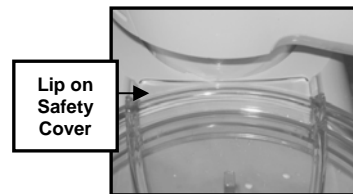

Fig. 5

Operating Instructions

Whipping Blade

Caution: Make sure that the unit is unplugged from the power source and the speed dial is in the "Off" position. Press the swivel head release button so that the swivel head is in the unlocked position before inserting or removing attachments.

Caution: Do not operate the unit for intervals longer than **20 seconds**. If longer chopping or mixing is required, run for **20 seconds**, allow the motor to stop and run again for another **20 seconds**.

1. Fit the processor bowl and spindle as previously described.
2. Fit the whipping blade over the spindle and press firmly into place. (Fig. 16)
3. Place the ingredients into the bowl.
4. Fit the lid onto the bowl. Rotate the swivel head and press to lock into position. Insert food pusher into feed chute.
5. Plug in the food processor.
6. Turn the food processor "On" selecting high speed.
7. Remove the whipping blade from the bowl before removing the whipped ingredients.



Fig. 16

FOR SAFETY, ALWAYS LEAVE THE PUSHER IN PLACE WHILE OPERATING THE PROCESSOR.

Note: Do not use for dough.

Hints & Tips for Whipping:

- Use to make whip egg whites or whipped cream.
- When whipping egg whites make sure that eggs are at room temperature for best results.

Processing Examples With The Whipping Blade

The processing times indicated below are approximate and also depend on the quantity of the food to be processed and the degree of fineness you require.

PRODUCT	QUANTITY	RECOMMENDED SPEED	OPERATION TIMES
EGGS	4 LARGE EGGS	1-MAX	10 – 20 SECONDS
WHIPPING CREAM	17.5 OZ/500mL	8 – MAX	15 – 30 SECONDS

* Always allow food to cool before placing in the bowl.

Operating Instructions

WARNING: USE THE FOOD PUSHER TO ADD FOOD INTO THE PROCESSOR BOWL THROUGH THE FEEDER TUBE.

- Do not overload the food processor bowl. In one operation, you can process a maximum of 5 cups (1250mL) of food.

French Fry Blade Assembly

Caution: Make sure that the unit is unplugged from the power source and the swivel head is in the "Off" position before inserting or removing attachments.

Caution: Do not operate the unit for intervals longer than 20 seconds. If longer chopping or mixing is required, run for 20 seconds, allow the motor to stop and run again for another 20 seconds.

The French Fry blade (G) may already be assembled onto the French Fry blade holder. (Marked as Fry Blade Holder.)

Note: The French Fry blade will only fit into the French Fry blade holder; identified by the higher hub.

- Place the spindle into the food processor bowl.
- Using the finger holes in the French fry blade holder, fit it over the spindle and press firmly into place. (Fig. 15)

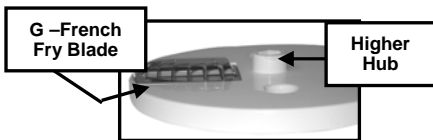

Fig. 15

WARNING: USE EXTREME CAUTION WHEN HANDLING BLADES. BLADES ARE SHARP.

- Place the lid on the food processor bowl, and lock the swivel head into position.
- Plug in the processor.

WARNING: USE THE FOOD PUSHER TO ADD FOOD INTO THE PROCESSOR BOWL THROUGH THE FEEDER TUBE.

- Do not overload the bowl. In one operation, you can process a maximum 5 cups (1250 ml) of food.

Processing Examples

Recommended speed for processing with chopping blades is High.

A		Thin Shredding (carrots, potatoes, cucumbers, cabbage)
B		Thick Shredding (Lettuce, carrots, onions)
C		Thick Slicing (Cabbage, carrots, onions)
D		Thin Slicing (Carrots, cucumbers, raw potatoes, lettuce)
E		Grating (Hard Cheeses)
F		Julienne (Vegetables)
G		French Fry (Potatoes)

Hints & Tips for French Fry, Shredding, Slicing, Grating & Julienne Blades

- For shredding, place food horizontally into the feeder tube.
- For slicing place the food vertically.
- If grating potatoes or apples, add 1 tsp lemon juice to prevent them from turning black.
- Potatoes can be sliced using the thin slicing blade for chips or use the large French Fry blade if making French fries.

Operating Instructions

- Turn the swivel head clockwise until it stops turning and push down until it "clicks" into place. (Fig. 6)

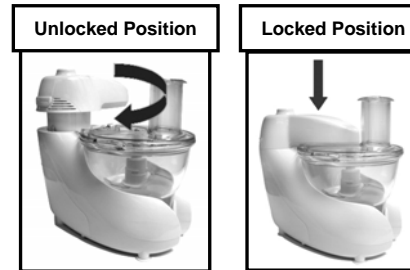

Fig. 6

- Plug in the processor and turn the speed control dial to the desired speed. If the processor does not come on, check that the swivel head and processor lid are both correctly fitted and locked into place. **For safety, always use the food pusher when putting food into the feeder tube. NEVER feed by hand.** (Fig. 7)



Fig. 7

Important: The food processor has a swivel head system. It cannot run unless the swivel head is locked. The swivel head cannot be opened unless the On/Off knob is turned to the "Off" position.

Using the Double Chopping Blade

Always disconnect unit from power source before cleaning or changing accessories.

Warning: USE EXTREME CAUTION WHEN HANDLING THE BLADES. THEY ARE EXTREMELY SHARP. ALWAYS remove the chopping blade protective guards before using.

Important Note: Do NOT operate continuously for more than 20 seconds at one time.

The food processor may be used with one blade or two blades, depending on type of food, finer chopping results, or speed of processing. (Fig. 8)

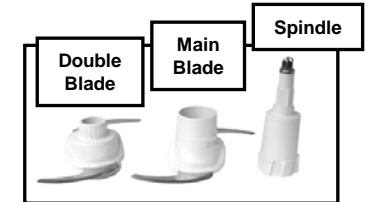

Fig. 8

- To open the food processor, ensure that the speed control dial is in the "Off" position and press the swivel head release button. (Fig. 9)

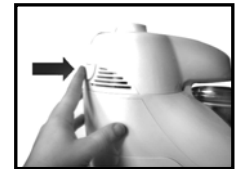

Fig. 9

- To use with a double blade, carefully slip the first blade onto the spindle. Hold this blade by the base. Hold second blade from top grip and place second blade on top of first. Turn second blade clockwise to lock into position. (Fig. 10)



Fig. 10

- Then place the blade assembly onto the shaft of the processor bowl. Always hold the chopping blade assembly by the top of the spindle.

Operating Instructions

- Place ingredients to be processed in the bowl.
- Place the processor lid onto the bowl with lip inside of the notch on the food processor body. Rotate the swivel head and press to lock into position. Insert the food pusher into the feeder tube.
- Plug the processor into a wall outlet.
- Turn the speed control dial to the desired speed setting.

Note: The food processor unit will not operate if the swivel head is not locked securely.

- Keep hands and utensils away from the cutting blades while chopping food to reduce the risk of severe injury to persons or damage to the food processor. A scraper may be used, but **ONLY** when the food processor is **NOT** running and has been unplugged. **Never feed food by hand. Always use the food pusher.** (Fig. 11)



Fig. 11

- When finished processing the ingredients, turn the speed control dial to the "Off" position and press the swivel head release button. The swivel head will automatically turn to allow you to remove the bowl lid.
- Remove the chopping blade(s) first before removing the processed food.

FOR SAFETY, ALWAYS USE THE FOOD PUSHER WHEN PUTTING FOOD INTO THE FEEDER TUBE. NEVER FEED BY HAND.

Processing Examples With The Double Chopping Blade

The processing times indicated below are approximate and also depend on the quantity of the food to be processed and the degree of fineness you require.

PRODUCT	QUANTITY	RECOMMENDED SPEED	OPERATION TIMES (used in 10 - 20 second intervals)
MEAT*	24.5 oz / 700 gr.	MAX	15 - 30 SECONDS
ONIONS	24.5 oz / 700 gr.	5 - 6	15 - 30 SECONDS
NUTS	21 oz / 600 gr.	8-MAX	15 - 30 SECONDS
FISH*	24.5 oz / 700 gr.	1 - 8	15 - 30 SECONDS
CHEESE	24.5 oz / 700 gr.	1 - 8	15 - 30 SECONDS
LIQUIDS (SOUPS)	24.5 oz / 700 gr.	1 - 8	10 - 20 SECONDS
CARROTTS	24.5 oz / 700 gr.	6 - 8	30 SECONDS
BREAD	4 SLICES	6 - 8	15 - 30 SECONDS
APPLES	24.5 oz / 700 gr.	8 - MAX	15 - 30 SECONDS
PARSLEY	MAX 4 BUNDLES	MAX	15 - 30 SECONDS

* Remove all bones before processing.

** Always allow food to cool before placing in the bowl.

Operating Instructions

Hints & Tips for Chopping Blades:

- The double chopping blade can be used for chopping meat, fish, vegetables, cheese, etc. setting the speed to maximum.
- For finer chopping, increase the length of time you process.
- For coarser chopping, use the pulse button for a few seconds and monitor food texture.
- Pre-cut larger pieces to make them fit into the feeder tube. When chopping hard foods (e.g. meat, cheese) cut into 1-inch (2.4 cm) cubes.

Slicing, Shredding, Grating & Julienne Blade Assembly

Caution: Make sure that the unit is unplugged from the power source and the speed control dial is in the "Off" position. Press the swivel head release button so that the swivel head is in the unlocked position before inserting or removing attachments.

Caution: Do not operate the unit for intervals longer than **20 seconds**. If longer chopping or mixing is required, run for **20 seconds**, allow the motor to stop and run again for another **20 seconds**.

- Place the blade of your choice on the blade holder. Insert the longer tab on the side of the blade holder first. (Fig. 12)

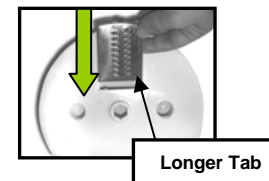

Fig. 12

- Press the other end of the blade until it clicks into place. (Fig. 13)



Fig. 13

- Place the spindle into the food processor bowl.
- Using the finger holes in the blade holder, fit it over the spindle and press firmly into place as indicated. (Fig. 14)

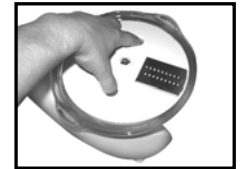

Fig. 14

Warning: Use Extreme Caution When Handling Blades. Blades Are Sharp.

- Place the lid on the food processor bowl, and lock the swivel head into position.
- Plug in the processor and select desired speed on speed control dial.

Free Manuals Download Website

<http://myh66.com>

<http://usermanuals.us>

<http://www.somanuals.com>

<http://www.4manuals.cc>

<http://www.manual-lib.com>

<http://www.404manual.com>

<http://www.luxmanual.com>

<http://aubethermostatmanual.com>

Golf course search by state

<http://golfingnear.com>

Email search by domain

<http://emailbydomain.com>

Auto manuals search

<http://auto.somanuals.com>

TV manuals search

<http://tv.somanuals.com>