

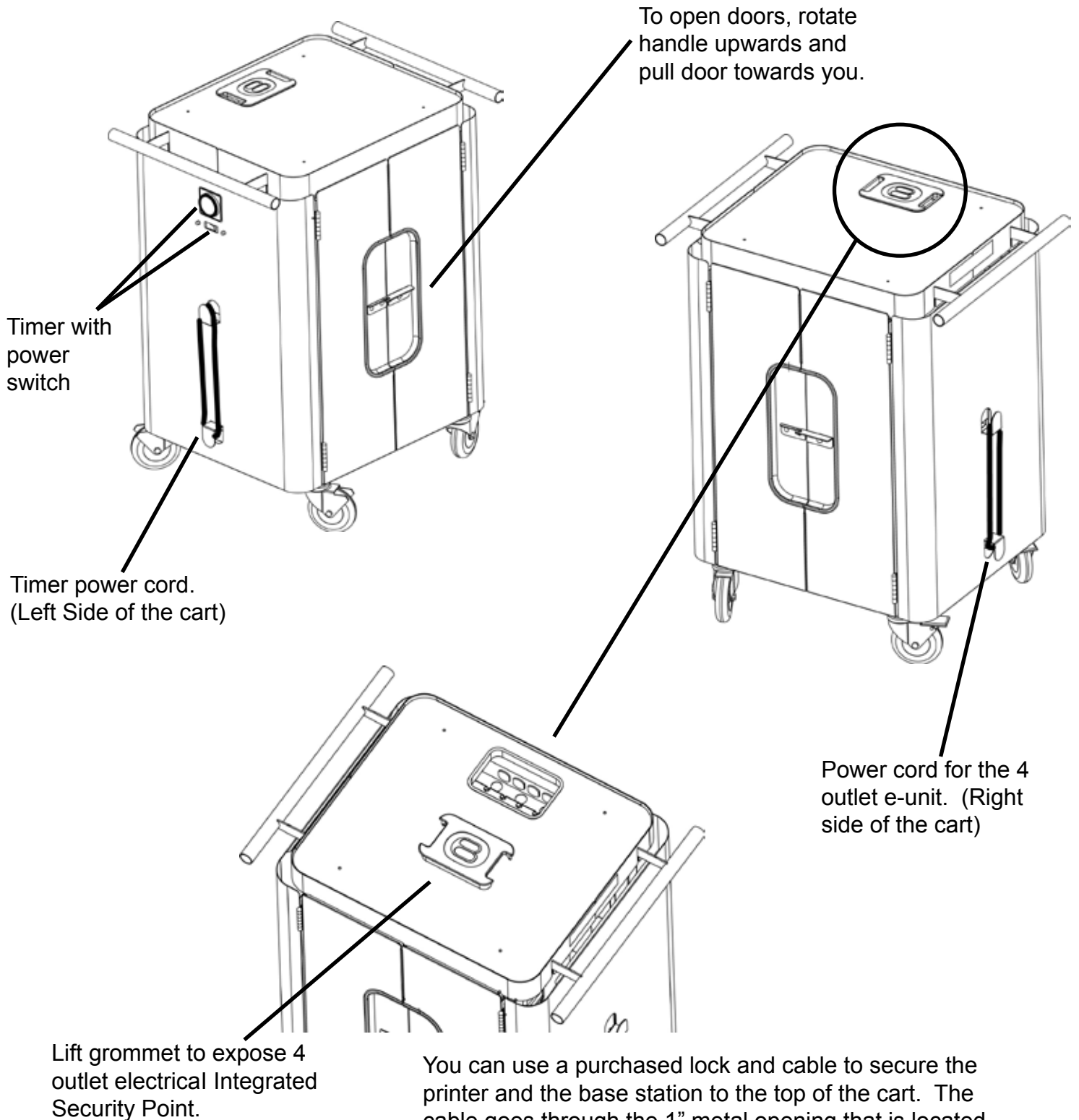

**BRETFORD**

**TL473LL/A**

**20 LAPTOP MOBILITY CART**



Timer with power switch

Timer power cord.  
(Left Side of the cart)

To open doors, rotate handle upwards and pull door towards you.

Power cord for the 4 outlet e-unit. (Right side of the cart)

Lift grommet to expose 4 outlet electrical Integrated Security Point.

You can use a purchased lock and cable to secure the printer and the base station to the top of the cart. The cable goes through the 1" metal opening that is located directly below the accessory power strip.

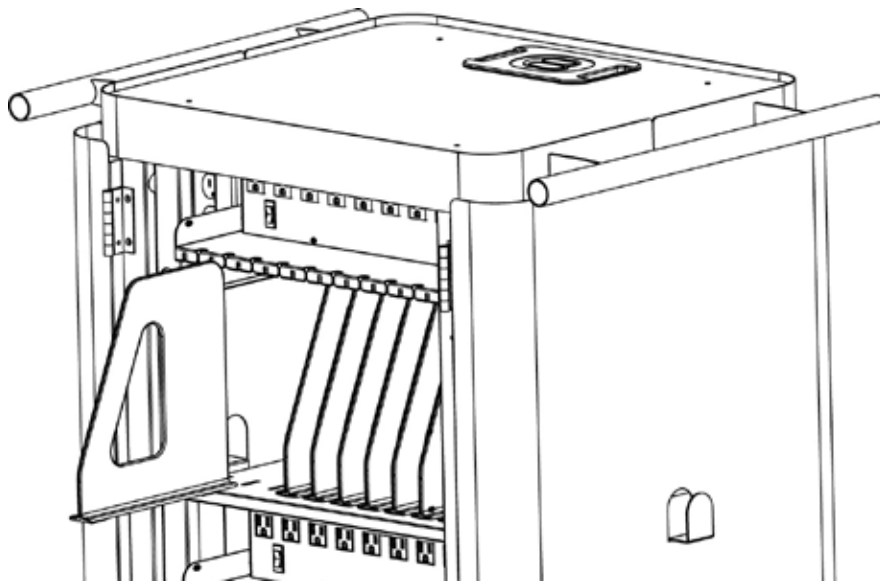

**All dividers are loaded into the cart prior to shipment.**

**To remove dividers:** First, pull upwards on the front of the divider to unsnap the front foot from the shelf, and then pull the divider up and out towards yourself, guiding the top edge through the slots above.

**To reinstall dividers:** Slide the divider into the cart, guiding the top edge through the slots above. Hook the lower rear divider foot into the back slot in the shelf. Then push the front edge downwards to snap the front foot in place.

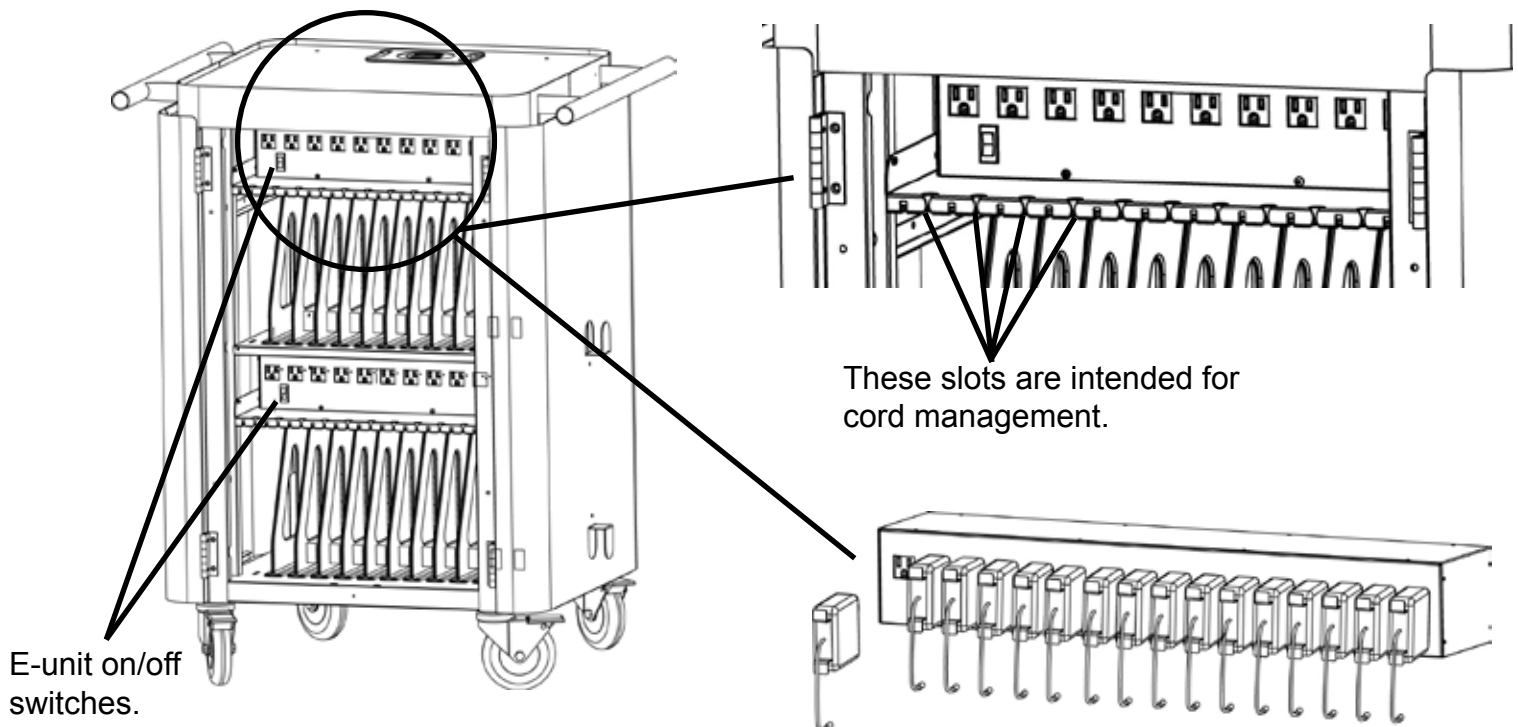

### **CHARGING LAPTOPS**

1. Make sure timer switch (outer left side of cart) is in the OFF position.
2. Slide laptops into storage compartments.
3. Plug brick into AC outlet above each laptop.
4. Plug timer power cord into wall outlet.
5. Turn switch to the ON position.

**CAUTION:** Only listed laptops may be used in the laptop cart.

# Bretford 20 Laptop MOBILITY Cart

TL473LL/A

**Ships 100% assembled**

## **12-year Guarantee**

12-year warranty  
(1 year on electrical).

## **Storage**

Cart features two shelves with compartments per shelf for storage of up to 20 laptops.

## **Charges 20 Laptops**

20-outlet UL electrical system includes an Automatic Timer/Charger Unit for the ability to charge all laptops using one circuit.

## **Extra Power**

Cart features a large working surface and an extra four-outlet power source to support an extra laptop, a base station and a printer.

## **Compact Design**

Although this cart can store and power up to 20 laptops, the exclusive quiet-glide wheels and compact size make it very easy to move around.



## **Ventilation**

Ventilation channels allow for maximum air flow within the cart.

## **One Power Cord**

Single grommet hole and cord enables cart to be plugged into wall for easy charging of laptops.

## **Flexible**

Shelf dividers may be removed for storing larger items.

## **Security**

Heavy duty doors and combination lock system on front of cart ensure security of equipment.

## **Cord Management**

Individual cord holders for each laptop provide convenient cord management.

# Specification Sheet

## TL473LL/A



## Technical Specifications

### Capacity

- 2 shelves divided equally into 10 compartments
- Holds and charges up to 20 laptops

### Size and Weight

- Overall: 33 1/4"W x 25 1/4"D x 44"H
- Compartments: 1 1/2"W x 11"H
- Top shelf: 25 1/4"W x 23 1/2"D
- Carton Pack: 48"W x 32"D x 48"H
- Ship Weight: 200 lbs.
- Actual Product Weight: 163 lbs.
- Ships by truck in one carton pack

### Assembly

- Ships already assembled in one pack (no assembly required)

### Power

- Two sources of Power
- First source includes two 10-outlet electrical units for charging laptops
- Each electrical unit mounts inside the front of the cart
- An on/off switch can be found on each electrical unit
- Includes an Automatic Timer/Charger which allows both electrical units to be charged using one circuit
- Electrical units plug directly into the Timer/Charger
- Timer/Charger switches the electrical current from one charging unit to the other
- Timer is resettable and ships standard with a two hour charging period per electrical unit - four hour charging time for all laptops
- Second source is a four-outlet power unit that is mounted in the top shelf providing power to accessory equipment
- All electrical components are UL listed and/or UL recognized
- The grey power strip unit is **NOT** the main power source for the laptop cart. It's intended use is for accessories **ONLY**.
- For pluggable equipment, the socket-outlet shall be installed near the equipment and shall easily be accessible.
- The plug on the end of the main line cord disconnects the main power.

### Construction

- Entire unit is constructed of 10-, 14-, 16 and 18-gauge steel
- Finish is an environmentally-safe Aluminum and white Power Paint that resists scratching and chipping
- Ventilation channel wraps around the cart so units stay cool while charging
- Cart rolls on four 5" plate casters on the corners for easy turning and moving over thresholds

### Security

- Cart features a 3-point locking system and a 40mm resettable combination lock for securing of the front doors of the cart.

# Bretford 20 Laptop MOBILITY Cart

TL473LL/A

## General Use

This cart is designed to allow you to easily store, secure, recharge and transport laptops and peripherals between classrooms. Please read these operating instructions carefully. It contains important advice concerning the use, and safety of your Bretford Cart. Keep these operating instructions in a safe place and pass them on to any subsequent user. This cart must only be used for its intended purpose in accordance with these operating instructions.

## Caution

- This cart is not designed to be operated by a child or student. Adult operation and supervision is recommended at all times.
- Although this cart is designed to support the transport of equipment within a school campus, it is not designed for outdoor use.
- Liquids should not be stored in, set on or placed inside this unit.
- Turn power switch to the off position before plugging in or unplugging the electrical units.
- Do not unplug this product from the outlet when your hands are wet.
- Do not move the cart by pulling the power cord.
- Do not plug the unit in if the switch, receptacle(s) or power cord has been damaged.
- Contact Bretford or a qualified electrician before attempting to make any type of electrical repair or parts replacement.

## Safety

- Before moving this cart from one room to the next, wrap the power cord around the cord winder located on the side of the cart.
- Do not pull cart. Always push the cart using the ergonomic handles.
- Engage locking casters when cart is not in transit.
- Use extra caution on ramps and thresholds.

# FREQUENTLY ASKED QUESTIONS

1. Who is Bretford?

Bretford Manufacturing, Inc. is a privately held company, founded in 1948 and headquartered in Franklin Park, Illinois, a northwest suburb of Chicago. Bretford is committed to providing the best communications furniture solutions to students, educators, professionals and consumers around the world through its innovative design and furniture systems. Bretford's Laptop Cart design philosophy is to provide a mobile product that allows education customers to easily store, secure, recharge and transport laptops and peripherals between classrooms.

2. How do I contact Bretford?

Web: [www.bretford.com](http://www.bretford.com)  
PH: 800.521.9614 ext.533  
FX: 800.343.1779

3. What number do I call if the cart is delivered damaged or I am missing a part?

- Call Bretford Customer Service at 800.521.9614 ext. 533.
- Tell the Bretford Customer Service Representative that you are an Apple customer in need of assistance and use the service code #19476.
- Bretford will take immediate action steps to solve any product damages/replacements.
- We will also record what type of resolution was made so that we can prevent any repeat errors in the future.

4. What type of lock/security feature does the cart come with?

Each cart features heavy duty steel doors that are secured with a 40mm combination padlock and 3-point steel locking system. Each lock combination may be reset by the user at any time with the reset key provided.

5. Is the electrical UL Listed?

Yes, all electrical components on Bretford carts are UL recognized and factory installed in the rear of each shelf. In addition to this, Bretford has successfully performed a variety of stability and safety tests on the cart.

6. Can the cart carry iBook computers as well as Powerbook computers?

Yes. All power and storage features of the cart are designed to support all types of iBook and Powerbook computers.

7. What about use in schools with older electrical wiring?

If you are unsure about the wiring in your school, Bretford strongly recommends that a qualified electrician test any circuits you will be using prior to plugging in the unit. The circuit should be checked for ground integrity and appropriate branch circuit protection.

8. What are the dimensions of the cart?

- Assembled cart measures 33 1/4"W x 25 1/4"D x 44"H
- Each compartment measures 1 1/2"W x 15 3/4"D x 11"H
- Shipping carton measures 48"W x 32"D x 48"H

9. I am concerned about storing the cart overnight. Any suggestions?  
Many of our customers choose to lock the cart in a closet or some type of secure environment. Please consult your facility manager if you have concerns about facility security.
10. How do I keep the cart from rolling away?  
Always engage all of the locking casters when cart is not in transit.
11. Can the cart roll away if it is on an incline?  
No, provided that you follow this instruction guide and always engage all of the locking casters when cart is not in transit.
12. Does the cart ship assembled?  
Yes.
13. How many computers can be charged?  
Up to 20
14. Can the cart be plugged in overnight?  
Yes. It is safe to leave the cart plugged in overnight in a secure and weather-protected room (obviously not under an open window).
15. How many computers can be loaded in the cart?  
Up to 20
16. Can the tires handle outside use?  
Yes. Although this cart should never be transported or used in inclement weather, the cart design supports transporting over rough surfaces or between campus buildings.
17. What is the weight of the cart with and without the laptops inside?  
This Bretford cart holds up to 20 iBooks and weighs only 163 lbs.
18. How long is the external power cord?  
The cord measures 10' in length. Before moving the cart from one room to the next, the power cords should be wrapped around the winders located on the rear of the cart.
19. Where can I place my peripheral items and presentation materials?  
The top shelf features a 23 1/2"D x 25"W general working surface. This provides the ideal space for a laptop, base station, printer and/or a projector.
20. How can I power up my extra presentation/peripheral equipment on the top shelf?  
There is a four-outlet power strip securely positioned inside the cord management bin on the top of the cart. For convenience, this power strip has a separate on/off switch and a separate power cord.
21. Can I charge all of the laptops off of one circuit?  
This Bretford cart features an automatic timer/charger unit. There are two 10-outlet electrical panels inside the cart and each one attaches to the timer unit requiring only one cord to be plugged into a wall outlet. Only one set of 10 laptops will charge at a time. When they are finished, the timer will switch to the other electrical unit to charge, thus allowing the use of one circuit rather than two.

## **INSTALLATION AND OPERATION MANUAL** **FOR BRETTFORD TIMER**

The Bretford Timer is a 24 hour time switch that provides accurate timing with 96 non-detachable-trippers that are adjustable in 15 minute increments up to 48 cycles per day. Easy to set and operate.

- First, plug the power cord into a 110 volt standard outlet. Set timer dial to desired timing scheme.
- Note: To activate "Side A" of the timer leave the trippers in the outward position.
- Push the trippers towards the center of the dial to activate equipment on "Side B".
- Now plug appropriate equipment into both "Side A & B". Toggle the power switch to the "ON" position. Let timer run as needed.

### SPECIFICATIONS:

**TIME CLOCK**- 24 HOUR

**RANGE**- 96, 15 MINUTE "SIDE A" OR "SIDE B" INCREMENTS

**POWER CORD**- 6 FOOT LONG

**VOLTAGE**- 125 VOLT AC 60 Hz

**AMPERAGE RATING**- 15 AMPERES MAXIMUM

**ENCLOSURE**- BLACK POWDER COATED STEEL

**DIMENSIONS**- 5 IN L x 5 IN W x 2.75 IN H

**SHIPPING WEIGHT**- 3 LBS.

**WARRANTY**- 1 YEAR FROM DATE OF MANUFACTURING

**PURPOSE**- TIME SWITCH

**CONSTRUCTION OF CONTROL**- IN-LINE CORD CONTROL ; ELECTRONIC

**TYPE 1 OR 2 ACTION**- TYPE 1

**LIMITATION OF OPERATING TIME**- LONG PERIOD

**CONTROL POLLUTION SITUATION**- NORMAL



# PAD LOCK - DOOR

## Resettable Combination Padlock

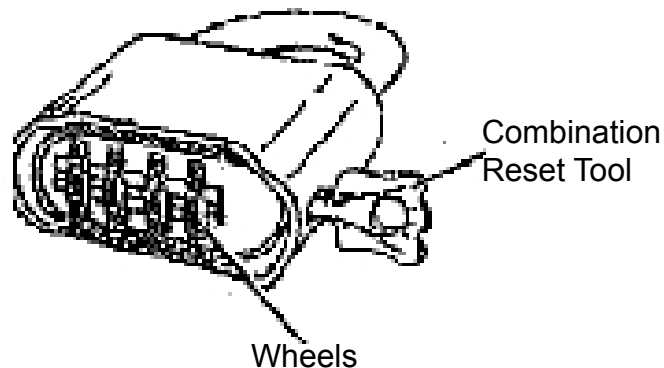

### Open Lock The First Time

- 1) Set the combination to 0-0-0-0
- 2) Depress shackle and pull open.

### To Set Your Own Combination

- \*\*REMEMBER:** Combination can only be set when lock is open.
- 1) Insert “reset” tool (included in package) in hole on side of lock.
  - 2) Push key in and turn key 90 degrees in either direction.  
(Key automatically stays in this position).  
Failure to exert force while pushing key in will result in a failed attempt to set or reset combination.
  - 3) Set wheels to desired combination. Depress the shackle to make sure the wheels are aligned.
  - 4) Turn and remove reset tool. Lock is now set to new combination.  
**\*\*BE SURE TO RECORD YOUR COMBINATION.**
  - 5) To lock scramble the wheels and close the shackle.
  - 6) To reopen dial your combination and depress shackle.

# WARRANTY

Bretford engineers and manufactures its products to provide dependable operation. Therefore, Bretford Manufacturing, Inc. warrants that all products it manufactures are at date of shipment free from defects in material or workmanship. Any product which under normal use fails to function within the time periods specified below and found defective in material or workmanship by the Company's inspection will be repaired or replaced without charge to the buyer or, at the election of Bretford Manufacturing, Inc., a credit will be allowed up to the invoice purchase price of the product. This warranty is inapplicable where, in the judgement of Bretford Manufacturing, Inc., the defect is attributable to normal wear, misapplication, abnormal use, misuse, modification or damage after shipment, including damage caused by the buyers failure to properly maintain, or other similar cause.

THIS WARRANTY IS EXPRESSLY IN LIEU OF ANY OTHER EXPRESSED OR IMPLIED WARRANTIES, INCLUDING ANY ORDINARY OR PARTICULAR PURPOSE. THERE ARE NO WARRANTIES WHICH EXTEND BEYOND THE DESCRIPTION ON THE FACE HEREOF.

Bretford Furniture  
Electrical Assemblies/Components

Twelve (12) years from date of shipment  
One (1) year from date of shipment

## Free Manuals Download Website

<http://myh66.com>

<http://usermanuals.us>

<http://www.somanuals.com>

<http://www.4manuals.cc>

<http://www.manual-lib.com>

<http://www.404manual.com>

<http://www.luxmanual.com>

<http://aubethermostatmanual.com>

Golf course search by state

<http://golfingnear.com>

Email search by domain

<http://emailbydomain.com>

Auto manuals search

<http://auto.somanuals.com>

TV manuals search

<http://tv.somanuals.com>