

Setup & Adjustment Instructions

LT-200 Series Tractors and Mowers



Mfg. No.	Description
<i>Tractors & Mower Combinations</i>	
2690437	LT-200, 20HP & 44" Mower Deck

Attention Setup Personal:



The safety warnings provided in this guide and in the operator's manual included with the unit contain important information that must be obeyed when assembling, setting-up, operating, servicing, transporting, or storing the unit. These warnings are highlighted by the safety alert triangle symbol shown above, which signifies that an important safety message is being provided.

You must read, understand, and follow these warnings and instructions, and use safe shop and work practices at all times while working on or around this unit and all other outdoor power equipment.

Setup



Sections and items denoted by the **Setup** symbol provide the information necessary to fully assemble, test, and prepare the units described above for delivery to your customers.

Adjust



Additional information concerning functional tests, general adjustment procedures, and the location of normal lubrication points are included in these instructions.

TABLE OF CONTENTS:

SAFETY RULES	2
SETUP PROCEDURES	
Quick Setup List	3
Uncrating	4
Battery Charging & Installation	4
Check Fluid levels	5
Check Transmission Oil Level	5
Fill and Check Engine Oil	5
Perform Safety Checks	6
Functional Tests	6
Mower Blade Stopping Check	6
Seat Switch Connection	6
Safety Interlock System	6
Torque Mower Blades	7
Burnishing the Electric PTO Clutch	7
Reduce and Check Tire Pressure	7
Lubrication	8
Hourmeter	11
Mower Adjustments & Assembly	10
Mower Deck Removal & Installation	10
Side-to-Side Leveling	11
Front-to-Back Leveling	11
ADJUSTMENT PROCEDURES	
Adjust Gauge Wheels	12
Seat Slide Adjustment	12
Electric PTO Clutch Adjustment	13
SERVICE PROCEDURES	
Mower Belt Replacement	14

Form No. 1734713-00

SAFETY RULES



Read these safety rules and follow them closely. Failure to obey these rules could result in loss of control of equipment, severe personal injury or death to you, yourself or bystanders, or damage to property or equipment. This mowing deck is capable of amputating hands and feet and throwing objects. The triangle in text signifies important cautions or warnings which must be followed.

IMPORTANT – Safe operation practices for riding mowers.

I. General operation

1. Read, understand, and follow all instructions in the manual and on the unit before starting.
2. Only allow responsible adults, who are familiar with the instructions, to operate the unit.
3. Clear the area of objects such as rocks, toys, wire, etc., which could be picked up and thrown by the blade(s).
4. Be sure the area is clear of other people before mowing. Stop the unit if anyone enters the area.
5. Never carry passengers.
6. Do not mow in reverse unless absolutely necessary. Always look down and behind before and while backing.
7. Be aware of the mower discharge direction and do not point it at anyone. Do not operate the mower without either the entire grass catcher or the guard in place.
8. Slow down before turning.
9. Never leave a running unit unattended. Always turn off blades, set parking brake, stop engine, and remove keys before dismounting.
10. Turn off blades when not mowing.
11. Stop engine before removing grass catcher or unclogging chute.
12. Mow only in daylight or good artificial light.
13. Do not operate the unit while under the influence of alcohol or drugs.
14. Watch for traffic when operating near or crossing roadways.
15. Use extra care when loading or unloading the unit into a trailer or truck.

II. Slope operation

Slopes are a major factor related to loss-of-control and tip-over accidents, which can result in severe injury or death. All slopes require extra caution. If you cannot back up the slope or if you feel uneasy on it, do not mow it.



WARNING – SLOPE OPERATION

Never operate on slopes greater than 17.6 percent (10°) which is a rise of 3-1/2 feet (106 cm) vertically in 20 feet (607 cm) horizontally. When operating on slopes that are greater than 15 percent (8.5°) but less than 30 percent use front counterweights and rear wheel weights (see your dealer). Select slow ground speed before driving onto slope. In addition to front and rear weights, use extra caution when operating on slopes with rear-mounted grass catcher. Mow UP and DOWN the slope, never across the face, use caution when changing directions and DO NOT START OR STOP ON SLOPE.

DO

- See your authorized dealer for recommendations of wheel weights or counterweights to improve stability.
- Mow up and down slopes, not across.
- Remove obstacles such as rocks, tree limbs, etc.
- Watch for holes, ruts, or bumps. Uneven terrain could overturn the unit. Tall grass can hide obstacles.
- Use slow ground speed so that you will not have to stop or change speeds while on the slope.
- Use extra care with grass catchers or other attachments. These can change the stability of the unit.

- Keep all movement on the slopes slow and gradual. Do not make sudden changes in speed or direction.
- Avoid starting or stopping on a slope. If tires lose traction, disengage the blade(s) and proceed slowly straight down the slope.

DO NOT

- Do not turn on slopes unless necessary, and then, turn slowly and gradually downhill, if possible.
- Do not mow near drop-offs, ditches, or embankments. The unit could suddenly turn over if a wheel is over the edge of a cliff or ditch, or if an edge caves in.
- Do not mow on wet grass. Reduced traction could cause sliding.
- Do not try to stabilize the unit by putting your foot on the ground.
- Do not use grass catcher on steep slopes.

III. Children

Tragic accidents can occur if the operator is not alert to the presence of children. Children are often attracted to the unit and the mowing activity. Never assume that children will remain where you last saw them.

1. Keep children out of the mowing area and under the watchful care of another responsible adult.
2. Be alert and turn unit off if children enter the area.
3. Before and when backing, look behind and down for small children.
4. Never carry children. They may fall off and be seriously injured or interfere with safe unit operation.
5. Never allow children to operate the unit.
6. Use extra care when approaching blind corners, shrubs, trees, or other objects that may obscure vision.

IV. Service

1. Use extra care in handling gasoline and other fuels. They are flammable and vapors are explosive.
 - a) Use only an approved container.
 - b) Never remove gas cap or add fuel with the engine running. Allow engine to cool before refueling. Do not smoke.
 - c) Never refuel the unit indoors.
 - d) Never store the unit or fuel container inside where there is an open flame, such as a water heater.
 - d) Clean up oil and fuel spills immediately.
2. Never run a unit inside a closed area.
3. Keep nuts and bolts, especially blade attachment bolts, tight and keep equipment in good condition.
4. Never tamper with safety devices. Check their proper operation regularly.
5. Keep equipment free of grass, leaves, or other debris build-up.
6. Stop and inspect the equipment if you strike an object. Repair, if necessary, before restarting.
7. Never make adjustments or repairs with the engine running.
8. Grass catcher components are subject to wear, damage, and deterioration, which could expose moving parts or allow objects to be thrown. Frequently check components and replace, when necessary, with manufacturer's recommended parts.
9. Mower blades are sharp and can cut. Wrap the blade(s) or wear gloves, and use extra caution when servicing them.
10. Check brake operation frequently. Adjust and service as required.
11. Allow the unit to cool before storing.



Quick Setup List -

Page	Setup Procedure	Steps to Perform
4	Uncrating	<ul style="list-style-type: none"> ○ Remove Crate & Banding. ○ Place Transmission Release Lever in PUSH position & Roll Tractor forward off skid.
4	Battery Charging & Installation	<ul style="list-style-type: none"> ○ Charge the Battery (<i>Note: proceed with other setup steps while battery is charging.</i>) ○ Install Battery.
5	Check Fluid Levels	<ul style="list-style-type: none"> ○ Check Transmission fluid level. ○ Fill & check Engine oil level.
6	SAFETY CHECKS	<ul style="list-style-type: none"> ○ Check for <u>LOOSE HARDWARE</u>. ○ Check all <u>OPERATOR CONTROLS</u>. ○ Test <u>PARKING BRAKE</u>. ○ Perform <u>MOWER BLADE STOPPING CHECK</u>. (Blade must stop within 5 seconds!) ○ Check the Seat Switch connection. ○ Perform <u>SAFETY INTERLOCK SYSTEM CHECK</u>.
7	Torque Mower Blades	<ul style="list-style-type: none"> ○ Torque mower blades to 45-55 ft.lbs. (61-75 Nm).
7	Burnish Electric Clutch	<ul style="list-style-type: none"> ○ Burnish Electric Clutch (<i>run for 15 seconds, repeat 10 times</i>).
7	Reduce & Check Tire Pressure	<ul style="list-style-type: none"> ○ Reduce & check Tire Pressure. (<i>Front Tires 12-15 psi, Rear tires 10-12 psi</i>)
8	Lubrication	<ul style="list-style-type: none"> ○ Lubricate all grease & oil points.
10	Mower Assembly	<ul style="list-style-type: none"> ○ Install Mower Deck onto Tractor and Attach Belt ○ Level Mower Deck (Side-to-side & Front-to-back).
14	Adjustment Procedures	<ul style="list-style-type: none"> ○ Gauge Wheels.

Setup

Uncrating

Using a reciprocating utility saw or equivalent, cut crate away from bottom skid. Remove crate. Remove shrink-wrap plastic.

2. Cut banding from front and rear tractor axles. Cut banding from mower rollers. Remove mower from bottom skid.



IMPORTANT NOTE

When cutting crate from bottom skid, use caution around tractor tires and mower rollers.

3. Hold brake pedal down (B, Figure 1) and push down on parking brake knob (C) to release parking brake.
4. Place hydro release lever in the PUSH position by pulling the release lever handle (D) back until it locks in the released position.
5. Be sure there are no nails or sharp objects on bottom skid to puncture the tractor's tires. Roll the tractor forward off the skid.

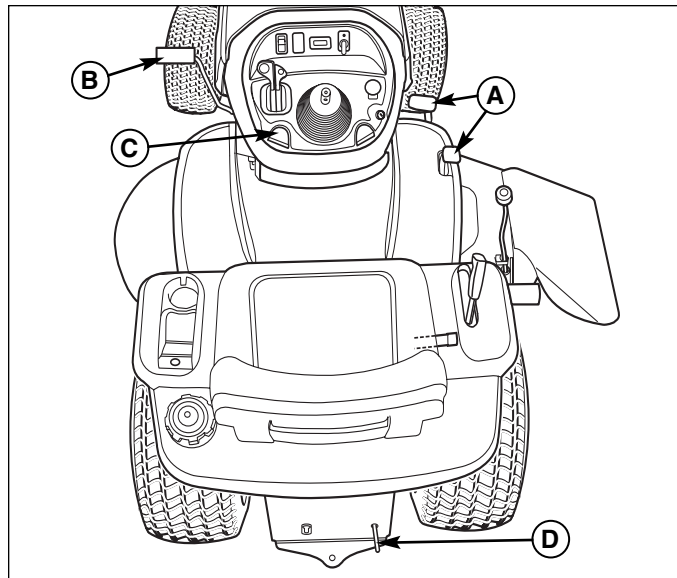

Figure 1. Engaging the Parking Brake

- A. Ground Speed Pedals**
- B. Brake Pedal**
- C. Parking Brake Knob**
- D. Hydro Release Lever**

Setup

Battery Charging & Installation

WARNING

BATTERY SAFETY RULES

- Battery acid causes severe burns. Avoid contact with skin.
- Wear eye protection while handling the battery.
- To avoid an explosion, keep flames and sparks away from battery, especially while charging.
- When installing battery cables, CONNECT THE POSITIVE (+) CABLE FIRST and negative (-) cable last. If not done in this order, the positive terminal can be shorted to the frame by a tool.

Charge Battery

1. Open the tractor hood to access the battery (E, Figure 2).
2. Loosen the wingnut & washer (D).
3. Pivot the hold-down rod (C) up and away from battery and secure.
4. Remove the battery (E).
2. To charge the battery, follow the instructions provided by the battery charger manufacturer as well as all warnings included in the safety rules section of this document. Charge the battery until fully charged. Do not charge at a rate higher than 10 amps.

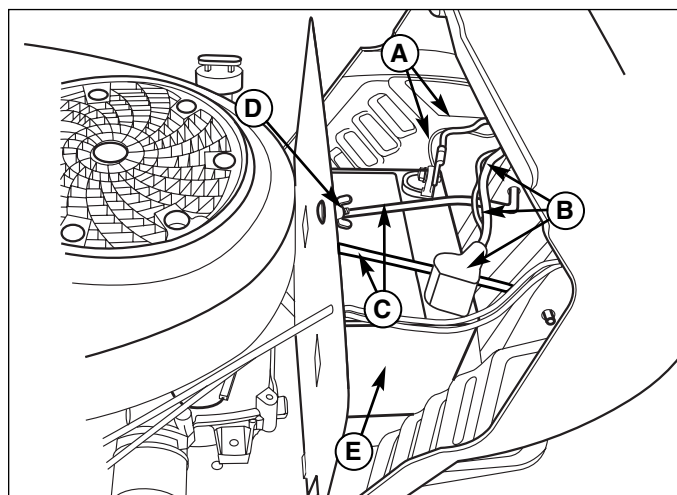

Figure 2. Battery Maintenance

- A. Negative Cables**
- B. Positive Cables & Cover**
- C. Hold-Down Rod**
- D. Wingnut & Washer**
- E. Battery**

Install Battery

1. Reinstall the battery (E) in the battery compartment, and secure with the battery hold-down rod (C) and wingnut & washer (D).
2. Reattach the battery cables, positive cables first (B) then the negative cables (A).
3. Coat the cable ends and battery terminals with petroleum jelly or non-conducting grease.



Check Fluid Levels

Check Transmission Oil Level

The K46 transmission is a sealed unit that is shipped with the correct oil level. However if a transmission's oil level is suspect it can be checked. See Transmission Maintenance.

Fill & Check Engine Oil

Service Interval: Before each use, and every 8 hours.

1. Turn the engine off, and set the parking brake to PARK.
2. Clean the area around the dip stick (C, Figure 3).
3. Remove the dip stick (C) and clean it with a paper towel.
4. Insert the dip stick (C) back into the engine and thread the cap back onto the tube.
5. Remove the dip stick and read the oil level. The oil level should be between the "FULL" and "ADD" marks (D). If not, add oil according to the oil recommendations chart (Figure 39 or 40).

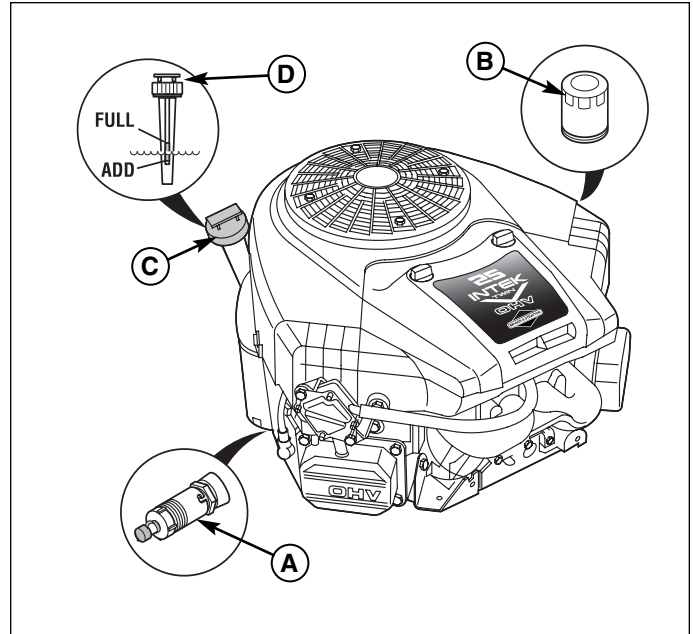

Figure 3. Briggs & Stratton two cylinder Models
A. Oil Drain Valve
B. Oil Filter
C. Dip Stick
D. Checking Oil Level

Setup **Perform Safety Checks**

WARNING

Disengage the PTO, stop the engine, set the parking brake, and wait for moving parts to stop before leaving operator's position for any reason.

If the tractor does not pass the test, do not operate tractor. Under no circumstance should you attempt to defeat the purpose of the safety system.

Functional Tests

1. Check the tractor for loose bolts, screws, nuts, etc.
2. Start the engine and check all controls for proper operation: ground speed control pedals, clutch/brake pedal, parking brake, throttle and choke cables, electric PTO clutch, headlight switch, steering, attachment lift, etc.
3. Stop the engine and check for fluid leaks: oil, gasoline, or transmission oil.
4. If any control fails to operate properly during testing or seems to be out of adjustment, check and readjust it according to the following Adjustments section.

Mower Blade Stopping Check

Mower blades and mower drive belt should come to a complete stop within five seconds after the electric clutch switch is turned off.

With the tractor in neutral, the electric clutch switch disengaged, and an operator in the seat, start the tractor engine. Run the engine at full throttle. Engage the electric PTO clutch switch and wait several seconds. Disengage electric clutch switch and check the time it takes for the mower drive belt to stop. If the mower drive belt does not stop within five seconds, adjust the PTO clutch according to the instructions in the Electric Clutch Adjustment section.

Seat Switch Connection

Check that the seat switch (A, Figure 4) is connected to the seat switch wire harness (B).

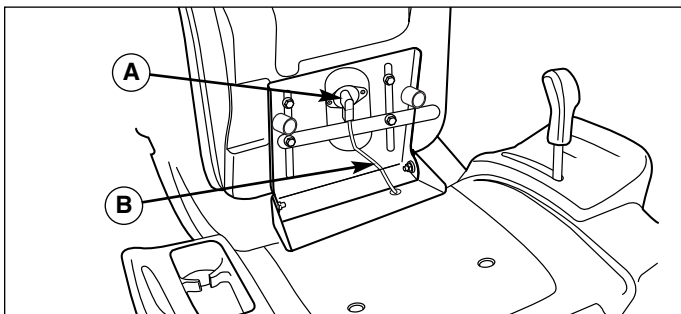

Figure 4. Seat Switch

- A. Seat Switch
- B. Wiring Harness

! Safety Interlock System Tests

This unit is equipped with safety interlock switches and other safety devices. These safety systems are present for your safety: do not attempt to bypass safety switches, and never tamper with safety devices. Check their operation regularly.

Operational SAFETY Checks

Your unit is equipped with a seat switch safety system. Check the seat switch operation every fall and spring with the following tests.

Test 1 — Engine should NOT crank if:

- PTO switch is ON, OR
- Brake pedal is NOT fully depressed (parking brake OFF),

Test 2 — Engine SHOULD crank if:

- PTO switch is OFF, AND
- Brake pedal is fully depressed (parking brake ON)

Test 3 — Engine should SHUT OFF if:

- Operator rises off seat with PTO engaged, OR
- Operator rises off seat with brake pedal NOT fully depressed (parking brake OFF).

Test 4 — Blade Brake Check

Mower blades and mower drive belt should come to a complete stop within five seconds after electric PTO switch is turned OFF (or operator rises off seat). If mower drive belt does not stop within five seconds, re-adjust the PTO clutch as described in the ADJUSTMENTS section or see your dealer.

Test 5 — Reverse Mow Option (RMO) Check

- Engine should shut off if: PTO is engaged AND RMO is not activated AND reverse pedal is depressed.
- RMO light should illuminate if: RMO is engaged AND PTO switch is activated.

NOTE: Once the engine has stopped, the PTO switch must be turned off after the operator returns to the seat in order to start the engine.

! WARNING

If the unit does not pass a safety test, do not operate it. See RMO Switch Adjustment. Under no circumstance should you attempt to defeat the purpose of the safety interlock system.

Setup **Torque Mower Blades**

! WARNING

For your personal safety, do not handle the sharp mower blades with bare hands. Careless or improper handling of blades may result in serious injury.

! WARNING

For your personal safety, blade mounting capscrews must each be installed with two spring washers or a hex washer and spring washer, then securely tightened. Torque blade mounting capscrew to 45 - 55 ft. lbs. (61 - 75 Nm).

1. Secure the hex washer (B, Figure 5), spring washer (C) and capscrew (D). Use a wooden block (A) to prevent blade rotation while tightening the blade bolt (D) to 45-55 ft. lbs. (61-75 Nm).

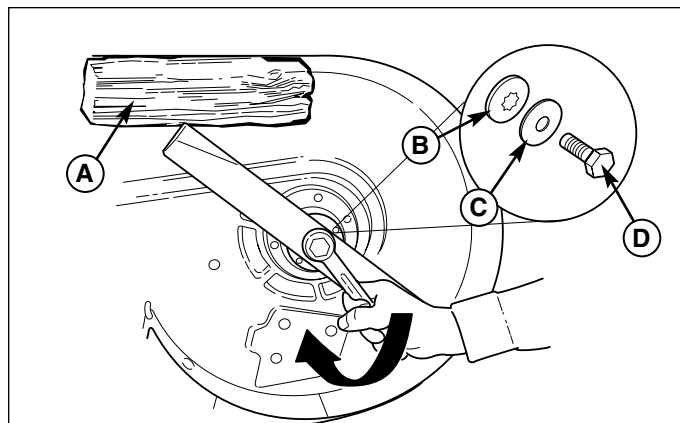

Figure 5. Blade Torque
A. 4x4 Wood Block
B. Spline or Hex Washer
C. Spring Washer
D. Blade Bolt

Setup **Reduce & Check Tire Pressures**

The tires are over-inflated for shipping purposes. Inflate to the pressures shown. Note that these pressures may differ slightly from the "Max Inflation" stamped on the side-wall of the tires. The pressures shown provide proper traction, improve cut quality, and extend tire life.

Setup **Burnishing the Electric PTO Clutch**

1. Select a safe area to operate the mower deck. With the drive in neutral, the PTO switch disengaged, and an operator in the seat, start the tractor engine. Run the engine at full throttle.
2. Engage the PTO switch and run the deck for fifteen seconds. Disengage the PTO switch and wait for the mower drive belt to stop.
3. Repeat step 2 above ten times, and then re-check the mower blade stopping time. (Stopping time must be five seconds or less.)

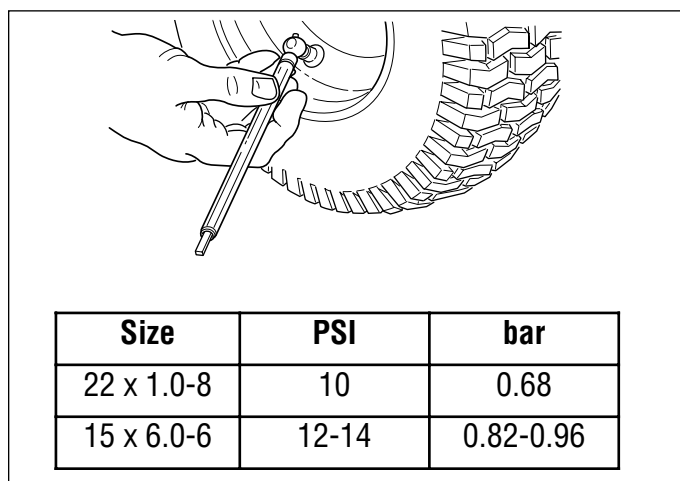

Figure 6. Tire Pressure

Setup

Lubrication

Lubricate the unit at the locations shown in Figures 7-10 as well as the lubrication points listed. Generally, all moving metal parts should be oiled where contact is made with other parts. Keep oil and grease off belts and pulleys. Wipe surfaces clean before and after lubrication.

Grease:

- steering linkage
- mower linkage
- front axle shafts (remove wheel hubs)
- rear axle shafts (remove wheel hubs)



Use grease fittings when present. Automotive lithium grease is recommended.

Oil:



- foot pedal rods & brackets
- seat adjustment assembly
- draglink
- mower deck height adjustment linkage
- manual lift lever
- transmission idler assembly

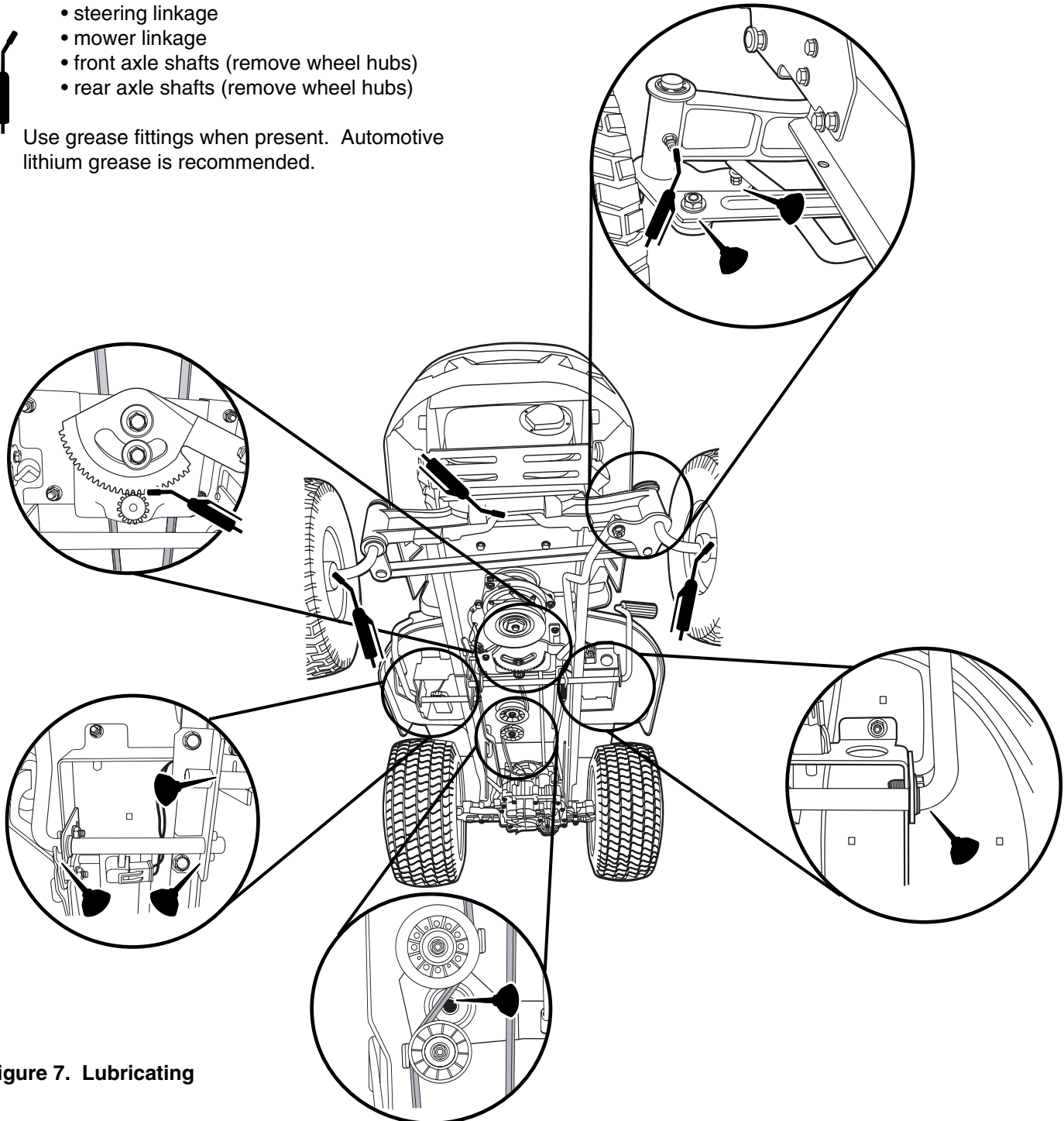

Figure 7. Lubricating

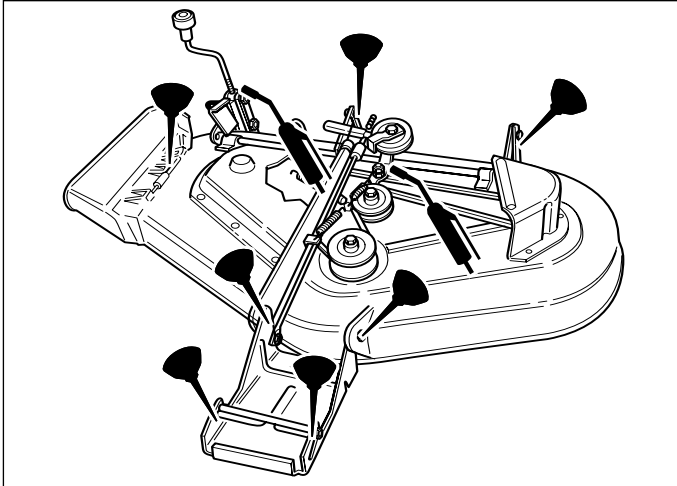

Figure 8. Mower Lubrication Points

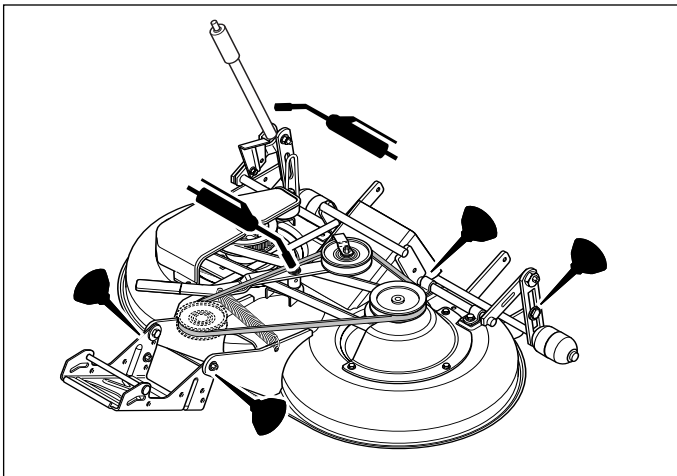

Figure 9. Mower Lubrication Points

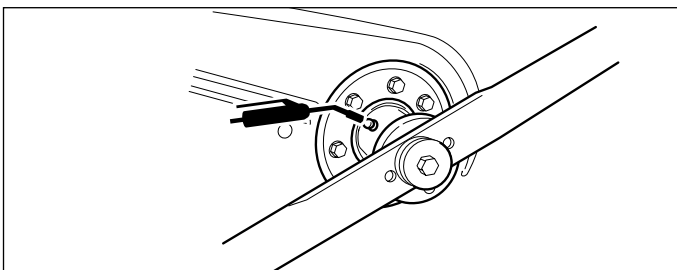

Figure 10. Arbor Lubrication Point

Hourmeter

HOURLMETER MODELS

The hour meter measures the number of hours the key has been in the RUN position. This hourmeter can not be reset and does not have a maintenance reminder.

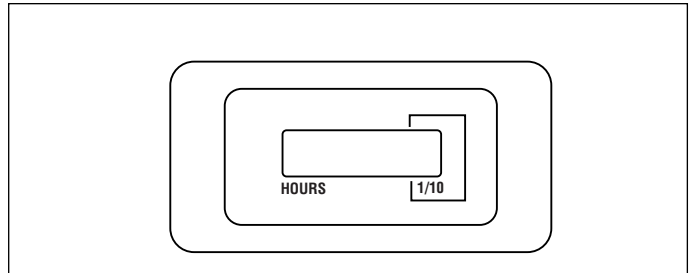

Figure 11. Hourmeter - Select Models

Mower Deck Removal & Installation

⚠ WARNING

Engage parking brake, disengage PTO, stop engine and remove key before attempting to install or remove the mower.

Removing the Mower Deck

1. Park tractor on a hard, level surface such as a concrete floor. Turn off PTO switch and engine, remove the key and apply parking brake.
2. Place wood blocks under the mower deck. Place the attachment lift in the lowest position.

⚠ CAUTION

Stored energy device. Mowers have spring lift assist. Lift lever must be in lowest cutting position and mower on support blocks to avoid injury when removing or installing mower mounting hardware.

3. Move idler arm (A, Figure 13) to relieve belt tension. Remove belt from PTO pulley (B).
4. Remove hair pin (D, Figure 12) and washer (C). Disconnect the mower lift channels (A) from the tractor lift arms (B). Re-install washers (C) and hair pins (D) to prevent loss.

⚠ CAUTION

The muffler and surrounding areas may be hot.

5. Turn wheels straight ahead. Support the mower hanger (C, Figure 14). Remove safety clip (A) and rod (B). Lower the mower hanger (C).
6. Turn wheels fully left, and slide mower deck out right side of tractor.

Installing the Mower Deck

1. Park tractor, shut off PTO and engine, remove the key and apply parking brake. Turn the wheels fully to the left.
2. Place mower height adjuster in the lowest cutting position. Place the mower lift lever in the lowest position, also. Slide mower deck under right side of tractor so that mower hitch is aligned with the front tractor hitch.
3. Turn wheels straight. Lift the mower hanger (C, Figure 14). Insert rod (B) through mower hanger (C) and tractor brackets (D). Secure with safety clip (A).

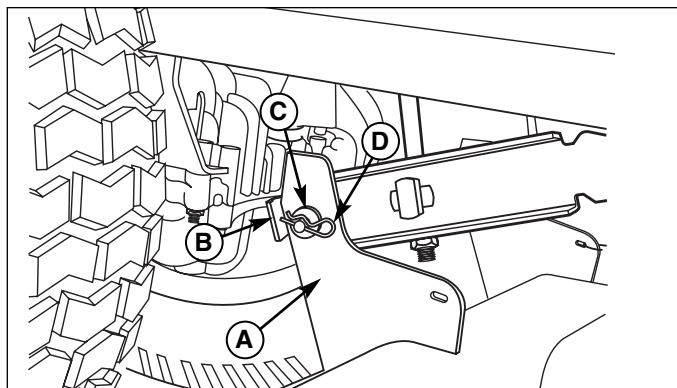

Figure 12. Lift Arms
(Viewed from underneath right side of tractor)
A. Mower Lift Channels C. Washer
B. Tractor Lift Arm D. Hair Pin

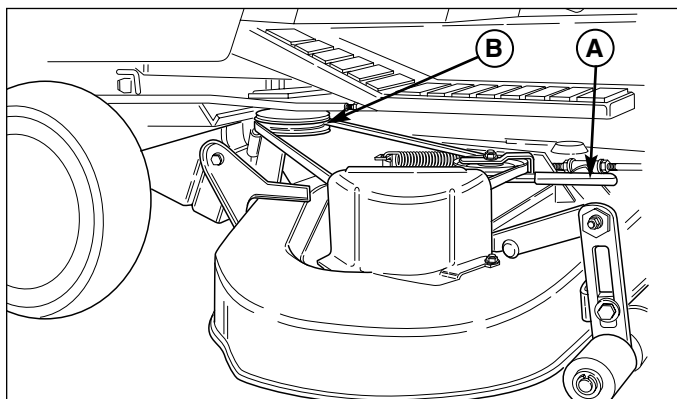

Figure 13. Removing & Installing Belt
A. Idler Arm
B. PTO Pulley

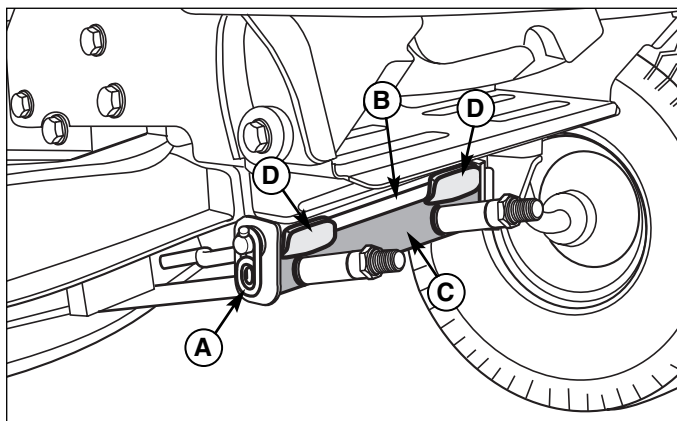

Figure 14. Mower Hitch
A. Safety Clip C. Mower Hanger
B. Rod D. Tractor Brackets

4. Connect the mower lift channels (A, Figure 12) to the tractor lift arms (B). Install washers (C) and hair pins (D).
5. Move idler arm (A, Figure 13) to relieve belt tension. Install belt onto the PTO pulley (B).

WARNING

Before checking mower, shut off PTO and engine, remove the key, and allow all moving parts to stop.

Leveling The Mower

If the cut is uneven, the mower may need leveling. Unequal or improper tire pressure may also cause an uneven cut. Make sure tire pressure is correct as specified in Checking Tire Pressure.

SIDE-TO-SIDE LEVELING

1. With the mower installed, place the tractor on a smooth, level surface such as a concrete floor. Turn the front wheels straight forward.
2. Check for bent blades and replace if necessary.
3. Place the mower in mid-cut position. Arrange the outside mower blades so that they are pointing from side-to-side.
4. Measure the distance between the outside tips of each blade and the ground. If there is more than 1/8" (3mm) difference between the measurements on each side, proceed to step 5. If the difference is 1/8" (3mm) or less, proceed to step 6.
5. Turn the locknut (B, Figure 15) to raise or lower that side of the mower.

FRONT-TO-BACK LEVELING

6. Arrange the blades so they face front-to-back.
7. Measure the distance from the ground to the front tip of the center blade, and from the ground to rear tips of left-hand and right-hand blades.

Note: Front tip of the center blade should be 1/4" (6mm) higher than rear tips of left-hand and right-hand blades. If not, proceed with step 8.

8. To raise front of mower deck, tighten locknuts (A, Figure 16) and against spacers (B). To lower front of mower deck, loosen locknuts (A). Locknuts must be turned evenly on both sides to keep deck level.

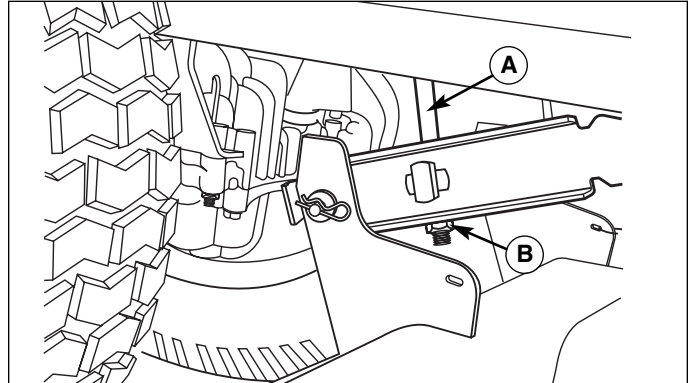

Figure 15. Leveling The Mower Side-to-Side
A. Lift Rod
B. Locknut

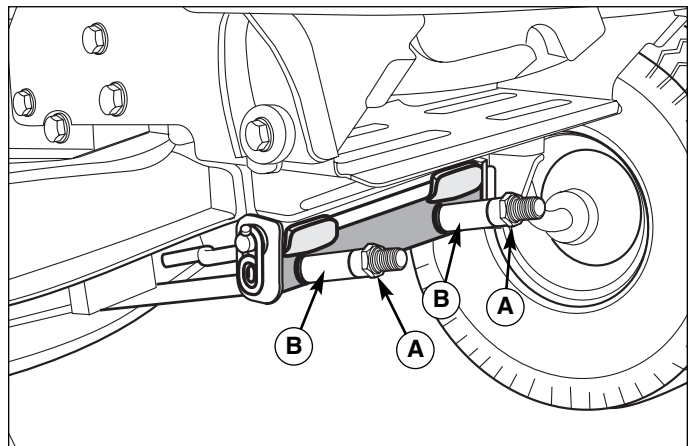

Figure 16. Leveling The Mower Side-to-Side
A. Locknuts
B. Spacers

Adjustment Procedures

Gauge Wheels

WARNING

Before checking mower, shut off PTO and engine, remove the key, and allow all moving parts to stop.

NOTICE

DO NOT remove the mower deck baffles. The baffles help prevent grass clippings from becoming airborne and plugging up the engine cooling fins.

The mower gauge wheels can be placed in several positions depending on the height of cut. When using higher cutting heights, set the wheels in the lower position. When using lower cutting heights, set the wheels in the upper position. To adjust:

1. Remove the locknut (B, Figure 17), gauge wheel (C), washer (D), and shoulder bolt (E). Change position of gauge wheel to desired height.
2. Insert shoulder bolt (E) through washers (D) gauge wheel (C), and gauge wheel bracket (A). Secure with locknut (B). Repeat steps 1 & 2 for all gauge wheels.

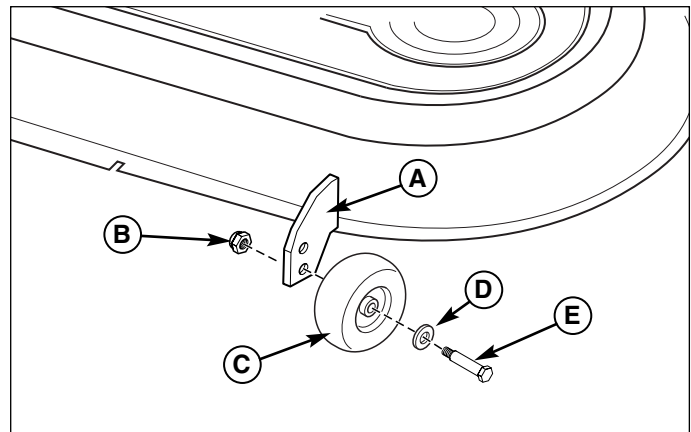

Figure 17. Fixed Bracket Gauge Wheel Adjustment
A. Gauge Wheel Bracket D. Washer
B. Locknut E. Shoulder Bolt
C. Gauge Wheel

Seat Adjustment

Seat Slide Adjustment

The seat can be adjusted forward and back. Move the lever (A, Figure 18), position the seat as desired, and release the lever to lock the seat into position.

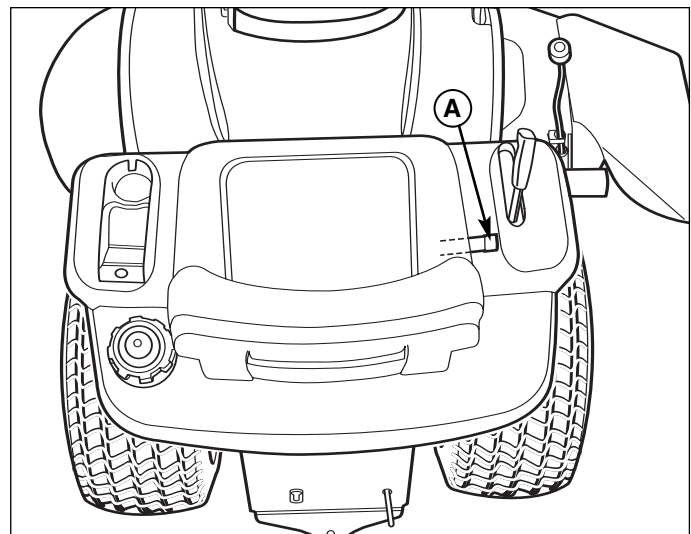

Figure 18. Seat Adjustment
A. Seat Adjustment Lever

Adjust **Electric PTO Clutch Adjustment**

Check the PTO clutch adjustment after 250 hours of operation. Also perform the following procedure if the clutch is slipping or will not engage.

1. Remove key from ignition switch and disconnect spark plug wires to prevent the possibility of accidental starting while the PTO is being adjusted.
2. See Figure 20. Note the position of the 3 adjustment windows (A) in the side of the brake plate and the nylock adjustment nuts (B).
3. Insert a .012" feeler gauge through each window, positioning the gauge between the rotor face and the armature face as shown in Figure 20.
4. Alternately tighten the adjustment nuts (B, Figure 19) until the rotor face and armature face just contacts the gauge.
5. Check the windows for an equal amount of tension when the gauge is inserted and removed, and make any necessary adjustments by tightening or loosening the adjustment nuts.

NOTE: The actual air gap between the rotor and armature may vary even after performing the adjustment procedure. This is due to dimensional variations on component parts, and is an acceptable condition.

6. Check the mower blade stopping time. The mower blades and mower drive belt should come to a complete stop within five seconds after the electric PTO switch is turned off (see MOWER BLADE BRAKE STOPPING CHECK, Page 6).

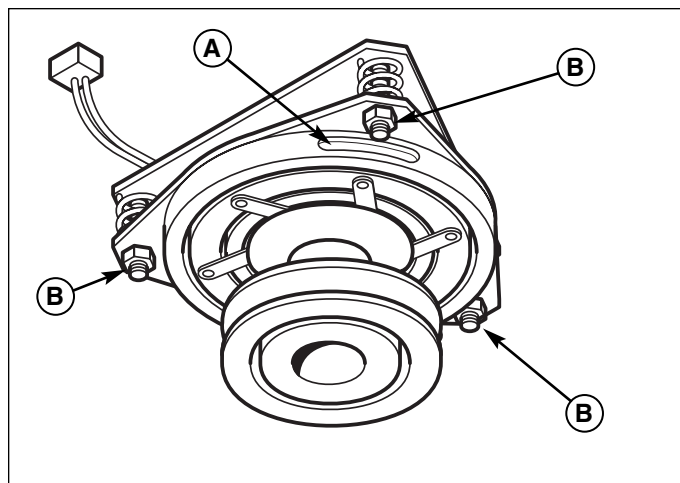

Figure 19. PTO Clutch Adjustment
A. Adjustment Window (Qty. 3, one shown)
B. Adjustment Nuts

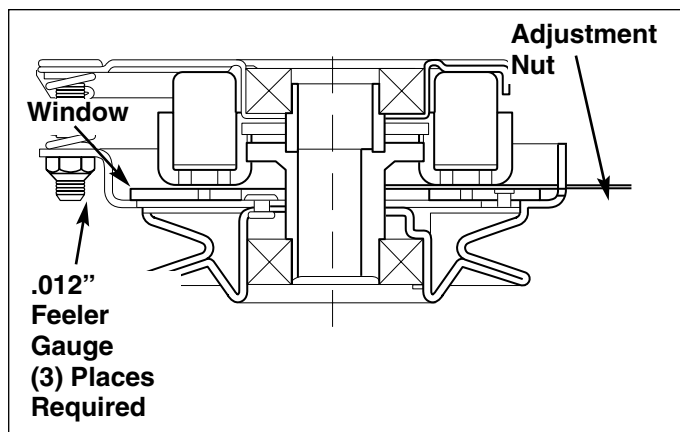

Figure 20. Feeler Gauge Position

Mower Belt Replacement



To avoid damaging belts, **DO NOT PRY BELTS OVER PULLEYS.**

Note: It is not necessary to remove the mower to install a new belt. However, for easier access mower can be removed. See Mower Removal in the Operation section.

1. Park the tractor on a smooth, level surface such as a concrete floor. Disengage the PTO, turn off the engine and lock the parking brake. Remove the key.
2. If mower is not removed, lower the mower lift and place the mower in the lowest cutting position.
3. Push the idler arm (A, Figure 21) to relieve belt tension. Drop the belt from the PTO (electric clutch) pulley.

IMPORTANT: Note the position of all belt guides relative to the belt and pulleys before loosening.

4. Some Models: Loosen the belt stop bracket(s) (C, Figure 21).
5. Remove the old belt and replace with a new belt. Make sure V-side of belt runs in arbor pulley grooves and the flat backside runs against the idler pulley.
6. Some Models: Position the belt stop bracket(s) (C, Figure 21) in their original positions. There must be 1/8" clearance between the belt stop and the pulleys.
7. Position the idler pulley belt guide (D) in its original position up against arm (A) so that there is a 1/8" gap between the pulley and belt guide.
8. Install mower on tractor if it was removed.
9. Run the mower under no-load condition for about 5 minutes.

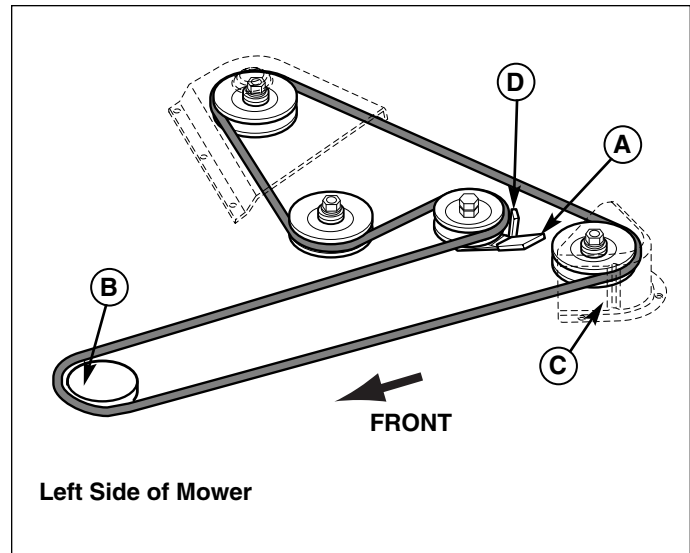

Figure 21. Typical Mower Belt Routing Three Blade Decks

A. Idler Pulley Arm C. Belt Stop Bracket
B. PTO Pulley (Engine) D. Idler Pulley Belt Guide

SNAPPER® and SNAPPER PRO®
are trademarks of Briggs & Stratton
Yard Power Group, WI USA.

Snapper Products
535 Macon St.
McDonough, GA 30253
Copyright © 2007 Briggs & Stratton Corporation
Milwaukee, WI USA.
All rights reserved.

Free Manuals Download Website

<http://myh66.com>

<http://usermanuals.us>

<http://www.somanuals.com>

<http://www.4manuals.cc>

<http://www.manual-lib.com>

<http://www.404manual.com>

<http://www.luxmanual.com>

<http://aubethermostatmanual.com>

Golf course search by state

<http://golfingnear.com>

Email search by domain

<http://emailbydomain.com>

Auto manuals search

<http://auto.somanuals.com>

TV manuals search

<http://tv.somanuals.com>