



CD102

Personal CD Player

Owner's Manual



CD102 Personal CD Player Owner's Manual

Thank you for purchasing this Califone CD Player, which we hope will support your teaching efforts in ELD, ELL, ESL and other language arts applications. I encourage you to go online to califone.com in order to learn more about our other product lines which help student understanding and achievements.

While online, make sure you register your Player for its one year warranty.

Sincerely,

A handwritten signature in black ink that reads "Roscoe Anthony". The signature is fluid and cursive, with a long, sweeping tail on the final letter.

Roscoe Anthony
President, Califone® International, Inc.



Unpacking

Inspect the unit and the headphones for any damage which may have occurred during shipping and contact us immediately. Please keep the packing material for further use.

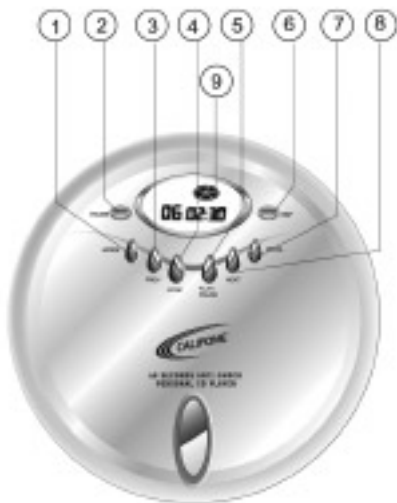

Location of Controls

1. MODE Button
2. Pause Button
3. Skip/Search button (PREV)
4. Stop Button
5. Play/Pause Button
6. ESP Button (Anti-Shock Protection)
7. Program Button
8. Skip/Search Button (NEXT)
9. LCD Display
10. DC 4.5V
11. Open CD Compartment Switch
12. Volume Control
13. HOLD Button
14. Line Out Socket
15. Headphone Socket
16. Bass Boost Switch

1.

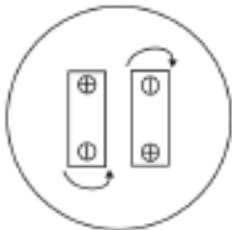

2

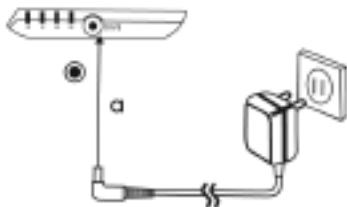

3

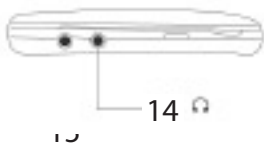
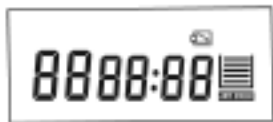

Power Supply

1. Battery

Open the battery cover, insert the batteries as indicated in diagram 1 and then close the battery cover.

Caution:

If you are not going to use the CD Player for an extended period of time, it's recommended the batteries be removed to prevent any possible corrosion within the unit.

2. Connecting AC Voltage

Transformer

Insert the DC Jack into point (a) as indicated in diagram 2 and then connect AC pack into an AC outlet.

Notes:

when not in operation, please unplug the AC transformer.

3. Battery Power/ Volume Indication

When the batteries become weak, the LCD display will indicate the "low battery" symbol. Replace the batteries to restore correct operation.

4. The CD Player Output Connection

The CD Player output can be connected to headphones (14), external amplifier, and jackbox for multiple listeners (15).

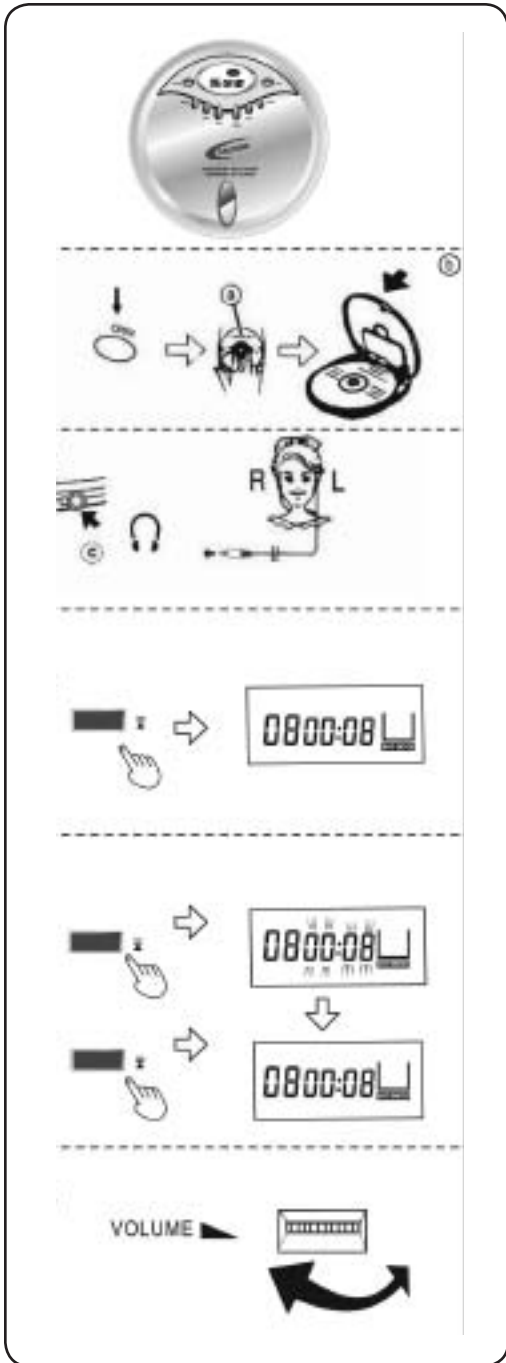

Operation

Play Mode

Press the [OPEN] button to open the cover and then insert the CD.

Ensure the label side is facing up. Place the center of the CD onto the spindle and gently press down to secure it in place. Close the cover.

Plug the stereo headphone into the phone jack.

Press the PLAY button once.

The Player will start playing with the LCD display showing the track number. When all of the tracks have been played, the player will automatically stop playing, unless programmed otherwise.

Pause Mode

To temporarily pause while the unit is playing, press the PLAY button once. The playing time in the LCD display will blink, indicating "Pause" mode. Pressing the PLAY button a second time will resume playing.

Stop Mode and Power Off

Press the STOP button once to stop playing the CD. After the STOP button is pressed, the LCD display will indicate the total tracks and total playing time.

To switch your player off from the STOP mode, press the STOP button. The LCD display will become blank and the player will turn off.

Adjusting Volume

Adjust the volume knob to the desired level.



1



Program Mode

Programmable Play

The disc can be played in a programmed order (maximum 20 tracks can be played) to suit personal preferences and learning styles.

(1) While a CD is playing, pressing the PROGRAM button will prompt the LCD display to indicate "PROG" and the track number "01".

(2) Press the FF/NEXT or REV/PREV button to select the first track to be programmed.

(3) Press the PROGRAM button to store the selected track. The track number will display "00" and the program number will change to "02", indicating that one track is stored and you may program your next selection.

Repeat steps 2 and 3 to continue programming.

When your programming is complete, press the PLAY button.

The LCD display will stop showing a blinking "PROG" and the player will start playing from the first "programmed" track.

Programming can also be conducted while in PAUSE mode. When all programmed tracks have been played, the player will automatically stop. The programmed tracks will be stored in memory until the CD door is opened or the power is shut off. To play the same programmed tracks again, press the PLAY button.



Other Play Methods

Skipping or Scanning Tracks

Pressing the FF/NEXT button while a CD is playing will skip to the next track. Pressing the REW/PREV button will skip the player backwards to the start of the current track or to the previous track if pressed twice. Press and hold the FF/NEXT button to fast forward through the current playing song. Press and hold the REW/PREV button to Rewind through the current playing song.

Repeating a Single Track

While in STOP, PLAY or PAUSE modes, press the MODE button. The LCD display will indicate 1 and the player will repeat the current track. Press the FF/NEXT or REW/PREV button to change the track that you wish to repeat.

If the "REPEAT" function was selected while in STOP mode, press the PLAY button to begin. Press the STOP button to exit REPEAT mode or press the MODE button consecutively until no "alternative" method is indicated on the LCD.

Repeating the Whole Disc

Press the MODE button twice. The LCD will indicate 1 ALL and the player will repeat playing the entire disc. Pressing the MODE button three times will return to the normal playing condition.

Intro Mode

The Intro Mode describes when the player will play the first 10 seconds of each track on the entire disk and will then automatically turn off. Press the MODE button three times and the LCD display will indicate "INTRO." Then press the PLAY button and the "INTRO" mode will begin.

Random Mode

Press the MODE button four times. The LCD will indicate "SHUFF;" Then press the PLAY button to begin. The player will play all tracks on the disc in random order until all tracks have been played. Press the MODE button once to exit RANDOM mode.



Automatic Start-Up/Shut Off

Power On

While in STOP mode, press the PLAY button. The Player will automatically start up and the display will indicate the start up sequence as shown in figure 1 (left).

Auto Shut Off

The Player will shut off automatically if no operation is selected within a one minute period after turning the CD Player on or after a disc has completed playing. If there is no disc in the unit, it will automatically shut off after approximately 30 seconds.

"DISC" (no disc) Indication

If there is no disc in the player or if a disc is not inserted correctly, the player will show "disc" on the LCD for approximately 30 seconds after pressing the PLAY button.

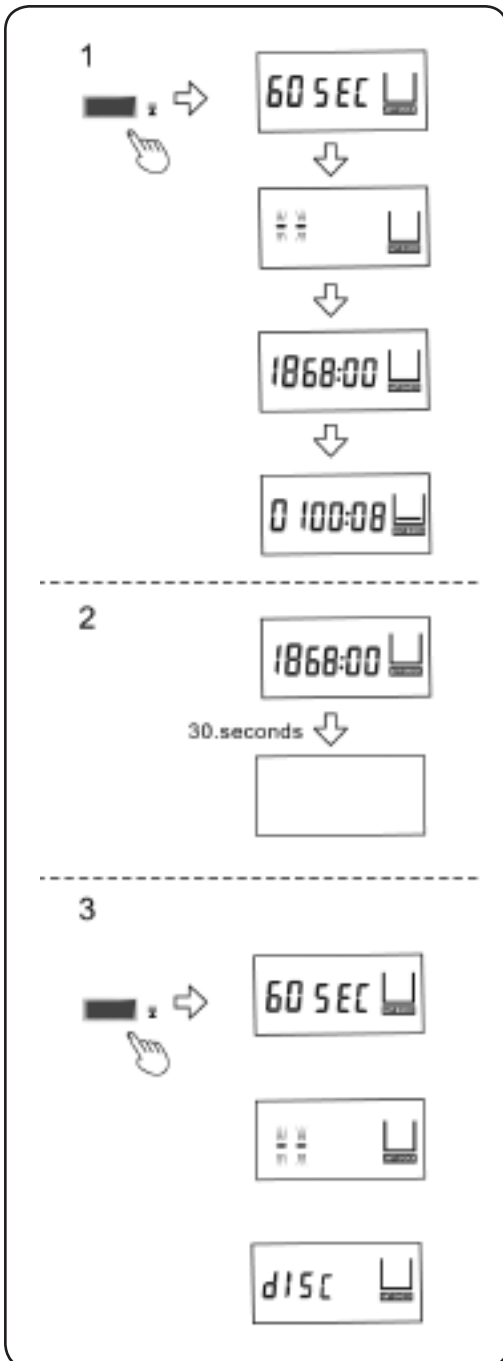





Shock Protection (ESP/Anti-Shock)

Vibration Resistant

By reading audio data and storing it in the "ANTI-SHOCK" memory, vibration resistance is achieved. When the player is bumped or knocked, the CD player will compensate with the data in its memory. The CD player also contains a vibration resistant mechanism to prevent the skipping noise caused by the change of playing speed when the player is "rocked".

Auto ESP

When pressing the PLAY button, the Anti-Shock System will automatically be enabled. The  in the display will turn into  after a few seconds of play. When vibration continues, the  in the display will turn into  depending on the length of the vibration.

To Cancel "ANTI-SHOCK"

Press the ESP button, the in  the display will turn off 

HOLD Function

Moving the HOLD switch to the "On" position locks the unit, protecting it from an accidental pressing of another button while in use.

2



3



4



Charge Function (Optional)

Charge Function

1. The CD Player will charge correctly sized rechargeable batteries (which are not supplied with the unit.) Open the battery cover and insert the rechargeable batteries into the battery compartment, making sure the correct polarity as shown in diagram 1 (left) is observed.

2. Connecting AC voltage transformer (2). Refer to Page 2 for correct connection.

3. Continuously press FAST FORWARD, REWIND, NEXT & PREVIOUS FUNCTIONS.

Press the FF/NEXT button once quickly to skip the next track. Press the REW/PREV button once quickly to skip backwards to the previous track or to the start of the current track. Press and hold the FF/NEXT button to fast forward through the current playing song. Press and hold the REW/PREV button to rewind through the current playing song.

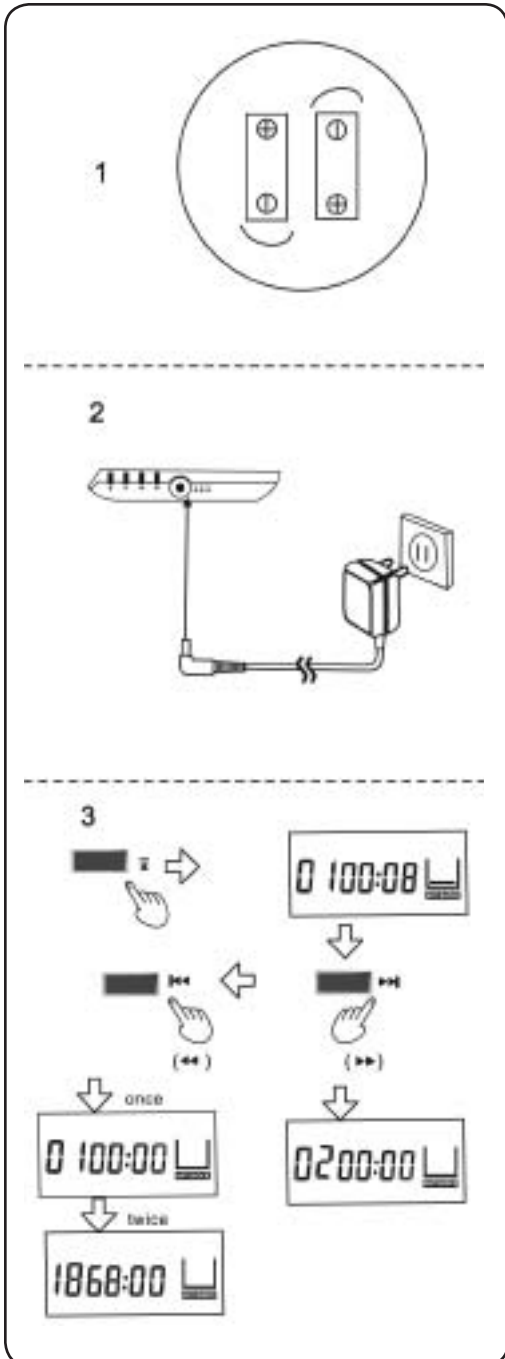

1



2



3

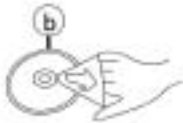

Concerning Compact Discs

1. Only Compact Discs bearing this mark can be used with this unit.
2. How to hold a disc
3. If the surface is dirty b) Play surface (shiny surfaces) Wipe it with a damp cloth and then wipe dry. Wipe from the center toward the edge.

Handling precautions

If you are taking the CD from a cold environment to a warm environment, moisture may form on the CD. Wipe any moisture off with a soft, dry, lint-free cloth before using the CD.

Do not write on the label side with a ball-point pen or other writing instrument. Do not use record cleaning sprays, such as: Benzine, Thinner, Static Electricity Prevention Liquids or any other solvent. Do not attach labels or stickers to CDs. (Do Not use CDs with exposed adhesive from tape or left over peeled off stickers.)

Do not use scratch-proof protectors or covers other than those specified for use with this unit.

Storage Precautions

Be sure to store CDs in their cases to protect them from dust, scratches and warping.

Do not place or store CDs where they can be: exposed to direct sunlight, humid or dusty locations, directly exposed to a heat vent or heating appliance, in the glove compartment or on the rear deck of an automobile.

Precautions

To prevent battery damage, electrolyte leakage, and short-circuiting, follow these recommendations.

- (A) Do not peel off the covering on batteries and do not use if the covering has been peeled off.
- (B) Align the polarities + and – correctly when inserting the batteries.
- (C) Do not mix different types or makes of batteries of old and new batteries.
- (D) Remove the batteries if you do not intend to use the unit for a long time.
- (E) Do not throw into fire, short-circuit, disassemble, or subject to excessive heat.
- (F) Do not attempt to recharge dry cell batteries.
- (G) Do not allow metal objects to touch the battery terminals as this may cause short-circuiting which is dangerous.

Unit

No altering or remodeling

This can cause malfunctioning.

Do not drop

This may damage the unit.

Locations to be avoided

Avoid using the unit in the following locations.

- 1. Bathrooms and other moisture-prone places
- 2. Warehouses and other dusty places
- 3. Very hot places such as near heating appliances, etc.

Do not leave the unit exposed to direct sunlight for long periods of time.

This may deform or discolor the cabinet and may also cause malfunctioning.

Specifications

Audio

| | |
|---------------------------------|------------------------------|
| Channels: | 2 (left and right, stereo) |
| Frequency Response: | 20-20000Hz |
| Channel Isolation: | >40dB |
| Wow-Flutter | Lower than measurement limit |
| Reading Time: | <10ESC |
| L, R level balance: | <2dB |
| Sampling Frequency: | 44.1 KHz |
| Power: | + - DC4.5V 600mA |
| Operating Temperature Range: | 0-40 C |
| Dimension (Width*Height*Depth): | 153*138*24.5mm |

Accessories

- 1. Operating Instructions
- 2. 3060AVS Stereo Headphone

Specifications/Features are subject to change without notice. Values of dimension are approximated.

Caution

This product utilizes a laser.

Use of controls or adjustments or performance of procedures other than those specified herein may result in hazardous radiation exposure.

Do not open covers and do not repair yourself. Refer servicing to qualified Califone personnel or our authorized service facilities.

Warning

To reduce the risk of fire, electric shock or product damage, do not expose this appliance to moisture of any kind. Marking sign is located on bottom of the unit.



Califone® International Inc. • 1145 Arroyo Avenue, # A • San Fernando, CA 91340 USA
Toll Free 800.722.0500 | Toll Free Fax 877.402.2248
International Customers call 818.407.2400 or Fax 818.407.2405 califone.com

Free Manuals Download Website

<http://myh66.com>

<http://usermanuals.us>

<http://www.somanuals.com>

<http://www.4manuals.cc>

<http://www.manual-lib.com>

<http://www.404manual.com>

<http://www.luxmanual.com>

<http://aubethermostatmanual.com>

Golf course search by state

<http://golfingnear.com>

Email search by domain

<http://emailbydomain.com>

Auto manuals search

<http://auto.somanuals.com>

TV manuals search

<http://tv.somanuals.com>