

SVW140 Warming Drawer
Manual for Installation, Use and Maintenance

CDA



Mains Electricity Connection

CONTACT A QUALIFIED TECHNICIAN TO CARRY OUT THE APPLIANCE ELECTRICAL CONNECTION.

Important : Before connecting the drawer to the domestic power supply to check its operation, always make sure the drawer power cable is correctly fitted and NOT squashed or caught under or behind the drawer or a combined appliance.

Important : Power cable replacement must be made with a cable having the same characteristics as that supplied by the Manufacturer (type H05RR-F, 3x1 mm² or higher) and carried out by the After-Sales Service or a qualified technician.

Before connecting the appliance to the power supply, make sure that the technical specifications (voltage: V and frequency: Hz) given on the rating plate match those of the power mains. In case of doubt, contact a qualified technician. If the plug is removed from the power cable, contact a qualified technician for fitting and connecting the appliance. Contact an electrician aware of the local regulations and the electricity company's regulations, ensuring that the work is carried out in compliance with the same.

Important : Make sure the appliance is connected to an approved earth wire, to guarantee electrical safety. If necessary, have the system checked by a specialised technician.

The Manufacturer declines any liability for injury and damage due to the lack or interruption of the earth wire.

Important : The earth connection is compulsory by law.

- If the appliance is connected to the power supply by means of an extension cord, make sure the cord and connection are insulated against moisture.
- The appliance is designed to be used only when correctly fitted.
- Never open the appliance casing. In case of contact with live wires or if the electrical and mechanical structure of the appliance is modified, an appliance fault may occur when it is used.
- If the installation, maintenance or repair works are not carried out correctly, there may be risks for the user. The Manufacturer declines any liability for damage or injury in such cases.
- During the warranty period, repairs must only be carried out by the authorised technical service, otherwise the warranty will be invalidated.
- Installation, repair and cleaning operations must only be carried out after ensuring that the appliance is disconnected from the power supply. The appliance is disconnected from the power supply in the following cases:
 - The main power switch is off.
 - The safety switch is turned off.
 - The appliance is unplugged.
- Grip the plug and not power cable to unplug the appliance.
- It is advisable to connect the appliance to the power supply by means of a socket; this will facilitate technical assistance operations, if necessary.
- Ensure that the socket is accessible even once the appliance has been fitted.
- If connection is not made by means of an electrical socket, contact an electrician aware of the local regulations and the electricity company's regulations, ensuring that the work is carried out in compliance with the same.
- If the socket is no longer accessible after fitting the appliance or if a fixed connection is provided for, a separation device for each pole must be arranged by the installer.
- Switches with contact opening of at least 3mm are valid separation devices.
- The specifications necessary for connection are given on the dataplate. These specifications must match those of the power supply.
- **The Manufacturer declines any liability for injury or damage due to incorrect installation, improper, wrong and unreasonable use of the appliance.**
- **The Manufacturer also declines any liability for damage (e.g. electric shock) caused by the lack or interruption of the earth wire.**
- After installation, all the parts of the appliance must be insulated, to prevent accidents during operation.

Before Using the Warming Drawer

When using the appliance for the first time, clean it as follows:

- Clean the surface with a damp cloth, then dry.
- Preheat the empty drawer for at least 2 hours: turn the temperature knob to the max. position in order to eliminate any manufacturing residuals (grease, oil or resins) which could cause unpleasant odours during cooking. Air the room.
- After carrying out this simple operation, the appliance will be ready for first use.

Before using the appliance, remove:

- Stickers on the front and warming drawer door, except the rating plate;
- Cardboard protection and protective plastic film from all the aesthetic parts, if present, and from the front panel controls and other parts of the warming drawer;
- Any stickers from the accessories if present.

Installation

Important : The warming drawer must be immediately fixed to the cabinet, complying with the following instructions. Do not install the combined electrical appliance provided for, before fixing the warming drawer to the cabinet.

Spacers : fix the drawer as shown opposite.

Note : should it be necessary to align the appliance aesthetically with other combinations of product, the drip tray at the bottom can be removed and eliminated by unfastening the two fixing screws.

- Before connecting the appliance to the power supply, compare the connection data (voltage and frequency) given on the dataplate with that of the electrical mains.
- The data must match, otherwise the appliance could become damaged.
- In case of doubt, contact a qualified technician.
- Make sure the socket can be easily accessed even after the appliance has been fitted.
- The warming drawer can only be fitted in combination with other appliances not weighing more than 40 kg and provided with adequate cooling ventilation. Otherwise, the right to the warranty is invalidated, since correct use cannot be guaranteed.
- For combined appliance installation comply with the instructions given in the relevant use and installation handbook.
- Fitting and installation of this appliance must only be carried out by qualified personnel who guarantee that the requirements for safe use are met.

Measurements

- All measurements are given in mm.

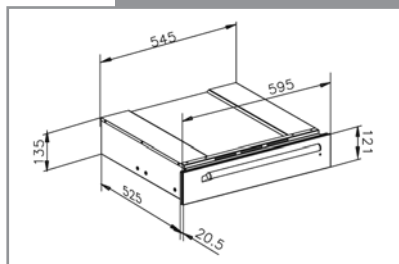
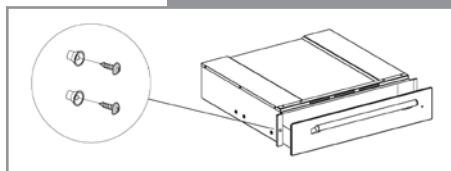

Using Your Warming Drawer

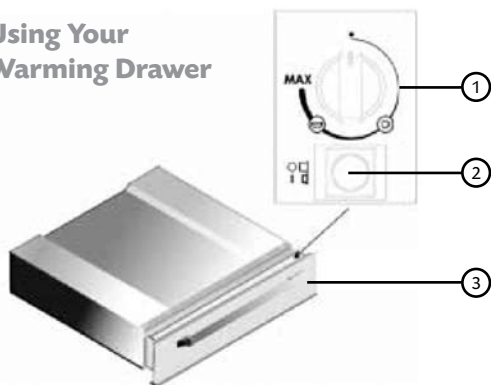

Operation

- Place the dishes in the drawer
- Set a temperature
- Switch the appliance on; the switch lights up
- Close the drawer gently
- Switch the appliance off before removing the warmed dishes

Selecting the Temperature

- The temperature knob enables a temperature adjustment of between approx. 30°C and 85°C.
- Turn the temperature knob all the way clockwise to max. and then anticlockwise.
- Do not force it past the stop, otherwise the thermostat will be damaged.
- The temperature scale does not indicate the absolute temperature values in °C, but gives symbols that represent the optimum temperature for the respective dish group.

Warming Times

The time necessary for warming dishes, glasses, etc. depends on various factors:

- Material and thickness of the dishes
- Load amount
- Load arrangement
- Temperature setting

Therefore exact indications cannot be provided.

It is advisable to find the required optimum settings by practical experience.

Load Capacity

- The load capacity depends on the height of the appliance and the size of the dishes.
- The following load examples are only a guide.
- Remember that the maximum drawer load is 25kg.

1. Temperature knob

2. Luminous ON-OFF switch

3. ON-OFF light

The control parts are the temperature knob and the luminous ON-OFF switch.

With the switch pressed (position 1) the drawer is on, whereas with the switch released (position 0) the drawer is off.

These parts are visible only when the drawer is open.

When the drawer is closed, a control light on the front of the appliance indicates if the drawer is switched on.

Temperature Control	Temperature	Information Regarding Use
Cups, Glasses	approx. 40°C	Hot drinks in glasses previously warmed at this temperature do not become cool so quickly, and in any case the container can be touched without any risk
Plates	approx. 60°C	The food on these plates stays hot for a longer time. The containers can be touched without any risk, otherwise use gloves or pot-holders
MAX Crockery	approx. 85°C	The thermostat is set to max temperature. The containers can be touched with special gloves or pot-holders

dishes for 6 persons

6	plates	Ø28cm
6	broth cups	Ø10cm
1	soup plate	Ø22cm
1	soup plate	Ø19cm
1	soup plate	Ø17cm
2	meat plates	Ø36cm

or as required

20	plates	Ø26cm
36	soup plates	Ø22cm
30	soup bowls	Ø10cm
10	plates	Ø27cm
10	soup plates	Ø22cm
10	pizza plates	Ø36cm
80	espresso coffee cups	
40	cappuccino cups	
30	glasses (grog)	
18	soup plates	Ø22cm
2	meat plates	21cmx18cm

Care and Cleaning

Important : never clean the appliance with high pressure water or steam cleaning equipment.

Also avoid using : detergents containing soda, acids or chlorides, abrasive detergents (in powder or lotion), abrasive sponges (e.g. steel wool) or sponges containing residuals of abrasive detergents, descaling detergents, dishwasher detergents, oven sprays.

Do not use corrosive products, hard sponges or rough cloths for cleaning.

Warming drawer exterior

- Clean with a damp cloth. If it is very dirty, add a few drops of dishwashing detergent to the water. Dry with a dry cloth.
- Do not use corrosive or abrasive detergents, as they can create dull areas. If any of these products accidentally comes into contact with the warming drawer, immediately clean the appliance with a damp cloth.
- Slight colour differences on the front of the appliance are due to the use of different materials, such as glass, plastic and metal.

Front panel

- Use a mild detergent and a soft window cleaning cloth or a microfibre cloth that does not leave fibres on the surface. Wipe horizontally, without pressing.

Antislip drawer base

- Extract the antislip base to access and clean the bottom of the drawer. Wash the base by hand with hot water and a mild detergent. Dry it thoroughly. Refit the antislip base in the drawer only when completely dry

Removing the Warming Drawer

- The drawer can be removed in order to clean the inside.
- Open the drawer fully (see pic. 1)
- Undo the 2 front screws (1 on each side) - (pic. 2)
- Lift the 2 hooks (1 on each side) - (pic. 3-4)
- Hold the front part of the drawer on both sides, because the rear part of the side guides has been lubricated.
- Remove the drawer by carefully lifting it upwards (pic.5) and put it down.
- The inside of the appliance can now be cleaned, using water and detergent.
- Do not place the drawer in water once it has been removed.

Refitting the Warming Drawer

- To refit the drawer, carry out the removal procedure in reverse order.
- To do this, place the drawer off the guides.
- **NB :** There is a fixing hook on the left and right side under the warming drawer.
- The drawer can be opened only if the fixing hook is in the correct position.

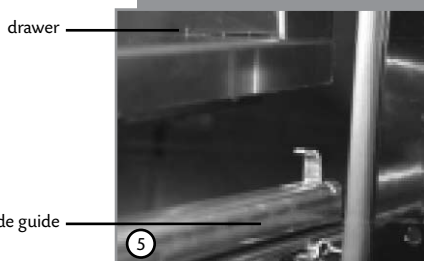
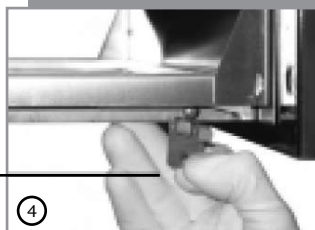
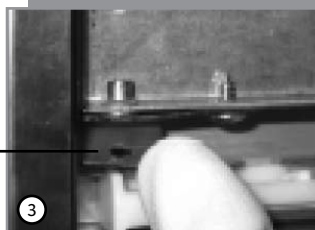

Troubleshooting Guide

If the dishes are not warm enough, make sure :

- the appliance is on
- the right temperature has been set
- the heat openings are not covered by large dishes or soup-plates
- the dishes have been warmed for a long enough time.

Different factors affect the warming time, e.g :

- the material and thickness of the dishes, the load amount and its arrangement, temperature setting.
- optimum dish warming times are subjective, therefore it is advisable to carry out trials to define them according to needs.

Customer Care

Before calling CDA Customer Care :

- Try to solve the problem on your own, according to the points described in "Troubleshooting Guide".
- Switch the appliance off and then on again it to see if the problem has been eliminated.

For the following problems, contact a qualified technician or CDA Customer Care :

- If the dishes are not warmed, make sure:
 - the main power switch is on;
 - the power cable is not disconnected or damaged.
- If the dishes become too hot:
 - the temperature controller may be faulty.
- The On/Off switch does not light up when the appliance is switched on:
 - the switch control light is faulty.

If the fault persists after the above checks, contact CDA Customer Care.

Always specify:

- a brief description of the fault;
- the type and exact model of the warming drawer;
- the Service number (number after the word Service on the rating plate), located on the outer right edge of the drawer slide.
- your full address;
- your telephone number.

If any repairs are required, contact CDA Customer Care (to guarantee the use of original spare parts and correct repair).

Failure to comply with these instructions may compromise the safety and quality of the product.

DECLARATION OF CONFORMITY

- This drawer is suitable to come into contact with food products and complies with European Regulation (CE) No. 1935/2004.
- This appliance is designed for use only as an appliance for warming or keeping cooked food or dishes warm. Any other use (for example for room heating) is considered improper and therefore potentially dangerous.
- This appliance has been designed, manufactured and marketed in compliance with:
 - safety objectives of the "Low Voltage" Directive 2006/95/EC (which replaces 73/23/EEC and subsequent amendments;
 - The protection requirements of EMC Directive 89/336/EEC;
 - the requirements of Directive 93/68/EEC.

Important

- This appliance is not to be used by persons (including children) with limited physical, sensorial or mental capacities or with insufficient knowledge or experience, unless they are under supervision or have been instructed in advance on how to use the appliance by those responsible for their safety.
- The warming drawer must not be used by young children or the infirm without supervision.
- Make sure children do not play with the appliance.
- The accessible parts of the warming drawer may become hot during use; keep children away from the appliance.
- Do not use abrasive materials or substances to clean the glass as they may damage it.
- The appliance becomes very hot during use. Be careful not to touch the heating elements inside the warming drawer.
- The warming drawer is only intended for domestic use, for heating dishes. Other uses are not allowed. The Manufacturer declines any liability for improper use or incorrect setting of the controls.
- Any repairs or adjustments must be carried out exclusively by a qualified technician.
- Make sure the appliance is securely fixed to the cabinet with the special screws supplied.
- Do not expose the warming drawer to the atmospheric agents.
- Do not rest or sit on the drawer when open, as this will damage the telescopic slides.
- The max. capacity of the drawer is 25Kg.
- **Do not cover the bottom of the warming drawer with aluminium foil or other objects.**
- The drawer seals must be kept clean to ensure that it closes properly.
- Never pour water directly in warming drawer.
- The juices of fruit dripping from the pan may leave permanent stains. It is advisable to clean the warming drawer before reusing it.
- To avoid scratching, do not drag dishes on the bottom of the warming drawer.
- Use suitable containers or crockery.
- Residual condensation could eventually damage the warming drawer and surrounding cabinets. It is advisable to:
 - cover food;
 - dry the wet parts when the warming drawers cold.
- Do not touch the warming drawer with wet parts of the body or use it when barefoot.
- Do not pull the appliance or the power cable to unplug it.
- **Do not allow children to touch:**
 - the controls and the warming drawer in general, especially during use and immediately afterwards, to avoid injury;
 - packing materials (bags, polystyrene, metal parts, etc.);
- Make sure the electrical cables of other appliances used near the warming drawer do not touch hot parts.
- Do not keep plastic or flammable objects in the warming drawer. When operating the appliance these objects could melt or catch fire.
- Use special oven gloves to remove hot dishes.
- Pressing the On button switches on the warmer drawer heating; risk of burns.
- Never insert objects (e.g. screwdrivers, sharp objects, papers, etc.) in the heating element and fan protection grill openings.

THE MANUFACTURER DECLINES ALL RESPONSIBILITY FOR EVENTUAL DAMAGES CAUSED BY FAILURE TO OBSERVE THESE INSTRUCTIONS.

Safeguarding the Environment

Disposal of packing material :

- The packing material is 100% recyclable and is marked with the recycle symbol . 
- The various parts of the packing must be disposed of in compliance with local regulations; do not disperse in the environment.

Disposal of old electrical appliances :

- This appliance is marked in compliance with European Directive 2002/96/EC, Waste Electrical and Electronic Equipment (WEEE).

By ensuring correct disposal of the product, the user can help prevent potentially negative consequences for the environment and the health of persons.

The symbol  on the product or on the accompanying documentation indicates that it should not be treated as domestic waste but must be taken to an appropriate collection centre for the recycling of electrical and electronic equipment.

Scrap the appliance in accordance with local regulations on waste disposal.

For further information regarding the treatment, recovery and recycling of this appliance, contact the competent local office, the domestic waste collection service or the shop where you purchased the product.



Notes :



Notes :



To contact our Customer Care Department, or for Service,
please contact us on the details below.

Free Manuals Download Website

<http://myh66.com>

<http://usermanuals.us>

<http://www.somanuals.com>

<http://www.4manuals.cc>

<http://www.manual-lib.com>

<http://www.404manual.com>

<http://www.luxmanual.com>

<http://aubethermostatmanual.com>

Golf course search by state

<http://golfingnear.com>

Email search by domain

<http://emailbydomain.com>

Auto manuals search

<http://auto.somanuals.com>

TV manuals search

<http://tv.somanuals.com>