

ChannelPlus Video Camera

The H722 video cameras are solid state cameras designed to fit deep double gang J-boxes.

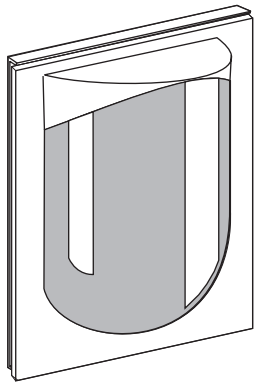

The H722 must be used with one of its companion channel injectors (H511HHR or H511BID). When used with an H511, video received from the H722 is used to create a new channel to add to existing television channels. The H722 is connected to the H511 by a single run of CAT-5 wire. Although this camera mount is intended for use indoors, or under an eave, a drip cap is supplied for use in exposed areas.

Two models are available:

- Model H722**
Black & White, 2 lux, 3.6 mm lens, smoked window
- Model H722C**
Color, 8 lux, 3.6 mm lens, smoked window

Note: The H722 is not a standalone video camera. Use only with an H511 channel injector.

Typical Installation

Connect the H722 camera using only *one* method:

- 1 Terminate cable with a CAT-5 jack and connect to the H511 using supplied RJ45 jumper. (Also see example H628 manual).
- 2 Wire camera or wall plate directly to the 8 position terminal block matching the CAT-5 wire colors to the colors on the terminal block. Insert wires and tighten screws.

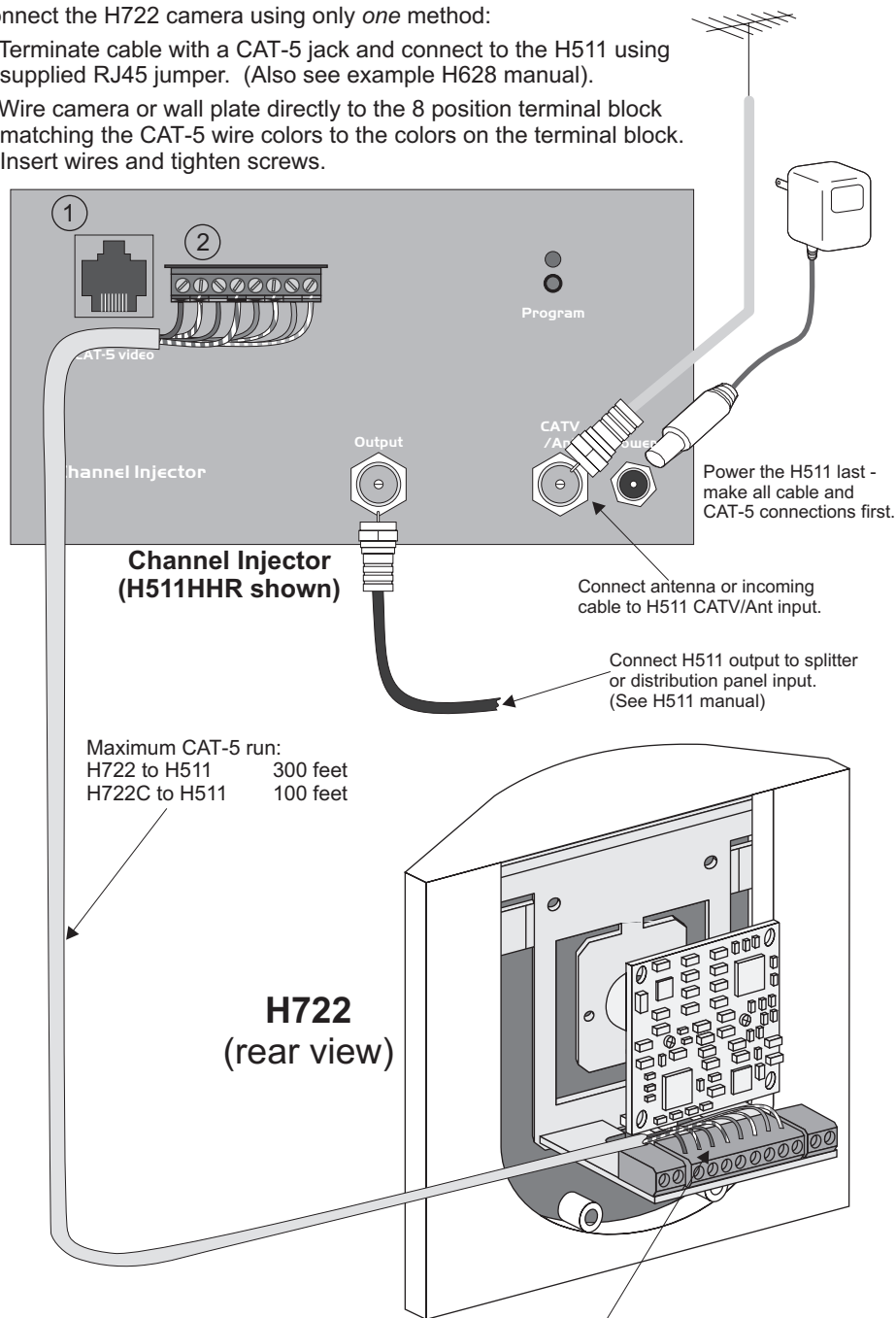

Insert wire into terminal block and tighten screws. Use the color bar to match wire colors. The color bar has two rows, one for CAT-5 and one for quad wire:
- For CAT-5 wire, remove the default resistor and use all 8 wires.
- For quad wire*, leave default resistor in place and match four color wire.

*The H722/H722C was designed to work with CAT-5 wiring. Although the system will function with quad wire, CAT-5 delivers the highest quality picture. CAT-5 allows the use of an automatic line length sensor and picture compensator. Quad wire does not take advantage of this enhancement.

Specifications: typical @ 25°C ± 5°C

Model	H722	H722C
Image format	EIA (Black & White)	NTSC (Color)
Resolution, horizontal	525 lines	525 lines
Resolution	350 lines	350 lines
Minimum illumination	2 lux	8 lux
Signal to Noise ratio	>45 dB	>45 dB
AGC	Yes	Yes
Lens	3.6mm F2.0	3.6mm F2.0
Lens viewing angle	78°	78°
White balance	automatic	automatic
Electronic shutter speed	1/60 to 1/50000 second	1/60 to 1/50000 second
Maximum distance to H511	300 feet	100 feet

Installing the Camera

The H722 is designed to be mounted outside in a J-box or inside into dry wall. When mounting outside, use the supplied drip cap and gasket. When mounting inside, use the supplied CADDY® bracket.

The H722 series cameras work best when they are looking down on their subject. For a front door application, place the camera about 7 feet off the ground, adjacent to the door.

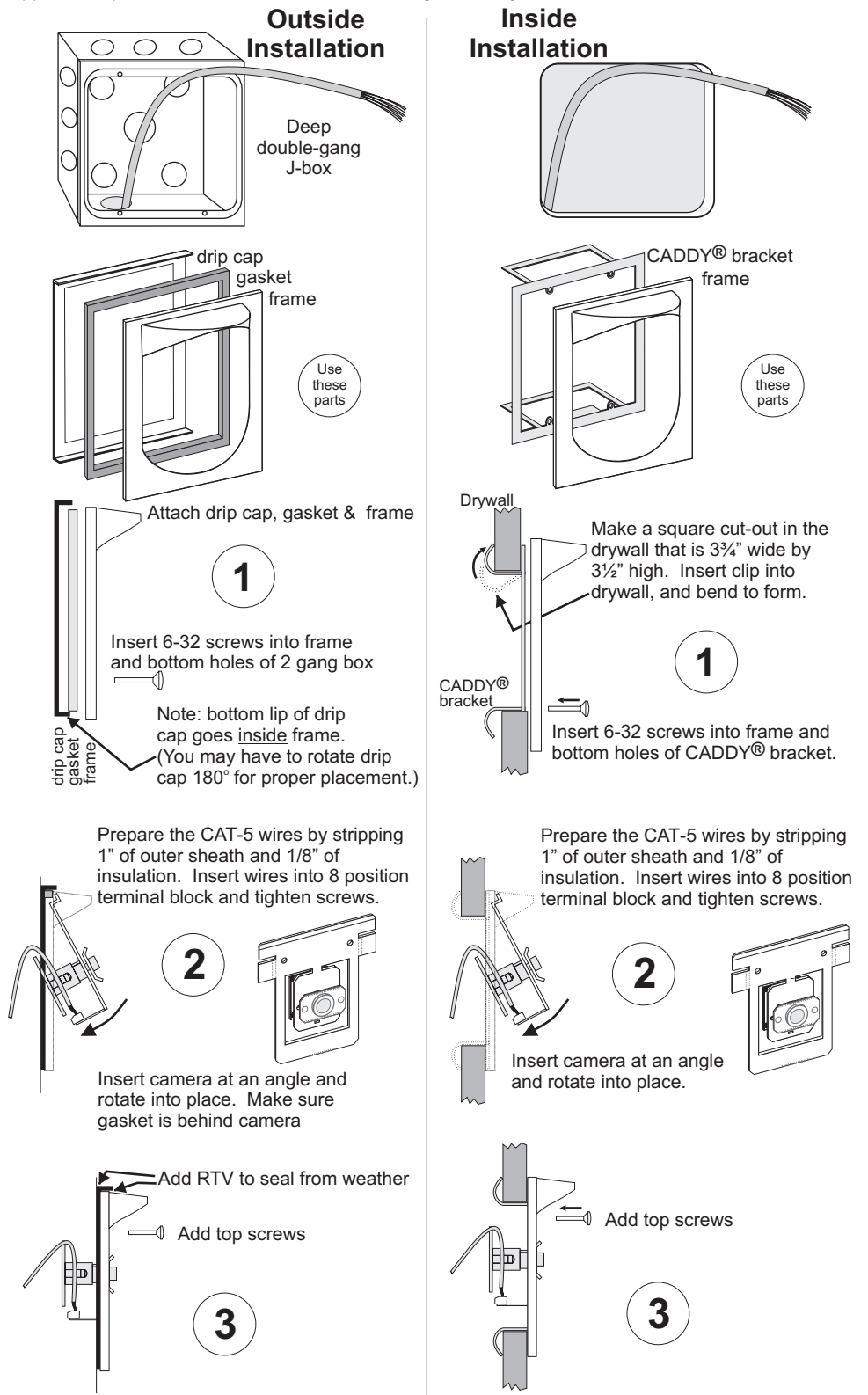

Aiming the Camera

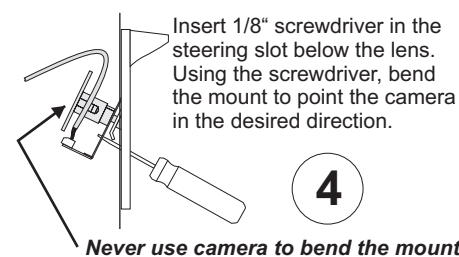

Attaching the Window

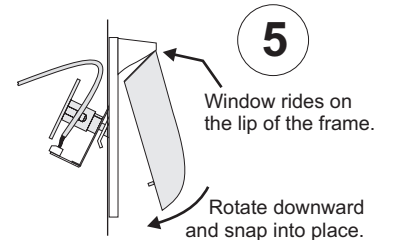

DECLARATION OF CONFORMITY

THIS DEVICE COMPLIES WITH PART 15 OF THE FCC RULES. OPERATION IS SUBJECT TO THE FOLLOWING TWO CONDITIONS: (1) THIS DEVICE MAY NOT CAUSE HARMFUL INTERFERENCE, AND (2) THIS DEVICE MUST ACCEPT ANY INTERFERENCE RECEIVED, INCLUDING INTERFERENCE THAT MAY CAUSE UNDESIRABLE OPERATION.

Installation requirements:

- FCC classifies this product under part 15 of its rules as a "television interface device". Systems designed using television interface devices have the following legal requirements:
- 1) The modulated channel signal strength may not exceed 15.56dBmV at any television. *Federal Regulation 47CFR15.115(b)(1)(i).*
 - 2) If an antenna is used in the system, the modulated channel signal strength may not exceed -51dBmV at the antenna input port. *Federal Regulation 47CFR15.115(c)(4).*

For the Installer:

Any system you design must comply with these regulations. As the installer, you are responsible. The H722 or H722C (when used with an H511) has the necessary characteristics to comply with the above requirements as designed without additional accessories. The H511HHR is suitable for use with an antenna or with CATV systems. The H511BID is suitable for use with CATV systems only.

Good ...
 Typical room - phone, TV
 Media center - phone, satellite receiver, AV modulators
 Home office - phone, TV, cable modem
 Better ...
 Typical room - phone, TV, ethernet
 Media center - phone, TV, ethernet, satellite receiver, AV modulators
 Home office - phone, TV, ethernet, cable modem
 Best ...
 Typical room - phone, TV, ethernet, satellite receiver
 Media center - phone, TV, ethernet, satellite receiver, AV modulators, hi-speed data
 Home office - phone, TV, ethernet, satellite receiver, cable modem, hi-speed data

	Good	Better	Best
Typical Room	1 Cat-5 1 RG-6	2 Cat-5 1 RG-6	2 Cat-5 2 RG-6
Media Center	1 Cat-5 3 RG-6	2 Cat-5 3 RG-6	3 Cat-5 3 RG-6
Home Office	1 Cat-5 2 RG-6	2 Cat-5 2 RG-6	3 Cat-5 3 RG-6

Wiring a house for OpenHouse
 The cables in an OpenHouse run from the various rooms of the house directly to the service center location. (This is known as 'home run' wiring.) Two types of wire are used for communication and entertainment: Cat-5, 4-UTP (4 Unshielded Twisted Pairs) wire handles data or 1 to 4 telephone lines. RG-6 coax handles television (antenna or cable), satellite dish, cable modem, or AV modulator signals. (An AV modulator creates new TV channels for front door camera, DVD player, a VCR or a satellite receiver.)
 We recommend the following pre-wire schemes. Run these wires from the service center to the rooms indicated.

OpenHouse ChannelPlus[®] Video Cameras
 Models H722 & H722C



www.channelplus.com

Warranty

Multiplex Technology, Inc. warrants this product to be free from defects in materials and workmanship for a period of one year from the date of purchase or MTI will repair, or at its option, replace the defective product. To obtain warranty service, call MTI for a return material authorization (RMA) number and return the product prepaid.

Attention: Customer Service. Please put the RMA number on the outside of the carton.

Any implied warranty arising from the sale of the product including implied warranties of merchantability and fitness for purpose are limited to the warranty stated above. MTI shall not be responsible for losses or damages or expenses, whether direct, consequential or incidental arising from the use of or the inability to use this product. Some states do not allow limitations on how long the implied warranty lasts or the exclusion or limitation or incidental or consequential damages, so the above limitations and exclusions may not apply to you. This warranty gives you specific legal rights, and you may have other rights which may vary from state to state.



Compatible

ChannelPlus Enclosures, Modules, Accessories & Wall Plates

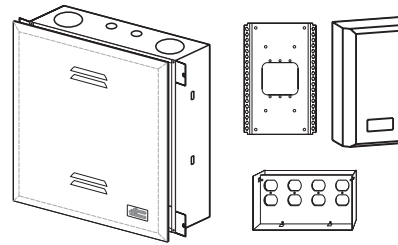

Service center enclosures

A full line of OpenHouse compatible enclosures, from simple, inexpensive mounting plates to high capacity in-wall cabinets. AC outlets can be mounted inside the cabinets using a UL listed accessory.

Starter systems

RF splitters and telephone punch downs. When it is time to upgrade, just snap this module out and replace with one of more of the more sophisticated units.

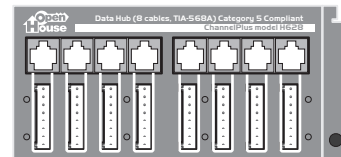
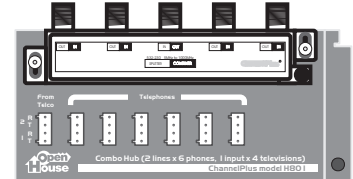

Data hubs

Termination blocks for the CAT-5 cables, Ethernet hubs. Bring the Internet to any room in the home. Or create a home data network.

Telephone hubs

Connections for 1-4 phone lines to every room. Starter hub adds RJ-31X jack for security system dialer.

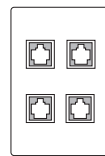
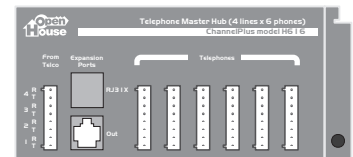

Wall plates

Wall plate systems for all rooms. The typical room gets TV and telephone. The Home office wall plate adds data ports. The media center wall plate adds satellite feeds.

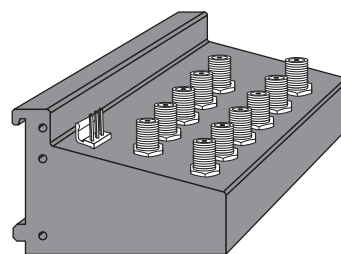

Coax panels

Distribute antenna or cable TV to every room of the house. Some models include bi-directional amplifiers for interactive cable systems. Some models include modulator inputs and IR engines.

AV modulators (for service center)

Create a new TV channel for a front door camera. Some models feature Cat-5 input connections.

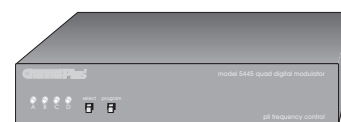
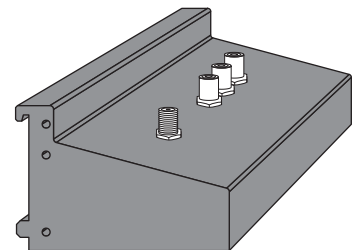

AV modulators (for media center)

Create new TV channels for DVD, VCR, or a satellite receiver. These modulators sit in the media center. Some offer true MTS stereo.

IR Accessories

Control video devices from any room.

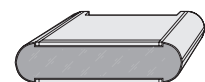

New ChannelPlus products are added all the time. Visit our website to learn more: www.channelplus.com

Free Manuals Download Website

<http://myh66.com>

<http://usermanuals.us>

<http://www.somanuals.com>

<http://www.4manuals.cc>

<http://www.manual-lib.com>

<http://www.404manual.com>

<http://www.luxmanual.com>

<http://aubethermostatmanual.com>

Golf course search by state

<http://golfingnear.com>

Email search by domain

<http://emailbydomain.com>

Auto manuals search

<http://auto.somanuals.com>

TV manuals search

<http://tv.somanuals.com>