



MODEL MS3001 / MS3200

VEHICLE SECURITY SYSTEM

OWNER'S MANUAL

Congratulations on your purchase of the Ungo Security System. This Ungo Security System was designed in the heart of California's high-tech "Silicon Valley" by Ungo Security Corporation, a subsidiary of Clarion Corporation. Since its founding in 1975, Ungo has been recognized as a pioneer and long time industry leader in vehicle security.

Please read this manual thoroughly to familiarize yourself with your system's components and operation. Discuss any questions you might have with your installing dealer.

Record the serial number of your Ungo system and keep all dealer records and receipts. Be sure to discuss the installation with the dealer so that you understand the specifics of the installation in your vehicle. Also, do not forget to complete and mail the Product Warranty Registration Card within 60 days of purchase and insure that the installing dealer has stamped and signed the appropriate section in order to properly register your warranty.

Table of Contents

1.	About Your System	Page 1
2.	Remote Transmitters	
	Remote Transmitter Layout	Page 2
	Two Car Operation	Page 3
	Adding a New Transmitter into the System	Page 4
	Deleting Transmitters	Page 4
	Battery Replacement	Page 5
3.	Basic Operation	
	Remote Arming	Page 6
	Remote Disarming	Page 7
	Tamper Alert	Page 7
	Silent Arming / Disarming	Page 7
	Arming Mode Selection	Page 8
	Passive Arming	Page 8
	Panic Mode	Page 8
	Emergency Override	Page 9
	Automatic System Rearming	Page 9
	Full Time System Diagnostics	Page 9
4.	Other Features	
	Valet Mode	Page 10
	Ignition Controlled Door Locking / Unlocking	Page 10
	Dome Light Control	Page 10
	Auxiliary Function Outputs	Page 11
	Remote Car Starter	Page 12
	Garage Door Receiver	Page 12
	Additional Remote Transmitters	Page 12
5.	Reference Chart	Page 13
6.	Technical Data	Page 14
7.	Warranty	Page 15

Note: Certain features described in this manual may require additional parts and/or labor. Also, many features of the Ungo MS3001 / MS3200 security systems have selectable options that must be activated or programmed during the system's installation. These items will be identified in the following sections. Your Authorized Ungo Dealer will be happy to discuss these features with you and help you design your system to meet your needs.

About Your Ungo Security System

Ungo Security Systems are state-of-the-art vehicle protection systems equipped with features designed to:

- Deter** potential intrusions to the vehicle by continually flashing the system LED status indicator while the system is Armed, giving a visual indication to any passer-by that the system is equipped with a security system.
- Detect** intrusions to the vehicle, including impacts to the vehicle's body and glass, and opening of the doors, trunk and hood.
- Alert** those in the vicinity of the vehicle by sounding the system's siren and flashing, parking lights, and honking the horn.
- Inform** the owner when the system has been triggered and specifically which zone was violated. The system will also inform the user of any bad switches or sensors that may be causing the system to function improperly.
- Protect** both you and the contents of your vehicle with features such as panic mode, dome light illumination, and ignition controlled door locking.

Each Ungo MS3001 / MS3200 System comes with:

- **Main Unit** - the "brain" of the system.
- **2 - Three Button Remote Transmitters**
- **Siren (MS3001)** - Water resistant, high output siren that sounds when system is triggered.
- **Battery Back-up Siren (MS3200)** - Water resistant, self contained, battery back-up siren that sounds for up to 1 full hour when system is triggered or if the siren becomes disconnected from it's source of power.
- **Status LED** - red illuminated indicator that provides system status information.
- **Emergency Override / Valet Switch** - used to override the system in case the Remote Transmitters become lost or stolen. Also used to temporarily disable the system when the vehicle is being serviced or turned over to a parking attendant.

Options and Convenience Features*

The advanced design of the Ungo system incorporates a number of optional inputs and outputs allowing you to create a customized security / convenience system by easily accommodating many optional convenience and security features such as:

- | | |
|---|--|
| <input type="checkbox"/> Remote Door Locking | <input type="checkbox"/> Glass Breakage Sensor |
| <input type="checkbox"/> Starter Disable | <input type="checkbox"/> Radar Sensor |
| <input type="checkbox"/> Horn Honk | <input type="checkbox"/> Garage Door Receiver |
| <input type="checkbox"/> Illuminated Entry / Exit | <input type="checkbox"/> Auxiliary Lighting Control |
| <input type="checkbox"/> Remote Window Control | <input type="checkbox"/> Stereo System Valet |
| <input type="checkbox"/> Remote Car Start | <input type="checkbox"/> Remote Head Lamp Control |
| <input type="checkbox"/> Extended Range Antenna | <input type="checkbox"/> Back-up Battery Siren |
| <input type="checkbox"/> Power Trunk / Hatch Release | |

*May require additional parts and/or labor, see store for details.

Remote Transmitters

Remote Transmitter Layout

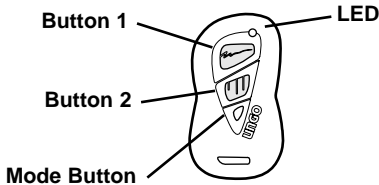

Each MS3001 / MS3200 system comes with 2 multifunction Remote Transmitters used to control nearly all of the system's features.

Each time a transmitter button is pressed, the LED will flash to indicate that a transmission is taking place.

Button 1 Arms and Disarms the system. This Button also locks and unlocks the doors when the system is in Valet Mode.

Button 2 controls the system's Auxiliary Function 1, which is normally used for activating a car's electric trunk release.

When Button 1 and 2 are pressed together, the system will Arm or Disarm *silently* (without chirp confirmation).

As an option, your installer can set system to *always* arm without chirp confirmation. If this is done, then pressing Buttons 1 and 2 together will Arm or Disarm the system *with* chirp confirmation.

The **Mode Button** will change the function of Buttons 1 and 2 when it is pressed, allowing Buttons 1 and 2 to control the system's Auxiliary Function Outputs.

Note also that the LED on the transmitter turns green when the Mode Button is pressed to indicate the current function of Buttons 1 and 2. The LED will stay on for 5 seconds, then turn off, returning Buttons 1 and 2 to their default settings.

It is also possible to set individual Remote Transmitters to arm and disarm the system using any of the Transmitters function Buttons, which is extremely useful when a Transmitter is used to control multiple systems. See ***Adding a Remote Transmitter into the System.***

The following diagram illustrates how the Remote Transmitter controls the functions of the system:

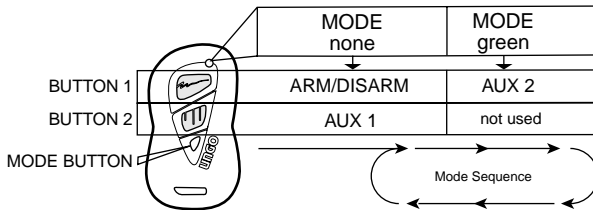

Two Car Operation

If you want to control two or more Ungo Security systems by a single Remote Transmitter, the unused functions of the Remote Transmitter can be set up by your dealer to operate another Ungo Security system, giving you the convenience of operating multiple vehicles from a single Remote Transmitter.

When set for two car operation, the Remote Transmitters will function as in the example below:

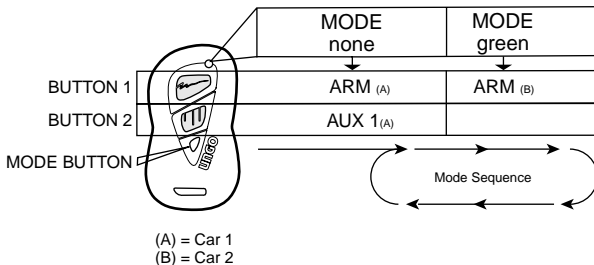

For more information about Two Car operation, see your Authorized Ungo Dealer.

Adding a New Transmitter into the System

The MS3001 / MS3200 has the ability to recognize up to 21 individual Remote Transmitters. If the vehicle is used by multiple drivers, each can have their own Remote Transmitter.

To add Remote Transmitters:

1. Turn on the ignition.
2. Press and hold the Override switch.

- The status LED will turn on red.

3. Within 5 seconds:

Continue holding the Override switch and Press Transmitter Button 1*
For remote arming **with** chirp confirmation.

--- or ---

Release the Override switch and Press Transmitter Button 1*
For remote arming **without** chirp confirmation.

- The status LED will flash once quickly to confirm that the new Remote Transmitter has been added.

4. Turn off the ignition.

* The Button that is pressed will be the Arm/Disarm Button on that Remote Transmitter. You may program any of the Transmitter's function buttons to arm and disarm the system at this point.

Deleting Transmitters (Adding a Remote Transmitter and Erasing All Other Remote Transmitters From the System)

1. Turn on the ignition.
2. Press and hold the Override switch.

- The status LED will turn on red.

Continue to hold the Override switch.

- After 5 seconds, the status LED will flash 4 times, then turn on red again.

3. Within 5 seconds:

Continue holding the Override switch and Press Transmitter Button 1*
For remote arming **with** chirp confirmation.

--- or ---

Release the Override switch and Press Transmitter Button 1*
For remote arming **without** chirp confirmation.

- The status LED will flash once quickly to confirm that the new Remote Transmitter has been added.

4. Turn off the ignition.

* The Button that is pressed will be the Arm/Disarm Button on that Remote Transmitter. You may program any of the Transmitter's function buttons to arm and disarm the system at this point.

Battery Replacement

Your Ungo Remote Transmitter uses a 12 volt alkaline battery, which will need to be replaced from time to time. Under normal conditions, the battery should last for up to a year before it needs replacement.

When your Remote Transmitter's battery is in need of replacement, you will notice a decrease in your system's operating range or a decrease in the brightness of the Transmitter's LED indicator.

To change the battery, remove the 2 screws at the back of the Transmitter and carefully separate the top and bottom halves of the Transmitter case.

Insert the new battery, making sure that the positive and negative terminals are positioned correctly and replace the cover.

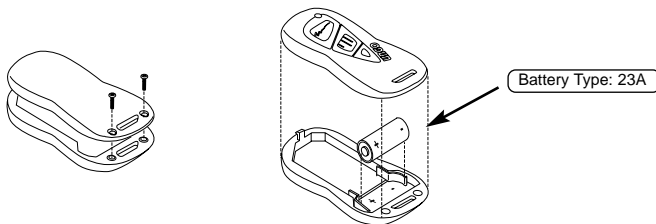

Basic Features

Remote Arming

When Armed, the system monitors and protects 5 independent areas, or **zones**, including the ignition switch, doors, hood/trunk, Shock Sensor, and an optional sensor.

To Arm the System:

1. Turn off the ignition.
 2. Press Button 1.
 - The siren will chirp once.*
 - The doors will lock.
 - The parking lights will flash once.
 - The LED will turn on red, indicating the ignition, doors, hood and trunk inputs are activated.
- * The siren chirp(s) during Arming will alert you the condition of the system and vehicle when the system is armed.
- | | | |
|--------------|---|---------------------------------|
| 1 chirp | = | normal arming |
| 1 + 3 chirps | = | Shock Sensor sensitivity is off |
| 1 + 4 chirps | = | door, hood, or trunk open |

During Arming, if the system detects a bad sensor or an open zone, the system will ignore that input, but keep all other areas protected.

3. After 20 seconds:
 - The LED will begin blinking, indicating that the sensor inputs are activated.

While the system is **Armed**, the system will trigger if:

- The ignition key is turned on.
- The doors are opened.
- The Shock Sensor detects an impact to the vehicle or the motion of the car being raised.
- The hood or trunk is opened.
- A connected optional sensor is disturbed.

When triggered, the siren will sound, the horn will honk, and the parking lights will flash.

If the same input triggers the system 3 times during a single arming cycle, the system will bypass that input, keeping the other zones protected, until the next time the system is armed.

If the Shock Sensor detects a light impact to the car or a connected optional sensor triggers the system's Warn Away input, the siren will sound a chirp to warn away the potential intruder.

Remote Disarming

To Disarm the System:

Press Button 1.

- The siren will chirp twice.*
- The doors will unlock.
- The parking lights will flash twice.
- The dome light will turn on.
- The LED will turn off.

* The siren chirps during disarming will alert you if the system had been triggered while armed.

2 chirps	=	normal disarming
1 long chirp + 1 short chirp	=	Tamper Alert - system was triggered

Tamper Alert

On Disarming, if the system responds with one long chirp and one short chirp, indicating the system was triggered, the LED will flash for 60 seconds to indicate the zone that triggered the system.

LED Flashes (60 seconds):

1 flash	=	door
2 flashes	=	Shock Sensor
3 flashes	=	optional sensor
4 flashes	=	hood / trunk

example: flash-flash-pause-flash-flash-pause = Shock Sensor

Silent Arming / Disarming

Each Remote Transmitters can be individually set to Arm and Disarm the system with or without chirp confirmation at the time they are programmed into the system (see **Adding a New Transmitter into the System**).

To temporarily cancel the Arming and Disarming confirmation chirps, you can Arm or Disarm the system by pressing Buttons 1 and 2 *together*.

Note: The confirmation chirps will only be cancelled if the system status is normal. The chirp indications for the open zone warning will not be cancelled when the system is Armed or Disarmed silently .

Arming Mode Selection

Your system can be set in one of the following Arming Modes:

- Passive (automatic) Arming *with* chirp confirmation
- Active Arming (by Remote Only)
- Passive (automatic) Arming *without* chirp confirmation

To set the Arming Mode:

1. Turn the ignition on.
2. Within 4 seconds, press Buttons 1 and 2 together.

First push:	one chirp	=	Passive Arming with chirp
Second push:	two chirps	=	Active Arming
Third push:	three chirps	=	Passive without chirp
3. Turn the ignition off to save your selection.

Passive Arming

When the **Arming Mode** has been set for *Passive Arming*, the system arms itself automatically, each time the ignition is turned off and all of the doors, hood and trunk are closed.

To start the Passive Arming Process:

1. Turn off the ignition.*
 - The status LED will begin to flash quickly.
2. Open the door and exit the vehicle.
 - Once all doors are closed and the dome light is turned off, the LED will turn off.
3. After 20 seconds,
 - The siren will chirp.
 - The parking lights will flash.
 - The doors will lock.**
 - The status LED will flash red, indicating the system is armed.
4. The system is now armed.

* The ignition must have been on for *at least 4 seconds* before the Passive Arming sequence will begin.

** If the Passive Locking feature is selected.

To temporarily disable Passive Arming, you can turn the ignition key on then off, within 4 seconds. The status LED will stop flashing, and the system will not passively arm until the next time the key is on for more than 4 seconds. This feature is useful for turning off passive arming when refueling or washing your car or if you want to sit in your car and do not want the system to arm.

Panic Mode

Allows you to instantly trigger the alarm in an emergency situation by the Remote Transmitter.

To enter Panic Mode:

1. Press and hold Button 1 for 2 seconds.
 - The system will trigger.
2. Press Button 1 again to stop Panic Mode.*

If Panic Mode is not stopped by the Remote, it will automatically time out after 40 seconds, and the system will return to its prior Armed/Disarmed state.

Emergency Override

In case your Remote Transmitter becomes inoperable, or it is lost or stolen, you can still enter and drive your car by using the following procedure. Be sure that before you attempt this procedure you have your ignition key ready and that you know the location of the override switch.

To override the system:

1. Unlock the door using the key.
2. Enter the vehicle.
 - Because the system is armed, the system will trigger and the siren will be sounding.
3. Turn ignition key on.
4. Press and hold the override switch.
 - The system will disarm.
5. You can now start and drive the car.

Automatic System Rearming

This feature, which can be turned on during the installation, insures the security of the system by protecting your car in case of an accidental disarm.

If your system becomes disarmed due to an accidental press of the Disarm Button, the system will automatically rearm if no other activity is detected within one minute.

One minute after Remote Disarming, the system will alert you with a 10 second series of chirps, then arm. (If the Passive Door Locking feature is selected during the installation, the system will also relock the doors.)

Any of the following will cancel Automatic System Rearming:

- Turn on the ignition.
- Open the Trunk or Hood.
- Activate Auxiliary Function 1 or 2.

Automatic System Rearming is independent of Passive Arming and only takes place if the system was Armed (actively or passively) for at least 20 seconds and then Disarmed by the Remote Transmitter.

Full Time System Diagnostics

The system continuously monitors all protected zones, even when it is not armed, and warns you if it detects a problem when you turn off the ignition.

1. Turn off the ignition.
2. If the siren chirps twice, the system has detected a problem.
3. The status LED will flash to indicate the zone where the problem has been detected.

1 flash	=	door
2 flashes	=	Shock Sensor
3 flashes	=	optional sensor
4 flashes	=	hood / trunk

Other Features

Valet Mode

Allows you to temporarily disable the security system when the car is being serviced or turned over to a parking attendant.

To turn Valet Mode on or off:

1. Turn on the ignition.
2. Press and hold the override switch.
3. While holding the override switch, turn off the ignition.
 - The siren will chirp **once** to indicate you have turned Valet Mode **on**.
 - The siren will chirp **twice** to indicate you have turned Valet Mode **off**.
4. Release the override switch.

While Valet Mode is on, you can continue to lock and unlock your doors with the Remote Transmitters, as well as operate the Auxiliary Functions.

For added protection, when the doors are locked by the Remote Transmitter, the system's Starter Disable circuit will activate and the LED will emit double flashes until the system is unlocked by the Remote.

If the Remote Transmitter is lost, stolen, or becomes inoperable while the car is locked in Valet Mode, you can use the **Emergency Override** procedure to deactivate the Starter Disable circuit.

Ignition Controlled Door Locking

For added convenience and safety, this feature automatically locks your car's doors 10 seconds after the ignition key is turned on and unlocks the doors when the ignition key is turned off.

To set Ignition Locking / Unlocking:

1. Turn the ignition on.
2. Within 4 seconds, press Transmitter Button 2.

The siren will chirp to indicate the setting.

one chirp	= On
two chirps	= Off

3. Press Transmitter Button 2 again to change the setting.
4. Turn off the ignition key to save your selection.

To prevent the keys from being locked inside the vehicle when Ignition Controlled Door Locking is on:

- The system will not lock the doors if any door is open when the ignition is turned on.
- The system will not lock the doors if any door is opened during the 10 second countdown.

To prevent you from accidentally locking your keys inside the car:

- The system will not automatically lock the doors if a door is open when the ignition key is turned on.
- The system will not automatically lock the doors if a door is opened during the first 10 seconds after the ignition key is turned on.

Dome Light Control

As an option for increased safety and convenience, the system can be set, during the installation, to automatically turn on the dome light when you Disarm the system and when you turn off the ignition.

Illuminated Entry. The dome light will turn on for 20 seconds when the system is disarmed (or unlocked in Valet Mode) using the Remote Transmitter.

Illuminated Exit. If the ignition key has been on for at least 10 seconds, the dome light will turn on for 20 seconds when you turn off the ignition.

Auxiliary Function Outputs

The system is equipped with two Auxiliary Function outputs that can be used to control a variety of additional features including, electric trunk release, remote car starter, power windows, power sunroof, stereo system valet, garage door receiver, etc.

Auxiliary Function 1 - momentary

Normally, this function is used to activate a power trunk release.

To operate Aux. 1, press Button 2.

This function will operate regardless of whether the system is armed or disarmed and will stay active for as long as Button 2 is held.

Sensor Defeat with Auxiliary 1 (Dedicated Remote Start Mode). When your system is used with an optional Remote Car Starter (Ungo model SAA4295), Auxiliary Function 1 can be selected to remotely start your car's engine. With the MS3001 / MS3200's Dedicated Remote Start Mode enabled, when Auxiliary Function 1 is used to activate the Remote Car Starter while the system is armed, the Shock Sensor and optional sensor inputs will be ignored. This will allow the alarm to continue protecting the door and hood/trunk inputs, but prevent it from triggering due to the motion of the engine starting and running. *This feature must be enabled by your installer at the time of installation.*

Sensor Defeat with Auxiliary 1 (Remote Shock Sensor Bypass). If the Auxiliary Function 1 is not used to activate an auxiliary feature, it may be used as a remote shock sensor bypass instead. In case of extreme weather conditions such as high winds, the Shock Sensor can be temporarily bypassed from the Remote Transmitter while the system is armed to prevent the system from false alarming. *To use this feature, Sensor Defeat with Auxiliary 1 must be enabled by your installer at the time of installation.*

Auxiliary Function 2 - momentary / latched

This Auxiliary Function has two selectable operating modes which can be programmed by your installer to allow custom operation of your vehicle and its accessories.

Momentary - the system will provide an output for as long as the Transmitter button is held.

Latched - the system will provide an output that turns on when the transmitter button is pressed and turns off when the transmitter button is pressed again.

Suggested use: *The Latched mode works great for activating auxiliary lighting such as neon or off road lights. It can also be used to activate your stereo system so that it be turned on without having the key in the ignition.*

To operate Aux. 2, press the Mode Button, then Button 1.

Remote Car Starter

When an optional Remote Car Starter (Ungo model number **SAA4295**) is installed into your car, the Remote Transmitter can be used to remotely start and run your car engine to warm-up the engine, as well as activate the heating / air conditioning system.

With the Dedicated Remote Start feature designed into the MS3001 / MS3200, the Remote Car Starter can be used to start your engine even while the system is armed. When the Remote Car Starter is activated by an Auxiliary Function, the system will receive a signal to temporarily ignore the Shock Sensor and the optional sensor inputs, so that the system will not trigger due to the action of the car starting or the vibration of the engine. The doors, hood, and trunk, however, remain protected.

When the Remote Car Starter is activated, the siren will emit 5 quick chirps, indicating the ignition trigger and sensor triggers are being temporarily disabled.

Garage Door Receiver

When an optional Garage Door Receiver (Ungo model number **SAA5999**) is used with your system, the Remote Transmitters can be set to control almost any automatic garage door opener.

By adding this feature to your system, you not only add the convenience of being able to open your garage door and activate your car security system by the same remote, but you also add the protection of Ungo's Varicode 2 anti-code grabbing technology to your automatic garage door

Reference Chart

You can use this chart to quickly identify and interpret your system's chirp indications and LED flashes.

Output	When	Status
1 chirp	arming	normal arming
1 + 3 chirps	arming	Shock Sensor sensitivity is off
1 + 4 chirps	arming	door, hood, or trunk is open
2 quick chirps	arming	Valet Mode is on
LED double flashes	Valet Mode	Starter Defeat Activated
2 chirps	disarming	normal disarming
1 Long + 1 Short Chirp	disarming	Tamper Alert - system was triggered
no LED flashes	after Tamper Alert	ignition
1 LED flash	after Tamper Alert	door
2 LED flashes	after Tamper Alert	Shock Sensor
3 LED flashes	after Tamper Alert	optional sensor
4 LED flashes	after Tamper Alert	hood or trunk
1 chirp	while armed	Warn Away
5 quick chirps	while armed	Dedicated Remote Start Mode activated
Double chirps (for 10 seconds)	1 minute after disarming	Automatic Rearming
LED flashing quickly	ignition key off	Passive Arming sequence started
Two chirps	ignition key off	Full Time System Diagnostics
1 LED flash	after Full Time Sys. Diag.	door
2 LED flashes	after Full Time Sys. Diag.	Shock Sensor
3 LED flashes	after Full Time Sys. Diag.	optional sensor
4 LED flashes	after Full Time Sys. Diag.	hood or trunk

Technical Data

Specifications

Main Unit

Voltage: 12v, negative ground

Current Consumption: <13.5mA

Temperature Range: -40°F to +170°F

-40°C to +77°C

Auxiliary Output Capability: 150mA

Internal Relays: 12/28A

Transmitter

Current Consumption: <.002mA, standby

Battery Type: miniature 12v, type 23A

FCC ID:

MP62VUUUNGO1001

HP92VUUUNGO603/03

THIS DEVICE COMPLIES WITH FCC RULES PART 15. OPERATION IS SUBJECT TO THE FOLLOWING TWO CONDITIONS: (1) THIS DEVICE MAY NOT CAUSE HARMFUL INTERFERENCE AND (2) THIS DEVICE MUST ACCEPT ANY INTERFERENCE THAT MAY BE RECEIVED, INCLUDING INTERFERENCE THAT MAY CAUSE UNDESIRED OPERATION.

Ungo Security Corporation
Gardena, CA
USA

Warranty Information

Model No.: MS3001 / MS3200 (circle one)

Serial No.: _____

Dealer Name: _____

Address: _____

Purchase Date: _____

Warranty Information

1. Ungo Security Corporation of Gardena, California ("Ungo Security") warrants this Ungo system to be free from defects in materials and workmanship and to comply with Ungo Security's applicable printed specifications.

2. Ungo Security systems carry a limited lifetime warranty on the Main unit (system brain) and transmitters. The warranty is limited to Ungo Security systems that have been installed by an approved Ungo dealer and is extended to the Original Purchaser ("Owner") and to the original vehicle in which it was installed only, and is not transferable to any subsequent owner or owners of the product(s).

All other products (including those products of other manufacturers which are supplied by Ungo security as a part of, or an accessory to, an Ungo Security-manufactured product) are warranted by Ungo security for a period of one year from the date of sale to the Owner. For specific identification of such products contact Ungo Security.

3. This warranty shall not cover: (I) any damage caused by Owner's negligence or misuse of any kind, or any damage due to causes unrelated to Ungo Security's manufacturing, including, but not limited to improper servicing or repair by someone other than Ungo security or an authorized service facility; (II) alterations or modifications to the Ungo System other than the addition of an authorized accessory; or (III) improper installation or removal from the vehicle contrary to Ungo Security's instructions.

4. Obligations of Ungo Security. In the event the Owner's Ungo System does not comply with this warranty, it must be returned to Ungo security as specified below. Ungo security will repair or replace it with a new or reworked unit, within thirty (30) days of receipt and acceptance of such defective unit, and without cost to Owner.

5. To make a claim under the warranty. Owner must: (I) provide Ungo security with written notice that the Ungo System does not comply with the warranty within thirty (30) days from the date of the Owner's discovery of the defect and (II) furnish proof of purchase and purchase date (this requirement is satisfied if Ungo security has a completed warranty registration card on file).

6. Owner obligations. To obtain Warranty Service, Owner must at Owner's expense: (I) have the Ungo System removed from the vehicle by an authorized Ungo Security dealer, (II) package the unit in a reasonable manner to prevent damage to the unit during shipment; and (III) ship the unit, freight prepaid, to Ungo Security's factory or other authorized repair facility.

7. Repair facility locations. To obtain the name, address and phone number of the nearest Authorized Ungo Repair Facility, Owners may contact Ungo security at 310-327-9100.

8. The Owners of Ungo Systems in California have the right to have the product serviced or repaired during the warranty period. The warranty period will be extended for the number

of full days that the product has been out of the Owner's hands for warranty repairs. If a defect exists within the warranty period, the warranty will not expire until the defect has been fixed. The warranty period will also be extended if the repair has not been performed due to delays caused by circumstances beyond the control of the Owner, or if the warranty repairs did not remedy the defect and the Owner notifies Ungo Security or the seller of the failure of the repairs within sixty (60) days after they were completed. If, after a reasonable number of attempts, the defect has not been fixed the Owner may return this product for replacement or a refund, subject in either case, to a deduction of a reasonable charge for usage. The time extension does not effect the protection or remedies the Owner has under other laws.

9. Exclusions from liability.

(A) In no event shall Ungo security be liable for any loss or damages beyond the original purchase price of the Ungo system, and Ungo security specifically excludes any and all incidental and consequential damages, whether resulting from breach of warranty or contract, negligence or other conduct in connection with any sale, use, servicing or repair of a unit. (Some states do not allow the exclusion of incidental or consequential damages, so the above exclusion may not apply to you.)

(B) There are no warranties, express, statutory or implied, which extend beyond that which is described herein, and in particular, all implied warranties of merchantability and fitness for a particular purpose, and all warranties of title and against encumbrances, are expressly disclaimed, limited and excluded as permitted by law; but in no event shall any implied warranty, whether of merchantability of fitness for a particular purpose or otherwise, have a duration exceeding that of the express warranty made herein. (Some states do not allow limitation on how long an implied warranty lasts, so the above limitation may not apply to you.)

(C) No agent, officer, employee or representative of Ungo Security, or any other person, has authority to make any representations, promises or warranties respecting Ungo Systems and their authorized accessories.

(D) Owner has the right to bring any action at law or in equity to resolve disputes concerning, or to enforce, the provisions of this warranty. No action at law or in equity may be brought against Ungo security for breach of warranty or contract or based on negligence of other conduct more than three (3) years from the date the cause of action has occurred.

(E) This warranty gives you specific legal rights, and you may also have other rights which vary from state to state.

(F) The remedies extended herein are the sole and exclusive remedies available to Owners of Ungo systems.

(G) Under no circumstances should this warranty, or the products covered by it, be construed as an insurance policy against loss.

Ungo Security Corporation

A Clarion Company
661 West Redondo Beach Blvd.
Gardena, CA 90247
800-Go-Clarion
www.clarionmultimedia.com

Free Manuals Download Website

<http://myh66.com>

<http://usermanuals.us>

<http://www.somanuals.com>

<http://www.4manuals.cc>

<http://www.manual-lib.com>

<http://www.404manual.com>

<http://www.luxmanual.com>

<http://aubethermostatmanual.com>

Golf course search by state

<http://golfingnear.com>

Email search by domain

<http://emailbydomain.com>

Auto manuals search

<http://auto.somanuals.com>

TV manuals search

<http://tv.somanuals.com>