

# Installation Instructions

## Gas Stacking Stand Mounting Kit, P/N 111467G for Two Gas SteamChef 22CGT3 or 22CGT6 Steamers Mounted on an ES263044 Equipment Stand

**This kit is for mounting (2) SteamChef 22CGT3.1 or 6.1 steamers on an ES263044 Equipment Stand.**

The Installation of Cleveland Range steamers on the ES263044 Equipment Stand should only be performed by Cleveland Range authorized technicians.

Read the entire installation procedure before beginning.

The installer must be familiar with this procedure, and the instructions supplied with each SteamChef Steamer, Cleveland Range P/N 22CGT-INM and P/N 22CGT-OPM.

Item Number on Drawings	Quantity	Part Number	Description
-	1	112523	WARNING LABEL, BURN AND SCALD HAZARD (SEE FIG. 2)
22	3	19148	SCREW, HEX WASHER HD, #10 X 1/2 , TYPE AB, ZINC PLTD
21	1	111401	FLUE RISER ASSY, CHEF 6
20	1	112488	ASSEMBLY, FLUE ADAPTER
19	7	108734	NUT, "U" TYPE (EXTRUDED) #10-24 UNC-2B THREAD
18	8	101231	SCREW, 10-24 X 0.500 SST, PHILLIPS TRUSS HEAD
17	1	112490	ASSEMBLY, REAR FLUE COVER
16	1	112489	COVER, FLUE ADAPTER, FRONT
15	4	110921	FITTING, 1/4 – 18 NPTF X 3/4 – 11.5 NH, BRASS
14	2	111000	FITTING, WYE, GHTF X (2) GHTM, BRASS
13	4	110987	STRAINER, FILTER WASHER, GARDEN HOSE INLET (GHT)
12	2	111160	HOSE ASSEMBLY, GHT (F) X 39" LONG
11	1	05265	ELBOW, 90, 1" NPT, BLK
10	1	1054693000	HOSE, BLACK EPDM, 1" ID X 30" LONG
9	2	03204	CLAMP, HOSE, WORM DRIVE, .812-1.50 DIA
8	2	14481	FITTING, 1" HOSE X 1" NPT (M)
7	1	20221	TEE, 1 1/2" NPT, BLK
6	2	02573	BUSHING, HEX, 1" NPT X 1-1/2" NPT, BLK
5	2	109268	NIPPLE, 1" NPT X 3-1/2" LONG, BLK, TBE
4	4	111013	WASHER, FENDER, 17/32" ID X 1.5" OD
3	4	23153	WASHER, LOCK, 1/2", SST
2	4	111012	SCREW, 1/2 – 13 , HEX HEAD
1	1	ES263044	EQUIPMENT STAND, ASSEMBLY, STACKED

1333 East 179<sup>th</sup> Street  
Cleveland, Ohio 44110  
Phone: (800) 338-2204  
Fax: (216) 481-3782  
[www.clevelandrange.com](http://www.clevelandrange.com)



**This kit is for mounting (2) SteamChef 22CGT3 or 6 steamers on an ES263044 Equipment Stand.**

The Installation of Cleveland Range steamers on the ES263044 Equipment Stand should only be performed by Cleveland Range authorized technicians.

Read the entire installation procedure before beginning.

The installer must be familiar with this procedure, and the instructions supplied with each SteamChef Steamer, Cleveland Range P/N 22CGT-INM and P/N 22CGT-OPM.

1. Position stand in the selected location so that the feet with round mounting pads are at the rear.
2. Use the adjustable feet to level the stand front-to-back and side-to-side.
3. The stand must be anchored to floor through holes in the round mounting pads in the rear feet.
4. Do NOT screw the 4" legs into steamers. The 4-inch legs provided with the steamers are not used when installing SteamChef steamers on a stand.
5. Set the **LOWER** steamer on the stand as shown in Figure 3.
6. Align the steamer so that the left front and right rear mounting bolts will come up through holes "A" indicated in Figure 1.
7. Secure the lower steamer to the stand using the 2 hardware provided See Figure 3.
8. Remove the side panels and seal any gaps between steamer and stand with a suitable RTV Sealant (not provided).
9. Repeat Steps 1-8 for the upper steamer.

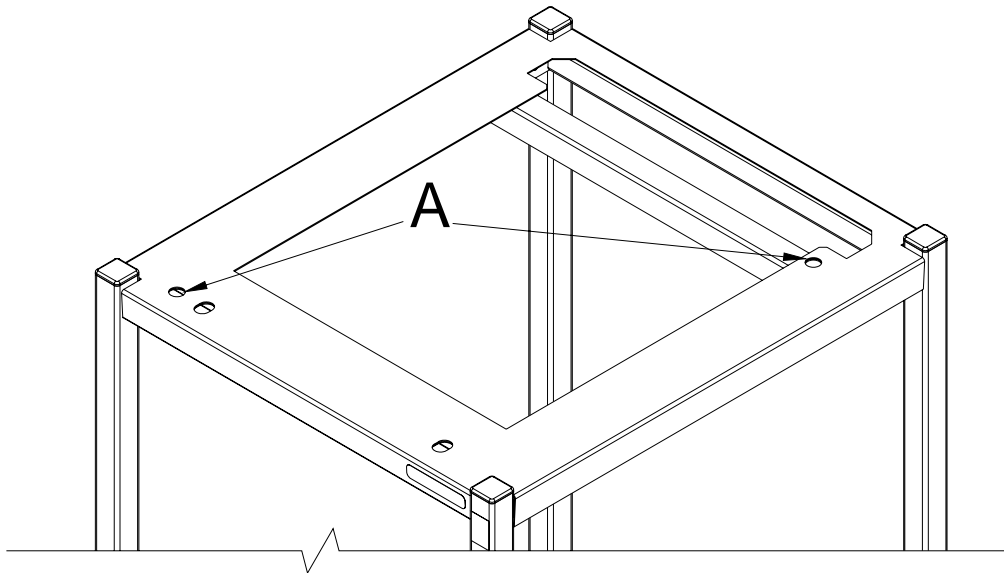

**Figure 1**  
**SteamChef Mounting Holes**

10. Attach drain fittings as shown in Figure 3.
  - Use a suitable pipe thread sealant or Teflon tape (not provided) on all NPT threaded connections.
  - Use a suitable plain washer or strainer washer at all Garden Hose threaded connections. See Figure 2 for strainer washer locations.
  - **DO NOT USE PIPE THREAD SEALANT OR TEFLON TAPE ON GARDEN HOSE THREADED CONNECTIONS.**
11. Check length of drain hose (Figure 3, Item 10) and shorten if necessary.
12. Place worm drive clamps (Figure 3, Item 9) over hose and push hose onto upper hose fitting.
13. Slightly rotate lower tee and hose fitting counter-clockwise until lower end of hose can start onto fitting.
14. Slide hose fully onto fitting by rotating tee and fitting back to their original vertical position.
15. Secure hose to fittings with worm drive clamps.

16. Attach inlet water trains for reservoir and condenser as shown in Figure 3. (Items 12 – 15).
  - Each SteamChef steamer is supplied with strainer washers (Figure 3, Item 13) for use on the water inlets. THESE STRAINER WASHERS MUST BE USED ON THE STEAMER WATER INLET CONNECTIONS.
17. After RTV sealant has set, replace side panels.
  - Do not seal side panels to unit.
  - Side panels must be easily removable for service access.
18. Install the flue assembly as shown in Figure 3.
  - a. Attach the flue adapter (Figure 4, 5, 6, Item 20) to the unit as shown in Figure 4, 5, and 6.
  - b. Attach the flue riser (Figure 4, 5, 6, Item 21) to the flue adapter as shown in Figure 4, 5, and 6.
  - c. Attach the flue adapter cover (Figure 4, 5, 6, Item 16) to the flue cover of the bottom steamer as shown in Figure 4, 5, and 6.
  - d. Slide the rear flue cover (Figure 4, 5, 6, Item 17) over the flue riser assembly (Figure 4, 5, 6, Item 21).
  - e. Secure the rear flue cover to the flue riser assembly with two screws on each side.
19. Complete the installation of the steamers as outlined in the SteamChef Installation Manual, P/N 22CGT-INM and Operator's Manual, 22CGT-OPM.
20. Place the Burn and Scald Hazard warning label on the door of the LOWER steamer as shown in Figure 2.

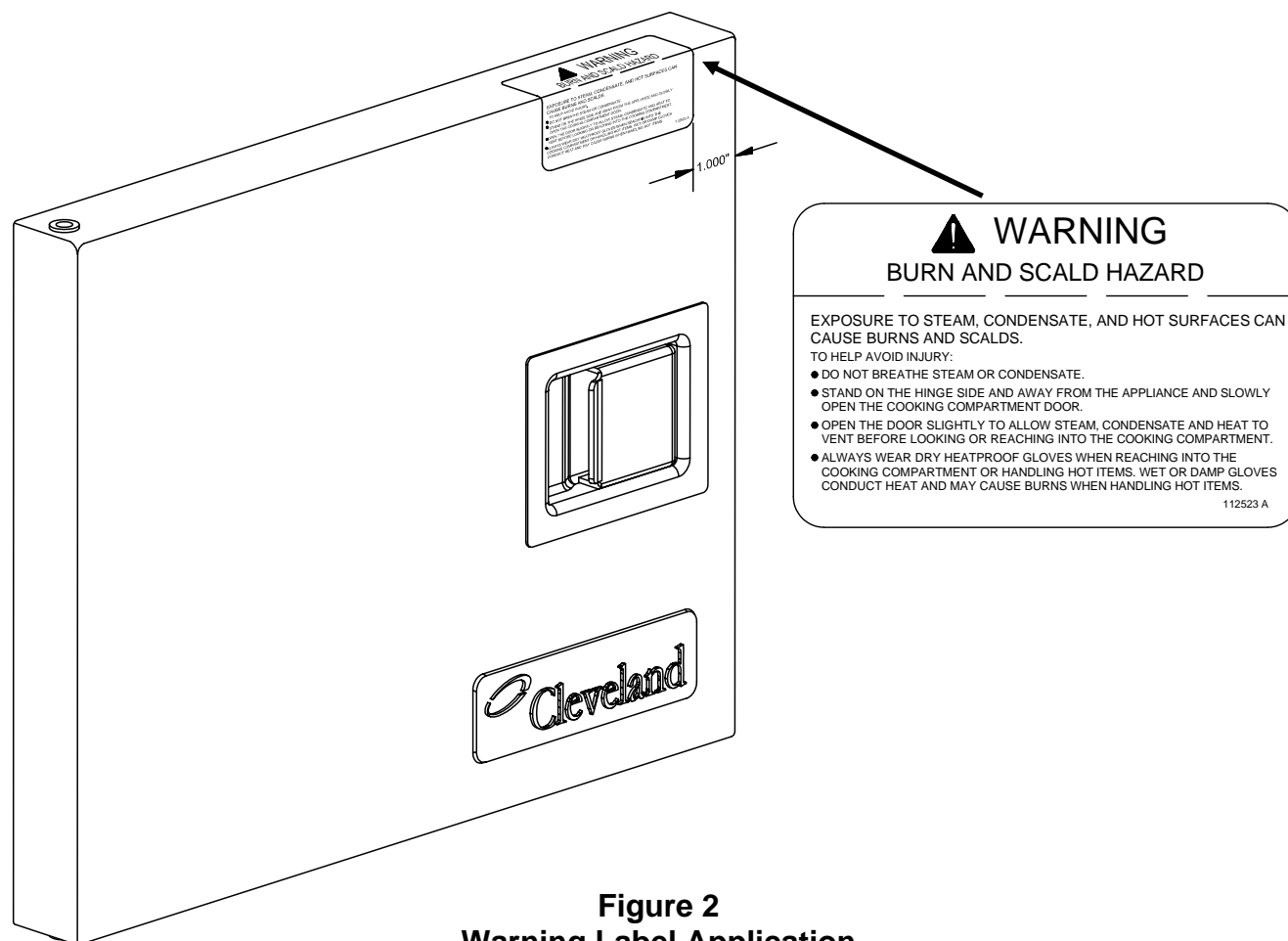

**NOTES**

1. SET THE UNITS ONTO THE STAND AND ATTACH THEM WITH THE 4 SETS OF BOLTS, LOCK WASHER AND WASHERS PROVIDED (ITEMS 2, 3 AND 4).
2. INSTALL THE PLUMBING AND DRAIN AS SHOWN. ALL THREADED PLUMBING (EXCEPT THOSE OF THE HOSE THREAD TYPE, ITEMS 6, 17 AND 18) REQUIRES THE USE OF PIPE SEALANT OR TEFLON TAPE (NOT PROVIDED).
3. THE END OF THE DRAIN MANIFOLD MUST BE EXTENDED TO A SUITABLE DRAIN. DO NOT PLUMB THE DRAIN SOLID TO THE FLOOR DRAIN, BUT INSTALL IT "FREE AIR VENTED". THERE MUST BE A 1" AIR GAP AT THE DRAIN END. IMPORTANT: WHEN STACKED, A 2" MINIMUM DRAIN CONNECTION IS REQUIRED BETWEEN THE OUTLET OF THE COMMON DRAIN AND THE FLOOR DRAIN. UNDER NO CIRCUMSTANCES SHOULD THE DRAIN PIPING EVER BE SIZED SMALLER THAN COMMON DRAIN OUTLET.
4. SEE INSTALLATION INSTRUCTIONS P/N 22CET-OPM FOR ADDITIONAL DETAILS OF STEAMCHEF 6 INSTALLATION.
5. SUPPLIED WITH STEAMER, NOT PART OF THE KIT.
6. SEAL ANY GAPS BETWEEN THE STEAMERS AND THE STAND WITH A SUITABLE FOOD GRADE RTV SILICONE SEALANT (NOT PROVIDED) RATED AT LEAST 250°F AND LISTED OR CLASSIFIED TO THE NSF/ANSI 51 OR 61 STANDARDS.

Figure 3

- Gas SteamChef 3 + 3
- Gas SteamChef 6 + 6
- Gas SteamChef 3 + 6

Plumbing a Drain connections  
Gas SteamChef 6 + 6  
Shown Typical

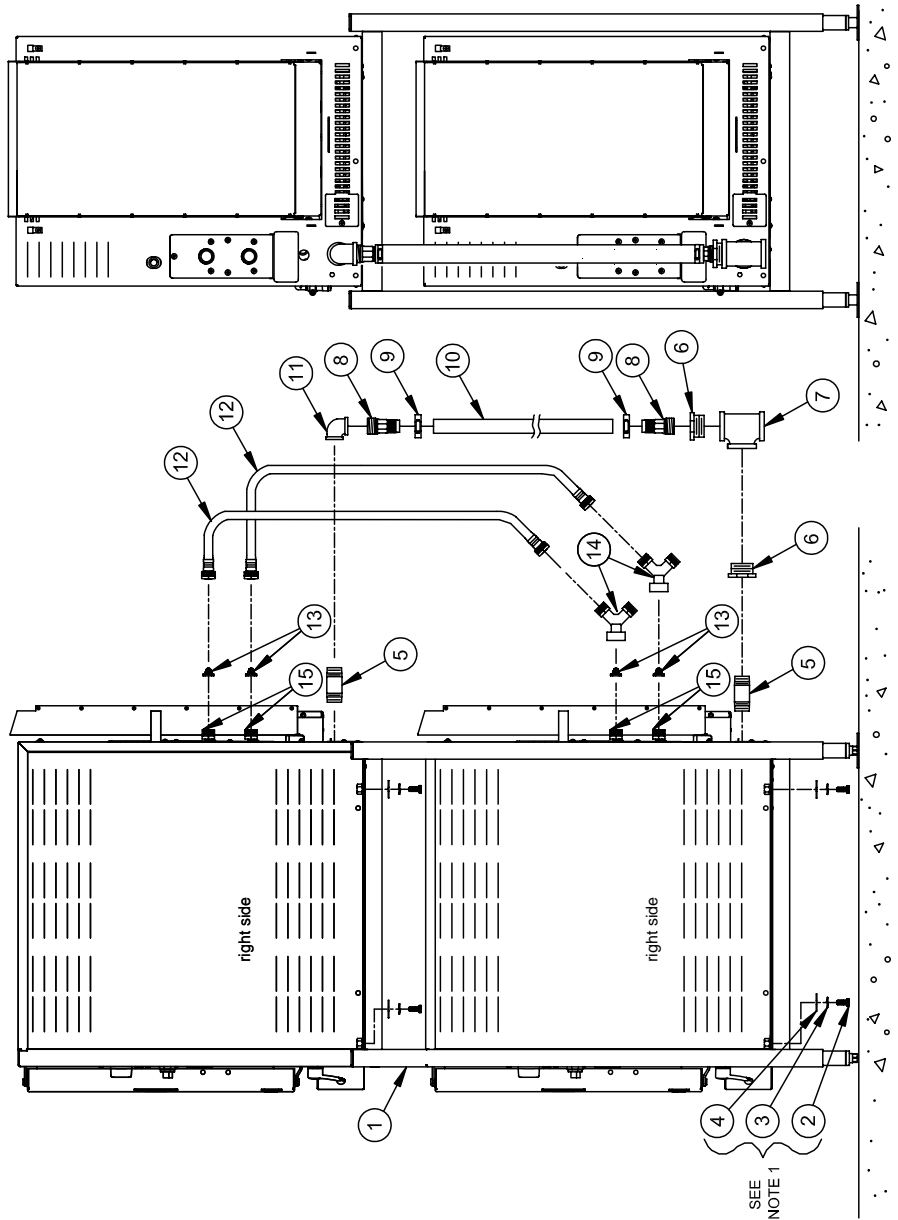

NOTE 5 >

15	4	110221	FITTING, 1/4-18 NPTF X 3/4-1.5 IN. BRASS
14	2	11000	FITTING W/VE. GATE X 1/2 GHTL. BRASS
13	4	110567	STRAINER, FILTER WASHER, GARDEN HOSE INLET (GHT)
12	2	111190	HOSE ASSEMBLY, GHT (F) X 3/8" LONG
11	1	05265	ELBOW, 90, 1" NPT, BLK
10	1	105463000	HOSE, BLACK EPDM, 1" ID X 3/8" LONG
9	2	02024	CLAMP, HOSE, WORM DRIVE, 3/12-1.50 DIA
8	2	14481	FITTING, 1" HOSE X, 1" NPT (M)
7	1	20221	TEE, 1 1/2" NPT, BLK
6	2	02573	BUSHING, HEX, 1" NPT X 1 1/2" NPT, BLK
5	2	102688	NIPPLE, 1" NPT X 3/4" LONG, BLK, TBE
4	4	110103	WASHER, FENDER, 1/2" ID X 1.50 OD
3	4	25153	WASHER, LOCK, 1/2" SST
2	4	110102	SCREW, 1/2-13, HEX HEAD, SST
1	1	ES263044	EQUIPMENT STAND, ASSEMBLY, STACKED

NOTE 5 >

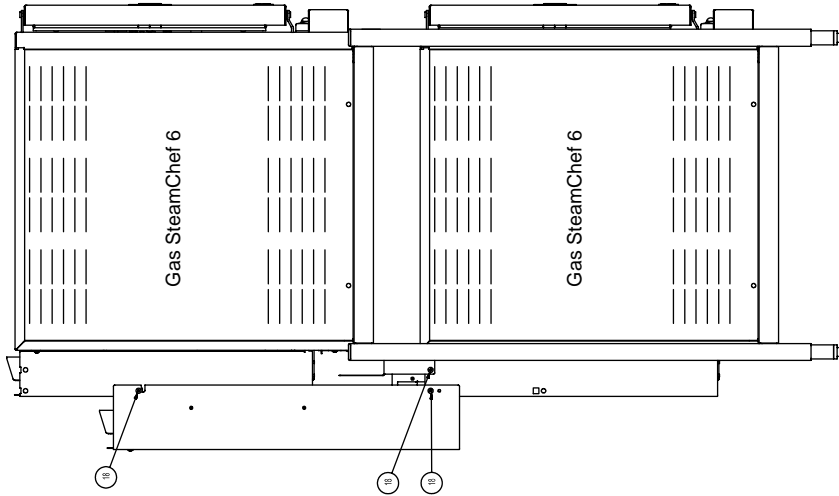
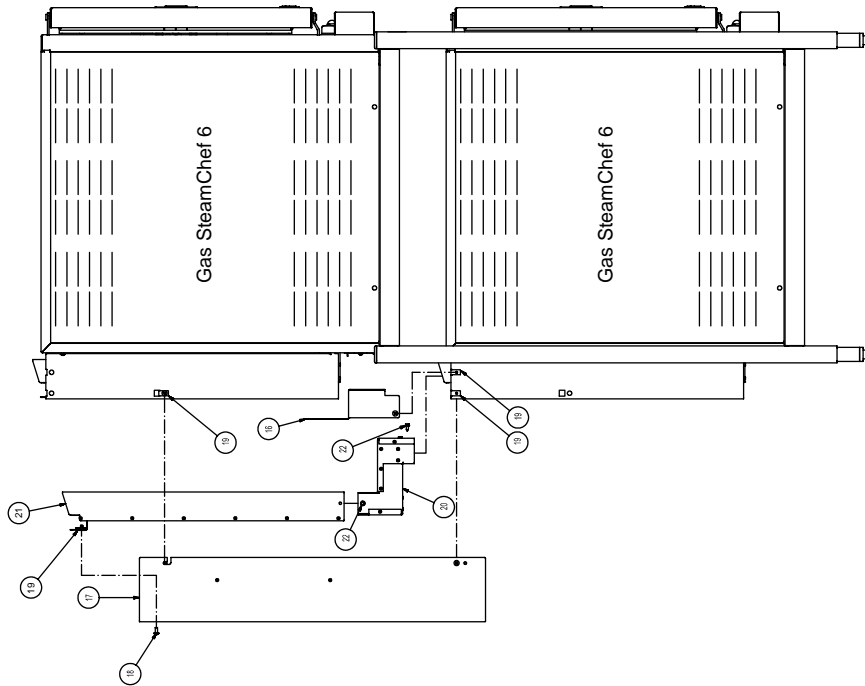

Figure 4  
Gas SteamChef 6 + 6  
Flue Extension Assembly  
Plumbing a Drain connections  
same as Figure 3

ITEM	QTY.	PART NO.	DESCRIPTION
22	3	19148	SCREW, HEX WASHER HD, #10 X 1/2, TYPE A8, ZINC PLTD
21	1	111401	FLUE RISER ASSY CHEF 6
20	1	112488	ASSEMBLY, FLUE ADAPTER
19	7	108734	NUT, U-TYPE (EXTRUDED) #10-24 UNC-2B THREAD
18	8	101231	SCREW, 10-24 X 0.600 SST, PHILLIPS TRUSS HEAD
17	1	112490	ASSEMBLY, REAR FLUE COVER
16	1	112489	COVER, FLUE ADAPTER FRONT

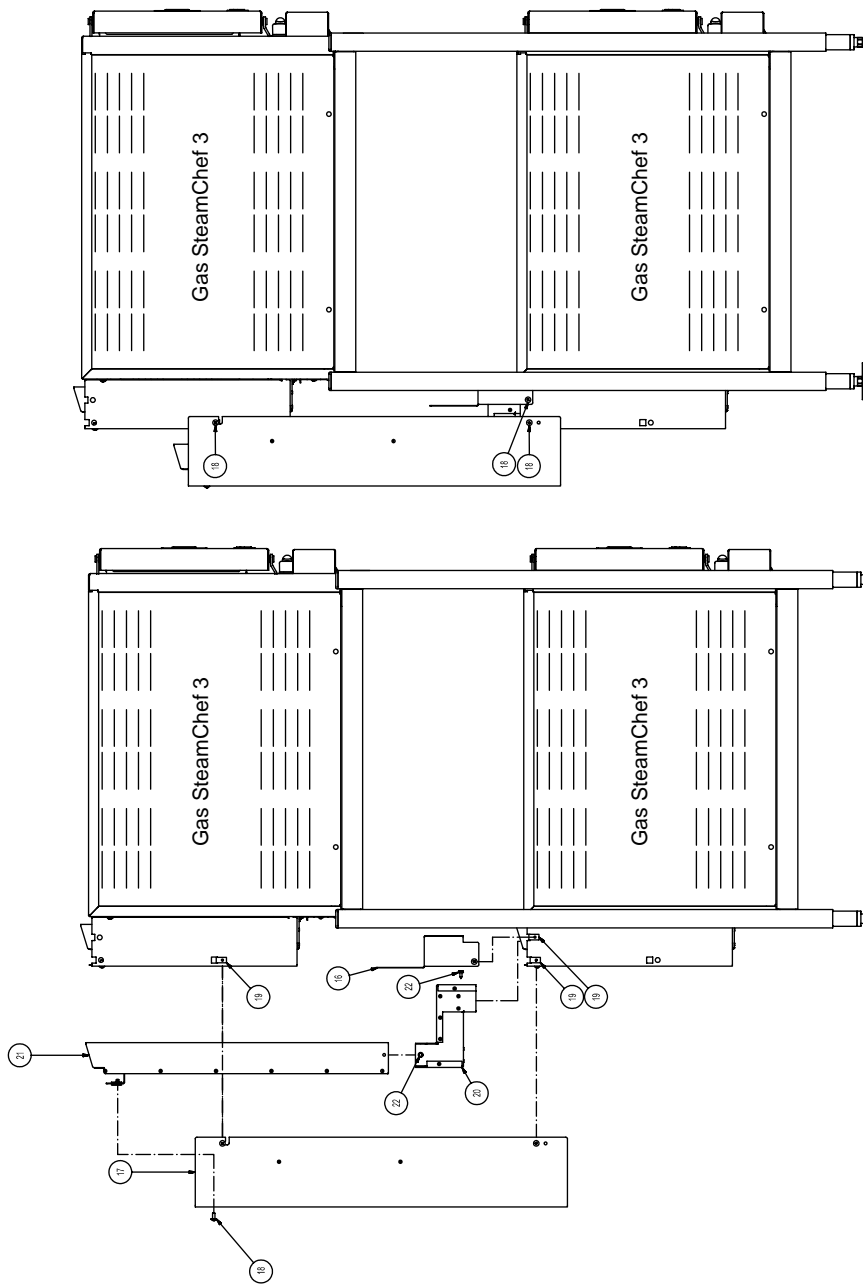
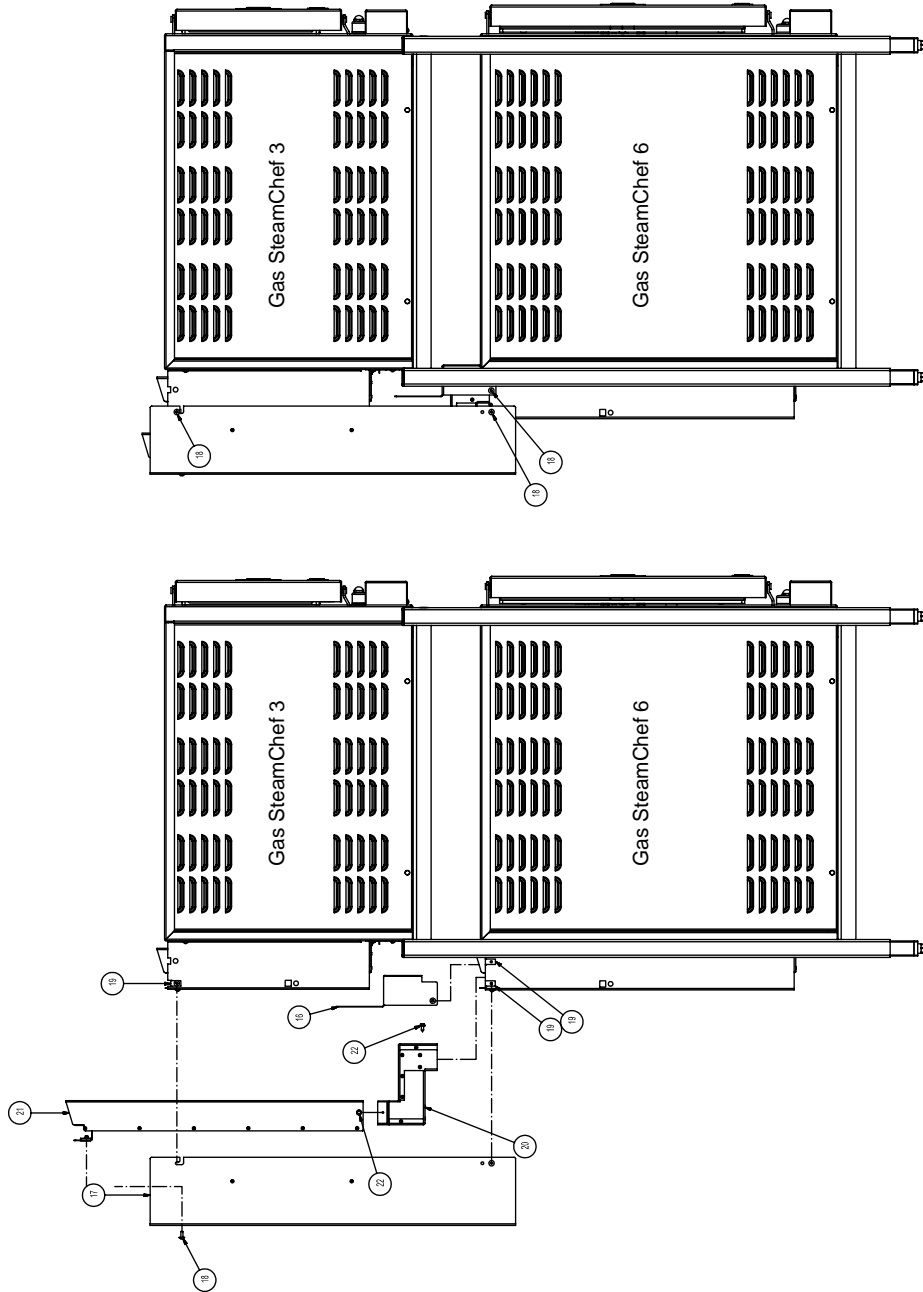

Figure 5  
 Gas SteamChef 3 + 3  
 Flue Extension Assembly  
 Plumbing a Drain connections  
 same as Figure 3

ITEM	QTY.	PART NO.	DESCRIPTION
22	3	19148	SCREW, HEX WASHER HD, #10 x 1/2, TYPE AB, ZINC PLTD
21	1	111401	FLUE RISER ASSY, CHEF 6
20	1	112486	ASSEMBLY, FLUE ADAPTER
19	7	108734	NUT, "U" TYPE (EXTRUDED) #10-24 UNC-2B THREAD
18	8	107231	SCREW, 10-24 X 0.500 SST, PHILLIPS TRUSS HEAD
17	1	112490	ASSEMBLY, REAR FLUE COVER
16	1	112489	COVER, FLUE ADAPTER FRONT

Figure 6  
Gas SteamChef 3 +6  
Flue Extension Assembly  
Plumbing a Drain connections  
same as Figure 3



ITEM	QTY	PART NO.	DESCRIPTION
22	3	19148	SCREW, HEX WASHER HD, #10 x 1/2, TYPE AB, ZINC PLTD
21	1	111401	FLUE RISER ASSY CHEF 6
20	1	112488	ASSEMBLY, FLUE ADAPTER
19	7	108734	NUT, U TYPE EXTRUDED #10-24 UNC-2B THREAD
18	8	107231	SCREW, 10-24 X 0.500 SST, PHILLIPS TRIBS HEAD
17	1	112490	ASSEMBLY, REAR FLUE COVER
16	1	112489	COVER, FLUE ADAPTER FRONT

## Free Manuals Download Website

<http://myh66.com>

<http://usermanuals.us>

<http://www.somanuals.com>

<http://www.4manuals.cc>

<http://www.manual-lib.com>

<http://www.404manual.com>

<http://www.luxmanual.com>

<http://aubethermostatmanual.com>

Golf course search by state

<http://golfingnear.com>

Email search by domain

<http://emailbydomain.com>

Auto manuals search

<http://auto.somanuals.com>

TV manuals search

<http://tv.somanuals.com>