

[THE SCIENCE OF SECURITY]

The background of the top section features a blue-tinted image of a car wheel on the left and a large, stylized, metallic 'GT' logo on the right. The 'GT' logo is illuminated with a blue glow. The word 'CLIFFORD' is written in large, white, bold, sans-serif capital letters across the center of the image.

CLIFFORD[®]

Security system and convenience

[USER GUIDE]

CLIFFORD
11CX
427 series

Limited Consumer Warranty

For a period of one calendar year from the date of purchase of this device, Directed Electronics, Inc. promises to the ORIGINAL PURCHASER to repair or replace (with a comparable reconditioned model), free of cost, any electronic control module which proves to be defective in workmanship or material under normal use, SO LONG AS THE SYSTEM WAS SOLD, INSTALLED, AND SERVICED BY A PROFESSIONAL AUTO INSTALLER, AND REMAINS IN THE CAR IN WHICH THE SYSTEM WAS ORIGINALLY INSTALLED. If warranty service is necessary you must have a clear copy of your sales receipt containing all of the information shown on the following page.

After the first calendar year, from the date of purchase of this device, Directed Electronics, Inc., promises to the ORIGINAL PURCHASER to repair or replace (with a comparable reconditioned model) any electronic control module which proves to be defective in workmanship or material under normal use **FOR A CHARGE OF \$45.00**, SO LONG AS THE SYSTEM WAS SOLD, INSTALLED, AND SERVICED BY A PROFESSIONAL AUTO INSTALLER, AND REMAINS IN THE CAR IN WHICH THE SYSTEM WAS ORIGINALLY INSTALLED. If warranty service is necessary you must have a clear copy of your sales receipt containing all of the information shown on the following page.

This warranty contains the entire agreement relating to warranty and supersedes all previous and contemporaneous representations or understandings, whether written or oral. IN ANY EVENT, DIRECTED ELECTRONICS, INC. IS NOT LIABLE FOR THE THEFT OF THE VEHICLE AND/OR ITS CONTENTS.

This warranty is void if the product has been damaged by accident, unreasonable use, neglect, improper service or other causes not arising out of defects in materials or construction. This warranty is nontransferable and does not apply to any unit that has been modified or used in a manner contrary to its intended purpose and does not cover batteries. The unit in question must be returned to the manufacturer, postage prepaid. This warranty does not cover labor costs for the removal, diagnosis, troubleshooting or reinstallation of the unit. For service on an out-of-warranty product a flat rate fee by model is charged. Contact your authorized dealer to obtain the service charge for your unit.

These systems are a deterrent against possible theft. Directed Electronics, Inc. is not offering a guarantee or insuring against the theft of the automobile or its contents and disclaims any liability for the theft of the vehicle and/or its contents. Directed Electronics does not authorize any person to create for it any other obligation or liability in connection with this security system.

TO THE MAXIMUM EXTENT ALLOWED BY LAW, ANY AND ALL WARRANTIES ARE EXCLUDED BY THE MANUFACTURER AND EACH ENTITY PARTICIPATING IN THE STREAM OF COMMERCE THEREWITH. THIS EXCLUSION INCLUDES BUT IS NOT LIMITED TO THE EXCLUSION OF ANY AND ALL WARRANTY OF MERCHANTABILITY AND/OR ANY AND ALL WARRANTY OF FITNESS FOR A PARTICULAR PURPOSE AND/OR ANY AND ALL WARRANTY OF NON-INFRINGEMENT OF PATENTS, IN THE UNITED STATES OF AMERICA AND/OR ABROAD. NEITHER THE MANUFACTURER OR ANY ENTITIES CONNECTED THEREWITH SHALL BE RESPONSIBLE OR LIABLE FOR ANY DAMAGES WHATSOEVER, INCLUDING BUT NOT LIMITED TO ANY CONSEQUENTIAL DAMAGES, INCIDENTAL DAMAGES, TOWING, REPAIR, REPLACEMENT, DAMAGES FOR LOSS OF TIME, LOSS OF EARNINGS, COMMERCIAL LOSS, LOSS OF ECONOMIC OPPORTUNITY AND THE LIKE. NOTWITHSTANDING THE ABOVE, MANUFACTURER DOES OFFER A LIMITED WARRANTY TO REPLACE OR REPAIR THE CONTROL MODULE AS DESCRIBED ABOVE. Some states do not allow limitations on how long an implied warranty will last or the exclusion or limitation of incidental or consequential damages. This warranty gives you specific legal rights, and you may also have other rights which vary from state to state.

IMPORTANT NOTE:

This product warranty is automatically void if its date code or serial number is defaced, missing, or altered. This warranty will not be valid unless you have completed the warranty card and mailed it to Directed Electronics, Inc. within 10 days after purchase to the address listed on the warranty registration card.

Make sure you have all of the following information from your dealer:

A clear copy of the sales receipt, showing the following:

- Date of purchase
- Your full name and address
- Authorized dealer's company name and address
- Type of system installed
- Year, make, model and color of the automobile
- Automobile license number
- Vehicle identification number
- All security options installed on automobile
- Installation receipts

contents

limited lifetime consumer warranty	i	nuisance prevention circuitry® ..	7
trademarks and copyrights	1	diagnostics	9
what is included	2	arming diagnostics	9
important information	2	disarming diagnostics	9
using your system	3	table of zones	10
manual (active) arming	3	rapid resume logic	10
automatic (passive) arming	3	glossary of terms	11
armed protection	4	notes	12
disarming	5	quick reference guide	13
disarming without a transmitter	5		
valet® mode	6		
remote valet®	6		
panic mode	7		

trademarks and copyrights

Code-Hopping™, Directed®, Doubleguard®, FailSafe®, Nuisance Prevention Circuitry®, NPC®, Silent Mode™, Soft Chirp®, Stealth Coding™, Stinger®, Valet®, and Warn Away® are all Trademarks or Registered Trademarks of Directed Electronics, Inc.

what is included

- Control module and harness
- Pre-wired Valet® switch with integrated red status LED
- Failsafe® Starter Kill relay (if equipped)

important information

Congratulations on the purchase of your system. Due to the complexity of this system, it must be installed by an authorized dealer only. Installation of this product by anyone other than an authorized dealer voids the warranty. All dealers are provided with a preprinted dealer certificate to verify that they are authorized.

By carefully reading this Owner's Guide prior to using your system, you will maximize the use of this system and its features.

You can print additional or replacement copies of this manual by accessing the Directed web site at www.directed.ca.

using your system

manual (active) arming

The factory default is active arming. In this mode you can activate, or arm, the system by locking the doors with your factory keyless entry transmitter. When the system arms, you will hear a short horn honk and see the parking lights (optional) flash once. While the system is armed, the status LED will flash about twice a second, showing that the system is actively protecting your vehicle. If you hear a second short horn honk after arming, and see the status LED flashing in groups, see Diagnostics section. This extra short horn honk is called Bypass Notification.

***note:** If the ignition is turned on within 60 seconds of arming the system, the system will automatically disarm.*

automatic (passive) arming

The system also can be programmed to arm itself automatically (called passive arming). If the system is programmed for passive arming, it will automatically arm 30 seconds after the ignition is turned off and the system “sees” you leave the vehicle by opening and closing a door. Whenever the system is in its 30-second passive-arming countdown, the status LED will flash twice as fast as it does when the system is armed. When the system arms, you will hear a short horn honk and the parking lights (optional) will flash once. The doors lock (if connected and programmed for passive locking).

***note:** Passive arming may qualify for a higher insurance discount. Check with your insurance agent*

note: If any protected doors are left open, the system will not passively arm. Additionally, each time door is triggered during the arming countdown, the 30-second countdown starts over.

armed protection

When armed, your vehicle is protected as follows:

- (This feature is optional and requires extra labour) If a door is opened, the system will immediately start pulsing the horn and flashing the parking lights (optional). Three seconds later, the horn output changes to a continuous blast. This progressive response gives you time to disarm the system with your transmitter if you inadvertently open the door while the system is armed, while still providing instant response (even if the door is immediately closed).

note: If programmed for instant trigger, the horn will output full trigger response after the door has been opened (see Programming Options)

- Turning on the ignition key triggers the same progressive response as opening a door.
- The starter interrupt prevents the vehicle's starter from cranking.

note: The vehicle may already be equipped with a starter kill relay from the factory.

disarming

To disarm the system, unlock the doors using your factory keyless transmitter. The horn will sound twice, and the parking lights (optional) will flash twice. If the horn sounds either four or five times when disarming, refer to the Diagnostics section of this guide. This is called Tamper Alert.

disarming without a transmitter

This feature allows you to override the system without the transmitter should it be lost, damaged or disabled. To do this, you must have the vehicle's ignition key and know where the integrated LED/Valet® switch is located. The Valet® switch is activated by pressing the LED status indicator.

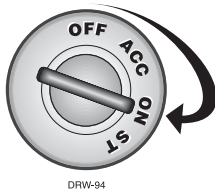
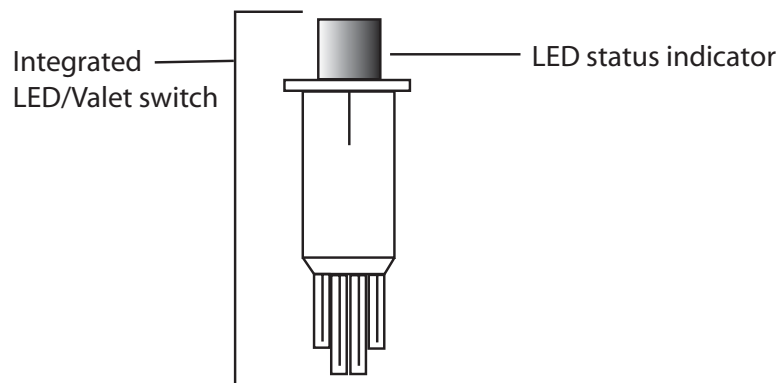

Turn the ignition to the "run" position. Press and release the integrated LED/Valet® switch, within 10 seconds. After a few seconds the LED will stop

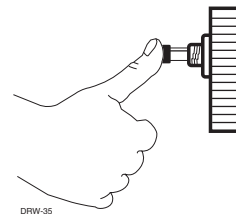

flashing and the vehicle should start. If it does not, you may have waited too long. Turn the ignition off and try again.

note: The setting for the number of times the integrated LED/Valet® switch must be pressed is set in the Programming Section of this guide.

valet® mode

You can prevent your system from arming, by using Valet® Mode. This is very useful when washing the vehicle or having it serviced. In Valet® Mode, the system will not arm, even with the transmitter, but all convenience functions (door locks, trunk release, etc.) will work normally.

To enter or exit Valet® Mode with the integrated LED/Valet® switch:

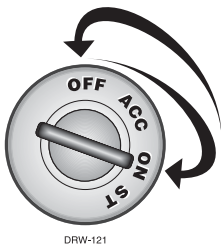

Turn ignition to "on" position, turn to "off" position. Press and release the integrated LED/Valet® switch within 10 seconds. The status LED will

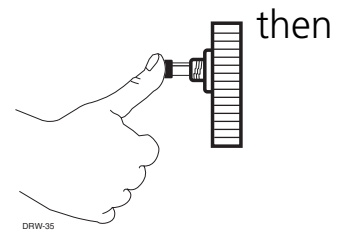

light steady if you have entered Valet® Mode. To exit Valet® Mode, repeat the steps above. The LED will turn off when exiting Valet® Mode.

remote valet®

Remote Valet® is a convenient feature that makes bypassing the security system easier. This feature makes it possible to exit or enter Valet® Mode using your factory keyless transmitter.

1. Open any door.
2. Press LOCK on the transmitter.
3. Press UNLOCK on the transmitter.
4. Press LOCK on the transmitter.

The status LED will stay on if you have entered Valet® Mode, and it will go out if you exited Valet® Mode.

note: The remote Valef® feature will not work with all factory keyless entry systems. Some keyless entry systems do not work with a door open.

panic mode

(This feature is optional and requires extra labour and parts) If you are threatened in or near your vehicle, you can attract attention by triggering the system with your transmitter! If your factory keyless transmitter does not have a panic button, this system can be programmed to enable a panic feature.

If enabled, just press the lock button on your factory keyless transmitter twice within three seconds to enter Panic Mode. The horn will sound and the parking lights (optional) will flash for 30 seconds. To stop Panic Mode at any time, press the unlock button on your factory transmitter.

note: The system can also be programmed so that pressing the lock button twice within three seconds will activate an optional accessory. If the unit is programmed to activate an optional accessory, Panic Mode will not be operational.

diagnostics

The microprocessor at the heart of your system is constantly monitoring all of the switches and sensors connected to it. It detects any faulty switches and sensors and prevents them from disabling the entire system. The microprocessor will also record and report any triggers that occurred during your absence.

arming diagnostics

If the system is armed with an input active (door open or ignition) the unit will chirp once when arming and then one more time a few seconds later. This is called bypass notification.

note: Bypass notification will not occur if chirps have been programmed OFF.

The system will ignore the input that was active when it was armed until it goes away. Three seconds later it will monitor that input normally. For example, if your car has interior light exit delay, and you arm the system before the interior light goes out, you may get bypass notification. Once the light goes out, however, the doors are monitored normally.

disarming diagnostics

Extra disarm chirps are the tamper alert. If four chirps are heard when disarming, the system was triggered in your absence. If five chirps are heard, a zone was triggered so many times that false alarm prevention circuitry has bypassed that zone. In either case, the status LED will indicate which zone was involved (see Table of Zones section). The system will retain this information in its memory, and chirp four or five times each time it is disarmed, until the next time the ignition key is turned on.

table of zones

The zone number is the number of LED flashes used by the system to identify that input. The standard input assignments are listed below.

ZONE (Number LED Flashes)	DESCRIPTION
1	Not available - 22CX only
2	Not available - 22CX only
3	Door switch trigger
4	Not available - 22CX only
5	Ignition trigger

rapid resume logic

This system will store its current state to non-volatile memory. If power is lost and then reconnected the system will recall the stored state from memory. This means if the unit is in Valet® Mode and the battery is disconnected for any reason, such as servicing the car, when the battery is reconnected the unit will still be in Valet® Mode. This applies to all states of the system including arm, disarm, and Valet® Mode.

glossary of terms

Control Module : The “brain” of your system. Usually hidden underneath the dash area of the vehicle. It houses the microprocessor which monitors your vehicle and controls all of the alarm’s functions.

Failsafe® Starter Kill : An automatic switch controlled by the system which prevents the vehicle’s starter from cranking whenever the system is armed. The vehicle is never prevented from cranking when the system is disarmed, in Valet® Mode, or should the starter kill switch itself fail. Your system is ready for this feature, however installation of this feature may require additional labor.

Integrated LED/Valet® Switch: A small push-button switch with an integrated Red LED mounted somewhere in the vehicle. The switch is used to override the alarm when a transmitter is lost or damaged, or to put it into Valet® Mode. The LED indicates the status of your system. It is also used to report triggers and faults in the system or sensors. This switch is also used to program optional features.

Cut along dotted line and fold for a quick and easy reference to keep in your purse or wallet.



QUICK REFERENCE GUIDE:

To arm the system

- You can arm the system by locking the doors with your factory keyless entry transmitter. When the system arms, you will hear a short horn honk, and see the parking lights flash (optional) once.

To disarm the system

- To disarm the system, unlock the doors using your factory keyless transmitter. You will hear two horn honks, and the parking lights (optional) will flash twice.

Disarming without a transmitter

- Turn on the ignition. Press the integrated LED/Valet® switch the programmed number of times within 10 seconds. The system should now disarm. If it does not, you may have waited too long. Turn the ignition off and on and try again.

To enter or exit Valet® Mode

- Turn ignition to “run” position, then turn to “off” position. Press and release the integrated LED/Valet® switch within 10 seconds. The status LED will light solid if you are entering Valet® Mode, and it will go out if you are exiting Valet® Mode.

Remote Valet®

- Open any door. Press the lock button on your transmitter. Within one second, press the unlock button on your transmitter. Within one second, press the lock button on your transmitter again. The status LED will stay on if you have entered Valet® Mode, and it will go out when exiting Valet® Mode.

The company behind this system is Directed Electronics, Inc.

Since its inception, Directed Electronics has had one purpose, to provide consumers with the finest vehicle security and car stereo products and accessories available. The recipient of nearly 100 patents and Innovations Awards in the field of advanced electronic technology, DIRECTED is ISO 9001 registered.

Quality Directed Electronics products are sold and serviced throughout North America and around the world.

Call (800) 361-7271 for more information about our products and services.



DEI is an ISO 9001 registered company.

Directed Electronics is committed to delivering world class quality products and services that excite and delight our customers.

driven to excel
Directed[®]
ELECTRONICS, INC.

Directed Electronics, Inc.
Delson, Qc, Canada
www.directed.ca

© 2004 Directed Electronics, Inc. - All rights reserved
G427L model 22CX 12-03

Free Manuals Download Website

<http://myh66.com>

<http://usermanuals.us>

<http://www.somanuals.com>

<http://www.4manuals.cc>

<http://www.manual-lib.com>

<http://www.404manual.com>

<http://www.luxmanual.com>

<http://aubethermostatmanual.com>

Golf course search by state

<http://golfingnear.com>

Email search by domain

<http://emailbydomain.com>

Auto manuals search

<http://auto.somanuals.com>

TV manuals search

<http://tv.somanuals.com>