

# HomeDock Music Remote™



DIGITAL LIFESTYLE OUTFITTERS™

Download from [www.Somanuals.com](http://www.Somanuals.com). All Manuals Search And Download.

# Contents

<a href="#">Quick Start</a>	<a href="#">4</a>
<a href="#">Included in the Box</a>	<a href="#">6</a>
<a href="#">Getting Connected</a>	<a href="#">7</a>
<a href="#">About The HomeDock Music Remote</a>	<a href="#">10</a>
Setting Up Your Music Remote	11
Using the Music Remote	12
<a href="#">Music Remote + iPod Settings</a>	<a href="#">14</a>
Changing iPod Settings	14
Changing Music Remote Settings	14
<a href="#">Additional Features</a>	<a href="#">15</a>
Jukebox	15
Syncing to iTunes and Your Computer	15
<a href="#">Tips + Troubleshooting</a>	<a href="#">16</a>
<a href="#">Tech Specs</a>	<a href="#">20</a>
<a href="#">Service + Support</a>	<a href="#">21</a>
<a href="#">Warranty</a>	<a href="#">22</a>
<a href="#">FCC Statement</a>	<a href="#">23</a>

© 2007 Digital Lifestyle Outfitters

The DLO logo, Digital Lifestyle Outfitters and HomeDock Music Remote are trademarks of Digital Lifestyle Outfitters. iPod is a trademark of Apple Inc., registered in the U.S. and other countries.

All Rights Reserved

Printed in Taiwan

M-61000-070302-D



# Quick Start

Thanks for purchasing the DLO HomeDock Music Remote, the dock that leaves your iPod by the stereo while you navigate your music on the remote's display screen from up to 150 feet – even through walls!

We'll get you started with these easy steps:

**STEP 1** Connect the power supply to the Music Remote Dock, then plug the included AC power supply into any available AC power outlet.

**STEP 2** Plug the included Audio Cable into the back of the Music Remote Dock and then into the L/R inputs of any available input on your stereo receiver.

**STEP 3** Charge the Music Remote battery by plugging it into the Music Remote Dock. While the Music Remote is charging, the screen will flash a **Charging** message. Once the Music Remote is fully charged, the screen will display **Charging Complete** for a few moments and then go blank.

**STEP 4** Dock your iPod in the Music Remote Dock. Then, adjust the Support Stand to fit your particular iPod by sliding the support up or down. Your iPod will start up in **Music Remote Mode**, as indicated by a check mark and **OK to disconnect** message on the iPod screen.

**NOTE:** In Music Remote Mode, the iPod Click Wheel is non-functional.

**STEP 5** Remove the Music Remote from the Dock. On the main menu, select either Artist or Playlist. Your Music Remote will automatically begin downloading your iPod's content. This may take a few minutes.

**IMPORTANT:** Do not press any button on the Music Remote while it is in the process of downloading your iPod music content. This will stop the download process.

**STEP 6** Scroll through your Playlists, Artists and Songs using the Music Remote and begin enjoying your iPod from anywhere in the house.

## Included in the Box

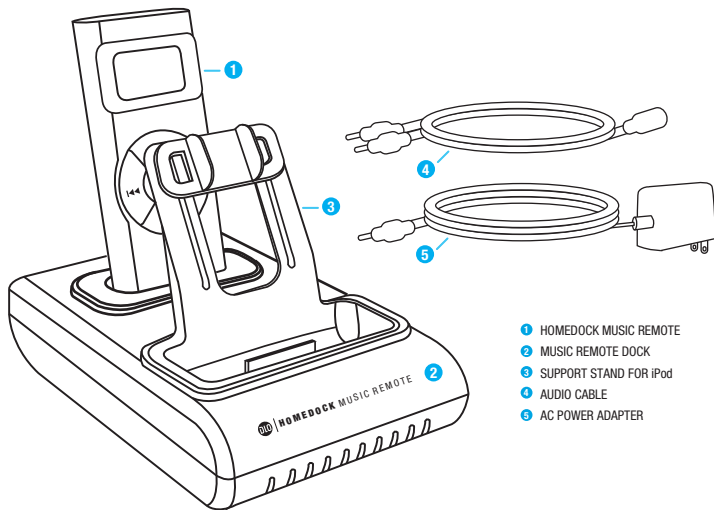

## Getting Connected

- 1 USB MINI PORT
- 2 5V DC POWER
- 3 AUDIO OUTPUT

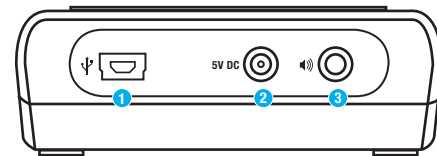

### Connecting Your HomeDock Music Remote

There are several ways you can use your Music Remote:

#### With your home stereo

To connect to a home stereo system, plug the included AC power adapter into the back of the Music Remote Dock, then into any available AC power outlet. Next, plug in the included Audio Cable into the back of the Music Remote Dock and then into the corresponding L/R inputs on your stereo.

#### With a powered speaker system or other audio device

To connect to a powered speaker system or other audio device with an Aux-In jack or mini-jack, plug the included AC power adapter into the back of the Music Remote Dock, then into any available AC power outlet. Next, plug a standard 1/8" mini-to-mini cable (available separately) into the back of the Music Remote Dock and the other end into the Aux-In jack on the speaker system or device.

### With your PC or Mac

To connect to your PC or Mac, plug the included AC power adapter into the back of the Music Remote Dock, then into any available AC power outlet. Next, use a standard USB to mini-USB cable (available separately) to connect the Music Remote Dock to your home computer using the mini-USB port on the back of the unit.

# About the HomeDock Music Remote

The DLO HomeDock Music Remote features a full-function RF remote with a bright OLED display that will control your iPod music anywhere. Its powerful range and easy-to-read display make it the ideal solution for controlling iPod around the house.

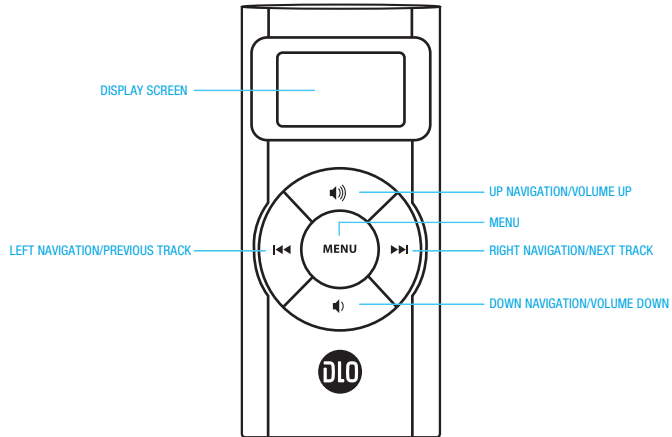

## Setting Up Your Music Remote

**STEP 1** After connecting your Dock, charging the Music Remote and inserting your iPod, press any button on the Music Remote to power it on. The Music Remote will display the **Now Playing** menu.

**STEP 2** Using the Down Nav button, scroll down to **Settings** and press the Right Nav button.

**STEP 3** **Download Lists** is now highlighted. Press the Menu button and your Music Remote will begin syncing with your iPod. This can take several minutes, depending on the amount of music on your iPod. Any time you change the content on your iPod by adding new Artists or Songs, or you use another iPod with the HomeDock Music Remote, you need to re-download your Lists.

**IMPORTANT:** Do not press any button on the Music Remote while it is in the process of downloading your iPod content. This will stop the download process.

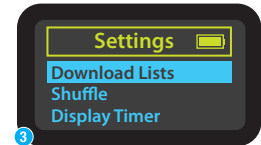
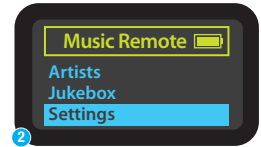
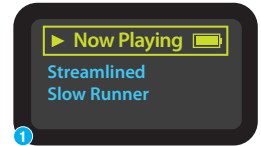

## Using the Music Remote

The Music Remote's bright OLED display lets you navigate and select your iPod music and other content. Just scroll to your desired selection using the Up or Down Nav buttons, and make your selection using the Right Nav or Menu button. The Music Remote will allow you to select your music by navigating through Playlists, Artists and Songs.

You can control playback functions with the Music Remote including Play/Pause, Fast Forward/Next Track, Rewind/Previous Track.

To adjust the volume, simply press the Volume Up or Volume Down buttons while in the [Now Playing](#) menu.

In the [Now Playing](#) menu, pressing the Menu button will take you to the Main Menu.

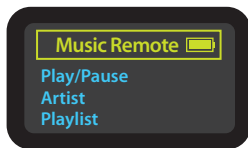

Any time you wish to navigate back to the previous menu, simply press the Left Nav button and the Music Remote will display the previous menu screen. To navigate to the next menu, simply press the Right Nav button.

When you need to power your Music Remote On or Off, press and hold the Menu button for a few seconds.

To check the strength of your Music Remote's RF signal, go to [Settings, About](#) and you will be able to view the RF Signal Indicator Bar

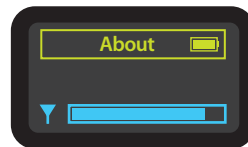

The Music Remote lets you customize your iPod listening experience. Just go to **Settings** on the Main Menu screen and select the settings that are right for you.

## Changing Music Remote Settings

---

- **Display Timer** lets you conserve your Music Remote's battery by setting it to sleep at either 30 seconds, 1 minute, or 2 minutes of inactivity. To quickly wake up your Music Remote, simply press any button on the remote.
- **Now Playing Mode** lets you set the display to show you either **Song/Artist** information or **Song/Next Song** information.
- **iPod Mode** disables your Music Remote's display screen, so you can control music playback using your iPod Click Wheel.

## Changing iPod Settings

---

- Use your Music Remote to change your EQ settings on your iPod. This allows you to select the perfect audio setting for the type of music you're enjoying. Choose from settings like **Rock**, **Hip-Hop**, **Bass Booster**, **Jazz**.
- **Shuffle Songs** will play back an artist or playlist in random order. If you want to shuffle your entire music library, you will need to select **Enter iPod Mode** on the Music Remote, and then select Shuffle Songs on your iPod.

## Jukebox

---

The Music Remote has a Jukebox feature that allows you to create on-the-fly playlists on the Music Remote. In the Main Menu, select **Jukebox**. Next, select Song #1, which will offer your Artist selections. Select an Artist, then select the song of your choice. Repeat this process with up to 10 songs, then select **Start Playing**.

**NOTE:** When you navigate out of the Jukebox, the list of your Jukebox selections will not be saved.

## Syncing to iTunes and Your Computer

---

The HomeDock Music Remote will also act as a dock for your iPod to sync with your computer and iTunes.

First, plug the included AC power adapter into the back of the Music Remote Dock, then into any available AC power outlet. Next, plug in an A-to-B USB cable (available separately) to connect your Music Remote Dock unit to your computer. The Music Remote will sync and charge your iPod automatically.

**IMPORTANT:** Do not use the Music Remote control with your iPod while it is docked and syncing with your computer. This will interrupt the syncing process.

To listen to your iPod using the Music Remote while it's connected to your computer, simply quit iTunes and use the included Audio Cable or iPod audio cable to connect to your computer's speakers.



# Tips + Troubleshooting

## My Music Remote does not select the correct track, and is unresponsive.

First, check that your iPod is securely connected to the Music Remote Dock, this is verified by the iPod screen displaying **OK to disconnect**. Make sure that you have downloaded all your iPod content onto the Music Remote. To learn more about downloading iPod lists, see [Setting Up Your Music Remote \(pg 11\)](#).

**NOTE:** The Music Remote's download process can be affected by outside RF interference. It is recommended that the download process be performed close to the Music Remote Dock. Do not press any button on the Music Remote while it is in the process of downloading your iPod content. This will stop the download process.

## My Music Remote is showing the wrong Playlists or Artists.

Your Music Remote must be synchronized with the iPod that is currently in the Music Remote Dock. Select [Download Lists](#) from the Settings menu, and your Music Remote will begin downloading the current iPod content.

## My Music Remote keeps displaying "Out of Range."

First, check that your iPod is securely connected to the Music Remote Dock. This is verified by the iPod screen displaying the Music Remote screen message **OK to disconnect**. The Music Remote is a powerful RF remote that will function through walls and other obstructions, but you may be out of range of the base unit or experiencing some kind of outside interference. Move closer to the Music Remote Dock

to verify communication. (Once communication is established, you can verify distance and RF signal under [About](#) in the [Settings](#) menu). If these steps do not work, or your Music Remote seems to be non-responsive, you should refresh the Music Remote by pressing and holding the [Menu](#) button and [Volume Up](#) button simultaneously for a few seconds until you see the DLO logo appear. If the issue persists, the Music Remote may need to be reset by pressing the end of a paper clip into the reset hole on the bottom left side of the remote.

## Do I need to download both lists (Artists and Playlists) separately?

No. Once you select [Download Lists](#), both lists will automatically be downloaded to your Music Remote.

## When I place my iPod into the Music Remote Dock, the iPod does not enter the Music Remote Mode.

Be sure that your iPod contains recent firmware. Visit [apple.com/ipod/download](http://apple.com/ipod/download) to get the latest iPod software updates.

## When I place my iPod into the Music Remote Dock, the iPod Click Wheel is no longer functional.

Don't worry, the Music Remote is working correctly and provides the same func-

tionality as the iPod Click Wheel. If you need to navigate your iPod, simply select [Enter iPod Mode](#) from the Music Remote's Settings Menu.

#### [My music sounds distorted and "fuzzy".](#)

The Music Remote lets you control the volume of your iPod music. However, it is important that you find the correct balance between your Music Remote's volume setting and the speaker system, stereo, TV, computer or other audio device's volume setting. Try different volume settings on your audio device until you find the optimum balance.

#### [I removed my iPod from the Dock and it still displays "OK to Disconnect".](#)

Return your iPod to the Dock and remove it after a few minutes. If this does not work, you can also reset your iPod by holding down the Menu + Center buttons.

## Dock

---

**Audio Output (L/R audio):** Aux-Out jack

**Power Input:** 5 VDC, 1 amp

**USB mini port**

**Operating Frequency:** 915.92 MHz

## Remote

---

**Operating Frequency:** 915.92 MHz

**Battery:** 3.3 Volt Rechargeable Lithium Ion. (not user serviceable)

## Power Adapter

---

**Power Adapter Input:** 100-240VAC, 47-63 Hz

**Power Adapter Output:** 5 VDC, 1 amp

## Cable

---

**mini-to-RCA Stereo Audio**

For more information, updates and tips, please visit our website at [www.dlo.com](http://www.dlo.com) and click [Support](#).

## Digital Lifestyle Outfitters Limited Manufacturer's Warranty

**What This Warranty Covers.** DLO (Digital Lifestyle Outfitters) warrants this product against defects in materials and workmanship. This limited warranty applies only to products manufactured by or for DLO.

**What This Warranty Does Not Cover.** This warranty does not apply to damage caused by: (a) accident, abuse, misuse, misapplication, ordinary wear, improper maintenance, failure to follow instructions, or products not manufactured by or for DLO; and (b) aftermarket services (including upgrades and expansions).

**How Long This Warranty Lasts.** This warranty lasts for a period of ninety (90) days from the date of original retail purchase.

**What DLO Will Do.** If a defect exists, DLO will exchange the product, at its option, with a product that is new or has been manufactured from new or serviceable used parts and that is at least functionally equivalent to the original product. DLO will warrant a replacement product against defects in materials and workmanship for a period of ninety (90) days from the date of replacement.

**How To Get Service.** In order to be eligible for this warranty, you MUST register your purchase at [www.dlo.com/register](http://www.dlo.com/register) within thirty (30) days of purchasing this product. If you believe that this product is defective in materials or workmanship, please e-mail [customerservice@dlo.com](mailto:customerservice@dlo.com) with a brief description of the problem, for further instructions.

**No Change To Warranty.** No DLO reseller, agent or employee is authorized to make any modification, extension, or addition to this warranty.

**How State Law Applies.** This warranty gives you specific legal rights, and you also may have other rights that vary from state to state, or country.

**Restrictions On Implied Warranties.** All implied warranties, including, without limitation, warranties of merchantability and fitness for a particular purpose, are limited in duration to the duration of this warranty. Some states do not allow limitations on how long an implied warranty lasts, so the above limitation may not apply to you.

**Restrictions On Damages.** DLO is not responsible for direct, special, incidental or consequential damages resulting from any breach of warranty or condition or under any other legal theory (including, without limitation, lost profits; downtime; goodwill; damage to or replacement of equipment and property; failure to maintain the confidentiality of data stored on the product; and any costs of recovering, reprogramming or reproducing any program or data stored in or used with products manufactured by or for DLO). Some states and countries do not allow the exclusion or limitation of incidental or consequential damages, so the above limitation or exclusion may not apply to you

W1000-050803-B

## Federal Communications Commission Interference Statement

This device complies with Part 15 of the FCC rules. Operation is subject to the following two conditions: (1) This device may not cause harmful interference, and (2) this device must accept any interference received, including interference that may cause undesired operation.

**CAUTION:** The manufacturer is not responsible for any radio or TV interference caused by unauthorized modifications to this equipment. Any such modification could void the user's authority to operate the equipment.

**NOTE:** This equipment has been tested and found to comply with the limits for a Class B digital device, pursuant to Part 15 of the FCC Rules. These limits are designed to provide reasonable protection against harmful interference in a residential installation. This equipment generates, uses and can radiate radio frequency energy and, if not installed and used in accordance with the instructions, may cause harmful interference to radio communications. However, there is no guarantee that interference will not occur in a particular installation. If this equipment does cause harmful interference to radio or television reception, which can be determined by turning the equipment off and on, the user is encouraged to try to correct the interference by one or more of the following measures:

- Reorient or relocate the receiving antenna.
- Increase the separation between the equipment and receiver.
- Connect the equipment into an outlet on a circuit different from that to which the receiver is connected.
- Consult the dealer or an experienced radio/TV technician for help.



Thanks for purchasing the DLO HomeDock Music Remote  
**Move with your music – not your iPod**

## Free Manuals Download Website

<http://myh66.com>

<http://usermanuals.us>

<http://www.somanuals.com>

<http://www.4manuals.cc>

<http://www.manual-lib.com>

<http://www.404manual.com>

<http://www.luxmanual.com>

<http://aubethermostatmanual.com>

Golf course search by state

<http://golfingnear.com>

Email search by domain

<http://emailbydomain.com>

Auto manuals search

<http://auto.somanuals.com>

TV manuals search

<http://tv.somanuals.com>