

IMPORTANT SAFETY INSTRUCTIONS

When using electrical appliances, especially when children are present, basic safety precautions should always be followed, including the following:

READ ALL INSTRUCTIONS BEFORE USING

KEEP AWAY FROM WATER

DANGER - Any appliance is electrically live even when the switch is off. To reduce the risk of death by electric shock:

1. Always unplug appliance immediately after using.
2. Do not use while bathing or in the shower.
3. Do not place or store appliance where it can fall or be pulled into a tub or sink.
4. Do not place in, or drop into, water or other liquid.
5. If an appliance falls into water, unplug it immediately. Do not reach into the water.

WARNING - To reduce the risk of burns, electrocution, fire, or injury to persons:

1. This appliance should never be left unattended when plugged in.
2. Do not pull, twist, or wrap line cord around appliance.
3. This appliance should not be used by, or near children or individuals with certain disabilities.

4. Use this appliance only for its intended use, as described in this manual. Do not use attachments not recommended by the manufacturer.

5. Never operate this appliance if it has a damaged cord or plug, if it is not working properly or if it has been dropped or damaged, or dropped into water. Return the appliance to an authorized service center for examination and repair.

6. Keep the cord away from heated surfaces.

7. Never use while sleeping.

8. Never drop or insert any object into any opening.

9. Do not use outdoors or operate where aerosol (spray) products are being used or where oxygen is being administered.

10. Unit is hot when in use. Do not let heated surface touch eyes or bare skin.

11. Do not place the heated unit directly on any surface while it is hot or plugged in.

12. Never block the air openings of the appliance or place on a soft surface such as a bed or couch, where the air openings may be blocked. Keep the air opening free of lint and other debris.

13. Do not use an extension cord with this appliance.

14. Do not touch hot surfaces of the appliance. Use handles or knobs.

15. Do not attempt to touch the housing of your appliance near the straightening plates, as it is hot when in use.

SAVE THESE INSTRUCTIONS

OPERATING INSTRUCTIONS

This straightening iron is intended for household use. Use on Alternating Current (60 hertz) only. This unit is designed to be operated at 120 volts AC.

This appliance has a polarized plug (one blade is wider than the other). As a safety feature, this plug will fit in a polarized outlet only one way. If the plug does not fit fully in the outlet, reverse the plug. If it still does not fit, contact a qualified electrician. Do not attempt to defeat this safety feature.

TO STRAIGHTEN HAIR

Hair should be clean and completely dried before using the straightening iron. Plug the iron into an electrical outlet. Turn on unit. The Power/Low 285°F and Ion On settings will become illuminated.

To turn off, press Off button (lights will go off). Never leave your straightening iron on and unattended. However, should you fail to turn the unit off it will shut itself off automatically within 60 minutes.

WARNING: The straightening iron's nano silver tourmaline ceramic-coated plates will get very hot within a few seconds and should not be placed in contact with the skin after the straightening iron has been turned on.

Temperature Setting Guide

LED TEMP. CONTROL	HAIR TYPE
Power/Low 285°F-310°F	Delicate, thin, easy-to-straighten hair
Medium 330°F	Average-to-thick or treated hair
Med-High 360°F	Thick or wavy hair
High/Max 395°F	Hard-to-straighten hair

INSTANT HEAT TECHNOLOGY

The iron's unique high temperature settings and Instant Heat technology provide styling versatility for all hair types. If you have fine hair, a low temperature will provide the best results. If you have thick, wavy or hard-to-straighten hair, keep the heat setting on high. You can vary the iron's temperature according to your particular need by scrolling the temperature settings using the +/- buttons.

For best results, use a light styling product before blow-drying hair. Start with a hair section that is 1½" wide and no more than ½" thick. Open the iron and place a hair section between the two hot plates, close to the scalp. Trap hair between the plates by firmly squeezing the handles together. While maintaining the tension, slowly pull the unit down along the hair section toward the end of hair. At the end of hair section, release the pressure on the handle and allow the hair section to slide out. Repeat process on additional sections of hair until you achieve the hair style you desire. It may be necessary to repeat process on certain areas, depending on the texture of your hair.

As you straighten your hair, you'll find that it glides more easily over the micro-bonded plate surfaces, and any residue from styling products is easy to remove.

Some experience is necessary when learning to use this straightening iron. After using the iron several times, you will learn the ideal way to straighten and style your hair.

STYLING WITH THE NANO SILVER TOURMALINE CERAMIC™ COATED PLATES

Your new straightening iron features nano technology – micro particles that create stronger bonds to plate surfaces, for smoother glide, maximum manageability and more professional results.

NANO SILVER TECHNOLOGY combines the technology of micro particles of ceramic and silver for clean, beautiful, healthy looking results.

The Nano Silver Tourmaline Ceramic™ Technology combines all that is best for your hair. Nano silver's unique properties leave hair cleaner, shinier and healthier looking. Tourmaline emits infrared heat for gentle styling, and natural ions that reduce frizz, help smooth down flyaways and renew the vitality of your hair. And ceramic generates gentle infrared energy and evenly distributes heat to protect hair from damage. Whatever style you create, this trio of technologies leaves your hair with a salon-perfect, silky smooth finish.

USING INSTANT HEAT, THE 5 ULTRA-HIGH HEAT TEMPERATURE SETTINGS & UNIFORM HEAT RECOVERY SYSTEM

This styling iron features a ceramic heater that maintains high temperatures during use for precision styling. It heats up quickly to the temperature you've selected for your hair type.

This Instant Heat technology has 5 ultra-high temperature settings. There is a temperature range that's gentle and safe for every type of hair, from the finest to the curliest and most resistant, and helps you create the look you want. And that's not all. Conair's professional salon standards of engineering provide you with a uniform and improved heat recovery system that maintains the iron at constant temperatures. There is a constant surge of power to ensure that heat is continuously and quickly delivered for optimal styling results, unlike other units, which lose heat during use. This provides consistent styling power so that every strand of your hair is set with the same level of heat and comes out the same way for a perfect finish.

THE IONIZING FUNCTION generates a cloud of negative ions that can:

- neutralize the generally positive charge on flyaway, frizzy hair
- eliminate static electricity
- contribute to shine

The new Nano Silver Tourmaline Ceramic™ Technology makes this straightener a pleasure to use – styling has never been easier! Get ready to experience salon results without the salon!

GET TO KNOW YOUR STRAIGHTENING IRON

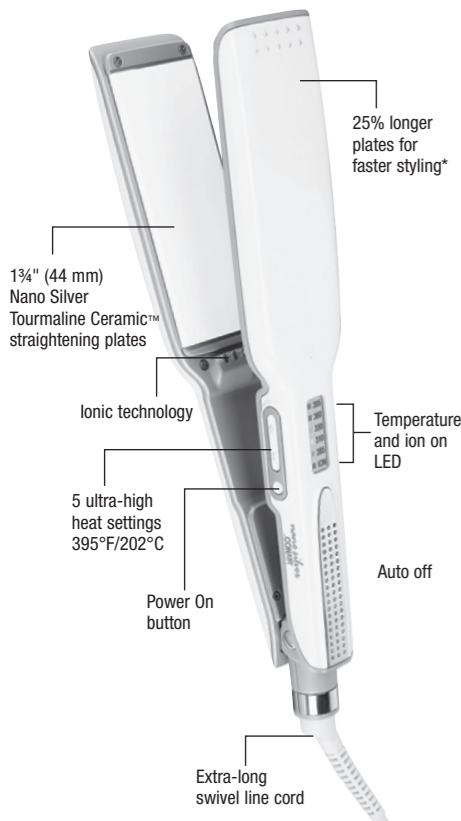

* When compared to other Conair® straighteners

2 In 1 Heat-Resistant Storage Pouch and Counter Mat



Fold and snap closed to store hot styling iron safely.

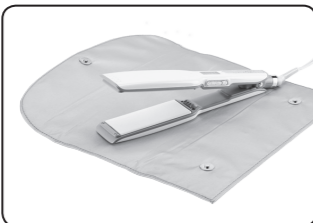

Open mat to protect counters from heat while styling.

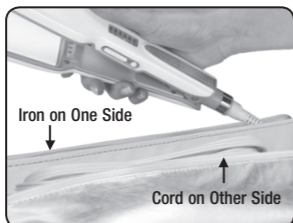

Divider separates power cord from iron for immediate, safe storage.

USER MAINTENANCE

Your straightening iron is virtually maintenance-free. No lubrication is needed. Keep all vents and openings clear of dirt and dust. If cleaning becomes necessary, disconnect the unit from the power source, allow to cool and wipe exterior with a cloth. If any abnormal condition occurs, unplug the unit, allow it to cool, and return it for repair to an authorized service representative only. No repairs should be attempted by the consumer.

CAUTION

NEVER allow the power supply cord to be pulled, twisted, or severely bent. Never wrap the cord tightly around the appliance. Damage will occur at the high flex point of entry into the appliance, causing it to rupture and short circuit. Inspect the cord frequently for damage. Stop use immediately if damage is visible or if unit stops or operates intermittently.

STORAGE

When not in use, your appliance is easy to store. Allow appliance to cool, then simply store in heat-resistant pouch out of reach of children in a safe, dry location. **Do not jerk or strain cord at plug connections.** Do not wrap the line cord around the appliance. Allow the cord to hang or lie loose and straight at the point of entry into the appliance.

**WARNING:
IF YOU THINK THE
POWER IS OFF WHEN
THE SWITCH IS OFF
YOU'RE WRONG.**

KEEP AWAY FROM WATER

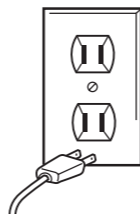

Everyone knows that electricity and water are a dangerous combination. But did you know that an electric appliance is still electrically live even if the switch is off? If the plug is in, the power is on. So when you are not using your appliances, keep them unplugged.

**ALWAYS UNPLUG
SMALL APPLIANCES**

LIMITED FIVE-YEAR WARRANTY

Conair will repair or replace (at our option) your unit free of charge for 60 months from the date of purchase if the appliance is defective in workmanship or materials.

To obtain service under this warranty, return the defective product to the service center listed below, together with your purchase receipt and \$5.00 for postage and handling. California residents need only provide proof of purchase and should call 1-800-3-CONAIR for shipping instructions. In the absence of a purchase receipt, the warranty period shall be 60 months from the date of manufacture.

ANY IMPLIED WARRANTIES, OBLIGATIONS, OR LIABILITIES, INCLUDING BUT NOT LIMITED TO THE IMPLIED WARRANTY OF MERCHANTABILITY AND FITNESS FOR A PARTICULAR PURPOSE, SHALL BE LIMITED IN DURATION TO THE 60-MONTH DURATION OF THIS WRITTEN, LIMITED WARRANTY.

Some states do not allow limitations on how long an implied warranty lasts, so the above limitations may not apply to you.

IN NO EVENT SHALL CONAIR BE LIABLE FOR ANY SPECIAL, INCIDENTAL, OR CONSEQUENTIAL DAMAGES FOR BREACH OF THIS OR ANY OTHER WARRANTY, EXPRESS OR IMPLIED, WHATSOEVER. Some states do not allow the exclusion or limitation of special, incidental, or consequential damages, so the above limitation may not apply to you.

This warranty gives you specific legal rights, and you may also have other rights, which vary from state to state.

Service Center

Conair Corporation
Service Department
7475 N. Glen Harbor Blvd.
Glendale, AZ 85307

For information on any Conair® or Infiniti™ by Conair® product call 1-800-3-CONAIR or visit us on the web at: www.conair.com/infiniti

©2007 Conair Corporation
150 Milford Road, East Windsor, NJ 08520
7475 N. Glen Harbor Blvd., Glendale, AZ 85307

Patent Pending

07NP150

IB-7771

Nano Silver
Tourmaline
Ceramic™ Styler

1 3/4" Straightener

Instruction & Styling Guide

For your safety and continued enjoyment of this product, always read the instruction book carefully before using.

Model CS45

infiniti™
nano silver
by CONAIR®

Free Manuals Download Website

<http://myh66.com>

<http://usermanuals.us>

<http://www.somanuals.com>

<http://www.4manuals.cc>

<http://www.manual-lib.com>

<http://www.404manual.com>

<http://www.luxmanual.com>

<http://aubethermostatmanual.com>

Golf course search by state

<http://golfingnear.com>

Email search by domain

<http://emailbydomain.com>

Auto manuals search

<http://auto.somanuals.com>

TV manuals search

<http://tv.somanuals.com>