

Continental

Refrigerator

27" & 32" FRONT BREATHER SANDWICH UNIT REFRIGERATORS



SW27-12M-FB



SW32-8-FB

Models Available

- SW27-8-FB
- SW27-8C-FB
- SW27-12M-FB
- SW32-8-FB
- SW32-8C-FB
- SW32-12M-FB

Utilizing Environmentally Safe, CFC-free R-134a Refrigerant



Standard Features

- Unique Air Flow Distribution Allows Pan Product to Maintain 33°–41°F Being in Compliance with and Certified Under the '98 NSF Standard For Preparation Units
- Modern, State-of-the-Art Styling
- Performance Rated Refrigeration System Utilizing Environmentally Safe R-134a Refrigerant
- Easily Serviceable Back Mounted Compressor
- 2" Non-CFC Polyurethane Foam Insulation
- Spring Loaded, Self Closing Door
- Magnetic Snap-In Gasket
- 3⁵/₈" Casters
- Heavy-Duty, Epoxy-Coated Steel Shelves
- Interior Hanging Thermometer
- Full Length Nylon Cutting Board
- Cabinet Construction Consisting of Stainless Steel Front and Top, Aluminum End Panels, Case Back and Interior
- Non-Corrosive, Plasticized Fin Evaporator Coil
- Completely Enclosed, Vented and Removable Case Back
- Automatic, Energy Saving, Non-Electric Condensate Disposal
- 1/6 Size Pans, 4" Deep
- 10 ft Cord and Plug Attached

Optional Features & Accessories

- Electric Condensate
- Pan Opening Sizes
- Door Locks
- Additional Shelves
- Single Overshelf
- Double Overshelf
- Stainless Steel Interior & Exterior-SS Models
- Remote Models -R
- Stainless Steel End Panels-SA Models
- Stainless Steel Roll Out Drawers in Lieu of Doors-D Models
- Stainless Steel Finished Back in Lieu of Aluminum

27" & 32" Front Breather Sandwich Unit Refrigerators

SPECIFICATIONS

SW27-8-FB SW27-8C-FB SW27-12M-FB SW32-8-FB SW32-8C-FB SW32-12M-FB

DIMENSIONAL DATA

Net Capacity (cu. ft.)	7.4	7.4	7.4	9.0	9.0	9.0
1/6 Size Pans	8	8	12	8	8	12
Width, Overall (in.)	27 ¹ / ₂	27 ¹ / ₂	27 ¹ / ₂	32	32	32
Depth, (incl. Hlds. & Bumpers) (in.)	31	31	31	31	31	31
Depth, Body Only (Less Door(s))(in.)	27 ¹ / ₂	27 ¹ / ₂	27 ¹ / ₂	27 ¹ / ₂	27 ¹ / ₂	27 ¹ / ₂
Depth, Cutting Board	12	19	10	12	19	10
Height, Overall (incl. 3 ⁵ / ₈ " Casters) (in.)	40 ⁷ / ₈	40 ⁷ / ₈	40 ⁷ / ₈	40 ⁷ / ₈	40 ⁷ / ₈	40 ⁷ / ₈
Shelf Area (sq. ft.)	3.5	3.5	3.5	3.9	3.9	3.9
No. of Shelves	1	1	1	1	1	1
No. of Doors	1	1	1	1	1	1
Condensing Unit Size (H.P.)	1/5	1/5	1/5	1/5	1/5	1/5
Refrigerant	R-134a	R-134a	R-134a	R-134a	R-134a	R-134a
Cabinet Electrical	115/60/1	115/60/1	115/60/1	115/60/1	115/60/1	115/60/1
Amps	6.2	6.2	6.2	6.3	6.3	6.3
Fans	2	2	2	2	2	2
Interior Depth (in.)	20	20	20	20	20	20
Interior Height (in.)	26 ¹ / ₄	26 ¹ / ₄	26 ¹ / ₄	26 ¹ / ₄	26 ¹ / ₄	26 ¹ / ₄
Interior Width (in.)	24 ¹ / ₄	24 ¹ / ₄	24 ¹ / ₄	28	28	28
Shipping Weight (lbs.)	180	180	188	195	195	205
Shipping Height (in.)	43 ¹ / ₄	43 ¹ / ₄	43 ¹ / ₄	43 ¹ / ₄	43 ¹ / ₄	43 ¹ / ₄
Shipping Length (in.)	35 ³ / ₄	35 ³ / ₄	35 ³ / ₄	39	39	39
Shipping Depth (in.)	46	46	46	46	46	46

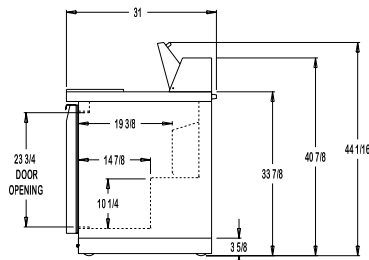

STANDARD TOP SIDE VIEW

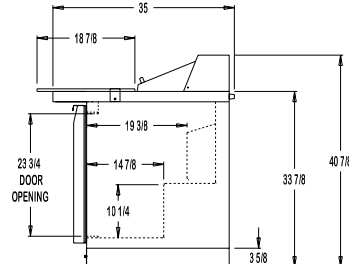

C-TOP SIDE VIEW

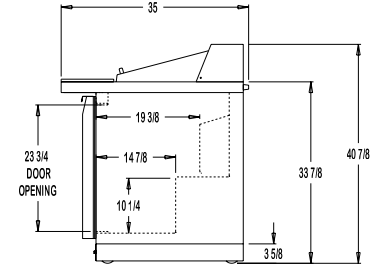

M-TOP SIDE VIEW

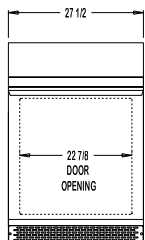

27" FRONT VIEW

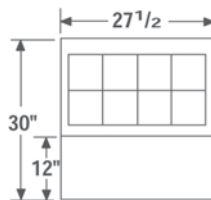

SW27-8 TOP VIEW

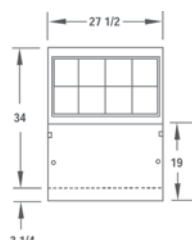

SW27-8C TOP VIEW

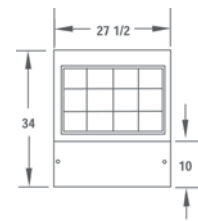

SW27-12M TOP VIEW

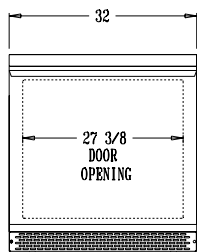

32" FRONT VIEW

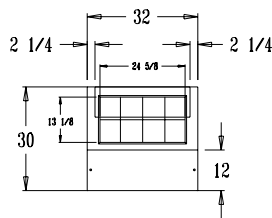

SW32-8 TOP VIEW

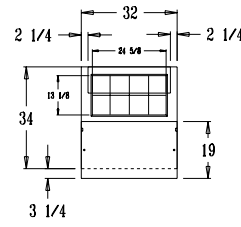

SW32-8C TOP VIEW

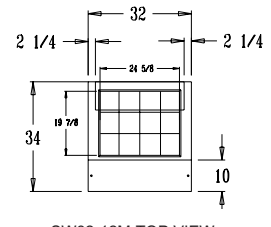

SW32-12M TOP VIEW

Continental

Refrigerator

A Division of National Refrigeration & A/C Products, Inc.
 539 Dunksferry Road Bensalem, PA 19020
 (800) 523-7138 Fax: (215) 244-9579
www.continentalrefrigerator.com

2732SANDFB907

Free Manuals Download Website

<http://myh66.com>

<http://usermanuals.us>

<http://www.somanuals.com>

<http://www.4manuals.cc>

<http://www.manual-lib.com>

<http://www.404manual.com>

<http://www.luxmanual.com>

<http://aubethermostatmanual.com>

Golf course search by state

<http://golfingnear.com>

Email search by domain

<http://emailbydomain.com>

Auto manuals search

<http://auto.somanuals.com>

TV manuals search

<http://tv.somanuals.com>