

DIMENSIONS

Slipfitter Mount

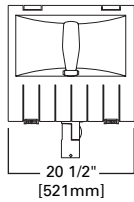

150-400W HPS & MH,
1000W HPS 9 1/2" [241mm]
1000W MH 10 1/2" [267mm]

Yoke Mount

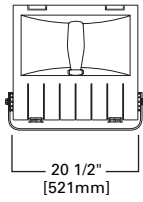

150-400W HPS & MH,
1000W HPS 9 1/2" [241mm]
1000W MH 10 1/2" [267mm]

Trunnion Mount

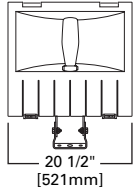

150-400W HPS & MH,
1000W HPS 9 1/2" [241mm]
1000W MH 10 1/2" [267mm]

YOKE- AND TRUNNION-MOUNT DRILL PATTERN

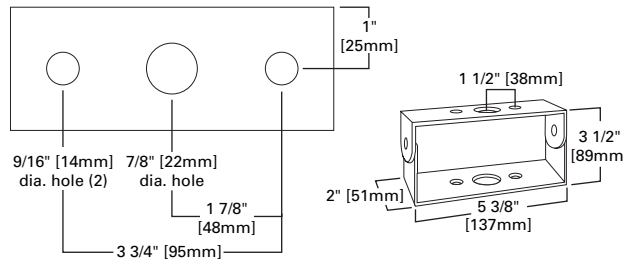

EPA-Effective Projected Area: 2.7

ORDERING INFORMATION

SAMPLE NUMBER: HPNK-S76-400-MT-Q

Lamp Type HP=High Pressure Sodium MH=Metal Halide MP=Pulse Start MH (CWA) ¹	Series NK=Nighthawk III	Mounting Type S=Slipfitter T=Trunnion Y=Yoke	Distribution 76=7Hx6V	Lamp Wattage 150=150W 175=175W 200=200W 250=250W 320=320W ² 400=400W 750=750W ³ 1000=1000W	Voltage⁴ 120V 208V 240V 277V 347V 480V MT=Multi-Tap ⁵ TT=Triple-Tap ⁶	Options & Accessories (See Below)
--	-----------------------------------	--	---------------------------------	---	---	---

STOCK SAMPLE NUMBER (Lamp Included)

SAMPLE NUMBER: MHNKS1K

Lamp Type HP=High Pressure Sodium MH=Metal Halide	Series NK=Nighthawk III ⁷	Mounting Type S=Slipfitter Y=Yoke	Lamp Wattage 25=250W ⁸ 40=400W 1K=1000W	Accessories TYS-XX=Trunnion or Yoke Slipfitter for 2 3/8", 3", or 3 1/2" O.D. Tenon
--	--	--	--	---

NOTES: Options not available with stock products. Order Accessories as separate items for field installation. Refer to standard ordering information to add options and accessories.

For Pole Information Refer to Cooper Lighting Pole Section.

Options⁹

F1=Single Fuse (120, 277 or 347V)
F2=Double Fuse (208, 240 or 480V)
Q=Quartz Restrike DC Bayonet Base (Hot Strike Only)
EM=Quartz Restrike Cold Start Time Delay Relay (Not available in 1000W)
PER=NEMA Twistlock Photocontrol Receptacle
T=Removable Quick-Disconnect Power Tray (Cannot be used with 1000W units)
LL=Lamp Included¹⁰

Accessories¹¹

VS/NK=Vandal Shield
VS/NK/1000=Vandal Shield for 1000W Units
WG/NK=Wire Guard (Specify Color)
OA/RA1016=Photoelectric Control, 105-285-Volt NEMA Type
OA/RA1027=Photoelectric Control, 480 Volt NEMA Type
OA/RA1028=Field Installed NEMA Twistlock Photocontrol Receptacle (Order Photocontrol Separately)
OA/RA1201=Photoelectric Control, 347 Volt NEMA Type
TV/NK=Top or Bottom Visor (Specify Color)
SV1/NK=Single Side Visor (Specify Color)
SV/NK=Double Side Visor (Specify Color)
OA/RA1013=Shorting Cap for NEMA Twistlock Photocontrol Receptacle
TYS-XX=Trunnion or Yoke Slipfitter for 2 3/8", 3", or 3 1/2" O.D. Tenon

LAMP TYPE	WATTAGE
Metal Halide	150, 175, 250, 400, 1000W
Pulse Start Metal Halide	200, 250, 320, 400, 750W
High Pressure Sodium	150, 250, 400, 750, 1000W

NOTES: 1 200, 250, 320, 350, 400, & 750W. 2 Pulse Start Metal Halide only. 3 HPS & MP only. 4 Products also available in non-US voltages and 50Hz for international markets. Consult factory for availability and ordering information. 5 Multi-Tap ballast is 120/208/240/277V wired 277V. 6 Triple-Tap ballast is 120/277/347V wired 347V. 7 Multi-tap ballast, 7Hx6V distribution, bronze finish, and lamp are standard for stock product. 8 250W stock product only available with Metal Halide lamp and slipfitter mount. 9 Add as suffix in the order showing. 10 Lamp is shipped separate from luminaire. Lamp is Cooper designated product based on luminaire requirements. Specified lamps must be ordered as a separate line item. 11 Order separately, replace XX with color suffix. 12 Specifications and dimensions subject to change without notice.

DESCRIPTION

The Lumark Nighthawk III utilizes a soft-cornered aerodynamic design to provide excellent EPA ratings and an aesthetically pleasing appearance. Dark bronze polyester powder coat finish assures corrosion resistance and long-lasting aesthetics. U.L. listed and CSA certified for wet locations.



NK NIGHTHAWK III

150 - 1000 W
High Pressure Sodium
Pulse Start Metal Halide
Metal Halide

SLIPFITTER-, YOKE-, OR TRUNNION-MOUNTED FLOODLIGHT

- Aerodynamically designed die-cast aluminum housing has low EPA rating and is finished in a dark bronze polyester powder coat
- Flush, draw-action latches offer easy access to lamp compartment without tools and maintain integrity of seal when closed
- Die-cast aluminum with integral cast hinges for toolless access
- Heat- and impact-resistant tempered glass. Lens is mounted flush with door surface to reduce wind drag and prevent dirt or moisture from accumulating
- Door gasket is foam-in-place silicone, providing maximum protection of interior components from the elements
- Available in three (3) mounting variations.
Slipfitter: Die-cast aluminum integral slipfitter mounts on 2 3/8" to 3" O.D. tenon. **Yoke:** Heavy-duty steel yoke provides flexibility in mounting from a variety of surfaces. **Trunnion:** Die-formed steel trunnion is easily adapted to many areas and allows easy fixture aiming.
- Approximate net weight: 59 lbs. (27 kgs.)

Free Manuals Download Website

<http://myh66.com>

<http://usermanuals.us>

<http://www.somanuals.com>

<http://www.4manuals.cc>

<http://www.manual-lib.com>

<http://www.404manual.com>

<http://www.luxmanual.com>

<http://aubethermostatmanual.com>

Golf course search by state

<http://golfingnear.com>

Email search by domain

<http://emailbydomain.com>

Auto manuals search

<http://auto.somanuals.com>

TV manuals search

<http://tv.somanuals.com>