

CROWN

Specifications

TR 3600 Series

Tow Tractor

TR 3600

Series



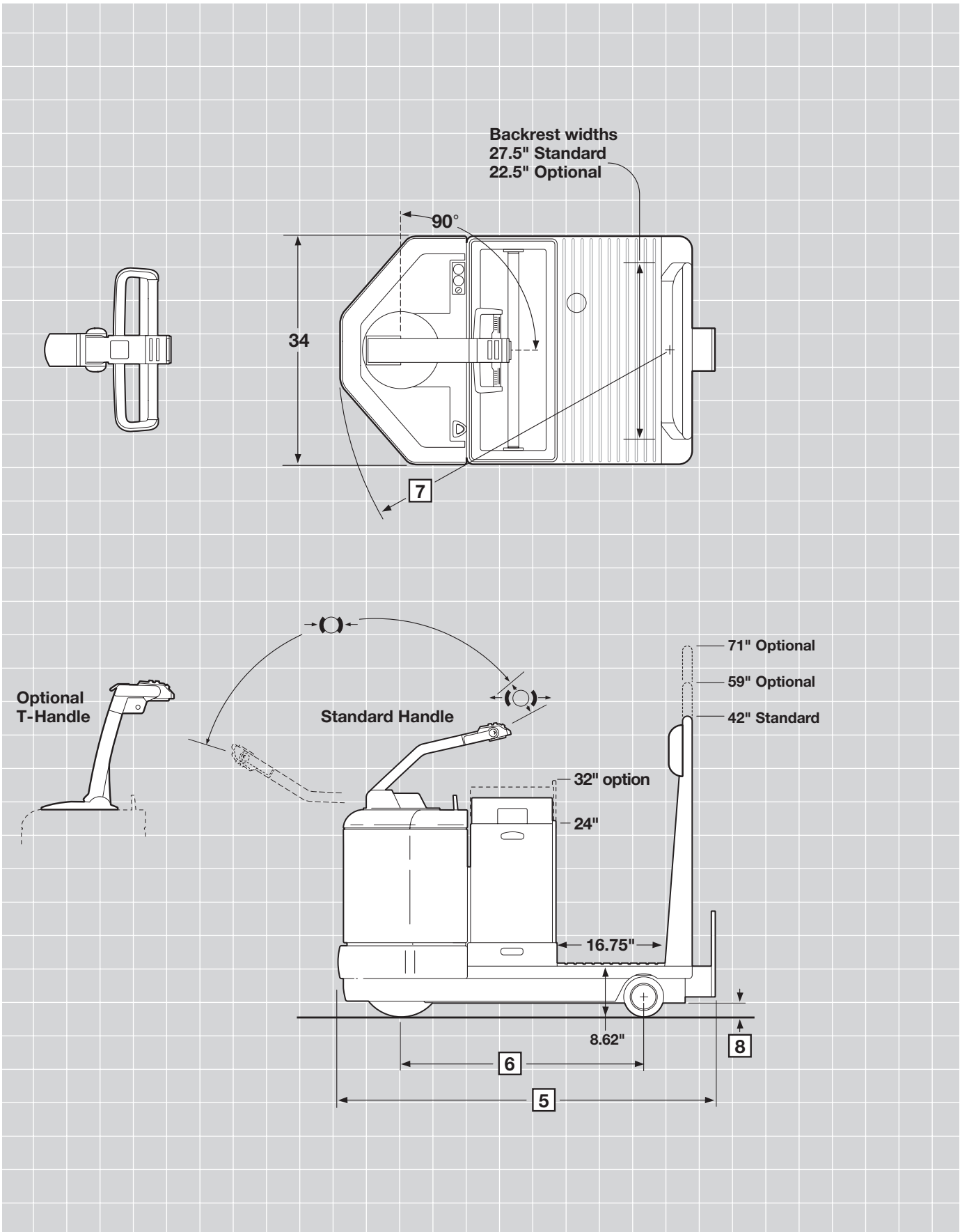

General Info	1	Manufacturer	Crown Equipment Corporation		
	2	Model	TR 3600		
	3	Drawbar Pull	Normal	lb	200*
			Maximum	lb	635
	4	Rolling Load Capacity		lb	10,000
5	Overall Length		in	60.3	
Dimensions	6	Wheelbase		in	38
	7	Turning Radius		in	48.3
	8	Grade Clearance		%	27
9	Travel Speeds	Empty	mph	9.0**	
		Loaded	mph	6.0**	
10	Truck Weight		lb	1280	

* 12" hitch height.
 **Power unit first travel only.

Adjustable Hitch Plates

Hitch plate allows all types of hitches to be adjusted in 1.75" increments.

Hitch	Hitch Heights	
	Minimum	Maximum
Automatic	8"	15"
Pintle	8.62"	15.62"
Eye	8.75"	15.75"
Pin & Clevis	7.88"	16.62"

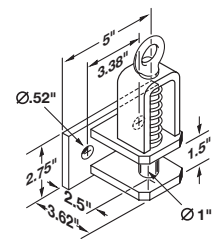
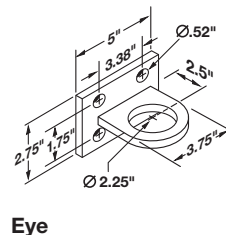
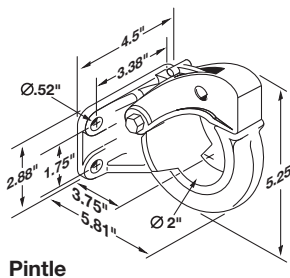
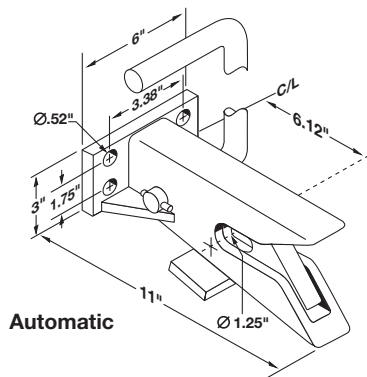

TR 3600 Series

Technical Information

Maximum Battery Size

13.19" wide x 31.12" long x 31.62" high

Batteries

24-volt, 750 amp hour, 21.5 Kwh
 Min/Max weight 975/1500 lb

Standard Equipment

- 24-volt fused electrical system
- Coupler
- Curtis transistor control
- InfoPoint® Quick Reference Guide and Maps support diagnostics
- Short battery wall (use with 23.38" tall battery)
- 27.5" wide backrest
- 42" tall backrest
- Padded back cushion
- Orange polyurethane trail wheels
- Black polyurethane drive tire
- Standard control handle includes full width twist grip with cams and full width horn button. The optional "T" type control handle with full width twist grips with cams, dual brake levers and parking brake lever.

12. 175 amp battery connector
13. Key switch
14. Horn
15. Lift-off left and right battery retainers

Optional Equipment

1. Curtis Spyglass (discharge indicator with high speed travel lockout and hour meter)
2. Hour meter
3. Molded urethane leg cushion (battery wall mount)
4. Suspended operator platform with molded urethane platform cushion
5. Tall battery wall (use with 31.62" tall battery)
6. 22.5" wide backrest
7. 59" or 71" high backrest
8. Storage tray and bin located in backrest
9. Storage module on battery (23.38" high battery only)
10. Battery compartment rollers
11. Battery retainer interlock switch
12. Quick battery disconnect handle (SB 175 and right side only)
13. Left side battery connector (facing power unit doors)
14. Drive tire and trail wheel options
15. Toggle switch in lieu of key
16. Freezer and corrosion conditioning
17. Special color paint
18. Automatic coupler with "Quick Release"
19. "T" type control handle with full width twist grips with cams, dual brake levers and parking brake lever.

Operator Area and Controls

The TR 3600 Series incorporates a comfortable operator compartment to increase productivity. Rounded edges and careful placement of operator contact points make the TR 3600 Series user-friendly.

A larger operator platform allows quick entry/exit onto the truck.

Where walking through the compartment is common, the larger compartment, low profile high speed pedal, rounded edges and optional backrest width and heights help walk-through.

The low profile high speed pedal prevents the operator from stepping up and over the pedal. When the pedal is engaged, it is approximately flush with the platform cushion for maximum comfort.

All operator contact points are rounded to prevent snagging of operators clothes or job related items.

Optional width and height backrests can be specified for your application. Hip, shoulder and elbow clearance are maximized when this feature is customized to your application.

A large back cushion is standard to minimize fatigue when the operator is in the transport position. An optional suspended floor and floor cushion reduces vibration and shock to the operator's feet and legs.

The TR has the standard control handle with full width twist grips with cams and a full width horn button. The TR has an optional 24" wide "T" type control handle, with full width twist grips with cams, dual brake levers and a parking brake lever. On the control pod is a full width horn button for easy actuation. Dual brake levers and parking brake are positioned and shaped for maximum comfort.

Many optional features for the operator area and controls are available to suit a wide range of applications.

Electrical System

Heavy-duty, 24-volt electrical system for demanding warehouse applications. The new 1404C separately excited traction control integrates many of the operating features to provide excellent control and reliability. Directional contactors are eliminated, while traction speeds have been improved for optimum productivity. Crown-manufactured, separately excited, high-torque drive motor is application designed for reliability and ease of service. Color-coded wiring is also used for ease of service.

Drive Unit

All gear drive from drive motor to drive wheel axle. Drive tire axle is mounted in the drive unit on both sides for maximum strength in rough floor applications. Drive unit is top and bottom mounted. Top mount is a large taper roller bearing for vertical or horizontal forces. Bottom mount has four shock mounted rollers on drive unit running in a hardened steel roller race. Gear train runs in oil-filled, sealed housing.

Wheels and Tires

Drive tire, 13" diameter x 4.5" wide x 8" hub polyurethane. Trail wheels, 7" diameter x 5" wide rubber or polyurethane.

Power Unit Structure

Rugged steel doors are suspended on heavy-duty pin hinges. Doors swing wide for good access. Doors can also be lifted off for unrestricted service access. Door bolts have exclusive convex design that mates with concave door holes for fast reinstallation of bolts. Heavy steel skirt surrounds entire area.

Brake

Internal expanding mechanical brake with fin-cooled 6" drum. Braking on the TR is actuated by moving the control handle into the brake range. Braking on TR with optional "T" type handle is actuated by two brake levers on the control handle.

Other Options

1. Audible travel alarm
2. Flashing lights

Safety considerations and dangers associated with audible travel alarms and flashing lights include:

- Multiple alarms and/or lights can cause confusion.
- Workers ignore the alarms and/or lights after day-in and day-out exposure.
- Operator may transfer the responsibility for "looking out" to the pedestrians.
- Annoys operators and pedestrians.

Dimensions and performance data given may vary due to manufacturing tolerances. Performance is based on an average size vehicle and is affected by weight, condition of truck, how it is equipped and the conditions of the operating area. Crown products and specifications are subject to change without notice.

**Crown Equipment Corporation**

New Bremen, Ohio 45869 USA

Tel 419-629-2311

Fax 419-629-3796

crown.com

Because Crown is continually improving its products, specifications are subject to change without notice.

Crown, the Momentum symbol and InfoPoint are trademarks of Crown Equipment Corporation.

Copyright 2006 Crown Equipment Corporation
SF14641 3/06
Printed in U.S.A.

Free Manuals Download Website

<http://myh66.com>

<http://usermanuals.us>

<http://www.somanuals.com>

<http://www.4manuals.cc>

<http://www.manual-lib.com>

<http://www.404manual.com>

<http://www.luxmanual.com>

<http://aubethermostatmanual.com>

Golf course search by state

<http://golfingnear.com>

Email search by domain

<http://emailbydomain.com>

Auto manuals search

<http://auto.somanuals.com>

TV manuals search

<http://tv.somanuals.com>