



Electric Steam Sterilizer

CS-6 SERIES

For your safety and continued enjoyment of this product, always read the instruction book carefully before using.
Download from [Www.Somanuals.com](http://www.Somanuals.com). All Manuals Search And Download.

IMPORTANT SAFEGUARDS

When using an electrical appliance, basic safety precautions should always be adhered to, including the following:

1. **READ ALL INSTRUCTIONS.**
2. **Always unplug unit from outlet when not in use, before putting on or taking off parts, and before cleaning. To unplug, grasp plug and pull from electrical outlet. Never pull cord. Allow to cool before handling.**
3. To protect against risk of electric shock, do not put cord, plug or unit base in water or other liquids.
4. Close supervision is necessary when any appliance is used by or near children.
5. Do not operate any appliance with a damaged cord or plug, or after the appliance malfunctions, or if appliance has been dropped or damaged in any manner. Return the appliance to the nearest authorized Cuisinart Service Facility for examination, repair, and electrical or mechanical adjustment.
6. The use of attachments not recommended or sold by Cuisinart may cause fire, electric shock or injury.
7. Do not let cord hang over edge of table or counter, or touch hot surfaces.
8. Don't attempt to handle the electrical cord to plug or unplug the unit when your hands are wet.
9. Do not use outdoors.
10. Do not touch hot surfaces. Use handles or knobs.
11. Extreme caution must be used when moving an appliance containing hot oil or other hot liquids.
12. When in use, the sterilizer contains hot water. Be careful to avoid spilling any water on yourself when removing items from the sterilizer.

13. Do not operate your appliance in an appliance garage or under a wall cabinet. **When storing in an appliance garage, always unplug the unit from the electrical outlet.** Not doing so could risk a fire, especially if the appliance touches the walls of the garage or the door touches the unit as it closes.
14. Do not use the appliance for other than intended use.
15. Where applicable, always attach plug to appliance and check that the control is OFF before plugging cord into wall outlet. To disconnect, turn the control to OFF, then remove plug from wall outlet.
16. Do not place on or near a hot gas or electric burner, or in a heated oven.
17. **WHEN IN USE THE STERILIZER CONTAINS BOILING WATER AND STEAM ESCAPES FROM THE VENT IN THE LID.**
18. Not for space heating purposes.

SAVE THESE INSTRUCTIONS FOR HOUSEHOLD USE ONLY SPECIAL CORD SET INSTRUCTIONS

A short power supply cord is provided to reduce the risks of becoming entangled in or tripping over a longer cord. Extension cord are available and maybe used if care is excercised in their use. If an extension cord (or a long detachable power-supply cord) is used:

1. The marked electrical rating of the detachable power-supply cord or extension cord should be at least as great as the electrical rating of the appliance.
2. If the appliance is of the grounded type, the extension cord should be a grounding type 3-wire cord.
3. The longer cord should be arranged so that it will not drape over the countertop or tabletop where it can be tripped over, snagged or pulled on unintentionally (especially by children).

NOTICE

This appliance has a polarized plug (one prong is wider than the other). As a safety feature, this plug will fit into a polarized outlet only one way. If the plug does not fit fully in the outlet, reverse the plug. If it still does not fit, contact a qualified electrician. Do not attempt to defeat this safety feature.

CONTENTS

Important Safeguards.....	2
Features and Benefits	3
Before First Use	4
Operation.....	4-5
Tips and Hints	6
Troubleshooting.....	6
Cleaning and Maintenance	6
Warranty	7

FEATURES AND BENEFITS

1. **Lid** - helps to accommodate different sized bottles and parts and contains steam for quick sterilization.
2. **Removable Lower Tray** - holds 6 glass or plastic bottles of all brands, shapes and sizes.
3. **Removable Upper Tray** - can be used to sterilize nipples, pacifiers, teethingers and other small items.
4. **Stem** - keeps the trays securely in place.
5. **Measuring Cup** - stores conveniently inside the unit lid.
6. **Sterilizing Chamber** - wipes clean with a damp cloth.
7. **Simple Dial Control** - easy ON/OFF operation.
8. **Cord Wrap (not shown)**
9. **BPA Free (not shown)** - all materials that come in contact with food are BPA free.

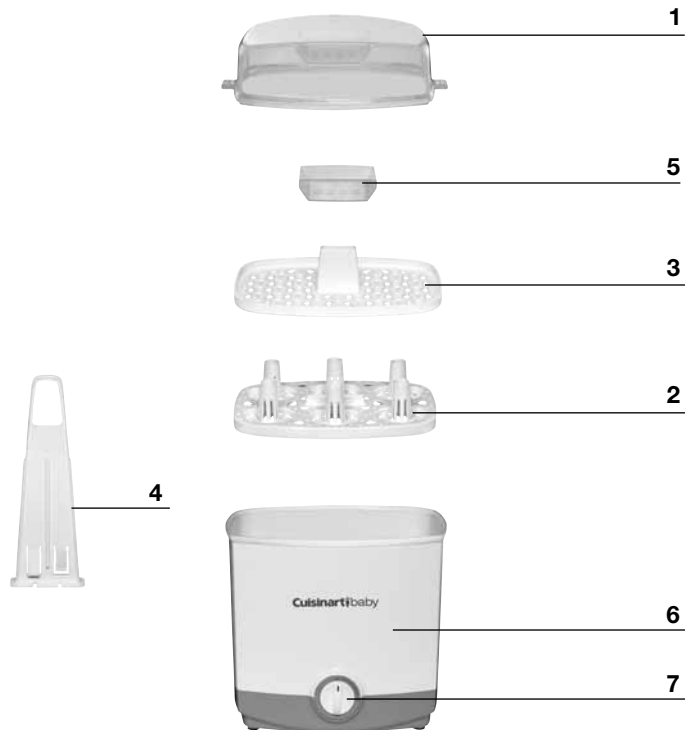

BEFORE THE FIRST USE

Carefully unpack the unit and remove any packaging and promotional labels in or on the sterilizer. Rinse all accessories thoroughly with warm soapy water.

OPERATION

Before you begin sterilizing, thoroughly wash all bottles and feeding accessories in warm soapy water or in the dishwasher.

1. Remove the measuring cup from the sterilizer lid by popping it up from the bottom edge.
2. Lift off the sterilizer lid and set it aside.
3. Fill the measuring cup with water to the fill line on the side of the measuring cup (100mL), then pour it into the sterilizing chamber.

NOTE: DO NOT EXCEED the recommended amount of water.

4. Slide the stem through the lower tray to assemble, then place them in the sterilizing chamber.
5. Place the bottles neck downward into the designated areas on the lower tray.
Note: The tray hold up to 6 of the largest bottles available.
6. Lift the upper tray by the center post in the middle of the tray and slide it over the stem attached to the lower tray in the steaming chamber.

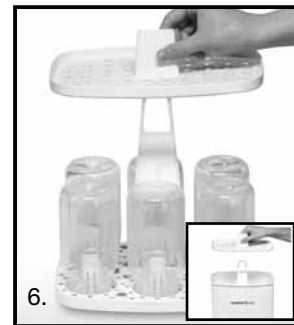
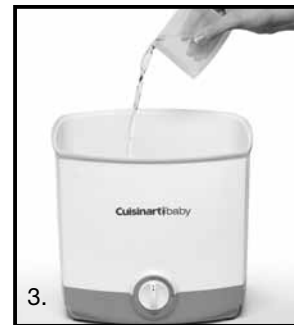

- Loosely scatter the unassembled components on the upper tray. (It is important that all bottle parts are disassembled before adding them to the upper tray for proper sterilization).
- Replace the measuring cup in the sterilizer lid and then place the lid on top of the sterilizing chamber.
- Turn the dial to ON and the LED light will illuminate to indicate the sterilizing has begun. The unit and the LED light will shut off automatically once sterilizing is complete. Turn the dial to the OFF position.

Caution: Hot surface. Avoid contact. During use, never touch the base, the lid or the lid handles.

- Allow the sterilizer to cool for 10 minutes before opening, and wash your hands thoroughly before handling the sterilized items.
 - Carefully remove the sterile contents by lifting up from the stem sticking through the upper tray. Use caution when removing, as the items will be hot.
- NOTE:** The contents will remain sterile for up to 24 hours if the sterilizer is unopened.

- To help prevent a buildup of calcium in the unit, drain and rinse the unit after each use. To empty the unit of excess water, wait until the unit has cooled, then tip the unit onto its side over the sink and any extra water will come out.



TIPS AND HINTS

For best results, use purified water to minimize a buildup of calcium in the sterilizing chamber.

TROUBLESHOOTING

Q: Why won't sterilizing start when I turn the unit on?

A: Check that the plug is securely inserted into the outlet.

A: The sterilizing chamber may be empty. Add water to the sterilizing chamber.

Q: How do I empty the unit of excess water?

A: To empty the unit of excess water, tilt the unit onto its side over the sink and any extra water will come out.

Q: Why is there a white residue in the sterilizing chamber?

A: Mineral-rich water causes calcium deposits to build up in the sterilizing chamber. The unit should be cleaned out once a month to avoid this buildup. Refer to the Decalcification section in Cleaning and Maintenance, following. To help prevent/minimize this buildup, fresh or purified water can be used.

Q: Why are the bottles coming out with marks on them?

A: This can happen when the sterilizer has a buildup of calcium deposits. Refer to the Decalcification section in Cleaning and Maintenance, following.

Q: Why is the sterilizing cycle taking so long?

A: Too much water has been added to the sterilizing chamber. Exactly 100mL of water should be used each time to sterilize.

CLEANING AND MAINTENANCE

Cleaning accessories and base

Clean all accessories in warm soapy water or on the top rack of the dishwasher.

Wipe the base clean with a damp sponge or cloth. Dry it immediately. Never submerge the base or the plug in water or other liquids.

Decalcification

Sometimes mineral deposits form inside the steam chamber that can cause damage to the machine. To avoid buildup of these minerals, the unit should be de-scaled once a month.

To descale, pour 1 cup of white (distilled) vinegar into the sterilizing chamber. Let it stand for at least 2 hours and then empty. Rinse the unit with water after you empty the unit of the vinegar to ensure it is properly rinsed out. Repeat if necessary.

Storage

The Cuisinart Baby® Electric Steam Sterilizer stores neatly on the countertop in a minimum of space. When it is not in use, make sure to empty any leftover water from the unit and leave it unplugged. The hidden cord storage underneath the base will help keep excess cord off the countertop.

The Cuisinart Baby® Electric Steam Sterilizer is intended for HOUSEHOLD USE ONLY. Any service other than cleaning and normal user maintenance should be performed by an authorized Cuisinart Service Representative.

WARRANTY

Limited 3-Year Warranty

This warranty is available to consumers only. You are a consumer if you own a Cuisinart Baby® Electric Steam Sterilizer that was purchased at retail for personal, family or household use. Except as otherwise required under applicable law, this warranty is not available to retailers or other commercial purchasers or owners.

We warrant that your Cuisinart Baby® Electric Steam Sterilizer will be free of defects in materials and workmanship under normal home use for 3 years from the date of original purchase.

We recommend that you visit our website, www.cuisinart.com for a fast, efficient way to complete your product registration. However, product registration does not eliminate the need for the consumer to maintain the original proof of purchase in order to obtain the warranty benefits. In the event that you do not have proof of purchase date, the purchase date for purposes of this warranty will be the date of manufacture.

CALIFORNIA RESIDENTS ONLY

California law provides that for In-Warranty Service, California residents have the option of returning a nonconforming product (A) to the store where it was purchased or (B) to another retail store that sells Cuisinart products of the same type. The retail store shall then, according to its preference, either repair the product, refer the consumer to an independent repair facility, replace the product, or refund the purchase price less the amount directly attributable to the consumer's prior usage of the product. If neither of the above two options results in the appropriate relief to the consumer, the consumer may then take the product to an independent repair facility, if service or repair can be economically accomplished. Cuisinart and not the consumer will be responsible for the reasonable cost of such service, repair, replacement, or refund for nonconforming products under warranty. California residents may also, according to their preference, return nonconforming products directly to Cuisinart for repair or, if necessary, replacement by calling our Consumer Service Center toll-free at 1-800-726-0190. Cuisinart will be responsible for the cost of the repair, replacement, and shipping and handling for such nonconforming products under warranty.

BEFORE RETURNING YOUR CUISINART PRODUCT

If your Cuisinart Baby® Electric Steam Sterilizer should prove to be defective within the warranty period, we will repair or, if we think necessary, replace it. To obtain warranty service, please call our Consumer Service Center toll-free at 1-800-726-0190 or write to: Cuisinart, 7811 North Glen Harbor Blvd., Glendale, AZ 85307. To facilitate the speed and accuracy of your return, enclose \$10.00 for shipping and handling. (California residents need only supply a proof of purchase and should call 1-800-726-0190 for shipping instructions.) Please be sure to include your return address, description of the product's defect, product serial number, and any other information pertinent to the return. Please pay by check or money order. NOTE: For added protection and secure handling of any Cuisinart product that is being returned, we recommend you use a traceable, insured delivery service. Cuisinart cannot be held responsible for in-transit damage or for packages that are not delivered to us. Lost and/or damaged products are not covered under warranty.

Your Cuisinart Baby® Electric Steam Sterilizer has been manufactured to the strictest specifications and has been designed for use only in 120-volt outlets and only with authorized accessories and replacement parts. This warranty expressly excludes any defects or damages caused by attempted use of this unit with a converter, as well as use with accessories, replacement parts or repair service other than those authorized by Cuisinart. This warranty does not cover any damage caused by accident, misuse, shipment or other than ordinary household use. This warranty excludes all incidental or consequential damages. Some states do not allow the exclusion or limitation of these damages, so these exclusions may not apply to you. You may also have other rights, which vary from state to state.

Important: If the nonconforming product is to be serviced by someone other than Cuisinart's Authorized Service Center, please remind the servicer to call our Consumer Service Center at 1-800-726-0190 to ensure that the problem is properly diagnosed, the product is serviced with the correct parts, and to ensure that the product is still under warranty.

Cuisinart baby



Bottle Warmer



Baby Food
Maker & Bottle
Warmer



Juicers



Blenders



Tools and
Gadgets

Cuisinart offers an extensive assortment of top quality products to make life in the kitchen easier than ever. Try some of our other countertop appliances, cookware, tools and gadgets.

www.cuisinart.com/baby

www.cuisinart.com

©2012 Cuisinart
150 Milford Road
East Windsor, NJ 08520
Printed in China

12CE131418

IB-11161

Free Manuals Download Website

<http://myh66.com>

<http://usermanuals.us>

<http://www.somanuals.com>

<http://www.4manuals.cc>

<http://www.manual-lib.com>

<http://www.404manual.com>

<http://www.luxmanual.com>

<http://aubethermostatmanual.com>

Golf course search by state

<http://golfingnear.com>

Email search by domain

<http://emailbydomain.com>

Auto manuals search

<http://auto.somanuals.com>

TV manuals search

<http://tv.somanuals.com>