

# Cuisinart baby

## INSTRUCTION BOOKLET



**Baby Bottle Warmer**

**BW-10 SERIES**

For your safety and continued enjoyment of this product, always read the instruction book carefully before using.  
Download from [Www.Somanuals.com](http://www.Somanuals.com). All Manuals Search And Download.

---

# IMPORTANT SAFEGUARDS

When using an electrical appliance, basic safety precautions should always be adhered to, including the following:

- 1. READ ALL INSTRUCTIONS.**
- 2. Always unplug unit from outlet when not in use, before putting on or taking off parts, and before cleaning. To unplug, grasp plug and pull from electrical outlet. Never pull cord. Allow to cool before handling.**
3. To protect against risk of electric shock, do not put cord, plug or unit base in water or other liquids.
4. Close supervision is necessary when any appliance is used by or near children.
- 5. Do not operate any appliance with a damaged cord or plug, after the appliance malfunctions, or if appliance has been dropped or damaged in any manner. Return the appliance to the nearest authorized Cuisinart Service Facility for examination, repair, and electrical or mechanical adjustment.**
6. The use of attachments not recommended or sold by Cuisinart may cause fire, electric shock or injury.
7. Do not let cord hang over edge of table or counter, or touch hot surfaces.
8. Don't attempt to handle the electrical cord to plug or unplug the unit when your hands are wet.
9. Do not use outdoors.
- 10. Before serving be sure food is at safe temperature.**
11. Do not touch hot surfaces. Use handles or knobs.

12. Extreme caution must be used when moving an appliance containing hot oil or other hot liquids.
13. Follow guidelines in the instructions for amount of water for a given bottle size depending on room or refrigerator temperature.
14. Always be sure that you are using the correct volume of water before beginning the warming cycle. The warmer should be emptied of residual water before each subsequent use.
15. When in use, the warmer contains hot water. Be careful to avoid spilling any water on yourself when removing bottle or jar from warmer.
16. Do not operate your appliance in an appliance garage or under a wall cabinet. **When storing in an appliance garage, always unplug the unit from the electrical outlet.** Not doing so could risk a fire, especially if the appliance touches the walls of the garage or the door touches the unit as it closes.
17. Do not use the appliance for other than intended use.
18. Where applicable, always attach plug to appliance and check that the control is OFF before plugging cord into wall outlet. To disconnect, turn the control to OFF, then remove plug from wall outlet.
19. Do not place on or near a hot gas or electric burner, or in a heated oven.

## SAVE THESE INSTRUCTIONS FOR HOUSEHOLD USE ONLY SPECIAL CORD SET INSTRUCTIONS

A short power supply cord is provided to reduce the risks of becoming entangled in or tripping over a longer cord. Extension cords may be used if care is exercised.

If an extension cord is used, the marked electrical rating of the extension cord should be at least as great as the electrical rating of the appliance. The longer cord should be arranged so that it will not drape over the countertop or tabletop, where it can be pulled on by children or tripped over unintentionally.

## NOTICE

This appliance has a polarized plug (one prong is wider than the other). As a safety feature, this plug will fit into a polarized outlet only one way. If the plug does not fit fully in the outlet, reverse the plug. If it still does not fit, contact a qualified electrician. Do not attempt to defeat this safety feature.

## CONTENTS

Important Safeguards.....	2
Features and Benefits .....	3
Before First Use .....	4
Operation.....	4
Bottle Warming Guide .....	4
Tips and Hints .....	6
Troubleshooting.....	6
Cleaning and Maintenance .....	6
Warranty .....	7

## FEATURES AND BENEFITS

- 1. Bottle Basket** – holds any size glass or plastic bottle.
- 2. Measuring Cup** – stores conveniently inside unit.
- 3a. Nightlight** – makes nighttime feedings a little easier.
- 3b. Nightlight Button** – to use light independently from bottle warmer.
- 4. Adapter Ring** – traps steam for faster heat-up when warming narrow bottles.

- 5. Food Warming Basket** – uses steam to heat up food quickly.
- 6. Simple Dial Control** – easy OFF/ON operation.
- 7. Cord Wrap (not shown)** – takes up excess cord and keeps countertop neat.
- 8. BPA Free (not shown)** – all materials that come into contact with food are BPA free.

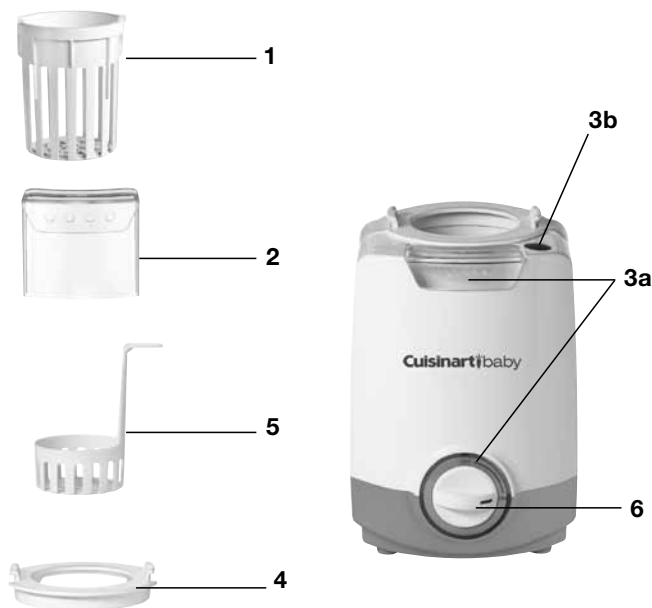

## BEFORE THE FIRST USE

Carefully unpack the unit and remove any packaging and promotional labels in or on the bottle warmer. Rinse all accessories thoroughly in warm soapy water.

## OPERATION

To warm your baby's bottle or food, please follow the instructions and the chart below.

**NOTE:** These instructions are to be used as a guide only. Please note that there are many variables, such as size of the bottle and starting temperature of the food, which can affect the speed at which this unit warms the bottle or jar as well as the final temperature. Adjustments to the instructions below may be necessary. **Always test the temperature of food before feeding baby.**

1. Remove the measuring cup from the front of the housing (fig. 1) and fill it with water to the appropriate fill line, according to the chart below.

Bottle Warming Guide		
Bottle Capacity	5°C/40°F	20°C/70°F
4 oz Plastic	10ml	8ml
8.9 oz Plastic	10ml	8ml
4 oz Glass	14ml	8ml
8.9 oz Glass	14ml	8ml
Baby Food 4 oz.	12ml	8ml
Baby Food 6 oz.	12ml	8ml

2. Pour the pre-measured amount of water from the measuring cup directly into the warming chamber (fig. 2).
3. Do not overfill. If too much water is used, the bottle or jar may be heated for too long a period and reach too high a temperature.

**Note:** Always make sure there is no water in chamber from previous use. To empty the unit of leftover water, tilt the unit onto its side over the sink. Any extra water will come out.

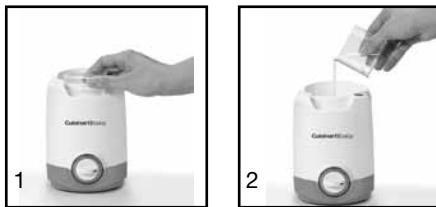

## USING THE BOTTLE BASKET

### For plastic bottles

1. Put the bottle basket into the bottle-warming chamber (fig. 3, 4). Line up the bottle basket arms with the insets on the bottle warmer housing. In this position the basket will be even/flush with the housing.



### For glass bottles

1. Put the bottle basket into the bottle warming chamber (fig. 5, 6) and turn the bottle basket to a 45-degree angle (basket will slide into place). In this position the bottle basket will sit about 1 inch above the housing.



2. Put the bottle into the bottle basket (fig. 4, 6) and turn the dial to ON position. Blue LED indicator will turn on. The unit will shut off automatically once bottle warming is complete. Turn the dial to the OFF position.
3. Let the bottle sit for 15 to 30 seconds before removing and be extremely careful removing the bottle from the unit. Shake the bottle to distribute the heated contents before checking the temperature.

## USING THE ADAPTER RING

1. When warming a narrow bottle, we suggest that you use the adapter ring.
2. Position the adapter ring over the bottle sitting in the bottle warming chamber and turn the dial to the ON position. Blue LED indicator will turn on. The unit will shut off automatically once bottle warming is complete. Turn the dial to the OFF position.

**NOTE: If the adapter ring does not fit loosely around the bottle, do not use.**



## USING THE FOOD WARMING BASKET

1. Remove the lid of the food jar and then place the jar into the food warming basket. Use the handle to lower it into the bottle warming chamber (fig. 1).
2. Turn the dial to the ON position. Blue LED indicator light will turn on. The unit will shut off automatically once food warming is complete. Turn the dial to the OFF position.
3. Let the jar sit for 15 to 30 seconds before removing. Use the handle of the food-warming basket to lift the jar out of the warming chamber (fig. 2). When you remove the jar from the unit, the contents of the jar will not be evenly heated. Stir the food to distribute the heated contents before checking the temperature.



## USING THE NIGHTLIGHT

1. To turn the nightlight on, press the gray button with the word LIGHT above it located on the top of the unit.
2. Light will illuminate from the measuring cup area and from around the dial. The nightlight will stay on until the button is pressed again.



---

## TIPS AND HINTS

For best results, use purified water to prevent calcium deposits in the warming chamber. When storing food, refrigerated food should be enjoyed within 3 days, and frozen foods should be used within 30 days for optimum freshness.

## TROUBLESHOOTING

**Q: Why won't steaming start when I turn the unit on?**

A: Check that the plug is securely inserted into the outlet.

A: The warming chamber may be empty. Add water to the steam chamber.

**Q: How do I empty the unit of excess water?**

A: To empty the unit of excess water, tilt the unit onto its side over the sink and any extra water will come out.

**Q: Why is there a white residue in the bottle warming chamber?**

A: Mineral-rich water causes calcium deposits to build up in the bottle warming chamber. The unit should be cleaned out once a month to avoid this buildup. See decalcification section in Cleaning and Maintenance, following. To help prevent/minimize this buildup, fresh or purified water can be used.

**Q: Why is the milk bottle/food jar too hot or too cold?**

A: Because there are so many variables when warming bottles/food jars, adjustments to the water amounts in the instruction booklet may be necessary. If the bottle/food jar was too hot try adding less water next time. If it was too cold try adding more water next time.

A: Make sure to shake the bottle/stir the food to distribute the heated contents after warming before checking the temperature.

## CLEANING AND MAINTENANCE

### Cleaning accessories and base

- Clean all accessories in warm soapy water or on the top rack of the dishwasher.
- Wipe the base clean with a damp sponge or cloth. Dry it immediately. Never submerge the base or the plug in water or other liquids.

### Decalcification

- Sometimes mineral deposits form inside the steam chamber and can cause damage to the machine. To avoid buildup of these minerals, the unit should be de-scaled once a month.
- To descale, pour 50 ml of white (distilled) vinegar into the steam chamber. Leave for at least 2 hours then empty.

### Storage

- The Cuisinart Baby® Bottle Warmer stores neatly on the countertop, taking a minimum of space. When it is not in use, make sure to empty any leftover water from the unit and leave it unplugged. The hidden cord storage underneath the base will help keep excess cord off the countertop.
- The Cuisinart Baby® Bottle Warmer is intended for **HOUSEHOLD USE ONLY**. Any service other than cleaning and normal user maintenance should be performed by an authorized Cuisinart Service Representative.

# WARRANTY

## Limited 3 Year Warranty

This warranty is available to consumers only. You are a consumer if you own a Cuisinart Baby® Bottle Warmer that was purchased at retail for personal, family or household use. Except as otherwise required under applicable law, this warranty is not available to retailers or other commercial purchasers or owners.

We warrant that your Cuisinart Baby® Bottle Warmer will be free of defects in materials and workmanship under normal home use for 3 years from the date of original purchase.

We recommend that you visit our website, [www.cuisinart.com](http://www.cuisinart.com) for a fast, efficient way to complete your product registration. However, product registration does not eliminate the need for the consumer to maintain the original proof of purchase in order to obtain the warranty benefits. In the event that you do not have proof of purchase date, the purchase date for purposes of this warranty will be the date of manufacture.

If your Cuisinart Baby® Bottle Warmer should prove to be defective within the warranty period, we will repair it, or if we think necessary, replace it. To obtain warranty service, simply call our toll-free number 1-800-726-0190 for additional information from our Customer Service Representatives, or send the defective product to Customer Service at Cuisinart, 7811 North Glen Harbor Blvd., Glendale, AZ 85307.

To facilitate the speed and accuracy of your return, please enclose \$10.00 for shipping and handling of the product.

Please pay by check or money order (California residents need only supply proof of purchase and should call 1-800-726-0190 for shipping instructions).

NOTE: For added protection and secure handling of any Cuisinart product that is being returned, we recommend you use a traceable, insured delivery service. Cuisinart cannot be held responsible for in-transit damage or for packages that are not delivered to us. Lost and/or damaged products are not covered under warranty. Please be sure to include your return address, daytime phone number, description of the product defect, product model number (located on bottom of product), original date of purchase, and any other information pertinent to the product's return.

### CALIFORNIA RESIDENTS ONLY:

California law provides that for In-Warranty Service, California residents have the option of returning a nonconforming product (A) to the store where it was purchased or (B) to another retail store which sells Cuisinart products of the same type.

The retail store shall then, at its discretion, either repair the product, refer the consumer to an independent repair facility, replace the product, or refund the purchase price less the amount directly attributable to the consumer's prior usage of the product. If the above two options do not result in the appropriate relief to the consumer, the consumer may then take the product to an independent repair facility if service or repair can be economically accomplished. Cuisinart and not the consumer will be responsible for the reasonable cost of such service, repair, replacement, or refund for nonconforming products under warranty.

California residents may also, according to their preference, return nonconforming products directly to Cuisinart for repair, or if necessary, replacement, by calling our Consumer Service Center toll-free at 1-800-726-0190.

Cuisinart will be responsible for the cost of the repair, replacement, and shipping and handling for such products under warranty.

### BEFORE RETURNING YOUR CUISINART® PRODUCT

If you are experiencing problems with your Cuisinart product, we suggest that you call our Cuisinart Service Center at 1-800-726-0190 before returning the product for service. If servicing is needed, a Representative can confirm whether the product is under warranty and direct you to the nearest service location.

Your Cuisinart Baby® Bottle Warmer has been manufactured to the strictest specifications and has been designed for use only in 120-volt outlets and only with authorized accessories and replacement parts. This warranty expressly excludes any defects or damages caused by attempted use of this unit with a converter, as well as by use with accessories, replacement parts or repair service other than those authorized by Cuisinart. This warranty does not cover any damage caused by accident, misuse, shipment or other than ordinary household use. This warranty excludes all incidental or consequential damages. Some states do not allow the exclusion or limitation of these damages, so these exclusions may not apply to you. You may also have other rights, which vary from state to state.

Important: If the nonconforming product is to be serviced by someone other than Cuisinart's Authorized Service Center, please remind the servicer to call our Consumer Service Center at 1-800-726-0190 to ensure that the problem is properly diagnosed, the product is serviced with the correct parts, and the product is still under warranty.

# Cuisinart baby



Baby Food Maker  
& Bottle Warmer



Sterilizer



Juicers



Blenders



Tools and  
Gadgets

Cuisinart offers an extensive assortment of top quality products to make life in the kitchen easier than ever. Try some of our other countertop appliances, cookware, tools and gadgets.

**[www.cuisinart.com/baby](http://www.cuisinart.com/baby)**

**[www.cuisinart.com](http://www.cuisinart.com)**

©2012 Cuisinart  
150 Milford Road  
East Windsor, NJ 08520  
Printed in China

12CE131414

IB-11644



## Free Manuals Download Website

<http://myh66.com>

<http://usermanuals.us>

<http://www.somanuals.com>

<http://www.4manuals.cc>

<http://www.manual-lib.com>

<http://www.404manual.com>

<http://www.luxmanual.com>

<http://aubethermostatmanual.com>

Golf course search by state

<http://golfingnear.com>

Email search by domain

<http://emailbydomain.com>

Auto manuals search

<http://auto.somanuals.com>

TV manuals search

<http://tv.somanuals.com>