

## Professional Sealed Side Burners



*BGB132-BI Double Side Burners, Built-in (as shown)*

Every chef wants the option of preparing a delicious side dish to accompany a culinary masterpiece. For this, DCS offers Professional Sealed Side Burners for built-in application and for 30" grill cart mount application. Constructed of heavy stainless steel, DCS side burners rated at a powerful 17,000 Btu's, are available in single or double burner configurations. Features include battery ignition, stainless steel grate cover and, of course, the same sleek design as DCS professional grills.

### ADDITIONAL FEATURES:

- Stainless steel grate cover included
- Removable stainless steel drip tray
- Designer metal control knobs
- See page 43 for available configurations

## Outdoor Warming Drawer



*WD-27-SS-OD 27" Outdoor Warming Drawer (as shown)*

Keep cooked foods perfectly warm until dinner is completely ready with the DCS Outdoor Warming Drawer. Our warming drawer includes a removable stainless steel shelf. That means there is enough space for up to 6 standard-sized dinner plates. With an expansive 1.6 cubic feet of space, thermostatically controlled temperature ranges from 175 to 230 degrees, dinner will always be ready when you are.

### ADDITIONAL FEATURES:

- Removable stainless steel shelf/serving tray
- 500 watts of power input
- Outdoor UL approval

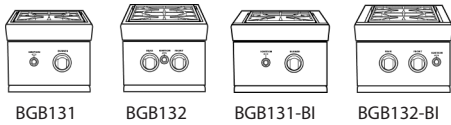

## Built-in Side Burner Dimensions

BGB131-BI Single Side Burner

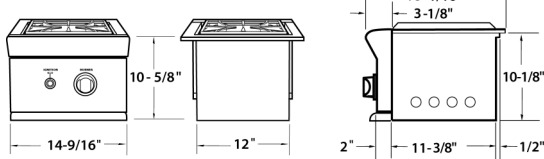

BGB132-BI Double Side Burner

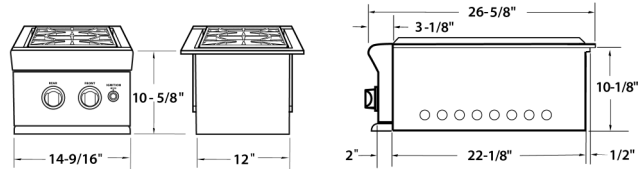

## 30" Cart Mount Side Burner Dimensions

BGB131 Single Side Burner

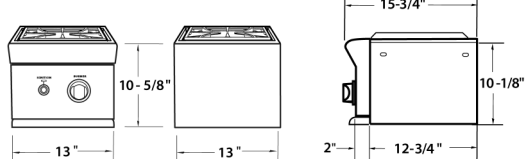

BGB132 Double Side Burner

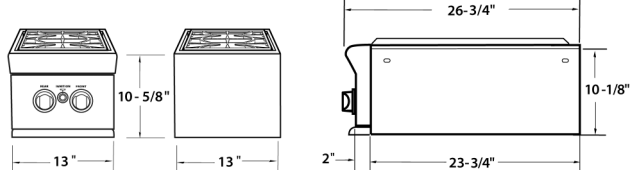

NOTE: Cart Mount Side Burners are not designed for built-in applications.

## Professional Side Burner Island Preparation

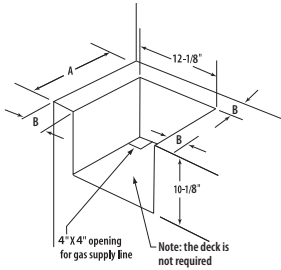

MODEL	A	B
BGB131-BI	12"	6" min.
BGB132-BI	22-3/8"	6" min.

MODEL NUMBER	BGB131	BGB131-BI	BGB132	BGB132-BI
30" CART MOUNT	✓		✓	
BUILT-IN		✓		✓
SIDE BURNER(S)	1 @ 17,000 Btu/hr	1 @ 17,000 Btu/hr	2 @ 17,000 Btu/hr	2 @ 17,000 Btu/hr
SHIPPING WEIGHT (LBS)	35.4	35.8	60.6	64.0
SHIPPING DIMENSIONS (HEIGHT X WIDTH X DEPTH)	13.5 x 14.5 x 19	13.5 x 14.5 x 19	16 x 18 x 30	16 x 18 x 30

Ordering Data: Please specify gas type (natural or propane) when ordering.

### Gas Requirements:

#### Natural

- 1/2" NPT male with a 3/8" flare adapter
- Operational Pressure: 4" W.C.
- Supply Pressure: 6" to 9" W.C.

#### Propane

- 1/2" NPT male with a 3/8" flare adapter
- Operational Pressure: 10" W.C.
- Supply Pressure: 11" to 14" W.C.

## Warming Drawer Dimensions

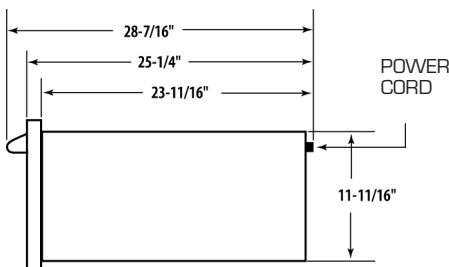
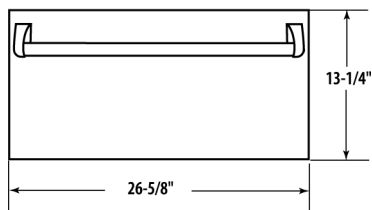

## Warming Drawer Island Preparation

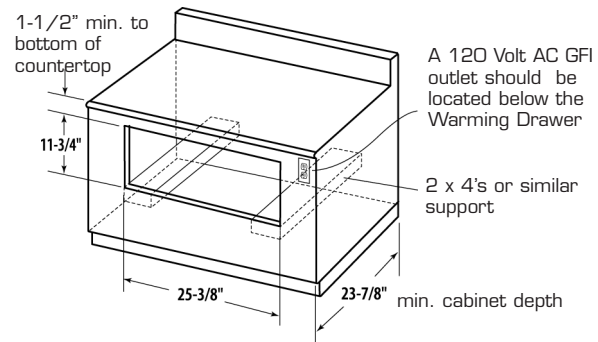

MODEL NUMBER	WD-27-SS-OD
DRAWER SPACE	1.6 CUBIC FEET
REMOVABLE SHELF/SERVING TRAY	✓
TYPE 304 STAINLESS STEEL	✓

### Power Requirements:

- 120V 60Hz
- 3 wire
- 15 amp circuit

## Free Manuals Download Website

<http://myh66.com>

<http://usermanuals.us>

<http://www.somanuals.com>

<http://www.4manuals.cc>

<http://www.manual-lib.com>

<http://www.404manual.com>

<http://www.luxmanual.com>

<http://aubethermostatmanual.com>

Golf course search by state

<http://golfingnear.com>

Email search by domain

<http://emailbydomain.com>

Auto manuals search

<http://auto.somanuals.com>

TV manuals search

<http://tv.somanuals.com>