



User's Guide CLOCK RADIO

DCR5000-P



QUICK REFERENCE

The Quick Reference is given to provide basic operation of the unit. Please completely read the user's guide to take advantage of all the features this unit has to offer.

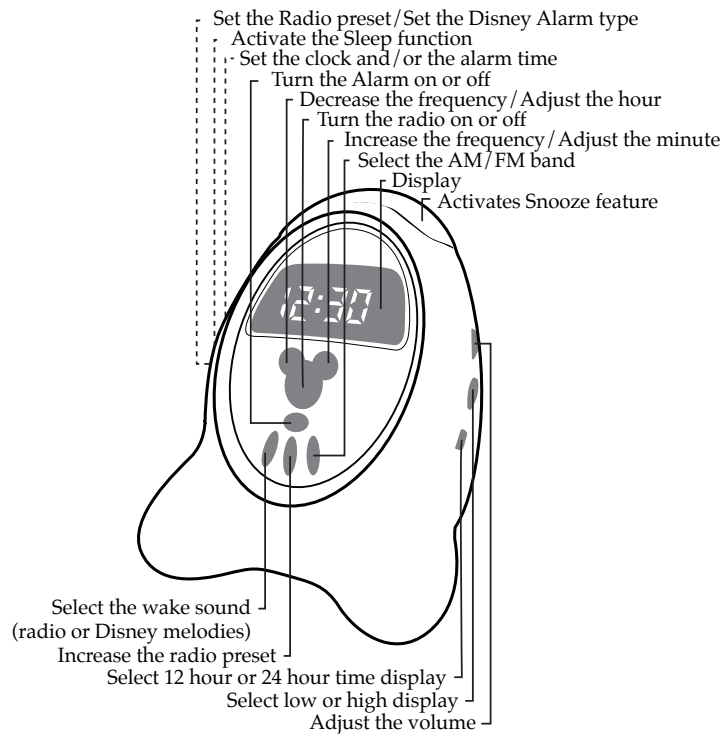

QUICK REFERENCE (CONTINUED)

TO LISTEN TO THE RADIO:

1. Press the Radio On/Off button to turn the unit on; the AM or FM indicator will light.
2. Press the AM/FM Band button to select AM or FM.
3. Tune a station by pressing the Tuning Up/Minute or Tuning Down/Hour button. Press and hold either button and the unit will scan and stop on the next strong station.
4. Adjust the volume using the Volume control.
5. Press the Radio On/Off button to turn the unit off.

TO SET OR RESET THE ACTUAL TIME:

1. With the unit off, press the Clock Set/Alarm Set button once to set the time; the Time indicator will light and the display will blink.
2. Press the Tuning Down/Hour button to set the hour and the Tuning Up/Minute button to set the minute. Make sure the appropriate AM/PM indicator is lit if using the 12 hour mode. Wait 10 seconds, or press the Clock Set/Alarm Set button twice and the time will be set.

TO SET OR RESET THE ALARM TIME:

1. With the unit off, press the Clock Set/Alarm Set button twice to set the alarm time; the Alarm On indicator will light and the display will blink.
2. Press the Tuning Down/Hour button to set the alarm hour and the Tuning Up/Minute button to set the alarm minute. Make sure the appropriate AM/PM indicator is lit if using the 12 hour mode. Wait 10 seconds, or press the Clock Set/Alarm Set button again and the alarm time will be set.

TO SET THE ALARM TO WAKE TO RADIO:

1. Set the alarm time as instructed above. Select a radio station and make sure the Volume control is set as desired.
2. Press the Alarm On/Off button once and the Alarm On and Radio (Alarm) indicators will light. When the actual time matches the selected preset alarm time, the radio will automatically turn on.
3. Press the Alarm On/Off button to turn off the alarm.

TO SET THE ALARM TO WAKE TO DISNEY ALARM:

1. Follow steps 1 and 2 in TO SET THE ALARM TO WAKE TO RADIO above.
2. Press the Alarm Type button repeatedly to cycle through the five Disney alarm choices. Press the Radio Preset Set/Disney Alarm Type button to confirm. When the actual time matches the selected preset alarm time, the selected tone will play.
3. Press the Alarm On/Off button to turn off the alarm.

Disney Elements © Disney

SAFETY PRECAUTIONS



DANGEROUS VOLTAGE:

The lightning flash with arrowhead symbol, within an equilateral triangle is intended to alert the user to the presence of uninsulated dangerous voltage within the product's enclosure that may be of sufficient magnitude to constitute a risk of electric shock to persons.



ATTENTION:

The exclamation point within an equilateral triangle is intended to alert the user to the presence of important operating and maintenance (servicing) instructions in the literature accompanying the appliance.



CAUTION
RISK OF ELECTRIC SHOCK
DO NOT OPEN



CAUTION: TO REDUCE THE RISK OF ELECTRIC SHOCK, DO NOT REMOVE COVER (OR BACK). NO USER-SERVICEABLE PARTS INSIDE. REFER SERVICING TO QUALIFIED SERVICE PERSONNEL.

- Place the unit on a stable surface.
- Avoid installing the unit in locations described below:
 - Places exposed to direct sunlight or close to heat radiating appliances such as electric heaters.
 - On top of other stereo equipment that radiates too much heat.
 - Places lacking ventilation or dusty places.
 - Places subject to constant vibration.
 - Humid or moist places.

SURGE PROTECTORS:

It is recommended to use a surge protector for AC connection. Lightning and power surges ARE NOT covered under warranty for this product.

IMPORTANT SAFETY INSTRUCTIONS

Before using the unit, be sure to read all operating instructions carefully. Please note that these are general precautions and may not pertain to your unit. For example, this unit may not have the capability to be connected to an outdoor antenna.

1. READ INSTRUCTIONS

All the safety and operating instructions should be read before the product is operated.

2. RETAIN INSTRUCTIONS

The safety and operating instructions should be retained for future reference.

3. HEED WARNINGS

All warnings on the product and in the operating instructions should be adhered to.

4. FOLLOW INSTRUCTIONS

All operating and use instructions should be followed.

5. CLEANING

Unplug this product from the wall outlet before cleaning. Do not use liquid cleaners or aerosol cleaners. Use a damp cloth for cleaning.

6. ATTACHMENTS

Do not use attachments not recommended by the product's manufacturer as they may cause hazards.

7. WATER AND MOISTURE

Do not use this product near water- for example, near a bathtub, washbowl, kitchen sink, or laundry tub, in a wet basement, or near a swimming pool.

8. ACCESSORIES

Do not place this product on an unstable cart, stand, tripod, bracket, or table. The product may fall, causing serious injury and serious damage to the product. Use only with a cart, stand, tripod, bracket, or table recommended by the manufacturer or sold with the product. Any mounting of the product should follow the manufacturer's instructions, and should use a mounting accessory recommended by the manufacturer.

8A. An appliance and cart combination should

be moved with care. Quick stops, excessive force, and uneven surfaces may cause the appliance and cart combination to overturn.



9. VENTILATION

Slots and openings in the cabinet and in the back or bottom are provided for ventilation and to ensure reliable operation of the product and to protect it from overheating. These openings must not be blocked or covered. The openings should never be blocked by placing the product on a bed, sofa, rug, or other similar surface. This product should never be placed near or over a radiator or heat source. This product should not be placed in a built-in installation such as a bookcase or rack unless proper ventilation is provided or the manufacturer's instructions have been adhered to.

10. POWER SOURCES

This product should be operated only from the type of power source indicated on the marking label. If you are not sure of the type of power supply to your home, consult your appliance dealer or local power company. For products intended to operate from battery power, or other sources, refer to the operating instructions.

11. GROUNDING OR POLARIZATION

This product is equipped with a polarized alternating-current line plug (a plug having one blade wider than the other). This plug will fit into the power outlet only one way.

This is a safety feature. If you are unable to insert the plug fully into the outlet, try reversing the plug. If the plug should still fail to fit, contact your electrician to replace your obsolete outlet. Do not defeat the safety purpose of the polarized plug.

12. POWER-CORD PROTECTION

Power-supply cords should be routed so that they are not likely to be walked on or pinched by items placed upon or against them, paying particular attention to cords at plugs, convenience receptacles, and the

IMPORTANT SAFETY INSTRUCTIONS

- point where they exit from the appliance.
13. **LIGHTNING**
To protect your product from a lightning storm, or when it is left unattended and unused for long periods of time, unplug it from the wall outlet and disconnect the antenna or cable system. This will prevent damage to the product due to lightning and power-line surges.
 14. **POWER LINES**
An outside antenna system should not be located in the vicinity of overhead power lines or other electric light or power circuits, or where it can fall into such power lines or circuits. When installing an outside antenna system, extreme care should be taken to keep from touching such power lines or circuits as contact with them might be fatal.
 15. **OVERLOADING**
Do not overload wall outlets and extension cords as this can result in a risk of fire or electric shock.
 16. **OBJECT AND LIQUID ENTRY**
Never push objects of any kind into this product through openings as they may touch dangerous voltage points or short out parts that could result in fire or electric shock. Never spill or spray any type of liquid on the product.
 17. **SERVICING**
Do not attempt to service this product yourself as opening or removing covers may expose you to dangerous voltage or other hazards. Refer all servicing to qualified service personnel.
 18. **REPLACEMENT PARTS**
When replacement parts are required, be sure the service technician uses replacement parts specified by the manufacturer or those that have the same characteristics as the original part. Unauthorized substitutions may result in fire, electric shock or other hazards.
 19. **SAFETY CHECK**
Upon completion of any service or repairs to this product, ask the service technician to perform safety checks to determine that the product is in proper operating condition.
 20. **WALL OR CEILING MOUNTING**
The product should be mounted to a wall or ceiling only as recommended by the manufacturer.
 21. **DAMAGE REQUIRING SERVICE**
Unplug the product from the wall outlet and refer servicing to qualified service personnel under the following conditions:
 - a. When the power-supply cord or plug is damaged.
 - b. If liquid has been spilled, or objects have fallen into the product.
 - c. If the product has been exposed to rain or water.
 - d. If the product does not operate normally by following the operating instructions. Adjust only those controls that are covered by the operating instructions, as an adjustment of other controls may result in damage and will often require extensive work by a qualified technician to restore the product to its normal operation.
 - e. If the product has been dropped or the cabinet has been damaged.
 - f. When the product exhibits a distinct change in performance - this indicates a need for service.
 22. **HEAT**
The product should be situated away from heat sources such as radiators, heat registers, stoves, or other products (including amplifiers) that produce heat.
 23. **NOTE TO CATV SYSTEM INSTALLER**
This reminder is provided to call the CATV system installer's attention to Article 820-40 of the NEC that provides guidelines for proper grounding and, in particular, specifies that the cable ground shall be connected to the grounding system of the building, as close to the point of cable entry as practical.
 24. **NONUSE PERIODS**
The power cord of the appliance should be unplugged from the outlet when left unused for a long period of time.

LOCATION OF CONTROLS

RIGHT

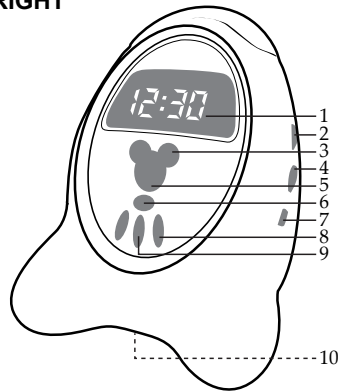

LEFT

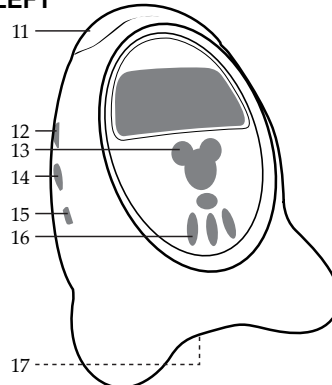

1. Display
2. Volume Control
3. Tuning Up/Minute Button
4. Display Low/High Button
5. Radio On/Off Button
6. Alarm On/Off Button
7. Display (12/24hr) Switch
8. AM/FM Band Button
9. Radio Preset Up Button
10. Battery Compartment (Bottom of Unit)

11. Snooze Button
12. Clock Set/Alarm Set Button
13. Tuning Down/Hour Button
14. Sleep Button
15. Radio Preset Set/Disney Alarm Type Button
16. Alarm Type Button
17. FM Antenna Wire (Bottom of Unit)

DISPLAY

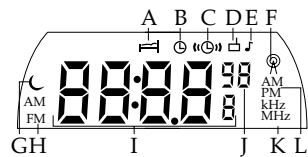

- | | |
|------------------|--------------------|
| A. Snooze | H. AM/FM |
| B. Time | I. Clock and Timer |
| C. Alarm On | J. Preset Number |
| D. Radio (Alarm) | K. MHz/kHz |
| E. Music (Alarm) | L. AM/PM |
| F. Preset | |
| G. Sleep | |

INSTALLATION

Unravel the AC cord and connect it to a conveniently located AC outlet having 120V and 60Hz only. The Clock Display will illuminate and "0:00" or "12:00" will blink in the window.

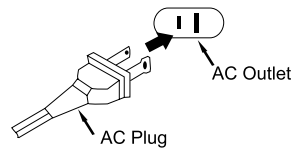

NOTE: If the AC plug does not fit into a nonpolarized outlet, do not file or cut the wide blade. It is the user's responsibility to have an electrician replace the obsolete outlet.

If the AC cord is disconnected or if there is a power failure, this electronic clock is designed to continue operating internally (without showing the time on the Clock Display) with two (2) AAA size batteries (not included).

To install the batteries:

- Remove the battery compartment door by inserting a small screwdriver, paper clip or similar item into the tab while gently pushing to remove.
- Insert two (2) AAA size batteries into the battery compartment. Be sure to observe the polarity markings which are engraved inside the battery compartment. If the batteries are inserted incorrectly, the unit will not operate.
- Replace the battery compartment door.

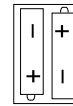

Be sure to check the condition of the batteries periodically by disconnecting the AC cord and connecting it again two or three minutes later. The preset times should continue operating. If the present time does not appear, it indicates the battery is dead or not connected properly.

BATTERY PRECAUTIONS

Follow these precautions when using batteries in this device:

1. Use only the size and type of batteries specified.
2. Be sure to follow the correct polarity when installing the batteries as indicated next to the battery compartment. Reversed batteries may cause damage to the device.
3. Do not mix different types of batteries together (e.g. Alkaline and Carbon-zinc) or old batteries with fresh ones.
4. If the device is not to be used for a long period of time, remove the batteries to prevent damage or injury from possible battery leakage.
5. Do not try to recharge batteries not intended to be recharged; they can overheat and rupture. (Follow battery manufacturer's directions.)

OPERATION

TO LISTEN TO THE RADIO

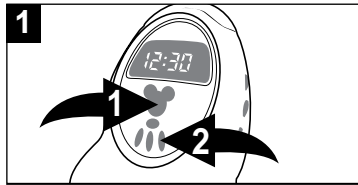

Press the Radio On/Off button ❶ to turn the unit on; the AM or FM indicator will light. Press the AM/FM Band button ❷ to select AM or FM.

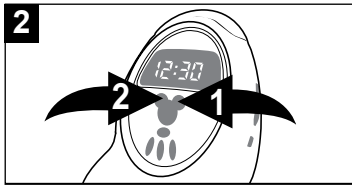

Tune a station by pressing the Tuning Up/Minute ❶ or Tuning Down/Hour ❷ button. Press and hold either button and the unit will scan and stop on the next strong station.

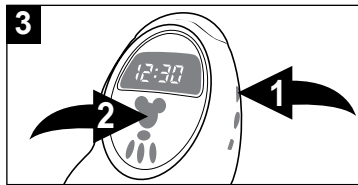

Adjust the volume using the Volume control ❶. Press the Radio On/Off button ❷ to turn the unit off.

Antennas

FM: Extend the FM antenna wire (located in the battery compartment) for best reception.

AM: Turn the unit for better AM reception.

SETTING RADIO PRESETS (10 FOR EACH BAND)

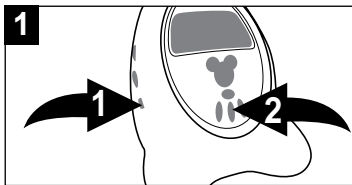

Tune a station as described in steps 1 and 2 above, then press the Radio Preset Set/Disney Alarm Type button ❶ once; the Preset Number will blink. Press the Radio Preset Up button ❷ to select a radio preset number, then press the Radio Preset Set/Disney Alarm Type button ❶ again to confirm and the radio preset will be set.

OPERATION (CONTINUED)

TO RECALL RADIO PRESETS

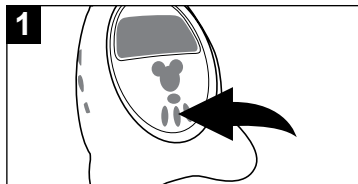

1
To recall a Radio Preset, press the Radio Preset Up button repeatedly until the desired Radio Preset appears in the display.

TO USE THE 12/24 HOUR SWITCH

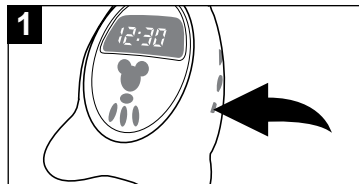

1
To set this unit for standard 12 hour clock format, slide this switch to the 12HR position. To set the clock for "military time", slide it to the 24HR position.

NOTE: Once a radio frequency is selected, the display will revert to the time display after 10 seconds.

TO SET OR RESET THE ACTUAL TIME

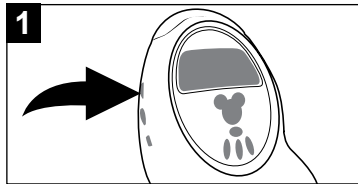

1
With the unit off, press the Clock Set/Alarm Set button once to set the time; the Time indicator will light and the display will blink.

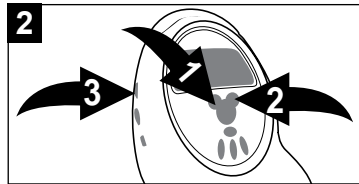

2
Press the Tuning Down/Hour button ① to set the hour and the Tuning Up/Minute button ② to set the minute. Make sure the appropriate AM/PM indicator is lit if using the 12 hour mode. Wait 10 seconds, or press the Clock Set/Alarm Set button ③ twice and the time will be set.

OPERATION (CONTINUED)

TO SET OR RESET THE ALARM TIME

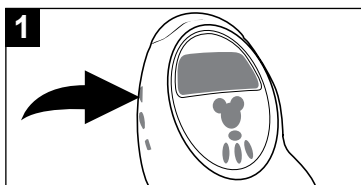

With the unit off, press the Clock Set/Alarm Set button twice to set the alarm time; the Alarm On indicator and the display will blink.

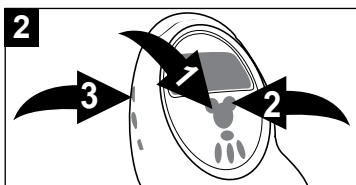

Press the Tuning Down/Hour button ❶ to set the alarm hour and the Tuning Up/Minute button ❷ to set the alarm minute. Make sure the appropriate AM/PM indicator is lit if using the 12 hour mode. Wait 10 seconds, or press the Clock Set/Alarm Set button ❸ again and the time will be set.

TO SET THE ALARM TO WAKE TO RADIO

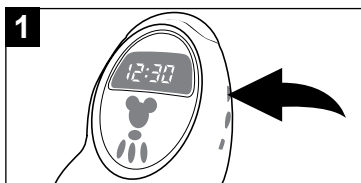

Set the alarm time as previously instructed. Select a radio station as described on page 8 and make sure the Volume control is set as desired.
NOTE: To avoid having the volume set too low that it cannot be heard when the alarm sounds, this unit will automatically set the volume to a preset level as needed.



Press the Alarm On/Off button and the Alarm On and Radio (Alarm) indicators will light. When the actual time matches the selected preset alarm time, the radio will automatically turn on.
To shut off the alarm, see TO SHUT THE ALARM OFF section on the next page.

OPERATION (CONTINUED)

TO SET THE ALARM TO WAKE TO DISNEY ALARM MUSIC



Set the alarm time as previously instructed. Press the Alarm On/Off button and the Alarm On and Radio (Alarm) indicators will light.

NOTE: To avoid having the volume set too low that it cannot be heard when the alarm sounds, this unit will automatically set the volume to a preset level as needed.

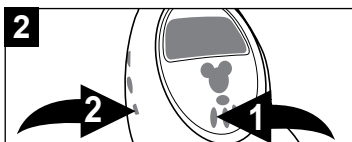

Press the Alarm Type button ❶ repeatedly to cycle through the five Disney alarm choices. Press the Radio Preset Set/Disney Alarm Type button ❷ to confirm. When the actual time matches the selected preset alarm time, the selected tone will play. To shut off the alarm, see TO SHUT THE ALARM OFF section below.

TO SHUT THE ALARM OFF



To shut the alarm off, press the Alarm On/Off button once to turn off the alarm and not set it for the next day. Press the Alarm On/Off button again until the Alarm On indicator lights and the alarm time will be reset for the next day.

SNOOZE



The alarm can be temporarily turned off manually by pressing the Snooze button; the alarm will turn back on automatically 10 minutes later. The Snooze indicator will light when Snooze is activated.

OPERATION (CONTINUED)

TO ACTIVATE THE SLEEP FUNCTION

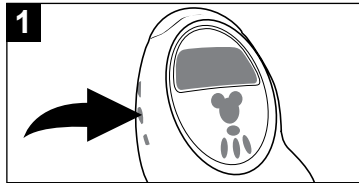

Tune the desired radio station as described on page 8. Press the Sleep button; the Sleep indicator will light and "10" will appear on the clock display, then release the button. The unit will turn on for 10 minutes and then turn off.

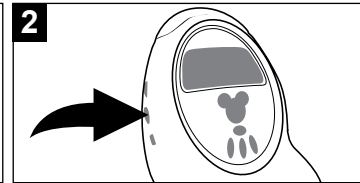

To adjust the sleep time up to 90 minutes in 10 minute intervals, repeatedly press the Sleep button.

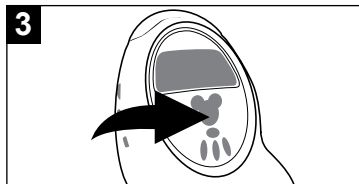

To cancel Sleep, press the Radio On/Off button.

DISPLAY LOW/HIGH

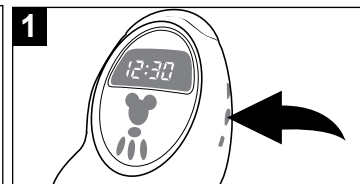

This unit has two levels of brightness for the display. Repeatedly press the Display Low/High button until the desired brightness appears in the display.

TROUBLESHOOTING GUIDE

Should this unit exhibit a problem, check the following before seeking service:

SYMPTOM	POSSIBLE CAUSE	POSSIBLE SOLUTION
GENERAL		
Power does not come on.	AC line cord not plugged in.	Insert plug firmly into AC outlet.
RADIO		
No sound.	Radio On/Off button was not pressed.	Press the Radio On/Off button to turn the unit on.
	Volume control at minimum position.	Increase the volume.
Noise or sound distorted on AM or FM.	AM - Interference from traffic.	Turn the radio for better AM reception.
	FM - Antenna Wire not extended.	Extend Antenna Wire.
CLOCK		
Flashing time.	Batteries connected improperly, not connected or dead.	Check the batteries and replace if necessary.
	Clock not set.	Set the clock.
Alarm does not turn on.	Alarm On/Off button is not pressed.	Press the Alarm On/Off button until the Alarm On indicator lights.
	Clock is not set.	Set the clock.
	Alarm time not set.	Set alarm time.

For additional set-up or operating assistance, please visit our website at www.memorexelectronics.com or contact customer service at 1-877-DISNYCE (1-877-347-6923).

Please keep all packaging material for at least 90 days in case you need to return this product to your place of purchase or Memcorp.

For parts and accessories, contact Fox International at 1-800-321-6993.

Distributed by Memcorp Inc., Weston Fl
Disney Elements © Disney 2003.

Free Manuals Download Website

<http://myh66.com>

<http://usermanuals.us>

<http://www.somanuals.com>

<http://www.4manuals.cc>

<http://www.manual-lib.com>

<http://www.404manual.com>

<http://www.luxmanual.com>

<http://aubethermostatmanual.com>

Golf course search by state

<http://golfingnear.com>

Email search by domain

<http://emailbydomain.com>

Auto manuals search

<http://auto.somanuals.com>

TV manuals search

<http://tv.somanuals.com>