



FlexScan® L680

46 cm (18.1 inch) TFT LCD Monitor



FlexScan® L680

The L680 presents the ultimate solution for professionals in stock bourses, banks, dealing rooms, and medical environments seeking a high-end, large screen LCD monitor. Ultra-wide viewing angles, a USB hub, and removable panel make the L680 the most versatile LCD available today.

46 cm (18.1 inch) TFT LCD Monitor

Basic Specifications

The L680 features a TFT active matrix panel which can support resolutions ranging from VGA 640 × 1480 to SXGA 1280 × 11024. Lifelike color, text clarity, and high contrast come with no geometric distortion.

Wide Viewing Angles

Comfortable viewing from almost any position with minimum deviation in color and image quality is guaranteed with ultra-wide viewing angles of 170 degrees both horizontally and vertically.



Expanded and Full Screen Modes

The L680 includes a scaling function so resolutions less than 1280 × 11024 can now be scaled to an expanded mode to fill most of the screen (4:3 horizontal-vertical ratio) or to a full screen mode (5:4 ratio).

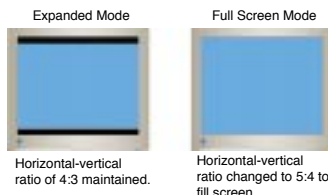

Smoothing Function

A smoothing function with adjustments in five gradations for both the expanded and full screen modes minimizes blurring and jagged edges which may occur in the scaling process.

Flexible Design

Multiple configurations are now possible with a panel that can be removed from the base and follows the VESA industry standard for mounting on an arm or a wall. Additionally, the power unit is located inside of the panel, eliminat-

ing the space consuming external power unit characteristic of many other LCDs.

Ergonomics and the Environment

The L680 complies with the most stringent ergonomic and environmental standards including TCO'99, the CE Mark, TÜV Rheinland/Ergonomie Geprüft, and the EPA ENERGY STAR® Program.



i-Sound™ Sound Unit

For multimedia applications, EIZO offers the *i-Sound*, a separately sold speaker unit which attaches seamlessly to the bezel of the L680. The *i-Sound* is equipped with two speakers, two stereo mini-jack cables, and a microphone.

Advanced Functions

- Auto contrast level function to adjust the input signal for proper display of color gradations.
- Auto adjustment button to center the displayed image and eliminate the need for preset timings.
- Slot for Kensington's MicroSaver® security system is included on the panel.
- Two video input terminals for simultaneous attachment of two computers to the L680.
- USB hub with one upstream port and four downstream ports.
- PowerManager™ and off timer functions to reduce energy consumption to under 3 watts during periods of inactivity.



FlexScan® L680 Specifications

Panel size	46 cm (18.1 inch)
	TFT Color LCD Panel
Pixel Pitch	0.280 mm × 0.280 mm
Display Colors	16.7 million colors
Viewing Angle	Horizontal: 170 degrees Vertical: 170 degrees
Scanning Frequency	H: 27 - 82 kHz, V: 50 - 85 Hz (Up to 75 Hz at 1280 × 1024)
Brightness	200 cd/m ²
Contrast Ratio	300:1 (typical)
Input Signals	RGB Analog
Input Terminals	D-Sub mini 15 pin × 2 (switchable)
Active Display Size	359 mm × 287 mm
Viewable Image Size	Diagonal: 459 mm
Recommended Resolution	1280 dots × 1024 lines
Plug & Play ¹	VESA DDC 1/2B
Screen Control	ScreenManager® & One Touch Auto Adjustment Function
Power Management System	VESA DPMS, EIZO MPMS ²
Power Consumption	67 W (typical)
Power Save Mode	Less than 3 W
Dimensions	430 mm (W) × 455 mm (H) × 218 mm (D) (with base) 430 mm (W) × 375 mm (H) × 97 mm (D) (panel only)
Net Weight	7.4 kg (with base) 5.8 kg (panel only)
Safety Standards	TÜV Rheinland/GS, CB, CE Mark
Ergonomic/Environmental Standards	TÜV Rheinland/Ergonomie Geprüft (including ISO 9241-3, -7 [Positive/Class I, Negative/ Class I], and -8 and MPR-II), EPA ENERGY STAR® Program, Energy 2000, TCO'99
USB Standard ³	USB Standard Rev. 1.1
USB Ports	1 upstream port (for computer or another hub), 4 downstream ports (for peripherals)

¹ Only valid when computer system supports all Plug & Play functions (personal computer, graphics board, Windows® 95/98/2000). For more details, please refer to the Windows 95/98/2000, personal computer, and graphics board manuals or contact the manufacturers.
² EIZO MPMS is a power management system developed by EIZO to replace Swedish NUTEK which was discontinued at the end of 1997.
³ Not all computers, operating systems, or peripherals may be compatible with the USB interface.

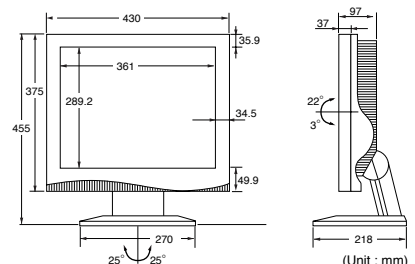

Specifications are subject to change without notice.

ENERGY STAR® is a U.S. registered mark. As an ENERGY STAR® Partner, Eizo Nanao Corporation has determined that this product meets the ENERGY STAR® guidelines for energy efficiency. Copyright © 1999 Eizo Nanao Corporation. All rights reserved. All product names are trademarks of their respective companies. PowerManager, and *i-Sound* are trademarks, and FlexScan, EIZO, and ScreenManager are registered trademarks of Eizo Nanao Corporation.



EIZO NANA O CORPORATION

655 Fukudome, Matto, Ishikawa 924-8533 Japan

Phone : +81 76 277-3310 Fax : +81 76 277-3450

http://www.eizo.co.jp/

Download from www.Somanuals.com. All Manuals Search And Download.

Free Manuals Download Website

<http://myh66.com>

<http://usermanuals.us>

<http://www.somanuals.com>

<http://www.4manuals.cc>

<http://www.manual-lib.com>

<http://www.404manual.com>

<http://www.luxmanual.com>

<http://aubethermostatmanual.com>

Golf course search by state

<http://golfingnear.com>

Email search by domain

<http://emailbydomain.com>

Auto manuals search

<http://auto.somanuals.com>

TV manuals search

<http://tv.somanuals.com>