

LIMITED WARRANTY:

This appliance shall be free from defects in materials and workmanship under normal home use for a period of one year from the date of receipt. During that period, defects will be repaired or the product will be replaced at the manufacturer's option without charge.

This warranty does not cover any failure which results from alteration, accident, misuse, abuse, neglect, commercial use or improper maintenance as published in our use and care book. Incidental or consequential damages are not covered by this guarantee.

This guarantee expressly excludes glass and thermal Carafes broken by accident or misuse. However, replacements can easily be ordered by calling Gevalia Kaffe Imports Service at 1-800-438-2542.

This warranty gives you specific legal rights, and you may also have other rights which vary from state to state.

FOR SERVICE:

Call the Gevalia Kaffe Import Service 1-800-438-2542 for further information on your Coffeemaker. Gevalia Kaffe is only available through the Gevalia Kaffe Import Service. To place an order or obtain additional information:

**Call us toll free at:
1-800-GEVALIA
(1-800-438-2542)**

NOTE: When calling, please have the unit model # (located on page 1) and the date code (located on the bottom of the Coffeemaker) ready.

REVISED: JUNE 2007



GEVALIA®

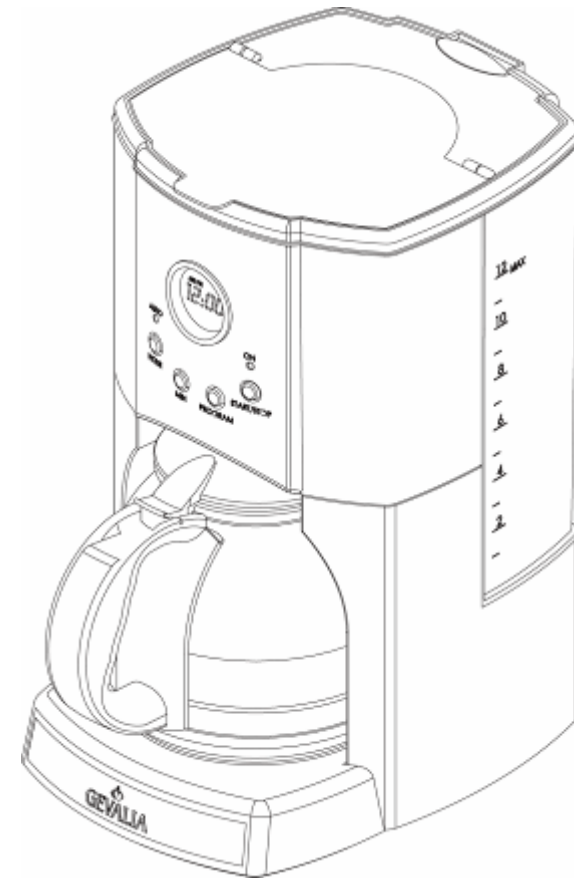

Programmable 12-Cup Coffeemaker

HOUSEHOLD USE ONLY

Model # XCE8

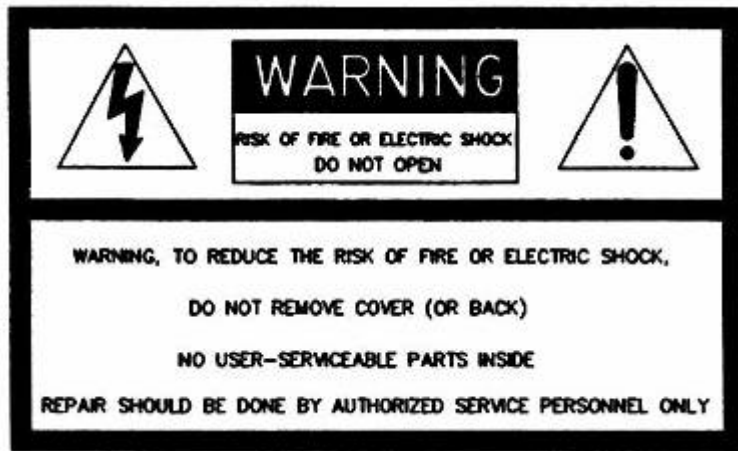

SA1965

The lightning flash with arrowhead symbol, within an equilateral triangle, is intended to alert the user to the presence of uninsulated "dangerous voltage" within the product's enclosure that may be of sufficient magnitude to constitute a risk of fire or electric shock to persons.



The exclamation point within an equilateral triangle is intended to alert the user to the presence of important operating and maintenance (servicing) instructions in the literature accompanying the appliance.

IMPORTANT SAFEGUARDS (Model XCE8)

When using electrical appliances, basic safety precautions should always be followed:

1. Read all instructions carefully.
2. Do not touch hot surfaces.
3. To protect against the risk of fire, electric shock, or personal injury, do not place cord, plug or unit in water or other liquids.

4. Should not be used by children.
5. Unplug from outlet when not in use and before cleaning. Allow to cool before replacing or taking off parts, and before cleaning.
6. Do not operate any appliance with a damaged cord or plug, or after the appliance malfunctions, is dropped, or has been damaged in any manner.
7. The use of accessory attachments is not recommended by the manufacturer for it may cause injury to the user.
8. Do not use outdoors.
9. Do not let cord hang over edge of table or counter, or touch hot surfaces.
10. Do not place on or near a hot gas or electric burner, or in a heated oven.
11. Always plug the cord into the wall outlet before turning on any controls. To disconnect, make sure the power is off (the ON light will not be illuminated), then remove the plug from the wall outlet.
12. Always use cold filtered or bottled water for best results. Warm water or other liquids could cause damage to the Coffeemaker.
13. TURN OFF THE UNIT AND WAIT AT LEAST 30 MINUTES AFTER THE BREW CYCLE IS COMPLETED BEFORE OPENING THE FILTER BASKET LID. IF YOU DO NOT, SOME STEAM MAY BE RELEASED FROM THE SHOWER HEAD WHEN YOU OPEN THE FILTER BASKET LID. THIS COULD CAUSE INJURY TO THE USER.
14. Scalding may occur if the Filter Basket Lid is lifted or removed during the brewing cycle.
15. Never use the Glass Carafe on a range top or in a conventional or microwave oven.
16. Do not set a hot Glass Carafe on a wet or cold surface.
17. Do not use a cracked Glass Carafe or a Glass Carafe that has a loose or weakened handle.
18. Do not clean the Coffeemaker with scouring powders, steel wool pads, or other abrasive materials.
19. Do not use this appliance for other than its intended use.
20. Do not put ice cubes in the Glass Carafe.

WARNING: TO REDUCE THE RISK OF FIRE OR ELECTRIC SHOCK, DO NOT REMOVE THE BOTTOM COVER. NO USER SERVICEABLE PARTS INSIDE.

CAUTION: DO NOT IMMERGE THE UNIT IN ANY LIQUID

WARNING: To avoid damage or injury from the Glass Carafe, please follow these precautions:

1. The Glass Carafe is designed for use with this appliance only. Never use the Glass Carafe on a range top or in a conventional or microwave oven.
2. Do not set a hot Glass Carafe on a wet or cold surface.
3. Discard the Glass Carafe if damaged in any manner or if the Glass Carafe has a loose or weakened handle. A chip or crack could result in breakage or contaminate the liquid contents with glass particles.
4. Do not clean the Glass Carafe or Coffeemaker with scouring powders, steel wool pads, or other abrasive materials. Do not insert your hand or other objects into the Glass Carafe. Please clean your Glass Carafe by rinsing it out with warm soapy water.
5. This Glass Carafe is designed to be used with this Coffeemaker only.
6. Do not use this appliance for other than its intended use.

SAVE THESE INSTRUCTIONS
Household Use Only

SAFETY FEATURES

1. A short power-supply cord is provided to reduce the hazards resulting from entanglement or tripping over a longer cord.
2. An extension cord may be used if care is exercised in its use.
3. If an extension cord is used, the marked electrical rating of the extension cord should be at least as great as the electrical rating of the appliance. The extension cord should be arranged so that it does not drape over the counter or table-top where it can be pulled on by children or tripped over accidentally. The electrical rating of the Coffeemaker is listed on the bottom panel of the unit.

4. As a safety feature, this appliance has a polarized alternating current plug (one blade is wider than the other). To reduce the risk of electric shock, this plug will fit in a polarized outlet only one way. If the plug does not insert fully in the outlet, reverse the plug. **Do not attempt to defeat this safety feature.**

Coffeemaker Parts Illustration: (Figure A)

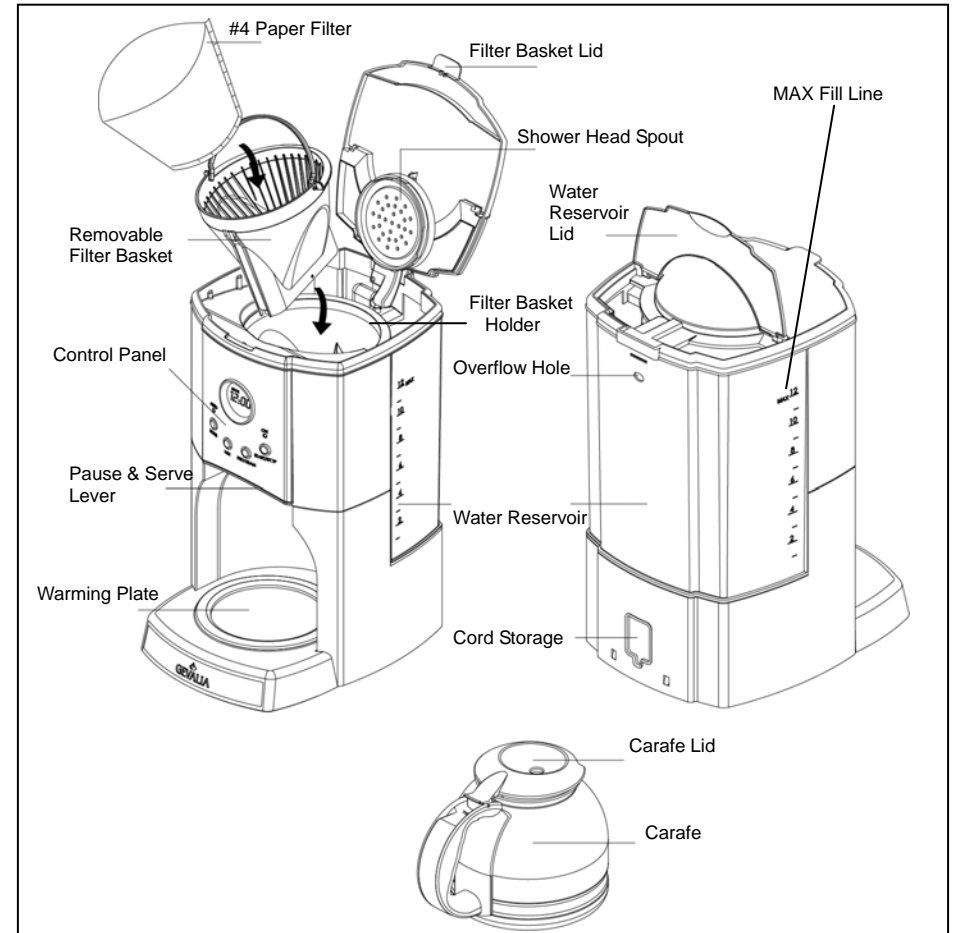

FEATURES

- **Pause & Serve:** Allows you to interrupt the brewing cycle and pour a cup of coffee before the entire brewing cycle is completed.

CAUTION:

While this will temporarily stop the coffee from dripping into the Glass Carafe, it does not stop the brewing cycle. After serving, the Glass Carafe should be immediately returned to the Warming Plate to prevent the Filter Basket from overflowing. Do not remove the Carafe for more than 30 seconds as the Filter Basket may overflow.

CAUTION:

If the Carafe is not fully seated on the Warming Plate, the Pause & Serve feature will not function properly. This could cause hot water or hot coffee to overflow.

When the Carafe is securely in place, it engages a lever which allows the coffee to drip. Please make sure that the Glass Carafe is securely in place and positioned firmly on the Warming Plate.

- **2 Hour Automatic Shut-Off:** For safety, this Coffeemaker has been designed with an auto shut-off feature. In both regular and auto-start modes, the Coffeemaker shuts off automatically 2 hours after the brewing cycle is completed.
- **On Light:** The “ON” light lets you know when the Coffeemaker is on for safe operation (will be illuminated green). Press the Start/Stop button twice for the brew cycle to begin.
- **Programmable Timer Light:** The “AUTO” light lets you know when the Coffeemaker is set to start brewing at the programmed time (will be illuminated red). Press the Start/Stop button once to initiate the Programmable Timer. The light will illuminate red (See the SETTING YOUR CLOCK AND USING THE PROGRAMMABLE TIMER section).

- **Cord Storage:** Hidden cord storage allows you to hide excess cord for a neat appearance.
- **Flip Top Open Filter Basket Holder:** Allows easy access to the Removable Filter Basket.

CAUTION:

ALWAYS TURN OFF THE UNIT AND WAIT AT LEAST 30 MINUTES AFTER THE BREWING CYCLE IS COMPLETED BEFORE OPENING THE FILTER BASKET LID. IF YOU DO NOT, SOME STEAM MAY BE RELEASED FROM THE SHOWER HEAD WHEN YOU OPEN THE FILTER BASKET LID. THIS COULD CAUSE INJURY TO THE USER.

- **Removable Cone Shape Filter Basket:** Cone shaped Filter Basket enriches flavor. We recommend using a Gevalia No. 4 cone shaped paper filter.
- **Shower Head Spout:** This allows the hot water to be evenly dispersed across the cone shaped filter thereby allowing the maximum flavor extraction.
- **Programmable Clock:** Allows you to program your Coffeemaker 24 hours in advance with a built in digital timer/clock.
- **Heat Resistant Glass Carafe:** The Glass Carafe is made of heat resistant glass to allow the coffee to stay hot for a prolonged period of time.

NOTE: Please remember that the liquid inside the Glass Carafe is HOT. Please be careful when pouring.

HOW TO USE YOUR COFFEEMAKER

PREPARING YOUR COFFEEMAKER FOR USE:

- Carefully unpack the Coffeemaker and remove all packing materials.
- Before making coffee in your Coffeemaker, thoroughly clean your Glass Carafe, Carafe Lid and Removable Filter Basket with warm soapy water. Rinse and dry. Do not use harsh or abrasive cleaners.
- You may wipe the Warming Plate with a clean damp cloth, however, do not immerse the Coffeemaker in water or other liquids.

Note: Prior to brewing your first pot of Gevalia coffee, we recommend that you run one brew cycle through the Coffeemaker using cold water only, without ground coffee or a paper filter. This will remove any dust that may have settled inside the Coffeemaker.

IMPORTANT: Use only cold filtered or bottled water for best results.

FILLING THE WATER RESERVOIR:

Open the hinged Water Reservoir Lid that is located on the top backside of the Coffeemaker (See Figure A). Fill the Water Reservoir with the desired amount of cold filtered or bottled water. Refer to the indicator markings on the side of the Water Reservoir to see how much water is inside it. Do not exceed the MAX Fill Line indicated on the Water Reservoir (See Figure A).

NOTE:

- There is an Overflow Hole in the back of the Water Reservoir to prevent exceeding the capacity of the Coffeemaker. If you add too much water, it will drip out from the back of the unit.
- The amount of brewed coffee after the brewing process will always be slightly less than the amount of water placed into the Coffeemaker, since some water will be absorbed by the coffee grounds.

SETTING YOUR CLOCK AND USING THE PROGRAMMABLE TIMER:



Figure B

SETTING YOUR CLOCK:

- To set the hour: Press the HOUR button repeatedly until desired hour is set.
- **Note:** Be sure to check that the AM/PM indicator, located in the top left side of the digital clock display, is also set to the correct time of day.
- To set the minutes: Press the MIN button repeatedly until desired minutes are set.

NOTE: Unplugging the unit will reset the clock to 12:00.

SETTING YOUR PROGRAMMABLE TIMER:

- Hold down the PROGRAM button.
- **NOTE:** When you are holding down the PROGRAM button, the word BREW will appear in the digital display. (See Figure B)
- Press the HOUR button to the desired hour. **Note:** Be sure to check that the AM/PM indicator, located in the top left side of the digital clock display, is also set to the correct time of day you want the Coffeemaker to begin brewing.
- Press the MIN button to the desired minute.
- Release the PROGRAM button.
- Make sure your current time is set correctly.
- Press the START/STOP button ONLY ONCE and the red AUTO light will go on. Your Coffeemaker is now set to start brewing at the programmed time.

If you are setting the unit to start brewing automatically, be sure that the unit is filled with water, the Filter Basket Lid is down, and that the Carafe is sitting securely on the Warming Plate.

NOTE: Unplugging the unit will reset the clock to 12:00.

NOTE: When the Coffeemaker is set to auto, the word AUTO will appear in the digital display. (See Figure B)

OPERATING INSTRUCTIONS:

1. Place the Coffeemaker on a flat, level surface such as a countertop. Plug the Coffeemaker into a 120 volt 60 Hz AC outlet.
2. Fill the Water Reservoir. Flip open the Filter Basket Lid and insert a No. 4 Gevalia cone shaped paper filter into the Removable Filter Basket. Place the desired amount of ground coffee into the paper filter. Brew Gevalia Kaffe with the coffee/water ratio you normally use when you prepare ground coffee. If you prefer strong coffee, we recommend the following European method, which produces rich, full-bodied flavor. Use one level Gevalia scoop for each cup (6 fluid ounces) or 12 level scoops per full pot of coffee. (Experiment with the amount of coffee used in order to adjust the flavor to your taste.)

3. Be sure that the Removable Filter Basket is seated properly in the Filter Basket Holder, by pushing it down and securely into place. Make sure the Filter Basket Lid is completely closed on the top of the Filter Basket Holder. Ensure there is water in the Water Reservoir.

IMPORTANT: Do not operate your Coffeemaker if the Filter Basket Lid on the top of the unit is not securely closed.

4. To brew coffee immediately, push the START/STOP button twice. The green ON light will illuminate and after a few moments the coffee will start to brew.
5. To set the Coffeemaker to start brewing at a certain time, hold down the PROGRAM button. While holding down the PROGRAM button, push the MIN and HOUR buttons to set the timer. Release the PROGRAM button. Once the timer is set to the correct time, you must then set the unit to AUTO. To do this, push the START/STOP button once until the red AUTO light illuminates.
6. When the unit is brewing, the green ON light will illuminate. After the brewing cycle is complete, the Warming Plate will remain on for 2 hours and then automatically shut off. While the Warming Plate is on, the ON light will remain illuminated.
7. To manually shut off the Coffeemaker, push the START/STOP button once. The green ON light will turn off, indicating the unit is off.

NOTE:

If you are setting the unit to start brewing automatically, be sure that the unit is filled with water, the Filter Basket Lid is down, and that the Carafe is sitting securely on the Warming Plate.

CAUTION:

After the brewing cycle is completed, there still will be HOT liquid in the Removable Filter Basket. Always turn off the unit and wait at least 30 minutes after the brewing cycle is completed before opening the filter basket lid and emptying the Removable Filter Basket.

TO BREW A SECOND POT

1. Turn the unit off.
2. Wait 30 minutes to prevent hot water in the tubes from splashing out.
3. Follow Instructions in "OPERATING INSTRUCTIONS" (above).

HINTS FOR GREAT TASTING COFFEE:

- A clean Coffeemaker is essential for making great tasting coffee. Regular cleaning, as specified in CLEANING YOUR COFFEEMAKER, is highly recommended.
- Always use fresh, cold filtered or bottled water in your Coffeemaker.
- Fine grind coffee (such as Gevalia) promotes fuller extraction and provides a rich, full-tasting coffee. Regular grind coffee will require slightly more coffee grounds per cup to provide the strength of a finer grind.
- Store coffee in a cool, dry place. Once coffee has been opened, keep it tightly sealed in the refrigerator or freezer to maintain its freshness.
- For optimum coffee flavor, buy whole beans and grind them just before brewing.
- Do not re-use coffee grounds as this will lessen the coffee flavor.
- Reheating coffee is not recommended. Coffee is at its peak flavor immediately after brewing.
- Small oil droplets on the surface of the brewed coffee is due to the extraction of oil from the coffee grounds. Oiliness may occur more frequently if heavily roasted coffee is used. Heavy use may also cause an increase in oil deposits, indicating a need to clean your Coffeemaker more frequently.

CLEANING YOUR COFFEEMAKER

- **CAUTION:** Always make sure Coffeemaker is unplugged before attempting to clean it. To protect against electric shock, do not immerse cord, plug or unit in water or other liquids.
- The outside of your Coffeemaker can be cleaned by wiping the surface with a damp, soft cloth.

IMPORTANT: Never immerse the Coffeemaker in water or other liquids.

- When cleaning the Carafe, DO NOT put your hands inside the Glass Carafe or insert anything into the glass chamber for the glass is fragile and may break. Clean your Glass Carafe by rinsing it with warm soapy water.
- The Glass Carafe Lid and Removable Filter Basket may be washed with warm soapy water or placed in the top rack of the dishwasher. Do not place any other parts of the Coffeemaker in the dishwasher.
- Rinse the Removable Filter Holder thoroughly after every use to insure trouble-free operation.
- Do not clean the inside of the Water Reservoir with a cloth as the cloth may have a lint residue that could clog the Coffeemaker.
- For stubborn stains, use a nylon or plastic pad with a non-abrasive cleaner. Do not use metal scouring pads or abrasive cleaners.

DECALCIFYING YOUR COFFEEMAKER

- Calcium deposits may build up in the Coffeemaker as a result of minerals commonly found in drinking water. The build-up is normal and may result in longer brewing times. This slow down can be eliminated by periodically decalcifying the Coffeemaker. We recommend decalcifying your unit with Gevalia Cleancaf Cleaner & Descaler. Nontoxic, biodegradable and odorless Cleancaf is a quick and easy way to keep coffeemakers clean, fresh and odor free. Use bi-monthly to remove or prevent oil residue and mineral buildup. You can order Cleancaf by calling 1-800-GEVALIA (1-800-438-2542) or visiting us at www.gevalia.com.
- A solution of two tablespoons of white vinegar to one carafe of cold water may also be used to decalcify. Pour the solution into the Water Reservoir, and then close the Hinged Reservoir Lid. Place the Glass Carafe securely on the Warming Plate and allow the Coffeemaker to brew the vinegar solution. Once it has finished brewing, empty the Glass Carafe and rinse it out with cold water. Refill the Water Reservoir with cold water only and run another new cycle to remove any remaining residue.

Free Manuals Download Website

<http://myh66.com>

<http://usermanuals.us>

<http://www.somanuals.com>

<http://www.4manuals.cc>

<http://www.manual-lib.com>

<http://www.404manual.com>

<http://www.luxmanual.com>

<http://aubethermostatmanual.com>

Golf course search by state

<http://golfingnear.com>

Email search by domain

<http://emailbydomain.com>

Auto manuals search

<http://auto.somanuals.com>

TV manuals search

<http://tv.somanuals.com>