

GA-3PXSL-RH  
AMD Socket AM2 Motherboard

# USER'S MANUAL

AMD® AM2 Processor Motherboard  
Rev. 1003



- \* The WEEE marking on the product indicates this product must not be disposed of with user's other household waste and must be handed over to a designated collection point for the recycling of waste electrical and electronic equipment!!
- \* The WEEE marking applies only in European Union's member states.

---

## Table of Content

Item Checklist .....	4
WARNING! .....	4
Chapter 1 Introduction .....	5
1.1.Features Summary .....	5
1.2GA-3PXS-L-RH Motherboard Components .....	7
Chapter 2Hardware Installation Process .....	9
2-1: Installing Processor and CPU Heat Sink .....	9
2-1-1: Installing CPU .....	9
2-1-2: Installing CPU Cooler Fan .....	10
2-2: Install memory modules .....	11
2-3: Install expansion cards .....	13
2-4: Connect ribbon cables, cabinet wires, and power supply .....	14
2-4-1 : I/O Back Panel Introduction .....	14
2-5: Connectors & Jumper Setting Introduction .....	16
2-6: Block Diagram .....	24
Chapter 3 BIOS Setup .....	25
Main .....	27
Advanced .....	32
Advanced BIOS Feature .....	33
Advanced Chipset .....	36
Integrated Peripherals .....	38
Power Management Setup .....	46
PnP/PCI Configuration .....	48
Security .....	50
Boot .....	51
PC Health .....	52
Exit .....	54

---

Chapter 4 Application Driver Installation .....	55
A.NVIDIA Chipset Driver Installation .....	55
B.nVIDIA VGA Driver Installation .....	61
C.Marvell LAN Driver Installation .....	63
D.DirectX 9.0 Driver Installation .....	66
Chapter 5 Appendix .....	69

## Item Checklist

- The GA-3PXSL-RH motherboard
- IDE (ATA100 ) cable x 1 / Floppy cable x 1
- CD for motherboard driver & utility
- GA-3PXSL-RH user's manual
- Serial ATA cable x 4
- I/O Shield Kit



### WARNING!

Computer motherboards and expansion cards contain very delicate Integrated Circuit (IC) chips. To protect them against damage from static electricity, you should follow some precautions whenever you work on your computer.

1. Unplug your computer when working on the inside.
2. Use a grounded wrist strap before handling computer components. If you do not have one, touch both of your hands to a safely grounded object or to a metal object, such as the power supply case.
3. Hold components by the edges and try not touch the IC chips, leads or connectors, or other components.
4. Place components on a grounded antistatic pad or on the bag that came with the components whenever the components are separated from the system.
5. Ensure that the ATX power supply is switched off before you plug in or remove the ATX power connector on the motherboard.

### Installing the motherboard to the chassis...

If the motherboard has mounting holes, but they don't line up with the holes on the base and there are no slots to attach the spacers, do not become alarmed you can still attach the spacers to the mounting holes. Just cut the bottom portion of the spacers (the spacer may be a little hard to cut off, so be careful of your hands). In this way you can still attach the motherboard to the base without worrying about short circuits. Sometimes you may need to use the plastic springs to isolate the screw from the motherboard PCB surface, because the circuit wire may be near by the hole. Be careful, don't let the screw contact any printed circuit write or parts on the PCB that are near the fixing hole, otherwise it may damage the board or cause board malfunctioning.

## Chapter 1 Introduction

### 1.1. Features Summary

Form Factor	<ul style="list-style-type: none"> <li>• 12" x 9.6" ATX size form factor, 4 layers PCB</li> </ul>
CPU	<ul style="list-style-type: none"> <li>• Supports AMD® Opteron™ 1000 series (Socket AM2) processor</li> <li>• AMD™ Single/Dual Core in AM2 socket</li> <li>• L2 cache on-die per processor from 1M</li> </ul>
Chipset	<ul style="list-style-type: none"> <li>• NVIDIA® GeForce 6150 Chipset</li> <li>• NVIDIA® nForce 430 Chipset</li> </ul>
Memory	<ul style="list-style-type: none"> <li>• 4 x DDRII-533/667 socket up to 16 GB</li> <li>• Supports Un-buffered DDRII 533/667</li> <li>• Dual Channel memory bus</li> <li>• Support 512MB, and 1GB memory</li> <li>• Single-bit Errors Correction, Multiple-bit Errors Detection</li> </ul>
I/O Control	<ul style="list-style-type: none"> <li>• ITE IT8712F-A Super I/O</li> </ul>
Expansion Slots	<ul style="list-style-type: none"> <li>• Supports 3 PCI slots 32-Bit/33MHz (5V)</li> <li>• Supports 1 PCI-Express x1 slot</li> <li>• Supports 1 PCI-Express x16 slot</li> </ul>
On-Board SATA RAID	<ul style="list-style-type: none"> <li>• Build in NVIDIA® nForce 430 chipset</li> <li>• Supports SATAII RAID 0, 1, 0+1, 5</li> </ul>
On-Board Peripherals	<ul style="list-style-type: none"> <li>• 2 ATA-133 connectors</li> <li>• 1 Floppy port supports 2 FDD with 1.2M, 1.44M and 2.88M bytes.</li> <li>• 2 PS/2 connectors</li> <li>• 1 Parallel port supports Normal/EPP/ECP mode</li> <li>• 2 Serial port (COM, 1 by cable)</li> <li>• 6 x USB 2.0 (4 by cable)</li> <li>• 1 VGA connector</li> <li>• 2 x LAN RJ45</li> <li>• 4 x SATAII connectors</li> </ul>
Hardware Monitor	<ul style="list-style-type: none"> <li>• CPU/Power/System Fan Revolution Detect</li> <li>• CPU shutdown when overheat</li> <li>• System Voltage Detect</li> </ul>
On-Board Graphic	<ul style="list-style-type: none"> <li>• Integrated in NVIDIA® GeForce 6150 Chipset</li> </ul>
On-Board LAN	<ul style="list-style-type: none"> <li>• Marvell 88E8056 GbE controller/Marvell 88E1116 GbE PHY</li> <li>• Supports WOL, PXE</li> </ul>

## GA-3PXSL-RH Motherboard

---

BIOS	<ul style="list-style-type: none"><li>• Licensed Award BIOS on 4MB flash ROM</li><li>• SMBIOS Spec. Rev 2.3.3. compliant</li><li>• ACPI defined S1, S3, and S5</li></ul>
Additional Features	<ul style="list-style-type: none"><li>• PS/2 Mouse power on under Windows Operating System</li><li>• External Modem wake up</li><li>• Supports S1, S3, S5 under Windows Operating System</li><li>• Wake on LAN (WOL)</li><li>• AC Recovery</li></ul>

---

## 1.2 GA-3PXSL-RH Motherboard Components

- |     |                        |     |                          |
|-----|------------------------|-----|--------------------------|
| 1.  | CPU                    | 26. | DIMMB1                   |
| 2.  | NVIDIA GeForce 6150    | 27. | DIMMA2                   |
| 3.  | NVIDIA nForce 430      | 28. | DIMMB2                   |
| 4.  | ITE 8712F-A            | 29. | PCI-E x1 Slot            |
| 5.  | BIOS Flash             | 30. | PCI-E x16 Slot           |
| 6.  | Marvel 88E1116 GbE PHY | 31. | PCI 3 Slot (32bit/33MHz) |
| 7.  | Marvel 8056 GbE        | 32. | PCI 2 Slot (32bit/33MHz) |
| 8.  | IDE1 Connector         | 33. | PCI 1 Slot (32bit/33MHz) |
| 9.  | IDE2 Connector         | 34. | PS/2 Connectors          |
| 10. | Floppy Connector       | 35. | USB ports                |
| 11. | SATA1 Connector        | 36. | Serial Port              |
| 12. | SATA2 Connector        | 37. | Parallel Port            |
| 13. | SATA3 Connector        | 38. | VGA Port                 |
| 14. | SATA4 Connector        | 39. | RJ45 LAN/USB ports       |
| 15. | Front Panel Connector  | 40. | Auxiliary Power (ATX1)   |
| 16. | Battery                | 41. | Auxiliary Power (+12V)   |
| 17. | Front USB2 Connector   | 42. | Jumper Block             |
| 18. | Front USB3 Connector   | 43. | Jumper Block             |
| 19. | COMB Connector         |     |                          |
| 20. | CPU 1 FAN              |     |                          |
| 21. | System Fan1            |     |                          |
| 22. | System Fan2            |     |                          |
| 23. | System Fan3            |     |                          |
| 24. | System Fan4            |     |                          |
| 25. | DIMMA1                 |     |                          |

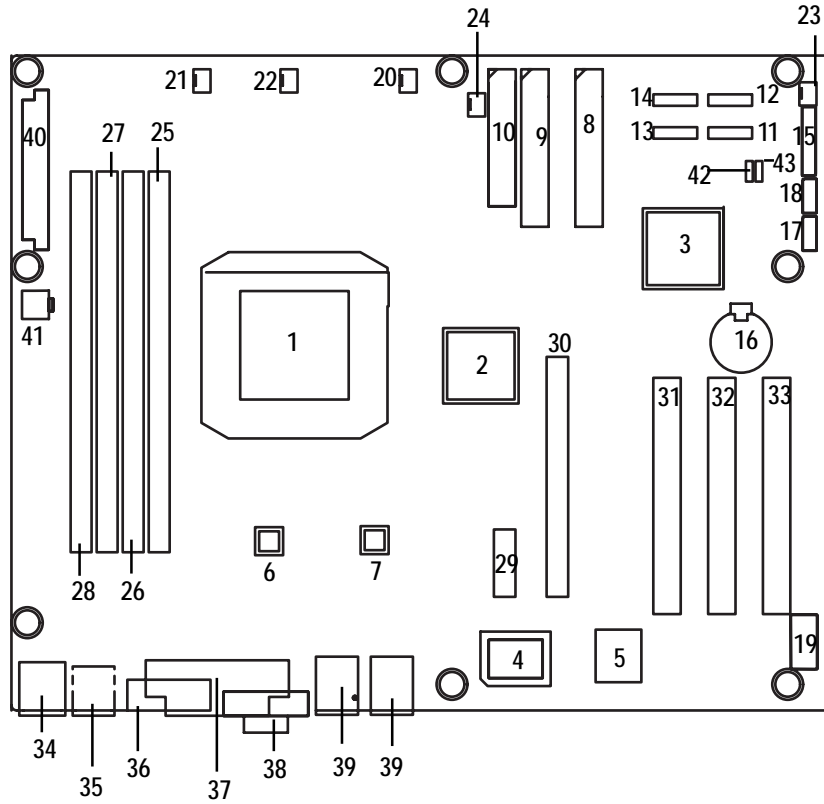



## Chapter 2 Hardware Installation Process

### 2-1: Installing Processor and CPU Heat Sink



#### CAUTION

Before installing the processor and cooling fan, adhere to the following cautions:

1. The processor will overheat without the heatsink and/or fan, resulting in permanent irreparable damage.
2. Never force the processor into the socket.
3. Apply thermal grease on the processor before placing cooling fan.
4. Please make sure the CPU type is supported by the motherboard.
5. If you do not match the CPU socket Pin 1 and CPU cut edge well, it will cause improper installation. Please change the insert orientation.

#### 2-1-1: Installing CPU

- Step 1. Check the CPU pins are not bent. Raise the locking lever next to the socket prior to installing the CPU.
- Step 2. The pin 1 location is designated on the CPU by a copper triangle that corresponds to a triangle marking on the socket as shown in Fig. 2.
- Step 3. Insert the CPU with the correct orientation. The CPU only fits in one orientation. When CPU is placed into socket properly, push the locking lever back into locked position.



Fig.1  
Raise locking lever at a 90 degree angle.



Fig.2  
Pin 1 location on the socket and CPU.  
Gently place the CPU into position and make sure the CPU pins fit perfectly into the holes. Once the CPU is positioned into its socket, place one finger down on the middle of the CPU and gently press the metal lever back into its original position.

## 2-1-2: Installing CPU Cooler Fan



Fig.1

Before installing the CPU cooler fan, please first add an even layer of heat paste on the surface of the CPU. Install all the CPU cooler components (Please refer to the cooler manual for detailed installation instructions).

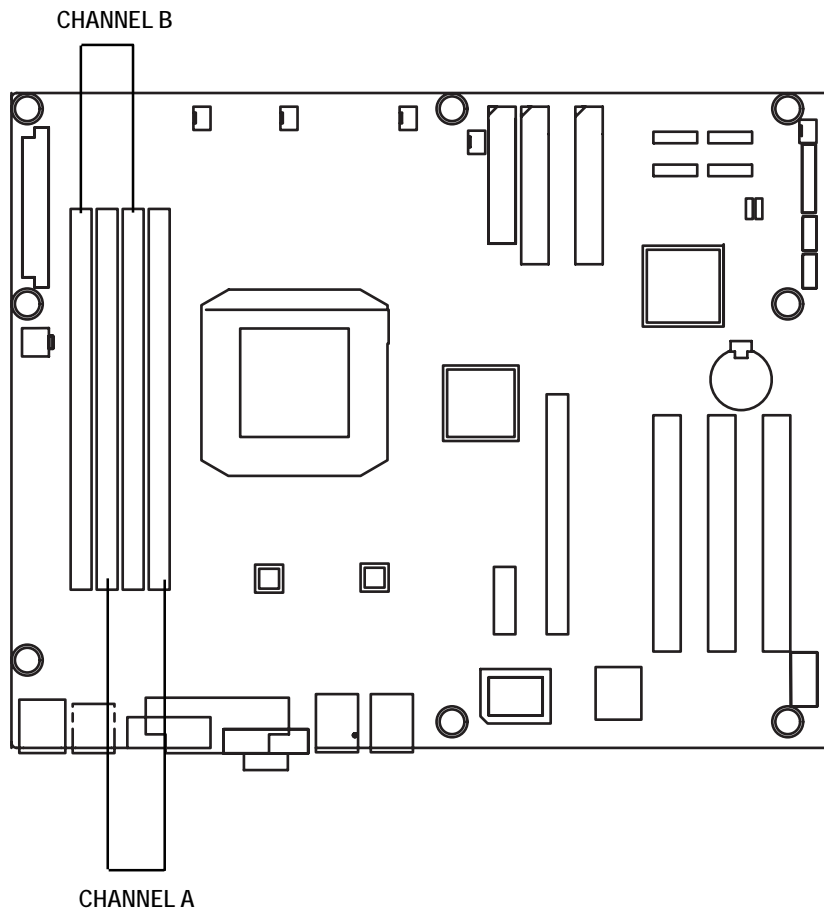

Fig.2

Please connect the CPU cooler fan power connector to the CPU\_FAN connector located on the motherboard.

## 2-2: Install memory modules

GA-3PXS-L-RH has 4 dual inline memory module (DIMM) sockets. It supports the Dual Channel Technology. The BIOS will automatically detects memory type and size. To install the memory module, just push it vertically into the DIMM socket. The DIMM module can only fit in one direction due to the notch. Wrong orientation will cause improper installation. Please change the insert orientation. Memory size can vary between sockets.



**Installation Step:**

1. Unlock a DIMM socket by pressing the retaining clips outwards.
2. Aling a DIMM on the socket such that the notch on the DIMM exactly match the notches in the socket.
3. Firmly insert the DIMM into the socket until the retaining clips snap back in place.
4. **When installing the DIMM into the DIMM socket, we recommend to populate one DIMM in Channel A module and one in Channel B module for best performance.**  
Please note that each logical DIMM must be made of two identical DIMMs having the same device size on each and the same DIMM size.
5. Reverse the installation steps when you wish to remove the DIMM module.

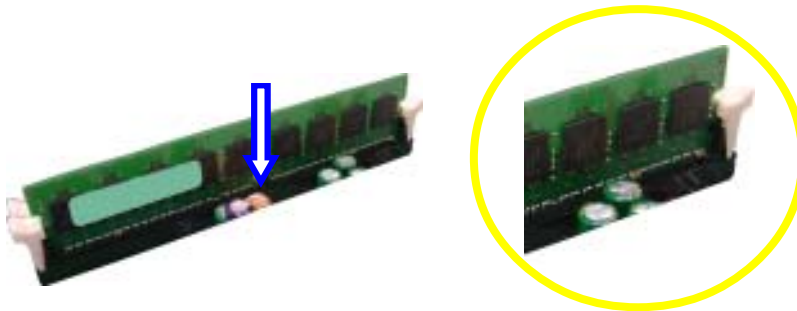

**Locked Retaining Clip**

**Table 2-3-1: DDRII DIMM Slot Populations**

Mode	Slot			
	DIMMA1	DIMMB1	DIMMA2	DIMMB2
Single Channel	Install			
		Install		
Dual Channel	Install	Install		
Dual Channel	Install	Install	Install	Install

## 2-3: Install expansion cards

1. Read the related expansion card's instruction document before install the expansion card into the computer.
2. Remove your server's chassis cover, necessary screws and slot bracket from the computer.
3. Press the expansion card firmly into expansion slot in motherboard.
4. Be sure the metal contacts on the card are indeed seated in the slot.
5. Replace the screw to secure the slot bracket of the expansion card.
6. Replace your computer's chassis cover.
7. Power on the computer, if necessary, setup BIOS utility of expansion card from BIOS.
8. Install related driver from the operating system.



## 2-4: Connect ribbon cables, cabinet wires, and power supply

### 2-4-1 : I/O Back Panel Introduction

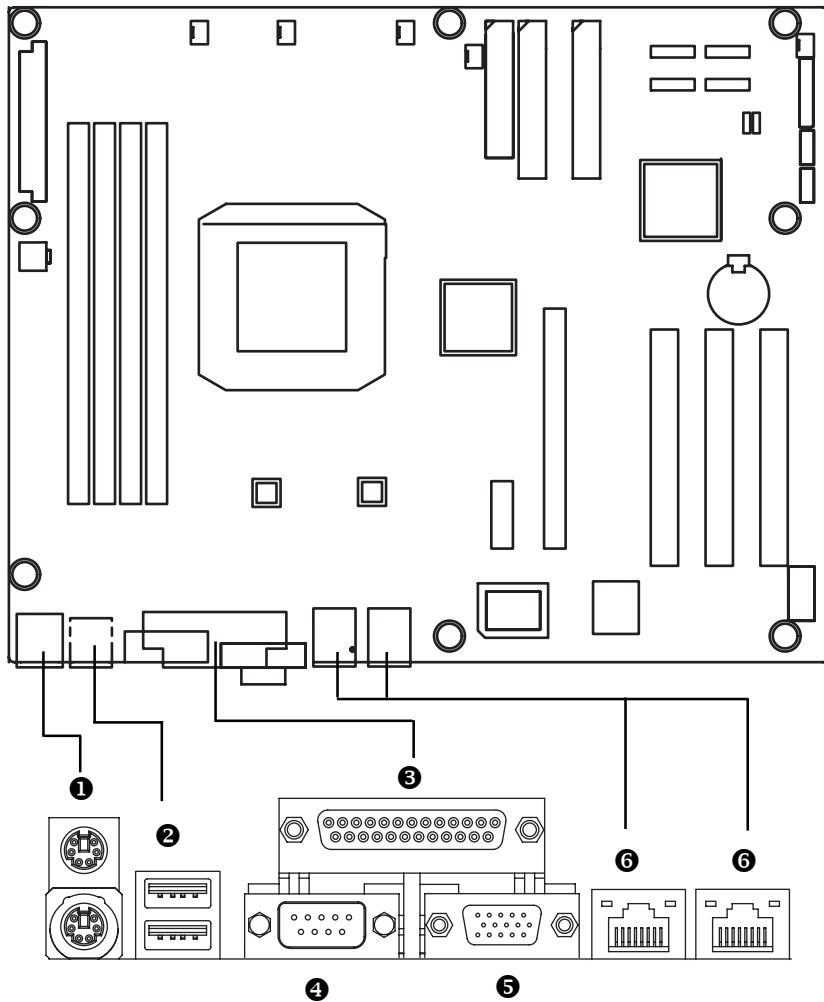

**❶ PS/2 Keyboard and PS/2 Mouse Connector**

To install a PS/2 port keyboard and mouse, plug the mouse to the upper port (green) and the keyboard to the lower port (purple).

**❷ USB Port**

Before you connect your device(s) into USB connector(s), please make sure your device(s) such as USB keyboard, mouse, scanner, zip, speaker...etc. have a standard USB interface. Also make sure your OS supports USB controller. If your OS does not support USB controller, please contact OS vendor for possible patch or driver updated. For more information please contact your OS or device(s) vendors.

**❸/❹/❺ Parallel Port / Serial Port / VGA Port**

This connector supports 1 standard COM port and 1 Parallel port. Device like printer can be connected to Parallel port ; mouse and modem etc can be connected to Serial port.

**❻ LAN Ports**

The provided Internet connection is Gigabit Ethernet, providing data transfer speeds of 10/100/1000Mbps.

**LAN LED Description**

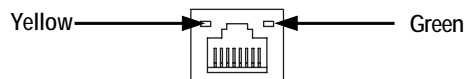

Name	Color	Condition	Description
LAN Link/ Activity	Green	ON	LAN Link / no Access
	Green	BLINK	LAN Access
	--	OFF	Idle
10/100 LAN Speed	Green	ON	100Mbps connection
	--	OFF	10Mbps connection

## 2-5: Connectors & Jumper Setting Introduction

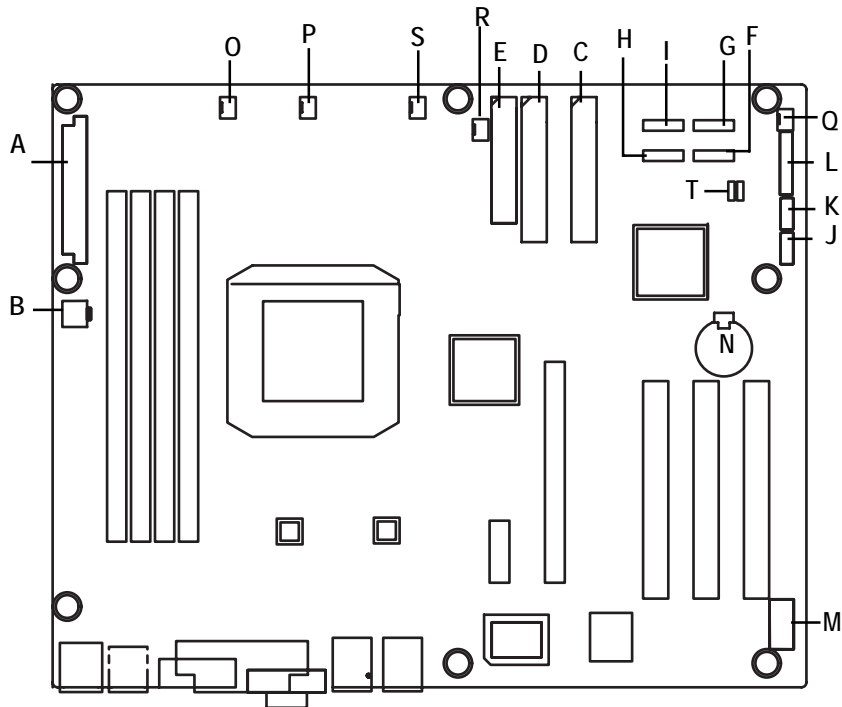

A) ATX	M) COMB
B) ATX_12V	N) Battery
C) IDE1	O) SYS_FAN1
D) IDE2	P) SYS_FAN2
E) FDD	Q) SYS_FAN3
F) SATA1	R) SYS_FAN4
G) SATA2	S) CPU_FAN
H) SATA3	T) CLR_CMOS (CMOS Clear Jumper)
I) SATA4	
J) F_USB2	
K) F_USB3	
L) F_Panel1	



A) ATX (ATX Power Connector)

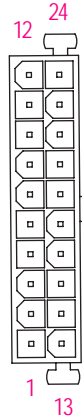
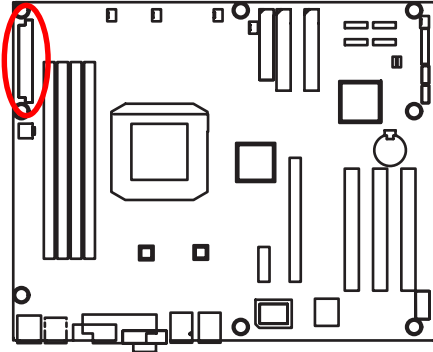

PIN No.	Definition
1	+3.3V
2	+3.3V
3	GND
4	+5V
5	GND
6	+5V
7	GND
8	POK
9	5VSB
10	+12V
11	+12V
12	+3.3V
13	+3.3V
14	-12V
15	GND
16	PSON
17	GND
18	GND
19	GND
20	-5V
21	+5V
22	+5V
23	+5V
24	GND

- AC power cord should only be connected to your power supply unit after ATX power cable and other related devices are firmly connected to the mainboard.

B) ATX\_12V( +12V Power Connector)

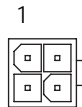
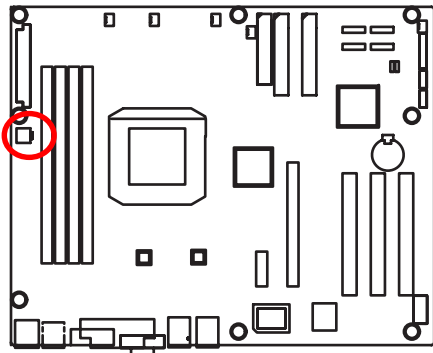

Pin No.	Definition
1	GND
2	GND
3	12V
4	12V

- This connector (ATX +12V) is used only for CPU1 Core Voltage.

### C/D) IDE1/IDE2 Connector

Please connect first harddisk to IDE1. The red stripe of the ribbon cable must be the same side with the Pin1.

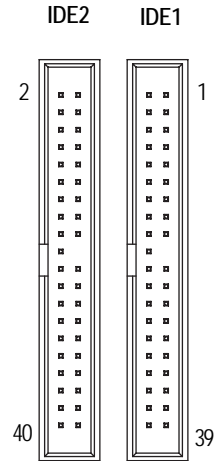
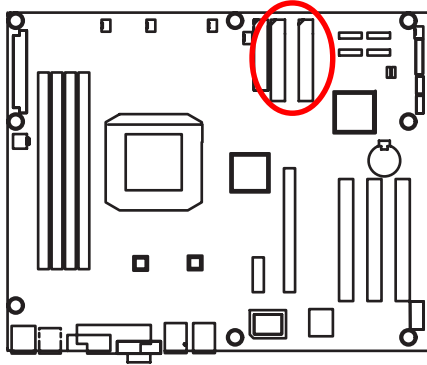

### E) FDD (Floppy Connector)

Please connect the floppy drive ribbon cables to FDD. It supports 1.2M, 1.44M and 2.88Mbytes floppy disk types. The red stripe of the ribbon cable must be the same side with the Pin1.

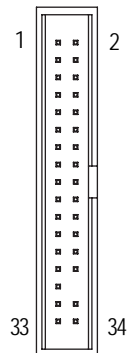
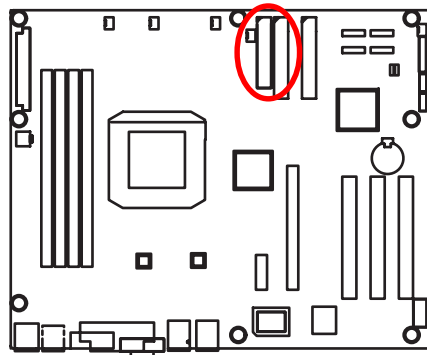

**F / G / H / I ) SATA1/ 2/ 3/ 4 (Serial ATA Connectors)**

You can connect the Serial ATA device to this connector, it provides you high speed transfer rates (150MB/sec).

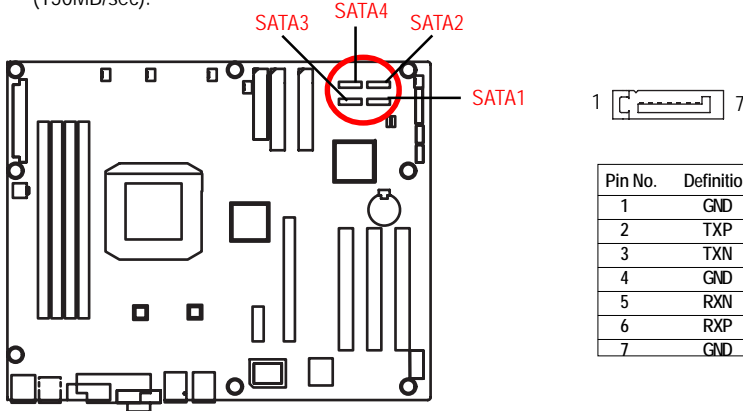

Pin No.	Definition
1	GND
2	TXP
3	TXN
4	GND
5	RXN
6	RXP
7	GND

**J / K ) F\_USB 2/3 (Front USB Connectors)**

Be careful with the polarity of the front panel USB connector. Check the pin assignment while you connect the front panel USB cable. Please contact your nearest dealer for optional front panel USB cable.

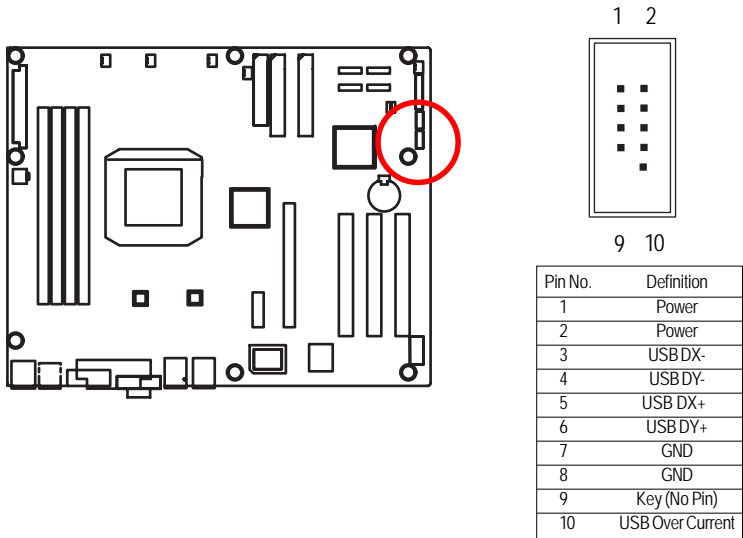

Pin No.	Definition
1	Power
2	Power
3	USB DX-
4	USB DY-
5	USB DX+
6	USB DY+
7	GND
8	GND
9	Key (No Pin)
10	USB Over Current

**L ) F\_Panel1 (2x10 Pins Front Panel Connectors)**

Please connect the power LED, PC speaker, reset switch and power switch etc of your chassis front panel to the front panel jumper according to the pin assignment below.

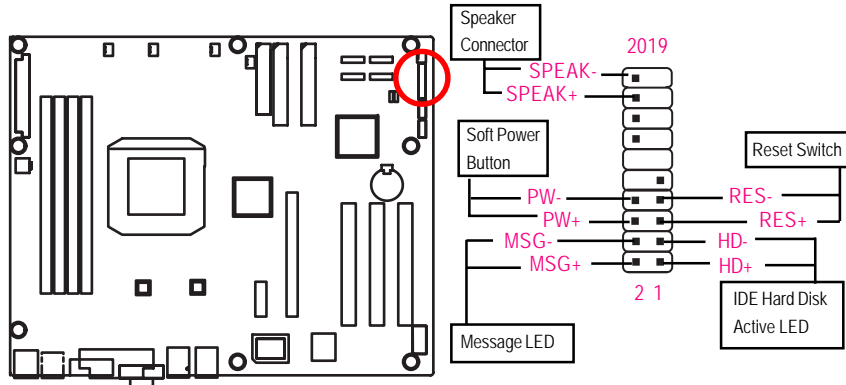

Pin No	Signal Name	Description
1	HD+	Hard Disk LED pull up (330 ohm)
2	MSG+	Message LED Signal (Pull up 330 ohm)
3	HD-	Hard Disk Active LED Signal
4	MSG-	Message Suspend LED (Blinking)
5	RES+	Front Panel Reset Button Signal
6	PW+	Front Panel Power On/Off Button
7	RES-	Front Panel Reset Button Signal
8	PW-	Front Panel Power On/Off Button
9	NC	No Connect
10	KEY	KEY
11	KEY	KEY
12	KEY	KEY
13	KEY	KEY
14	KEY	KEY
15	KEY	KEY
16	KEY	KEY
17	KEY	KEY
18	KEY	KEY
19	SPEAKER+	Speaker connector
20	SPEAKER-	Speaker connector

M) COMB

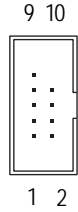
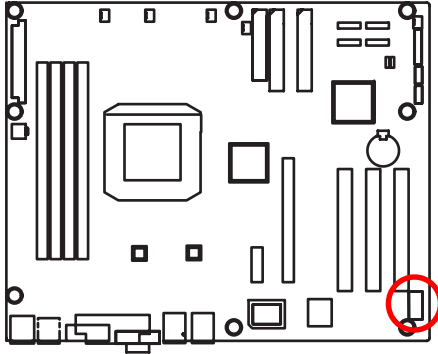

Pin No.	Definition
1	DCD-
2	SIN2
3	SOUT2
4	DTR2-
5	GND
6	DSR2-
7	RTS2-
8	CTS2-
9	RI2-
10	Key Pin

N) Battery

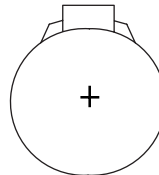
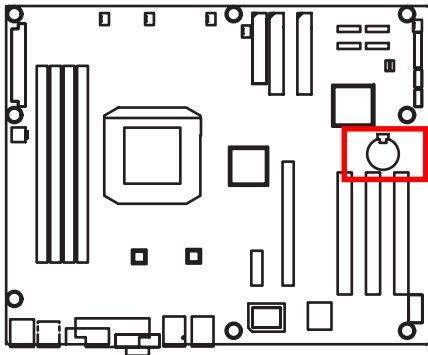

**CAUTION**

- ❖ Danger of explosion if battery is incorrectly replaced.
- ❖ Replace only with the same or equivalent type recommended by the manufacturer.
- ❖ Dispose of used batteries according to the manufacturer's instructions.

If you want to erase CMOS...

1. Turn OFF the computer and unplug the power cord.
2. Remove the battery, wait for 30 second.
3. Re-install the battery.
4. Plug the power cord and turn ON the computer.

**O / P / Q / R) SYS\_FAN1/2/3/4 (System Fan Connectors)**

This connector allows you to link with the cooling fan on the system case to lower the system temperature.

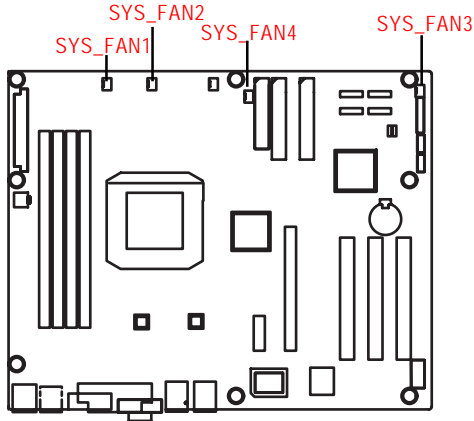

Pin No.	Definition
1	GND
2	+12V
3	Sense

**S) CPU\_FAN (CPU Fan Connector)**

Please note, a proper installation of the CPU cooler is essential to prevent the CPU from running under abnormal condition or damaged by overheating. The CPU fan connector supports Max. current up to 1A .

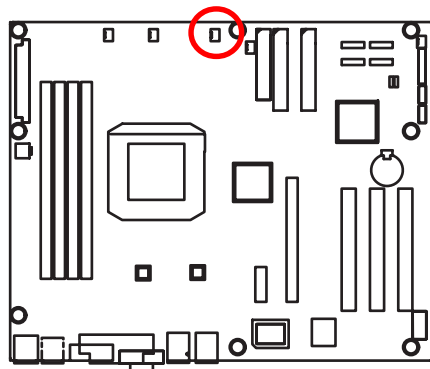

Pin No.	Definition
1	GND
2	+12V
3	Sense

T) CLR\_CMOS (Clear CMOS Function)

You may clear the CMOS data to its default values by this jumper.

Default value doesn't include the "Shunter" to prevent from improper use this jumper. To clear CMOS, temporarily short 1-2 pin.

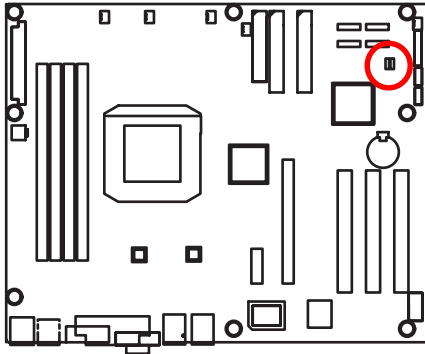

1-2 close: Clear CMOS



2-3 close: Normal (Default value)

## 2-6: Block Diagram

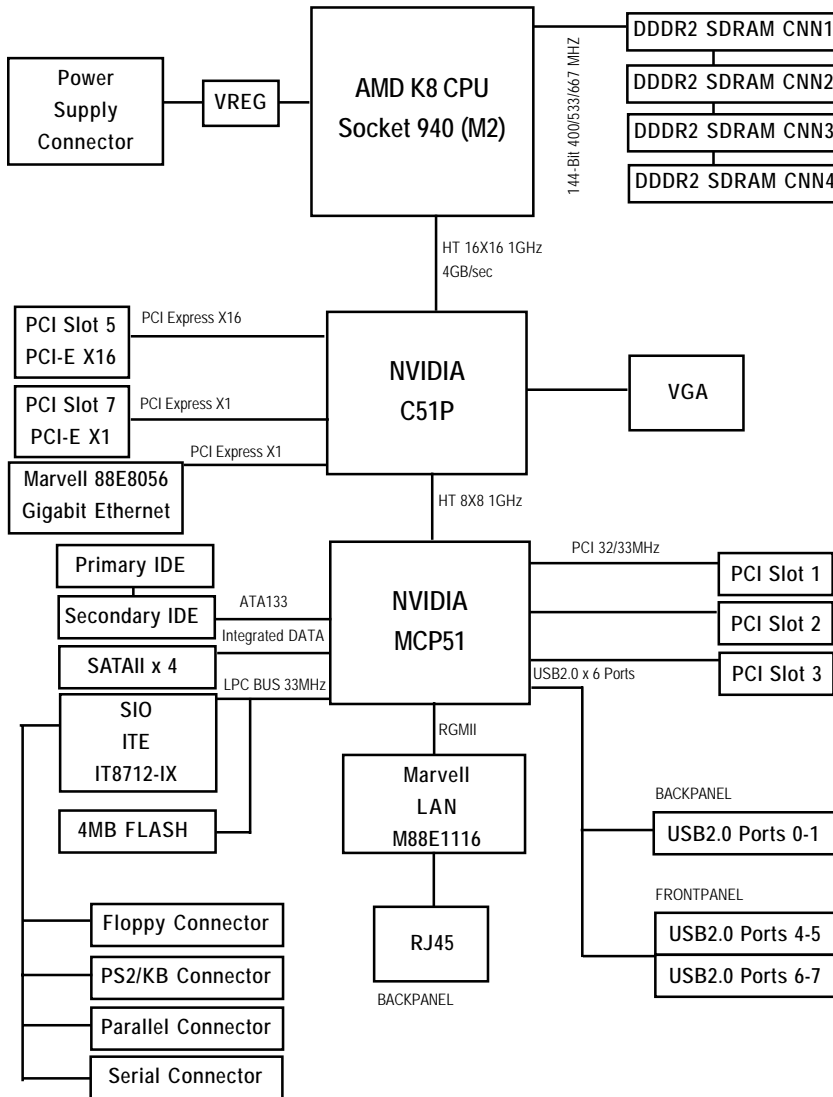



## Chapter 3 BIOS Setup

BIOS Setup is an overview of the BIOS Setup Program. The program that allows users to modify the basic system configuration. This type of information is stored in battery-backed CMOS RAM so that it retains the Setup information when the power is turned off.

### ENTERING SETUP

Power ON the computer and press <DEL> immediately will allow you to enter Setup.

### CONTROL KEYS

<↑>	Move to previous item
<↓>	Move to next item
<←>	Move to the item in the left hand
<→>	Move to the item in the right hand
<Esc>	Main Menu - Quit and not save changes into CMOS Status Page Setup Menu and Option Page Setup Menu - Exit current page and return to Main Menu
<+/PgUp>	Increase the numeric value or make changes
<-/PgDn>	Decrease the numeric value or make changes
<F1>	General help, only for Status Page Setup Menu and Option Page Setup Menu
<F2>	Item Help
<F3>	Reserved
<F4>	Change Menu Color
<F5>	Restore the previous CMOS value from CMOS, only for Option Page Setup Menu
<F6>	Reserved
<F7>	Load the Optimized Defaults
<F8>	Reserved
<F9>	Reserved
<F10>	Save all the CMOS changes, only for Main Menu

## **GETTINGHELP**

### **Main Menu**

The on-line description of the highlighted setup function is displayed at the bottom of the screen.

### **Status Page Setup Menu / Option Page Setup Menu**

Press F1 to pop up a small help window that describes the appropriate keys to use and the possible selections for the highlighted item. To exit the Help Window press <Esc>.

- **Main**  
This setup page includes all the items in standard compatible BIOS.
- **Advanced**  
This setup page includes all the items of AWARD special enhanced features.  
(ex: onboard device enable/disable, power management)
- **Security**  
Change, set, or disable password. It allows you to limit access to the system and Setup, or just to Setup.
- **Boot**  
This setup page include all the items of first boot function features.
- **PC Health Status**  
This setup page displays the System auto detect Temperature, voltage, fan speed.
- **Exit**  
Save CMOS value settings to CMOS and exit setup or abandon all CMOS value changes and exit setup.

## Main

Once you enter Award BIOS Setup Utility, the Main Menu (Figure 1) will appear on the screen. Use arrow keys to select among the items and press <Enter> to accept or enter the sub-menu.

Phoenix-Award Workstation BIOS CMOS Setup Utility					
Main	Advanced	Security	Boot	PC Health	Exit
Date (mm:dd:yy)	Thr. Jan. 29 2006			Item Help	
Time (hh:mm:ss)	23:1:52				
▶ System Information	[Press Enter]				
Drive A	[1.44M, 3.5 <sup>1/2</sup> ]				
Floppy 3 Mode Support	[Disabled]				
Halt On	[All, But Keyboard]				
x Base Memory	KB				
x Extended Memory	KB				
x Total Memory	KB				
↑↓→←: Move    Enter: Select +/-/PU/PD: Value    F10: Save    ESC: Exit    F1: General Help F5: Previous Values    F7: Optimized Defaults					

Figure 1: Main

### ☞ Date

The date format is <date> <month>, <day>, <year>.

- ▶▶ Date    The date, Monday to Sunday.
- ▶▶ Month    The month, Jan. Through Dec.
- ▶▶ Day    The day, from 1 to 31 (or the maximum allowed in the month)
- ▶▶ Year    The year, from 1999 through 2098

### ☞ Time

The times format is set in <hour>, <minute> and <second>. The time is calculated base on the 24-hour military-time clock. For example, 1 p.m. is 13:00:00.

Note that "x" indicates Display ONLY

Phoenix-Award WorkstationBIOS CMOS Setup Utility					
Main	Advanced	Security	Boot	PC Health	Exit
System Information			Item Help		
***** System Information *****					
Product Name:		GA-XXXXXX			
BIOS Version:		F1			
Build Date:		xx-xx-xx			
Manufactory:					
Chipset Type:					
LAN1 MAC Address:					
LAN2 MAC Address:					
CPU Core Frequency					
CPU Frequency Ratio					
CPU L1 Cache					
CPU L2 Cache					
▶ IDE Channel 0 Master		[None]			
▶ IDE Channel 0 Slave		[None]			
▶ IDE Channel 1 Master		[CD-540E]			
▶ IDE Channel 1 Slave		[None]			
▶ IDE Channel 2 Master		[None]			
▶ IDE Channel 3 Master		[None]			
▶ IDE Channel 4 Master		[None]			
▶ IDE Channel 5 Master		[None]			
↑↓→←: Move    Enter: Select +/-/PU/PD: Value    F10: Save    ESC: Exit    F1: General Help F5: Previous Values    F7: Optimized Defaults					

Figure 1-1: Main

### 🔗 System Information

This category includes the information of motherboard, BIOS version, Build Date, Manufactory, relative chipset type, and processors information.

---

**☞ IDE HDD Auto Detection**

Press [Enter] to auto-detect the HDD's size, head, etc on this channel.

**☞ IDE Channel 0~5 Master / Channel 0~1 Slave**

The category identifies the types of hard disk from drive C to F that has been installed in the computer. There are two types: **auto type**, and **manual type**. Manual type is user-definable; Auto type that will automatically detect HDD type.

Note that the specifications of your drive must match with the drive table. The hard disk will not work properly if you enter improper information for this category.

If you select User Type, related information will be asked to enter to the following items. Enter the information directly from the keyboard and press <Enter>. Such information should be provided in the documentation form your hard disk vendor or the system manufacturer.

**▶ Access Mode**

This option allows user to set hard drive parameters.

Option: CHS, LBA, Large, Auto (Default Value)

▶▶ Capacity	Displays the capacity of HDD
▶▶ Cylinder	Number of cylinders
▶▶ Heads	Number of heads
▶▶ Precmp	Write precomp
▶▶ Landind Zone	Landing zone
▶▶ Sectors	Number of sectors

If a hard disk has not been installed, select NONE and press <Enter>.

### ☞ **Drive A**

The category identifies the types of floppy disk drive A that has been installed in the computer.

- ▶▶ None                      No floppy drive installed
- ▶▶ 360K, 5<sup>1/4</sup> in.            5.25 inch PC-type standard drive; 360K byte capacity.
- ▶▶ 1.2M, 5<sup>1/4</sup> in.            5.25 inch AT-type high-density drive; 1.2M byte capacity  
(3.5 inch when 3 Mode is Enabled).
- ▶▶ 720K, 3<sup>1/2</sup> in.            3.5 inch double-sided drive; 720K byte capacity
- ▶▶ 1.44M, 3<sup>1/2</sup> in.          3.5 inch double-sided drive; 1.44M byte capacity.
- ▶▶ 2.88M, 3<sup>1/2</sup> in.          3.5 inch double-sided drive; 2.88M byte capacity.

### ☞ **Floppy 3 Mode Support**

This is required to support older Japanese floppy drives. Floppy 3 Mode Support will allow reading and writing of 1.2MB (as opposed 1.44MB) on a 3.5-inch diskette.

- ▶▶ Disabled                 Normal Floppy Drive. (Default value)
- ▶▶ Drive A                  Drive A is 3 mode Floppy Drive.
- ▶▶ Drive B                  Drive B is 3 mode Floppy Drive.
- ▶▶ Both                      Drive A & B are 3 mode Floppy Drives.

### ☞ **Halt On**

This function allows system to halt when an error is detected during Power-On-Self -Test.

- ▶▶ NO Errors                The system boot will not stop for any error that may be detected and you will be prompted.
- ▶▶ All Errors                Whenever the BIOS detects a non-fatal error the system boot will be stopped.
- ▶▶ All, But Keyboard      The system boot will not stop for all errors except a keyboard error. (Default value)
- ▶▶ All, But Diskette      The system boot will not stop for all errors except a disk error.
- ▶▶ All, But Disk/Key      The system boot will not stop for all errors except keyboard and disk errors.

**☞ Base Memory**

The POST of the BIOS will determine the amount of base (or conventional) memory installed in the system.

**☞ ExtendedMemory**

The BIOS determines how much extended memory is present during the POST. This is the amount of memory located above 1 MB in the C PU's memory address map.

**☞ Total Memory**

The POST of the BIOS will determine the amount of total memory installed in the system.

## Advanced

Phoenix-Award WorkstationBIOS CMOS Setup Utility					
Main	Advanced	Security	Boot	PC Health	Exit
▶ Advanced BIOS Feature				Item Help	
▶ Advanced Chipset					
▶ Integrated Peripherals					
▶ Power Management Setup					
▶ PnP/PCI Configuration					
↑↓→← : Move    Enter: Select +/-/PU/PD: Value    F10: Save    ESC: Exit    F1: General Help F5: Previous Values    F7: Optimized Defaults					

Figure 2: Advanced



## Advanced BIOS Feature

Phoenix-Award Workstation BIOS CMOS Setup Utility		
Advanced		
Advanced BIOS Feature		Item Help
Quick Power On Self Test	[Enabled]	
Boot Up Floppy Seek	[Disabled]	
Boot Up Num-Lock Status	[On]	
x APIC Mode	Enabled	
Full Screen LOGO Show	[Disabled]	
Summary Screen Show	[Enabled]	
DMI Event Log	[Enabled]	
Clear All Event Log	[No]	
View DMI Event Log	[Enter]	
Mark DMI events Log as Read	[Enter]	
x Event Log Capacity	Space Available	
x Event Log Vaildity	Vaild	
↑↓→← : Move    Enter: Select +/-/PU/PD: Value    F10: Save    ESC: Exit    F1: General Help F5: Previous Values    F7: Optimized Defaults		

Figure 2-1: Advanced BIOS Features

### Quick Power On Self Test

This category speeds up Power On Self Test (POST) after you power on the computer. If it is set to Enable, BIOS will shorten or skip some check items during POST.

- ▶▶ Enabled                      Enables quick POST.(Default value)
- ▶▶ Disabled                      Normal POST.

### ☞ **Boot Up Floppy Seek**

During POST, BIOS will determine the floppy disk drive installed is 40 or 80 tracks. 360K type is 40 tracks 720K, 1.2M and 1.44M are all 80 tracks.

- ▶▶ Enabled                      BIOS searches for floppy disk drive to determine it is 40 or 80 tracks. Note that BIOS can not tell from 720K, 1.2M or 1.44M drive type as they are all 80 tracks. (Default value)
- ▶▶ Disabled                     BIOS will not search for the type of floppy disk drive by track number. Note that there will not be any warning message if the drive installed is 360K.

### ☞ **Boot Up Num-Lock Status**

This option allows user to select power-on status for NumLock.

- ▶▶ Auto                            System auto assign. (Default value)
- ▶▶ Enabled                      Enable NumLock.
- ▶▶ Disabled                     Disable this function.

### ☞ **Full Screen Logo Show**

- ▶▶ Enabled                      Show Full Logo when system boot.
- ▶▶ Disabled                     Disable this function. (Default value)

### ☞ **Summary Screen Show**

- ▶▶ Enabled                      Show Summary screen when system boot. (Default value)
- ▶▶ Disabled                     Disable this function.

### ☞ **DMIEvent Log**

- ▶▶ Enabled                      Store POST error message to the DMI Event Log. (Default value)
- ▶▶ Disabled                     Disable this function.

### ☞ **Clear all DMI Event Log**

- ▶▶ Yes                            System will clear DMI event logs at next POST stage, and set this item to [No] automatically.
- ▶▶ No                             Do not clear DMI event logs at next POST stage. (Default value)

☞ **View DMI Event Log**

Press [Enter] to view all DMI event logs.

☞ **Mark DMI Events Log as Read**

This option allows user to clear all DMI Event Logs immediately. Press [Enter] will pop up a confirmation window. Hit [Y] and [Enter] to clear all DMI event logs immediately.

☞ **Event Log Capacity**

This item displays the information of Event Log Capacity.

☞ **Events Log Vaildity**

This item displays the information of Event Log Vaildity.

---

## Advanced Chipset

Phoenix-Award WorkstationBIOS CMOS Setup Utility	
Advanced	
Advanced Chipset	Item Help
OnChip VGA [Enabled]	
Frame Buffer Size [64M]	
System BIOS Cacheable [Disabled]	
↑↓→← : Move    Enter: Select +/-/PU/PD: Value    F10: Save    ESC: Exit    F1: General Help F5: Previous Values    F7: Optimized Defaults	

Figure 2-2: Advanced Chipset

---

**OnChip VGA**

- ▶▶ Enabled      Enable Onboard VGA chipset. (Default value)
- ▶▶ Disabled      Disable this device.

**Frame Buffer Size**

This item allows user to select the frame buffer size.

- ▶▶ Options      16M, 32M, 64M, 128MB, 256MB.

**System BIOS Cacheable**

- ▶▶ Enabled              Enable System BIOS Cacheable function.
- ▶▶ Disabled             Disabled this function. (Default value)

## Integrated Peripherals

Phoenix-Award WorkstationBIOS CMOS Setup Utility	
Advanced	
Integrated Peripherals	Item Help
▶ IDE Function Setup	
▶ RAID Config	
OnChip USB	[V1.1+V2.0]
USB Memory Type	[SHADOW]
USB Keyboard Support	[Disabled]
USB Mouse Support	[Disabled]
MAC Lan	[Auto]
MAC Media Interface	[Pin Strap]
2nd Lan Controller	[Auto]
IDE HDD Block Mode	[Enabled]
Onboard FDC Controller	[Enabled]
Onboard Serial Port 1	[3F8,IRQ4]
Onboard Serial Port 2	[2F8,IRQ3]
UART Mode Select	[Normal]
x UR2 Duplex Mode	Half
Onboard Parallel Port	[378/IRQ7]
x ECP Mode Use DAM	3
↑↓→← : Move    Enter: Select +/-/PU/PD: Value    F10: Save    ESC: Exit    F1: General Help F5: Previous Values    F7: Optimized Defaults	

Figure 2-3: Integrated Peripherals

---

## ☞ IDE Function Setup

### ☞ OnChip IDE Channel 0

- ▶▶ Enabled      Enable onboard Onchip IDE Channel 0. (Default value)
- ▶▶ Disabled      Disable this function.

### ☞ Primary Master PIO

- ▶▶ Auto            Auto detect the IDE secondary master PIO. (Default value)
- ▶▶ Mode 0        Select Mode 0 as IDE secondary master PIO.
- ▶▶ Mode 1        Select Mode 1 as IDE secondary master PIO.
- ▶▶ Mode 2        Select Mode 2 as IDE secondary master PIO.
- ▶▶ Mode 3        Select Mode 3 as IDE secondary master PIO.
- ▶▶ Mode 4        Select Mode 4 as IDE secondary master PIO.

### ☞ Primary Slave PIO

- ▶▶ Auto            Auto detect the IDE secondary slave PIO. (Default value)
- ▶▶ Mode 0        Select Mode 0 as IDE secondary slave PIO.
- ▶▶ Mode 1        Select Mode 1 as IDE secondary slave PIO.
- ▶▶ Mode 2        Select Mode 2 as IDE secondary slave PIO.
- ▶▶ Mode 3        Select Mode 3 as IDE secondary slave PIO.
- ▶▶ Mode 4        Select Mode 4 as IDE secondary slave PIO.

### ☞ Primary Master UDMA

- ▶▶ Auto            Auto detect the IDE Primary Master Ultra DMA in the specified IDE channel. (Default value)
- ▶▶ Disabled      Disable this function.

### ☞ Primary Slave UDMA

- ▶▶ Auto            Auto detect the IDE Primary Slave Ultra DMA in the specified IDE channel. (Default value)
- ▶▶ Disabled      Disable this function.

### ☞ **OnChip IDE Channel 1**

- ▶▶ Enabled      Enable onboard Onchip IDE Channel 0. (Default value)
- ▶▶ Disabled      Disable this function.

### ☞ **Secondary Master PIO**

- ▶▶ Auto            Auto detect the IDE secondary master PIO. (Default value)
- ▶▶ Mode 0        Select Mode 0 as IDE secondary master PIO.
- ▶▶ Mode 1        Select Mode 1 as IDE secondary master PIO.
- ▶▶ Mode 2        Select Mode 2 as IDE secondary master PIO.
- ▶▶ Mode 3        Select Mode 3 as IDE secondary master PIO.
- ▶▶ Mode 4        Select Mode 4 as IDE secondary master PIO.

### ☞ **Secondary Slave PIO**

- ▶▶ Auto            Auto detect the IDE secondary slave PIO. (Default value)
- ▶▶ Mode 0        Select Mode 0 as IDE secondary slave PIO.
- ▶▶ Mode 1        Select Mode 1 as IDE secondary slave PIO.
- ▶▶ Mode 2        Select Mode 2 as IDE secondary slave PIO.
- ▶▶ Mode 3        Select Mode 3 as IDE secondary slave PIO.
- ▶▶ Mode 4        Select Mode 4 as IDE secondary slave PIO.

### ☞ **Secondary Master UDMA**

- ▶▶ Auto            Auto detect the IDE Primary Master Ultra DMA in the specified IDE channel. (Default value)
- ▶▶ Disabled      Disable this function.

### ☞ **Secondary Slave UDMA**

- ▶▶ Auto            Auto detect the IDE Primary Slave Ultra DMA in the specified IDE channel. (Default value)
- ▶▶ Disabled      Disable this function.



---

**☞ IDE DMA transfer access**

- ▶▶ Enabled      Enable IDE DMA transfer access. (Default value)
- ▶▶ Disabled     Disable this function.

**☞ Serial-ATA Controller**

- ▶▶ All Enabled    Enable all serial device controllers. (Default value)
- ▶▶ Disabled     Disable this device.
- ▶▶ SATA-1       Only enable SATA-1 device.

**☞ IDE Prefetch Mode**

- ▶▶ Enabled      Enable IDE Prefetch Mode. (Default value)
- ▶▶ Disabled     Disable this function.

**☞RAID Enable**

- ▶▶ Enabled      Enable RAID function.
- ▶▶ Disabled     Disable this function. (Default value)

**☞SATA1 Primary RAID**

- ▶▶ Enabled      Enable SATA1 Primary RAID function.
- ▶▶ Disabled     Disable this function. (Default value)

**☞SATA1 Secondary RAID**

- ▶▶ Enabled      Enable SATA1 Secondary RAID function.
- ▶▶ Disabled     Disable this function. (Default value)

**☞SATA2 Primary RAID**

- ▶▶ Enabled      Enable SATA1 Primary RAID function.
- ▶▶ Disabled     Disable this function. (Default value)

**☞SATA2 Secondary RAID**

- ▶▶ Enabled      Enable SATA1 Secondary RAID function.
- ▶▶ Disabled     Disable this function. (Default value)

---

**☞ OnChip USB**

- ▶▶ Options V1.1+V2.0, V1.1, Disabled.  
Default value is V1.1+V2.0

**☞ USB Memory Type**

- ▶▶ Options SHADOW, Base Memory (640K).

**☞ USB Keyboard Support**

- ▶▶ Enabled Enable USB Keyboard Support.
- ▶▶ Disabled Disable USB Keyboard Support. (Default value)

**☞ USB Mouse Support**

- ▶▶ Enabled Enable USB Mouse Support.
- ▶▶ Disabled Disable USB Mouse Support. (Default value)

**☞ MAC LAN**

- ▶▶ Auto Auto detect onboard H/W LAN. (Default value)
- ▶▶ Disabled Disable this function.

**☞ MAC Media Interface**

This BIOS feature determines which MAC interface is used to connect the Gigabit MAC to the external PHY devices.

- ▶▶ Pin Strap When set to Pin Strap, the Gigabit MAC will automatically determine the right interface by querying the interface pins. (Default value)
- ▶▶ MII When set to MII, the Gigabit MAC is set to use the MII which will be connected to Fast Ethernet PHY devices. This only allows transfers of up to 100Mbps.
- ▶▶ RGMII When set to RGMII, the Gigabit MAC is set to use the RGMII which will be connected to reduced pin-count Gigabit PHY devices. This allows transfers of up to 1000Mbps.

### ☞ **2nd LAN Controller**

- ▶▶ Auto Auto detect onboard second H/W LAN. (Default value)
- ▶▶ Disabled Disable this function.

### ☞ **IDE HDD Block Mode**

The IDE HDD Block Mode feature speeds up hard disk access by transferring data from multiple sectors at once instead of using the old single sector transfer mode. When you enable it, the BIOS will automatically detect if your hard disk supports block transfers and configure the proper block transfer settings for it. Up to 64KB of data can be transferred per interrupt with IDE HDD Block Mode enabled.

- ▶▶ Enabled Enable IDE HDD Block Mode. (Default value)
- ▶▶ Disabled Disable this function.

### ☞ **Onboard FDC Controller**

- ▶▶ Enabled Select "enabled" to active Onboard Floppy Controller. (Default value)
- ▶▶ Disabled Disable this function.

### ☞ **Onboard Serial Port 1**

- ▶▶ Auto BIOS will automatically setup the port 1 address.
- ▶▶ 3F8/IRQ4 Enable onboard Serial port 1 and set IO address to 3F8. (Default value)
- ▶▶ 2F8/IRQ3 Enable onboard Serial port 1 and set IO address to 2F8.
- ▶▶ 3E8/IRQ4 Enable onboard Serial port 1 and set IO address to 3E8.
- ▶▶ 2E8/IRQ3 Enable onboard Serial port 1 and set IO address to 2E8.
- ▶▶ Disabled Disable onboard Serial port 1.

### ☞ **Onboard Serial Port 2**

- ▶▶ Auto BIOS will automatically setup the port 2 address.
- ▶▶ 3F8/IRQ4 Enable onboard Serial port 2 and set IO address to 3F8.
- ▶▶ 2F8/IRQ3 Enable onboard Serial port 2 and set IO address to 2F8. (Default value)
- ▶▶ 3E8/IRQ4 Enable onboard Serial port 2 and set IO address to 3E8.
- ▶▶ 2E8/IRQ3 Enable onboard Serial port 2 and set IO address to 2E8.
- ▶▶ Disabled Disable onboard Serial port 2.

---

### ☞ **UART Mode Select**

- ▶▶ Normal Using as standard serial port. (Default value)
- ▶▶ IrDA Using as IR and set to IrDA mode.
- ▶▶ ASKIR Using as IR and set to ASKIR mode.
- ▶▶ SCR Using as Smart Card Interface.

### ☞ **UR2 Duplex Mode**

This entry can be adjust when user select [IrDA] in UART Mode item.

- ▶▶ Full IR function Duplex Full.
- ▶▶ Half IR function Duplex Half.

### ☞ **Onboard Parallel Port**

- ▶▶ 378/IRQ7 Enable onboard LPT port and set address to 378/IRQ7. (Default value)
- ▶▶ 278/IRQ5 Enable onboard LPT port and set address to 278/IRQ5.
- ▶▶ 3BC/IRQ7 Enable onboard LPT port and set address to 3BC/IRQ7.
- ▶▶ Disabled Disable onboard LPT port.

### ☞ **Parallel Port Mode**

- ▶▶ 3BC/IRQ7 Enable onboard LPT port and set address to 3BC/IRQ7.
- ▶▶ Disabled Disable onboard LPT port.
- ▶▶ SPP Using Parallel port as Standard Parallel Port. (Default value)
- ▶▶ EPP Using Parallel port as Enhanced Parallel Port.
- ▶▶ ECP Using Parallel port as Extended Capabilities Port.
- ▶▶ ECP+EPP Using Parallel port as ECP & EPP mode.
- ▶▶ Normal Using Parallel port as Normal.

### ☞ **ECP Mode Use DMA**

This option is only available if the setting for the Parallel Port Mode option is ECP. This option sets the DMA channel used by parallel port.

The options: 1, 3 (Default value)



---

**☞ ACPI Function**

- ▶▶ Enabled            Enable ACPI function. (Default Value)
- ▶▶ Disabled           Disable this function.

**☞ ACPI Suspend Type**

- ▶▶ S1(POS)            Set ACPI suspend type to S1.
- ▶▶ S3(STR)            Set ACPI suspend type to S3.
- ▶▶ S1, S3             Set ACPI suspend type to S1&S3. (Default value)

**☞ Soft-off by PBTIN**

- ▶▶ Instant-off         Press power button then Power off instantly. (Default)
- ▶▶ Delay 4 Sec.        Press power button 4 sec to Power off. Enter suspend if button is pressed less than 4 sec.

**☞ WOL (PME#) From Soft-Off**

- ▶▶ Disabled           Disable Wake Up On LAN and PME wakeup function. (Default value)
- ▶▶ Enabled            Enable Wake Up On Ring function.

**☞ WOR (RI#) From Soft-off**

- ▶▶ Disabled           Disable Wake Up On Ring function. (Default value)
- ▶▶ Enabled            Enable Wake Up On Ring function.

**☞ Power -On by Alarm**

You can set "Power -On by Alarm" item to enabled and key in Data/time to power on system.

- ▶▶ Disabled           Disable this function. (Default value)
- ▶▶ Enabled            Enable alarm function to POWER ON system.

If Power on by Alarm Lead To Power On is Enabled.

Date ( of Month) Alarm :            Everyday, 0~31 (0 indicates repeat daily)

Time ( hh: mm: ss) Alarm :         (0~23) : (0~59) : (0~59)

## PnP/PCI Configuration

Phoenix-Award WorkstationBIOS CMOS Setup Utility		
Advanced		
PnP/PCI Configuration		Item Help
Init Display First	[PCIEx]	
Reset Configuration Data	[Disabled]	
Resource Controller By	[Auto (ESCD)]	
x IRQ Resource		
PCI VGA Palette Snoop	[Disabled]	
***** PCI Express relative items *****		
Maximum Payloads Size	[4096]	
↑↓ → ← : Move    Enter: Select +/-/PU/PD: Value    F10: Save    ESC: Exit    F1: General Help F5: Previous Values    F7: Optimized Defaults		

Figure 2-5: PnP/PCI Configuration

### ☞ Init Display First

This feature allows you to select the first initiation of the monitor display from which card, when you install an AGP VGA card and a PCI VGA card on board.

- ▶▶ PCIEx                      Set Init Display First to PCI Express Slot. (Default value)
- ▶▶ PCI Slot                    Set Init Display First to PCI Slot.

### ☞ Reset Configuration Data

- ▶▶ Yes                          Clear the Extended System Configuration Data (ESCD) area.
- ▶▶ No                            Disable this function. (Default value)



---

### ☞ Resource Controller By

This BIOS item provides function for configuring all of the boot and Plug & Play compatible devices. Normally, user should set this item Auto, then the BIOS can automatically assign the IRQs and DMA channels. All the IRQ and DMA assignment fields should disappear as a result.

But if you are having problems assigning the resources automatically via the BIOS, you can select Manual to reveal the IRQ and DMA assignment fields. Then you can assign each IRQ or DMA channel to either Legacy ISA or PCI/ISA PnP devices.

▶▶ Options                      Auto (ESCD), Manual. Default value is Auto (ESCD).

### ☞ PCI VGA Palette Snoop

This option is only useful if you use an MPEG card or an add-on card that makes use of the graphics card's Feature Connector. It corrects incorrect color reproduction by "snooping" into the graphics card's framebuffer memory and modifying (synchronizing) the information delivered from the graphics card's Feature Connector to the MPEG or add-on card. It will also solve the problem of display inversion to a black screen after using the MPEG card.

▶▶ Enabled                      Enable PCI VGA Palette Snoop.  
▶▶ Disabled                      Disable this function. (Default value)

### ☞ Maximum Payloads Size

This option provides function for user to set the maximum TLP payloads size for the PCI Express devices. The unit is "byte".

▶▶ Options                      128, 256, 512, 1024, 2048, 4096.

## Security

Phoenix-Award WorkstationBIOS CMOS Setup Utility					
Main	Advanced	Security	Boot	PC Health	Exit
Set Supervisor Password				Item Help	
Set User Password					
Supervisor Password Status		Not Installed			
User Password Status		Not Installed			
Security Option		[Setup]			
↑↓→← : Move    Enter: Select +/-/PU/PD: Value    F10: Save    ESC: Exit    F1: General Help F5: Previous Values    F7: Optimized Defaults					

Figure 3: Security

When you select this function, the following message will appear at the center of the screen to assist you in creating a password.

Type the password, up to eight characters, and press <Enter>. You will be asked to confirm the entered password. Type the password again and press <Enter>. You may also press <Esc> to abort the selection and not enter a password.

To disable password, just press <Enter> when you are prompted to enter password. A message "PASSWORD DISABLED" will appear to confirm the password being disabled. Once the password is disabled, the system will boot and you can enter Setup freely.

The BIOS Setup program allows you to specify two separate passwords:

SUPERVISOR PASSWORD and a USER PASSWORD. When disabled, anyone may access all BIOS Setup program function. When enabled, the Supervisor password is required for entering the BIOS Setup program and having full configuration fields, the User password is required to access only basic items.

If you select "System" at "Password Check" in Advance BIOS Features Menu, you will be prompted for the password every time the system is rebooted or any time you try to enter Setup Menu.

If you select "Setup" at "Password Check" in Advance BIOS Features Menu, you will be prompted only when you try to enter Setup.

### ☞ Security Option

Select whether the password is required every time when the system boots or only when user enter the setup.

## Boot

Phoenix-Award WorkstationBIOS CMOS Setup Utility	
Main	Advanced Security Boot PC Health Exit
<ul style="list-style-type: none"> <li>▶ Removable Device Priority</li> <li>▶ Hard Disk Boot Priority</li> <li>▶ CD-ROM Boot Priority</li> <li>▶ Network Boot Priority</li> </ul>	Item Help
↑↓→← : Move    Enter: Select +/-/PU/PD: Value    F10: Save    ESC: Exit    F1: General Help F5: Previous Values    F7: Optimized Defaults	

Figure 4: Boot

### **⚡ About This Section: Boot**

The "Boot" menu allows user to select among four possible types of boot devices listed using the up and down arrow keys. By applying <+> and <Space> key, you can promote devices and by using the <-> key, you can demote devices. Promotion or demotion of devices alerts the priority that the system uses to search for boot device on system power on.

### **🔓 Removable Device / Hard Drive / CD-ROM Drive/ Network Boot Priority**

These three fields determines which type of device the system attempt to boot from after BIOS Post completed. Specifies the boot sequence from the available devices. If the first device is not a bootable device, the system will seek for next available device.

## PC Health

Phoenix-Award WorkstationBIOS CMOS Setup Utility		
Main	Advanced	Security Boot PC Health Exit
Shutdown Temperature	[Disabled]	Item Help
VCC		
VCORE		
+3.3V		
+12V		
DDR 1.8V		
3VDUAL		
Voltage Battery		
System Temperature1		
System Temperature2		
CPU Temperature		
SYS Fan 1 Temperature		
SYS Fan 2 Temperature		
SYS Fan 3 Temperature		
SYS Fan 4 Temperature		
Fan Control Mode		
↑↓→← : Move    Enter: Select +/-PU/PD: Value    F10: Save    ESC: Exit    F1: General Help F5: Previous Values    F7: Optimized Defaults		

Figure 5: PC Health

---

**⚙ Shutdown Temperature**

- ▶▶ Determine CPU overheat shutdown temperature.

**⚙ Voltage: VCC/VCORE +3.3V/ +12V/DDR 1.8V/ 3VDUAL/****Voltage Battery**

- ▶▶ Detect system's voltage status automatically.

**⚙ CPU /System 1/ System 2 Temperature**

- ▶▶ Display the current CPU temperature, System1 & 2 ambient temperature.

**⚙ CPU SYS 1/2/3/4 FAN Speed (RPM)**

- ▶▶ Display the current CPUs and System 1/2/3/4 FAN speed.

**⚙ Fan Control Mode**

- ▶▶ Depend on CPU Temp      Control by CPU temperature. (Default value)
- ▶▶ Control By CPU&SYS1      Control by CPU and System 1 temperature.

## Exit

Phoenix-Award WorkstationBIOS CMOS Setup Utility					
Main	Advanced	Security	Boot	PC Health	Exit
Load Optimized Defaults				Item Help	
Save & Exit Setup					
Exit Without Saving					
↑↓→← : Move    Enter: Select +/-/PU/PD: Value    F10: Save    ESC: Exit    F1: General Help F5: Previous Values    F7: Optimized Defaults					

Figure 7: Exit

### ☞ Load Optimized Defaults

When you press <Enter> on this item, you will get a confirmation dialog box with a message as below:

Load Optimal Defaults? ((Y/N) Y

### ☞ Save & Exit Setup

Type "Y" will quit the Setup Utility and save the user setup value to RTC CMOS.

Type "N" will return to Setup Utility.

### ☞ Exit Without Saving

Type "Y" will abandon all data and quit without saving.

Type "N" will return to Setup Utility.

## Chapter 4 Application Driver Installation

### A. NVIDIA Chipset Driver Installation

Insert the driver CD-title that came with your motherboard into your CD-ROM driver, the driver CD-title will auto start and show the installation guide. If not, please double click the CD-ROM device icon in "My computer", and execute the setup.exe.

#### Installation Procedures:

1. The CD auto run program starts, Click on "nVIDIA Chipset Driver" to start the installation.
2. Then, a series of installation wizards appear. Follow up the wizards to install the drivers.
3. Setup completed, click "Finish" to restart your computer.

#### 1. Autorun



2. InstallShield Wizard Welcome Window

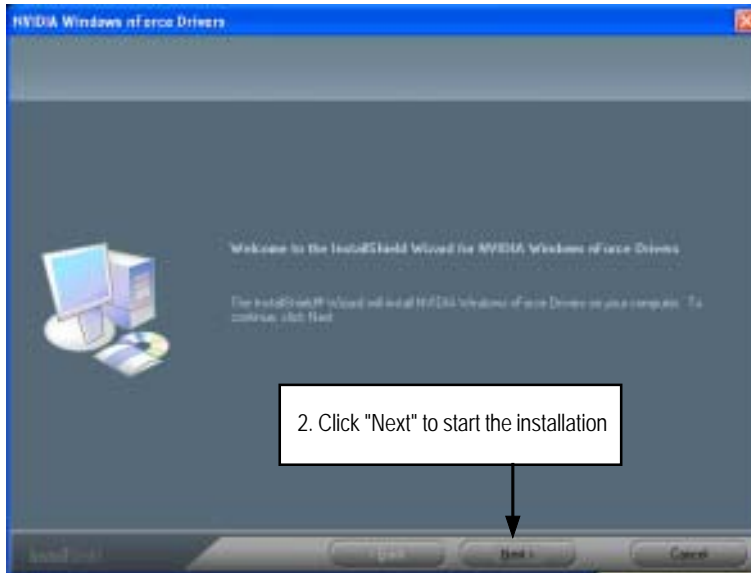

3. Select Features

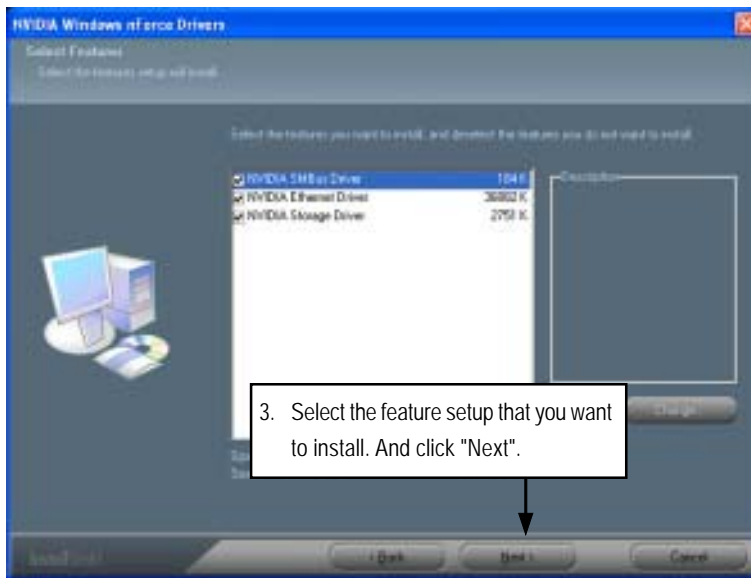



4. NVIDIA IDE SW Driver Information

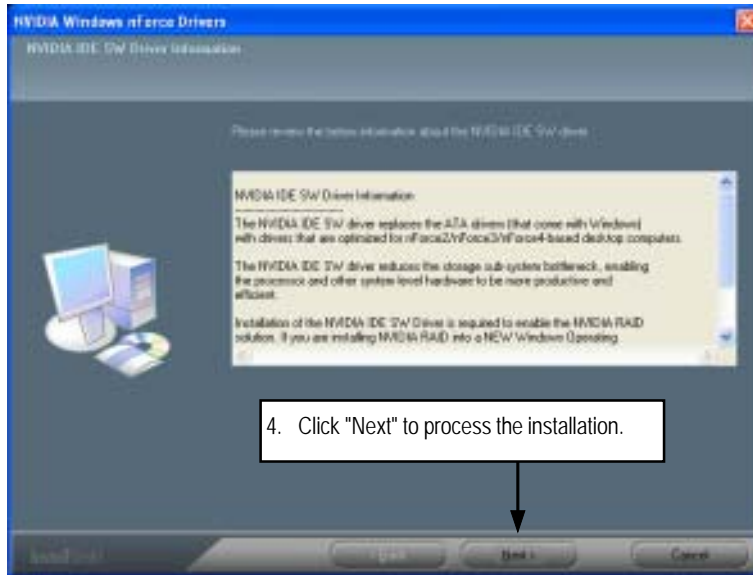

5. IDE SW Driver Installation Confirmation Dialog

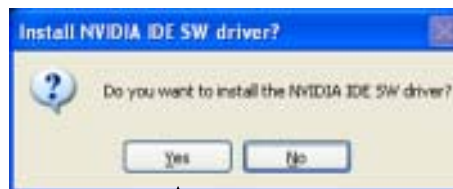

6. Firewall and ForceWare Network Access Manager Installation Confirmation Dialog

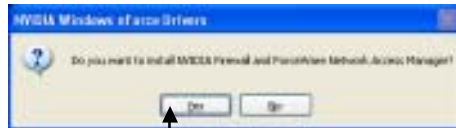

6. Click "Yes".

7. Network Access Manager Installation

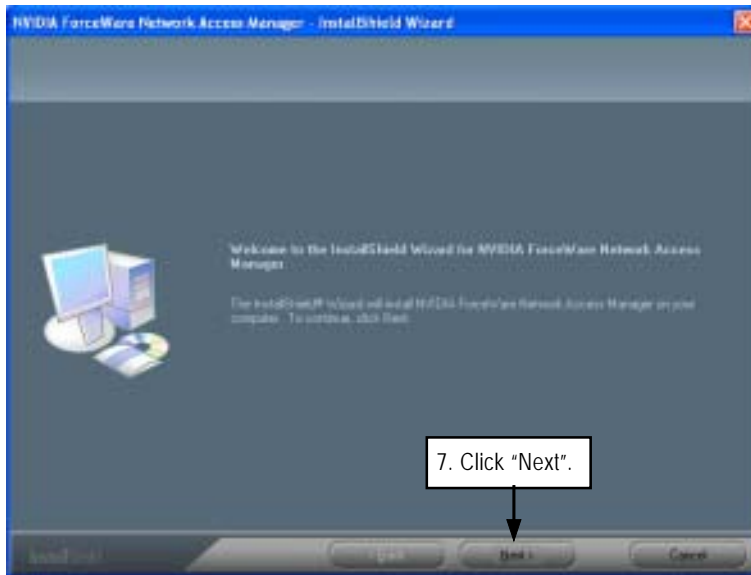

7. Click "Next".

## 8. Network Access Manager Setup Type Selection

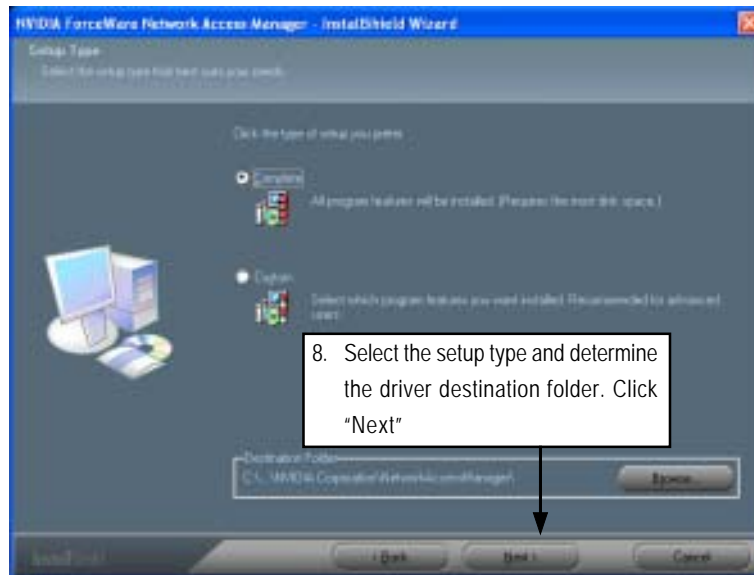

## 9. Network Access Manager Installation Language Preference

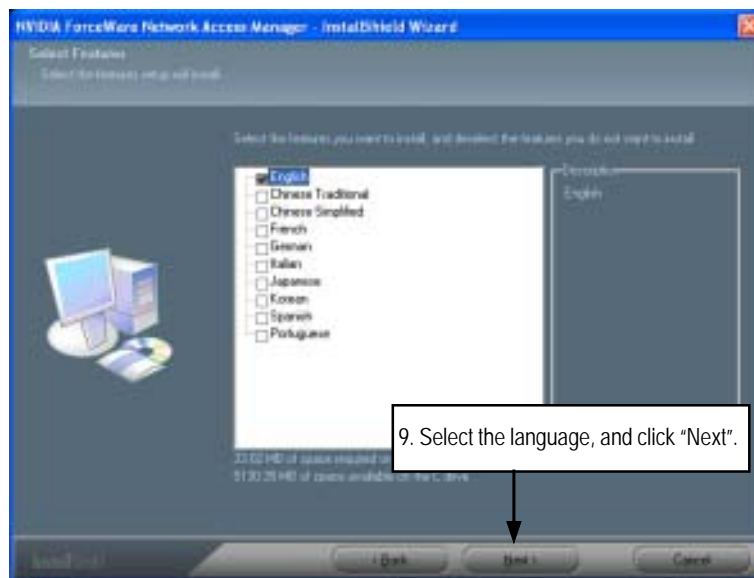

10. ActiveArmor FireWall Installation

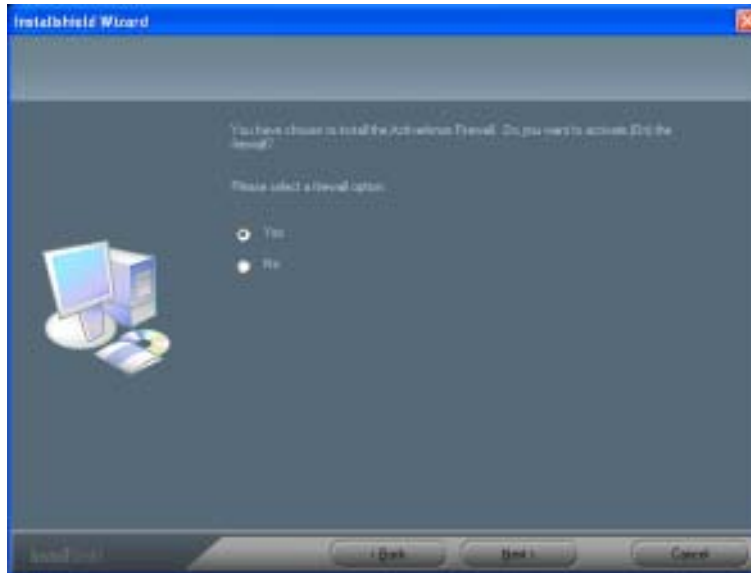

11. Installation Complete. Restart Computer

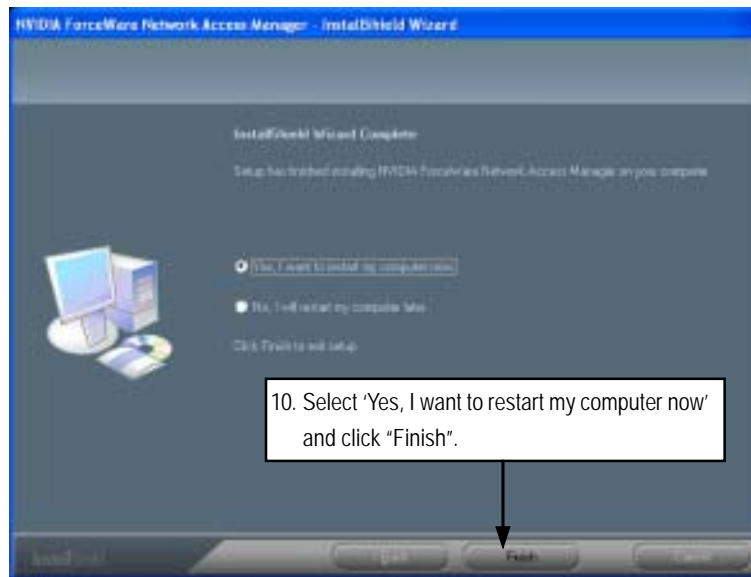

## B. nVIDIA VGA Driver Installation

Insert the driver CD-title that came with your motherboard into your CD-ROM driver, the driver CD-title will auto start and show the installation guide. If not, please double click the CD-ROM device icon in "My computer", and execute the setup.exe.

### Installation Procedures:

1. The CD auto run program starts, **Click** on "nVIDIA VGA Driver" to start the installation.
2. Then, a series of installation wizards appear. Follow up the wizards to install the drivers.
3. Setup completed, click "Finish" to restart your computer.

### 1. Autorun



2. InstallShield Wizard Welcom Window

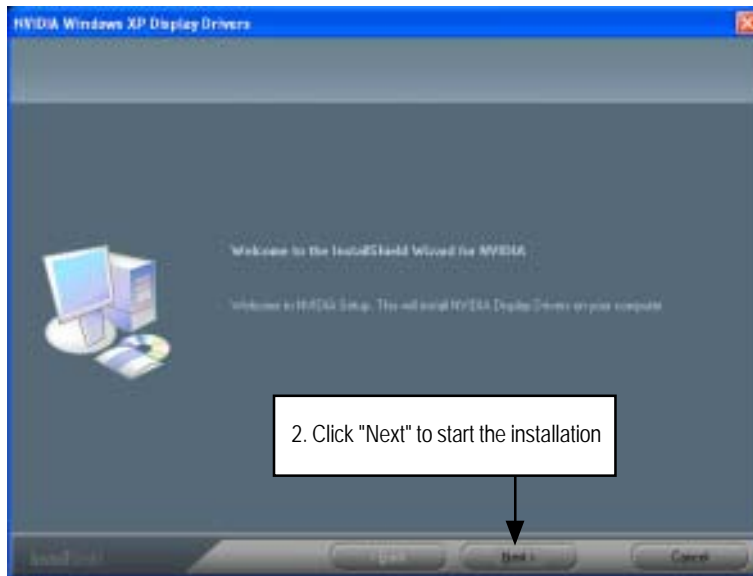

3. Installaiton Wizard Completed

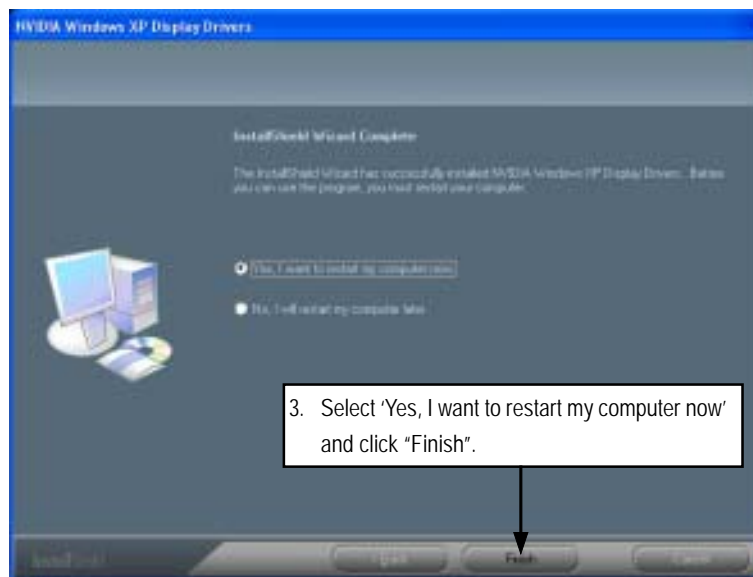

### C. Marvell LAN Driver Installation

Insert the driver CD-title that came with your motherboard into your CD-ROM driver, the driver CD-title will auto start and show the installation guide. If not, please double click the CD-ROM device icon in "My computer", and execute the setup.exe.

#### Installation Procedures:

1. The CD auto run program starts, Click on "Marvell LAN Driver" to start the installation.
2. Then, a series of installation wizards appear. Follow up the wizards to install the drivers.
3. Setup completed, click "Finish" to restart your computer.

#### 1. Autorun



2. InstallShield Wizard Welcome Window

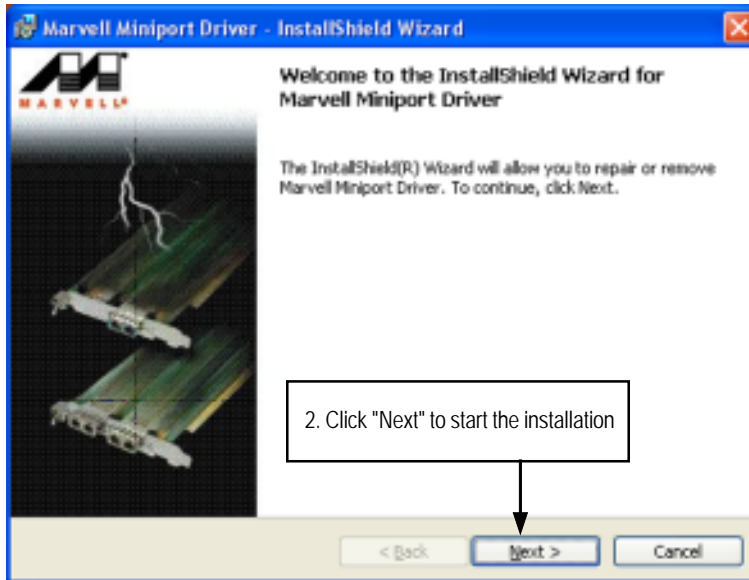

3. License Agreement

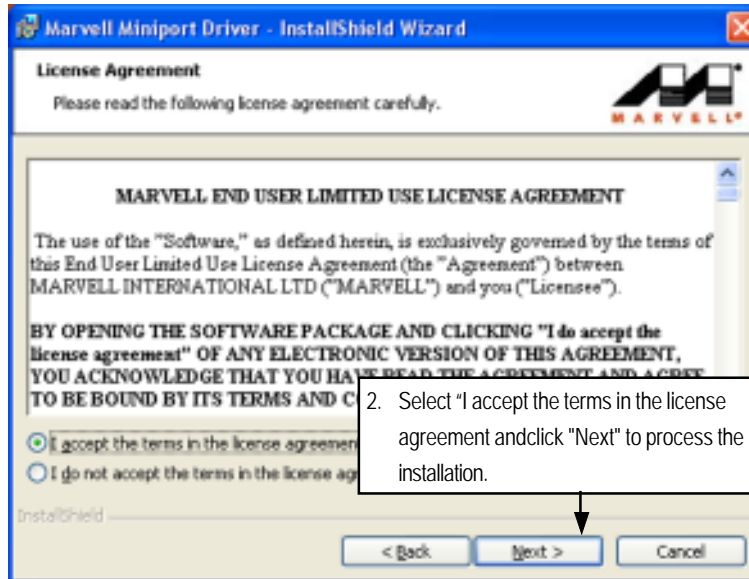



4. Ready to Install the Program



5. Installaiton Wizard Completed



#### D. DirectX 9.0 Driver Installation

Insert the driver CD-title that came with your motherboard into your CD-ROM driver, the driver CD-title will auto start and show the installation guide. If not, please double click the CD-ROM device icon in "My computer", and execute the setup.exe.

##### Installation Procedures:

1. The CD auto run program starts, **Double click** on "Directx9.0" to start the installation.
2. Then, a series of installation wizards appear. Follow up the wizards to install the drivers.
3. Setup completed, click "Finish" to restart your computer.

##### 1. Autorun



2. License Agreement



3. Start Installation

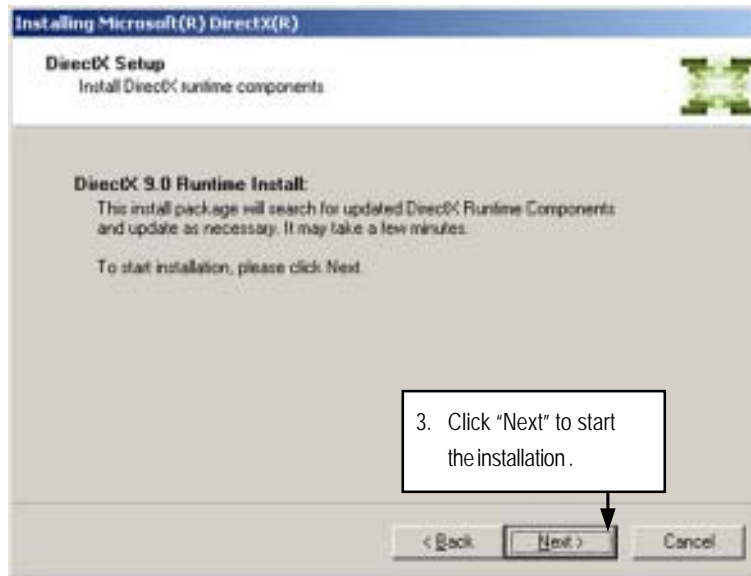

4. Installaiton Wizard completed

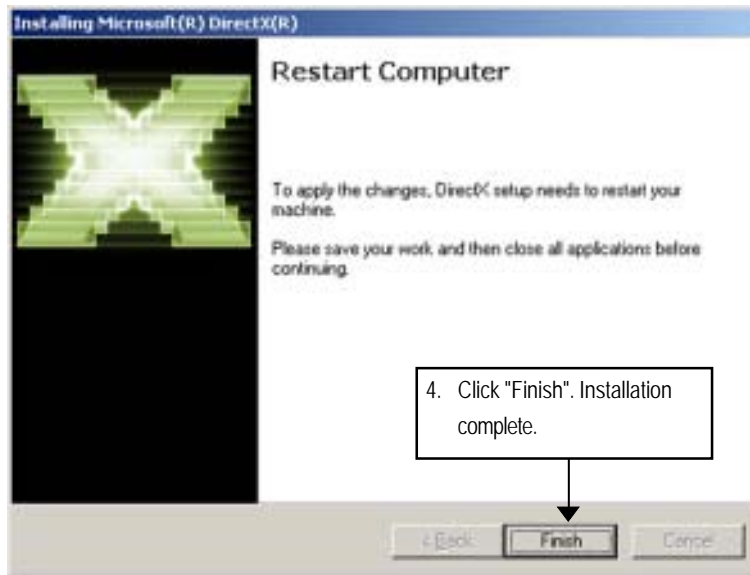

## Chapter 5 Appendix

### Appendix : Acronyms

Acronyms	Meaning
ACPI	Advanced Configuration and Power Interface
APM	Advanced Power Management
AGP	Accelerated Graphics Port
AMR	Audio Modem Riser
ACR	Advanced Communications Riser
BBS	BIOS Boot Specification
BIOS	Basic Input / Output System
CPU	Central Processing Unit
CMOS	Complementary Metal Oxide Semiconductor
CRIMM	Continuity RIMM
CNR	Communication and Networking Riser
DMA	Direct Memory Access
DMI	Desktop Management Interface
DIMM	Dual Inline Memory Module
DRM	Dual Retention Mechanism
DRAM	Dynamic Random Access Memory
DDR	Double Data Rate
ECP	Extended Capabilities Port
ESCD	Extended System Configuration Data
ECC	Error Checking and Correcting
EMC	Electromagnetic Compatibility
EPP	Enhanced Parallel Port
ESD	Electrostatic Discharge
FDD	Floppy Disk Device
FSB	Front Side Bus
HDD	Hard Disk Device
IDE	Integrated Dual Channel Enhanced
IRQ	Interrupt Request

to be continued.....

---

GA-3PXSL-RH Motherboard

---

Acronyms	Meaning
I/O	Input / Output
IOAPIC	Input Output Advanced Programmable Input Controller
ISA	Industry Standard Architecture
LAN	Local Area Network
LBA	Logical Block Addressing
LED	Light Emitting Diode
MHz	Megahertz
MIDI	Musical Instrument Digital Interface
MTH	Memory Translator Hub
MPT	Memory Protocol Translator
NIC	Network Interface Card
OS	Operating System
OEM	Original Equipment Manufacturer
PAC	PCI A.G.P. Controller
POST	Power-On Self Test
PCI	Peripheral Component Interconnect
RIMM	Rambus in-line Memory Module
SCI	Special Circumstance Instructions
SECC	Single Edge Contact Cartridge
SRAM	Static Random Access Memory
SMP	Symmetric Multi-Processing
SMI	System Management Interrupt
USB	Universal Serial Bus
VID	Voltage ID

---

## Free Manuals Download Website

<http://myh66.com>

<http://usermanuals.us>

<http://www.somanuals.com>

<http://www.4manuals.cc>

<http://www.manual-lib.com>

<http://www.404manual.com>

<http://www.luxmanual.com>

<http://aubethermostatmanual.com>

Golf course search by state

<http://golfingnear.com>

Email search by domain

<http://emailbydomain.com>

Auto manuals search

<http://auto.somanuals.com>

TV manuals search

<http://tv.somanuals.com>