



SxA250

Compact Powered Sound
Reinforcement Speaker For:
Live Sound, Speech, Playback,
DJ, A/V, Institutional Venues



Key Features:

- Lightweight, Ergonomic Size - 49lb (22.2 kg)
- Angled Enclosure for Monitor Use
- Mic and Line Inputs with Mix Capability
- 350 W Dynamic LF Power
- 80 W Dynamic HF Power
- LF and HF Equalization
- Line Output for Additional Speakers
- 80° x 55° Constant Coverage Horn
- High Sensitivity, 126 dB Maximum SPL
- Dynamic Filters Provide Overload Protection and Linear Response
- Built-in Pole Mount
- Easily Suspended with Optional Rigging Kit



General Description:

The SxA250 sets a new standard for powered speakers. Its design provides the user multiple inputs with mix capability, an easy to use EQ section, and plenty of power in a very compact, attractive package.

This is a full range loudspeaker ideal for applications requiring high-quality sound. Careful attention to the dynamic requirements of music guided the amplifier design to provide high SPL. The high quality microphone preamplifier provides great sounding vocals or speech. A master level control sets the desired SPL, and the line input can be mixed and balanced with a microphone with its level control. Its linear response is easily optimized for speech or music with the on board multiband equalization.

Built-in pole mount and optional rigging hardware make it easy to position for your application.

The high-frequency section of the SxA250 utilizes a molded-in, 80° x 55° constant-directivity horn. This unique pattern contributes to high intelligibility. Vocals sound natural yet "cut through" reverberant, noisy rooms. Coverage pattern is uniform and sound quality off-axis is very well maintained, even at 40° off axis (an 80° total coverage angle). The SxA250's high-frequency horn is driven by the DH2010A, a 1.25 inch diaphragm, wide-bandwidth, titanium-diaphragm driver using a unique, convex-drive TimePath™ phasing plug structure (U.S. Patent #4,525,604) for smooth and extended high-frequency response.

Technical Specifications:

Freq. Response (-10 dB):	55Hz-20kHz
Max SPL:	126 dB
Horizontal Coverage:	80°
Vertical Coverage:	55°
LF Amplifier Power:	350W 10ms burst, 150W Continuous
HF Amplifier Power:	80W 10ms burst, 50W Continuous
Mic Input Sensitivity:	-35 dBu to 0 dBu for full output
Line Input Sensitivity:	-12 dBu to 0 dBu for full output
LF Transducer:	15" (381mm)
HF Transducer:	1.25" (32mm) exit Compression Driver
Connectors:	
Bal. Inputs; Mic, Line :	XLR, XLR & ¼" phone Combination
Balanced Output:	XLR
Equalization:	Shelving; LF ±6dB @ 140Hz HF ±4dB @ 5kHz
Power Requirement:	110-130 VAC, 50-60Hz, or 220-240 VAC, 50-60Hz 600 Watts
Enclosure Material:	7-ply Plywood
Grille:	Powder Coated Steel with Cloth
Dim (H x W x D):	24.6" x 17.2" x 13.1" (625mm x 437mm x 333mm)
Net Weight (each):	49 lbs (22.2 kg)
Shipping Weight:	53 lbs (24.0 kg)

Block Diagram:

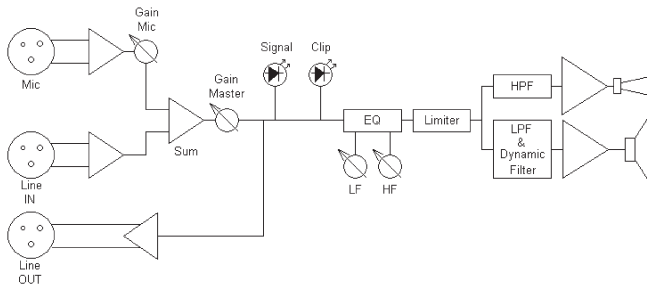

Frequency Response:

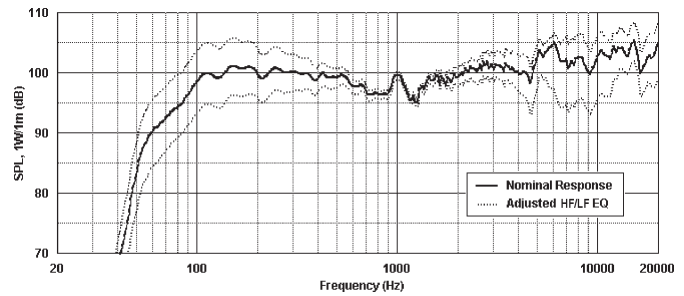

Dimension Drawings:

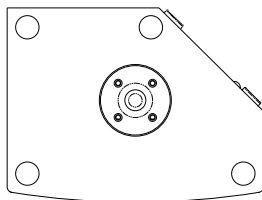
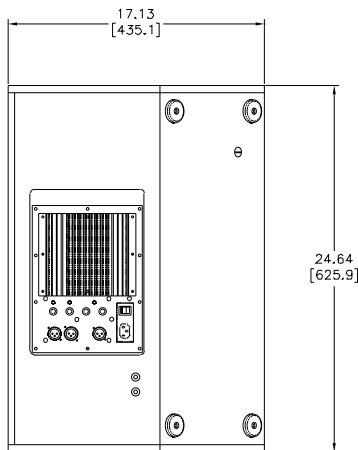
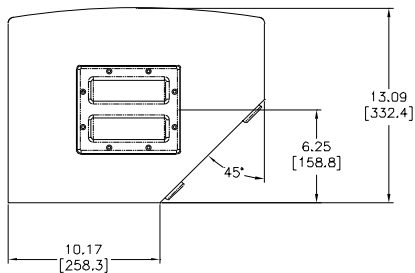

Beamwidth:

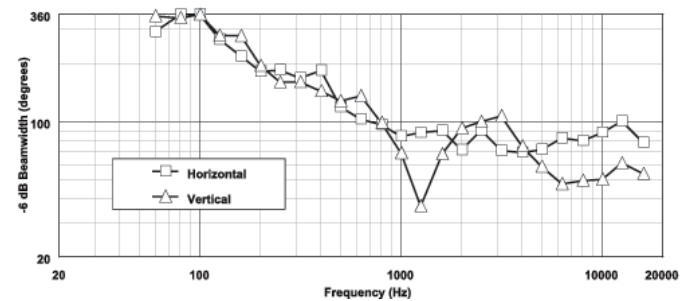

Directivity:

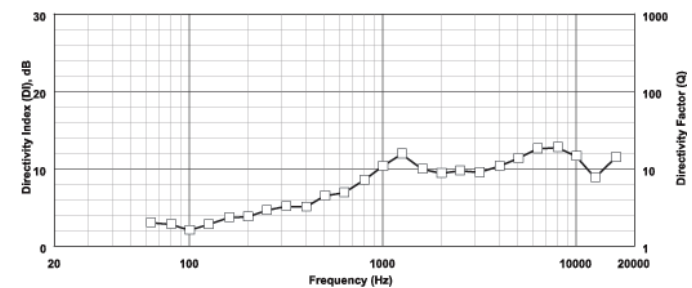

Performance Match:

- SxA180 Sub

Available Accessories:

- SK1 Rigging Hardware
- 100BK Tripod Stand

SxA250 Part Numbers

- 301221-001 120V
- 301221-003 230V

EV Electro-Voice®

12000 Portland Avenue South, Burnsville, MN 55337
Phone: 952/884-4051, Fax: 952/884-0043

www.electrovoice.com

© Telex Communications, Inc. 11/2001

Part Number 38110-076 Rev A

U.S.A. and Canada only. For customer orders, contact Customer Service at:

800/392-3497 Fax: 800/955-6831

Europe, Africa, and Middle East only. For customer orders, contact Customer Service at:

+ 49 9421-706 0 Fax: + 49 9421-706 265

Other International locations. For customer orders, contact Customer Service at:

+ 1 952 884-4051 Fax: + 1 952 887-9212

For warranty repair or service information, contact the Service Repair department at:

800/685-2606

For technical assistance, contact Technical Support at: 866/78AUDIO

Specifications subject to change without notice.

Free Manuals Download Website

<http://myh66.com>

<http://usermanuals.us>

<http://www.somanuals.com>

<http://www.4manuals.cc>

<http://www.manual-lib.com>

<http://www.404manual.com>

<http://www.luxmanual.com>

<http://aubethermostatmanual.com>

Golf course search by state

<http://golfingnear.com>

Email search by domain

<http://emailbydomain.com>

Auto manuals search

<http://auto.somanuals.com>

TV manuals search

<http://tv.somanuals.com>