



Hand Held Hard Surface Steam Cleaner

Owner's Manual
Model: SC717XH
120V., 1000W.



USA: EURO-PRO OPERATING LLC
94 Main Mill Street, Door 16
Plattsburg, NY 12901

Canada: EURO-PRO OPERATING LLC
4400 Bois Franc
St. Laurent, QC H4S 1A7

Tel.: 1 (800) 798-7398

IMPORTANT SAFETY INSTRUCTIONS

When using your **Hand Held Hard Surface Steam Cleaner**, basic safety precautions should always be observed, including the following:

1. Read all instructions before using your steam cleaner.
 2. Use the system only for its intended use.
 3. To protect against a risk of electric shock, **do not** immerse any part of the system in water or other liquids.
 4. **Never** yank cord to disconnect from outlet; instead, grasp plug and pull to disconnect.
 5. **Do not** allow cord to touch hot surfaces. Let the system cool completely before putting away or opening water tank (removing the safety cap). Wrap cord loosely around system when storing.
 6. **Always** disconnect system from electrical outlet when filling with water or emptying and when not in use. Always turn the safety cap slowly when opening the water tank. This will allow any remaining steam to escape gradually.
 7. **Do not** operate the system with a damaged cord or plug, or if the appliance or any other part of the system has been dropped or damaged. To avoid the risk of electric shock, do not disassemble or attempt to repair the steam cleaner. Return the system to **EURO-PRO Operating LLC** (see warranty) for examination and repair. Incorrect re-assembly or repair can cause a risk of electrical shock or injury to persons when the steam cleaner is used.
 8. Close supervision is necessary for any appliance being used by or near children. **Do not** leave the system unattended while connected to electrical outlet or when hot.
 9. Burns can occur from touching hot metal parts, hot water or steam. Use caution when draining unit after use as there may be hot water in the unit. **Never** direct steam at any person. The steam is very hot and can cause burns.
 10. **Do not** operate in the presence of explosive and/or flammable fumes.
 11. This appliance is intended only for household use. Follow all user instructions in this manual.
 12. **Never** use any chemicals or substance other than tap water in the machine. Use of chemicals may damage the machine. Use of chemicals will automatically void your warranty.
- To reduce the risk of fire, electric shock, or injury:**
- **Do not** leave the steam cleaner plugged in when unattended. Unplug the electrical cord when not in use and before servicing or refilling water tank.
 - **Do not** allow to be used as a toy. Close attention is necessary when used by or near children, pets or plants.
 - Use only as described in this manual. Use only manufacturer's recommended accessories.
 - **Do not** pull cord, use cord as a handle, close a door on cord, or pull cord around sharp edges or corners. Keep cord away from heated surfaces.
 - **Do not** use extension cords or outlets with inadequate current carrying capacity.
 - **Do** turn off all controls as applicable before unplugging from electrical outlet.
 - **Do not** unplug by pulling on cord. To unplug, grasp the plug, not the cord.
 - **Do not** handle plug or steam cleaner with wet hands or operate without shoes.
 - **Do not** put any objects into openings. **Do not** use with any opening blocked.
 - **ALWAYS STORE YOUR APPLIANCE INDOORS** in a cool, dry area.
 - **Do** keep your work area well lit.
 - **Do Not turn the appliance over or on its side. Never direct steam towards people, animals or plants.**
 - **Do not** immerse the steam cleaner into water or other liquids. Always unplug the power cord from the electrical socket when filling the steam cleaner.
 - **DO NOT add cleaning solutions, scented perfumes, oils or any other chemicals to the water used in this appliance as this may damage the unit or make it unsafe for use.** Use tap water or distilled/purified water if the tap water in your area is very hard.

Model SC717XH

EURO-PRO 

ONE YEAR LIMITED WARRANTY

Your Steam Cleaner is warranted to be free from defects in material and workmanship for a period of one (1) year from the date of purchase when utilized for normal household use by the original purchaser only. The included Warranty Registration Card must be filled out and returned within 10 days of purchase. This is essential for your Warranty to be effective should any problem arise with this product.

Should any defect covered by the terms of the limited warranty be discovered within one year, **EURO-PRO Operating LLC** will repair or replace any defective part provided the unit is returned by the original purchaser, freight prepaid, to:

U.S.: **EURO-PRO Operating LLC**, 94 Main Mill Street, Door 16, Plattsburgh, NY 12901

Canada: **EURO-PRO Operating LLC**, 4400 Bois Franc, St. Laurent, Qc, H4S 1A7

Proof of purchase date and \$12.95 for handling and return packing/shipping charges must be included.*

The liability of under this warranty is limited solely to the cost of the replacement parts or the complete unit at our option. **LABOUR CHARGES ARE NOT INCLUDED.**

This warranty does not cover normal wear of parts and does not apply to any unit that has been tampered with or used for commercial purposes. This Limited Warranty does not cover damage caused by misuse, negligent handling, or damage due to faulty packaging or mishandling in transit (by any common carrier).

This warranty is extended to the original purchaser of the unit and excludes all other legal and/or conventional warranties. The responsibility of **EURO-PRO Operating LLC**, if any, is limited to the specific obligations expressly assumed by it under the terms of the limited warranty. In no event is **EURO-PRO Operating LLC** liable for incidental or consequential damages of any nature whatsoever. Some States/Provinces do not permit the exclusion or limitation of incidental or consequential damages, so the above may not apply to you.

This warranty gives you specific legal rights which vary from state to state or province to province.

***Important: Carefully pack item to avoid damage in shipping. Be sure to attach tag to item before packing with your name, complete address and phone number with note giving purchase information, model number and what you believe is the problem with item. We recommend you insure the package (as damage in shipping is not covered by your warranty). Mark the outside of your package "ATTENTION CUSTOMER SERVICE". We are constantly striving to improve our products, therefore the specifications contained herein are subject to change without notice.**



OWNERSHIP REGISTRATION CARD

Please fill out and mail the product registration card within ten (10) days of purchase. The registration will enable us to contact you in the unlikely event of a product safety notification. By returning this card you acknowledge to have read and understood the instructions for use, and warnings set forth in the accompanying instructions. Return to:

EURO-PRO Operating LLC, 94 MAIN MILL STREET, DOOR 16, PLATTSBURGH, NY 12901

Model SC717XH

Appliance model

Date purchased

Name of store

Owner's name

Address

City

State

Zip Code

SAVE THESE INSTRUCTIONS

For Household Use Only

Maintenance & Cleaning Instructions

Maintenance & Cleaning Instructions

Caution: This appliance must be unplugged from the electrical outlet and allowed to cool down before all cleaning and maintenance tasks.

- Let the appliance cool down completely before cleaning or storing.
- Empty all water from the water tank after each use.
- Store in a dry, cool place.
- A periodic rinse of your steam cleaner will free it from deposits. This is recommended every **10-15** tankfuls to free up any scale deposits. Fill the boiler with water and shake vigorously. Tilt the cleaner upside down to empty the boiler of water and any scale deposits.

Cleaning the Nozzles

Your steamer should not normally require cleaning, however, should you notice a marked decrease in steam output it may be necessary to remove mineral deposit build-up from the nozzle orifice. First ensure that there is water in the tank.

If tank is empty, fill with water, (we recommend using purified or distilled water), then re-start unit noting whether steam output is normal. If steam output is still low, follow these cleaning instructions:

1. Unplug steam cleaner from wall outlet.
2. Use a small diameter stiff metal wire such as a straightened metal paperclip and carefully insert the end of the wire into the nozzle orifice. (Fig. 10)

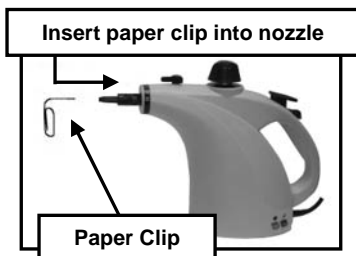

Fig. 10

3. Move wire back and forth several times to remove any deposits.
4. Reconnect appliance to power outlet, assure that the variable steam adjustment is in the maximum flow position, depress the trigger and note steam output.
5. If steam performance does not improve, descale your steam cleaner and then repeat steps #1 through #4.

Descaling Your Steam Cleaner

If the tap water in your area contains a high level of calcium deposits and you have been using tap water to do your steam cleaning, you should descale your unit after **10-15 tankfuls**.

1. Unplug the steam cleaner from the power source before you descale the boiler. Allow to cool.
2. Fill the boiler with **1 part vinegar and 5 parts water** and leave overnight or for a period of approximately **8 hours**.

Important Note: Do not screw the safety cap onto the steam cleaner while you are descaling the boiler. **Do not use the steam cleaner while descaling solution is inside the boiler.**

3. After the period of soaking, turn the steam cleaner upside down to empty solution from the boiler. Due to the fact that a small amount of solution will be left in the boiler, it is necessary to rinse the boiler out with clean water **2 or 3 times**. Your steam cleaner is now ready for use.

ADDITIONAL IMPORTANT SAFEGUARDS

1. To avoid circuit overload, **do not** operate another appliance on the same socket (circuit) as the steam cleaner.
2. If an extension cord is absolutely necessary, an extension cord rated a minimum of **15 ampere, 14 gage** cord should be used. Cords rated for less amperage may overheat. Care should be taken to arrange cord so that it cannot be pulled or tripped over.
3. **Do not** leave unattended when the system is connected to a power supply/electrical outlet.

Warning: This appliance is equipped with a grounded-type 3-wire cord (3-prong plug). This plug will only fit into an electrical outlet made for a 3-prong plug. This is a safety feature. If the plug should fail to fit the outlet, contact an electrician to replace the outlet. Do not attempt to defeat the safety purpose of the grounding pin, part of the 3-prong plug.

Caution: The force and heat of the steam may adversely affect certain materials. Always check the suitability of using the steam cleaner on a surface by carrying out a preliminary test on a hidden area.

Examples for **guidance** only:

- Varnished wood or glossy leather can be bleached by the effects of steam.
- Shiny plastic materials risk being tarnished.
- Acrylic, velvets and linen are very sensitive to the temperature of steam.

The manufacturer accepts no responsibility for damage caused to objects, materials, animals or persons due to the inappropriate use of steam, and through ignoring the advice and recommendations set down in the Owner's Manual.

Getting To Know Your Hand Held Hard Surface Steam Cleaner



- | | |
|------------------------------|------------------------------------|
| 1. Nozzle | 11. Nylon Detail Brush (x2) |
| 2. Variable Steam Adjustment | 12. Hose |
| 3. Safety Cap | 13. Angle Adapter |
| 4. Trigger Button | 14. Concentrator Nozzle |
| 5. Trigger Safety Lock | 15. Window Squeegee/Steam Diffuser |
| 6. Handle | 16. Measuring Cup |
| 7. Main Unit | 17. Funnel |
| 8. Power Cord | 18. Cleaning Cloth |
| 9. Heating Indicator Light | 19. Brass Detail Brush(x2) |
| 10. Steam Ready Light | 20. Storage case (not shown) |

Technical Specifications

Voltage: 120V., 60Hz.
 Power: 1,000 Watts
 Water Capacity: 10 oz. (300 ml)

*Illustrations may differ from actual product.

Operating Instructions

Nylon Detail Brush / Angle Adapter

- Both the angle adapter and the nylon detail brush can be used on the concentrator nozzle.
- To use, push either of the attachments onto the end of the concentrator nozzle. (Fig. 8 & 9)

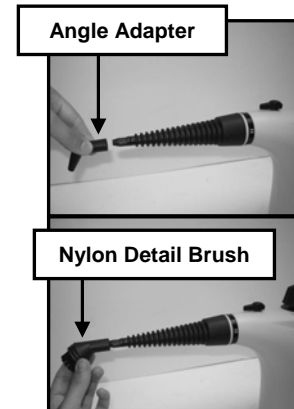

Fig. 8

Fig. 9

Brass Detail Brush

- Use the brass detail brush to clean ovens and hard metal surfaces.
- To use, attach the brass detail brush onto the concentrator nozzle. (Fig. 9)

Using the Steam Cleaner with the Hose

To attach the hose to the main unit:

- Align the raised arrow on the end of the hose with the single white line on the ring of the snout. (Fig. 5 & 6)
- Push the end of the hose onto the nozzle until it stops against the appliance.
- To lock the hose in place, turn it 90 degrees clockwise so that the raised arrow mark aligns with the two white lines on the ring of the snout. (Fig. 6)

- To attach the concentrator nozzle, window squeegee/steam diffuser, angle adapter or detail brush to the hose, follow the instructions in the corresponding sections.

Bathroom Areas

To clean the bathtub or shower area, use the nylon detail brush for grout, shower door tracks, hard to get areas and heavily soiled areas. Allow plenty of time for the heat to penetrate the surface. This is especially helpful in the shower area if there is tile or grout.

To clean the toilet, use the nylon detail brush. Use a terry cloth towel or paper towel to wipe up excess moisture and residue.

To clean the sink and faucets, use the nylon detail brush.

Soap Scum

Soap scum dissolves almost immediately under a combination of heat and moisture. Rinse the surface with a small amount of water afterwards or go back over it once more with a clean terry cloth towel.

Note: Soap scum sometimes will develop a hard surface from water-borne minerals. If this is the case, use the nylon detail brush first to break up this surface - or spray or wipe first with lemon, vinegar or seltzer soda water to soften the minerals. Moving too slowly can dry out the soap scum and cause it to granulate on the surface. The surface will have a gritty feel. If this happens, apply vapor to the surface with the nylon detail brush again and re-clean.

Operating Instructions

Window Squeegee/Steam Diffuser

The window squeegee comes apart in two separate pieces. When taken apart, one of the pieces can be used as a steam diffuser.

A steam diffuser is useful when wanting to steam clothing, upholstery, window coverings and bedding etc. To take apart the window squeegee:

- Push back the locking tab to release the window squeegee from the steam diffuser. (Fig. 7)

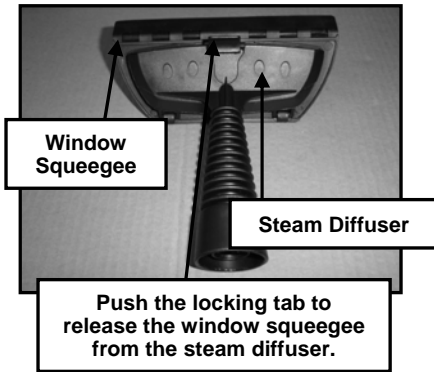

Fig. 7

To attach the window squeegee/steam diffuser:

- Align the raised arrow on the end of the window squeegee/steam diffuser with the single white line on the ring of the snout.
- Push the window squeegee/steam diffuser onto the nozzle until it stops against the appliance.
- To lock the window squeegee/steam diffuser in place, turn it 90 degrees clockwise so that the raised arrow mark aligns with the two white lines on the ring of the snout.
- To remove the window squeegee from the steam diffuser, just push down on the locking tab to release the window squeegee from the steam diffuser.

- Once having removed the window squeegee piece, you are now able to use the this attachment as a steam diffuser.
- The cleaning cloth is used with the steam diffuser. Just slip it over the steam diffuser. This can be used to clean fabric, upholstery, bedding etc.

Caution: Always determine the color-fastness of any fabric - especially with reds or blues - by taking a clean, moist, warm towel and gently rubbing a small area as far down on the back or other out of the way place on the furniture as possible. If color comes off on the towel, you may need to have the piece dry cleaned.

Cleaning Upholstery

- Use the steam diffuser with the cleaning cloth. Use fast, light strokes, avoid getting the fabric wet. Be patient with stubborn spots; work on a spot gently for no more than a minute at a time, then wait **five minutes** for the area to dry and repeat.
- Use circular movements or back-and-forth and side-to-side movements to get all sides of surface fibers. Finish with a brushing in one direction that will give the fabric a uniform appearance.

Cleaning Windows, Glass Surfaces and Mirrors

- To use the window squeegee, work with the vapor jet down using the top to bottom movements. To do this without leaving streaks, use lateral movements from the top to the bottom of the surface.

Features of Your Hand Held Hard Surface Steam Cleaner

The steam cleaner utilizes pressurized steam to remove tough grease, dirt and grime. Steam is nature's purest and most powerful cleaner for safely cleaning all hard surfaces in your home without harsh chemicals, thus being perfectly ecological.

The appliance has various attachments so that it can be used for many purposes such as:

- ✓ Clean upholstery, sealed grout, bathroom/kitchen tile, stovetops.
- ✓ Easy to clean difficult to reach areas with the angle adapter or concentrator such as faucets, etc.
- ✓ Ideal for windows, mirrors, glass doors, etc.
- ✓ Clean fabrics, window coverings, pillows, bedding etc.
- ✓ Clean hard surface areas such as counters, sinks, shower door tracks, etc.

Warning: The steam cleaner is designed to clean hard surfaces and upholstery that will withstand high heat. **Do not** use on soft plastics, unsealed wood and cold glass. On surfaces that have been treated with wax or some no wax floors, the sheen may be removed by the heat and steam action. **Do not** use on unsealed wood. This could cause the wood grain to rise. It is therefore recommended to test an isolated area of the surface to be cleaned before proceeding.

Caution: **DO NOT** plug in the machine during filling. Use a grounded receptacle. Use only a heavy duty extension cord rated for 15 amps. **Do not use an ordinary extension cord.**

Important: **DO NOT** add cleaning solutions, scented perfumes, oils or any other chemicals to the water used in this appliance. **Use regular water or distilled/purified water if the tap water in your area is very hard.**

Operating Instructions

Caution: Always ensure the unit is **unplugged** from the wall receptacle prior to filling or re-filling the water tank.

Assembly and Using the Steamer

1. Before filling the steam cleaner, make sure that the unit is **NOT** plugged in. Also, slide the safety trigger lock to the right to lock it. (Fig. 1) To unlock this safety feature, slide the trigger safety lock to the left. (Fig. 2)

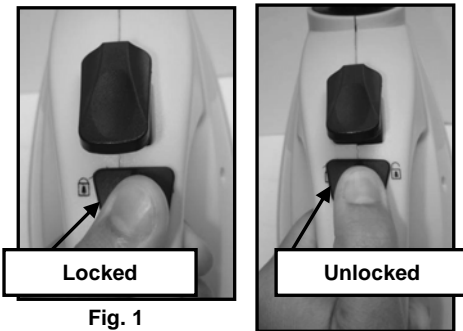

Fig. 1

Fig. 2

2. Simultaneously press down on the safety cap and turn it counter-clockwise until removed.
3. Place funnel in the tank and add water. **DO NOT overfill. Maximum filling capacity is 300 mL (10 oz.)** Replace the safety cap by turning it clockwise until it has tightened. Attach desired accessory attachment.

Note: Heating time is approximately **4 to 5 minutes**. Filling the boiler with hot water will shorten heat up time.

4. Plug the unit into a standard **120 volt** wall receptacle. The heating light will then light up.
5. Allow approximately **4 to 5 minutes** for water vapor to reach its working temperature and pressure.
6. At the start, some water may come out of the nozzle (this is normal).

7. Grasp the handle firmly with one hand and slide the trigger safety lock to the left to unlock it.
8. Using your thumb, press down on the trigger button to release the steam ("ON" position). Turn the variable steam adjustment in a clockwise or counterclockwise direction to change the amount of steam released. To stop steam from being released, let go of the trigger button ("OFF" position).

Important Note: On the top of the trigger button, there is a slide that can be used to lock the trigger in the "ON" position. To engage it, depress the trigger button with your thumb and then slide your thumb forward. (Fig. 3) To release the lock and turn off the steam, press down on the slide and pull it back, then release the pressure on the trigger.

To avoid loss of steam while the unit is heating, be sure that the steam trigger is not depressed or locked in the "ON" position prior to plugging the unit in.

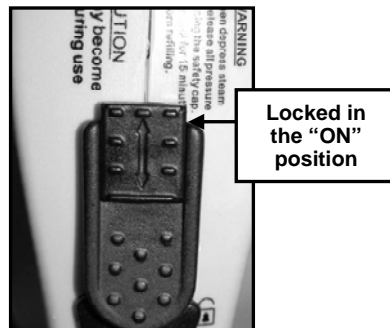

Fig. 3

9. When finished using the steam cleaner, unplug and allow to cool. Follow the instructions in the "Maintenance & Cleaning Instructions" section.

Warning: **DO NOT** aim steam at any live electrical components or devices, such as electrical outlets.

Operating Instructions

Important: Disconnect steam cleaner from wall outlet before refilling. It is time to refill your steam cleaner when there is no more steam coming out of the nozzle.

Warning: Because the water tank is pressurized, use caution when opening to refill. Always unplug the unit and let the unit cool for **15 minutes** before opening the safety cap. Depress the trigger button while you unscrew the safety cap counter-clockwise.

Caution: When refilling the appliance while it is still hot, the first drops of water might squirt back. **Use caution when opening the safety cap.**

Filling and Refilling the Steamer

1. Disconnect electrical power cord from wall outlet.
2. Press down on the trigger button until all pressure has been released.
3. Wait for approximately **15 minutes** before carefully unscrewing the safety cap.
4. Turn slowly a half turn counter-clock wise and wait for the hissing noise created by residual steam to stop.
5. Unscrew the safety cap in the counter-clock wise direction until it is completely unscrewed and allow it to cool.
6. Slowly pour water into the boiler using the measuring cup and the funnel. (Fig. 4)

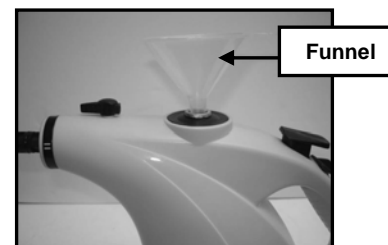

Fig. 4

7. Screw safety cap back on the appliance and plug appliance back into wall outlet. Steam will start to be produced as before.

Warning: This appliance is under pressure. After every use, press trigger button until all pressure has been released before removing safety cap.

Important: DO NOT OVERFILL. Maximum filling capacity is 300 ml. (10 oz.)

Concentrator Nozzle

To attach the concentrator nozzle:

- Align the raised arrow on the larger end of the concentrator nozzle with the single white line on the ring of the snout. (Fig. 5 & 6)
- Push the concentrator onto the nozzle until it stops against the appliance.
- To lock the concentrator nozzle in place, turn it 90 degrees clockwise so that the raised arrow mark aligns with the two white lines on the ring of the snout. (Fig. 6)

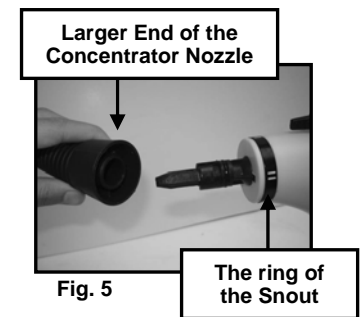

Fig. 5

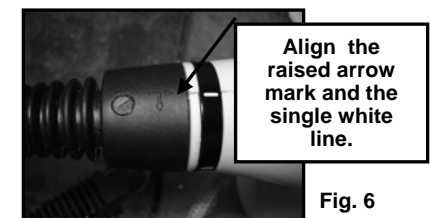

Fig. 6

Free Manuals Download Website

<http://myh66.com>

<http://usermanuals.us>

<http://www.somanuals.com>

<http://www.4manuals.cc>

<http://www.manual-lib.com>

<http://www.404manual.com>

<http://www.luxmanual.com>

<http://aubethermostatmanual.com>

Golf course search by state

<http://golfingnear.com>

Email search by domain

<http://emailbydomain.com>

Auto manuals search

<http://auto.somanuals.com>

TV manuals search

<http://tv.somanuals.com>