



2 in 1 Stick and Hand Vac

Owner's Manual

Model: EP664

120V., 60Hz., 5 Amps



U.S : **EURO-PRO Operating LLC**
94 Main Mill Street, Door 16
Plattsburgh, NY 12901

Canada : **EURO-PRO Operating LLC**
4400 Bois Franc
St-Laurent, QC H4S 1A7

1 (800) 798-7398
www.sharkvac.com

EURO-PRO 



ONE (1) YEAR LIMITED WARRANTY

EURO-PRO Operating LLC warrants this product to be free from defects in material and workmanship for a period of one (1) year from the date of the original purchase, when utilized for normal household use, subject to the following conditions, exclusions and exceptions.

If your appliance fails to operate properly while in use under normal household conditions within the warranty period, return the complete appliance and accessories, freight prepaid to:

US: **EURO-PRO Operating LLC**, 94 Main Mill Street, Door 16, Plattsburgh, NY, 12901

CANADA: **EURO-PRO Operating LLC**, 4400 Bois Franc, St. Laurent, QC, H4S 1A7

If the appliance is found by **EURO-PRO Operating LLC** to be defective in material or workmanship, **EURO-PRO Operating LLC** will repair or replace it free of charge. Proof of purchase date and \$ 7.95 to cover the cost of return shipping and handling must be included. *

Non-durable parts including, without limitation, filters, brushes and electrical parts which normally require replacement are specifically excluded from warranty.

The liability of **EURO-PRO Operating LLC** is limited solely to the cost of the repair or replacement of the unit at our option. This warranty does not cover normal wear of parts and does not apply to any unit that has been tampered with or used for commercial purposes. This limited warranty does not cover damage caused by misuse, abuse, negligent handling or damage due to faulty packaging or mishandling in transit. This warranty does not cover damage or defects caused by or resulting from damages from shipping or repairs, service or alterations to the product or any of its parts, which have been performed by a repair person not authorized by **EURO-PRO Operating LLC**.

This warranty is extended to the original purchaser of the unit and excludes all other legal and/or conventional warranties. The responsibility of **EURO-PRO Operating LLC** if any, is limited to the specific obligations expressly assumed by it under the terms of the limited warranty. **In no event** is **EURO-PRO Operating LLC** liable for incidental or consequential damages of any nature whatsoever. Some states do not permit the exclusion or limitation of incidental or consequential damages, so the above may not apply to you.

This warranty gives you specific legal rights, and you may also have other rights which vary from province to province.

***Important: Carefully pack item to avoid damage in shipping. Be sure to include proof of purchase date and to attach tag to item before packing with your name, complete address and phone number with a note giving purchase information, model number and what you believe is the problem with item. We recommend you insure the package (as damage in shipping is not covered by your warranty). Mark the outside of your package "ATTENTION CUSTOMER SERVICE". We are constantly striving to improve our products, therefore the specifications contained herein are subject to change without notice.**



OWNERSHIP REGISTRATION CARD

CANADIAN CONSUMERS ONLY

Please fill out and mail the product registration card within ten (10) days of purchase. The registration will enable us to contact you in the unlikely event of a product safety notification. By returning this card you acknowledge to have read and understood the instructions for use, and warnings set forth in the accompanying instructions.

RETURN TO: **EURO-PRO Operating LLC**, 4400 Bois Franc, St. Laurent, Quebec, H4S 1A7

Model EP644

Appliance model

Date purchased

Name of store

Owner's name

Address

City

Prov.

Postal code

IMPORTANT SAFETY INSTRUCTIONS

When using your **Vacuum** basic safety precautions should always be observed, including the following:

1. Read all instructions before using your vacuum.
2. Use the system only for its intended use.
3. To protect against a risk of electric shock, **do not** immerse any part of the system in water or other liquids.
4. **Never** yank cord to disconnect from outlet; instead, grasp plug and pull to disconnect.
5. **Do not** allow cord to touch hot surfaces.
6. **Do not** run appliance over cord.
7. **Do not** operate the system with a damaged cord or plug, or if the appliance or any other part of the system has been dropped or damaged. To avoid the risk of electric shock, do not disassemble or attempt to repair the vacuum. Return the system to **EURO-PRO Operating LLC** (see warranty) for examination and repair. Incorrect re-assembly or repair can cause a risk of electrical shock or injury to persons when the vacuum is used.
8. Close supervision is necessary for any appliance being used by or near children. **Do not** leave the system unattended while connected.
9. Keep hair, loose clothing, fingers and all parts of body away from opening and moving parts.
10. **Do not** use to pick up flammable or combustible liquids such as gasoline or use in areas where they may be present.
11. **Do not** pick up anything that is burning or smoking such as cigarettes, matches or hot ashes.
12. Use extra care when cleaning on stairs.
13. **Do not** use the vacuum without the filter in place.
14. This appliance is intended only for household use. Follow all user instructions in this manual.

To reduce the risk of fire, electric shock, or injury:

- **Do not** leave the vacuum plugged in when unattended. Unplug the electrical cord when not in use and before servicing.
- **Do not** allow to be used as a toy. Close attention is necessary when used by or near children, pets or plants.
- Use only as described in this manual. Use only manufacturer's recommended accessories.
- **Do not** pull cord, use cord as a handle, close a door on cord, or pull cord around sharp edges or corners. Keep cord away from heated surfaces.
- Use **only** extension cords UL-rated or cUL at 15 amperes. Extension cords rated for less amperage may overheat. Care should be taken to arrange the cord so that the cord cannot be pulled or tripped over.
- Turn off all controls as applicable before unplugging from electrical outlet.
- **Do not** handle plug or vacuum with wet hands or operate without shoes.
- **Do not** put any objects into openings. Do not use with any opening blocked. Keep free of dust, lint, hair and anything else that may reduce air flow.
- Store your appliance indoors in a cool, dry area.
- Keep your work area well lit.
- Keep end of hose, wands and other openings away from your face and body.
- Use only on dry surfaces.
- Using improper voltage may result in damage to the motor and possible injury to the user. Correct voltage is listed on rating label.

WARNING: The power cord on this product contains lead, a chemical known to the State of California to cause birth defects or other reproductive harm. **Wash hands after handling.**

SAVE THESE INSTRUCTIONS

For Household Use Only



WARNING: To reduce the risk of electric shock, this appliance has a polarized plug (one blade is wider than the other). This plug will fit in a polarized outlet only one way. If the plug does not fit fully in the outlet, reverse the plug. If it still does not fit, contact a qualified electrician to install the proper outlet. Do not modify the plug in any way.

PARTS AND COMPONENTS

1. Floor Nozzle
2. Air Intake
3. Dust Cup Release Button
4. On/Off Switch
5. Vacuum Handle
6. Power Cord Holder
7. Handle Release Button
8. Power Cord
9. Hand Vac Handle
10. Dust Cup Filter
11. Dust Cup (Container)
12. Crevice Brush

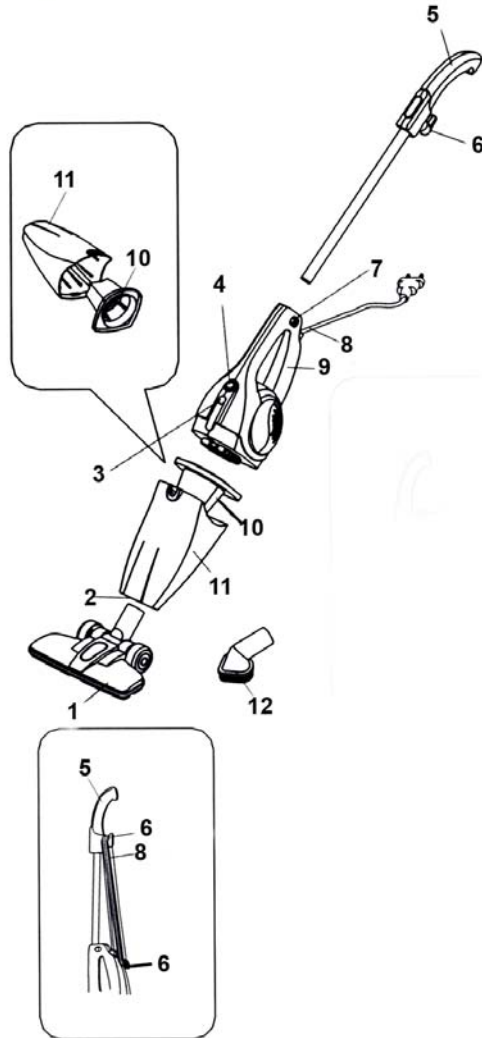

Technical Specifications

Voltage: 120V., 60Hz.
Power: 5 Amps

Note: Illustrations may differ from actual product.

ORDERING REPLACEMENT DUST CUP FILTER

TO ORDER REPLACEMENT FILTER for Model EP664

Call: 1 (800) 798-7398
Monday to Friday 8:30 A.M. - 5:00 P.M. Eastern Standard Time
or
visit our website: www.sharkvac.com

FOR TECHNICAL SUPPORT for Model EP664

Call: 1 (800) 798-7398
Monday to Friday 8:30 A.M. - 5:00 P.M. Eastern Standard Time

Please Note:

The filter is washable. It should, however, be replaced every three (3) to six (6) months to ensure peak performance of your vacuum.

Important:

Make sure that **THE** filter has been completely air dried for 24 hours before re-installing back in the vacuum.

OPERATING INSTRUCTIONS

Motor Thermostat

IMPORTANT: This unit is equipped with a motor protective thermostat. If for some reason the vacuum cleaner should overheat, the thermostat will automatically turn the unit off. Should this occur:

- Push the On/Off button once.
- Disconnect the plug from the power source.
- Check the source of overheating problem. (i.e. clogged hose or filter)

- If clogged hose or filter is found, unclog the hose and replace the filters.
- Wait at least 45 minutes before attempting to reuse the vacuum.
- After unit has cooled down for 45 minutes, plug in the cleaner and push the On/Off button. The vacuum should start again.
- If the vacuum still does not start, contact customer service at 1 (800) 798-7398.

TROUBLE SHOOTING GUIDE

PROBLEM	POSSIBLE REASON	POSSIBLE SOLUTION
VACUUM WILL NOT OPERATE	<ol style="list-style-type: none"> 1. Power cord not firmly plugged into outlet. 2. No power in wall outlet. 3. Needs servicing. 4. Thermostat has tripped. 	<ol style="list-style-type: none"> 1. Plug unit in firmly. 2. Check fuse or breaker. Replace fuse/reset breaker. 3. Call 1 (800) 798-7398. 4. Turn the unit off and unplug from outlet. Allow unit to cool down, then restart.
VACUUM WILL NOT PICK-UP OR SUCTION POWER IS WEAK	<ol style="list-style-type: none"> 1. Dust cup is full. 2. Unit clogged. 3. Filter needs cleaning or replacing. 	<ol style="list-style-type: none"> 1. Empty and clean dust cup. 2. Turn unit off and unplug from wall outlet. Remove dust cup filter and check for object(s) in the air intake opening and remove. 3. Clean or replace filter.
DUST ESCAPING FROM VACUUM	<ol style="list-style-type: none"> 1. Dust cup is full. 2. Dust cup is not installed correctly. 3. Filter is not in unit. 	<ol style="list-style-type: none"> 1. Empty and clean dust cup. 2. Review dust cup instructions. 3. Install filter in unit.
BRUSH OR FLOOR NOZZLE WILL NOT PICK-UP	<ol style="list-style-type: none"> 1. Brush or floor nozzle is clogged. 2. Dust cup is full. 3. Filter need cleaning or replacing. 	<ol style="list-style-type: none"> 1. Remove brush and/or floor nozzle. Remove obstruction from brush and /or floor nozzle. 2. Empty and clean dust cup. 3. Clean or replace filter.

PRECAUTIONARY MEASURES

IMPORTANT: If the suction opening in the unit or the nozzle is **BLOCKED**, switch off the vacuum cleaner and remove the blocking substance before you start the unit again.

1. **Do not** operate the vacuum cleaner too close to heaters, radiators or cigarette butts.



4. When pulling out the power plug from the wall outlet, pull the plug **not** the power cord.

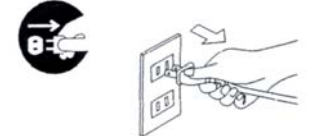

2. Before inserting the power plug into the wall outlet, make sure that your hands are dry.

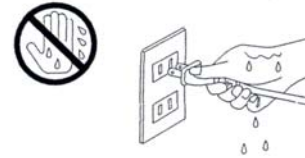

5. **Do not** pick up anything that is burning or smoking such as cigarettes, matches or hot ashes.

6. **Do not** use without filter in place.

3. Before you start vacuuming, make sure to remove large or sharp objects that might damage the dust cup.

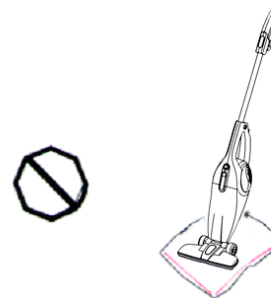

OPERATING INSTRUCTIONS

Warning: Always remove the power plug from the wall outlet before assembling or removing accessories.

Inserting the Vacuum Handle into the Hand Vac

- Push down on the vacuum handle release button then insert the vacuum handle into the opening above the hand vac handle. (Fig. 1)

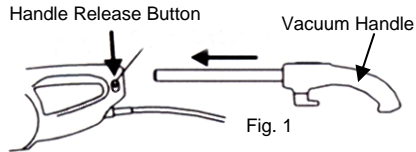

- To remove the vacuum handle, press down on the vacuum handle release button and pull the pole up while securely holding the hand vac handle. (Fig. 2)

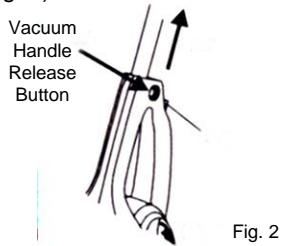

Attaching the Floor Nozzle to the Hand Vac

- Insert the floor brush into the air intake opening.
- To remove the floor nozzle from the hand vac, pull the floor nozzle straight out from the hand vac. (Fig. 3)

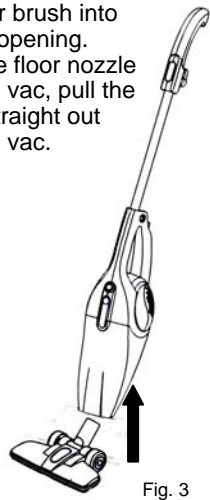

Attaching the Crevice Brush to the Hand Vac

- Hold the end of the crevice brush. Insert the crevice brush into the air intake opening of the unit. (Fig. 4)

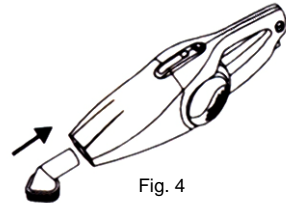

- For a longer reach the crevice brush can be used with the unit assembled as a stick vacuum. (Fig. 5)
- To remove the dusting brush pull straight out from the air intake opening.

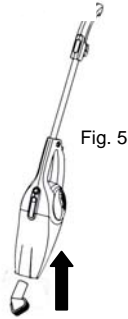

Winding & Unwinding the Power Cord

This unit is equipped with a convenient cord storage feature. The power cord winds around the two cord holders at the back of the unit. The top one has a quick cord release feature. Turn the cord holder to the left or the right to remove the power cord. (Fig. 6)



On/Off Switch

- The On/Off switch has two different positions.
- Push on the "I" side to turn the vacuum ON.
- Push on the "O" side to turn the vacuum OFF.

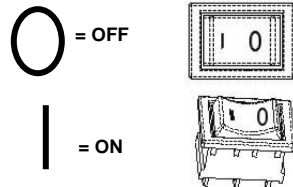

OPERATING INSTRUCTIONS

Using the Unit as an Upright

- Ensure that the dust cup filter is installed in the dust cup container.
- Unwind the power cord and plug into the 120V outlet.
- Press the On/Off switch to the On position and vacuum.

Note: When vacuuming deep pile carpets or hard to vacuum carpets, lower the angle of the vacuum handle (see illustration at right) for easier maneuverability.

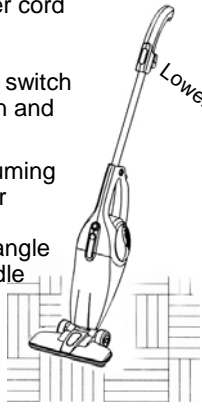

Important: Do NOT use the vacuum without the filter in place.

Using the Unit as a Hand Vacuum

- Ensure that the unit is unplugged before removing parts, or performing maintenance.
- Press the vacuum handle release button and pull handle to remove.
- Pull the floor nozzle out from the hand vac.
- Attach the crevice brush to the end of the hand vac if desired.
- Press the On/Off switch to the on position to vacuum.

Changing & Cleaning the Dust Cup Filter

To achieve the best performance, empty the dust cup container and clean the dust cup filter after each use.

1. To remove the dust cup container, press down on the dust cup release button and pull off the dust cup container. (Fig. 7)



2. Empty the dust from the dust cup container. (Fig. 8)

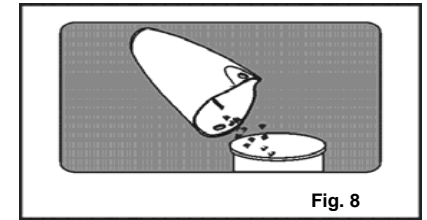

3. Pull off the dust cup filter. (Fig. 9)

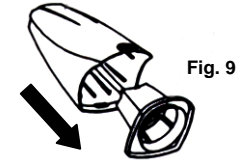

4. Rinse the dust cup filter in cold water, and then wait until it air dries completely before replacing it back into the dust cup container. **Do not** use a washing machine to clean the dust cup filter. **Do not** use a hair dryer to dry it. **Air dry only.**
5. Replace the dust cup filter carefully into the dust cup container. **NEVER** operate vacuum cleaner without dust cup filter in place.
6. Attach the dust cup container to the vacuum.

Note: It is recommended that the dust cup filter be replaced every three (3) to six (6) months to ensure peak performance of the unit.

Caution: The suction hole must be open and free of any obstructions at all times. Otherwise, the motor will overheat and could become damaged.

Free Manuals Download Website

<http://myh66.com>

<http://usermanuals.us>

<http://www.somanuals.com>

<http://www.4manuals.cc>

<http://www.manual-lib.com>

<http://www.404manual.com>

<http://www.luxmanual.com>

<http://aubethermostatmanual.com>

Golf course search by state

<http://golfingnear.com>

Email search by domain

<http://emailbydomain.com>

Auto manuals search

<http://auto.somanuals.com>

TV manuals search

<http://tv.somanuals.com>