

ONE (1) YEAR LIMITED WARRANTY

EURO-PRO Operating LLC warrants this product to be free from defects in material and workmanship for a period of one (1) year from the date of the original purchase. This warranty applies only to normal domestic household use. Should your appliance fail to operate properly while in use under normal household conditions within the one (1) year warranty period, return the complete appliance and accessories, freight prepaid to **EURO-PRO Operating LLC** at the address given below.

EURO-PRO Operating LLC, 94 Main Mill Street, Door 16, Plattsburgh, N.Y. 12901

If the appliance is found by **EURO-PRO Operating LLC** to be defective in material or workmanship, **EURO-PRO Operating LLC** will repair or replace it free of charge. Proof of purchase date and \$18.95 to cover the cost of return shipping and handling must be included. * Non-durable parts including, without limitation, drive belts, rotating brushes and electrical parts which normally require replacement are specifically excluded from warranty.

The liability of **EURO-PRO Operating LLC** is limited solely to the cost of the repair or replacement of the unit at our option. This warranty does not cover normal wear of parts and does not apply to any unit that has been tampered with or used for commercial purposes. This limited warranty does not cover damage caused by misuse, abuse, negligent handling or damage due to faulty packaging or mishandling in transit. This warranty does not cover damage or defects caused by or resulting from damages from shipping or repairs, service or alterations to the product or any of its parts, which have been performed by a repair person not authorized by **EURO-PRO Operating LLC**.

This warranty is extended to the original purchaser of the unit and excludes all other legal and/or conventional warranties. The responsibility of **EURO-PRO Operating LLC** if any, is limited to the specific obligations expressly assumed by it under the terms of the limited warranty. **In no event is EURO-PRO Operating LLC** liable for incidental or consequential damages of any nature whatsoever. Some states/provinces do not permit the exclusion or limitation of incidental or consequential damages, so the above may not apply to you.

This warranty gives you specific legal rights, and you may also have other rights which vary from state to state.

***Important: Carefully pack item to avoid damage in shipping. Be sure to include proof of purchase date and to attach tag to item before packing with your name, complete address and phone number with a note giving purchase information, model number and what you believe is the problem with item. We recommend you insure the package (as damage in shipping is not covered by your warranty). Mark the outside of your package "ATTENTION CUSTOMER SERVICE". We are constantly striving to improve our products, therefore the specifications contained herein are subject to change without notice.**



OWNERSHIP REGISTRATION CARD

Please fill out and mail the product registration card within ten (10) days of purchase. The registration will enable us to contact you in the unlikely event of a product safety notification. By returning this card you acknowledge to have read and understood the instructions for use, and warnings set forth in the accompanying instructions.

RETURN TO: EURO-PRO Operating LLC, 94 Main Mill Street, Door 16, Plattsburgh, NY 12901

Model V1055H

Appliance model

Date purchased

Name of store

Owner's name

Address

City

State

Zip Code

EURO-PRO X

Bagless Upright Vacuum

OWNER'S MANUAL

Model V1055H
120V., 60Hz., 12 Amps



EURO-PRO Operating LLC
94 Main Mill Street, Door 16
Plattsburgh, NY 12901
Tel.: 1 (800) 798-7398

IMPORTANT SAFETY INSTRUCTIONS

When using your **Bagless Upright Vacuum**, basic safety precautions should always be observed, including the following:

WARNING: To reduce the risk of fire, electrical shock, or injury:

1. **Do NOT** leave vacuum cleaner unattended when it is plugged in. Unplug from outlet when not in use and before removing filters.
2. To reduce the risk of electric shock – **Do NOT** use outdoors or on wet surfaces.
3. **Do NOT** allow children to use as a toy. Close attention is necessary when used by or near children.
4. Use only as described in this manual. Use only manufacturer's recommended attachments.
5. **Do NOT** use with damaged cord or plug. **Do NOT** use vacuum cleaner if it has been dropped, damaged, left outdoors, or dropped into water. Return appliance to **EURO-PRO Operating LLC** for examination, repair or adjustment.
6. **Do NOT** pull or carry by cord. **Do NOT** use cord as a handle, close a door on cord, or pull cord around sharp edges or corners. **Do NOT** run appliance over cord. Keep cord away from heated surfaces. **Do NOT** unplug by pulling on cord. To unplug, grasp the plug, not the cord.
8. **Do NOT** handle plug or vacuum cleaner with wet hands.
9. **Do NOT** use the vacuum cleaner to pick up large objects or objects that are likely to damage the vacuum cleaner.
10. Keep hair, loose clothing, fingers, feet and all parts of body away from openings, rotating agitator and other moving parts. **Do NOT** operate cleaner in bare feet or when wearing open toe shoes.
11. **Do NOT** pick up hot coals, cigarette butts, matches or any hot, smoking, or burning objects.
12. **Do NOT** pick up hard or sharp objects such as glass, nails, screws, coins, etc.

13. **Do NOT** use without all filters in place. Use **ONLY** filters and accessories provided by **EURO-PRO Operating LLC**. Failure to do so will void the warranty.
14. Turn off all controls before plugging or unplugging vacuum cleaner into electrical outlet.
15. Use extra care when vacuuming on stairs.
16. **Do NOT** pick up flammable or combustible materials (lighter fluid, gasoline, kerosene, etc.) or use in the presence of explosive liquids or vapor.
17. **Do NOT** pick up toxic material (chlorine bleach, ammonia, drain cleaner, etc.).
18. **Do NOT** use in an enclosed space filled with vapors given off by oil based paints, paint thinner, moth proofing substances, flammable dust, or other explosive or toxic vapors.
19. Use only on dry, indoor surfaces.
20. **Do NOT** use for any purpose other than described in this user's guide.
21. The use of an extension cord is not recommended.
22. **Do NOT** put any objects into openings. **Do NOT** use with any opening blocked. Keep free of dust, lint, hair and anything else that may reduce air flow.
23. Store your appliance indoors in a cool, dry area.
24. Keep your work area well lit.
25. **Do NOT** immerse the vacuum into water or other liquids.
26. Keep end of hose, wands and other openings away from your face and body.
27. To avoid damaging the carpet, keep the vacuum cleaner head moving at all times.

SAVE THESE INSTRUCTIONS

For Household Use Only

WARNING: To reduce the risk of electric shock, this appliance has a polarized plug (one blade is wider than the other). This plug will fit in a polarized outlet only one way. If the plug does not fit fully in the outlet, reverse the plug. If it still does not fit, contact a qualified electrician to install the proper outlet. **Do NOT** modify the plug in any way.



Bagless Upright Vac

TO ORDER REPLACEMENT FILTERS OR BELTS for Model V1055H

Call: 1 (800) 798-7398

Monday to Friday 8:30 A.M. - 5:00 P.M. Eastern Standard Time

FOR TECHNICAL SUPPORT for Model V1055H

Call: 1 (800) 798-7398

Monday to Friday 8:30 A.M. - 5:00 P.M. Eastern Standard Time

Please Note:

The HEPA-Type Dust Cup Filter and filter ring may be washed. They should, however, be replaced every three (3) to six (6) months, depending on amount of use, to ensure peak performance of your vacuum. We recommend washing them once a month or when suction appears to be reduced. To wash your HEPA-Type Dust Cup Filter, hold filter cartridge by frame flange and rinse under a tap until all observable dirt has been removed. Some discoloration of the HEPA-Type filter material may occur, this is normal and will not affect the filter's performance. When finished, shake off excess water and let air dry completely before replacing into the vacuum. **Do NOT** wash in dishwasher.

It is important that when you wash the HEPA-Type dust cup filter, or filter ring, you allow them to dry **COMPLETELY** before using again. We recommend 24 hours to air dry. **DO NOT DRY IN DRYER.**

Important:

Make sure that ALL washable Filters are completely dry before inserting back in the vacuum.

PROBLEM SOLVING

This appliance was inspected thoroughly and was in good operating condition when it was shipped from the factory. If a minor problem occurs, it usually can be solved quite easily when the cause is found. Therefore, this checklist is provided for your convenience.

PROBLEM	POSSIBLE CAUSE	POSSIBLE SOLUTION
Cleaner Won't Run	<ol style="list-style-type: none"> 1. Not properly plugged into wall outlet. 2. No electricity in wall outlet. 3. On/Off switch not turned on. 4. Motor thermostat tripped. 5. Blown fuse/tripped breaker. 	<ol style="list-style-type: none"> 1. Plug in firmly. 2. Check fuse or breaker. 3. Push on/off switch to on. 4. Reset motor thermostat. 5. Reset circuit breaker or replace fuse.
Cleaner Won't Pick Up	<ol style="list-style-type: none"> 1. Full or clogged dust cup. 2. Wrong pile height setting. 3. Clogged nozzle. 4. Clogged dust inlet port. 5. Clogged hose. 6. Broken belt. 7. Hose not inserted fully. 8. Dirty filters. 9. HEPA Type filter and filter ring needs cleaning or replacing. 	<ol style="list-style-type: none"> 1. Clean dust cup (container). 2. Adjust setting. 3. Remove obstruction. 4. Remove power head cover and remove obstruction. 5. Remove obstruction. 6. Replace belt. 7. Push hose in securely. 8. Clean / change filters. 9. Clean or replace HEPA Type filter and filter ring.
Cleaner Picks Up Moveable Rugs Or Pushes Too Hard	<ol style="list-style-type: none"> 1. Wrong pile height setting. 	<ol style="list-style-type: none"> 1. Adjust setting.
Agitator Does Not Turn	<ol style="list-style-type: none"> 1. Broken belt. 2. Belt installed incorrectly. 	<ol style="list-style-type: none"> 1. Replace belt. 2. Check belt changing and agitator cleaning.
Air Flow Restricted With Attachment Use Sound Changes	<ol style="list-style-type: none"> 1. Attachment use restricts air flow. 2. New carpet debris clogging air path. 	<ol style="list-style-type: none"> 1. Check attachment. 2. Remove obstruction.

PRECAUTIONARY MEASURES

Important: If the suction opening in the unit, the hose or the extension tube become blocked, switch off the vacuum cleaner and remove the blocking substance before you start the unit again.

1. **Do not** operate the vacuum cleaner too close to heaters, or radiators.

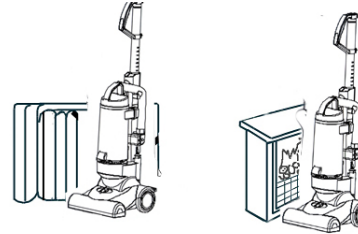

2. Before inserting the power plug into the wall outlet, make sure that your hands are dry.

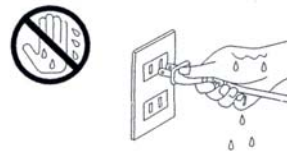

3. **Do not** vacuum any liquids.



4. Keep hair, loose clothing, fingers, feet and all parts of body away from openings, rotating agitator and other moving parts.

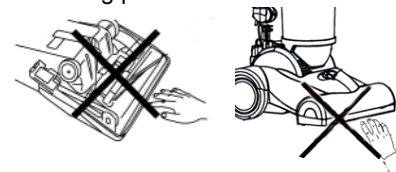

5. When pulling out the power plug from the wall outlet, pull the plug not the power cord.

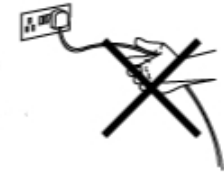

6. **Do not** pick up anything that is burning or smoking such as cigarettes, matches or hot ashes.
7. **Do not** run appliance over power cord.
8. **Do not** use without dust cup (container) or filters in place.
9. Before you start vacuuming, make sure to remove large or sharp objects that might damage the vacuum.

Note: This vacuum cleaner is equipped with a plug and power cord that retract automatically. If the cord or plug get damaged, it must be replaced by a qualified technician.

Warning: Hold the plug when rewinding the cord. Do not allow the cord to whip when rewinding.

GETTING TO KNOW YOUR BAGLESS BAGLESS UPRIGHT

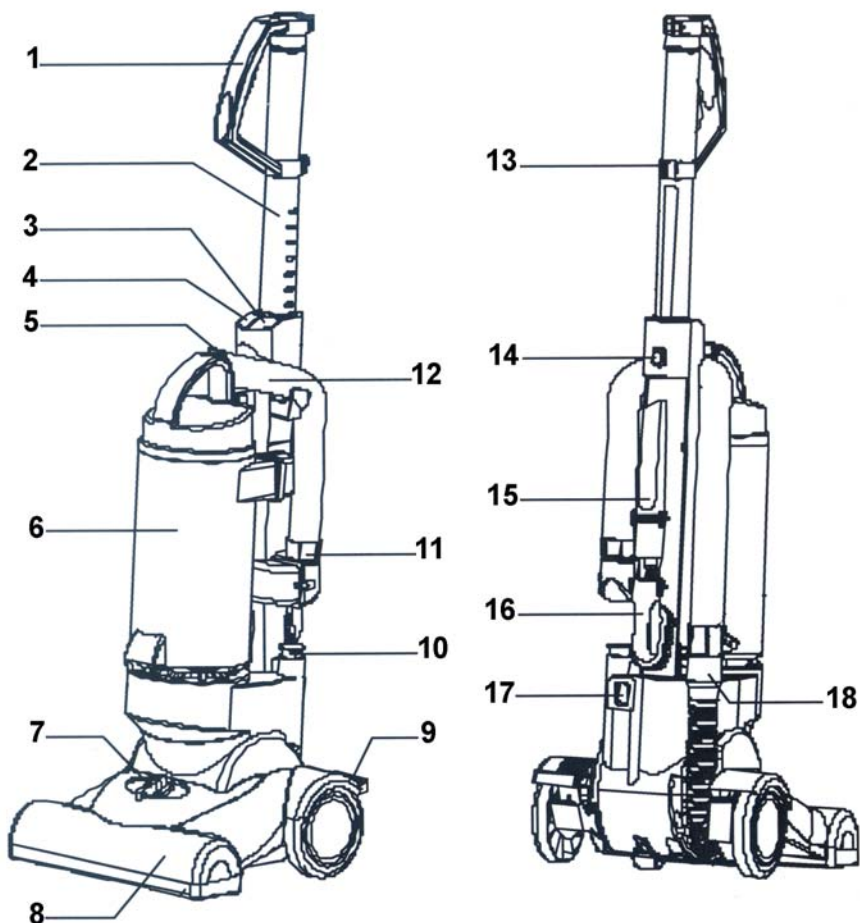

- | | |
|---|------------------------------------|
| 1. Handle | 9. Handle Release Pedal |
| 2. Telescopic Handle | 10. Cord Rewind Button |
| 3. Telescopic Tube Height Adjustment Button | 11. Hose Intake |
| 4. On/Off Button | 12. Flexible Hose |
| 5. Dust Cup Release Button | 13. Power Cord Clip |
| 6. Dust Cup (Container) | 14. Telescopic Tube Release Button |
| 7. Carpet Height Adjustment Knob | 15. Crevice Tool |
| 8. Motorized Power Head | 16. Dusting Brush |
| | 17. Power Cord |
| | 18. Hose Connector |

Technical Specifications

Voltage: 120V., 60Hz.
 Power: 12 Amps
 Note: Illustrations may differ from actual unit.

OPERATING INSTRUCTIONS

- Carefully clear away any excess dust or debris from agitator.
- Remove agitator from housing starting on the left side followed by the right side.
- If the belt has broken, remove any loose pieces before replacing with a new belt.
- Remove the worn or broken belt from the motor drive shaft.
- Loop the new belt first over the drive shaft then over agitator into the groove on the right side of the agitator. (Fig. 11)
- Insert the right side of the agitator by placing the end cap down into the slot on the housing and then align the left side. Press down firmly to make sure that each end of the agitator is correctly fitted into the slots.

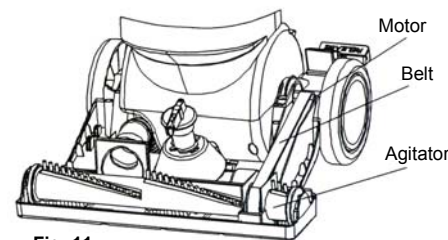

Fig. 11

NOTE: There will be some tension on the belt as the agitator is being put into place.

- Make sure that the belt is centered on the pulley and the agitator turns.
- Replace the front end of the top cover ensuring the wheel hubs fit properly in place. (Fig 12)
- Lift handle to secure top cover over carpet height selector.
- Drop handle so that the vacuum is laying flat again. Holding the top and bottom of unit gently turn unit over and replace the screws. Do not turn the screws too tightly to avoid stripping the screw holes.

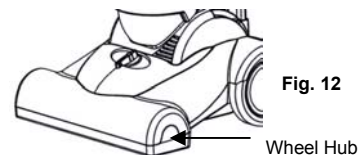

Fig. 12

Wheel Hub

Storage

To store the vacuum cleaner, put it in the upright position. Turn the power "Off". Remove the power cord from the electrical outlet. Press the cord rewind button. If the cord does not fully retract, pull it out again and then press on cord rewind button.

Warning: Hold the plug when rewinding the cord. Do not allow the cord to whip when rewinding.

Note: Before using the appliance, unwind a sufficient length of cable and Insert the plug into the wall socket. A yellow mark on the power cord shows the ideal cable length. Don't pull the power cord beyond the red mark.

Motor Thermostat

Important: This unit is equipped with a motor protective thermostat. If for some reason the vacuum cleaner should overheat, the thermostat will automatically turn the unit off. Should this occur:

- Push the On/Off button once.
- Disconnect the plug from the power source.
- Check the source of overheating problem. (i.e. clogged hose or filter)
- If clogged hose or filter is found, unclog the hose and replace the filters.
- Wait at least 45 minutes before attempting to reuse the vacuum.
- After unit has cooled down for 45 minutes, plug in the cleaner and push the On/Off button. The vacuum should start again.
- If the vacuum still does not start, contact customer service at 1 (800) 798-7398.

OPERATING INSTRUCTIONS

PLEASE NOTE: The white pleated filter material in the HEPA-Type Filter will discolor over time -This is NORMAL and will NOT affect the performance of the filter. If the HEPA-Type Filter

is properly "TapCleaned" after each use and suction does not return to 100%, then we suggest that the HEPA-Type filter be

"TapCleaned" vigorously until no more dust

can be removed, then rinsed under the faucet and allowed to air dry for 24 hours before refitting into the vacuum. (Fig. A) **This should be done once a month or when suction appears to be reduced .**

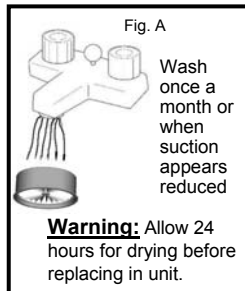

Warning: Always empty the dust cup container and clean the HEPA-Type filter, filter ring and filter frame before each use and during prolonged usage.

Never over fill the dust cup container - remove dirt and clean the HEPA-Type filter, filter ring and filter frame when dirt in dust cup is at or below the "FULL" level or during prolonged usage because you could risk damaging the motor.

If you wash the Hepa-Type filter and filter ring, make sure that they have completely air dried for 24 hours before inserting back into the vacuum.

Please Note: The HEPA-Type Filter is washable. It should, however, be replaced every three (3) to six (6) months to ensure peak performance of your vacuum.

The filter ring is also rinseable but should be air dried for 24 hours before replacing into the vacuum. It should however be replaced every three (3) months to ensure peak performance of your vacuum.

Important: Make sure that **ALL** filters are completely dry before re-installing back in the vacuum.

Cleaning the Filter Ring

1. Around the HEPA-Type filter there is a filter ring. This is washable in lukewarm water. (Fig. 10) To remove the filter ring, slide it off the HEPA-Type filter.

2. We recommend washing the filter ring when you are washing your HEPA-Type filter. Always allow the filter ring to air dry for 24 hours before replacing onto the HEPA-Type filter. Never run the vacuum without all the filters in place.

Note: This is a washable filter, but we recommend replacing it every three (3) months.

Cleaning & Changing the Belt

Warning: To reduce the risk of electric shock, the power cord must be disconnected before removing the dust cup, HEPA-Type filter, changing the filters or performing maintenance/trouble shooting checks.

Occasionally the power head drive belt will require changing, the frequency will depend upon the amount of use your vacuum sees.

1. Turn the vacuum "Off" and unplug from power supply.
2. Release the handle by pressing the handle release pedal and pull back on the handle unit it releases from its upright position, and turn the unit over on the floor.
3. With a #2 Phillips screw driver, remove the four (4) screws on the bottom base plate. There are two in the front of the unit and 2 screws recessed in the back.
4. With the unit still lying down, hold the top and bottom plates together while turning the unit over. Remove the one (1) screw that holds the carpet height adjustment button. Lift the cover of the power head starting from the back.

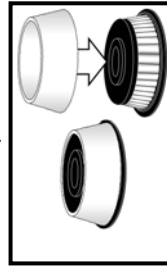

Fig. 10

OPERATING INSTRUCTIONS

Assembling Your Vacuum Cleaner

WARNING: Always remove the power plug from the wall outlet before assembling or removing accessories.

Assembling the Vacuum Cleaner

1. Carefully unpack all the components, set the packaging aside.
2. Lift the vacuum body to the upright position.
3. Insert the handle into the handle inlet of the vacuum.
4. Press down on the telescopic tube height adjustment button while pushing the telescopic tube down. (Fig. 1)

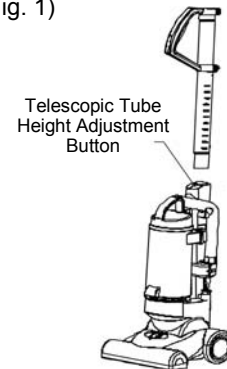

Fig. 1

5. To remove the telescopic tube, extend it to its maximum height by depressing the telescopic tube height adjustment button and then press the telescopic tube release button and pull the tube out. (Fig. 2)

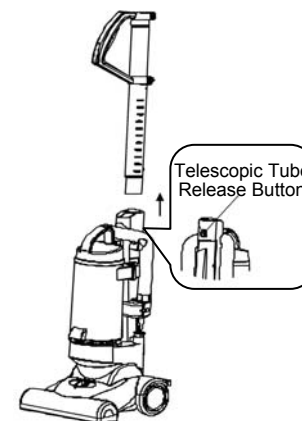

Fig. 2

Using the Attachments

1. Place vacuum in its upright position. Make sure that the vacuum cleaner is **NOT** plugged into the electrical outlet when adding or removing accessories.

2. Turn the carpet height selector to the highest position.
3. Remove the telescopic tube from the unit following the instructions on page 4.
4. Remove the hose connector from the side of the unit.
5. Insert the flexible hose into the top of the handle. (Fig. 3)
6. Insert the desired attachment firmly onto the end of the telescopic tube.



Fig. 3

Warning: When the vacuum is turned on, the beater brush will continue to rotate. **AVOID** tipping the vacuum or setting it on furniture, fringed area rugs or carpeted stairs while you are using the hose with attachments. **AVOID** leaving the vacuum in one place for an extended period of time, particularly on thick carpet.

Crevice Tool

For radiators, crevices, corners, baseboards and between cushions.



Dusting Brush

The dusting brush is used for the furniture, Venetian blinds, lamp shades, shelves, etc.



Caution: Do **NOT** pull the vacuum cleaner around the room by the hose as it could tip over and cause damage. When using the attachments, **Do NOT** over extend the hose length when reaching. Trying to reach beyond the hose reach could cause the vacuum to tip over. The dust cup cover handle can be used to lift the vacuum when changing locations.

OPERATING INSTRUCTIONS

How to Start

The vacuum can be used on multiple types of carpeting or bare floors. When using the crevice tool or dusting brush, place the handle of the vacuum in the upright position.

1. Plug the power cord into the electrical outlet.
2. Push the On/Off button to the "On" position to turn the vacuum on.
3. To release the handle, step on the handle release pedal and pull back handle.
4. When using the crevice tool or dusting brush, the vacuum must be in the upright position. (Fig. 4)

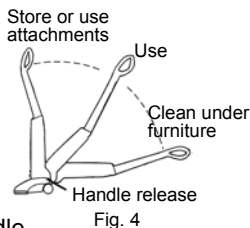

Carpet Height Selector

This upright vacuum can be used on multiple types of carpeting and bare floors. To select a pile height setting:

1. Turn vacuum cleaner "Off".
2. Select a pile height setting by rotating the carpet height selector to the desired setting. (Fig. 5)

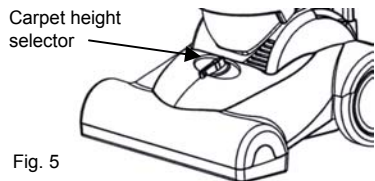

Suggested Pile Height Setting:
You may need to raise the height of the vacuum to make some jobs easier, such as scatter rugs and longer pile carpets. Suggested settings are:



- HIGH:** shag carpet, long pile, plush scatter rugs, tools
MED: medium to long pile
LOW: very low pile, bare floors

Place unit in "UPRIGHT" position when using attachment or hose to prevent possible floor damage. Always set the carpet height selector to "highest" setting when using the accessories and hose.

Attention: Special care is required when vacuuming certain types of carpet or floor covering. Always check the carpet or floor covering manufacturer's recommended cleaning instructions before vacuuming.

Removing & Emptying Dust Cup (Container)

Warning: To reduce the risk of electric shock, the power cord must be disconnected before removing the dust cup (container), dust cup HEPA-Type filter, changing the pre-motor filter or performing maintenance/trouble shooting checks.

Important: Do **NOT** use the vacuum without **ALL** the filters in place. The "Dust Cup (Container)" must always be emptied when the dirt level reaches the "FULL" line on the dust cup (container). To remove the dust cup (container) from the vacuum:

1. Press down on the dust cup release button that is located on the dust cup cover handle of the dust cup. (Fig. 6)

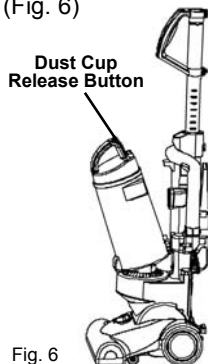

2. To empty the dust cup container, hold the dust cup from the handle over a garbage container and press on the trap door release button that is on the back side of the dust cup container to release the dust cup bottom. (Fig. 7)

OPERATING INSTRUCTIONS

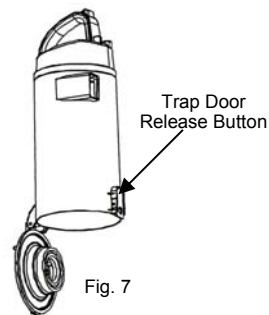

- The dust cup container can be washed in lukewarm water.
- **Do not** use strong detergents.
- Ensure that the dust cup container is fully dry before putting back on the vacuum cleaner.
- **Do not** wash in dishwasher.

Cleaning the HEPA Filter and the Filter Frame

Warning: After each Use - Always remove the Filter Assembly, then vigorously tap clean the HEPA-Type Filter until no more dust can be removed.

IMPORTANT, Please Note: The Rinseable "TapClean" HEPA-Type Dust Cup Filter will quickly accumulate many fine dust particles inside the white filter folds that are difficult to see but which will eventually block or reduce your suction power - if not cleaned properly. Clean the HEPA-Type Filter after each use as described in this section.

1. To remove the filter assembly from the dust cup, hold the dust cup cover from the handle in one hand and with the other hand, turn the dust cup container counter clockwise. (Fig. 8)

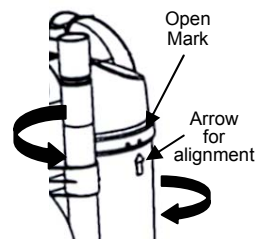

2. Remove the filter assembly from the dust cup container.
3. To separate the filter assembly, hold the bottom of the filter frame and pull the HEPA-Type filter out. (Fig. 9)

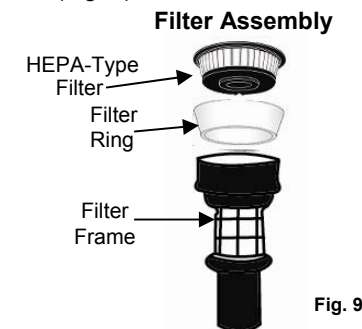

4. Remove the filter ring that is around the HEPA-Type filter. Then vigorously "TapClean" the HEPA-Type Filter on a hard surface until no more dust is observed falling out.



5. To clean the filter frame, we recommend that you rinse it under lukewarm running water to remove the dirt that accumulates on it, but always allow 24 hours to air dry before inserting back into the vacuum.
6. To re-assemble the filter assembly, insert the filter ring over the HEPA-Type filter and then insert the HEPA-Type filter assembly into the filter frame. Replace the filter assembly into the dust cup container. Replace the dust cup container cover.



Free Manuals Download Website

<http://myh66.com>

<http://usermanuals.us>

<http://www.somanuals.com>

<http://www.4manuals.cc>

<http://www.manual-lib.com>

<http://www.404manual.com>

<http://www.luxmanual.com>

<http://aubethermostatmanual.com>

Golf course search by state

<http://golfingnear.com>

Email search by domain

<http://emailbydomain.com>

Auto manuals search

<http://auto.somanuals.com>

TV manuals search

<http://tv.somanuals.com>