

EURO-PRO X

Cordless Hand Sweeper

OWNER'S MANUAL

Model V1707H

4.8 Volt DC



EURO-PRO Operating LLC Operating LLC

94 Main Mill Street, Door 16

Plattsburgh, NY 12901

Tel: 1 (800) 798-7398



ONE (1) YEAR LIMITED WARRANTY

EURO-PRO Operating LLC warrants this product to be free from defects in material and workmanship for a period of one (1) year from the date of the original purchase, when utilized for normal household use, subject to the following conditions, exclusions and exceptions.

If your appliance fails to operate properly while in use under normal household conditions within the warranty period, return the complete appliance and accessories, freight prepaid to:

In US: **EURO-PRO Operating LLC**, 94 Main Mill Street, Door 16, Plattsburgh, N.Y. 12901

If the appliance is found to be defective in material or workmanship, **EURO-PRO Operating LLC** will repair or replace it free of charge. Proof of purchase date and \$ 9.95 to cover the cost of return shipping and handling must be included. *

Non-durable parts including, without limitation, dust trays and brushes which normally require replacement are specifically excluded from warranty.

The liability of **EURO-PRO Operating LLC** is limited solely to the cost of the repair or replacement of the unit at our option. This warranty does not cover normal wear of parts and does not apply to any unit that has been tampered with or used for commercial purposes. This limited warranty does not cover damage caused by misuse, abuse, negligent handling or damage due to faulty packaging or mishandling in transit. This warranty does not cover damage or defects caused by or resulting from damages from shipping or repairs, service or alterations to the product or any of its parts, which have been performed by a repair person not authorized by **EURO-PRO Operating LLC**.

This warranty is extended to the original purchaser of the unit and excludes all other legal and/or conventional warranties. The responsibility of **EURO-PRO Operating LLC**, if any, is limited to the specific obligations expressly assumed by it under the terms of the limited warranty. **In no event is EURO-PRO Operating LLC** liable for incidental or consequential damages of any nature whatsoever. Some states do not permit the exclusion or limitation of incidental or consequential damages, so the above may not apply to you.

This warranty gives you specific legal rights, and you may also have other rights which vary from state to state.

***Important: Carefully pack item to avoid damage in shipping. Be sure to include proof of purchase date and to attach tag to item before packing with your name, complete address and phone number with a note giving purchase information, model number and what you believe is the problem with item. We recommend you insure the package (as damage in shipping is not covered by your warranty). Mark the outside of your package "ATTENTION CUSTOMER SERVICE". We are constantly striving to improve our products, therefore the specifications contained herein are subject to change without notice.**



OWNERSHIP REGISTRATION CARD

Please fill out and mail the product registration card within ten (10) days of purchase. The registration will enable us to contact you in the unlikely event of a product safety notification. By returning this card you acknowledge to have read and understood the instructions for use, and warnings set forth in the accompanying instructions.

To: **EURO-PRO Operating LLC**, 94 Main Mill Street, Door 16, Plattsburgh, N.Y., 12901

V1707H

Appliance model

Date purchased

Name of store

Owner's name

Address

City

State

Zip Code

IMPORTANT SAFEGUARDS

When using an electrical appliance, basic safety precautions should always be observed, including the following:

READ ALL INSTRUCTIONS BEFORE USING YOUR CORDLESS HAND SWEEPER.

! WARNING: To reduce the risk of fire, electrical shock, or injury:

- Do not charge this unit outdoors.
- Do not use outdoors or on wet surfaces.
- Do not allow to be used as a toy. Close attention is necessary when used by or near children.
- Use only as described in this manual. Use only manufacturer's recommended attachments.
- Do not use charger with damaged cord or plug. Do not use cordless hand sweeper if it has been dropped, damaged, left outdoors, or dropped in water. Return it to **EURO-PRO Operating LLC** for examination, repair or adjustment.
- Do not abuse the charger cord. Never carry the charger or base by the cord or yank to disconnect from an outlet; instead grasp the charger and pull to disconnect.
- Keep charger cord away from heated surfaces.
- This product includes rechargeable nickel cadmium batteries. Batteries must be recycled or disposed of properly. **Do not incinerate batteries or expose to high temperatures**, as they may explode.
- Do not handle plug or appliance with wet hands.
- Do not put any object into openings. Do not use with any opening blocked; keep free of dust, lint, hair and anything that may reduce air flow.
- Keep hair, loose clothing, fingers, and all parts of body away from openings and moving parts.
- Do not pick up anything that is burning or smoking, such as cigarettes, matches, or hot ashes.
- Do not use to pick up flammable or combustible liquids such as gasoline or use in areas where they may be present.
- Do not use charger with an extension cord. Plug charger directly into an electrical outlet. Use charger only in a standard (120V., 60Hz) electrical outlet.
- Keep end of rotating brush and other openings away from your face and body.
- Do not use the cordless hand sweeper without dust container in place.**
- Store the cordless hand sweeper indoors. Store after use to prevent accidents.
- Leaks from battery cells can occur under extreme conditions. If the liquid, which is 20-35% solution of potassium hydroxide, gets on the skin - wash immediately with soap and water or neutralize with a mild acid such as lemon juice or vinegar. If the liquid gets into the eyes, flush them immediately with clean water for a minimum of 10 minutes and seek medical attention.
- Use only on dry, indoor surfaces.
- Do not use for any purpose other than described in this user's guide.
- Do not attempt to use the charger with any other product or attempt to charge this product with another charger. **Use only the charger supplied with this appliance.**
- The battery is to be recycled or disposed of safely.
- The appliance must be disconnected from the supply when removing the battery

**SAVE THESE INSTRUCTIONS
FOR HOUSEHOLD USE ONLY**

EURO-PRO X™

CORDLESS HAND SWEEPER

Model V1707H
4.8 Volt DC

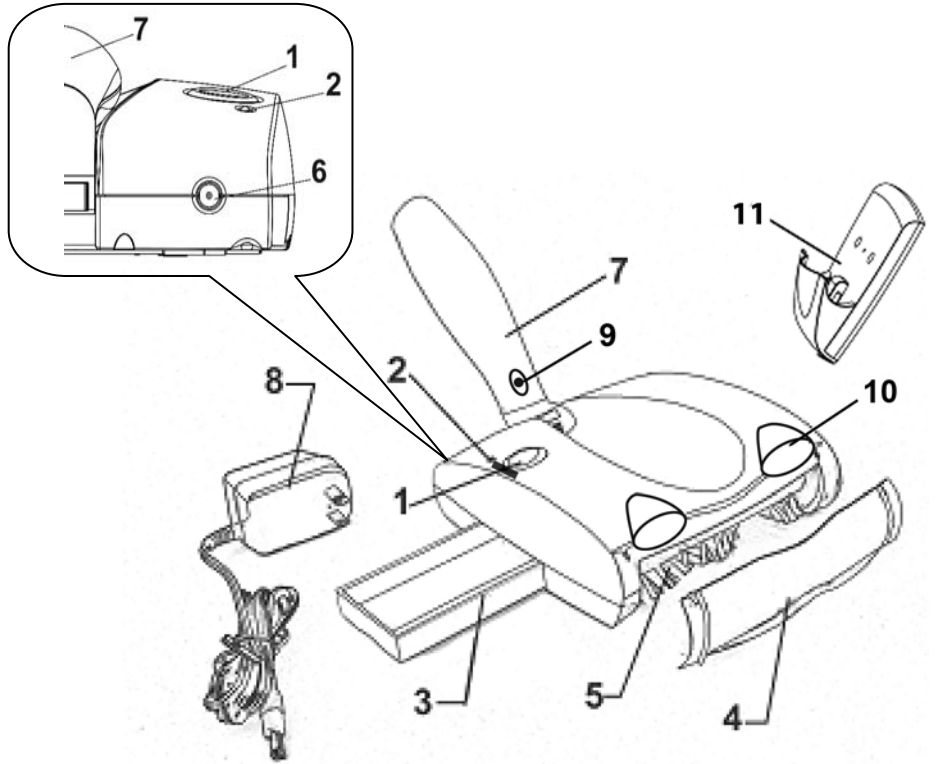

- | | |
|-----------------------------|---|
| 1. On / Off Switch | 6. Charging Jack |
| 2. Charging Light Indicator | 7. Pivoting Telescopic Handle |
| 3. Dust Tray | 8. Charging Adapter |
| 4. Transparent Brush Cover | 9. Telescopic Handle Release Button |
| 5. Rotating Brush | 10. Headlight (x2) |
| | 11. Charging Stand with Wall Mount Screws |

Note: Illustrations may differ from actual unit.

NOTE: Cordless Hand Sweeper is shipped with the batteries uncharged. Charging of the unit for 24 hours prior to first use is required. Use replacement battery # XB1707H only.

Care and Maintenance

To improve the performance and life of your unit, we recommend you do the following:

1. Once a month clean the unit with a dry cloth, including the chamber into which the dust tray fits. Remove any hair, fiber or other materials that may have built up in the chamber and on the rotating brush.
2. Don't use abrasive materials to clean the hand sweeper. **Do not immerse the unit in water.**
3. Do not pick up liquids or use on wet floors.
4. Do not use on concrete, tar or similar rough surfaces .
5. Don't pick up pieces of string or fabrics with the sweeper.
6. Do not clean tasseled or frayed carpets with the sweeper.
7. To remove the squeegee, turn the screw plug a quarter turn counter clockwise and slide the squeegee out. Slide the new squeegee in and then turn the screw plug a quarter turn clockwise to lock the squeegee in place. For replacement squeegees, call 1 (800) 798-7398.

TROUBLESHOOTING GUIDE

PROBLEM	POSSIBLE REASON	POSSIBLE SOLUTION
SWEEPER WILL NOT OPERATE	<ol style="list-style-type: none"> 1. Batteries discharged. 2. No power in electrical outlet supplying transformer. 3. Unit needs servicing. 	<ol style="list-style-type: none"> 1. Charge unit. 2. Check fuse or breaker. Replace fuse/reset breaker. 3. Call Customer Service.
SWEEPER WILL NOT PICK-UP	<ol style="list-style-type: none"> 1. Dust tray is full. 2. Unit needs recharging. 3. Brush bar dirty. 	<ol style="list-style-type: none"> 1. Empty dust tray. 2. Charge unit. 3. Clean brush bar.
DUST ESCAPING FROM SWEEPER	<ol style="list-style-type: none"> 1. Dust tray is full. 2. Brush bar dirty. 	<ol style="list-style-type: none"> 1. Empty dust tray. 2. Clean brush bar.
ROTATING BRUSH WILL NOT PICK UP	<ol style="list-style-type: none"> 1. Unit clogged. 2. Dust tray is full. 	<ol style="list-style-type: none"> 1. Check for excessive material on brush or in bottom of sweeper. Remove obstruction from brushes and/or sweeper. 2. Empty and clean dust tray.
SWEEPER WILL NOT CHARGE	<ol style="list-style-type: none"> 1. Electrical outlet not working 2. Charging Adapter not working 3. Batteries no longer functioning 4. On/Off switch is in the ON position. 	<ol style="list-style-type: none"> 1. Check to ensure outlet is working properly. (Easily checked by plugging in another appliance. 2. Replace charging adapter 3. See battery disposal. 4. Depress On/Off switch.

Battery Removal & Disposal

NOTE: If uncertain as to how to remove your battery pack, we suggest you take your sweeper to a reputable small appliance service technician to have this service performed.

Follow these steps when battery removal is required.

This hand sweeper is equipped with Ni-Cd batteries and you need to dispose of them properly. When the batteries are no longer good for use, they must be removed from the sweeper for disposal. Do not remove the batteries for any reason other than disposal of them. **The batteries must be recycled or disposed of in accordance with local regulations. Please consult your Yellow Pages or local recycling center for more information.**

WARNING: You must never use ordinary batteries for replacement as these may leak and cause damage. Use only battery pack **XB1707H** supplied for replacement by **Euro-Pro**.

Removal of Battery Pack

1. Turn unit over so that the base is facing upwards.
2. With a #1 Phillips screw driver, remove the screw securing the battery pack compartment cover to the unit and place aside. (Fig. 9)
3. Remove the old battery pack from the unit and detach the connector jack from the unit. (Fig. 10)
4. Attach the connector jack from the new battery pack to the female connector jack in the battery compartment.
5. Insert the new battery pack into the battery compartment making sure that all the wiring carefully tucked inside under the battery pack.
6. Replace screw to secure the battery compartment cover to the unit. Do not over tighten.

CAUTION: This appliance contains Ni-Cd batteries. The batteries must be recycled or disposed of in accordance with local regulations. Please consult your Yellow Pages or local recycling center for more information.

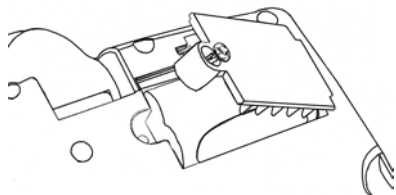

Fig. 9

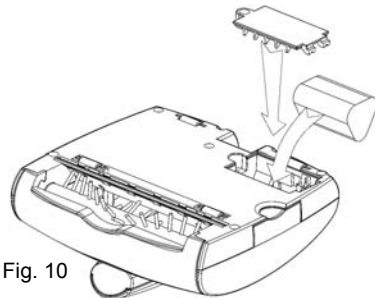
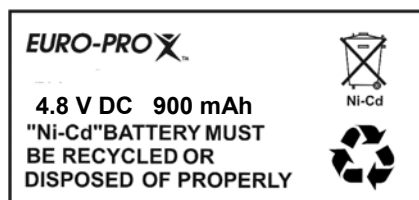

Fig. 10



HOW TO OPERATE YOUR CORDLESS HAND SWEEPER

Before you start:

Your Cordless Hand Sweeper will require very little assembly. You should remove it from the carton and familiarize yourself with all the components listed as per the parts drawing (pg.2) This will help you in the assembly and operation of your cordless hand sweeper.

1. **Before using, please ensure that the cordless hand sweeper has been initially charged for 24 hours.** Your cordless sweeper will only operate properly when the batteries are fully charged. When fully charged, your sweeper will operate for approximately 90 minutes - dependent upon the type of use (example - counters/tabletops or upholstery).
2. Push the On/Off switch to operate the unit. To turn off, press switch again. (Fig. 1)

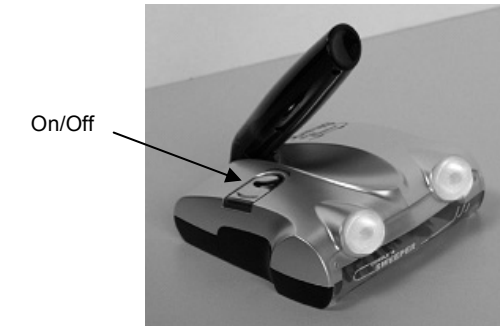

Fig. 1

EXTENDING THE TELESCOPIC HANDLE

For an extended reach this unit is equipped with a telescopic handle.

1. To extend the handle, press on the telescopic handle release button and pull up slightly to release the locking mechanism. Continue to pull handle all the way up until it clicks into place. (Fig. 2)
2. To store press the telescopic handle release button while pushing the handle down to release the locking mechanism. Continue to push down on the handle until it locks into place. You may now fold the handle down.

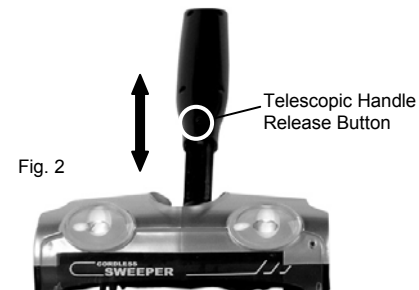

Fig. 2

CAUTION: Any electronic or electrical appliance should not be stored in or exposed to areas of high heat or humidity. Do not store your cordless hand sweeper close to stoves, radiators, furnaces or in a bathroom or bathing area.

CLEANING THE DUST TRAY

To achieve the best performance, empty the dust tray after each use.

1. Pull the dust tray straight out from the side. (Fig. 3)



Fig. 3

2. Empty dust tray contents. (Fig. 4) If desired- you may rinse the dust tray with water to clean - but **dry thoroughly** before replacing into the hand sweeper.

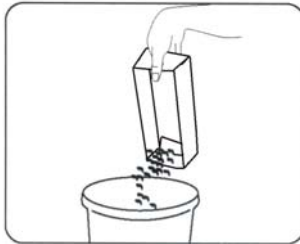

Fig. 4

3. Replace dust tray into cordless hand sweeper.
4. Periodically remove the transparent brush cover on the front of the cordless hand sweeper and remove any build up of lint, hair or fiber on the rotating brush. To remove the transparent cover - grip the cover from the bottom, pull down and out until the cover unlocks from the bottom slots and tabs located on the top of the sweeper. (Fig. 5, Fig. 6)

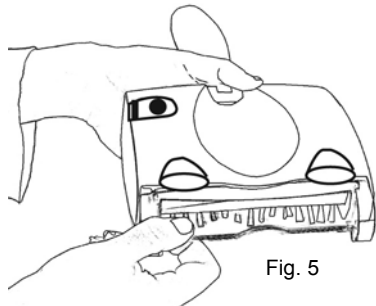

Fig. 5

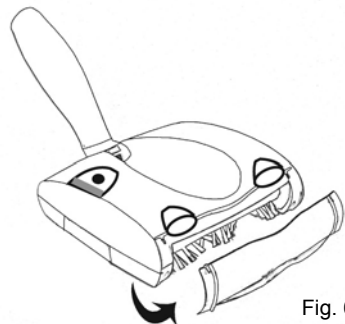

Fig. 6

CAUTION: Do not accidentally turn unit on while cleaning.
Do not clean while unit is charging.

CHARGING THE CORDLESS HAND SWEEPER

- 1a. Connect the charger plug to the charging jack or hole on the back of the hand sweeper. Plug the the charging adapter into the wall outlet. (120V.,60Hz.) Use only the charger supplied by the manufacturer, rated output DC 6V, 100mAh. (Fig. 7)
OR
- 1b. Connect the charger plug on the charging jack of charging stand (Fig. 8). Plug the charging adapter into the wall outlet(120V., 60Hz). Use only charger provided, place the unit in the charging stand.
2. This cordless hand sweeper is powered by Ni-Cd batteries. Before first use, they must be charged for a minimum of 24 hours. When the batteries are charging, charging light indicator on the top of the unit will illuminate to tell you that the unit is charging.
3. Once the batteries are fully charged, the cordless hand sweeper will run for approximately 90 minutes before recharging is required.
4. When recharging the unit, the "On/Off" switch must be in the "OFF" position.
5. The charging light indicator on the top of the sweeper will illuminate to indicate that the sweeper is properly charging.
6. To recharge, repeat step # 1 above. Charging times will vary depending upon the amount of usage between charging cycles.

Wall Mounting Bracket

1. Make sure that the intended wall area for the wall mounting bracket to be drilled is free from any hidden electrical wires, water pipes and gas lines.
2. Select an appropriate place close to a wall power outlet (120V., 60 Hz).
3. Do not mount near direct sunlight, near a heat source or outdoors.
4. Select an appropriate drill type for the material to be drilled.
5. Carefully measure and mark the location of all bracket holes and then drill holes and screw the wall mounting bracket onto the wall.

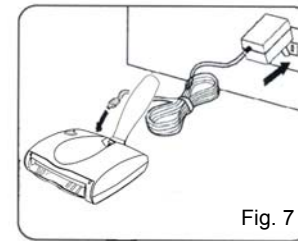

Fig. 7

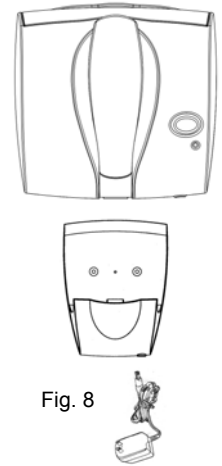

Fig. 8

NOTE: If, when you place the sweeper to recharge and the charging indicator light does **NOT** illuminate, then press the On/Off button once to turn the sweeper off. The charging indicator light should now light up.

NOTE: Peak performance may only be realized after the unit has been charged and discharged two (2) or three (3) times.

IMPORTANT: To maintain peak performance of your cordless hand sweeper, it is recommended that the unit be fully discharged, then completely re-charged at least once a month.

CAUTION

- Use only with the battery pack supplied with the unit.
- Do not attempt to remove the battery pack from the unit to charge it.
- Never attempt to throw the battery pack or unit into a fire or incinerate it.
- Do not attempt to remove or damage the battery casing.
- Battery must be recycled or disposed of properly at the end of it's service life.

Free Manuals Download Website

<http://myh66.com>

<http://usermanuals.us>

<http://www.somanuals.com>

<http://www.4manuals.cc>

<http://www.manual-lib.com>

<http://www.404manual.com>

<http://www.luxmanual.com>

<http://aubethermostatmanual.com>

Golf course search by state

<http://golfingnear.com>

Email search by domain

<http://emailbydomain.com>

Auto manuals search

<http://auto.somanuals.com>

TV manuals search

<http://tv.somanuals.com>