

Hideaway® HSA 200S Series

Compact, Fixed Configuration, Tilt-Up HSA - Hideaway Surface Access Enclosures with Square Bezel



COMMON FEATURES

- Durable pneumatic movement and mechanical latching mechanism
- HSA 200SE includes built-in Extender video and audio line driver
- Top surface available in black anodized or brushed aluminum finishes
- One female 15-pin HD connector and 3.5 mm mini stereo audio jack
- Two CAT 6 RJ-45 network/data/phone connectors; unswitched AC outlet
- Versions available with US, Australia, UK, Central Europe, Switzerland, France, Israel, or India power outlets
- **NEW** Available Universal AC power receptacle accepts US, UK, Israel, Central Europe, France, Australia, India, Swiss, Italy, and Denmark AC plug types
- UL/CUL listed and CE compliant
- Installation routing template available upon request
- Brushed brass and polished aluminum finishes available by special order, requires 11-14 week lead time

DESCRIPTION

The Extron **Hideaway HSA 200S** and **HSA 200SE** provide compact, tilt-up, architectural solutions for inconspicuous computer-video interface connector access. The HSA 200SE provides a built-in Extron Extender line driver, which allows computer video signals to be output on five BNC pigtails and driven over long cable runs without degradation of the signal. The Extender also converts unbalanced audio to a balanced signal.

The HSA 200S and HSA 200SE square bezel enclosures are designed for easy mounting into virtually any table surface and are ergonomically designed, keeping installation time and effort at a minimum. Once installed, the HSA 200S and HSA 200SE products fit flush with the tabletop, storing connectors out of sight. To access the connectors, users press down on the top of the enclosure. Pressing down releases a mechanical latch and the HSA slowly pivots into view, presenting the connectors at an ergonomic 49-degree angle to the tabletop.

Both models offer one female 15-pin HD connector, one unswitched AC outlet, two bezel-mounted CAT 6 RJ-45 network/data/phone connectors, and audio on 3.5 mm stereo jack connectors on its faceplate.

The HSA 200S and HSA 200SE include an RJ-45 connection kit for each front panel RJ-45 jack. Inside the kit, there is one set of icons for labeling, one blank hole filler, and an assortment of colored bezels. This offers the option of labeling and color-coding the RJ-45 connectors as they pertain to their assigned function, or covering the connector when it is not needed. The Hideaway HSA 200S and HSA 200SE ship standard in black anodized or brushed aluminum finish.*

Versions are available with discrete US, Australia, UK, Central Europe, Switzerland, France, Israel, or India power outlets, as well as a universal receptacle ideal for use in hotels and conference centers.

*Polished aluminum finish and brushed brass finish are also available. These models are built to order and require a longer lead time. Call an Extron Customer Support Representative for more information.

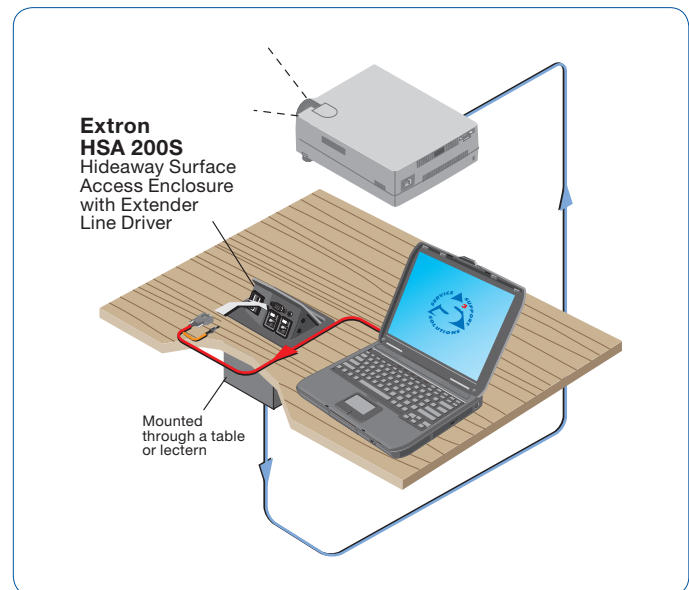

Continued →

Hideaway® HSA 200S Series

HSA 200S

Compact, Fixed Configuration, Tilt-Up HSA - Hideaway Surface Access Enclosures with Square Bezel



Closed view



MODEL	VERSION DESCRIPTION	PART #
HSA 200S	US – Black Anodized	60-510-01
HSA 200S	US – Brushed Aluminum	60-510-03
HSA 200S	UK – Black Anodized	60-705-0B
HSA 200S	UK – Brushed Aluminum	60-705-1B
HSA 200S	ISRAEL – Black Anodized	60-705-0C
HSA 200S	ISRAEL – Brushed Aluminum	60-705-1C
HSA 200S	EU – Black Anodized	60-705-0D
HSA 200S	EU – Brushed Aluminum	60-705-1D
HSA 200S	FRANCE – Black Anodized	60-705-0E
HSA 200S	FRANCE – Brushed Aluminum	60-705-1E
HSA 200S	AUS – Black Anodized	60-705-0F
HSA 200S	AUS – Brushed Aluminum	60-705-1F
HSA 200S	INDIA – Black Anodized	60-705-0G
HSA 200S	INDIA – Brushed Aluminum	60-705-1G
HSA 200S	SWISS – Black Anodized	60-705-0H
HSA 200S	SWISS – Brushed Aluminum	60-705-1H
HSA 200S NEW	UNIVERSAL – Black Anodized	60-705-0J
HSA 200S NEW	UNIVERSAL – Brushed Aluminum	60-705-1J

HSA 200SE

Compact, Fixed Configuration, Tilt-Up HSA - Hideaway Surface Access Enclosures with Square Bezel and Extender Line Drive

UNIQUE FEATURES

- Includes built-in Extender video and audio line driver



Closed view



MODEL	VERSION DESCRIPTION	PART #
HSA 200SE	US – Black Anodized	60-511-01
HSA 200SE	US – Brushed Aluminum	60-511-03
HSA 200SE	UK – Black Anodized	60-706-0B
HSA 200SE	UK – Brushed Aluminum	60-706-1B
HSA 200SE	ISRAEL – Black Anodized	60-706-0C
HSA 200SE	ISRAEL – Brushed Aluminum	60-706-1C
HSA 200SE	EU – Black Anodized	60-706-0D
HSA 200SE	EU – Brushed Aluminum	60-706-1D
HSA 200SE	FRANCE – Black Anodized	60-706-0E
HSA 200SE	FRANCE – Brushed Aluminum	60-706-1E
HSA 200SE	AUS – Black Anodized	60-706-0F
HSA 200SE	AUS – Brushed Aluminum	60-706-1F
HSA 200SE	INDIA – Black Anodized	60-706-0G
HSA 200SE	INDIA – Brushed Aluminum	60-706-1G
HSA 200SE	SWISS – Black Anodized	60-706-0H
HSA 200SE	SWISS – Brushed Aluminum	60-706-1H
HSA 200SE NEW	UNIVERSAL – Black Anodized	60-706-0J
HSA 200SE NEW	UNIVERSAL – Brushed Aluminum	60-706-1J

AC OUTLET OPTIONS



Continued →

Hideaway® HSA 200S Series

Hideaway® HSA 200C Series Accessories

ROUTING TEMPLATES	MODEL DESCRIPTION	PAGE	PART #
HSA 200/222 and Cable Cubby 300S/300C			
Routing Template: US Template	HSA 200/222 US Routing Template	n/a	70-237-01
HSA 200/222 Routing Template	HSA 200/222 International Routing Template	n/a	70-237-02

OPTIONAL ACCESSORIES	MODEL DESCRIPTION	PAGE	PART #
HSA 200 RJ-11 Cable Kit	For HSA - Hideaway Surface Access Enclosures - HSA 200 Kit	n/a	70-231-01
Flexible Conduit Adapter Kit For HSA 200/222	Installation Kit for Hard Wired Electrical Environments - HSA 200/222	page 140	70-229-01

SPECIFICATIONS

VIDEO – HSA 200SE

Gain	Selectable: unity (0.7 V), (0.75 V) 50%, (0.8 V) 100%
Bandwidth	300 MHz (-3 dB)

NOTE: ID bits are terminated on pins 4 and 11.

VIDEO INPUT – HSA 200S

Number / Signal type	1 VGA–UXGA RGBHV, RGsB, RsGsBs
Connectors	(1) 15-pin HD female

VIDEO INPUT – HSA 200SE

Number / Signal type	1 VGA–UXGA RGBHV, RGsB, RsGsBs
Connectors	(1) 15-pin HD female
Nominal level	0.7 Vp-p for RGB
Minimum / Maximum levels	Analog: 0.3 V to 1.5 Vp-p with no offset at unity gain
Impedance	75 ohms
Horizontal frequency	15 kHz to 135 kHz
Vertical frequency	30 Hz to 170 Hz

VIDEO OUTPUT – HSA 200S

Number / Signal type	1 pass-through VGA–UXGA RGBHV, RGsB, RsGsBs
Connectors	5 BNC female on pigtails

VIDEO OUTPUT – HSA 200SE

Number / Signal type	1 VGA–UXGA RGBHV, RGsB, RsGsBs
Connectors	5 BNC female on pigtails
Nominal level	0.7 Vp-p for RGB
Minimum / Maximum levels	Analog: 0.3 V to 1.5 Vp-p
Impedance	75 ohms
DC offset	±5 mV with input at 0 offset

NOTE: Output resolution may vary depending on whether or not the Extender is attached to the computer at startup, and also on the type of computer being used.

SYNC – HSA 200SE

Input type	RGBHV, RGsB, RsGsBs
Output type	RGBHV, RGsB, RsGsBs
Input level	2.0 V to 5.0 Vp-p
Output level	TTL: 5.0 Vp-p, unterminated
Input impedance	510 ohms
Output impedance	75 ohms
Max. propagation delay	18.8 ns
Max. Rise / Fall time	4 ns
Polarity	Positive or negative (follows input)

AUDIO – HSA 200SE

Gain	Unbalanced output: 0 dB; balanced output: +6 dB
Frequency response	20 Hz to 20 kHz, ±0.5 dB
THD + Noise	0.025% @ 1 kHz, 0.020% @ 20 kHz at nominal level
S/N	>90 dB at rated maximum output (21 dB, balanced)
Stereo channel separation	>75 dB @ 20 Hz to 20 kHz

AUDIO INPUT – HSA 200S

Number / Signal type	1 stereo, unbalanced
Connectors	(1) 3.5 mm stereo female jack

AUDIO INPUT – HSA 200SE

Number / Signal type	1 stereo, unbalanced
Connectors	(1) 3.5 mm stereo female jack
Impedance	>10k ohms unbalanced, DC coupled
Nominal level	-10 dBV (316 mVrms)
Maximum level	+6 dBu, (balanced or unbalanced) at 1% THD+N

NOTE: 0 dBu = 0.775 Vrms. 0 dBV = 1 Vrms. 0 dBV = 2 dBu.

AUDIO OUTPUT – HSA 200S

Number / Signal type	1 pass-through stereo, unbalanced
Connectors	(1) 3.5 mm, direct insertion captive screw connector, 3 pole

AUDIO OUTPUT – HSA 200SE

Number / Signal type	1 stereo, balanced/unbalanced
Connectors	(1) 3.5 mm direct insertion captive screw connector, 5 pole
Impedance	50 ohms unbalanced, 100 ohms balanced
Nominal level	Unbalanced output: -10 dBV (316 mVrms) Balanced output: -2 dBu (632 mVrms)
Maximum level (Hi-Z)	>+14 dBu, balanced at 1% THD+N
Maximum level (600 ohm)	>+5.5 dBm, balanced at 1% THD+N

GENERAL

Power (HSA 200SE)	Supplied by an external power supply External power supply: 100 VAC to 240 VAC, 50/60 Hz, external, autoswitchable; to 12 VDC, 0.42 A, regulated Power input requirements: 12 VDC, 0.2 A
-------------------	--

Temperature / Humidity

(HSA 200SE)	Storage: -40 to +158 °F (-40 to +70 °C) / 10% to 90%, noncondensing Operating: -3° to +122 °F (0 to +50 °C) / 10% to 90%, noncondensing
-------------	--

Rack mount

No, but furniture mountable

Enclosure type

Metal

Enclosure dimensions

CAUTION: Use the appropriate metal Extron routing template or refer to the surface cutout dimensions here before cutting a hole in the furniture or other surface. Pay special attention to the direction the unit will face; the unit's connector access side is underlined. Extron is not responsible for miscut mounting holes.

USA models

Top plate (outer rim)	6.470" W x 5.125" D (16.43 cm W x 13.02 cm D)
Surface cutout (inside rim)	5.970 ±0.0325" W x 4.625 ±0.0325" D <u>(15.16 ±0.083 cm W x 11.75 ±0.083 cm D)</u>
Top plate (inside tilt plate)	4.344" W x 3.000" D (11.03 cm W x 7.62 cm D)
Box (under surface)	4.0" H x 4.6" W (front of unit) x 4.4" D (10.2 cm H x 11.7 cm W x 11.2 cm D) without clamps 4.0" H x 8.0" W (front of unit) x 4.4" D (10.2 cm H x 20.3 cm W x 11.2 cm D) with clamps

International models

Top plate (outer rim)	8.183" W x 6.375" D (20.79 cm W x 16.19 cm D)
Surface cutout (inside rim)	7.683 ±0.0325" W x 5.875 ±0.0325" D <u>(19.51 ±0.083 cm W x 14.92 ±0.083 cm D)</u>
Top plate (inside tilt plate)	5.90" W x 4.10" D (14.99 cm W x 10.41 cm D)
Box (under surface)	4.0" H x 6.3" W (front of unit) x 5.0" D (10.2 cm H x 15.9 cm W x 12.7 cm D) without clamps 4.0" H x 10.0" W (front of unit) x 5.0" D (10.2 cm H x 25.3 cm W x 12.7 cm D) with clamps

Product weight

HSA 200S	4.0 lbs (1.8 kg)
HSA 200SE	5.0 lbs (2.3 kg)

Shipping weight

HSA 200S	7 lbs (4 kg)
HSA 200SE	8 lbs (4 kg)

Vibration

ISTA 1A in carton (International Safe Transit Association)

Listings, certification

UL, CUL, CSA C/US

Compliances

HSA 200SE: CE, FCC Class A, VCCI, AS/NZS, ICES

MTBF

30,000 hours

Warranty

3 years parts and labor

NOTE: All nominal levels are at ±10%. Specifications are subject to change without notice.

Free Manuals Download Website

<http://myh66.com>

<http://usermanuals.us>

<http://www.somanuals.com>

<http://www.4manuals.cc>

<http://www.manual-lib.com>

<http://www.404manual.com>

<http://www.luxmanual.com>

<http://aubethermostatmanual.com>

Golf course search by state

<http://golfingnear.com>

Email search by domain

<http://emailbydomain.com>

Auto manuals search

<http://auto.somanuals.com>

TV manuals search

<http://tv.somanuals.com>