

FENDER® JAZZMASTER™ ULTRALIGHT LOUDSPEAKER ENCLOSURE

Your new Jazzmaster™ Ultralight loudspeaker features a Jensen® 12" (30.5 cm) speaker with a neodymium magnet, handling up to 250 watts of power. Designed to complement the Fender® Jazzmaster Ultralight amplifier, the Ultralight speaker cabinet is constructed from quality Italian poplar plywood. Please read these instructions and your amplifier manual before making connections.

Ultralight Connections

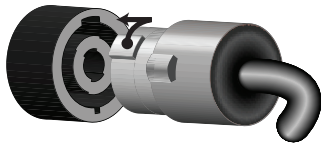

To connect the Jazzmaster™ Ultralight speaker to an Ultralight amplifier, use the Speakon® cable included with the amplifier. Rotate the Speakon® connector to align it with the input slots, then fully insert the connector.

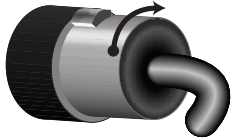

Rotate the connector clockwise until it locks into place.

Disconnecting

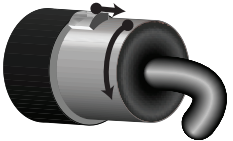

Slide the locking tab back on the connector while rotating the connector counter-clockwise. Pull the connector out from the input socket.

Non-Speakon® Connections

If your amplifier does not have a Speakon® speaker output, you will need the appropriate speaker cable or adapter to connect the Jazzmaster™ Ultralight loudspeaker. Speaker cable should be 2-conductor, 16-gauge minimum with the Speakon® connector wired:

1+ pin = Positive

1- pin = Negative



SPECIFICATIONS

PART NUMBER	2277700000
SPEAKER	One 12" (30.5 cm) steel frame driver 2" (5.1 cm) voice coil Neodymium magnet
CABINET	5/8" (1.6 cm) Italian Poplar plywood
SENSITIVITY	98.5 dB, 1 Watt - 1 Meter
POWER HANDLING	250 Watts
IMPEDANCE	2 ohms
CONNECTIONS	4-Pole Speakon® Connector using Pins 1+ and 1-
ENCLOSURE VOLUME	V _B = 0.8 ft ³ (38.7 L)
DIMENSIONS	Height: 15 1/4 in (38.7 cm) Width: 15 1/4 in (38.7 cm) Depth: 10 1/4 in (26.0 cm)
WEIGHT	16 lb (7.3 kg)

Product specifications are subject to change without notice.

A PRODUCT OF:
FENDER MUSICAL INSTRUMENTS CORPORATION
CORONA, CALIFORNIA USA

Fender® and Jazzmaster™ are trademarks of FMIC.
Other trademarks are property of their respective owners.
© 2005 FMIC. All rights reserved.

Free Manuals Download Website

<http://myh66.com>

<http://usermanuals.us>

<http://www.somanuals.com>

<http://www.4manuals.cc>

<http://www.manual-lib.com>

<http://www.404manual.com>

<http://www.luxmanual.com>

<http://aubethermostatmanual.com>

Golf course search by state

<http://golfingnear.com>

Email search by domain

<http://emailbydomain.com>

Auto manuals search

<http://auto.somanuals.com>

TV manuals search

<http://tv.somanuals.com>