

The MA120 is a two channel amplifier with independent output level and BQ for each channel.

MA120 AMPLIFIER INSTRUCTION MANUAL



OTHER FIRST ACT® PRODUCTS :



Guitar Case



10 & 20ft Cables



Auto Tuner

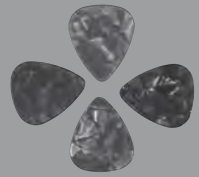

Picks



Books



Guitar Strings



Stringwinder



First Act Inc.
745 Boylston Street
Boston, MA 02116 USA
firstact.com



Customer Assistance
Phone: 888.551.1115
Email: info@firstact.com

©2006 First Act Inc. All rights reserved.
First Act and the First Act logo are
trademarks of First Act Inc.
US Patent Nos. D487,627S
MA120.M.02

IMPORTANT SAFETY INSTRUCTIONS
Please read carefully before operating your amplifier:
Follow these basic precautionary measures to ensure a longer life for your amplifier, and to reduce the risk of electric shock.

1. This unit should be protected from contact with water, moisture, or liquids of any kind.
 2. This amplifier should only be serviced by a qualified repair technician.
 3. This unit should not be placed near a heat source (permissible operating temperature range 32-104°F).
 4. Do not set heavy objects on the power cable or allow the cable to be torn. If the cable needs repair, do not plug the amplifier in. Have the amplifier repaired immediately by a qualified service technician.
 5. Unplug your amplifier when not in use for extended periods of time.
 6. Turn amplifier power off when not in use.
 7. The outside of the amplifier may be cleaned with a dry cloth only. Do not use water or chemicals to clean.
 8. This unit contains digital circuitry and may cause interference if placed too close to radio or television receivers.
9. Do not operate the amplifier if:
 - » the unit or main cable has been visibly damaged
 - » the unit has been dropped
 - » the unit has been exposed to moisture/liquids of any kind
 - » the unit is not functioning properly
 10. Do not expose the unit to:
 - » Direct sunlight
 - » Excessive humidity
 - » Excessive dust
 - » Strong vibration
 11. This unit must be properly grounded.
 12. To prevent electric shock hazard, do not open the cabinet or chassis of the amplifier.
- Note:** If you suspect that your amp is defective, have it checked and repaired by a qualified service technician.

FACEPLATE

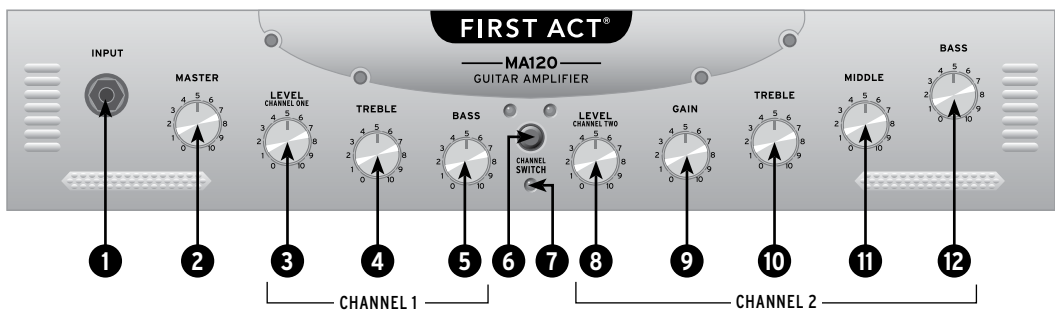

BACKPLATE

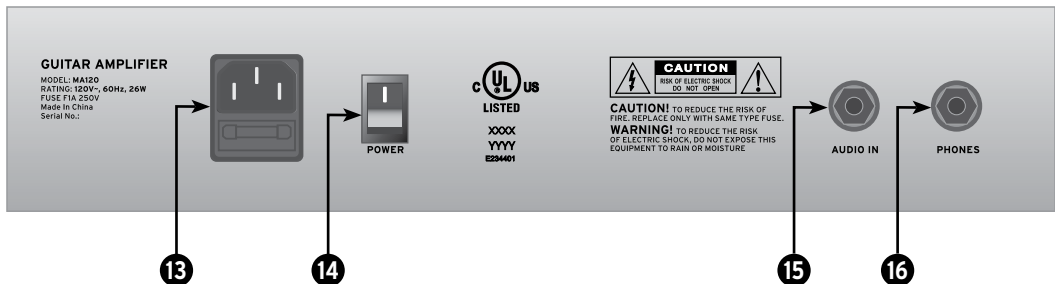

1. **INPUT JACK**
Connect instrument cable here (1/4" jack).
2. **MASTER**
Controls the total output level of amplifier.

CHANNEL 1 - CLEAN CHANNEL

3. **LEVEL**
Controls the output level.
4. **TREBLE**
Adjusts high frequency output.
5. **BASS**
Adjusts low frequency output.
6. **CHANNEL SWITCH**
Switch off/out for Channel 1—indicated by green LED.
Switch on/in for Channel 2—indicated by red LED.
7. **LED**
Indicates amplifier power on/off.

CHANNEL 2 - DISTORTION CHANNEL

8. **LEVEL**
Controls the output level.
9. **GAIN**
Controls the input level. Increasing gain adds distortion, or overdriven rock tone; decreasing gain produces a cleaner sound.
10. **TREBLE**
Adjusts high frequency output.
11. **MIDDLE**
Adjusts middle frequency output.
12. **BASS**
Adjusts low frequency output.

SPECIFICATIONS

Output Power:

20 watts RMS

Frequency Range:

40 Hz ~ 8 kHz

Speaker:

8" / 25W / 4 ohms

Input Sensitivity:

26 mV

Power Supply:

Detachable,
UL-approved
power cable

Dimensions: (LxWxH)

12.5" x 13" x 6.75"

Weight:

15 lbs.

SPECIFICATIONS SUBJECT TO CHANGE WITHOUT NOTICE

REPLACING THE FUSE

An additional fuse has been enclosed in the fuse compartment of your amplifier, directly below the power input. The fuse compartment contains an active fuse and a replacement. The fuse protects against power surges. If your amplifier does not power up as usual, the fuse may need to be replaced.

If the fuse fails:

1. Turn the amplifier power off.
2. Unplug the amplifier.
3. Detach the power cord and set aside.
4. Carefully insert a flathead screwdriver to open the fuse compartment. Be careful not to break the fuse inside.
5. Remove the blown fuse from the inner (active) slot.
6. Move the new fuse from the outer slot to the inner slot.
7. Close the fuse compartment.
8. Discard the blown fuse.

Note: If you replace the fuse and the amplifier still does not power up, have the unit checked by a qualified repair technician.

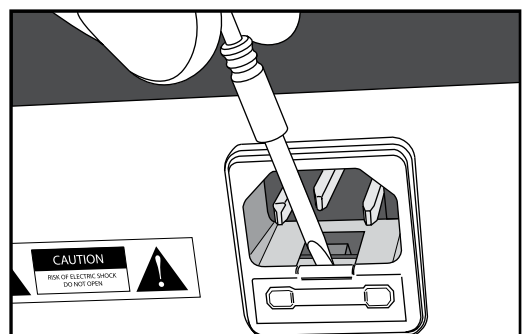

Open the fuse compartment.

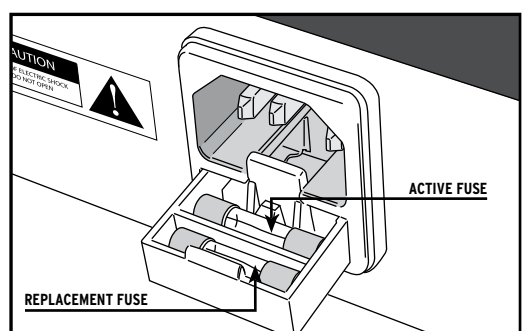

Remove the blown fuse from the inner (active) slot. Move the new fuse from the outer slot to the inner slot.

CAUTION REPLACE ONLY WITH SAME TYPE 250V, 1A FUSE.
USING ANOTHER TYPE IS A POTENTIAL FIRE HAZARD.

Free Manuals Download Website

<http://myh66.com>

<http://usermanuals.us>

<http://www.somanuals.com>

<http://www.4manuals.cc>

<http://www.manual-lib.com>

<http://www.404manual.com>

<http://www.luxmanual.com>

<http://aubethermostatmanual.com>

Golf course search by state

<http://golfingnear.com>

Email search by domain

<http://emailbydomain.com>

Auto manuals search

<http://auto.somanuals.com>

TV manuals search

<http://tv.somanuals.com>