

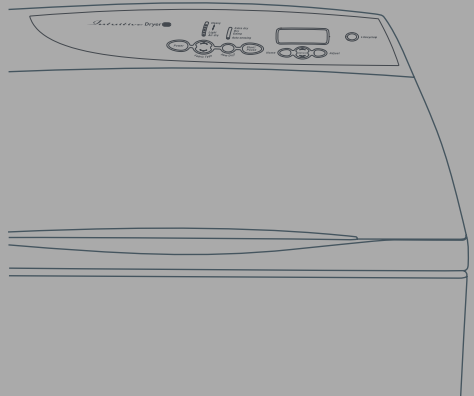

Fisher & Paykel



Intuitive™ Dryer 

DEIX1

Dryer
Installation instructions and
User guide NZ & AU

Contents

Safety Instructions	5
Installation Instructions	8
Location Requirements	8
Exhausting	10
Electrical	13
Installation	14
Features	15
Getting Started Quickly	16
Fabric Type	
Heavy, Mixed, Casual, Dry and Wear	18
Light, Air Dry	19
How Dry?	
Autosensing	20
Dryness Levels	20
Display Screen	21
All About the Option Button	21
Progress Screen	22
The Options	
Creasables, Time Dry	23
End of Cycle Beeps, Reminders, Cycle Tips, Troubleshooting	24
Lifecycles®	
Family Allergy, Towels, Shirts, Lingerie	25
Special Freshen Up, Warm Up, Pillows	25
Bulky Blankets, Jeans, Duvet/Doona	26
Using Your Dryer	
Sorting, Loading	27
Lint Bucket	28
Lidlock	
Power failure	29
Cleaning	30
If your <i>Intuitive™</i> Dryer Beeps for Help	31
Trouble Shooting	32
Manufacturers Warranty	34
Customer Care	35

Thank you for buying a Fisher & Paykel *Intuitive™* dryer.

We hope you enjoy using the *Intuitive™* dryer as much as we have enjoyed designing it. We've developed this dryer to treat your clothes with the utmost care, drying them gently so they will look better for longer. We know you'll enjoy the benefits of its easy loading drum, reverse tumbling and lint removal system.

Please take the time to read this User Guide carefully. It will help you to operate and maintain your new *Intuitive™* dryer.

Your safety, and the safety of others is very important. Located on your dryer and throughout this guide are safety messages and instructions; it is important that you understand and follow them.

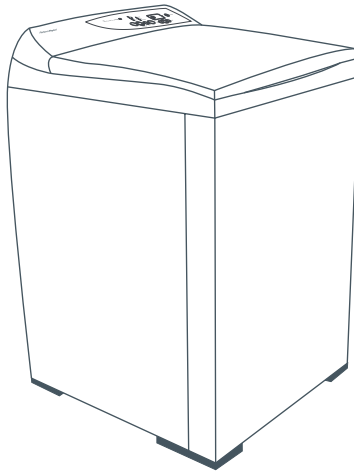

Warranty

Years of development and rigorous testing ensure that you have bought a world-class product. In the unlikely event that a problem should occur, refer to the warranty section at the back of this Guide (refer to Manufacturers Warranty page 34).

If you have a problem with your dryer refer to our Trouble Shooting section (refer to Trouble Shooting pages 32 – 33, or If Your *Intuitive™* Dryer Beeps For Help, page 31). If your problem is not referenced, please always contact your Fisher & Paykel Authorised Service Agent or our Customer Care Centre, in New Zealand – Toll Free 0800 FP CARE (0800 37 2273), in Australia – Toll Free 1300 650 590, rather than attempting to fix it yourself.



Important Safety Instructions



Installation



WARNING!

To reduce the risk of electrocution, injury or fire:

- Read all instructions carefully before using this dryer.
- If you are replacing an old dryer, make sure that children cannot get trapped inside it by (for example) removing the lid.
- Do not store or install the dryer where it will be exposed to water or the weather.
- Before you use this dryer, it must be properly installed and located as described in these instructions.
- Follow carefully the venting details in the installation section. **This dryer must be exhausted outside.**
- Have electrical installation and service performed by a suitably qualified person. Connection by an unqualified person could cause a safety hazard.
- Ensure the dryer is correctly connected to a properly earthed, protected and rated power supply circuit. This circuit must be provided with a means of isolation close to the dryer.
- Do not plug the dryer into an extension cord.
- Make sure the supply cable is located so that it will not be stepped on, tripped over or otherwise subject to stress or damage.

Use



WARNING!

To reduce the risk of electrocution or injury:

- Do not allow children to play inside, around or with this dryer or any other appliance.
- Never climb on, climb into, or stand on the dryer top, lid or drum.
- Do not tamper with the controls or the lid lock.
- If your dryer is running and you want to unload or add clothes, press **START/PAUSE** and wait until the machine has unlocked the lid. Do not force it open.
- Do not put undergarments that contain metal reinforcements in the dryer. Damage to the dryer can result if the metal reinforcements come loose during drying.
- Do not let young children or incapacitated people use this dryer without supervision.
- Do not operate this dryer if it is damaged, malfunctioning, partially disassembled or has missing or broken parts, including a damaged cord or plug.
- Disconnect this dryer from the power supply before attempting any user maintenance or cleaning.



Important Safety Instructions



Note:

Pressing the **POWER** button does NOT disconnect the dryer from the power supply, even though the lights are out.

- When disconnecting a dryer that is plugged in, to avoid damage to the cord or junction of the cord plug, pull by the plug rather than the cord or junction of the cord plug.
- Before the appliance is removed from service or discarded remove the lid and the drum door to the drying compartment.



WARNING!

To reduce the risk of fire generally:

- Do not use this dryer in a commercial installation. It has been designed for domestic use only. In commercial applications there may be increased lint accumulation or flammable materials in the atmosphere or load.
- Use this dryer only for its intended purpose as described in this User Guide.
- Only dry materials washed in water or a detergent and water solution. The dryer is intended for this only.
- Do not put in the dryer items that have been cleaned in, washed in, soaked in or spotted with flammable liquids or solids e.g. petrol, kerosene, dry cleaning solvents, vegetable or cooking oil, waxes or other flammable or explosive substances.
Highly flammable substances commonly used in domestic environments include acetone, denatured alcohol, petrol, kerosene, some brands of spot removers, turpentine, waxes and wax removers.
- Do not use if industrial chemicals have been used for cleaning.
- Do not dry a total textile load (dry weight) of more than 8 kilograms in this dryer.



WARNING

To reduce the risk of fire from spontaneous combustion:

- Do not put items that have been spotted or soaked with vegetable oil or cooking oil in the dryer. They are a fire hazard.
Oil-affected items can ignite spontaneously, especially when exposed to heat sources such as in a tumble dryer. The items become warm causing an oxidation reaction in the oil. This oxidation creates heat. If the heat cannot escape, the items can become hot enough to catch fire. Piling, stacking or storing oil-affected items can prevent heat from escaping creating a fire hazard.



Important Safety Instructions



- If it is unavoidable that fabrics that contain vegetable oil, cooking oil or have been contaminated by hair care products be placed in a tumble dryer, wash them first in hot water with extra detergent – this will reduce, but not eliminate the fire hazard. Use the Air Dry cycle of the dryer to reduce the temperature of these items. Do not remove them from the tumble dryer or pile or stack them while they are still hot. Indeed all clothes should go through the cool down/airing phase of the cycle. If for any reason the dryer is stopped before the cycle has finished, remove dry clothes immediately. Do not leave them in the dryer. Spread them out to cool. Do not leave them bunched up, e.g. in a clothes basket.
- Do not use fabric softeners or similar products in a tumble dryer to eliminate the effects of static electricity, unless this practice is specifically recommended by the manufacturer of the fabric softener or product.
- Never dry in the dryer any plastic items such as shower caps, or plastic lined tablecloths or babies' bibs or waterproof nappy covers. If these items must be dried, use only the Air Dry cycle.
- Never use heat to dry in the dryer rubber items (also known as latex foam) such as rubber-backed articles, clothes fitted with foam rubber pads, pillows, or shoes containing rubber. Only dry using the Air Dry cycle. Foam rubber material can when heated produce fire by spontaneous combustion.



WARNING!

To reduce the risk of fire from lint build-up:

- Empty the lint bucket before the lint reaches the top of the transparent section, (usually once a week if the dryer is used every day).
- Keep the area around and underneath your dryer free from the accumulation of combustible materials such as lint, paper, rags, chemicals etc.
- Do not store any items that may burn or melt (such as paper, materials, plastics or plastic containers etc.) next to the dryer.
- At regular intervals have the interior of the dryer and exhaust duct cleaned of any accumulated lint. This must be done by a qualified person for electrical safety.

Note:

Besides being a fire hazard, accumulated lint in the dryer also reduces the efficiency of the dryer by causing longer drying times and increased power consumption. Ensure the Lint bucket is not overflowing.

SAVE THESE INSTRUCTIONS

Installation Instructions

Read the Important Safety Instructions on pages 5 – 7 before you start installing the dryer.

Location Requirements

- The dryer must not be stored or installed in an area that is exposed to water or the weather.
- It must be installed in a well-ventilated location. Do not install it in any room or cupboard which does not permit the free flow of replacement air.
- It must exhaust air outside.
- Before installing the dryer ensure that there is sufficient height to fully open the lid.
- Allow sufficient room behind the dryer for the exhaust.
- The air intake is at the rear of the dryer. Ensure that there is a sufficient air passage on each side of the dryer for intake air.

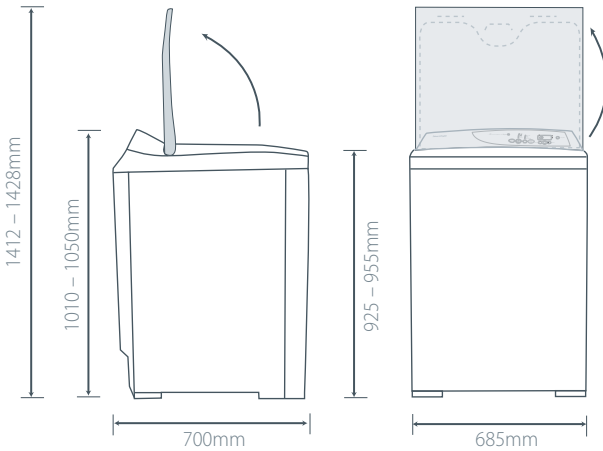

Exhaust Outlet Location

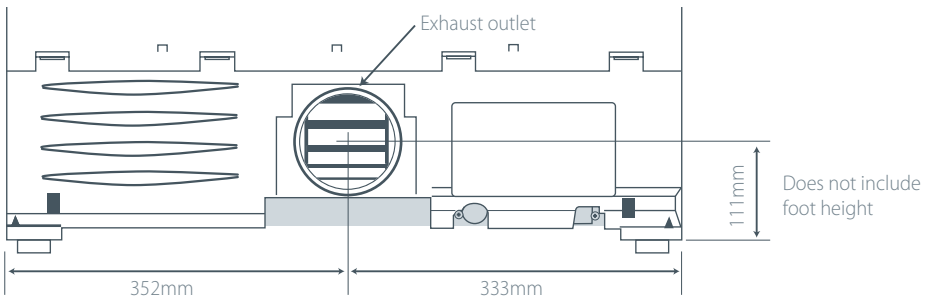

Note:

These are dimensions looking at the back of the dryer. When looking at the wall to cut the duct hole, dimensions will be the mirror image of these.

Alcove or Cupboard Installation Requirements

- No fuel burning appliance can be installed in the same alcove or cupboard.
- The top opening area in the door must be a minimum of 300cm^2 and the bottom opening area must have a minimum of 160cm^2 . (Louvered doors with at least the minimum air openings are acceptable.)
- These openings must never be obstructed.
- Minimum installation clearances are required but more clearance is recommended.

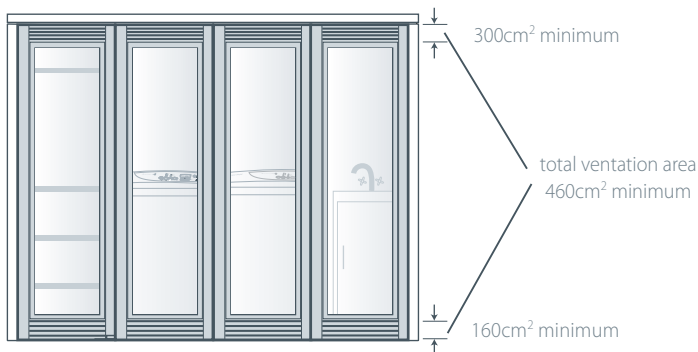
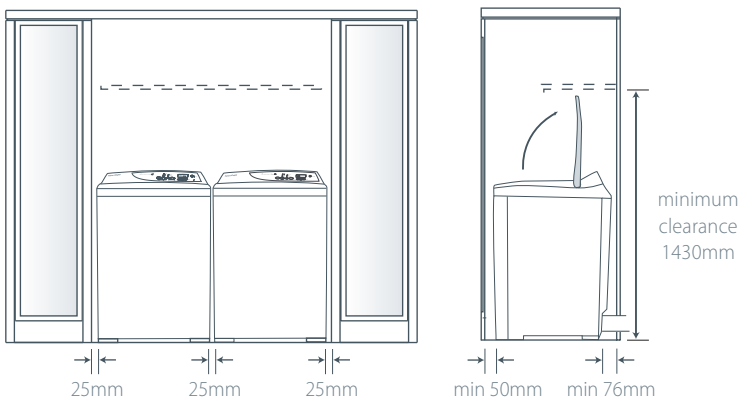

Exhausting

Designing and Installing a New Exhaust Duct System

- The dryer must be exhausted outside. This will reduce drying time, prevent the build up of lint and moisture in the room in which it is located and reduce the risk of fire.
- Do not exhaust the dryer into a chimney or gas vent, a wall, a ceiling or any concealed space in a building. Do not exhaust the dryer under a building or porch, or into a light well or other area that will accumulate lint.
- Keep ducting as short and straight as possible and do not exceed the maximum lengths as stated later in these installation instructions.
- It is strongly recommended to end the exhaust duct with an exhaust hood with a self-closing damper to prevent back drafts and entry of wildlife.
- Do not use an exhaust outlet with an internal screen and never install a screen over it.
- Ensure the hood has at least 300mm clearance between the bottom of the hood and the ground or other obstruction.
- Exhaust ducting products can be purchased from your local appliance store or hardware store.
- 100mm thick wall flexible metal or rigid galvanized metal duct is recommended. Using ducts larger than 100mm diameter may result in more lint accumulating.
- Using straight rigid metal ducting will minimize lint accumulation. Thick wall flexible metal ducting may be used but care must be exercised to avoid sharp bends which may squash the duct and cause blockages.
- Plastic or metal foil flexible duct can kink, sag, be punctured, reduce airflow, extend drying times and affect dryer operation. It should not be used.
- Avoid sag or loops in the duct as they may collect and store water and accumulate lint.
- At joints, point the male section away from the dryer.
- Use duct tape to secure joints. Do not use screws as they collect lint.

Re-using an Existing Duct System

Before using an existing exhaust duct system ensure that:

- The duct is not pierced, kinked or crushed.
- It does not exceed the maximum recommended length (page 12).
- The exhaust hood damper opens and closes freely and with sufficient movement.
- There is not an excessive pressure drop in the duct. (Static pressure in the exhaust ducting should not exceed 250Pa (25mm water gauge), or be less than 0 inches of water column (i.e. negative pressure), when measured with a manometer in the first 150mm of the duct, with the dryer running on Air Dry (no heat) setting).

Exhausting

Determine Vent Duct Length and Route

This dryer can only be vented from the rear.

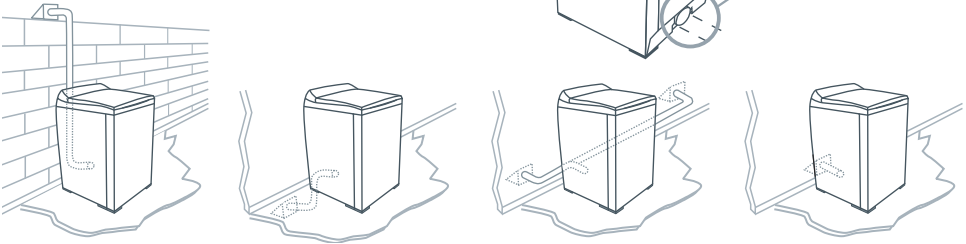

Choose a route that will provide the straightest and most direct path outside. Plan the installation to use the fewest number of elbows and turns.

When using elbows (rigid duct) or making turns (thick wall flexible duct), allow as much room as possible. With flexible duct bend duct gradually to avoid kinking and avoid 90° turns.

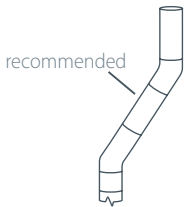

Maximum Length of Exhaust Duct

The maximum length of the exhaust duct system depends upon:

- The type of ducts (rigid or flexible).
 - The number of elbows or bends used.
- 1 Refer to the exhaust duct length chart for the maximum duct lengths you can use. Do not use duct runs longer than specified in the exhaust duct length charts (refer to next page).
Longer duct systems will:
 - Accumulate lint creating a potential fire hazard.
 - Shorten the life of the dryer.
 - Reduce performance, resulting in longer drying times and an increased energy usage.
 - 2 Determine the number of elbows/bends you will need.
 - 3 In the column listing the type of duct you are using (rigid or flexible), find the maximum length of duct on the same line as the number of elbows/bends to be used

Maximum Length of Exhaust Duct

Maximum length of 100mm diameter duct with 100mm hood.

Number of 90° elbows/bends	Rigid	Thick Wall Flexible Metal (fully extended)
0	19.5m	10.9m
1	16.5m	9.4m
2	13.4m	8.2m
3	10.6m	7.6m
4	8.2m	7.0m

For exhaust systems not covered by the exhaust duct length charts (such as multiple unit hook-ups, plenums, and power-assist fans), contact our Customer Care Centre as on page 35.

Alternative Installation for Close Clearances

Venting systems come in many varieties. Select the type best for your installation. A typical close-clearance installation is shown.

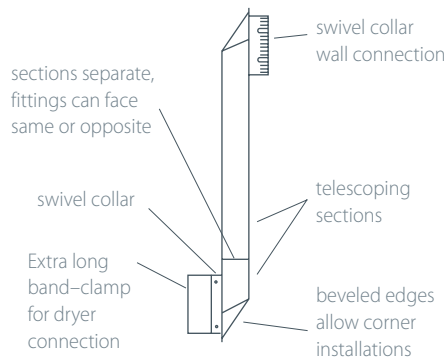
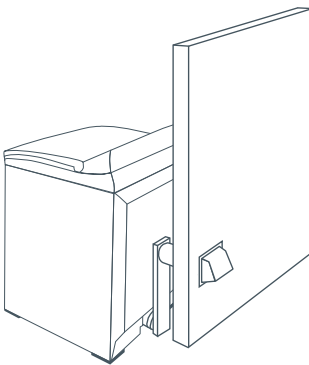

The Maximum length using a 50mm x 150mm duct with two elbows and a 65mm exhaust hood is 2.4 metres.

Refer to the venting system kit manufacturers instructions.

Electrical

Supply Requirements

The dryer requires a 230 – 240 V single phase 50 Hz sinusoidal AC supply.

It must be connected to an individual branch circuit rated for at least 30 amps and protected by its own fuse or circuit breaker.

Either an isolating switch or a plug and socket (or both) rated for at least 30 Amps is required in the circuit in a position close to the dryer and accessible after it is installed.



WARNING!

Electric Shock Hazard

- Use a cable clamp.
- Disconnect power before making electrical connections.
- Securely tighten all electrical connections.
- Do not use an extension cord.
- Do not plug the dryer into a standard 3 pin outlet.
- Failure to do so can result in death, fire, or electrical shock.

Dryer Connection

A suitably qualified person must do the electrical part of the dryer installation

- 1 Ensure the supply cable is isolated from the supply.
- 2 Remove the terminal block cover plate and retain the screw for step 7.
- 3 Fit the cable clamp (supplied in the top packer under the dryer).
- 4 Thread the power supply cable through the cable clamp.
- 5 Connect the neutral wire to the bottom screw terminal, the earth wire to the centre screw terminal and the phase (line or active) wire to the top screw terminal.
- 6 Ensure there is some slack in the cable inside the terminal box and tighten the cable clamp onto the cable.
- 7 Refit the terminal block cover the opposite way round from how it was supplied by inserting the two tabs first on the rear panel of the dryer and secure cover with securing screw.

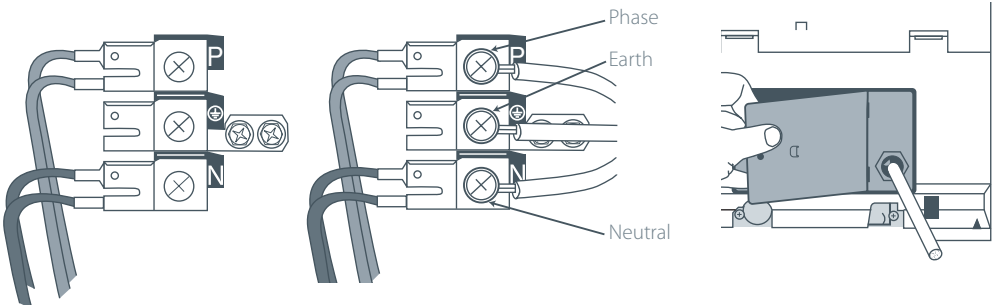

Installation

Unpacking

- Only remove the packaging at the customer's premises.
- This will ensure the appliance arrives in pristine condition and reduces the risk of transport damage.
- Make sure the dryer is in a suitable location for installation.
- Consider installing the dryer before the washing machine in a side by side installation, this will allow better access to electrical and exhaust connections.

Remove Packaging

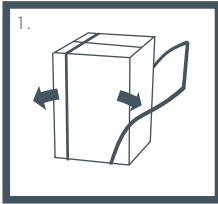

1. Remove straps.

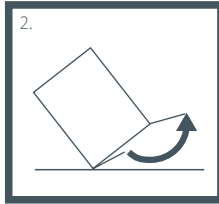

2. Unfold the bottom flaps on the carton.

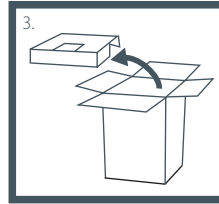

3. Unfold the top flaps on the carton, remove top packer.

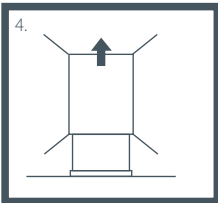

4. Remove the carton by lifting it off the product (do not cut the carton off).

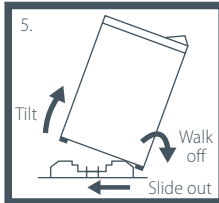

5. Remove the basepacker by tilting the product back and walking the product off it.

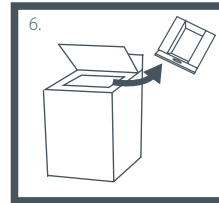

6. Remove the drum packer being careful to rescue the cable clamp from it. Remove the tape from the lint collector bucket.

Level Machine

- Check the dryer is level, and make necessary adjustments to the front levelling feet.
- The rear levelling feet are self adjusting.

Final Installation Check List

Check that:

- All joints in the ducting are made with duct tape – no screws are used.
- Ducting is clean and is connected to the dryer.
- Dryer is level side to side and front to back
- Customer has been shown how to use the dryer.

Note:

This dryer has a drum reversal feature to reduce clothes tangle. Throughout the drying cycle the motor will run for four minutes, then stop and run in the opposite direction for forty seconds before reversing again.

Features

Smart Loading

The new ergonomic design of this dryer means less bending. Simply move clothes from the washer to the dryer with minimal effort.

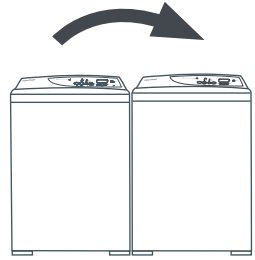

Superior Clothes Care

Superior clothes care is accomplished by an efficient high airflow fan and careful heat control. The *Intuitive*™ dryer provides the right heat for temperature sensitive delicate articles while still efficiently drying more robust regular and denim loads.

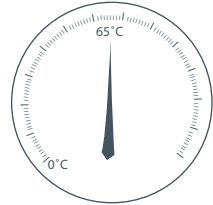

Reverse Action Tumbling

The drum reverses regularly, so your clothes dry more evenly without roping or tangling.

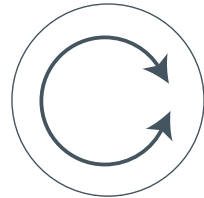

Lint Bucket

The lint filter is automatically scraped clean during the drying cycle and the lint is deposited into the lint bucket. No touching or scraping lint any more. Airflow is more efficient as it is never restricted by a blocked filter.

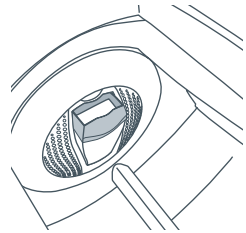

Perfect with the Fisher & Paykel *Intuitive*® Washer

The dryer combined with the *Intuitive*® washer's superior spin performance and quick cycle times will cut laundry turn around time by up to one third, reducing the time you spend doing laundry.

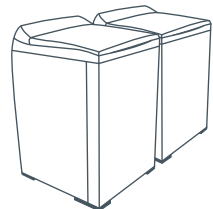

Stainless Steel Drum

Being stainless steel, this drum is not only more hygienic, it's also more resilient and easier to keep looking good.

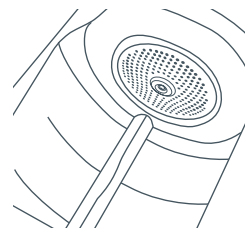

Getting Started Quickly

A. Sorting

- Sort clothes of similar types and loads that take similar times to dry. (Refer to Sorting page 27).



B. Loading

- Load clothes no higher than the transparent section of the lint bucket. (Refer to Loading page 27).

C. Lint Bucket

- Check to see if the lint bucket needs emptying. Empty before the lint reaches the top of the transparent section (refer to Lint Bucket page 28).

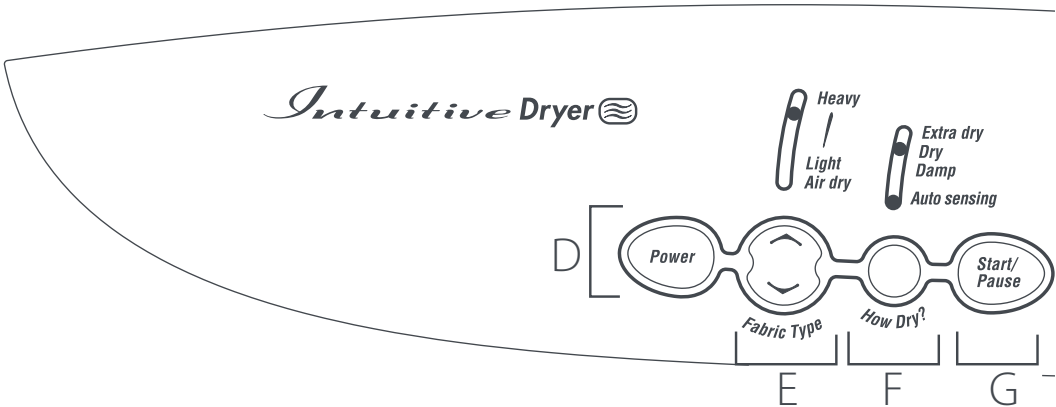

D. Press Power

E. Fabric Type

- Choose the fabric type that most represents the items in your load. Your dryer defaults to a **MIXED** fabric type, to change it press either the **UP** or **DOWN** arrow. A description of each cycle will pop up on the display screen as you scroll through the lights. (For more information on the cycles refer to page 18).
- If you want to use **AIR DRY**, press the **DOWN** arrow until **AIR DRY** light is lit.

Getting Started Quickly

F. How Dry?

- Choose how dry you want to dry your clothes, There are 5 dryness settings you can choose between, **EXTRA DRY**, **EXTRA DRY/DRY**, **DRY**, **DAMP/DRY**, or **DAMP**. (Refer to page 20 for descriptions). Press the **HOW DRY** button until the setting you want is lit.

G. Start

- Press **START/PAUSE** to start your machine.

H. Display screen

- Shows you what options you have selected and/or any *Lifecycles*® you may have chosen. The display screen also shows you the progress of the load as well as displaying messages to help you with the overall running of your machine.

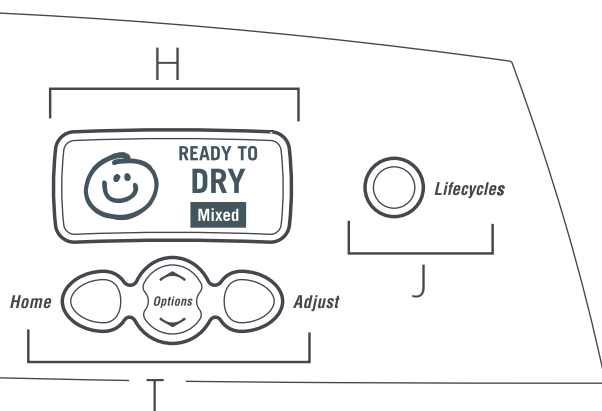

I. Options Menu

- Choose any options you want by scrolling through the **OPTIONS MENU**. Press the **OPTIONS** button. Scroll through the options by using the **UP** and **DOWN** arrows. To select an **OPTION**, press **ADJUST**.
- Once a selection has been made press **HOME** to return to the main screen (Refer to page 23).

J. Lifecycles®

- There are 10 unique *Lifecycles*® that have been specifically designed to make drying simpler and easier.

Family	Specials	Bulky Items
Allergy	Freshen Up	Blankets
Towels	Warm Up	Jeans
Shirts	Pillows	Duvet/Doona
Lingerie		

(Refer to *Lifecycles*® page 25).

Fabric Type

The *Intuitive™* dryer is capable of drying many different fabric types. On the display screen the **FABRIC TYPE** button is located next to the **POWER** button. Use the **UP** and **DOWN** arrows to alter the fabric type you wish to dry with.

When you turn your *Intuitive™* dryer on it will automatically select the **MIXED** fabric type. This setting is suitable for drying your everyday garments, e.g. t-shirts, trackpants, sweatshirts etc.

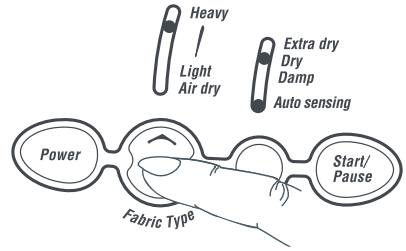

To change the **FABRIC TYPE**, press either the **UP** or **DOWN** Arrow.

Select a fabric type that matches the type of load you are drying. Different fabrics have different drying requirements, so it is important to choose the cycle that best describes the load. For example if your load contains mainly delicate items it is best you select the **LIGHT** Fabric Type.

Always follow manufacturer's care label instructions when drying.

If you are unsure of the temperature to select for a load, it's best to select a lower heat rather than a higher heat, e.g. the **LIGHT** or **CASUAL** setting instead of the **MIXED** setting.

There are five **FABRIC TYPES** programmed into your *Intuitive™* dryer as well as an **AIR DRY** option.

HEAVY

The **HEAVY** setting has been designed to provide a long, high heat cycle for heavy fabrics and denims that tend to have thick and bulky seams. This setting dries for longer intervals to ensure heavy items are fully dry.

MIXED

The **MIXED** setting has a High heat for drying everyday clothing and linen. This cycle is suitable for most garments labelled "Tumble Dry".

CASUAL

The **CASUAL** setting uses a medium heat for lightweight fabrics. It is ideal for lightweight cottons and items labelled "tumble with a medium heat"

DRY AND WEAR

The **DRY AND WEAR** setting uses a medium heat combined with the selection of the **CREASABLES** option. Ideal for any types of garments where you want to wear them straight away. The Creasables option is automatically selected so there is no need to iron clothes when you remove them from your dryer. Once drying is completed, clothes are automatically turned every 5 minutes, without heat, to reduce the likelihood of creases and wrinkles developing. This will continue for up to 24 hours or until you stop the dryer.

Fabric Type

LIGHT

The **LIGHT** setting is ideal for delicate or heat sensitive items. Use this setting when care-labels recommend low heat settings or for garments with a synthetic fibre content, where overheating could cause damage to fibres.

AIR DRY

The **AIR DRY** option is for items requiring drying without heat. Perfect for airing clothes or to freshen up garments that have been packed in a suitcase or drawer.

Press the **FABRIC TYPE** button **DOWN** until the **AIR DRY** light is glowing. A second screen will automatically pop up, to show **AIR DRY** time options. Use the **ADJUST** button to choose the length of time you wish to dry your load for.

How Dry?

AUTO SENSING

Autosensing is automatically selected when your *Intuitive™* dryer is turned on. When selected, your dryer automatically senses the dryness level of the load and turns off when the clothes are dry. Intuitive's internal computer measures the moisture content of the load using metal sensor bars and together with a temperature sensor determine when the clothes have reached the selected dryness level.

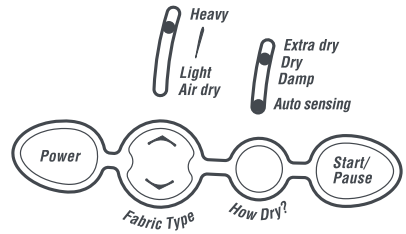

For optimum clothes care match the cycle to the load. **AUTO SENSING** often provides the best results and leads to lower energy costs than **TIME DRY**.

There are five different dryness levels to choose from:

- **EXTRA DRY**
- **DRY/EXTRA DRY**
- **DRY**
- **DAMP/DRY**
- **DAMP**

The dryer defaults to the **DRY** Setting. To change this press the **HOW DRY** button until the dryness setting you want is highlighted. If you choose the **DAMP/DRY** or **DRY/EXTRA DRY** setting two lights will be displayed.

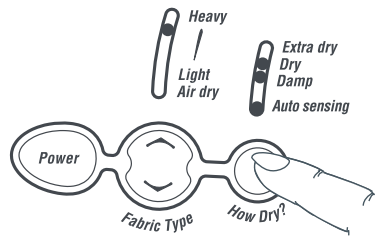

At the end of the cycle if the clothes are still damp or are too dry next time adjust the dryness level on the touch pad to meet your personal preferences.

Dryness Level Descriptions

EXTRA DRY

This is mainly for items that you want to store (i.e. place in a drawer, cupboard or wardrobe). By using this setting you eliminate the possibility of 'musty smells' that commonly occur when items are stored in a damp state.

DRY

Dries clothes to a level where they are considered 'dry', so garments can be worn immediately.

DAMP

Dries the clothes to a level where they are considered 'moist'. It is designed for delicate, light-weight fabrics and articles of clothing which you want to iron-dry.

Display Screen

The display screen on the right hand side of the panel shows you what the machine is doing during the cycle. The display screen also shows you the different drying options available. When you first turn your *Intuitive™* dryer on it will briefly display the message "Welcome to Intuitive". The main screen then appears with a big smiley face and tells you the machine is **READY TO DRY**, the setting it has defaulted to and also displays any options/lifecycles you select.



All About the Options Button...

Your *Intuitive™* dryer has a menu of drying options you can use. The buttons and the display screen on the right hand side of the panel are used to select and display the different options.

To Select a Drying Option:

- 1 Push either the Options **UP** or Options **DOWN** arrow. The Options menu will then be displayed.
- 2 Scroll through the options by using either the **UP** or **DOWN** arrows. To select an option use the **ADJUST** button. The option will be highlighted to show you have selected it.
- 3 Press **HOME**, the display will return to the home screen, where your selected drying option(s) will be displayed.
- 4 To start your dryer press **START/PAUSE**.

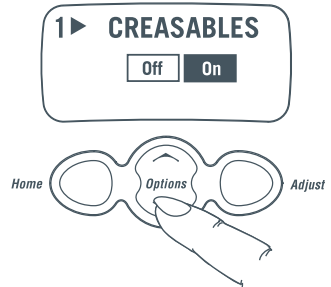

Note:

If you want to change any of the drying options while your machine is running you will need to press **START/PAUSE** before changing an option or setting.

Progress Screen

During the cycle the display screen shows you the progress of your load by displaying a series of messages that indicate what stage the dryer is up to. The display screen also scrolls through any options you may have chosen.

When you first start your dryer the words **SENSING Dampness** will appear on the screen. During this period the dryer is sensing the dampness of your load.

Once the dryer has sensed your loads dampness the words **DRYING** will appear on the screen. (If you have chosen **AIR DRY** the word **AIRING** will appear). This message is displayed for the majority of the cycle letting you know it is in the process of drying your load. The dryer will continue to display the word **DRYING** until it senses that your load is becoming damp.

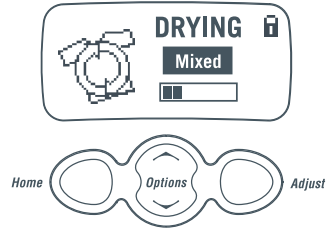

The word **DAMP** will appear when the dryer senses that the load is becoming dry. This is the stage that you can remove delicate garments you wish to hang dry.

The word **DAMP/DRY** appears when the dryer senses that the clothes are almost dry. It will continue drying until it reaches the **HOW DRY** level you have selected. Once it reaches the dryness setting you have chosen your dryer will progress into **COOLING**.

You can select an option in the Options menu to remind you to remove your delicates early (refer to page 24).

The word **COOLING** will appear when dryer is in the process of cooling down the dry load. This is where the load is tumbled with no heat, decreasing the need for ironing. **COOLING** will continue until the dryer senses the clothes have been cooled down sufficiently. The exception is **TIME DRY** which has a fixed **COOLING** period.

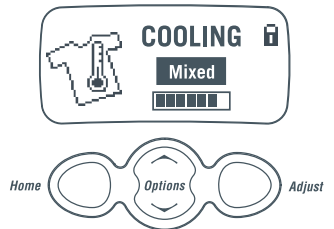

The Options

For all the options mentioned below select the **OPTIONS** menu (by pressing the **UP** Options arrow). Use the Options arrows to scroll through the options until the one you want is displayed.

Press **ADJUST** to select it and **HOME** to return to the main screen.



1. CREASABLES

The **CREASABLES** option minimises the likelihood of creases or wrinkles forming in clothes, if you are not able to unload the dryer straight away. This option rotates the drum periodically after the cycle has finished. This tumbling action, combined with blowing cool air through the clothes, helps garments to remain crease free.

CREASABLES uses very little power and will continue for up to 24 hours or until the user turns the dryer off. After completing each tumble *Intuitive™* dryer will give an end of cycle beep to remind you that the load is dry and can be removed.

To stop the dryer press either **POWER** or **START/PAUSE**. *Intuitive™* dryer will open the drum door and unlock the lid, so you can remove your clothes.

CREASABLES can be selected on any cycle.

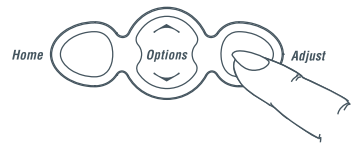

2. TIME DRY

There are three timed cycles. You can choose between 20, 40 and 80 minutes. A **COOLING** period of 10 minutes is included in the 80-minute and 40-minute cycle. The 20 minute cycle has a 5-minute **COOL DOWN** period.

To select a timed cycle, press the **ADJUST** button to move to the time you wish to dry for. Your *Intuitive™* dryer will default to 40 minutes.

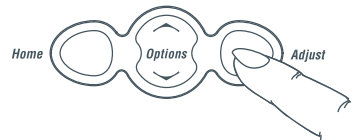

If you choose to select **TIME DRY**, please note the dryer will not sense when your clothes are dry. This may increase the chance of over-drying.

We recommend that you dry your clothes for a slightly shorter time than you think they need, or check on them regularly (to avoid over-drying).

The Options

3. END OF CYCLE BEEPS

You can change the number of beeps your *Intuitive™* dryer sounds at the end of the cycle. Scroll to Options screen 3, use the **ADJUST** button to move to your desired preference. Press **HOME** to save your selection.

4. REMINDER – REMOVE DELICATES EARLY

If you wish, your *Intuitive™* dryer can remind you to remove your delicate items while they are still slightly damp. This can be useful if you have a mixture of light and heavy fabrics in your load. Your dryer will beep and display a message when it senses that the load is nearly dry. You will then be able to remove delicate items and the rest of the load will continue the cycle.

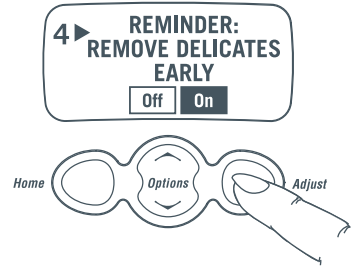

To activate the reminder, scroll to Options screen 4, press the **ADJUST** button to select **ON**, then press **HOME** to save your setting.

5. REMINDER – EMPTY LINT BUCKET

This reminder is automatically selected when you receive your dryer. If you do not wish to be reminded every 5 cycles to remove the lint from the lint bucket you can turn the reminder off. Scroll to Options screen 5, press the **ADJUST** button to select **OFF**, then press **HOME** to save your setting (also refer to page 28).

6. REMINDER – ADD SOFTENER SHEETS

If you add fabric softener sheets to your dryer, you can select this option to remind you to add them at the beginning of each cycle. To activate the reminder, scroll to Options screen 6, press the **ADJUST** button to select **ON**, then press **HOME** to save your setting.

7. CYCLE TIPS

Cycle tips screens are displayed to help you to remember what each cycle does.

For example, when you select Fabric Type = Mixed, after 1 second a cycle tips screen will appear with the words "Mixed – High heat for everyday cottons".

Once you have become familiar with your dryer you may wish to switch these tips off. Scroll to Options screen 7, press the **ADJUST** button to select **OFF**, then press **HOME** to save your setting.

8. TROUBLE SHOOTING

Your *Intuitive™* dryer provides basic Trouble Shooting tips on screen. Scroll to options screen 8, press the **ADJUST** button to select the topic that you require assistance with. The topic will then be displayed on the screen. Use the options down arrow to scroll through possible solutions. For more detailed Trouble Shooting information refer to pages 32 – 33 of this guide, or If Your *Intuitive™* Dryer Beeps For Help, page 31.

Lifecycles®

Your *Intuitive™* dryer has a range of special, pre-programmed *Lifecycles®* to make doing the laundry even easier.

- Push the **LIFECYCLES** button.
- Use the **OPTIONS** button to scroll through the 3 *Lifecycles®* menus, or you can press the **LIFECYCLES** button repeatedly.
- Use the **ADJUST** button to select a lifecycle.
- Press **HOME** to return to the main screen.

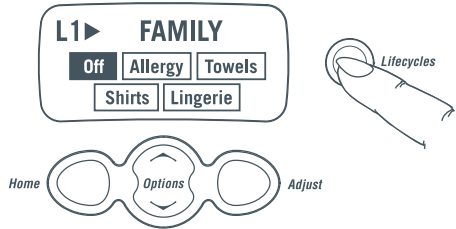

L1 ► Family

ALLERGY

This cycle has been designed to complement the Allergy cycle currently available in the *Intuitive™* washer. It is recommended for both, allergy sufferers and for piece of mind in times of family illness. This cycle uses a high heat to ensure that dust mites and bacteria populations are decimated. It has been designed primarily for sheets and everyday clothing, and is not recommended for garments that are heat sensitive.

TOWELS

Heavy Fabric Type, Dry/Extra Dry dryness level, with Autosensing. Specifically designed for towels.

SHIRTS

This cycle has been developed for business and dress shirts. It uses a medium heat, Autosensing selected, Dry dryness level, with the Creasables option selected to reduce creasing.

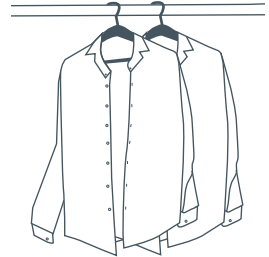

LINGERIE

This is an extra gentle cycle for delicate fabrics. It has been designed for garments that you previously may have been reluctant to put into the dryer e.g. lingerie and synthetics. This cycle dries using the Light Fabric Type setting, Autosensing, the Dry dryness level, and has the Creasables option selected to reduce creasing. We recommend placing undergarments in a net bag for extra protection.

L2 ► Special Items

FRESHEN UP

This cycle tumbles for 20 minutes without heat. It has been designed to freshen clean clothes that have been stored in a cupboard, drawer or packed in a suitcase.

WARM UP

Warm Up is designed to heat clothes for 20 minutes so that they are warm to the touch. Warm your pyjamas before bed on a cold night, or warm towels while you are in the shower. The Warm Up cycle uses a Casual Fabric Type and is not recommended for garments that are heat sensitive.

PILLOWS

An 80 minute no heat cycle ideal for pillows and soft toys. Foam items can be dried using this setting.

L3 ► Bulky Items

BLANKETS

You will need to check the care label to make sure that the item can be dried in the dryer.

It is a good idea to include 4 – 5 medium sized towels along with the blanket for cushioning. This will reduce shrinkage from over tumbling. If you are drying more than one blanket, ensure that they do not sit higher than the top of the lint bucket, otherwise there will not be enough room for them to tumble.

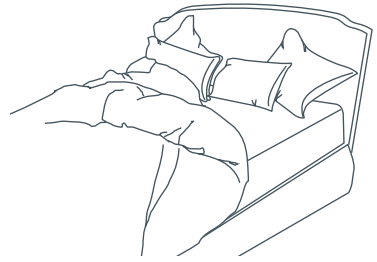

This cycle uses the lowest heat setting, the Light Fabric Type setting and runs with the Damp/Dry How Dry setting.

On completion, remove the blanket, shake and if needed stretch the blanket back to its original shape. Place back in the dryer and repeat until the blanket is dry.

Note:

It is important to completely dry the blanket to prevent mildew from forming.

JEANS

This cycle has been designed for drying denims or similar heavyweight items like jeans and thick towels, which are bulky or have thick seams. The Jeans lifecycle has been tailored to dry these items. This cycle uses High Heat, the Heavy Fabric Type, and has the **CREASABLES** option selected.

DUVET/DOONA

Duvets/Doonas are very bulky items and can be difficult to dry.

It is important before you put your duvet/doona in the dryer that you check to make sure the care label says that it can be dried in a clothes dryer.

This cycle uses Autosensing, and dries on the lowest heat setting. The Fabric Type setting used is Light, How Dry level is Dry/Extra Dry. It is a good idea to check the garment throughout the cycle to ensure even drying. If the item contains feathers, add a heavy item (e.g. a towel tied in a knot) to the load to help fluff the duvet/doona.

Ensure the load does not sit higher than the top of the lint bucket before starting the cycle.

Using Your Dryer

Check the care labels inside the garments to determine whether the garment manufacturer recommends tumble-drying.

Sorting

It is best that you sort your garments before placing them into the dryer. Sort into loads of similar types, and loads that take similar times to dry.

Heavier items (e.g. towels, t-shirts and flannel sheets) are best dried separately from lightweight items (e.g. synthetics, poly-cotton sheets and shirts). This prevents the possibility of some items becoming over-dried whilst others are still damp. It will also help to extend the life of your clothing and linen.

Drying your clothes as soon as the washer has finished will decrease the chance of creases and the chance of dye transfer from coloured items to white items.

We recommend that articles of clothing with screen-printing are turned inside out to ensure the screen-printing does not stick to the drum. Garments with hooks or zippers need to be fastened and where possible turned inside out. Place undergarments in a net bag to provide protection from other items in the load.



Loading

Garments need to be loaded properly to reduce the likelihood of them creasing and to ensure the load is dried evenly. Make sure there is ample room for the garments to tumble freely while drying. Load in terms of the space the garments take up when dry, rather than when they are wet.

The general rule is one wash load = one dryer load. Only load the dryer up to the top of the transparent section of the lint bucket. Loading any higher may result in uneven drying, tangling, creasing and the dryer becoming overloaded.

It is a good idea to dry 'permanent press' type garments together in a separate cycle with the **CREASABLES** option turned on. This will help reduce creases and the need for ironing.

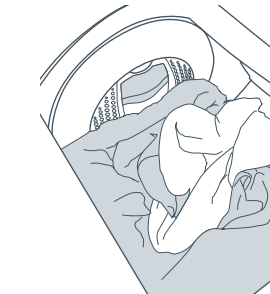

Using Your Dryer

Lint Bucket

The *Intuitive™* dryer's lint removal system is unique. Unlike other dryers, the *Intuitive™* dryer automatically removes the lint for you, from the lint screen – all you have to do is tip the lint out!

The lint filter is hidden behind the lint bucket. As the air passes through this filter the lint is caught on the fine mesh. Once the lint is about 2mm thick it comes into contact with a scraper which deposits it into the bucket. This process is automatically performed every time lint builds up on the filter.

Apart from the benefit of not having to scrape the lint after every cycle, it also means the drying efficiency is not affected by lint build-up during the drying cycle.

The lint bucket is located inside the dryer on the left-hand side. You can remove it by gently pulling the handle and lifting outwards. It slots easily back into place.

This lint bucket does not need to be cleaned as regularly as other dryer's lint filters. The lint bucket only needs to be emptied before the lint reaches the top of the transparent section.

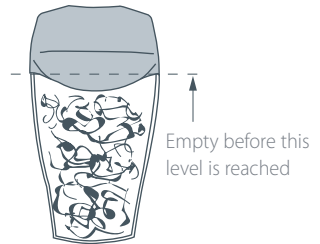
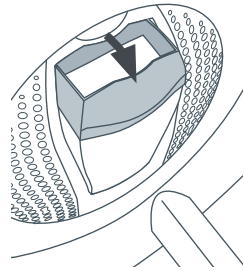

It is important that you run your dryer with the lint bucket in place at all times.

Lid Lock

Your *Intuitive™* dryer locks its lid at the start of the drying cycle, providing added safety for you and your family while it is operating. This lock ensures the lid cannot be opened while the drum is rotating.

A lidlock symbol (padlock) appears in the corner of the screen when locked (it disappears when unlocked). If the lidlock symbol is flashing the lid is in the process of being unlocked. During this stage, the lid still cannot be lifted.

The lid must be closed before the drying cycle can start. If **START/PAUSE** is pressed with the lid open, the machine will beep and a message will appear in the display screen saying "Please close the lid Press start to continue", to signal that the lid needs to be closed. Once the lid has been closed and **START/PAUSE** is pressed, the **LID LOCK** will be activated and the drying cycle will begin.

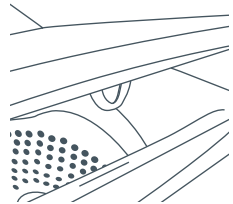
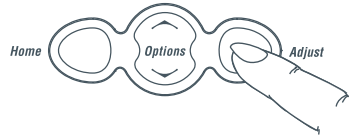
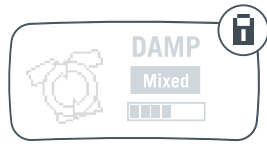

Power Failure

If the power is cut while your *Intuitive™* dryer is operating, the lid will be unlocked. In some circumstances the drum door may not be automatically opened. If this occurs it is best if the dryer is not interfered with. When the power is restored the dryer will automatically resume operating. However if it does not automatically open, first close the lid and start the dryer in the usual manner, after 5 seconds press **START/PAUSE**. This will cause Intuitive to open correctly with the lid unlocked.

If it is absolutely necessary to remove some items before power is restored follow the steps below:

- 1 Ensure the dryer is disconnected from the power supply.
- 2 Open the lid (this will already be unlocked).
- 3 On the left hand side of the dryer there is a thumb tab that appears when the drum is closed. Press the thumb tab, while rotating the drum by hand away from you (push the drum towards the back of the dryer).
- 4 Hold the thumb tab down until the drum starts opening.
- 5 Keep rotating the drum until it is fully open and it comes to a stop.
- 6 Now you can remove items from the dryer drum.
- 7 Close the lid once you have removed desired items.
- 8 Re-connect the power supply to your dryer.

The drum door will automatically close and the dryer will resume normal operation when power is restored.

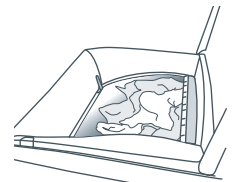
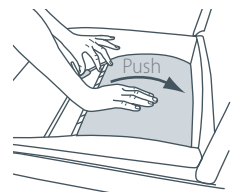
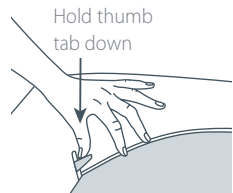

Cleaning

Clean your dryer with a soft damp cloth and wipe dry. Do not use scouring cleaners as they can damage the paint and plastic surfaces.

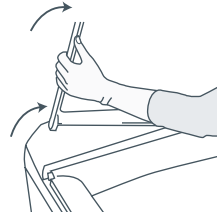

Removing the Lid

You can remove the lid for cleaning. Open the lid fully, hold one side with one hand and tap the other side with an upwards motion. To replace the lid, hold the lid vertically and align both hinges before clicking back into place.

Pre-Treatment Sprays

Do not use pre-treatment sprays or liquids on or near your dryer as they can damage your machine's control panel as well as any of its plastic parts. Damage to your dryer caused by pre-treatment products will not be covered by your warranty.

Stains

If stains appear inside the drum of your machine, mix a detergent and water paste (or use a non-flammable liquid cleaner) and wipe over the stain with a soft cloth. Then tumble old towels for 20 – 30 minutes on the **AIR DRY** setting to remove all traces of the cleaner.

Lint Bucket

The lint bucket will need to be emptied before the lint reaches the top of the transparent section. A lint bucket that is not full ensures your clothes will remain lint-free and your dryer will operate at maximum efficiency.

Venting

Inspect and clean all ducting at least once a year to remove accumulated lint. Check frequently that any damper on the exhaust hood moves sufficiently and opens and shuts freely.

If Your Intuitive™ Dryer Beeps For Help

Your *Intuitive™* dryer is capable of diagnosing its own troubles. If your dryer is displaying a message on the display screen and is sounding a musical series of beeps every 5 seconds, it has a problem that you may be able to solve using the checklist below. (It's the same sound *Intuitive™* dryer makes when you plug it in).

If you are unable to solve the problem from the checklist below call for service.

Machine is beeping and... "I can't get ANY AIR" (your dryer is still running)

This message indicates there is an airflow restriction and your clothes will take longer to dry. Possible reasons for the airflow restriction could include:

Your lint bucket is too full. Remove the lint from the lint bucket, then run the dryer on any cycle for a few minutes with no load to remove any lint still trapped in the dryer. Empty the lint bucket again.

Check the exhaust system. The ducting could be restricted, squashed or blocked. Is the piping bent, kinked or clogged? Does it need to be cleaned?

Machine is beeping and ... "I can't LOCK THE LID"

Close the lid and press **START/PAUSE**.

If the lid is already closed, open the lid and close it again, then press **START/PAUSE**.

Disconnect from the power (either by unplugging the dryer or turning off the circuit breaker that supplies it). Wait 10 seconds, reconnect and try turning it on again.

Machine is beeping and... "I can't CLOSE THE DRUM"

The machine is unable to close the drum due to clothes interfering with the closing mechanism. Remove any articles that are interfering with the drum door and dry these in the next load.

Is your load higher than the top of the lint bucket? Remove some articles and dry these in the next load.

If your dryer is continually beeping and a message is displayed on the screen, a fault has occurred which requires repair from a Service Agent.

Pressing the **POWER** button once will stop the beeping but will still display the fault code. We recommend leaving the machine in this mode as the fault code will enable the service person to quickly identify the cause of the problem.

Trouble Shooting

Pressing POWER does not turn the dryer on

Is the electrical cord plugged in? If not plug the cord in.

If there is a switch, is it switched on?

Could your household power supply be at fault? (If your plug is suitable, try plugging another electrical appliance into the same outlet).

Check your house circuit breakers and fuses. If they are at fault contact an electrician.

Dryer does not heat

Is the dryer set to the **AIR DRY** Fabric Care Setting?

Has the dryer progressed to **COOLING**. (Check the Display Screen).

If the problem persists call for service.

Clothes are still wet/damp

Is the dryer set on **DAMP**?

Try selecting a higher **HOW DRY?** dryness level.

Is the drum warm? If not, is the dryer set to the **AIR DRY** setting?

Try drying similar weight clothes together.

If the problem persists call for service.

Pressing START/PAUSE does not start the dryer

Is the lid open? Shut the lid and press **START/PAUSE**.

Is there a fault displayed on the display screen? Refer to page 31, – If Your Dryer Beeps For Help.

Dryer is taking a long time to dry

Is the lint bucket full? If so empty it to improve performance.

Is the airflow system free from obstruction?

Has the dryer been vented correctly? Is the venting distance too great?

Is the machine over-loaded?

Have heavyweight items been separated from lightweight items?

Are the clothes very wet when they are removed from the washing machine? Increase your washer's spin speed.

Are you using the **AIR DRY** setting?

Is your dryer on **LIGHT** Fabric Type?

Dryer keeps stopping and starting

Your dryer has a reverse action tumble. When it changes direction it will pause momentarily and will start again in the opposite direction, this is normal.

Has **CREASABLES** been selected?

Trouble Shooting

Linting Problems

Is the lint bucket full? When lint reaches the top of the transparent section of the bucket it needs emptying.

Have you separated lint-shedding garments (e.g. towels) from lint receiving garments (e.g. synthetics).

Have you checked your pockets for tissues or other items that could have been left in them?

Have you over-loaded your dryer? Over-loading can result in linting problems due to reduced airflow and lint not being able to collect on the filter.

Have you over-dried your load? Over-drying can cause lint-attracting static electricity. Try a lower **HOW DRY** Dryness Setting or use **AUTO-SENSING** instead of **TIME DRY**.

Is the lint bucket in place?

Static problems

Have your clothes been over-dried? Choose a lower dryness setting.

Items shrinking

Has the load been over-dried? Choose a lower dryness setting.

Is tumble-drying recommended? Check care labels inside garments.

If you selected **TIME DRY** - did you set it to dry for too long?

Has the correct temperature been used to dry the garment? Check the care label.

Clothes are creased

Does the load sit higher than the lint bucket? Your dryer is over-loaded, decrease the load size.

Did you remove your clothes as soon as the dryer was finished? Use the **CREASABLES** option, if you cannot return to the dryer in time.

Have your clothes been over-dried? Select a lower dryness level. Check your garments care-labels.

Drum door will not open

Refer to page 29 – Power Failure for more information, or contact your Fisher & Paykel Authorised Service Agent.

Lid will not open

Is the **CREASABLES** option selected? Press **START/PAUSE** to open the lid.

Manufacturer's Warranty

When you purchase any new Fisher & Paykel whiteware Product you automatically receive a two year Manufacturer's Warranty covering parts and labour for servicing.

Fisher & Paykel Undertakes to

Repair or, at its option, replace without cost to the owner either for material or labour any part of the Product, the serial number of which appears on the Product, which is found to be defective within TWO YEARS of the date of purchase.

This warranty DOES NOT cover

- A** Service calls which are not related to any defect in the Product. The cost of a service call will be charged if the problem is not found to be a Product fault. For example:
 1. Poor drying performance due to incorrect installation, e.g. no venting system fitted, dryer vent against a wall, blocked lint filter.
 2. Poor drying performance due to incorrect loading, e.g. overloading or underloading.
 3. Damage from articles in the drum, e.g. bra wires, pens, crayons or dye transfer.
 4. Damage caused by incorrect electrical installation.
- B** Defects caused by factors other than:
 1. Normal domestic use or
 2. Use in accordance with the Product's User Guide.
- C** Defects to the Product caused by accident, neglect, misuse or Act of God.
- D** Correction of unauthorised repairs.
- E** Normal recommended maintenance as set out in the Product's User Guide.

Service under this manufacturer's warranty must be provided by an Authorised Service Agent (refer to the Customer care section for contact details). Such service shall be provided during normal business hours. This warranty certificate should be shown when making any claim.

Note:

This Warranty is an extra benefit and does not affect your legal rights and applies only to product purchased in New Zealand and Australia.

Please keep this User Guide in a safe place.

Do not return to Fisher & Paykel.

Customer Care



Check the things you can do yourself. Refer to your User Guide and check:

- 1 your appliance is correctly installed
- 2 you are familiar with its normal operation
- 3 you have read the Trouble shooting section.

If after checking these points you still need assistance please refer to the following:

In New Zealand If You Need Assistance...*

Call your Fisher & Paykel retailer who is trained to provide information on your appliance, or if we can be of any further help, please contact our Customer Care Centre,

Toll Free: 0800 FP CARE or 0800 37 2273 **Fax:** (09) 273 0656
Email: customer.care@fp.co.nz **Postal address:** P.O. Box 58732, Greenmount, Auckland

If you need service...*

Fisher & Paykel has a network of independent Fisher & Paykel Authorised Service Centres whose fully trained technicians can carry out any service necessary on your appliance. Your dealer or our Customer Care Centre can recommend an Authorised Service Centre in your area.

In Australia If You Need Assistance...*

Call the Fisher & Paykel Customer Care Centre and talk to one of our Customer Care Consultants.

Toll Free: 1300 650 590 **Fax:** (07) 3826 9298
Email: customer.care@fp.com.au **Postal Address:** PO Box 798, Cleveland QLD 4163

If you need service...*

Fisher & Paykel Australia Pty Ltd has a network of independent Fisher & Paykel Authorised Service Centres whose fully trained technicians can carry out any service necessary on your appliance. Our Customer Care Centre can recommend an Authorised Service Centre in your area.

*If you call or write, please provide: name, address, model number, serial number, date of purchase and a description of the problem. This information is needed in order to better respond to your request for assistance.

Product details can be found on the back of the console or top right hand corner of the dryer cabinet.

Product Details

Fisher & Paykel Ltd

Model/Serial No.

Date of Purchase _____ **Purchaser** _____

Dealer _____ **Suburb** _____

Town _____ **Country** _____

Copyright © Fisher & Paykel 2005. All rights reserved.

The product specifications in this booklet apply to the specific products and models described at the date of issue. Under our policy of continuous product improvement, these specifications may change at any time. You should therefore check with your Customer Care Centre to ensure this booklet correctly describes the product currently available.

www.fisherpaykel.com

NZ AU
Dryer Installation Instructions
and User Guide
Published: 02/2005
Part No. 395629 A

Download from Www.Somanuals.com. All Manuals Search And Download.

Free Manuals Download Website

<http://myh66.com>

<http://usermanuals.us>

<http://www.somanuals.com>

<http://www.4manuals.cc>

<http://www.manual-lib.com>

<http://www.404manual.com>

<http://www.luxmanual.com>

<http://aubethermostatmanual.com>

Golf course search by state

<http://golfingnear.com>

Email search by domain

<http://emailbydomain.com>

Auto manuals search

<http://auto.somanuals.com>

TV manuals search

<http://tv.somanuals.com>