

Fisher-Price®

M6711

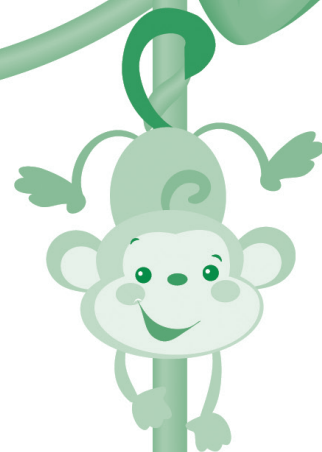

! WARNING

IMPORTANT!
KEEP INSTRUCTIONS FOR FUTURE REFERENCE.



www.fisher-price.co.uk

Download from www.Somanuals.com. All Manuals Search And Download.



WARNING

To prevent serious injury from falls and being strangled in the restraint system:

- Always use the restraint system.
- Not recommended for children who can sit up by themselves (6 months approximately, until 9 Kg/20 lbs).
- Never leave child unattended.
- It is dangerous to use this product on an elevated surface.
- Never use toy bar as a handle.



CAUTION

This package contains small parts in its unassembled state. Adult assembly is required.

- Please read these instructions before assembly and use of this product.
- Adult assembly is required.
- Tool required for assembly: Phillips screwdriver (not included).
- Requires four "C" (LR14) **alkaline** batteries for operation (not included).
- Weight Limit: 9 kg (20 lbs).

IMPORTANT! The maximum weight limit for this product is 9 kg (20 lbs). If your child weighs less than 9 kg (20 lbs), but is really active and appears to be able to climb out of the swing, immediately discontinue its use.

- Product features and decoration may vary from photo.

GREAT BRITAIN: Mattel UK Ltd, Vanwall Business Park, Maidenhead SL6 4UB. Helpline: 01628 500303; www.service.mattel.com/uk

AUSTRALIA: Mattel Australia Pty. Ltd., 658 Church Street, Locked Bag #870, Richmond, Victoria 3121 Australia. Consumer Advisory Service 1300 135 312.

NEW ZEALAND: 16-18 William Pickering Drive, Albany 1331, Auckland.

ASIA: Mattel East Asia Ltd, Room 1106, South Tower, World FinanceCentre, Harbour City, Tsimshatsui, HK, China.

MALAYSIA: Diimport & Diedarkan Oleh: Mattel SEA Ptd Ltd. (993532-P) Lot 13.5, 13th Floor, Menara Lien Hoe, Persiaran Tropicana Golf Country Resort, 47410 PJ. Tel: 03-78803817, Fax: 03-78803867.

Care

The pad and toys are machine washable. Wash them separately in cold water on the gentle cycle. Do not use bleach. Tumble dry separately on low heat and remove promptly. The frame and toy bar can be wiped clean using a mild cleaning solution and a damp cloth. Do not immerse this product.

To remove the pad:

- Lift the seat bottom tube and remove the pad lower pocket.
- Push the restraint belts back through the pad.
- Turn the product face down. Unfasten the buckle, and turn the product upright again.
- Slide the pad upper pocket off the seat back tube.

To re-assemble the pad:

- Refer to assembly steps 8 and 9.

Parts

IMPORTANT! Please remove all parts from the package and identify them before assembly. Some parts may be packed in the pad.

2 Swing Frames

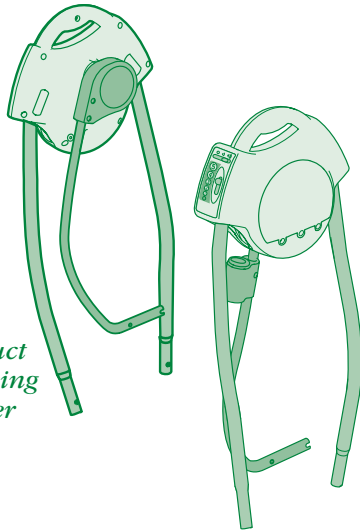

Hint: To allow the product to swing properly, the swing arm-to-frame (with power switch) connection is designed to be loose.

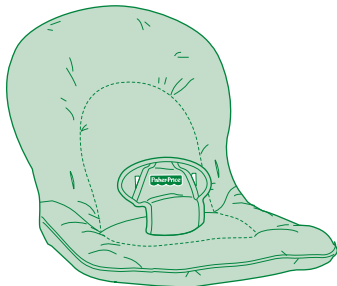

Seat Pad

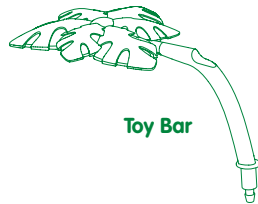

Toy Bar

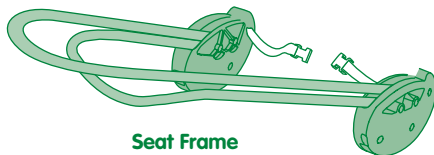

Seat Frame

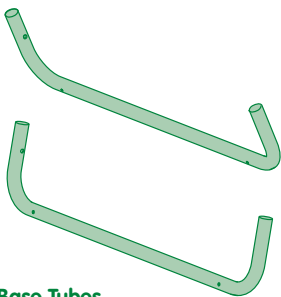

2 Base Tubes



2 Toys



#6 x 2,5 cm Screw – 2
Shown Actual Size

Note: Tighten or loosen all screws with a Phillips screwdriver. Do not over-tighten the screws.

Assembly

IMPORTANT! Before assembly and each use, inspect this product for damaged hardware, loose joints, missing parts or sharp edges. DO NOT use if any parts are missing or broken. Contact Mattel for replacement parts and instructions if needed. Never substitute parts.

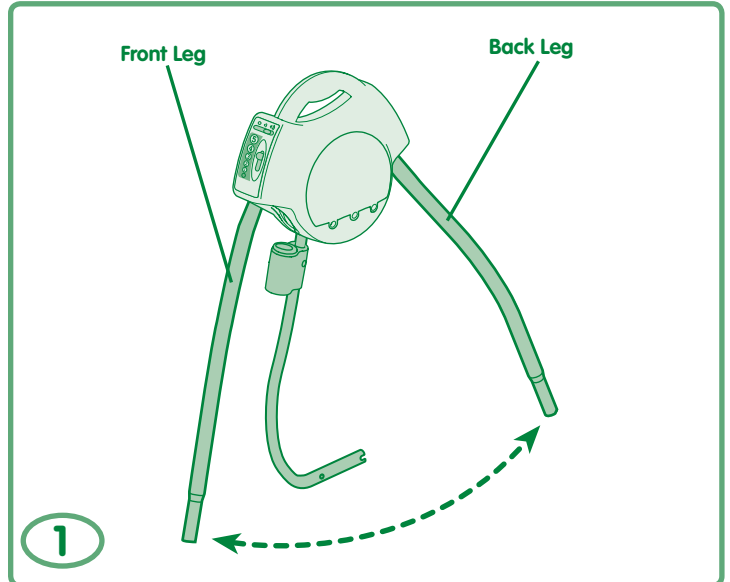

- Slide the front and back legs on the swing frame out until they “**click**” into place.
- Repeat this procedure to open the other swing frame.

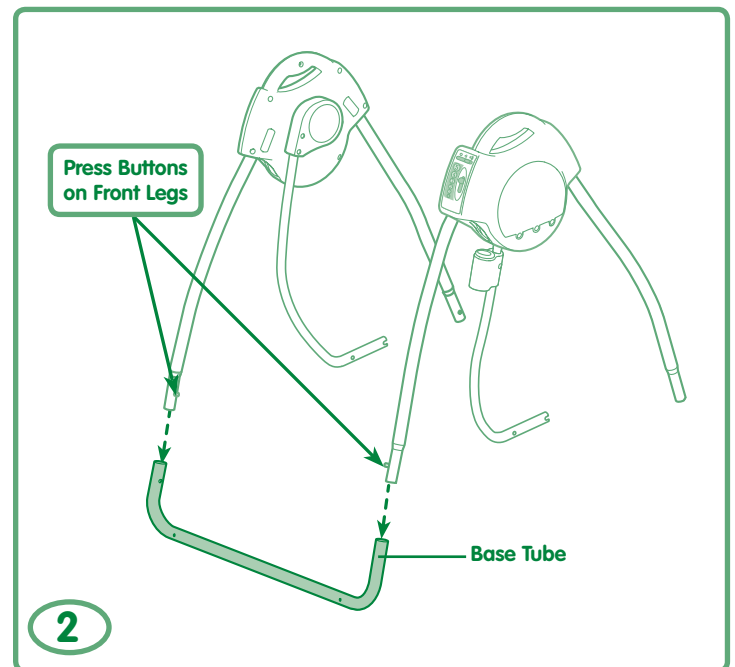

- While pressing the buttons on each front leg, insert the front legs into the base tube.
- Push the front legs down into the base tube until the buttons “**click**” into place.

Assembly

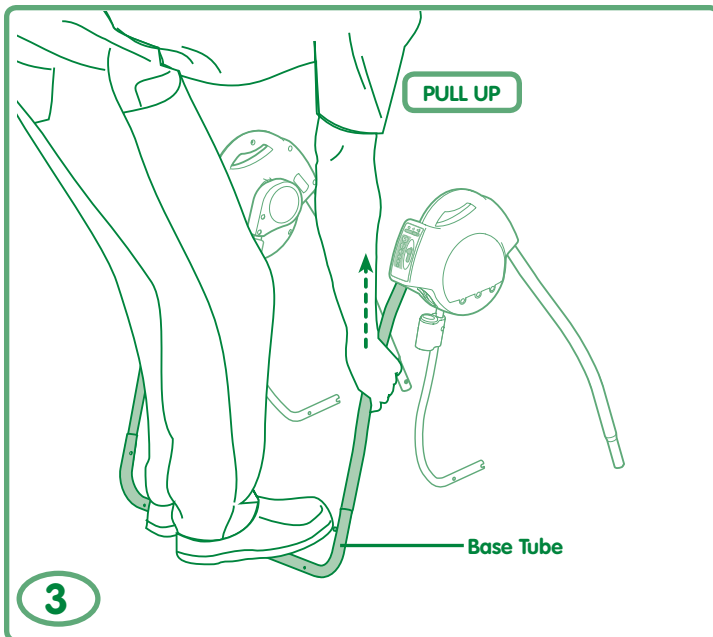

- While standing on the base tube, pull the front legs up. The front legs **should remain secured** to the base tube. If you can remove the front legs, you have not assembled them correctly to the base tube. Re-read and repeat assembly step 2.

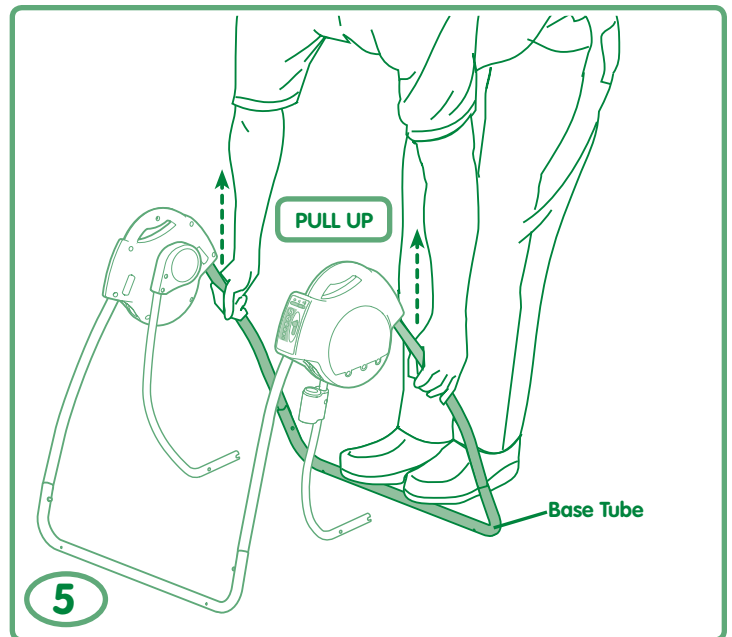

- While standing on the base tube, pull the back legs up. The back legs **should remain secured** to the base tube. If you can remove the back legs, you have not assembled them correctly to the base tube. Re-read and repeat assembly step 4.

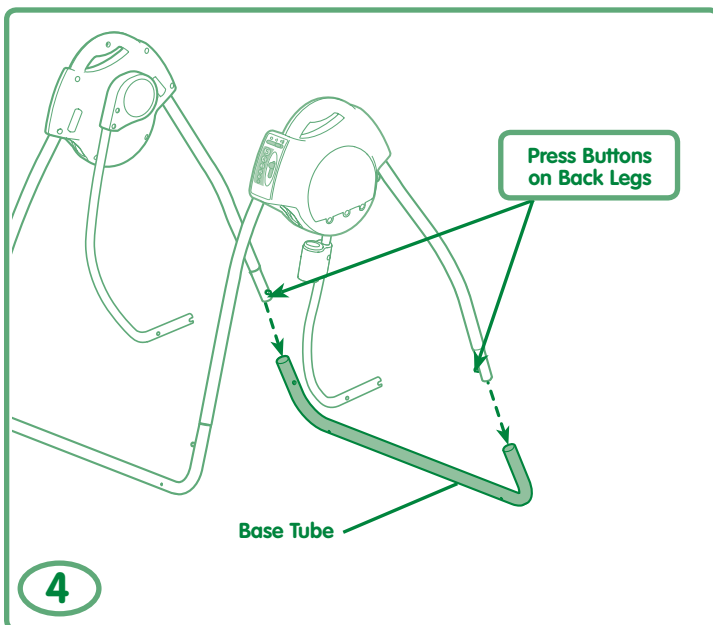

- While pressing the buttons on each back leg, insert the back legs into the remaining base tube.
- Push the back legs down into the base tube until the buttons “**click**” into place.

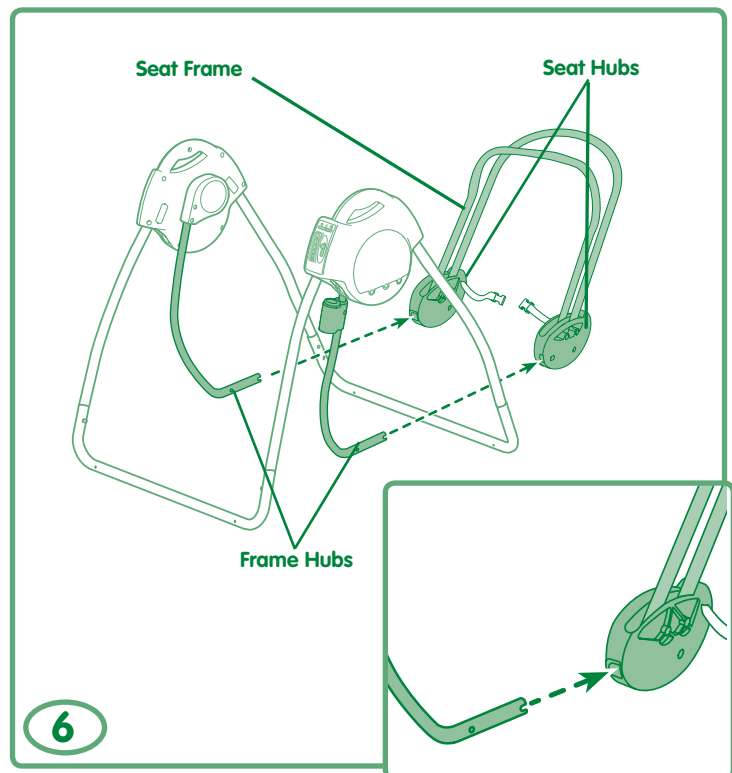

- Position the seat frame so that the tubes are upright, as shown.
- While gently pulling the seat hubs out, fit them to the matching frame hubs.

Hint: If the hubs do not fit together, simply turn the seat frame around and try again!

Assembly

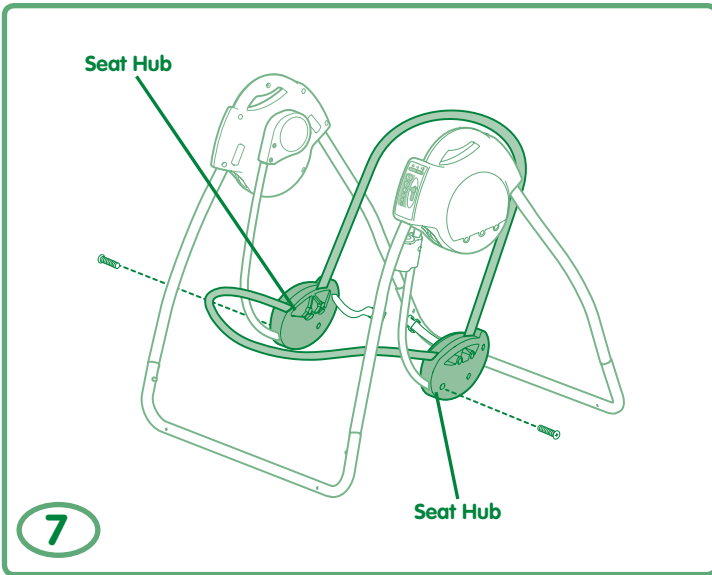

- 7
- Insert a screw through the outside of each seat hub. Tighten the screws.

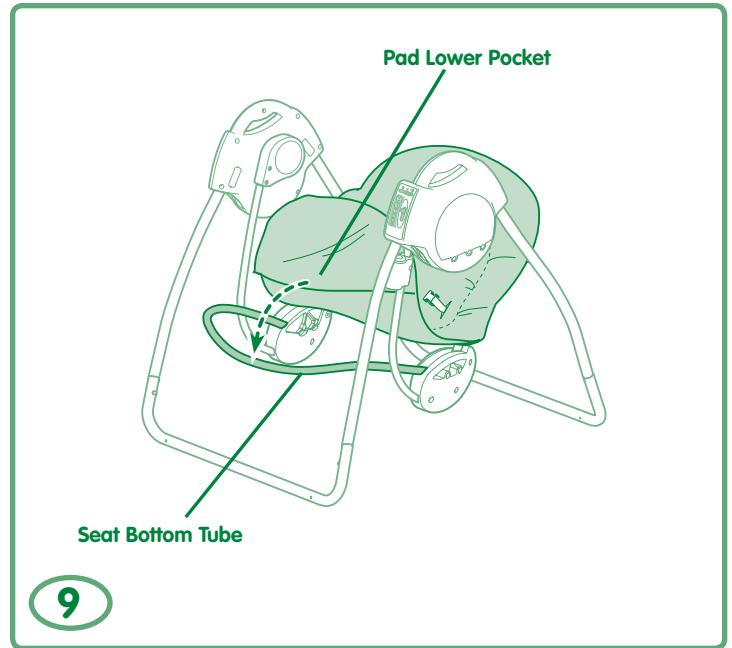

- 9
- Fit the pad lower pocket onto the seat bottom tube, as shown.

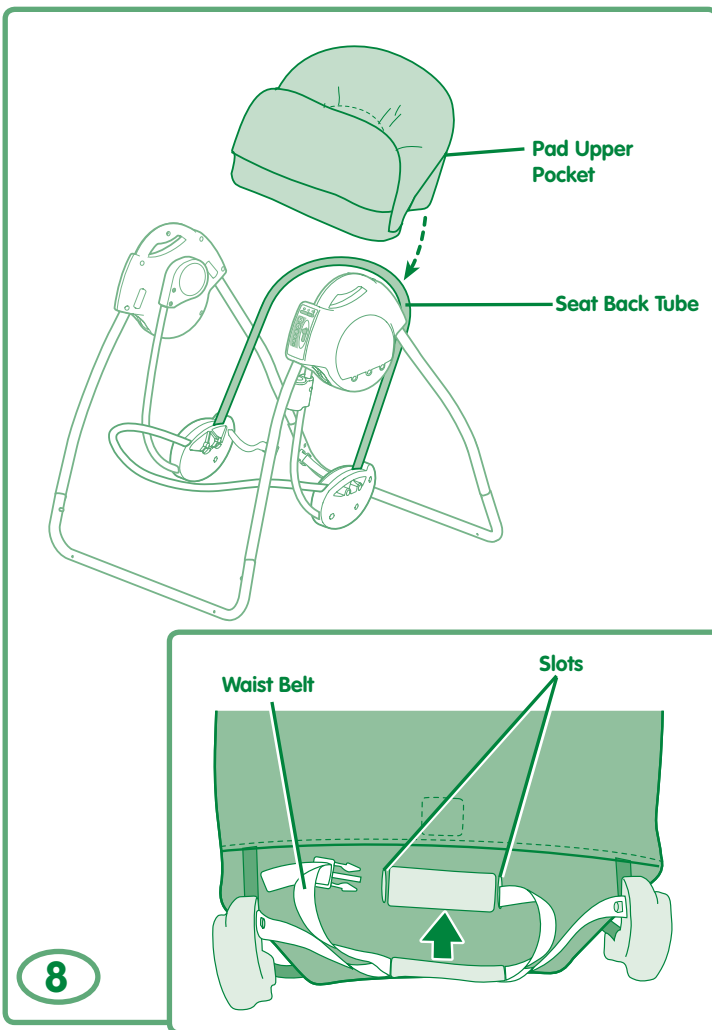

- 8
- Fit the pad upper pocket over the seat back tube.
 - From behind the assembly, insert the waist belts through the slots in the pad.

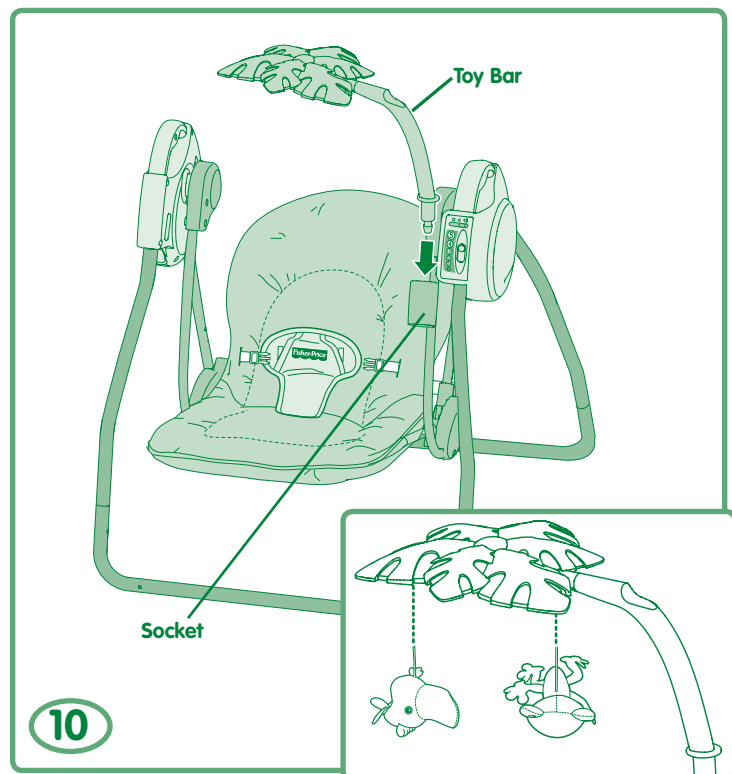

- 10
- Insert and “snap” the peg on the toybar into the socket on the swing arm. Pull the toy bar up to be sure it is secure.
 - Fit the toy strings up through the slots in the toy bar leaf.
- Assembly is now complete.**

Battery Installation

Hint: We recommend using **alkaline** batteries for longer battery life.

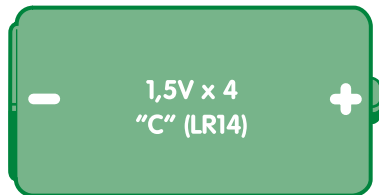

Note: Low battery power may cause product movement to slow and sound volume to become faint or turn off all together. If this should happen, please remove and discard all four batteries and replace with four, new "C" (LR14) **alkaline** batteries.

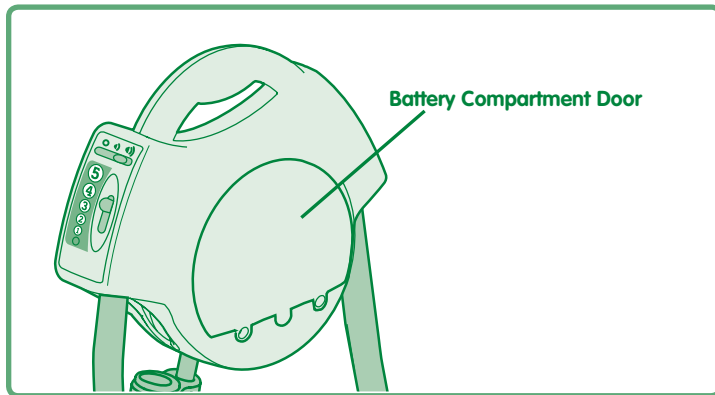

- Locate the battery compartment door on the frame.
- Loosen the screws in the battery compartment door.
- Remove the battery compartment door.
- Insert four "C" (LR14) **alkaline** batteries.
- Replace the battery compartment door and tighten the screws.
- If this product begins to operate erratically, you may need to reset the electronics. Slide the power switch off and then back on.



- Protect the environment by not disposing of the product with household waste (2002/96/EC). Check your local authority for recycling advice and facilities (Europe only).

Battery Safety Information

In exceptional circumstances, batteries may leak fluids that can cause a chemical burn injury or ruin your product. To avoid battery leakage:

- Do not mix old and new batteries or batteries of different types alkaline, standard (carbon-zinc) or rechargeable (nickel-cadmium).
- Insert batteries as indicated inside the battery compartment.
- Remove batteries during long periods of non-use. Always remove exhausted batteries from the product. Dispose of batteries safely. Do not dispose of this product in a fire. The batteries inside may explode or leak.
- Never short-circuit the battery terminals.
- Use only batteries of the same or equivalent type as recommended.
- Do not charge non-rechargeable batteries.
- Remove rechargeable batteries from the product before charging.
- If removeable, rechargeable batteries are used, they are only to be charged under adult supervision.



WARNING

To prevent serious injury from falls and being strangled in the restraint system:

- Always use the restraint system.
- Not recommended for children who can sit up by themselves (6 months approximately, until 9 Kg/20 lbs).
- Never leave child unattended.
- It is dangerous to use this product on an elevated surface.
- Never use toy bar as a handle.

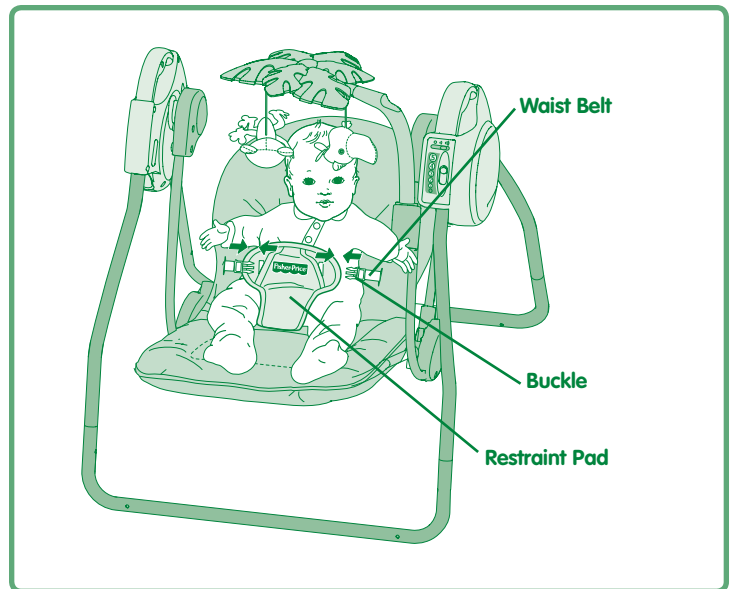

- Place your child in the seat. Position the restraint pad between your child's legs.
- Fasten both waist belts to the buckles on each side of the restraint pad. **Make sure you hear a “click” on both sides.**
- Check to be sure the restraint system is securely attached by pulling it away from your child. The restraint should remain attached.
- Tighten each waist belt so that the restraint system is snug against your child. Please refer to the next section for instructions to tighten the waist belt.

IMPORTANT! The maximum weight limit for this product is 9 kg (20 lbs). If your child weighs less than 9 kg (20 lbs), but is really active and appears to be able to climb out of the swing, immediately discontinue its use.

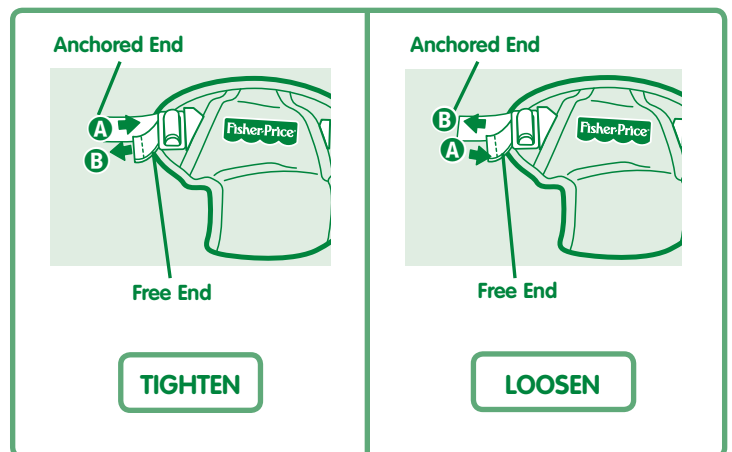

To tighten the belts: Feed the anchored end of the belt up through the buckle to form a loop **A**. Pull the free end of the belt **B**. Repeat this procedure to tighten the other belt.

To loosen the belts: Feed the free end of the belt up through the buckle to form a loop **A**. Enlarge the loop by pulling on the end of the loop toward the buckle. Pull the anchored end of the belt to shorten the free end of the belt **B**. Repeat this procedure to loosen the other belt.

Please Note: After adjusting the belts to fit your child, make sure you pull on them to be sure they are securely fastened.

Swinging and Music

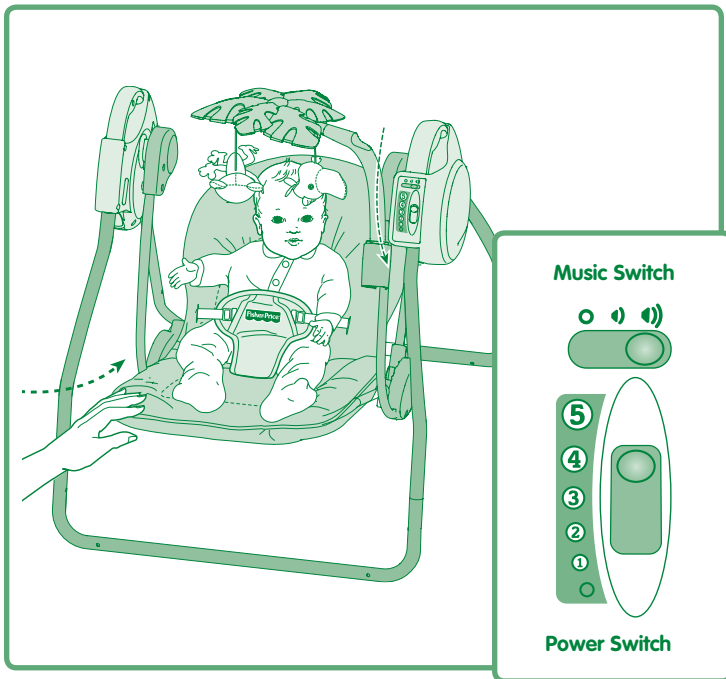

- Place your child in the seat and secure properly.

Hint: After turning on power, this product may not swing unless there is a child in the seat.

- Slide the power switch to any of five speed settings.
- Give the seat a light push to start the swinging motion.

Adjust the power switch to the desired swing motion setting.

Hint: As with most battery-powered swings, a heavier child will reduce the amount of swinging motion on all settings. In most cases, the low setting works best for a smaller child while the high setting works best for a larger child.

- If swinging stops while using a lower setting, try a higher setting. Give the seat a light push to start the swinging motion again.
- Slide the music switch to on with low volume (speaker icon with one line); on with high volume (speaker icon with two lines) or off (circle with diagonal line).
- Be sure to turn this product off when not in use. Slide the power switch to the off setting (circle with diagonal line).
- Make sure your child is properly secured in the swing seat.
- Grasp both handles, as shown, and lift.
- Carefully carry the swing to another room. Be sure to set the swing down on a **non-elevated, flat surface**.

Storage

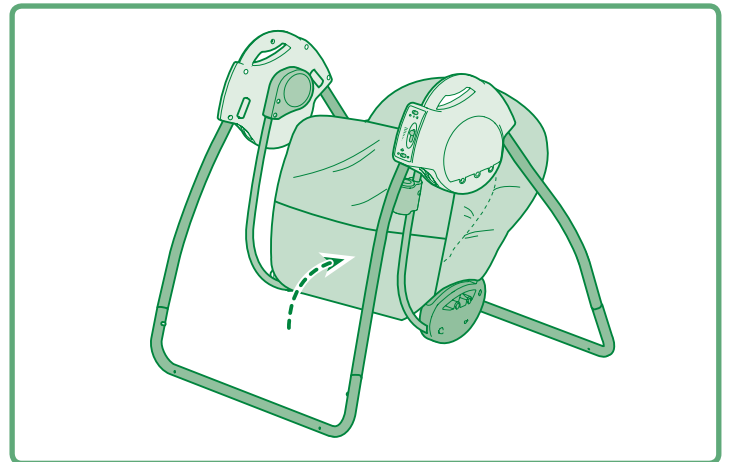

- Lift the seat bottom.

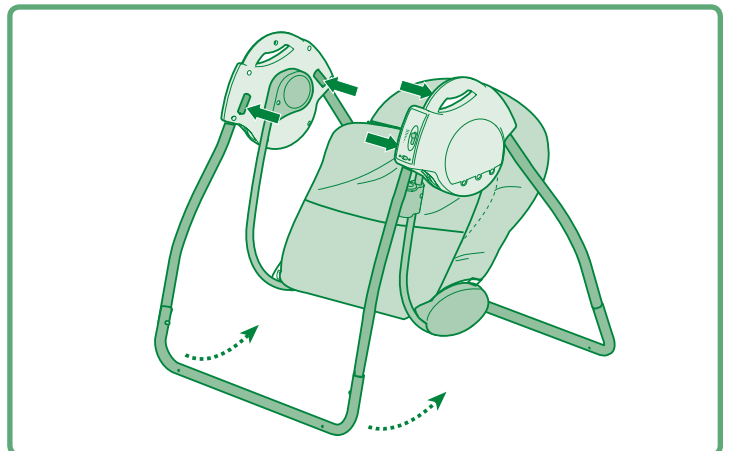

- Press the frame release buttons on the inside of the frames and push the front legs inward.

Free Manuals Download Website

<http://myh66.com>

<http://usermanuals.us>

<http://www.somanuals.com>

<http://www.4manuals.cc>

<http://www.manual-lib.com>

<http://www.404manual.com>

<http://www.luxmanual.com>

<http://aubethermostatmanual.com>

Golf course search by state

<http://golfingnear.com>

Email search by domain

<http://emailbydomain.com>

Auto manuals search

<http://auto.somanuals.com>

TV manuals search

<http://tv.somanuals.com>