

Fisher-Price®

Grow to Pro® Baseball

Instructions

Product Number: 72818



**Please keep this instruction sheet for future reference,
as it contains important information.**

Adult assembly is required.

No tools necessary for assembly.

Download from www.Somanuals.com. All Manuals Search And Download.

Parts

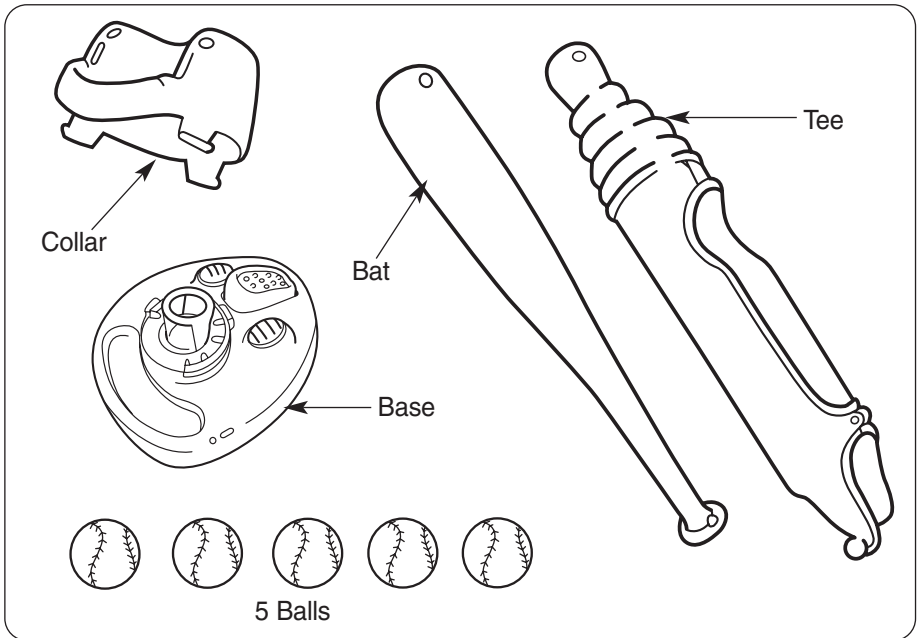

Important Message to Parents

- Be sure that when your child is batting, there are no other children in or around the batting area, including directly in front of the tee.
- This toy is designed for use with plastic balls and a plastic bat. It is not designed for use with wooden or metal bats, or regulation baseballs or softballs. Use of such balls and bats may damage this toy.
- We recommend that this toy be used on a non-paved surface, such as grass or sand.

Assembly

1

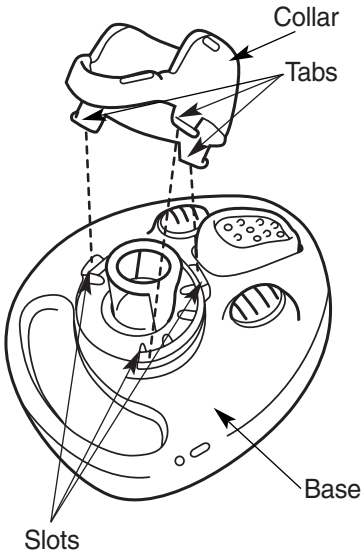

- Position the base right side up.
- Insert and snap the three tabs on the collar into the three slots in the base.

IMPORTANT! Assembling the collar to the base is a one-time assembly. Please be sure **all three tabs** on the collar are inserted into the base slots.

2

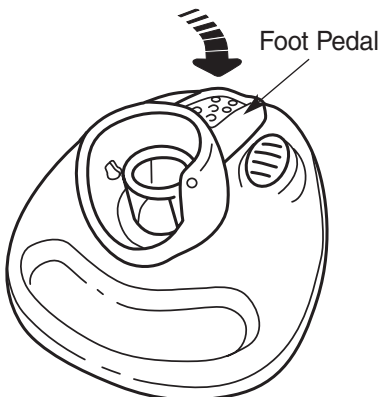

- Using your hand or foot, press the foot pedal down to the set position.

3

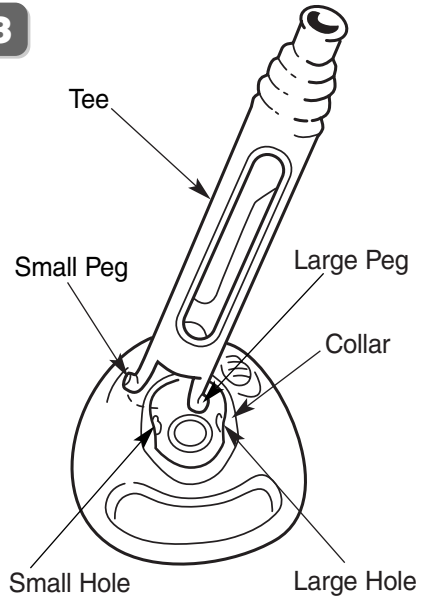

- Fit the large peg on the tee into the large hole in the collar.
- Insert the small peg on the tee into the small hole in the collar.
- Pull up on the tee to be sure it is secure.

IMPORTANT! As a precaution, the tee has been designed to release from the base if stressed. If the tee releases from the base, simply reattach it following assembly steps **2** and **3**.

Batting Practice: T-Ball

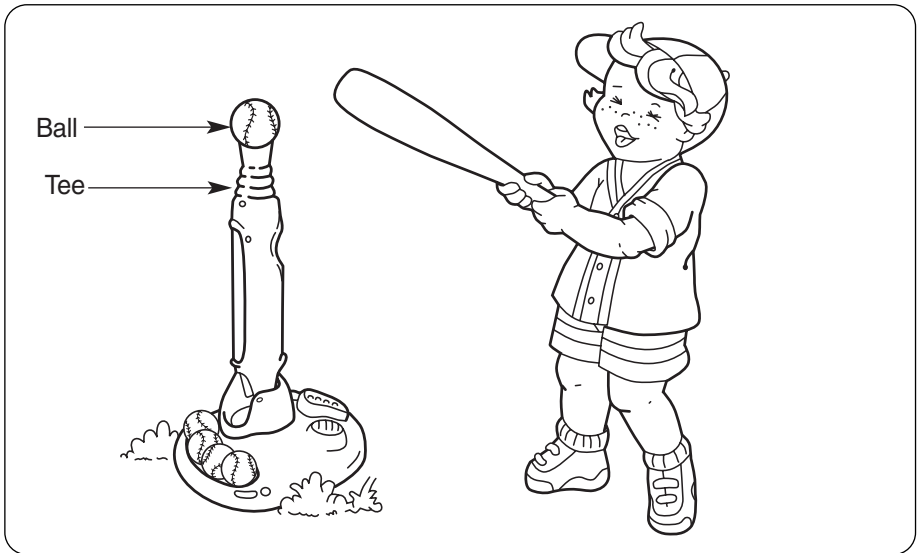

- Place a ball on top of the tee.
- Hold the bat with hands together, about one or two inches from the knob at the end of the bat.

Helpful Hint: Right-handed batters should have the right hand on top of the left hand; left-handed batters should have the left hand on top of the right hand.

- Stand with feet about shoulder width apart.
- Stand close enough to hit the ball comfortably. Look at the ball and swing with a smooth and level motion.

Batting Practice: Pop-Up Pitch

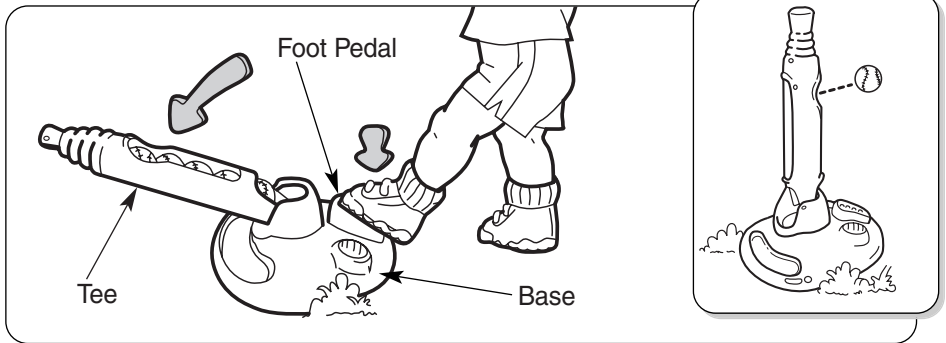

- Insert all five balls into the hole in the side of the tee.
- Tilt the tee back and a ball will load into the collar.
- Using your foot, press the foot pedal until it locks into the set position.

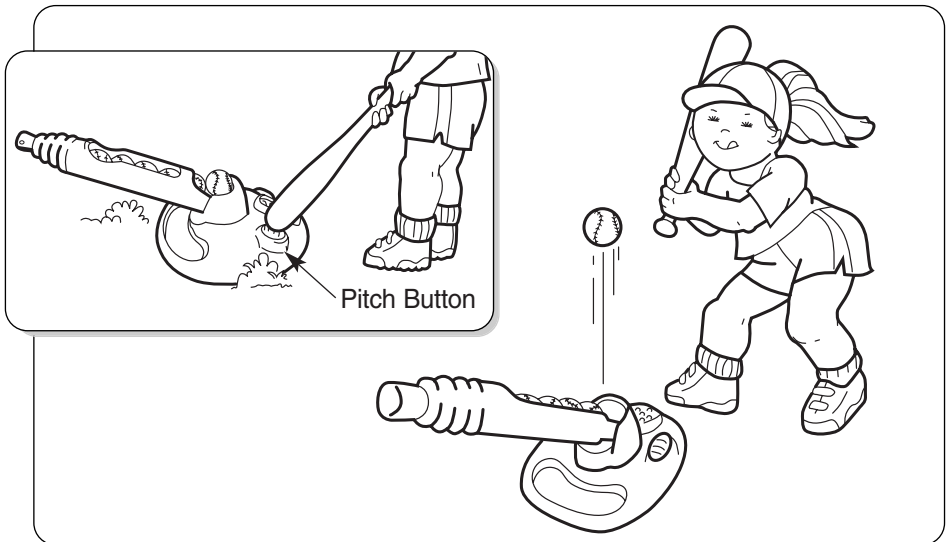

- Hold the bat with hands together, about one or two inches from the knob at the end of the bat.

Helpful Hint: Right-handed batters should have the right hand on top of the left hand; left-handed batters should have the left hand on top of the right hand.

- Stand with feet about shoulder width apart.
- Tap either of the pitch buttons with the bat.
- Keep your eyes on the ball as it pops-up and swing with a smooth and level motion.
- Press the foot pedal down again to load the next ball!

Storage and Care

IMPORTANT! Never store Grow to Pro® Baseball with the foot pedal in the set (pressed down) position.

- Periodically inspect Grow to Pro® Baseball for wear and damage and replace any cracked parts.
- To clean, use a mild soap and water solution and a clean cloth. Rinse clean with water to remove soap residue.

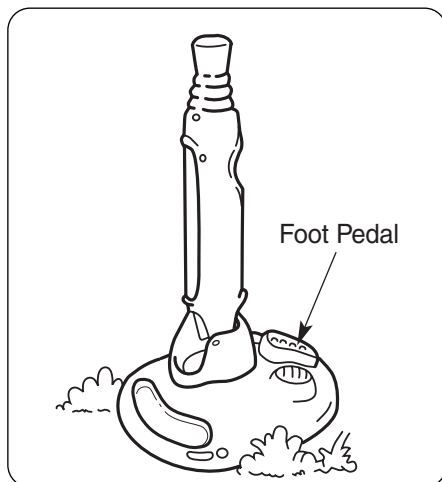

Consumer Information

Questions? We'd like to hear from you!

Call Fisher-Price® Consumer Affairs, toll-free at **1-800-432-KIDS**, 8 AM - 6 PM EST Monday through Friday. Hearing-impaired consumers using TTY/TDD equipment, please call 1-800-382-7470. Or, write to: Fisher-Price® Consumer Affairs, 636 Girard Avenue, East Aurora, New York 14052.

Free Manuals Download Website

<http://myh66.com>

<http://usermanuals.us>

<http://www.somanuals.com>

<http://www.4manuals.cc>

<http://www.manual-lib.com>

<http://www.404manual.com>

<http://www.luxmanual.com>

<http://aubethermostatmanual.com>

Golf course search by state

<http://golfingnear.com>

Email search by domain

<http://emailbydomain.com>

Auto manuals search

<http://auto.somanuals.com>

TV manuals search

<http://tv.somanuals.com>