

Fisher-Price®

T6340



www.fisher-price.com

Download from Www.Somanuals.com. All Manuals Search And Download.

Consumer Information



WARNING

Prevent Entanglement Injury

- Keep mobile out of baby's reach.
- Remove mobile portion of product from crib or playpen when baby begins to push up on hands and knees.
- This product may not attach to all crib designs. Do not add additional strings or straps to attach to crib or playpen.
- Use **ONLY** attached to a crib or playpen.

IMPORTANT! Always attach with all provided fasteners tightly to a crib or playpen according to the instructions. Do not add additional strings or straps to attach to a crib. Check frequently.

- Please keep this instruction sheet for future reference, as it contains important information.
- Requires four "C" (LR14) **alkaline** batteries for mobile/base operation and two "AAA" (LR03) **alkaline** batteries for remote operation (batteries not included).
- Adult assembly is required.
- Tool required for assembly: Phillips screwdriver (not included).
- The mobile portion of this product may be used from birth until 5 months.
- The base portion of this product may be used from birth until 24 months.
- A crib mobile is intended for visual stimulation and is not to be grasped by a child.
- This toy has no consumer serviceable parts. Do not take this toy apart.
- If this product begins to operate erratically, you may need to reset the electronics. Slide the power/volume switch on the base off and then back on. Remove the batteries from the remote and replace them.

Parts

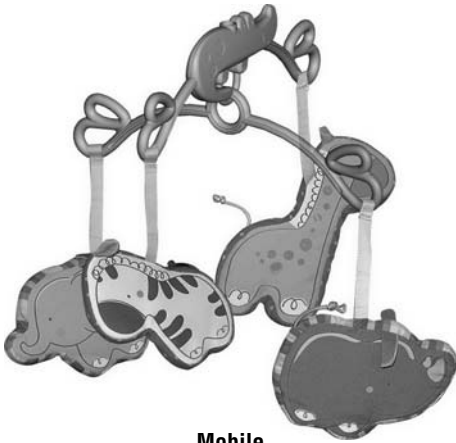

Mobile

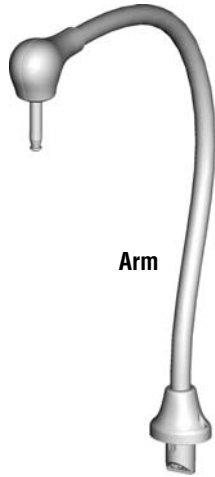

Arm



Crib Connector



Remote

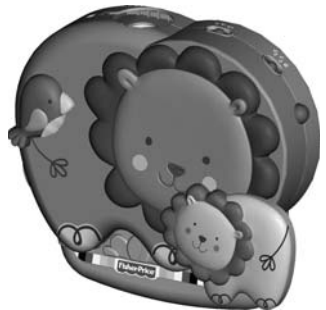

Base

Note: All of the screws used to assemble this toy are attached to the product. Follow these instructions carefully to fully secure the screws. Tighten and loosen all screws with a Phillips screwdriver. Do not over-tighten the screws.

Consumer Information



CONSUMER ASSISTANCE

1-800-432-5437 (US & Canada)

1300 135 312 (Australia)



service.fisher-price.com

Fisher-Price, Inc., 636 Girard Avenue, East Aurora, NY 14052.

Hearing-impaired consumers: 1-800-382-7470.

Outside the United States:

Canada: Mattel Canada Inc., 6155 Freemont Blvd.,
Mississauga, Ontario L5R 3W2; www.service.mattel.com.

Great Britain: Mattel UK Ltd, Vanwall Business Park,
Maidenhead SL6 4UB. Helpline: 01628 500303.
www.service.mattel.com/uk

Mattel Europa, B.V., Gondel 1, 1186 MJ Amstelveen, Nederland.

Australia: Mattel Australia Pty. Ltd., 658 Church Street,
Locked Bag #870, Richmond, Victoria 3121 Australia.

New Zealand: 16-18 William Pickering Drive,
Albany 1331, Auckland.

Care

- Wipe this toy with a clean cloth dampened with a mild soap and water solution. Do not immerse this toy. The soft toys are surface washable.



- Protect the environment by not disposing of this product with household waste (2002/96/EC). Check your local authority for recycling advice and facilities (Europe only).

Battery Installation

*Hint: We recommend using **alkaline** batteries for longer battery life.*

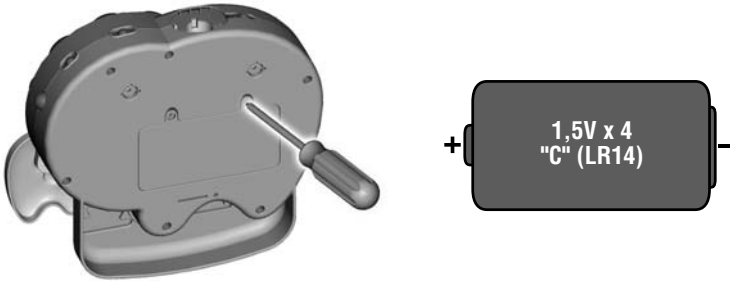

Base

- Loosen the screws in the battery compartment door with a Phillips screwdriver. Remove the battery compartment door.
- Insert four "C" (LR14) **alkaline** batteries.
- Replace the battery compartment door and tighten the screws.

IMPORTANT! Under normal use conditions, the batteries in the base will require replacement more often than the batteries in the remote. When sounds or motion become faint or stop, it's time for an adult to change the batteries.

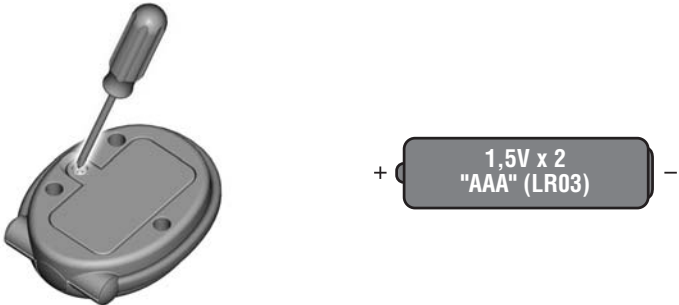

Remote

- Loosen the screw in the battery compartment door with a Phillips screwdriver. Remove the battery compartment door.
- Insert two "AAA" (LR03) **alkaline** batteries.
- Replace the battery compartment door and tighten the screw.
- If the base does not seem to react to the remote after replacing batteries in the base, it's time for an adult to replace the batteries in the remote.

Battery Safety Information

In exceptional circumstances, batteries may leak fluids that can cause a chemical burn injury or ruin your product. To avoid battery leakage:

- Do not mix old and new batteries or batteries of different types: alkaline, standard (carbon-zinc) or rechargeable (nickel-cadmium).
- Insert batteries as indicated inside the battery compartment.
- Remove batteries during long periods of non-use. Always remove exhausted batteries from the product. Dispose of batteries safely. Do not dispose of this product in a fire. The batteries inside may explode or leak.
- Never short-circuit the battery terminals.
- Use only batteries of the same or equivalent type, as recommended.
- Do not charge non-rechargeable batteries.
- Remove rechargeable batteries from the product before charging.
- If removable, rechargeable batteries are used, they are only to be charged under adult supervision.

Assembly

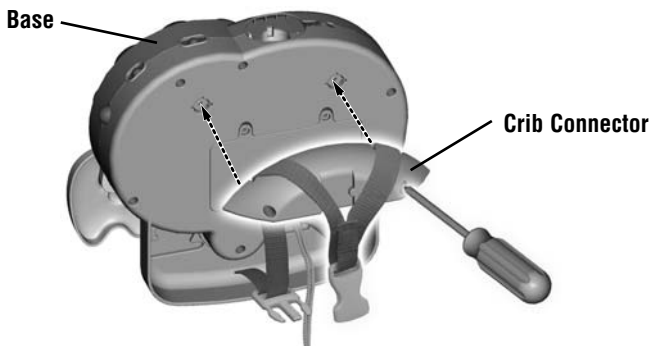

- Fit the crib connector to the base and tighten **both** screws.

IMPORTANT! Make sure the straps are over the **top** of the crib connector.

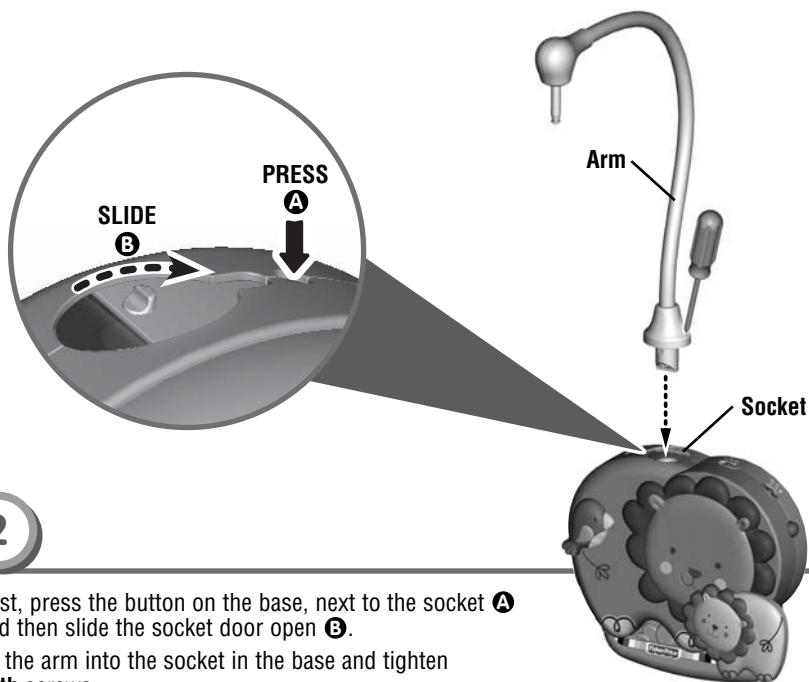

- First, press the button on the base, next to the socket **A** and then slide the socket door open **B**.
- Fit the arm into the socket in the base and tighten **both** screws.

Assembly

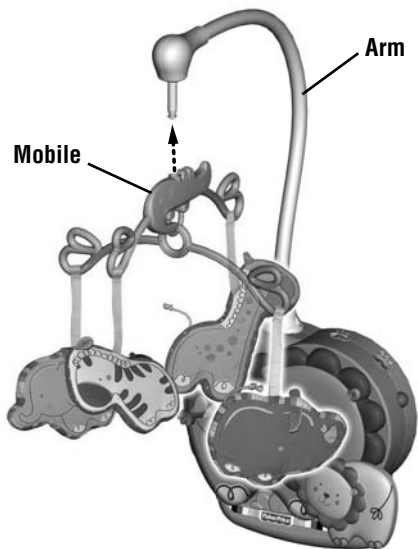

3

- Fit the mobile to the end of the arm.
- Push to **"snap"** the mobile onto the arm. Pull the mobile to be sure it's secure to the arm.

Crib Attachment



WARNING

Prevent Entanglement Injury

- Keep mobile out of baby's reach.
- Remove mobile portion of product from crib or playpen when baby begins to push up on hands and knees.
- This product may not attach to all crib designs. Do not add additional strings or straps to attach to crib or playpen.
- Use ONLY attached to a crib or playpen.

Crib Attachment

IMPORTANT! If you are attaching this toy to a crib side rail that can be lowered and raised, make sure the crib side rail is in the raised (locked) position whenever a child is in the crib.

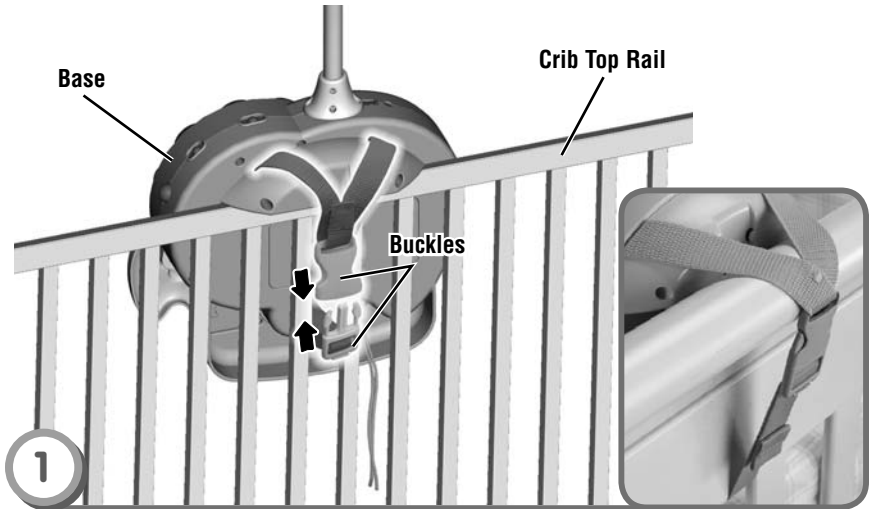

- Position the base so that the decorated side faces the inside of the crib.
- Fit the base onto the crib top rail.

Hint: The base is designed to fit most crib designs. Please refer to the main illustration and the inset photograph.

- Make sure the top strap is hanging over the crib top rail. Pull the bottom strap through the crib rails.
- Buckle the straps. Make sure you hear a “click”.

Crib Attachment

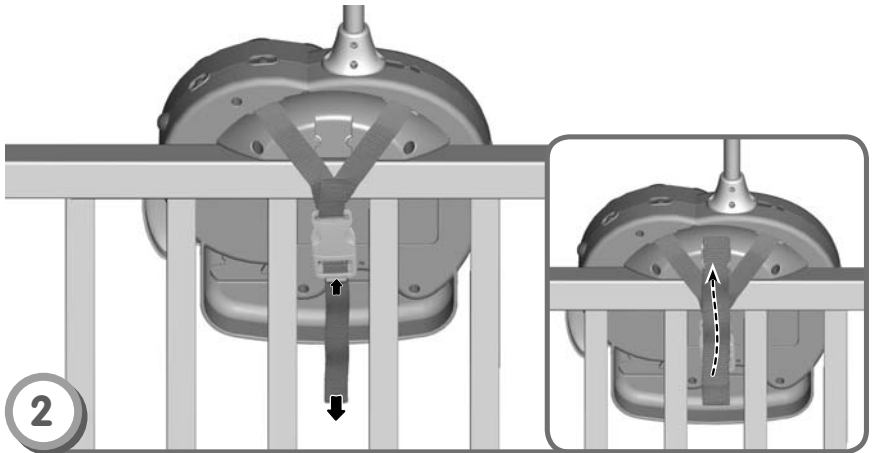

- Make sure the straps are tightened securely around the crib rail.
- While pushing the tab at the bottom of the buckle, pull the free end of the strap to tighten on the rail.

Hint: You can secure the free end of the strap to the base.

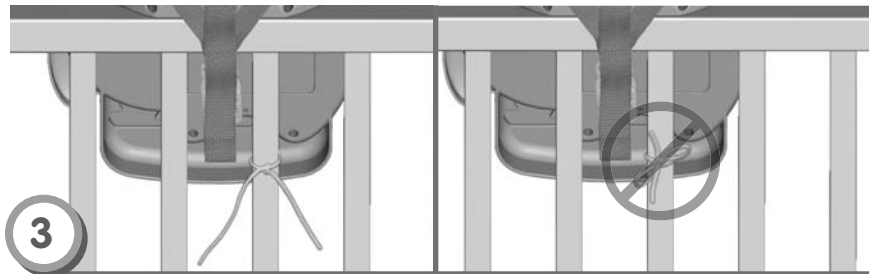

- Tie the base strings to a crib spindle.

Note: It is better to tie the strings in a knot than a bow, since a bow may be easily untied.

Crib Attachment

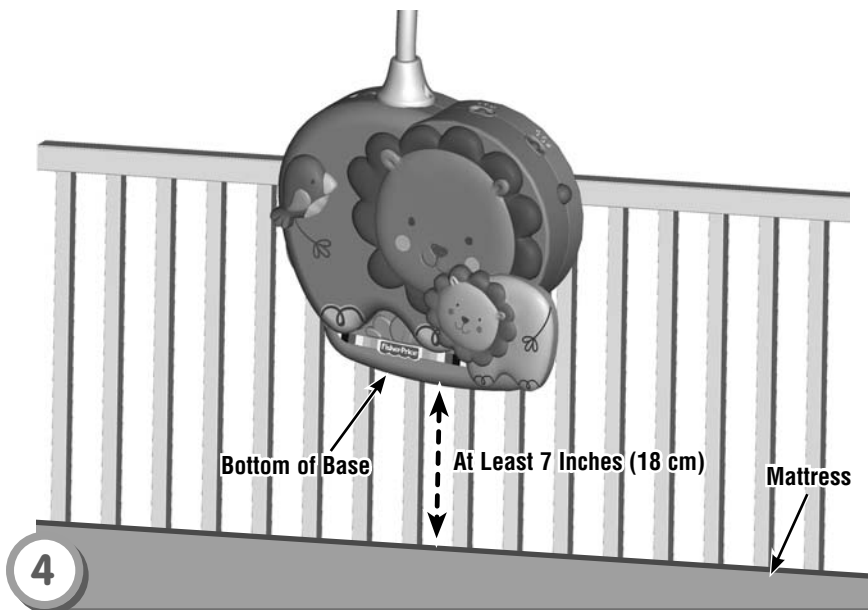

- If the distance between the base and the mattress is less than 7 Inches (18 cm), lower the crib mattress.

Crib Removal

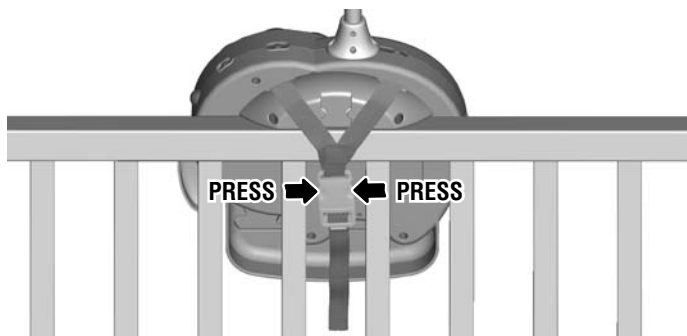

- To remove the base from a crib rail, simply press the tabs on each side of the buckle.

Use

IMPORTANT!

- In the unlikely event that use of the remote interferes with normal use of other remote controlled equipment, such as televisions, stereos, or use of other electronic or battery powered appliances interfere with operation of the mobile, do not use both appliances at the same time.
- For best performance between the mobile and the remote, avoid using the remote in areas of bright light. In bright natural or artificial light, you may notice loss of range. Move the mobile or otherwise reduce the amount of light to improve performance.

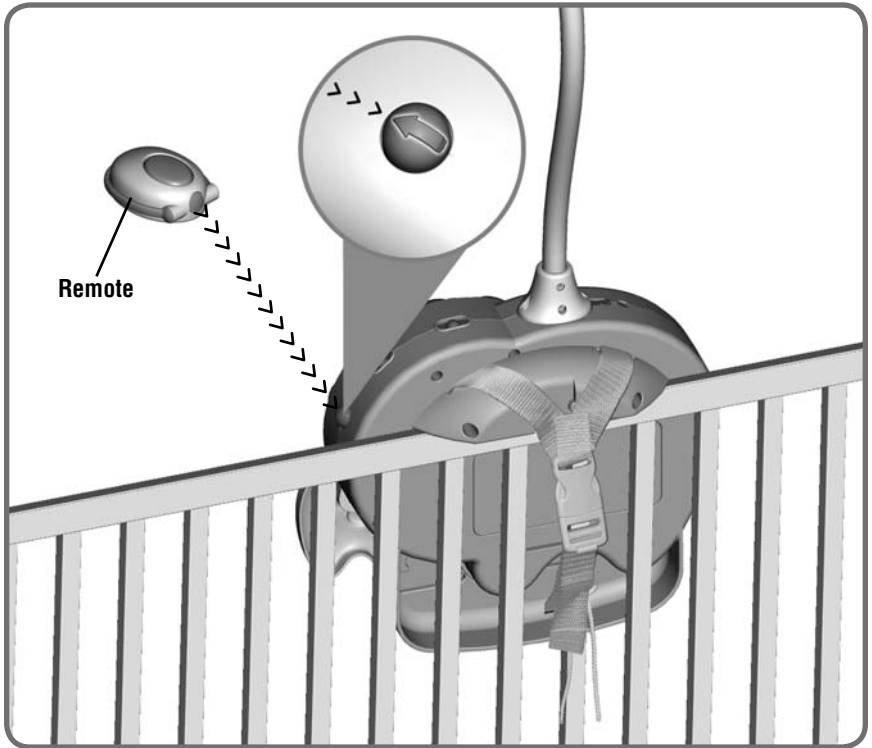

- When using the remote, make sure the arrow on the base is pointing towards the transmitter window on the remote. **For best results make sure the path between the transmitter window on the remote and the base are in a direct line and free of obstacles. Position the base so that the arrow points to the area from which you're most likely to use the remote.**

Use



Power/Volume Switch

- Slide the switch to ON with low volume (two arrows pointing left) or ON with high volume (two arrows pointing right). When finished using the product, slide the switch OFF (power symbol).



Sound Select Switch

- Slide the switch to select:
 - Classical Music (musical note icon)
 - Lullabies (crescent moon icon)
 - Nature Sounds (leaf icon)



Mode Select Switch

- Slide the switch to select a mode:
 - Music and Motion (musical note and circular arrow icon)
 - Music only (musical note icon)

- Press the button on the remote to activate the mobile. Press again to stop.

Note: The remote will remain active for about four hours. After four hours you will need to slide the power/volume switch on the mobile off, then on again to reactivate.

Convert to Music Box

Remove the mobile and use as a music box!



- Loosen both screws in the arm near the base. Lift and remove the arm.
- Close the socket door on top of the base.

Hint: The socket door must be completely closed for use as a music box.

- Store the mobile in a safe place for future use.

FCC Statement (United States Only)

This equipment has been tested and found to comply with the limits for a Class B digital device, pursuant to Part 15 of the FCC Rules. These limits are designed to provide reasonable protection against harmful interference in a residential installation. This equipment generates, uses and can radiate radio frequency energy and, if not installed and used in accordance with the instructions, may cause harmful interference to radio communications. However, there is no guarantee that interference will not occur in a particular installation. If this equipment does cause harmful interference to radio or television reception, which can be determined by turning the equipment off and on, the user is encouraged to try to correct the interference by one or more of the following measures:

- Reorient or relocate the receiving antenna.
- Increase the separation between the equipment and receiver.
- Consult the dealer or an experienced radio/TV technician for help.

Note: Changes or modifications not expressly approved by the manufacturer responsible for compliance could void the user's authority to operate the equipment.

This device complies with Part 15 of the FCC Rules. Operation is subject to the following two conditions: (1) this device may not cause harmful interference and (2) this device must accept any interference received, including interference that may cause undesired operation.

ICES-003

This Class B digital apparatus complies with Canadian ICES-003.

Operation is subject to the following two conditions: (1) this device may not cause harmful interference and (2) this device must accept any interference received, including interference that may cause undesired operation.

NMB-003

Cet appareil numérique de la classe B est conforme à la norme NMB-003 du Canada.

L'utilisation de ce dispositif est autorisée seulement aux conditions suivantes: (1) il ne doit pas produire de brouillage et (2) l'utilisateur du dispositif doit être prêt à accepter tout brouillage radioélectrique reçu, même si ce brouillage est susceptible de compromettre le fonctionnement du dispositif.

Free Manuals Download Website

<http://myh66.com>

<http://usermanuals.us>

<http://www.somanuals.com>

<http://www.4manuals.cc>

<http://www.manual-lib.com>

<http://www.404manual.com>

<http://www.luxmanual.com>

<http://aubethermostatmanual.com>

Golf course search by state

<http://golfingnear.com>

Email search by domain

<http://emailbydomain.com>

Auto manuals search

<http://auto.somanuals.com>

TV manuals search

<http://tv.somanuals.com>