

**Fisher-Price®**

**W1443**

**made by**  
**ME!**  **™**



Please keep this instruction sheet for future reference,  
as it contains important information.

Adult setup is required.

**[www.fisher-price.com](http://www.fisher-price.com)**

Download from [Www.Somanuals.com](http://Www.Somanuals.com). All Manuals Search And Download.

## Important Information

- Adult supervision is recommended.
- Paints may stain some surfaces. Protect the play area before use.
- Water toys sometimes get messy. Do not play with this toy on surfaces that can be damaged by water.
- Keep paint away from eyes.
- After each use, drain and rinse this toy. Dry thoroughly before storing.
- If paint gets on skin, wash with soap and water. Wash hands with soap and water after use.
- Avoid contact with finished and unfinished wood, matte finish paint, wallpaper, painted walls, carpeting and other material that cannot be washed or laundered.
- If paint gets on clothing, pretreat with a stain remover and wash separately in warm water as soon as possible. A second washing may be necessary to remove paint.

## Includes

4 No Spill  
Paint Cups

4 Tempera  
Paints

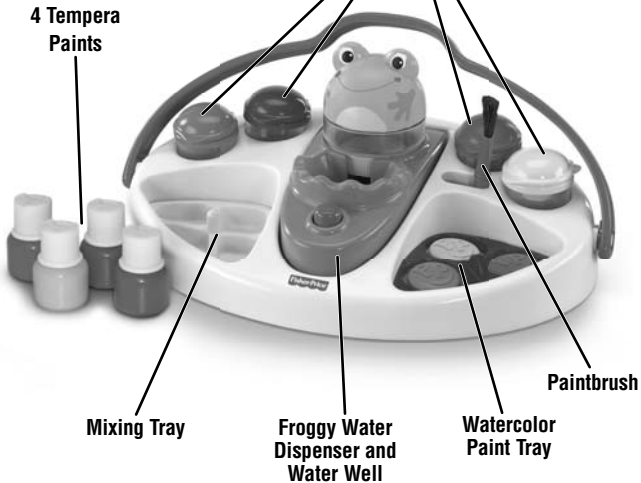

Mixing Tray

Froggy Water  
Dispenser and  
Water Well

Watercolor  
Paint Tray

Paintbrush



## CONSUMER ASSISTANCE

1-800-432-5437 (US & Canada)

1300 135 312 (Australia)



**service.fisher-price.com**

**Fisher-Price, Inc., 636 Girard Avenue, East Aurora, NY 14052.**

**Hearing-impaired consumers: 1-800-382-7470.**

Outside the United States:

Canada: Mattel Canada Inc., 6155 Freemont Blvd.,  
Mississauga, Ontario L5R 3W2; [www.service.mattel.com](http://www.service.mattel.com).

Great Britain: Mattel UK Ltd, Vanwall Business Park,  
Maidenhead SL6 4UB. Helpline: 01628 500303.  
[www.service.mattel.com/uk](http://www.service.mattel.com/uk)

Mattel Europa, B.V., Gondel 1, 1186 MJ Amstelveen, Nederland.

Australia: Mattel Australia Pty. Ltd., 658 Church Street,  
Locked Bag #870, Richmond, Victoria 3121 Australia.

New Zealand: 16-18 William Pickering Drive,  
Albany 1331, Auckland.



Fisher-Price, Inc., a subsidiary of Mattel, Inc., East Aurora, NY 14052 U.S.A.  
©2011 Mattel, Inc. All Right Reserved. © and ™ designate U.S. trademarks of Mattel, Inc.

**PRINTED IN CHINA**

**W1443pr-0920**

Download from [Www.Somanuals.com](http://Www.Somanuals.com). All Manuals Search And Download.

## Setup



- Twist to remove the cap from the paint bottle. Remove and discard the seal on the paint bottle, then replace the cap.
- Fill the no-spill paint cups with paint.

**Note:** To prevent paints from drying out, empty paint from the no-spill cups after each use.

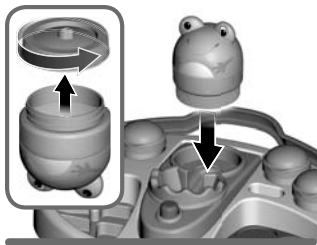

- Twist to remove the cap from the froggy water dispenser. Fill with water to the fill line and replace the cap.
- Fit the dispenser into the base.

### Well



- The well will automatically fill with clean water.

## Setup

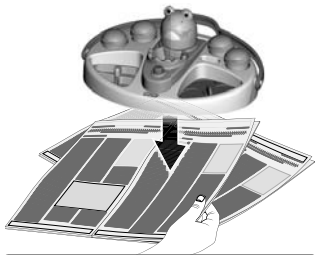

- Place newspaper or another protective material on your work surface.

## Painting Fun!



- Use the mixing tray to mix paint colors. Dip your brush in the well to clean or for use with watercolors.



- Press the button to drain dirty water from the well.

## Cleanup

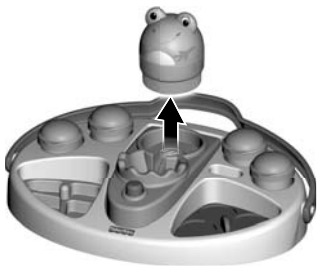

- 
- Remove the froggy water dispenser from the well.

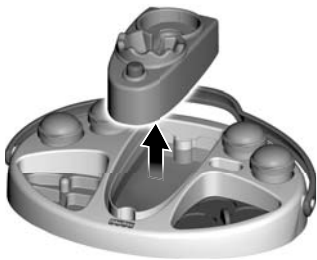

- 
- Lift to remove the top of the well from the tray.

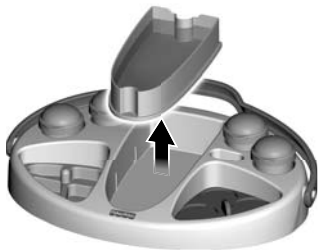

- 
- Carefully remove the bottom of the well from the tray and pour dirty water out. Rinse and replace in the base.
  - Clean the froggy water dispenser and water well, no-spill paint cups, paintbrush, mixing tray and base with a mild soap and water solution.

## All-in-One Storage



- When finished, replace the no-spill paint cups and the paintbrush in the base.



## Free Manuals Download Website

<http://myh66.com>

<http://usermanuals.us>

<http://www.somanuals.com>

<http://www.4manuals.cc>

<http://www.manual-lib.com>

<http://www.404manual.com>

<http://www.luxmanual.com>

<http://aubethermostatmanual.com>

Golf course search by state

<http://golfingnear.com>

Email search by domain

<http://emailbydomain.com>

Auto manuals search

<http://auto.somanuals.com>

TV manuals search

<http://tv.somanuals.com>