

**Fisher-Price®**

# *Kick & Play Bouncer*



**Model Number: 79636**

Please keep this instruction sheet for future reference,  
as it contains important information.

Adult assembly is required.

Tool required for assembly: Phillips screwdriver (not included).

Requires one "D" (LR20) **alkaline** battery (not included) in the soothing unit.

Requires three "AA" (LR6) **alkaline** batteries (not included) in the toy bar.

Discover what's possible... [www.fisher-price.com](http://www.fisher-price.com)



## WARNING

### **To prevent serious injury and/or falls:**

- Never use on any elevated surface, since child's movement may cause bouncer to slide or tip over.
- Never use as a carrier or lift while child is seated.
- Always use the restraint system.
- Never leave child unattended.
- Never use as a car seat.
- Never use with a child able to sit up, unassisted.

# Parts

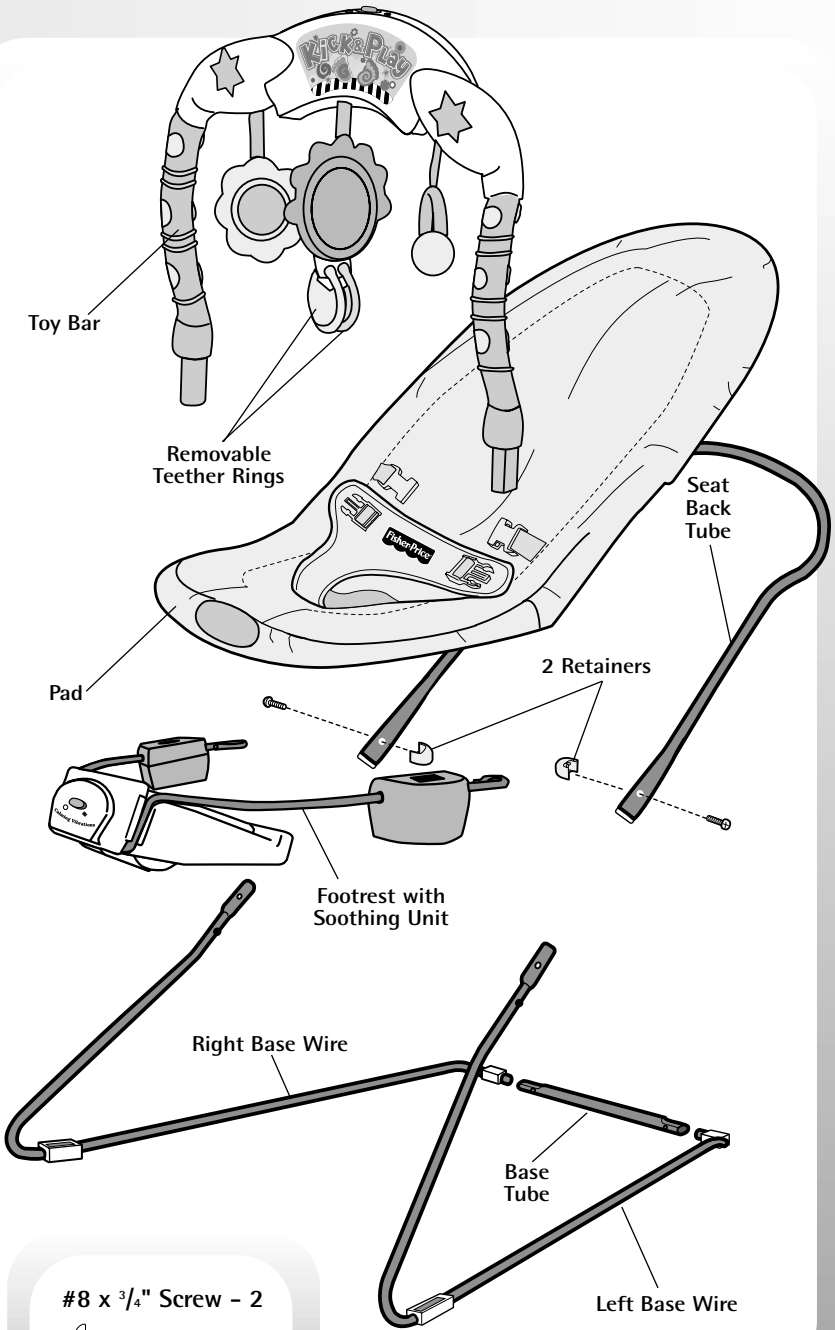

#8 x 3/4" Screw - 2



Shown Actual Size

# Battery Installation

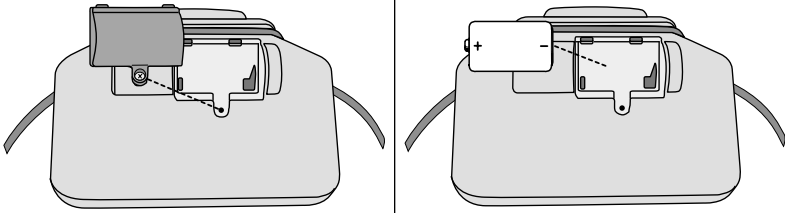

## Soothing Unit

- Locate the soothing unit on the footrest wire.
- Loosen the screw in the soothing unit battery compartment door with a Phillips screwdriver. Remove the battery compartment door.
- Insert one "D" (LR20) **alkaline** battery, as indicated inside the battery compartment.
- Replace the battery compartment door. Tighten the screw with a Phillips screwdriver. Do not over-tighten.

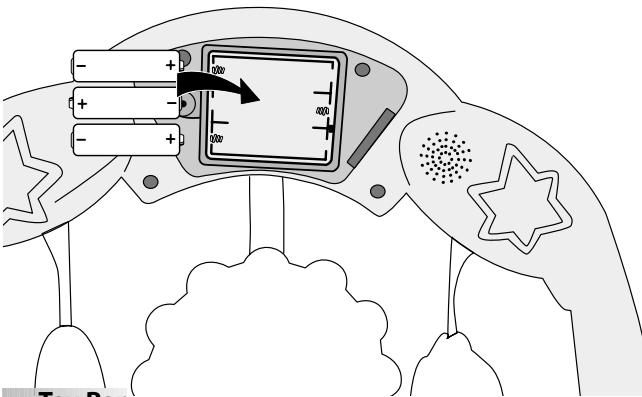

## Toy Bar

- Loosen the screw in the toy bar battery compartment door with a Phillips screwdriver. Remove the battery compartment door.
- Insert three "AA" (LR6) **alkaline** batteries, as indicated inside the battery compartment.
- Replace the battery compartment door. Tighten the screw with a Phillips screwdriver. Do not over-tighten.

# Battery Tips

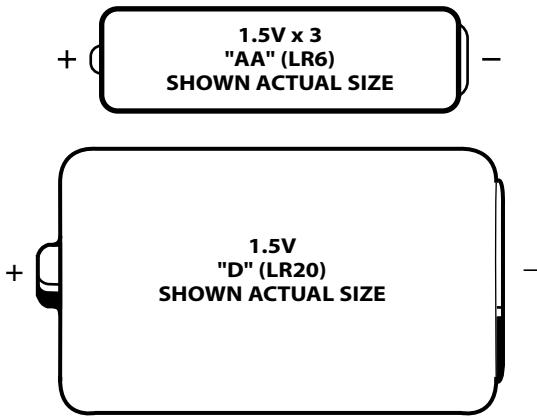

- Do not mix old and new batteries.
- Do not mix different types of batteries: alkaline, standard (carbon-zinc) or rechargeable (nickel-cadmium).
- Remove the batteries during long periods of non-use. Always remove exhausted batteries from the toy. Battery leakage and corrosion can damage this product. Dispose of batteries safely.
- Do not dispose of batteries in a fire. The batteries may explode or leak.
- Never short circuit the battery terminals.
- Non-rechargeable batteries are not to be recharged.
- Only batteries of the same or equivalent type as recommended in the "Battery Installation" instructions are to be used.
- If removable rechargeable batteries are used, they are only to be charged under adult supervision.
- Rechargeable batteries are to be removed from the product before they are charged.
- If you use a battery charger, it should be examined regularly for damage to the cord, plug, enclosure and other parts. Do not use a damaged battery charger until it has been properly repaired.

## CAUTION

This package contains small parts  
in its unassembled state.  
Adult assembly is required.

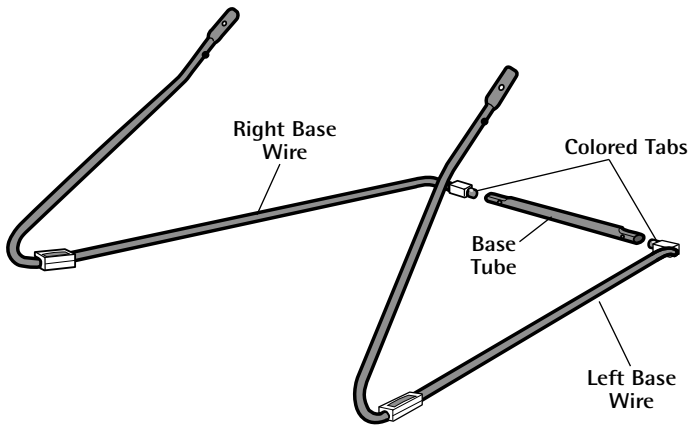

- Place the base tube on a flat surface as shown.
- Position the left and right base wires as shown. Note the locations of the colored tab on the left and right base wires.
- Fit the left base wire into the base tube.
- Fit the right base wire into the base tube.

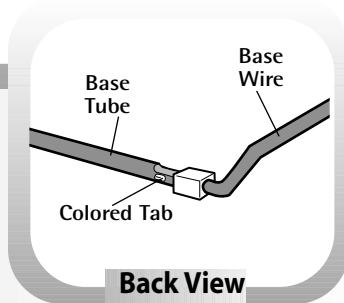

- **Make sure both colored tabs on the base wires are visible through the holes in base tube.**

# Assembly

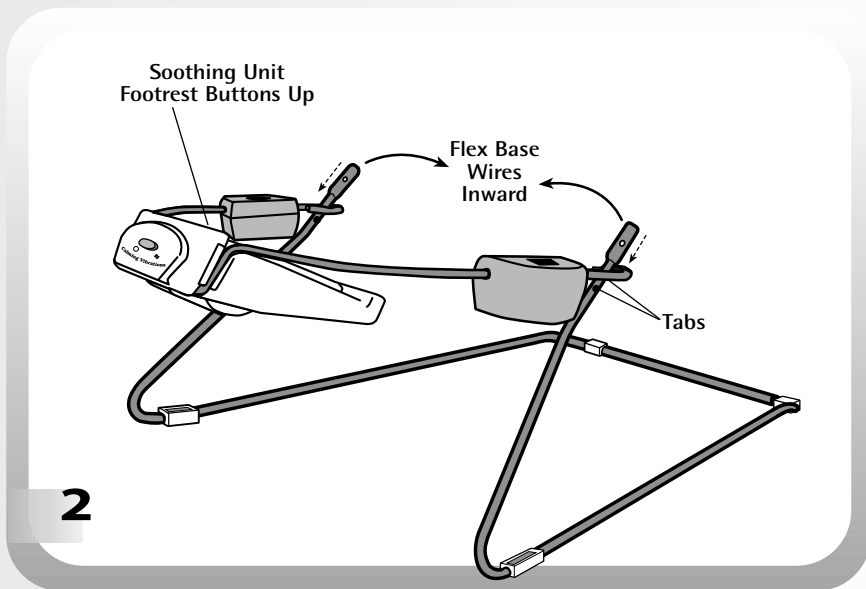

- Position the footrest so that the soothing unit buttons are upright.
- While flexing the base wires toward each other, hook the footrest onto the ends of the base wires.
- Push the footrest **down completely to the tabs** on the base wires.

# Assembly

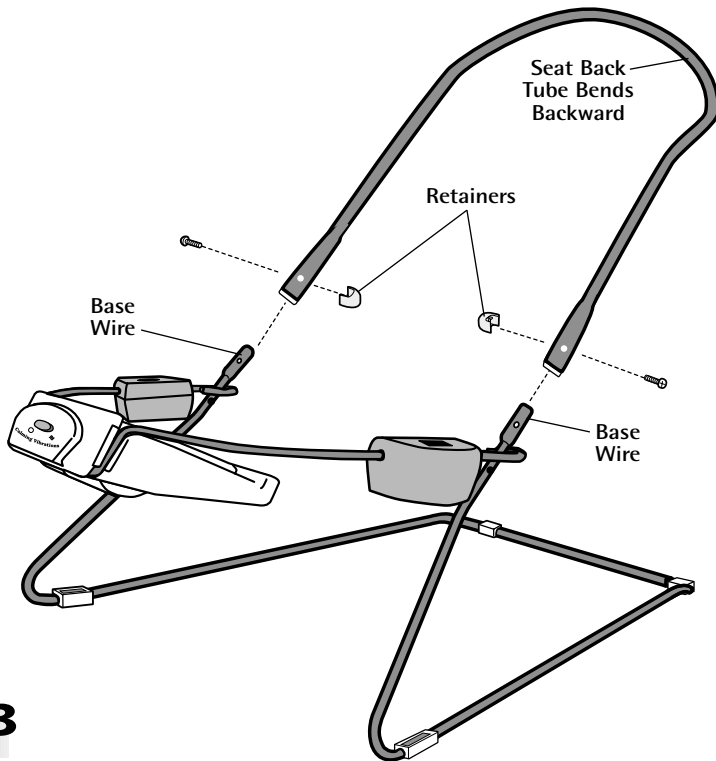

3

- Position the seat back tube so that it bends backward.
- Fit the seat back tube completely onto the base wires. Make sure the hole in each end of the seat back tube aligns with the hole in each base wire.
- Fit a retainer (rounded side inward) to one end of the seat back tube.
- Insert a screw through the **outside** hole in the seat back tube and into the retainer.
- While holding the retainer in place, tighten the screw with a Phillips screwdriver. Do not over-tighten.
- Repeat this procedure to secure the other side of the seat back tube to the base assembly using the remaining retainer and screw.



# Assembly

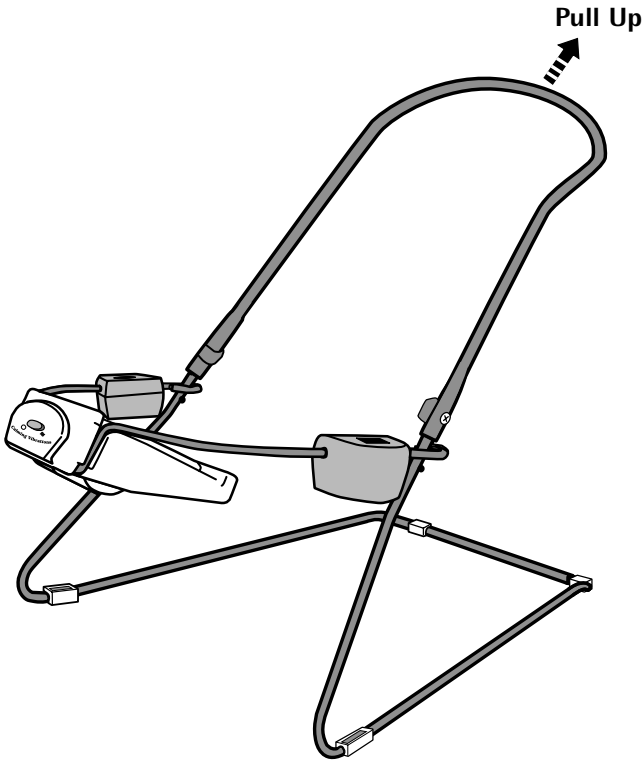

**4**

- Pull up on the seat back tube to be sure it is secure. If you can remove either end of the seat back tube, you have not assembled it correctly. Remove the screws and retainers. Re-read and repeat Assembly steps 3 and 4.

# Assembly

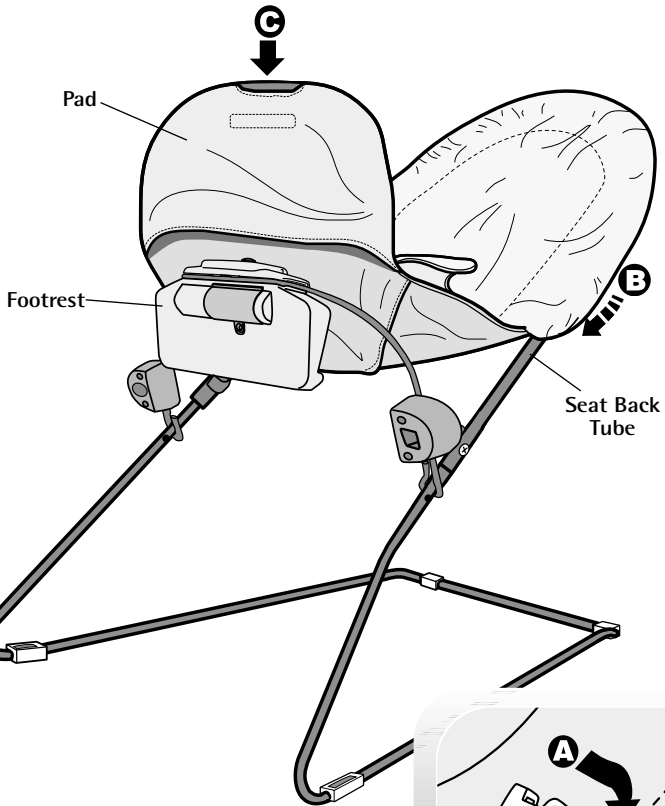

5

- Unbuckle the restraint belts from the restraint pad. Push the restraint belts back through the slots in the pad **A**.
- Fit the pad upper pocket onto the seat back tube **B**.
- Lift the footrest. Fit the pad lower pocket onto the footrest **C**. Lower the footrest.

# Assembly



- Fit both restraint belts back through the pad slots, as shown.

# Assembly

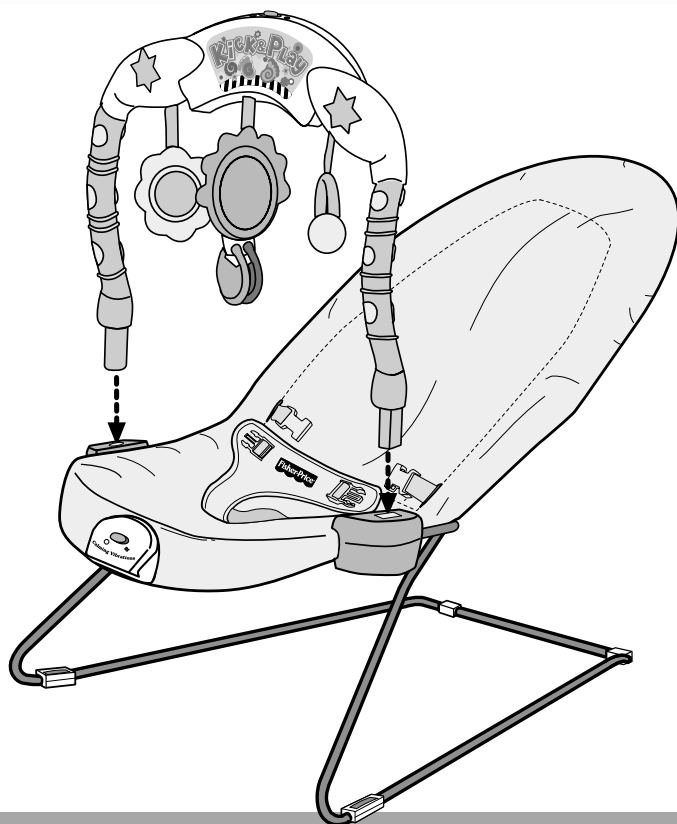

- Fit the ends of the toy bar into the sockets in the footrest.

**Hint:** The square end of the toy bar fits into the square socket and the circular end of the toy bar fits into the circular socket.

**Assembly is now complete.**

- The toy bar is removable. Simply lift up to remove.

# Set-Up & Use

## **WARNING**

### **To prevent serious injury and/or falls:**

- Never use on any elevated surface, since child's movement may cause bouncer to slide or tip over.
- Never use as a carrier or lift while child is seated.
- Always use the restraint system.
- Never leave child unattended.
- Never use with a child able to sit up, unassisted.

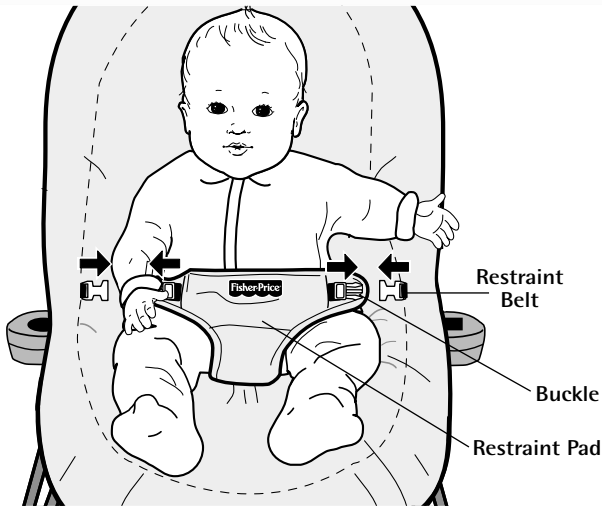

### **Securing Your Child**

- If the toy bar is attached, remove it before placing your child in the seat.
- Place your child in the seat. Position the restraint between your child's legs.
- Fasten both restraint belts to the buckles on each side of the restraint pad. **Make sure you hear a "click" on both sides.**
- Check to be sure the restraint is securely attached by pulling it away from your child. The restraint should remain attached.
- Attach the toy bar, if desired (see Assembly step 7).

# Set-Up & Use

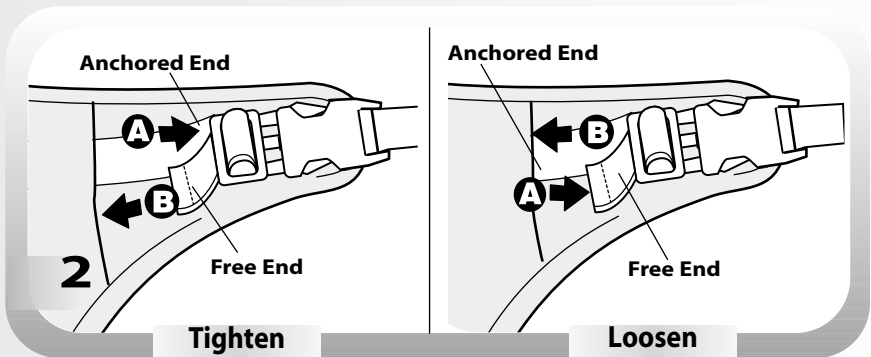

## To tighten the belts:

- Feed the anchored end of the belt up through the buckle to form a loop **A**.
- Pull the free end of the belt **B**.
- Repeat this procedure to tighten the other belt.

## To loosen the belts:

- Feed the free end of the belt up through the buckle to form a loop **A**.  
Enlarge the loop by pulling on the end of the loop toward the buckle.
- Pull the anchored end of the belt to shorten the free end of the belt **B**.
- Repeat this procedure to loosen the other belt.

**Please Note:** After adjusting the belts to fit your child, make sure you pull on them to be sure they are securely fastened.

# Set-Up & Use

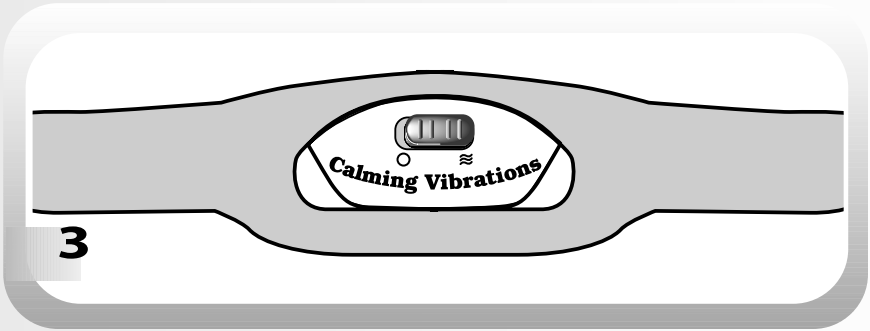

## Calming Vibrations

- Make sure your child is properly secured in the seat.
- To turn vibrations on, slide the power switch on the soothing unit to the **on** position  $\approx$ .
- To turn vibrations off, slide the power switch on the soothing unit to the **off** position  $\circ$ .

**IMPORTANT!** If vibrations from the soothing unit become faint, or if there are no vibrations, remove the battery from the soothing unit and dispose of it properly. Replace the battery with a new "D" (LR20) **alkaline** battery.

# Set-Up & Use

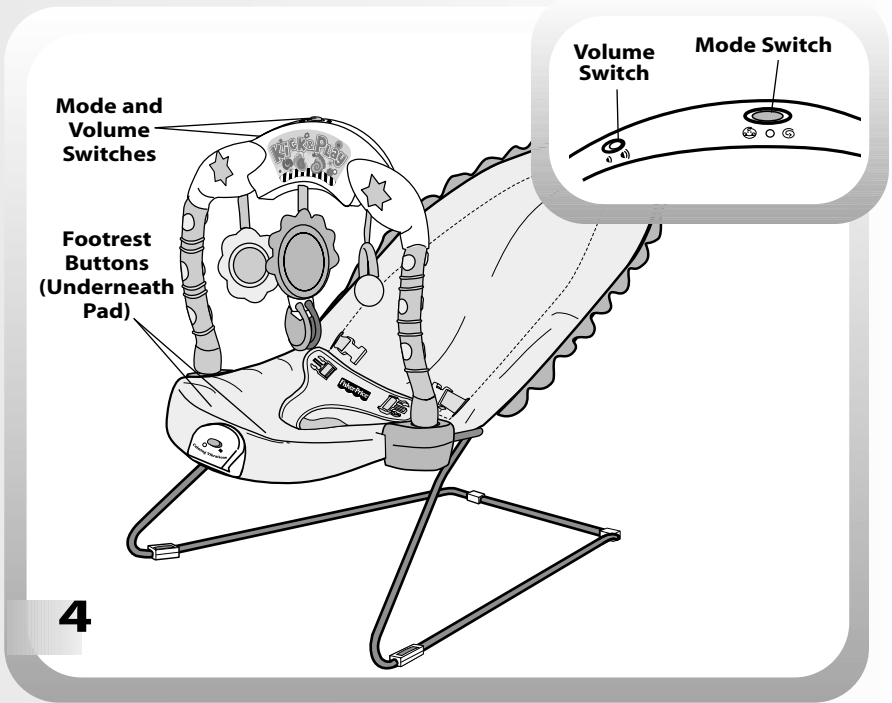

## Sounds and Lights

### 👶 Baby Activated

- Slide the **mode switch** to 🎵 for **baby activated** mode.
- When baby **kicks a footrest button**, baby is rewarded with sound effects and chasing lights. After baby kicks the buttons several times in a row, baby enjoys a musical tune and twinkling lights.

### 🎵 Parent Activated

- Slide the **mode switch** to 🎵 for **parent activated** mode. Baby enjoys 10 minutes of music and a light show.

### ○ Off

- Slide the toy bar switch to ○ to turn off sounds and lights.
- Slide the **volume switch** to 🔊 for low volume; 🔊 for high volume.

**IMPORTANT!** If lights become dim or sound becomes faint, remove the batteries from the toy bar and dispose of properly. Replace the batteries with three, new "AA" (LR6) **alkaline** batteries.



# Set-Up & Use

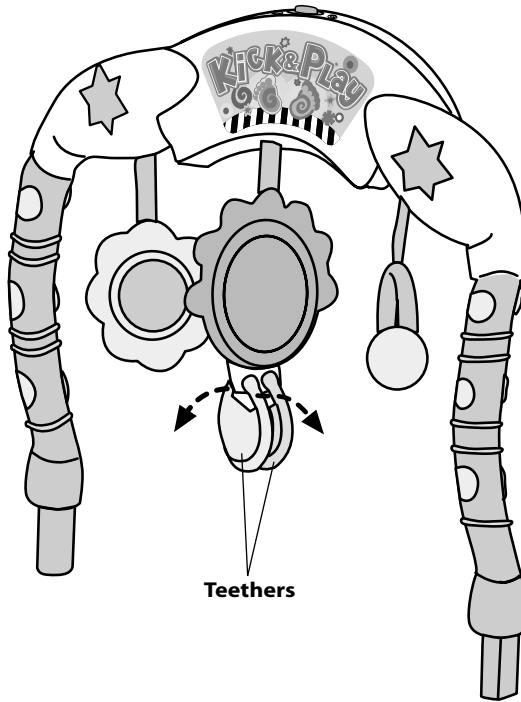

**5**

- The teethers are removable from the toy on the toy bar. Simply twist the ends of each teether slightly to remove them from the center toy.

# Care

The pad is machine washable. Wash the pad separately in cold water on the gentle cycle. Do not use bleach. Tumble dry separately on low heat and remove promptly. The frame and toy bar and teethingers can be wiped clean using a mild cleaning solution and a damp cloth. Do not immerse the soothing unit or toy bar.

## **To remove the pad:**

- Lift the footrest and remove the pad lower pocket
- Push the restraint belts back through the pad.
- Slide the pad upper pocket off the seat back tube.

## **To re-assemble the pad:**

- Refer to assembly steps 5 and 6.

# FCC Statement (United States Only)

This equipment has been tested and found to comply with the limits for a Class B digital device, pursuant to part 15 of the FCC rules. These limits are designed to provide reasonable protection against harmful interference in a residential installation. This equipment generates, uses and can radiate radio frequency energy and, if not installed and used in accordance with the instructions, may cause harmful interference to radio communications. However, there is no guarantee that interference will not occur in a particular installation. If this equipment does cause harmful interference to radio or television reception, which can be determined by turning the equipment off and on, the user is encouraged to try to correct the interference by one or more of the following measures:

Reorient or relocate the receiving antenna.

Increase the separation between the equipment and receiver.

Connect the equipment into an outlet on a circuit different from that to which the receiver is connected.

Consult the dealer or an experienced radio/TV technician for help.

Note: Changes or modifications not expressly approved by the manufacturer responsible for compliance could void the user's authority to operate the equipment.

# Consumer Information

Occasionally a consumer may experience a problem with one of our products. If this should happen, please call us toll-free, rather than return this product to the store. Usually, we can solve the problem over the telephone or send you replacement parts.

Please call Fisher-Price® Consumer Relations, toll-free at **1-800-432-KIDS**, 8 AM - 6 PM EST Monday through Friday. Hearing-impaired consumers using TTY/TDD equipment, please call 1-800-382-7470.

Or, write to:  
Fisher-Price® Consumer Relations  
636 Girard Avenue  
East Aurora, New York 14052

**For other countries, outside the United States:**

Canada: call 1-800-567-7724, or write to:

Mattel Canada Inc., 6155 Freemont Blvd., Mississauga, Ontario L5R 3W2.

Great Britain: telephone 01628 500302.

Australia: Mattel Australia Pty. Ltd., 658 Church Street, Locked Bag #870, Richmond, Victoria 3121 Australia.

Consumer Advisory Service 1300 135 312.

New Zealand: 16-18 William Pickering Drive, Albany 1331, Auckland.

## Free Manuals Download Website

<http://myh66.com>

<http://usermanuals.us>

<http://www.somanuals.com>

<http://www.4manuals.cc>

<http://www.manual-lib.com>

<http://www.404manual.com>

<http://www.luxmanual.com>

<http://aubethermostatmanual.com>

Golf course search by state

<http://golfingnear.com>

Email search by domain

<http://emailbydomain.com>

Auto manuals search

<http://auto.somanuals.com>

TV manuals search

<http://tv.somanuals.com>